



*Mail/Copied
2/25/22
KH*

COMMISSIONERS:
STAN VANDERWERF (CHAIR)
CAMI BREMER (VICE-CHAIR)

LONGINOS GONZALEZ, JR.
HOLLY WILLIAMS
CARRIE GEITNER

PLANNING AND COMMUNITY DEVELOPMENT DEPARTMENT
CRAIG DOSSEY, EXECUTIVE DIRECTOR

2/25/2022

RE: 11275 Forest Edge Drive – Administrative relief for side setback

File: ADR222
Parcel ID No.:62230-00-012

To Whom It May Concern:

This letter is to inform property owners adjacent to 11275 Forest Edge Drive that the applicant, Kelly and Timothy Hromadka, have requested approval of an application for administrative relief of the 25-foot side setback requirement within the RR-5 (Rural Residential) zoning district.

The Planning and Community Development Department Director may make a formal decision regarding the administrative relief application on 3/7/2022. Any comments or questions may be forwarded to me prior to that decision. Administrative approval by the Planning and Community Development Department Director is subject to the appeal provisions of the Land Development Code.

You may view the application documents online at www.epcdevplanreview.com. Please feel free to contact me with any questions, comments, or concerns you may have prior to the decision.

Respectfully,

Kylie Bagley
El Paso County Planning and Community Development
719-520-6300
KylieBagley@elpasoco.com



El Paso County Parcel Information

File Name:

Zone Map No.:

Date:

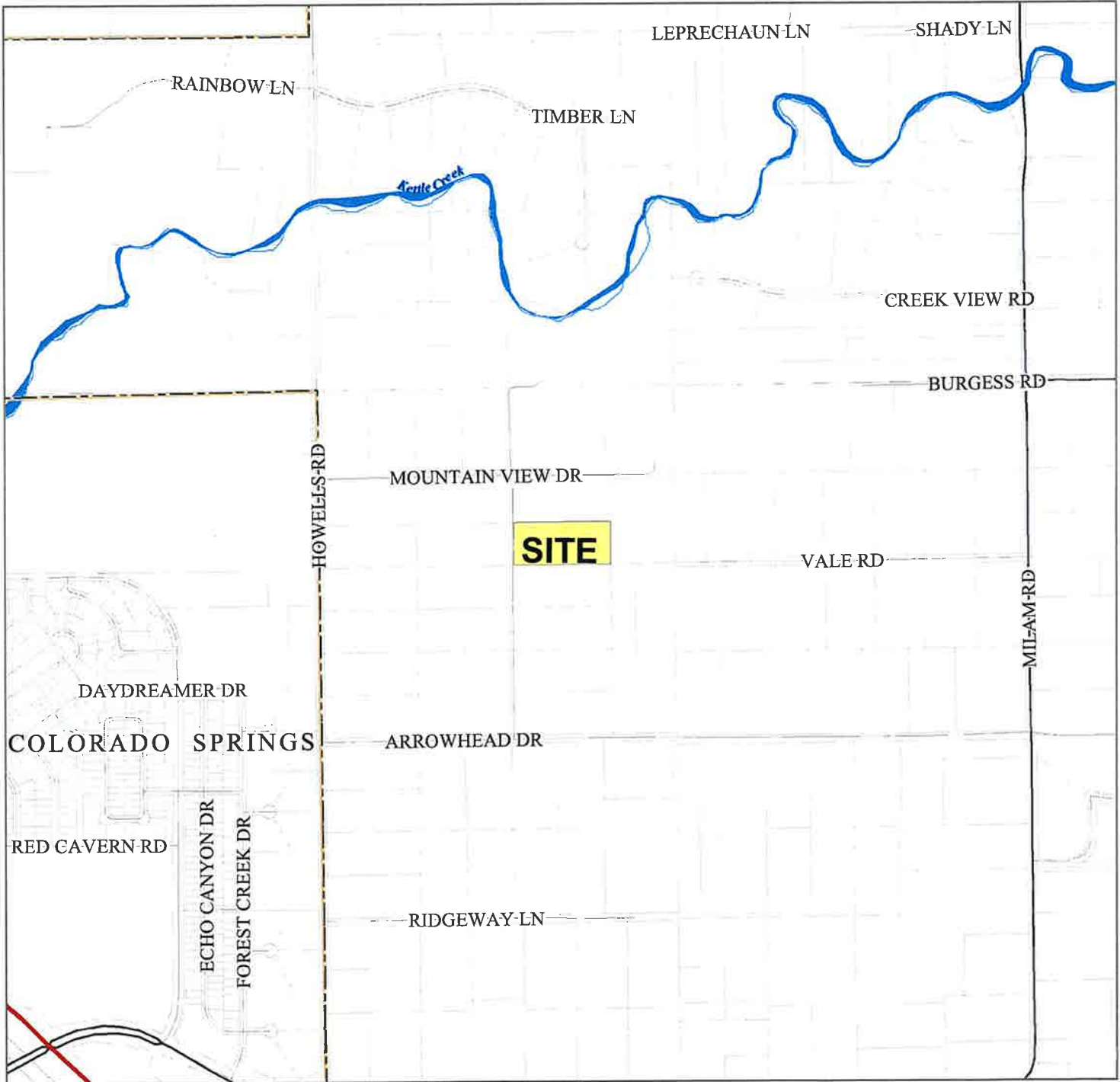

Please report any parcel discrepancies to:
El Paso County Assessor
1675 W. Garden of the Gods Rd.
Colorado Springs, CO 80907
(719) 520-6600



COPYRIGHT 2018 by the Board of County Commissioners, El Paso County, Colorado. All rights reserved. No part of this document or data contained hereon may be reproduced; used to prepare derivative products; or distributed without the specific written approval of the Board of County Commissioners, El Paso County, Colorado. This document was prepared from the best data available at the time of printing. El Paso County, Colorado, makes no claim as to the completeness or accuracy of the data contained hereon.

6223000103
BAIRD MICHELE
11280 FOREST EDGE DR
COLORADO SPRINGS, CO 80908

6223000083
BAYER ANTHONY M
4220 VALE RD
COLORADO SPRINGS, CO 80908

6223000012
HROMADKA TIMOTHY
11275 FOREST EDGE DR
COLORADO SPRINGS, CO 80908

6223000104
JARDON LOUIE A
11220 FOREST EDGE DR
COLORADO SPRINGS, CO 80908

6223000013
JASPAN DENNIS
11215 FORREST EDGE DR
COLORADO SPRINGS, CO 80908

6223000072
LANE JOEL L C
4220 ARROWHEAD DR
COLORADO SPRINGS, CO 80908

6223000011
PUFFPAFF FAMILY TRUST
11325 FOREST EDGE DR
COLORADO SPRINGS, CO 80908

6223000010
SOUSA HENRY
4025 MOUNTAIN VIEW DR
COLORADO SPRINGS, CO 80908