

ENG-CDR21010-R3-CDs-Barbarick-Ultimate.pdf Markup Summary

2 (2)

13. THE LAYER OF CONSTRUCTION SHALL REMAIN WITH THE PROPERTY OWNER'S PERMISSION AND AGREEMENT, WHEN REQUIRED, FOR REPAIRS, MAINTENANCE, OR CONSTRUCTION.

Include county plowable median nose detail (SD-2-22)

Subject: Text Box
Page Index: 2
Date: 4/4/2022 9:58:51 AM
Author: CDurham
Color: ■
Layer:
Space:
Page Label: 2

Include county plowable median nose detail (SD-2-22)

Include county patterned concrete median detail (SD-2-21)

Subject: Text Box
Page Index: 2
Date: 4/4/2022 10:00:08 AM
Author: CDurham
Color: ■
Layer:
Space:
Page Label: 2

Include county patterned concrete median detail (SD-2-21)

3 (2)

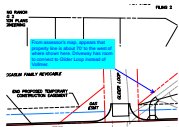

Subject: Callout
Page Index: 3
Date: 4/4/2022 12:51:45 PM
Author: CDurham
Color: ■
Layer:
Space:
Page Label: 3

From assessor's map, appears that property line is about 70' to the west of where shown here. Driveway has room to connect to Glider Loop instead of Vollmer.

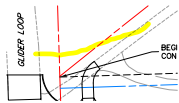

Subject: Highlight
Page Index: 3
Date: 4/4/2022 12:52:11 PM
Author: CDurham
Color: ■
Layer:
Space:
Page Label: 3

4 (3)

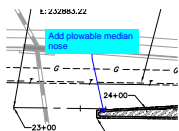

Subject: Callout
Page Index: 4
Date: 4/4/2022 9:59:20 AM
Author: CDurham
Color: ■
Layer:
Space:
Page Label: 4

Add plowable median nose

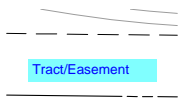

Subject: Text Box
Page Index: 4
Date: 4/4/2022 12:38:35 PM
Author: CDurham
Color: ■
Layer:
Space:
Page Label: 4

Tract/Easement

NER SOUTH
EL SHOULDER
EPC TYPE
CURB & GL

Tract/Easement

Subject: Text Box

Page Index: 4

Date: 4/4/2022 12:38:52 PM

Author: CDurham

Color: ■

Layer:

Space:

Page Label: 4

Tract/Easement

5 (1)

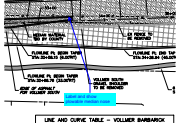

Subject: Callout

Page Index: 5

Date: 4/4/2022 12:54:22 PM

Author: CDurham

Color: ■

Layer:

Space:

Page Label: 5

Label and show plowable median nose

6 (9)

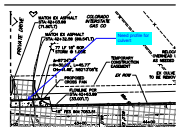

Subject: Callout

Page Index: 6

Date: 4/4/2022 12:56:35 PM

Author: CDurham

Color: ■

Layer:

Space:

Page Label: 6

Need profile for culvert



Subject: Callout

Page Index: 6

Date: 4/4/2022 12:58:01 PM

Author: CDurham

Color: ■

Layer:

Space:

Page Label: 6

Label where c&g ends

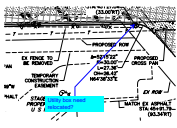

Subject: Callout

Page Index: 6

Date: 4/4/2022 12:58:40 PM

Author: CDurham

Color: ■

Layer:

Space:

Page Label: 6

Utility box need relocated?

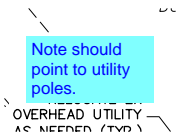

Note should
point to utility
poles.

OVERHEAD UTILITY
AS NEEDED (TYP)

Subject: Text Box

Page Index: 6

Date: 4/4/2022 12:59:46 PM

Author: CDurham

Color: ■

Layer:

Space:

Page Label: 6

Note should point to utility poles.

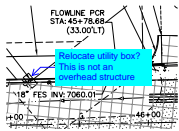

Subject: Callout
Page Index: 6
Date: 4/4/2022 1:00:18 PM
Author: CDurham
Color: ■
Layer:
Space:
Page Label: 6

Relocate utility box? This is not an overhead structure

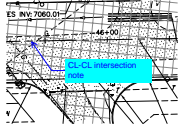

Subject: Callout
Page Index: 6
Date: 4/4/2022 1:00:56 PM
Author: CDurham
Color: ■
Layer:
Space:
Page Label: 6

CL-CL intersection note

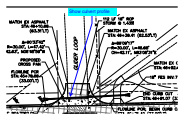

Subject: Callout
Page Index: 6
Date: 4/4/2022 1:02:35 PM
Author: CDurham
Color: ■
Layer:
Space:
Page Label: 6

Show culvert profile

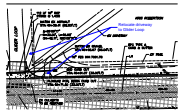

Subject: Callout
Page Index: 6
Date: 4/11/2022 12:42:01 PM
Author: dsdrice
Color: ■
Layer:
Space:
Page Label: 6

Relocate driveway to Glider Loop

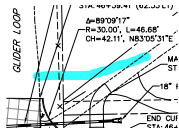

Subject:
Page Index: 6
Date: 4/11/2022 12:41:52 PM
Author: dsdrice
Color: ■
Layer:
Space:
Page Label: 6

Relocate driveway to Glider Loop

7 (1)

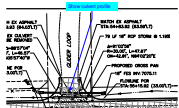

Subject: Callout
Page Index: 7
Date: 4/4/2022 3:13:06 PM
Author: CDurham
Color: ■
Layer:
Space:
Page Label: 7

Show culvert profile

2

Subject: Text Box
Page Index: 11
Date: 4/4/2022 3:29:39 PM
Author: CDurham
Color: ■
Layer:
Space:
Page Label: 11

2

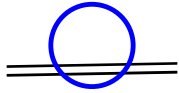

Subject: Ellipse
Page Index: 11
Date: 4/4/2022 3:30:00 PM
Author: CDurham
Color: ■
Layer:
Space:
Page Label: 11

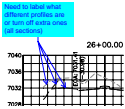

Subject: Callout
Page Index: 12
Date: 4/4/2022 3:32:47 PM
Author: CDurham
Color: ■
Layer:
Space:
Page Label: 12

Need to label what different profiles are or turn off extra ones (all sections)

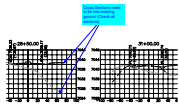

Subject: Callout
Page Index: 12
Date: 4/4/2022 3:34:18 PM
Author: CDurham
Color: ■
Layer:
Space:
Page Label: 12

Cross Sections need to tie into existing ground (Check all sections)