

REV A

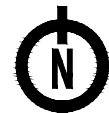

ION	
CONFIDENTIAL - THE INFORMATION HEREIN CONTAINED SHALL NOT BE USED FOR THE BENEFIT OF ANYONE EXCEPT ION DEVELOPER, LLC NOR SHALL IT BE DISCLOSED IN WHOLE OR IN PART TO OTHERS OUTSIDE RECIPIENTS ORGANIZATION, EXCEPT IN CONNECTION WITH THE SALE AND USE OF THE RESPECTIVE EQUIPMENT, WITHOUT THE WRITTEN PERMISSION OF ION DEVELOPER, LLC.	
ION DEVELOPER, LLC 4801 N UNIVERSITY AVE #900 PROVO, UT 84604 888.781.7074 DAVID STANLEY CONRAD EC EC.0100960	
SITE INFORMATION: MARGARET & CARY LIPPETT 14380 PARK CANYON ROAD COLORADO SPRINGS, COLORADO 80929 (16) SILFAB SOLAR SIL-400 HC+ (16) ENPHASE IQ8PLUS-72-2-US 6.4KW DC, 4.64KW STC-AC, 5.708KW CEC-AC	
DRAWING BY	DALLIN QUINTON
DATE	01-Nov-2023
PROJECT ID	00AUBI
SHEET NAME	SITE PLAN
SHEET NUMBER	V-2
REVISION	A

SITE NOTES:

JUNCTION BOXES UNDER PV ARRAY SHALL BE INSTALLED TO BE CONSIDERED ACCESSIBLE BY NEC 690.34

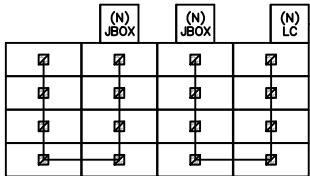

PVI

TRENCHING PATH: 120 FT. LENGTH @ 24 IN. DEPTH, TRIPLEX URD-CABLE (DIRECT BURIAL) W/ PVC SCH. 80 RISERS

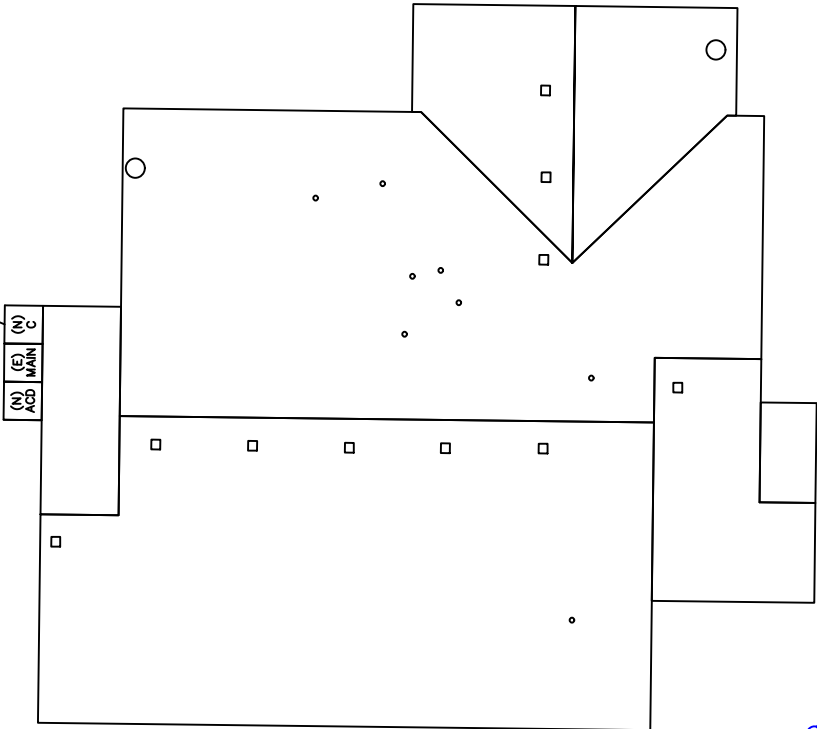

Released for Permit
11/06/2023 1:36:48 PM

Pikes Peak
REGIONAL
Building Department

richg
ELECTRICAL

FRONT OF HOME
14380 PARK CANYON ROAD

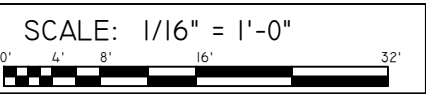

SYSTEM LEGEND			
(E) UTILITY METER / MAIN SERVICE PANEL	(N) PV COMBINER PANEL	(N) JUNCTION BOX	S# SUNEYE LOCATION
(E) MAIN SERVICE PANEL	(N) PV LOAD CENTER	(N) AC DISCONNECT (VISIBLE-OPEN LOCKABLE LABELED DISCONNECT)	FIRE SETBACK
(E) SUBPANEL	(N) PV PRODUCTION METER	(N) MICROINVERTER	(N) PV MODULE
	(N) DC-DC / STRING INVERTER	(N) DC DISCONNECT	STRUCTURALLY DISQUALIFIED

PV ARRAY CRITERIA AND SPECIFICATIONS

PV ARRAY SECTION	PV MODULE QTY	AZIMUTH	PITCH	TSRF
PVI	16	180	35	99%



SITE INFORMATION:	
MARGARET & CARY LIPPETT 14380 PARK CANYON ROAD COLORADO SPRINGS, COLORADO 80929 (16) SILFAB SOLAR SIL-400 HC+ (16) ENPHASE IQ8PLUS-72-2-US 6.4KW DC, 4.64KW STC-AC, 5.708KW CEC-AC	
DRAWING BY	DALLIN QUINTON
DATE	01-Nov-2023
PROJECT ID	00AUBI
SHEET NAME	PV ARRAY PLAN
SHEET NUMBER	S-3
REVISION	A