

You will need to revise your landscaping to meet the standards of LDC Sec. 6.2.2. Since it does not make sense to landscape the entire property, you will at a minimum need to landscape the project area according to LDC standards. This will require a request for alternative landscaping at the site development plan stage.

At a minimum, you will need to provide screening measure for the following:

- the parking area, meeting Sec. 6.2.2(C)
- buffer the project boundary area, meeting Sec. 6.2.2(D)(2) on the east side of the project
- Internal landscaping to the project area, meeting Sec. 6.2.2(E)(2).

You may need to request alternative measures for a perimeter screening fence or wall, but it may still be beneficial to screen portions of this site with an opaque fence or wall.

Native Area

EXISTING PASTURE TO REMAIN

EXISTING PASTURE TO REMAIN

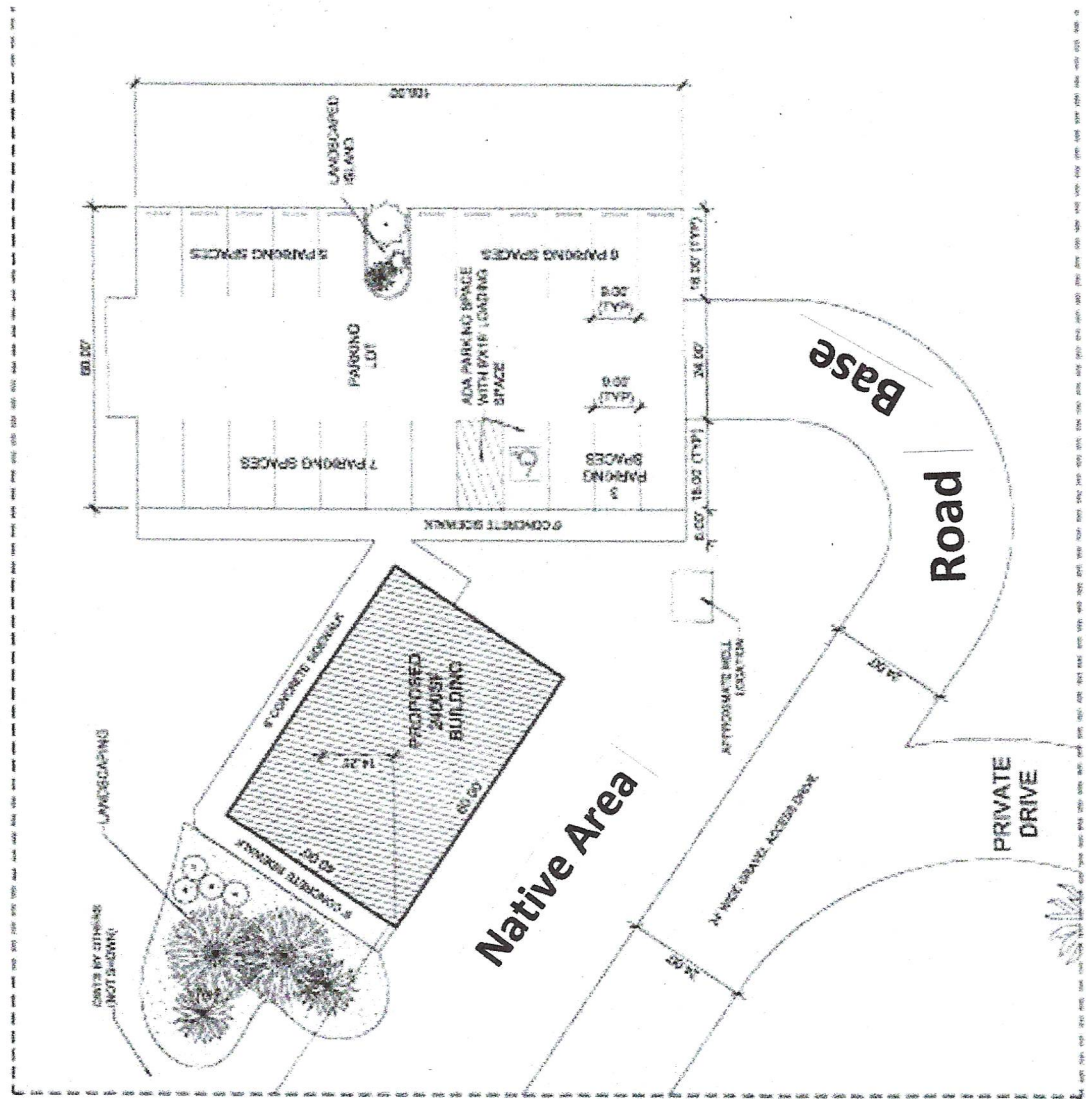

Landscaping Plan