

1
REFER TO OWNERSHIP TABLE
ON SHEET C2, TYP.

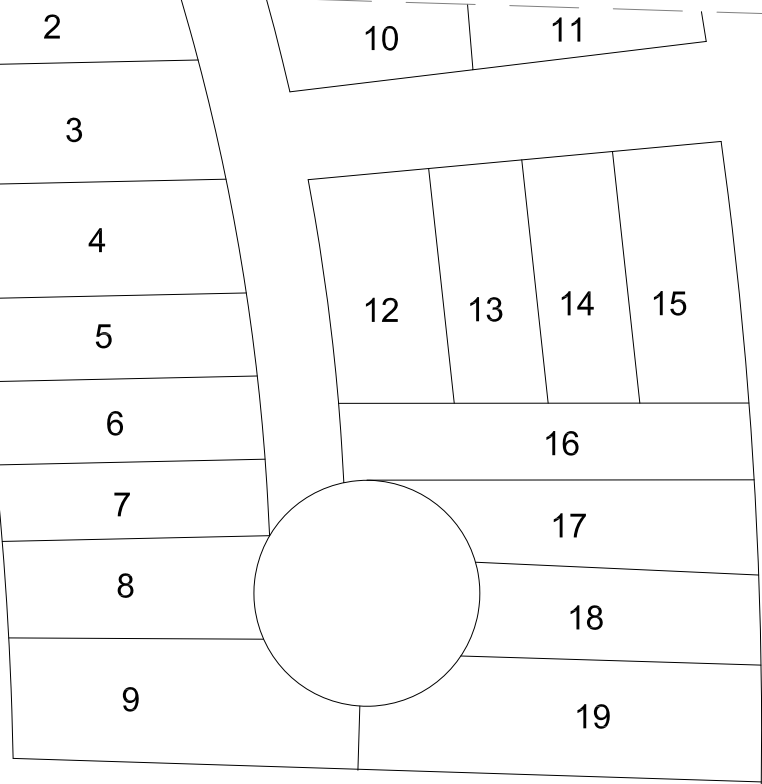

FALCON HWY
60' R.O.W.
S 88° 11' 43" E
1455.00 FT.

EXISTING CMP
CULVERT DISCHARGE
PROPOSED PAVEMENT
(MIN. DISTANCE OF 50'
FROM FALCON HIGHWAY)

PROPOSED
BUILDING

EXISTING POND

EXISTING HOUSE

REFER TO ENLARGEMENT
ON SHEET C3

500' FOR ADJOINING PROPERTIES TYP.

6275 N. MERIDIAN RD.
PARCEL #A318000028
A TRACT OF LAND IN NW4 OF SEC 18-13-64 DESC AS FOLS. COM AT NW COR OF
SEC 18 TH ALG W LN OF SD SEC S 00-00'00" E 30.01 FT. S 88-11'43" E 30.01 FT
FOR POB, TH ALG SLY RW OF FALCON HWY S 88-11'43" E 1455.00 FT. S 00-00'00"
E 1185.94 FT. N 83-11'43" W 1455.00 FT TO E R/W OF MERIDIAN ROAD, TH ALG R/W
N 00-00'00" E 1185.94 FT TO POB
41.92 ACRES
ZONING: RR-5

EXISTING
HORSE ARENA

EXISTING
AG BARN
(SEE NOTE
5 PAGE C3)

EXISTING DRAINAGE DITCH

EXISTING DAM

MERIDIAN RD.
60' R.O.W.
N 00° 00' 00" E
1185.94'

±1348' SETBACK

25' SETBACK

S 00° 00' 00" E
1185.94'

500' FOR ADJOINING PROPERTIES TYP.

28' SETBACK

N 83° 11' 43" W
1455.00 FT.

25' SETBACK

26

27

28

29

ADJOINING PROPERTY MAP

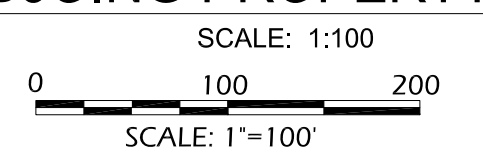

SITE NOTES:

- 1. NO MORE THAN ONE (1) ACRE OF DISTURBANCE IS ALLOWED FOR THE CONSTRUCTION OF THE BUILDING, PARKING LOT, ACCESS ROAD AND LANDSCAPE AREAS.
- 2. NO MORE THAN 50 VEHICLES (INCLUDING SHUTTLING) ARE ALLOWED ON SITE AT ONE TIME.



1910 ASPEN CIRCLE
PUEBLO, CO 81006
TEL 719.696.8274
DARLENE@DKHENG.COM

CONCEPTUAL
NOT FOR
CONSTRUCTION

STAMP:

**COMMUNITY BUILDING
(NON-PROFIT EVENT VENUE)**

6275 N MERIDIAN RD, PEYTON, CO 80831

Owners: David and Cindy Smallidge

PROJECT NUMBER:
DRAWN BY:
REVIEWED BY:
DATE:

ISSUE RECORD:

SITE PLAN
C1

ADJOINING OWNERSHIP WITHIN 500'					
NUMBER	PARCEL #	LAND USE	ZONE	OWNER	MAILING ADDRESS
1	5312400017	A.G. GRAZING LAND	R/CR SS	MOODY, BRIAN	8605 EXPLORER DR.
2	4307304055	SINGLE FAMILY RESIDENCE	PUD	EPHRON, JOEY	6540 WATUSI RD.
3	43070304056	SINGLE FAMILY RESIDENCE	PUD	MILE HIGH CAPITAL GROUP LTD	PO BOX 15486 CO SPRINGS, CO 80935
4	43070304057	SINGLE FAMILY RESIDENCE	PUD	BAUER, CARLA	2530 WATUSI RD.
5	4307304058	SINGLE FAMILY RESIDENCE	PUD	CASTRO, DAVID	6528 WATUSI RD.
6	4307304059	SINGLE FAMILY RESIDENCE	PUD	McPEEK, CASEY	6518 WATUSI RD.
7	4307304060	SINGLE FAMILY RESIDENCE	PUD	MANNING, RAYMOND	6516 WATUSI RD.
8	4307304061	SINGLE FAMILY RESIDENCE	PUD	LAVINE, MICHAEL	6506 WATUSI RD.
9	4307304062	SINGLE FAMILY RESIDENCE	PUD	WILSTEAD, IAN	6504 WATUSI RD
10	4307306012	SINGLE FAMILY RESIDENCE	PUD	INHABIT THAT LLC	5860 BIG CANON DR ENGLEWOOD, CO. 80111
11	4307306013	SINGLE FAMILY RESIDENCE	PUD	DAVIS, TYLER	6522 GELBVIEH RD.
12	4307304070	SINGLE FAMILY RESIDENCE	PUD	HOFFMAN, JEREMY	11815 SHORTHORN RD.
13	4307304069	SINGLE FAMILY RESIDENCE	PUD	N/A	N/A
14	4307304068	SINGLE FAMILY RESIDENCE	PUD	CABONILAS, ALAN	11845 SHORTHORN RD.
15	4307304067	SINGLE FAMILY RESIDENCE	PUD	LEFEBVRE, PATRICIA	11855 SHORTHORN RD.
16	4307304066	SINGLE FAMILY RESIDENCE	PUD	HANCOCK, RANDAL	6512 GELBVIEH RD.
17	4307304065	SINGLE FAMILY RESIDENCE	PUD	FRITZA, COLE	6510 GELBVIEH RD.
18	4307304064	SINGLE FAMILY RESIDENCE	PUD	INHABIT THAT LLC	5860 BIG CANON DR.
19	4307304063	SINGLE FAMILY RESIDENCE	PUD	INHABIT THAT LLC	5860 BIG CANON DR.
20	430730512	COUNTY	PUD	EL PASO COUNTY	200 S CASCADE AVE STE 150
21	N/A	POLITICAL SUBDIVISION	RR-5	FALCON SCHOOL D49	10850 E WOODMEN RD.
22	N/A	RELIGIOUS WORSHIP	RR-5	DIOCESE OF COLORADO SPRINGS	228 N CASCADE AVE
23	5313000002	SINGLE FAMILY RESIDENCE	RR-5	RICHARDSON DORYLEE	11735 FALCON HWY
24	5313000046	SINGLE FAMILY RESIDENCE	RR-5	LAZOR, STEVENS	13975 E US HWY 24
25	5313000119	SINGLE FAMILY RESIDENCE	RR-5	REVOK LIVING	4544 CLARK FORK PL
26	5313000099	SINGLE FAMILY RESIDENCE	RR-5	FINLEY, WENDY	3 CERRO CIR, LAMY NM, 87540
27	5313001012	SINGLE FAMILY RESIDENCE	RR-5	HATHAWAY, THOMAS	6150 N MERIDIAN RD.
28	4318004001	SINGLE FAMILY RESIDENCE	RR-5	SEIBEL, JEREMIAH	6155 N MERIDIAN RD
29	N/A	RES LAND NOT INTEGRAL TO AG OP	RR-5	SHIRLEY, JOHNSON	11545 FALCON HWY



1910 ASPEN CIRCLE
PUEBLO, CO 81006
TEL 719.696.8274
DARLENE@DKHENG.COM

CONCEPTUAL
NOT FOR
CONSTRUCTION

STAMP:

**COMMUNITY BUILDING
(NON-PROFIT EVENT VENUE)**

6275 N MERIDIAN RD, PEYTON, CO 80831

Owners: David and Cindy Smallidge

PROJECT NUMBER: 2024-DW00-A
ISSUE RECORD:
REVIEWED BY: _____
DATE: _____

ADJOINING
SITE
INFORMATION
C2

**WEDDING VENUE
FOR DAVID AND CINDY SMALLIDGE
6275 N. MERIDIAN ROAD
CITY OF PEYTON
EL PASO COUNTY, COLORADO**

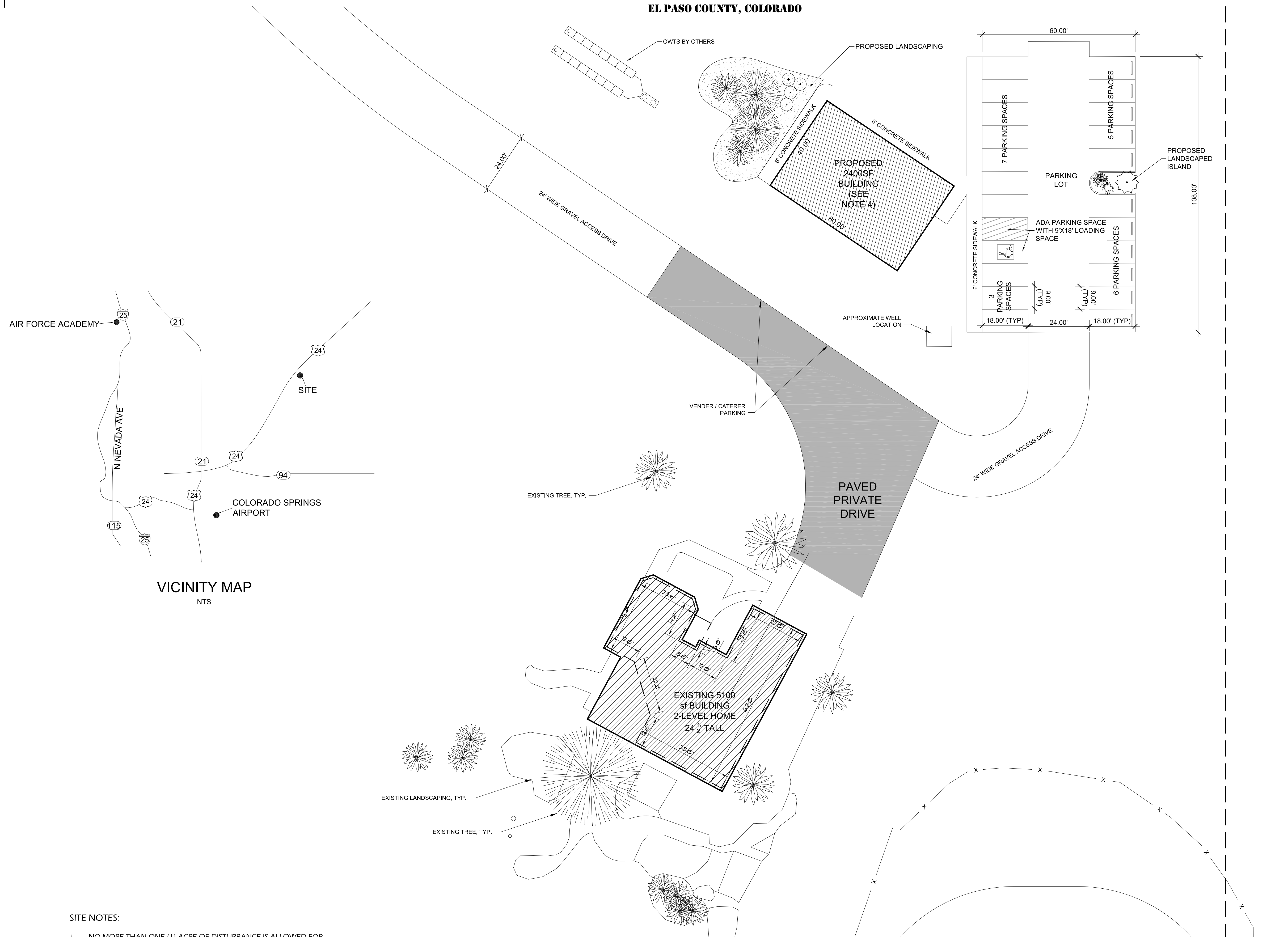

SITE NOTES:

1. NO MORE THAN ONE (1) ACRE OF DISTURBANCE IS ALLOWED FOR THE CONSTRUCTION OF THE BUILDING, PARKING LOT, ACCESS ROAD AND LANDSCAPE AREAS.
2. NO MORE THAN 50 VEHICLES (INCLUDING SHUTTLING) ARE ALLOWED ON SITE AT ONE TIME.
3. THE ACCESS ROAD WILL NEED TO BE PAVED FOR A MINIMUM DISTANCE OF 50 FEET FROM FALCON HIGHWAY.
4. THE PROPOSED 2400 SQUARE FOOT, 25' 5 3/8" TALL STRUCTURE IS A COMMERCIAL STRUCTURE PROPOSED TO BE USED AS A PRIVATE EVENT CENTER. AND THEREFORE, SUBJECT TO THE EL PASO COUNTY ROAD IMPACT FEE PROGRAM.
5. EXISTING AG BARN 12' X 90' X 8 1/2' TALL.
6. THERE ARE NO KNOWN EASEMENTS ON SITE.

PLAN ENLARGEMENT

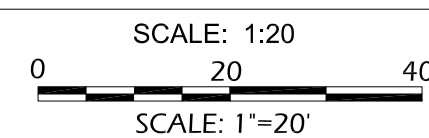

**CONCEPTUAL
NOT FOR
CONSTRUCTION**



1910 ASPEN CIRCLE
PUEBLO, CO 81006
TEL 719.696.8274
DARLENE@DKHENG.COM

STAMP:

**COMMUNITY BUILDING
(NON-PROFIT EVENT VENUE)**

6275 N MERIDIAN RD, PEYTON, CO 80831

Owners: David and Cindy Smallidge

PROJECT NUMBER:
DRAWN BY:
REVIEWED BY:
DATE:

ISSUE RECORD:

PLOT PLAN
C3