

APPROX. 500'
TO MERIDIAN ROAD
INTERSECTION

APPROX. 450'
TO MERIDIAN ROAD

APPROX. 150'
TO MERIDIAN ROAD

LEGEND OF EXISTING FEATURES

- PROPERTY LINE
- RIGHT-OF-WAY LINE
- SETBACK LINE
- EASEMENT
- SECTION LINE
- CENTERLINE
- 799 --- INTERMEDIATE CONTOUR
- 800 --- INDEX CONTOUR
- (T) --- TELEPHONE UNDER GR.
- (OH-T) --- TELEPHONE OVERHEAD
- (FO) --- FIBER OPTIC SERVICE
- (G) --- GAS SERVICE
- (E) --- POWER UNDERGROUND
- (OH-E) --- POWER OVERHEAD
- (W) --- WATER SERVICE
- (S) --- SANITARY SEWER
- (ST) --- STORM SEWER
- (NP) --- POND NORMAL POOL
- 000 --- EX. FLOWLINE
- X --- CHAIN LINK FENCE
- X --- FARM FENCE
- / --- WOOD FENCE
- □ --- IRON FENCE | RAILING
- BUILDING | STRUCTURE
- EX. BUILDING OVERHEAD
- RIM --- RIM ELEVATION
- INV. --- INVERT ELEVATION
- FFE --- FINISHED FLOOR ELEVATION
- ◆ BENCHMARK
- RBC MONUMENT
- △ SECTION CORNER
- HC TRANSFORMER
- ⊕ E ELECTRIC METER
- ⊕ E ELECTRIC MANHOLE
- ⊕ C POWER POLE | GUY WIRE
- ☆ LIGHT POLE
- ⊕ T TELEPHONE PEDESTAL
- ⊕ T TELEPHONE MANHOLE
- G ⊕ E GAS MARKER
- G ⊕ E ELECTRIC MARKER
- ⊕ T TRAFFIC POLE
- ⊕ T TRAFFIC MANHOLE
- G ⊕ G GAS METER
- G ⊕ G GAS VALVE
- ⊕ S STORM MANHOLE
- ⊕ S SANITARY MANHOLE
- ⊕ S STORM INLETS
- ⊕ S CLEAN-OUT
- ⊕ S D.S.P. DOWNSPOUT
- ⊕ S FIRE HYDRANTS
- ⊕ S WATER METER
- ⊕ S WATER VALVES
- ⊕ S POST INDICATOR VALVE
- ⊕ S FIRE DEPARTMENT CONN.
- ⊕ S SIGNS
- ⊕ S MAILBOX
- ⊕ S ADA PARKING
- ⊕ S PARKING COUNT
- ⊕ S TREES
- ⊕ S SHRUB
- ⊕ S SPOT GRADE

LANDSCAPE LEGEND - PROPOSED

- HARDWOOD MULCH
- PERMANENT SEEDING
- SOD
- PERENNIAL PLANTINGS
- LANDSCAPE EDGING
- DECIDUOUS SHRUB
- DECIDUOUS SHRUB
- EVERGREEN SHRUB
- ORNAMENTAL GRASS
- PLANT TAG
- EVERGREEN TREE
- DECIDUOUS TREE
- DECIDUOUS TREE
- ORNAMENTAL TREE
- ORNAMENTAL TREE
- ORNAMENTAL TREE
- MULTI-STEM TREE

PLANT SCHEDULE

| Key | Botanical Name | Common Name | Quantity | Size | Condition |
|-------------------------|---------------------------------|------------------------|----------|----------|-----------|
| UNDERSTORY TREES | | | | | |
| CC | CERCIS CANADENSIS | EASTERN REDBUD | 4 | 1 IN | B&B |
| EVERGREEN SHRUBS | | | | | |
| JC | JUNIPERUS CHINESIS | NICK'S COMPACT JUNIPER | 8 | 12 IN | #5 CONT. |
| BS | BUXUS SEMPERVIRENS | AMERICAN BOXWOOD | 12 | 24 IN | #5 CONT. |
| DECIDUOUS SHRUBS | | | | | |
| VJ | VIBURNUM X 'JUDI' | JUDD VIBURNUM | 11 | 24 IN | #5 CONT. |
| SB | SYRINGA PUBESCENS SUBSP. PATULA | MISS KIM LILAC | 19 | 24 IN | #5 CONT. |
| ORNAMENTAL GRASS | | | | | |
| HS | HELICTOTRICHON SEMPERVIRENS | BLUE OAT GRASS | 8 | 12 IN | #1 CONT. |
| EVERGREEN TREES | | | | | |
| PE | PINUS EDULIS | PINON PINE | 3 | 4 FT HT. | B&B |
| DECIDUOUS TREES | | | | | |
| AF | ACER FREEMANII | FREEMAN MAPLE | 4 | 2 IN | B&B |

REVISION BLOCK

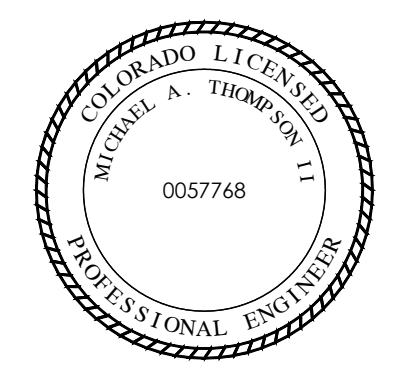

Michael Thompson

DATE: 10/21/2020

DRAWN BY: KPB CHECKED BY: AMT

HAMILTON DESIGNS
A LIMITED LIABILITY COMPANY

11 Municipal Drive, Suite 300
Fishers, Indiana 46038
P. (317) 570-8800
www.hamilton-designs.com

CONSTRUCTION PLANS FOR:
ARBY'S | FALCON, CO
11775 Meridian Market View
Falcon, Colorado 80831

BELL AMERICAN GROUP, LLC
8930 Bath Street, Suite L
Indianapolis, Indiana 46256

PROJECT NO. 2019-0246

DATE 10/21/2020

SCALE 1" = 20'

SHEET NAME **LANDSCAPE PLAN**

SHEET NO.

LP-101

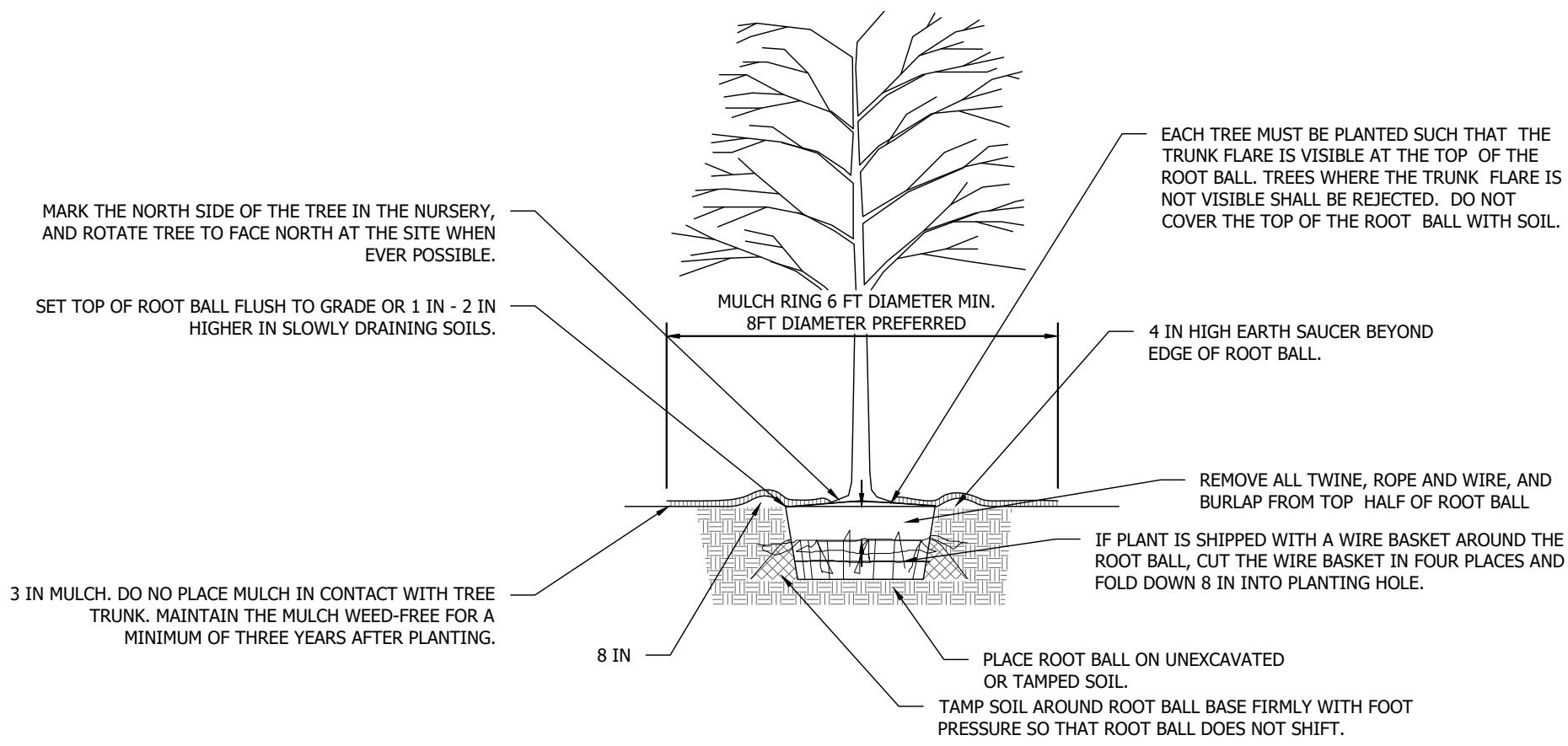

- NOTE:
1. THIS DETAIL ASSUMES THAT THE PLANTING SPACE IS LARGER THAN AN 8' SQUARE OPEN TO THE SKY, AND NOT COVERED BY ANY PAVING OR GRATING.
 2. STAKE TREES ONLY UPON THE APPROVAL OF THE LANDSCAPE ARCHITECT
 3. WRAP TREE TRUNKS ONLY UPON THE APPROVAL OF THE LANDSCAPE ARCHITECT.
 4. DO NOT HEAVILY PRUNE THE TREE AT PLANTING. PRUNE ONLY CROSSOVER LIMBS, CO-DOMINANT LEADERS, AND BROKEN OR DEAD BRANCHES. SOME INTERIOR TWIGS AND LATERAL BRANCHES MAY BE PRUNED; HOWEVER, DO NOT REMOVE THE TERMINAL BUDS OF BRANCHES THAT EXTEND TO THE EDGE OF THE CROWN.
 5. FOR DIMENSIONS OF PLANTING AREAS, TYPES OF SOIL, AMENDMENTS, OR SOIL REPLACEMENT, SEE "SOIL IMPROVEMENT DETAILS"

TREE PLANTING DETAIL, FOR B&B ALL SOIL TYPES

NOT TO SCALE

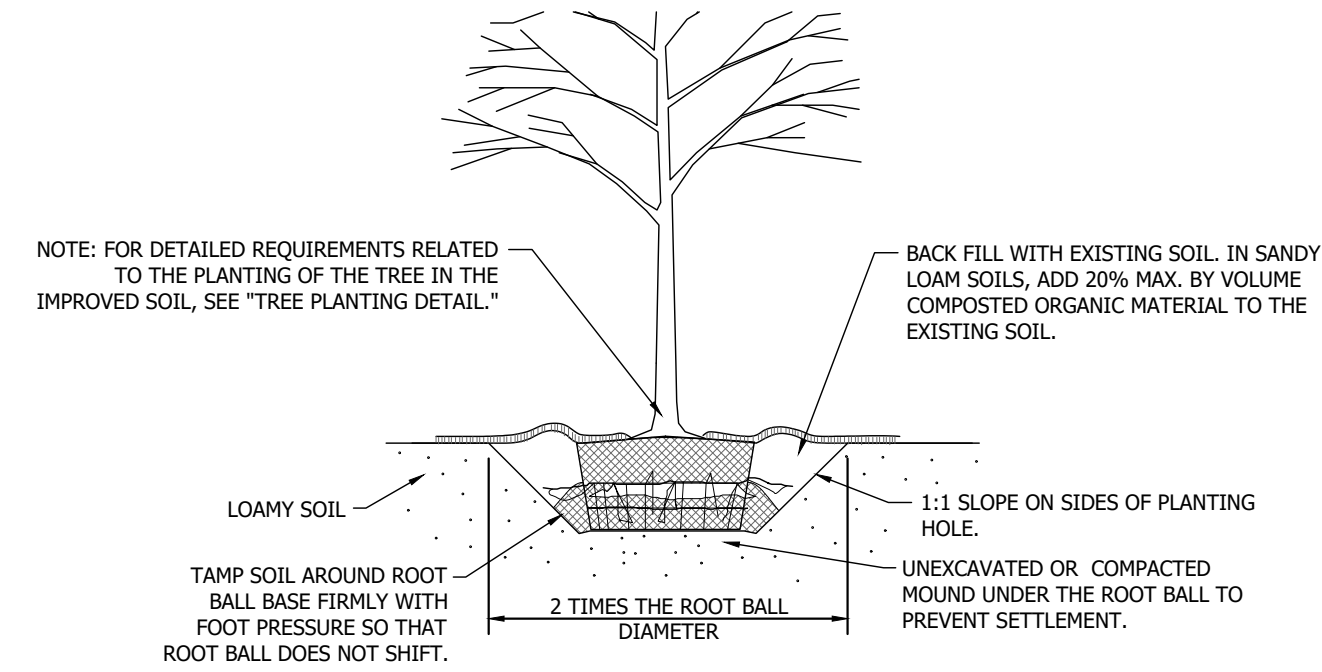

LOAMY SOILS INCLUDE THE FOLLOWING USDA TEXTURAL CLASSIFICATIONS AND HAVE A CLAY CONTENT OF BETWEEN 15 TO 27% LOAM, SANDY LOAM AND SILT LOAM. NOTE THAT SOILS AT THE OUTER LIMITS OF THE LOAM CLASSIFICATIONS MAY PRESENT SPECIAL PLANTING PROBLEMS NOT ANTICIPATED BY THIS DETAIL.

LOAMY SOILS ARE DEFINED AS GRANULAR OR BLOCKY FRIABLE SOILS, A MIXTURE OF SAND, SILT AND CLAY PARTICLES WITH A MINIMUM OF 1.5% BY DRY WEIGHT ORGANIC MATTER. THE SOIL MUST NOT BE SO COMPACTED AS TO IMPEDE ROOT GROWTH OR DRAINAGE. THE SOIL STRUCTURE SHALL NOT BE PLATY OR MASSIVE. THE SOIL MUST BE TESTED FOR TEXTURE, DRAINAGE CAPABILITY, PH, AND NUTRIENT VALUES PRIOR TO DETERMINING ANY ADDITIONAL SOIL IMPROVEMENTS. CONTRACTOR SHALL CONSULT LANDSCAPE ARCHITECT IN POOR SOIL CONDITIONS.

1. TREES PLANTED IN NON RESTRICTED SOIL CONDITIONS. THIS DETAIL ASSUMES THAT THE AREA OF LOAMY SOIL AVAILABLE TO EACH TREE IS A MINIMUM OF 500 SQUARE FEET.

SOIL IMPROVEMENT DETAIL

NOT TO SCALE

WIRE OR CABLE SIZES SHALL BE AS FOLLOWS:
TREES UP TO 2.5 IN CALIPER - 14 GAUGE
TREES 2.5 IN TO 75 MM 3 IN CALIPER - 12 GAUGE

TIGHTEN WIRE OR CABLE ONLY ENOUGH TO KEEP FROM SLIPPING. ALLOW FOR SOME TRUNK MOVEMENT. PLASTIC HOSE SHALL BE LONG ENOUGH TO ACCOMMODATE 1.5 IN OF GROWTH AND BUFFER ALL BRANCHES FROM THE WIRE.

TUCK ANY LOOSE ENDS OF THE WIRE OR CABLE INTO THE WIRE WRAP SO THAT NO SHARP WIRE ENDS ARE EXPOSED.

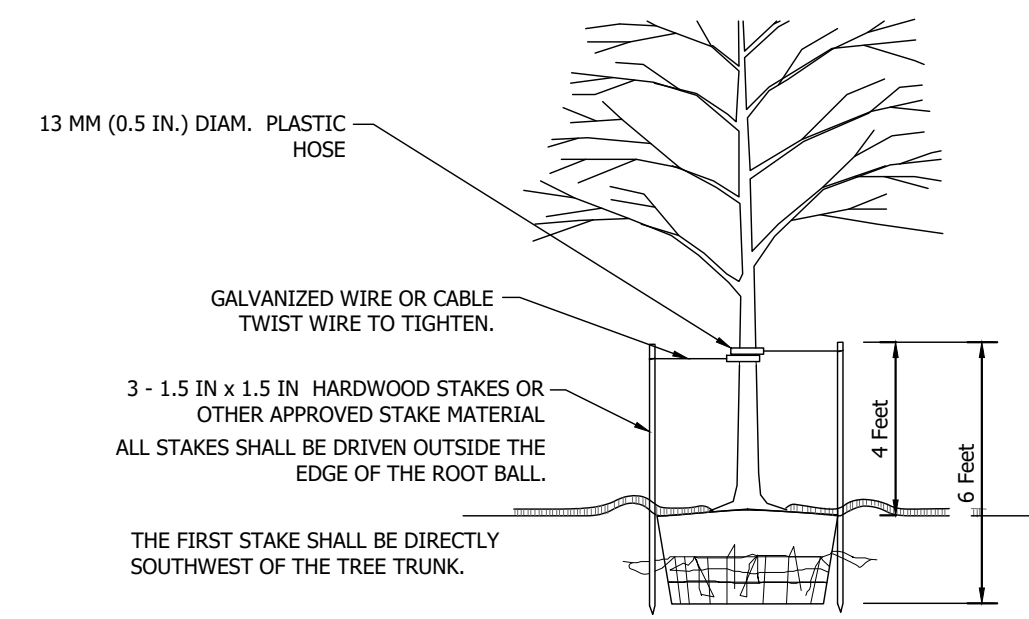

ASSURE THAT THE BEARING SURFACE OF THE PROTECTIVE COVERING OF THE WIRE OR CABLE AGAINST THE TREE TRUNK IS A MINIMUM OF 0.5 IN.

REMOVE ALL STAKING AS SOON AS THE TREE HAS GROWN SUFFICIENT ROOTS TO OVERCOME THE PROBLEM THAT REQUIRED THE TREE TO BE STAKED. STAKES SHALL BE REMOVED NO LATER THE END OF THE FIRST FULL GROWING SEASON AFTER PLANTING. IT SHALL BE THE CONTRACTOR'S RESPONSIBILITY TO REMOVE STAKING MATERIALS.

TREE STAKING DETAIL, 3" CALIPER OR LESS

NOT TO SCALE

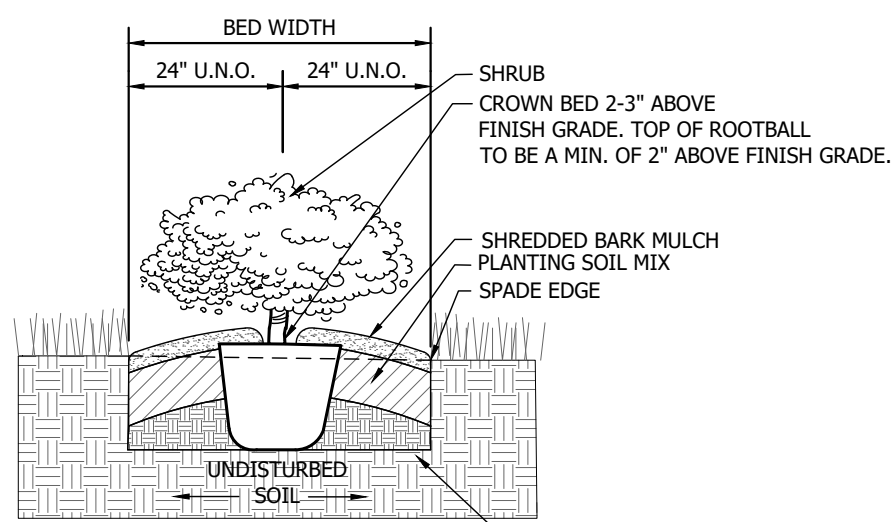

PLANTING PROCEDURE

1. LAYOUT BED AND OUTLINE WITH SPADE EDGE.
2. ROTOTILL BED TO 12" DEPTH.
3. SPREAD 6" MIN. LAYER OF PLANTING SOIL MIX OVER BED.
4. ROTOTILL PLANTING SOIL MIX INTO TOP OF BED.
5. INSTALL PLANTS, MULCH, AND WATER THOROUGHLY.

HEDGE PLANTING

NOT TO SCALE

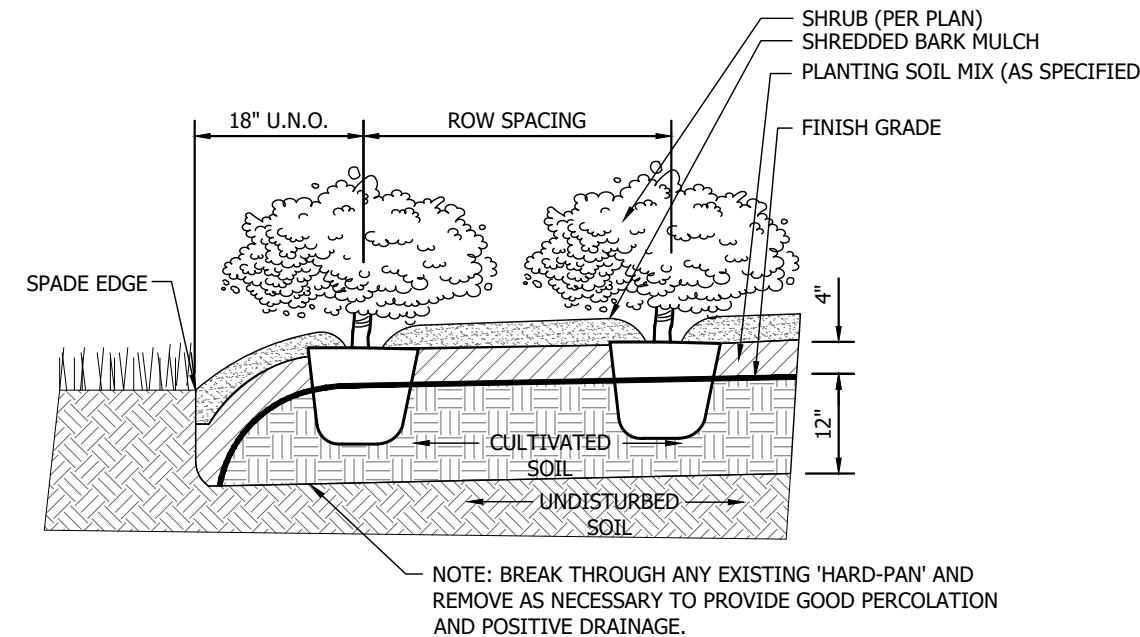

PLANTING PROCEDURE

1. LAYOUT BED AND OUTLINE WITH SPADE EDGE.
2. ROTOTILL BED TO 12" DEPTH.
3. SPREAD 4" MIN. LAYER OF PLANTING SOIL MIX OVER BED.
4. ROTOTILL PLANTING SOIL MIX INTO TOP OF BED.
5. INSTALL PLANTS, MULCH, AND WATER THOROUGHLY.

SHRUB MASS PLANTING

NOT TO SCALE

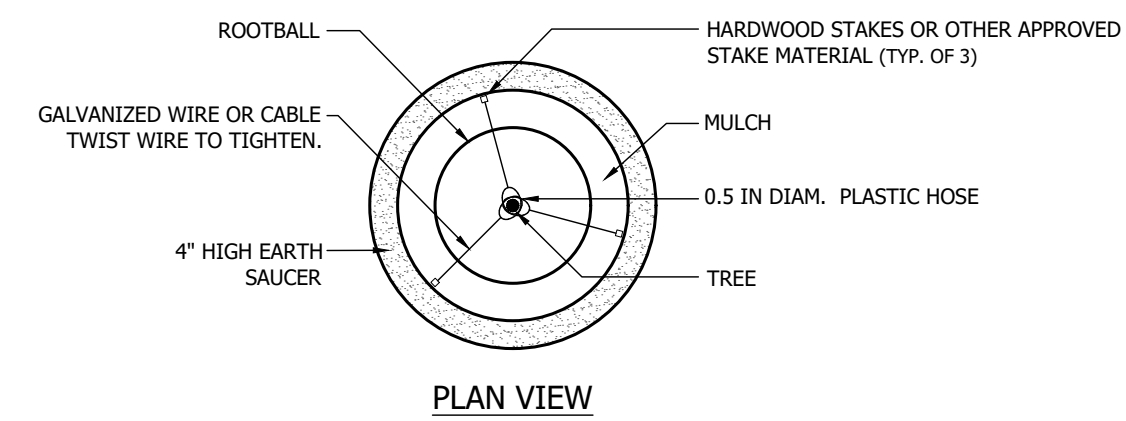

TREE STAKING DETAIL

NOT TO SCALE

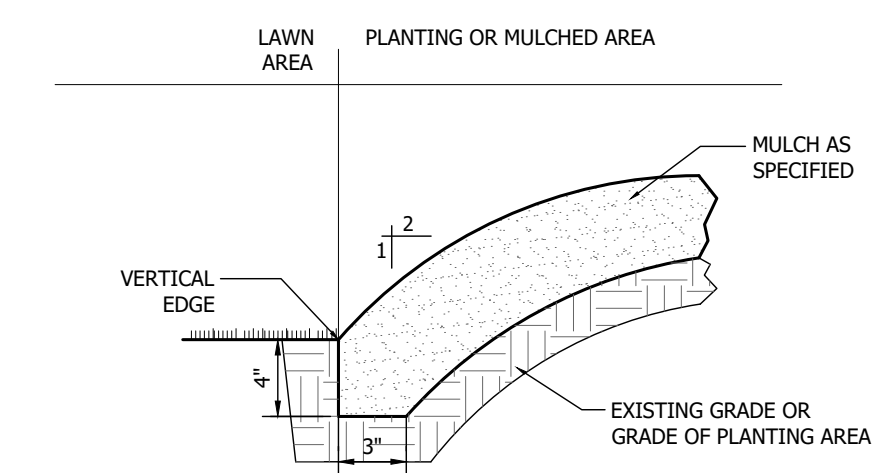

SPADE EDGE

NOT TO SCALE

REVISION BLOCK

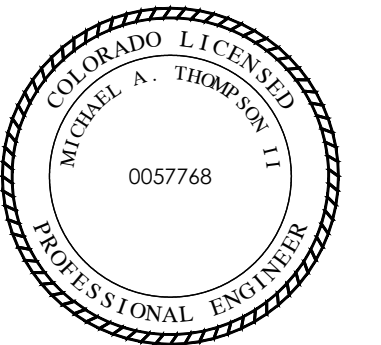

Michael Thompson

DATE
10/21/2020

DRAWN BY
KPB

CHECKED BY
AMT

**HAMILTON
DESIGNS**

A LIMITED LIABILITY COMPANY

11 Municipal Drive, Suite 300
Fishers, Indiana 46038
P. (317) 570-8800
www.hamilton-designs.com

CONSTRUCTION PLANS FOR:
ARBY'S I FALCON, CO
11775 Meridian Market View
Falcon, Colorado 80831

BELL AMERICAN GROUP, LLC
8930 Bath Street, Suite L
Indianapolis, Indiana 46256

PROJECT NO.
2019-0246

DATE
10/21/2020

SCALE
1" = # #'

SHEET NAME
**LANDSCAPE
DETAILS**

SHEET NO.

LP-501



Know what's below.
Call before you dig.