



MPW ENGINEERING, LLC  
 110 W. 7TH STREET • SUITE 600 • DENVER, CO 80202  
 (303) 582-4088 • (303) 582-4087 FAX



Copyright 2020 by Arby's Restaurant Group

NEW RESTAURANT FOR:  
**ARBY'S - INSPIRE DUAL HIGH 40 - STD**  
 11775 MERIDIAN MARKET VIEW  
 FALCON, CO  
 FOR  
 RB AMERICAN GROUP  
 6200 OAK TREE BLVD, INDEPENDENCE, OH 44131

PROJECT NUMBER:

ISSUE	DATE
PRELIMINARY	
PERMIT	
BID	
REVISION	01-25-2021
	03-11-2021

SITE  
 PHOTOMETRIC  
 PLAN

SHEET:

**E0.1**



Lighting at roadway cannot exceed 0.1 foot-candles.

**SITE LIGHTING PHOTOMETRIC PLAN - ELECTRICAL**

SITE LIGHTING FIXTURE SCHEDULE #							NOTES
TYPE	MANUFACTURER	CATALOG NUMBER	VOLT	WATT	QTY	DESCRIPTION	
RxA	TRACE-LITE	RxA - 70	120/277	70	10	(2) POLE FIXTURES @ 90° W/ 7" ARM	1,2

NOTES:  
 1. FIXTURE FURNISHED WITH LAMP.  
 2. FIXTURE SHALL BE U.L. LISTED AND LABELED FOR WET LOCATIONS.  
 FOR FIXTURE VERIFICATION, CONTACT PAUL GRAF OF ACCENT LIGHTING: (316)636-1278 FAX (316)636-1280

NOTE:  
 ELECTRICAL CONTRACTOR TO PROVIDE AS BUILT UNDER GROUND CONDUITS SURVEY CONDUCTED PRIOR TO FINAL INSPECTION BY UTILITY COMPANY.

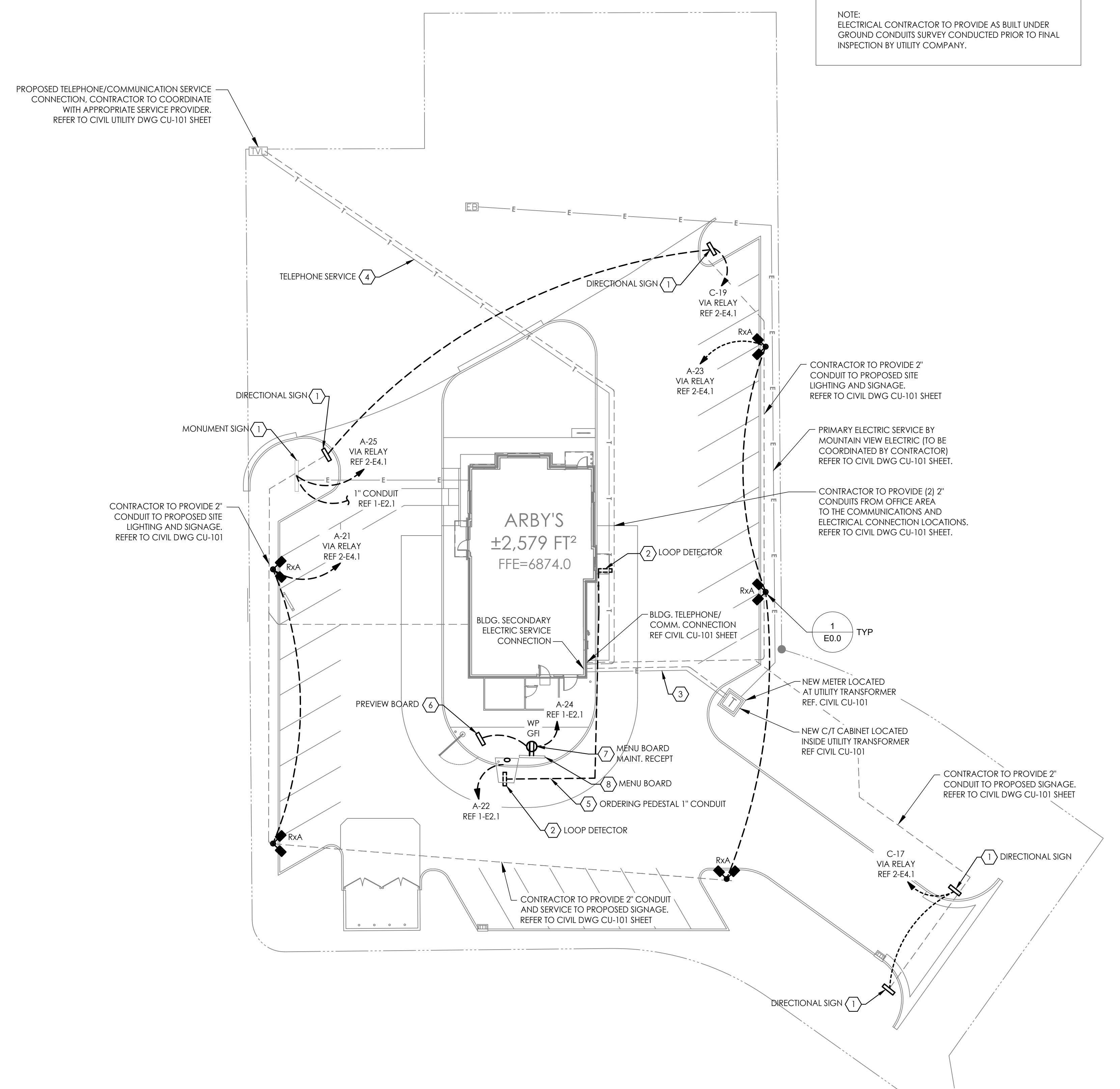

SITE LIGHTING LEGEND	
— E —	ELECTRIC SERVICE
— T —	TELEPHONE / COMMUNICATION
⬢	NEW PARKING LOT LIGHTS
⤵	CONDUIT, CONCEALED IN SLAB
⊞	NEW PYLON SIGN
⬡	DIRECTIONAL SIGN

**GENERAL NOTES:**

- CONTRACTOR SHALL HAVE A THOROUGH KNOWLEDGE OF AND PERFORM ALL WORK IN ACCORDANCE WITH ALL APPLICABLE LOCAL, STATE, AND NATIONAL CODES AND MANUFACTURERS' RECOMMENDATIONS.

**CODED NOTES: #**

- COORDINATE SIGN LOCATIONS WITH SIGN CONTRACTOR. VERIFY CONNECTION REQUIREMENTS. CIRCUITS SHALL BE ROUTED THROUGH CONTACTOR "C4" CONTROLLED BY SWITCH "F". RE: 2/E-2. CONTRACTOR TO RUN 1" EMPTY CONDUIT WITH PULL STRING TERMINATED AT DESK MANGER RE: 1/E-3. FOR PYLON SIGN.
- CONTRACTOR SHALL INSTALL OWNER PROVIDED LOOP DETECTOR'S, 2" BELOW FINISH GRADE OF CONCRETE AT DRIVE THRU SPEAKER POST AND DRIVE THRU WINDOW.
- (2) 4" SCHEDULE 40 PVC SECONDARY CONDUIT WITH PULLSTRING FROM POINT OF CONNECTION VERIFY EXACT LOCATION AND REQUIREMENTS WITH UTILITY COMPANY BEFORE WORK. UTILITY CO. CONTACT: DAVID PAULK\_AEP (888)-216-3523/(405)-222-7636: 1/E-4. AND CIVIL PLAN FOR ADDITIONAL INFORMATION AND COORDINATION.
- TELEPHONE SERVICE ENTRANCE: PROVIDE (1) 2" SCHEDULE 40 PVC CONDUIT 24" BELOW FINISHED GRADE WITH PULL STRING. CONTRACTOR SHALL COORDINATE ALL TELEPHONE COMPANY REQUIREMENTS WITH TELEPHONE COMPANY PRIOR TO BID. PROVIDE ALL MATERIAL AND FURNISH ALL LABOR NECESSARY TO COMPLY WITH TELEPHONE COMPANY REQUIREMENTS. REFER TO CIVIL PLAN FOR CONTINUATION OF CONNECTION
- PROVIDE (1) 1 1/2" SCHEDULE 40 PVC CONDUIT 24" BELOW FINISHED GRADE WITH PULL STRING TO ORDERING PEDESTAL FOR MENU BOARD COMMUNICATION SYSTEM. RE:1/E-3.
- BRANCH CIRCUIT CONTINUATION TO PREVIEW BOARD. COORDINATE SIGN LOCATION WITH SIGN CONTRACTOR. VERIFY CONNECTION REQUIREMENTS.
- INSTALL WEATHER PROOF (GFI) MAINTENANCE RECEPTACLE ON BACK SIDE OF MENU BOARD. RECEPTACLE TO BE CIRCUITED WITH MENU BOARD.
- COORDINATE MENU BOARD AND PREVIEW BOARD(S) WITH SIGN CONTRACTOR. CIRCUIT SHALL BE CONTROLLED BY SWITCH "J". RE: 2/E-2

**SITE LIGHTING PLAN - ELECTRICAL**

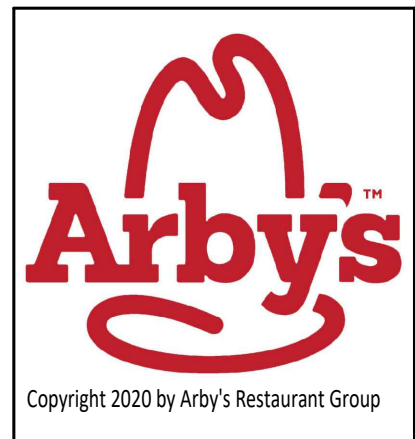
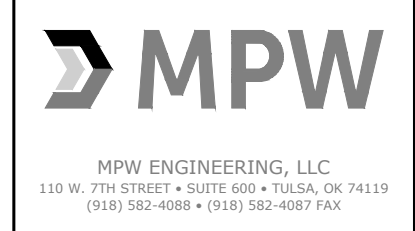
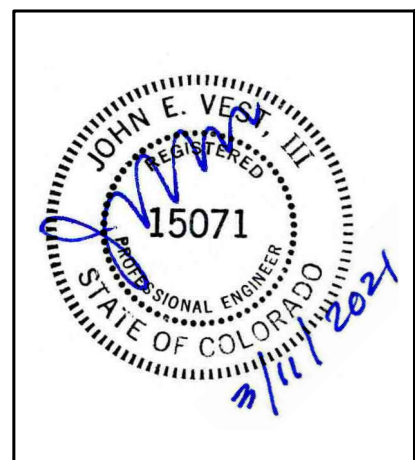

**NEW RESTAURANT FOR:**  
**ARBY'S - INSPIRE DUAL HIGH 40 - STD**  
 11775 MERIDIAN MARKET VIEW  
 FALCON, CO  
 FOR  
 RB AMERICAN GROUP  
 6200 OAK TREE BLVD, INDEPENDENCE, OH 44131

ISSUE	DATE
PRELIMINARY	
PERMIT	
BID	
REVISION	01-25-2021
	03-11-2021

SITE LIGHTING ELECTRICAL PLAN

SHEET:  
**E1.0**