



**Vertex Consulting Services, LLC**  
455 Pikes Peak Avenue, Suite 101  
Colorado Springs, CO 80903-3672  
719-733-8605

February 2, 2023

**RE: Kershman Minor Subdivision**

Dear Adjacent Neighbor:

This letter is being sent to you because Jacob & Sherry Kershman are proposing a land use project in El Paso County at the referenced location (see below). This information is being provided to you prior to a submittal with the County. Please direct any questions on the proposal to the referenced contact below. Prior to any public hearing on this proposal a notification of the time and place of the public hearing will be sent to the adjacent property owners by the El Paso County Planning and Community Development Department. At that time, you will be given the El Paso County contact information, the file number and an opportunity to respond either for, against, or expressing no opinion in writing at the public hearing for this proposal.

For questions specific to this project, please contact:

Vertex Consulting Services, Nina Ruiz  
455 E Pikes Peak Avenue, Suite 101  
Colorado Springs, CO 80903  
Nina.ruiz@vertexcscos.com  
719-733-8605

Request: The purpose of this application is to request approval of a map amendment (rezone) to the RR-2.5 zoning district and a four-lot minor subdivision. Please contact Nina Ruiz regarding any concerns or suggestions you may have (contact above).

Site location:

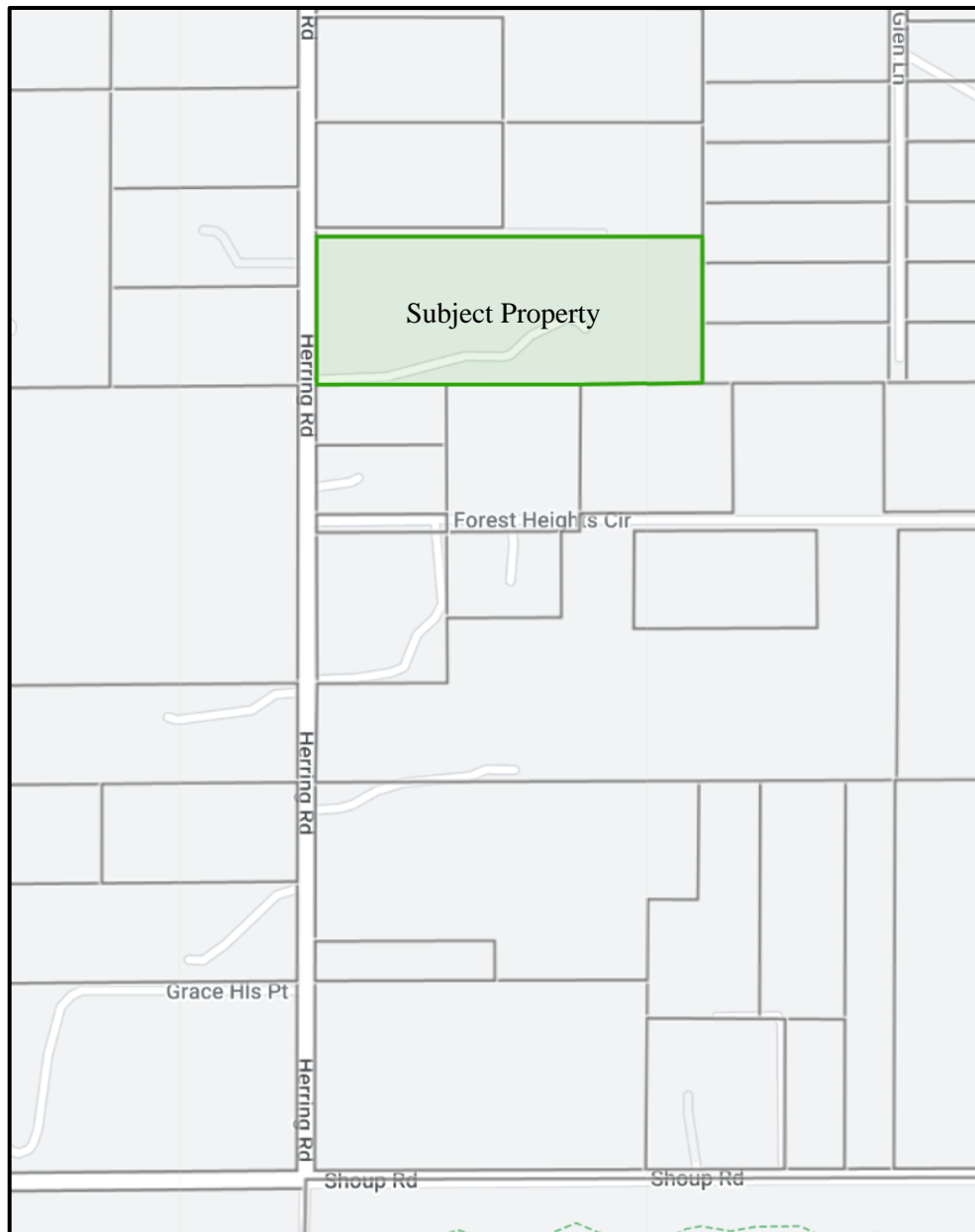

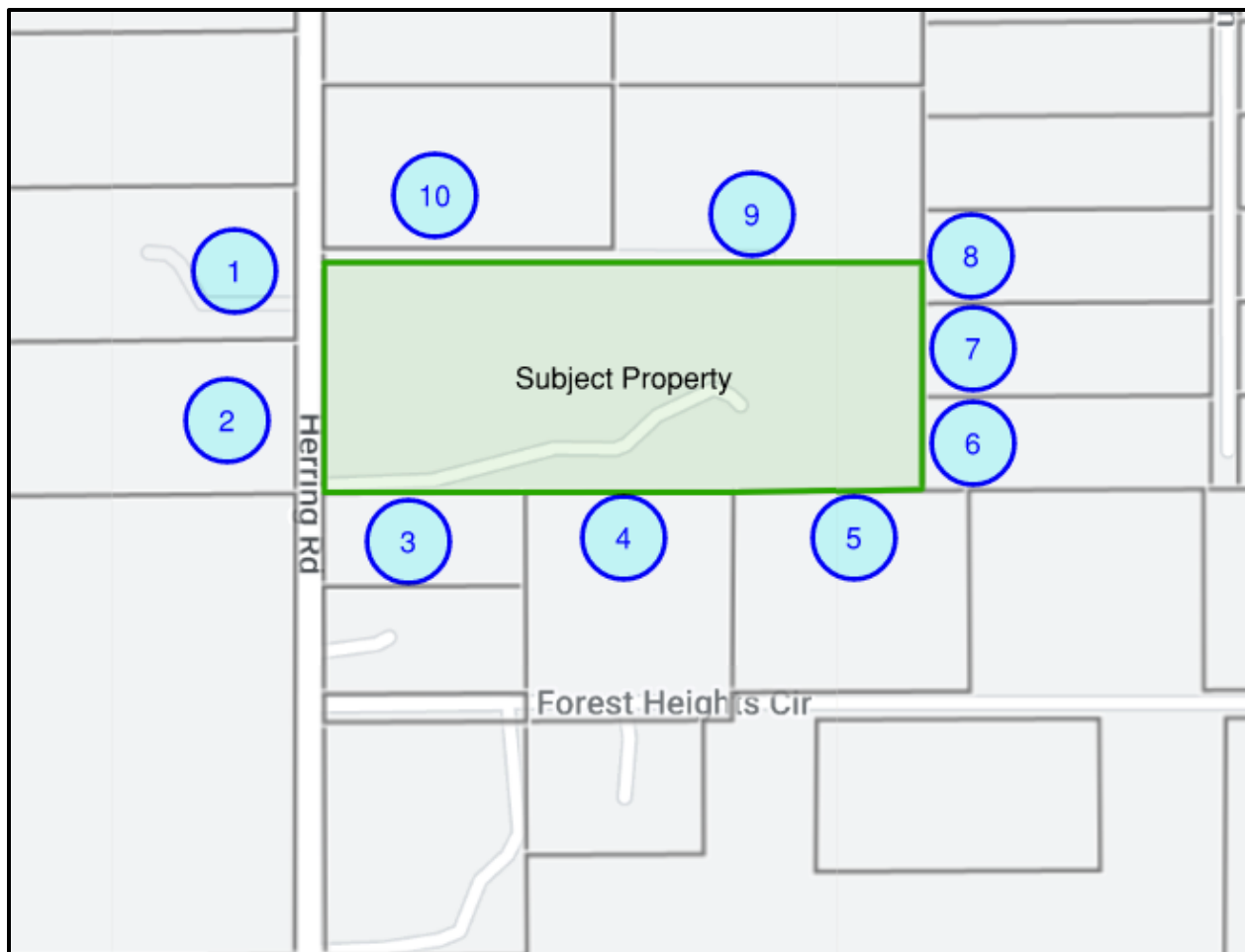

1. Jace Turner & Marie Robertson, PO Box 88015, Colorado Springs, CO 80908
2. Theresa & Richard Strader, 13030 Herring Road, Colorado Springs, CO 80908
3. Shane & Juanice Self, 12975 Herring Road, Colorado Springs, CO 80908
4. Frederick Yonce, 7940 Forest Heights Circle, Colorado Springs, CO 80908
5. Leilani Ritchie, 7960 Forest Heights Circle, Colorado Springs, CO 80908
6. Benjamin & Eileen Malcolm, 12030 Meadow Glen Lane, Colorado Springs, CO 80908
7. Kevin & Elizabeth McNamara, 13070 Meadow Glen Lane, Colorado Springs, CO 80908
8. Chad & Heather Rainey, 13110 Meadow Glen Lane, Colorado Springs, CO 80908
9. Lockhart Survivors Trust, 13145 Herring Road, Colorado Springs, CO 80908
10. Lockhart Survivors Trust, 13145 Herring Road, Colorado Springs, CO 80908

U.S. Postal Service<sup>™</sup>  
CERTIFIED MAIL<sup>®</sup> RECEIPT  
Domestic Mail Only

For delivery information, visit our website at [www.usps.com](http://www.usps.com)<sup>®</sup>.

**OFFICIAL USE**

Certified Mail Fee \$

Extra Services & Fees (check box, add fee as appropriate)

<input type="checkbox"/> Return Receipt (hardcopy)	\$
<input type="checkbox"/> Return Receipt (electronic)	\$
<input type="checkbox"/> Certified Mail Restricted Delivery	\$
<input type="checkbox"/> Adult Signature Required	\$
<input type="checkbox"/> Adult Signature Restricted Delivery	\$

Postage \$

Total Postage and Fees \$

Sent To Lockhart Springs Trout

Street and Apt. No., or PO Box No. 1345 Herring Rd

City, State, ZIP+4<sup>®</sup> CO 80908

PS Form 3800, April 2015 PSN 7530-02-000-9047 See Reverse for Instructions

2489 426E 0000 0142 2202

U.S. Postal Service<sup>™</sup>  
CERTIFIED MAIL<sup>®</sup> RECEIPT  
Domestic Mail Only

For delivery information, visit our website at [www.usps.com](http://www.usps.com)<sup>®</sup>.

**OFFICIAL USE**

Certified Mail Fee \$

Extra Services & Fees (check box, add fee as appropriate)

<input type="checkbox"/> Return Receipt (hardcopy)	\$
<input type="checkbox"/> Return Receipt (electronic)	\$
<input type="checkbox"/> Certified Mail Restricted Delivery	\$
<input type="checkbox"/> Adult Signature Required	\$
<input type="checkbox"/> Adult Signature Restricted Delivery	\$

Postage \$

Total Postage and Fees \$

Sent To Shane + Joanne Self

Street and Apt. No., or PO Box No. 12975 Herring Rd

City, State, ZIP+4<sup>®</sup> CO 80908

PS Form 3800, April 2015 PSN 7530-02-000-9047 See Reverse for Instructions

5964 E206 0000 0297 2202

U.S. Postal Service<sup>™</sup>  
CERTIFIED MAIL<sup>®</sup> RECEIPT  
Domestic Mail Only

For delivery information, visit our website at [www.usps.com](http://www.usps.com)<sup>®</sup>.

**OFFICIAL USE**

Certified Mail Fee \$

Extra Services & Fees (check box, add fee as appropriate)

<input type="checkbox"/> Return Receipt (hardcopy)	\$
<input type="checkbox"/> Return Receipt (electronic)	\$
<input type="checkbox"/> Certified Mail Restricted Delivery	\$
<input type="checkbox"/> Adult Signature Required	\$
<input type="checkbox"/> Adult Signature Restricted Delivery	\$

Postage \$

Total Postage and Fees \$

Sent To Frederick Yone

Street and Apt. No., or PO Box No. 7940 Forest Hills Cir

City, State, ZIP+4<sup>®</sup> CO 80908

PS Form 3800, April 2015 PSN 7530-02-000-9047 See Reverse for Instructions

2664 E206 0000 0297 2202



U.S. Postal Service<sup>TM</sup>  
CERTIFIED MAIL<sup>®</sup> RECEIPT  
Domestic Mail Only

For delivery information, visit our website at [www.usps.com](http://www.usps.com).

**OFFICIAL USE**

Certified Mail Fee \$  
Extra Services & Fees (check box, add fee as appropriate)  
☐ Return Receipt (hardcopy) \$  
☐ Return Receipt (electronic) \$  
☐ Certified Mail Restricted Delivery \$  
☐ Adult Signature Required \$  
☐ Adult Signature Restricted Delivery \$  
Postage \$  
Total Postage and Fees \$  
Sent To Joe Turner + Marie Robertson  
Street and Apt. No., or PO Box No. PO Box 88013  
City, State, ZIP+4<sup>®</sup> Colorado Springs, CO 80908

PS Form 3800, April 2015 PSN 7530-02-000-9047  
See Reverse for Instructions

U.S. Postal Service<sup>TM</sup>  
CERTIFIED MAIL<sup>®</sup> RECEIPT  
Domestic Mail Only

For delivery information, visit our website at [www.usps.com](http://www.usps.com).

**OFFICIAL USE**

Certified Mail Fee \$  
Extra Services & Fees (check box, add fee as appropriate)  
☐ Return Receipt (hardcopy) \$  
☐ Return Receipt (electronic) \$  
☐ Certified Mail Restricted Delivery \$  
☐ Adult Signature Required \$  
☐ Adult Signature Restricted Delivery \$  
Postage \$  
Total Postage and Fees \$  
Sent To Theresa + Richard Strader  
Street and Apt. No., or PO Box No. 13030 Henry Rd  
City, State, ZIP+4<sup>®</sup> Colorado Springs, CO 80908

PS Form 3800, April 2015 PSN 7530-02-000-9047  
See Reverse for Instructions

U.S. Postal Service<sup>TM</sup>  
CERTIFIED MAIL<sup>®</sup> RECEIPT  
Domestic Mail Only

U.S. Postal Service<sup>TM</sup>  
CERTIFIED MAIL<sup>®</sup> RECEIPT  
Domestic Mail Only

For delivery information, visit our website at [www.usps.com](http://www.usps.com).

**OFFICIAL USE**

Certified Mail Fee \$  
Extra Services & Fees (check box, add fee as appropriate)  
☐ Return Receipt (hardcopy) \$  
☐ Return Receipt (electronic) \$  
☐ Certified Mail Restricted Delivery \$  
☐ Adult Signature Required \$  
☐ Adult Signature Restricted Delivery \$  
Postage \$  
Total Postage and Fees \$  
Sent To Benjamin + Eileen Malcolm  
Street and Apt. No., or PO Box No. 17030 Meadows Glen Ln  
City, State, ZIP+4<sup>®</sup> Colorado Springs, CO 80908

PS Form 3800, April 2015 PSN 7530-02-000-9047  
See Reverse for Instructions

U.S. Postal Service<sup>TM</sup>  
CERTIFIED MAIL<sup>®</sup> RECEIPT  
Domestic Mail Only

For delivery information, visit our website at [www.usps.com](http://www.usps.com).

**OFFICIAL USE**

Certified Mail Fee \$  
Extra Services & Fees (check box, add fee as appropriate)  
☐ Return Receipt (hardcopy) \$  
☐ Return Receipt (electronic) \$  
☐ Certified Mail Restricted Delivery \$  
☐ Adult Signature Required \$  
☐ Adult Signature Restricted Delivery \$  
Postage \$  
Total Postage and Fees \$  
Sent To Lillian Richter  
Street and Apt. No., or PO Box No. 7960 Forest Hills Circle  
City, State, ZIP+4<sup>®</sup> Colorado Springs, CO 80908

PS Form 3800, April 2015 PSN 7530-02-000-9047  
See Reverse for Instructions

U.S. Postal Service<sup>TM</sup>  
CERTIFIED MAIL<sup>®</sup> RECEIPT  
Domestic Mail Only

U.S. Postal Service<sup>TM</sup>  
CERTIFIED MAIL<sup>®</sup> RECEIPT  
Domestic Mail Only

For delivery information, visit our website at [www.usps.com](http://www.usps.com).

**OFFICIAL USE**

Certified Mail Fee \$  
Extra Services & Fees (check box, add fee as appropriate)  
☐ Return Receipt (hardcopy) \$  
☐ Return Receipt (electronic) \$  
☐ Certified Mail Restricted Delivery \$  
☐ Adult Signature Required \$  
☐ Adult Signature Restricted Delivery \$  
Postage \$  
Total Postage and Fees \$  
Sent To Chad + Heather Ramey  
Street and Apt. No., or PO Box No. 13110 Meadows Glen Lane  
City, State, ZIP+4<sup>®</sup> Colorado Springs, CO 80908

PS Form 3800, April 2015 PSN 7530-02-000-9047  
See Reverse for Instructions

U.S. Postal Service<sup>TM</sup>  
CERTIFIED MAIL<sup>®</sup> RECEIPT  
Domestic Mail Only

For delivery information, visit our website at [www.usps.com](http://www.usps.com).

**OFFICIAL USE**

Certified Mail Fee \$  
Extra Services & Fees (check box, add fee as appropriate)  
☐ Return Receipt (hardcopy) \$  
☐ Return Receipt (electronic) \$  
☐ Certified Mail Restricted Delivery \$  
☐ Adult Signature Required \$  
☐ Adult Signature Restricted Delivery \$  
Postage \$  
Total Postage and Fees \$  
Sent To Kenn + Elizabeth McNertney  
Street and Apt. No., or PO Box No. 13010 Meadows Glen Ln  
City, State, ZIP+4<sup>®</sup> Colorado Springs, CO 80908

PS Form 3800, April 2015 PSN 7530-02-000-9047  
See Reverse for Instructions

U.S. Postal Service<sup>TM</sup>  
CERTIFIED MAIL<sup>®</sup> RECEIPT  
Domestic Mail Only