

**BRAKES PLUS**  
**SITE DEVELOPMENT PLAN**  
**2467 MARKSHEFFEL ROAD**

SITUATED IN A PORTION OF THE NORTHWEST QUARTER OF SECTION 4, TOWNSHIP 14 SOUTH, RANGE 65 WEST  
OF THE 6TH P.M., COUNTY OF EL PASO, STATE OF COLORADO

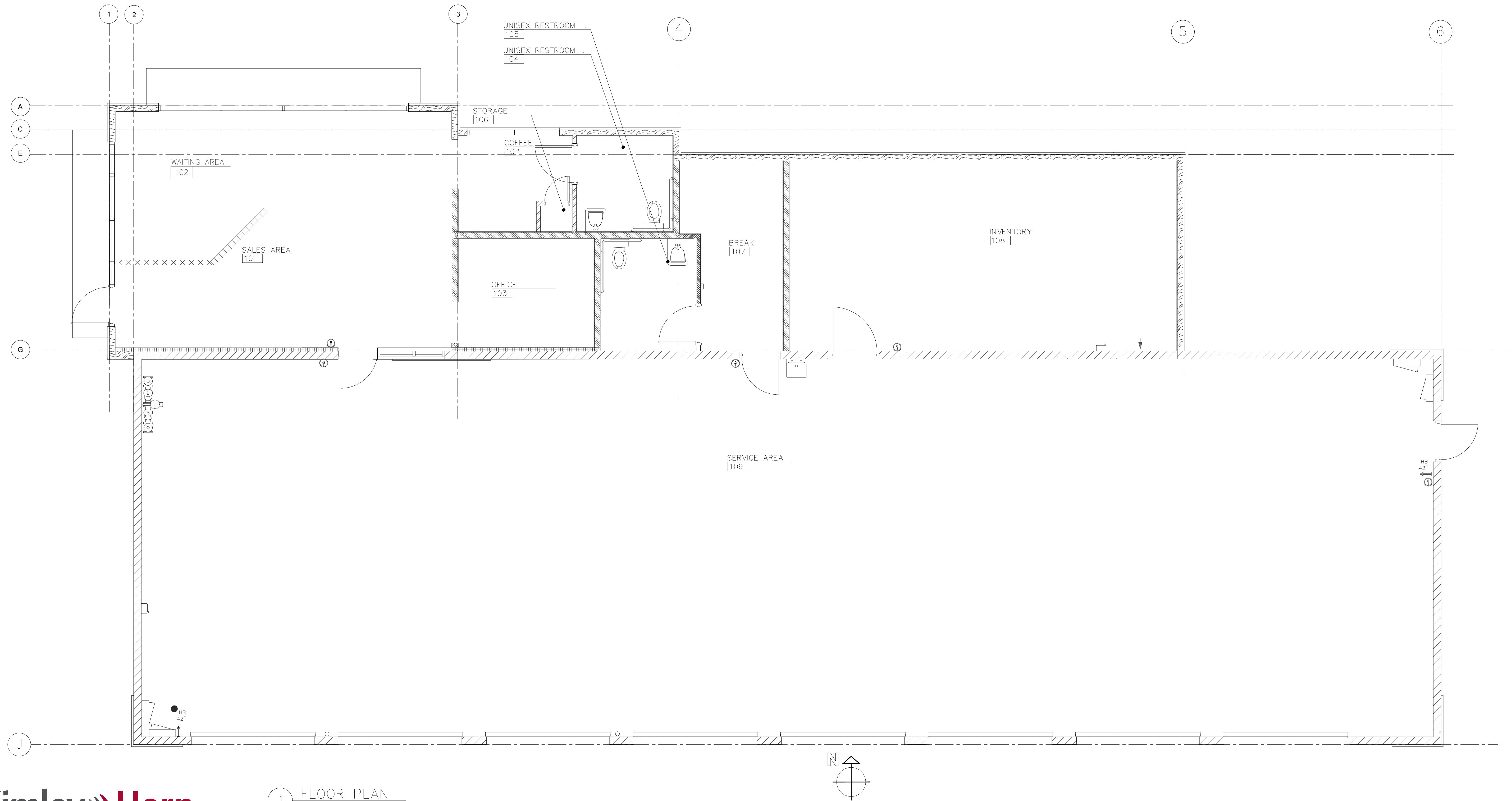

1 FLOOR PLAN  
SCALE: 1/4" = 1'-0"