

Erosion and Stormwater Quality Control Permit_V1.pdf Markup Summary

7/15/2022 2:53:03 PM (1)

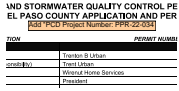

Subject: Engineer
Page Label: 1
Author: dotprete
Date: 7/15/2022 2:53:03 PM
Status:
Color: ■
Layer:
Space:

Add "PCD Project Number: PPR-22-034

7/15/2022 2:53:11 PM (1)

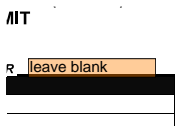

Subject: Engineer
Page Label: 1
Author: dotprete
Date: 7/15/2022 2:53:11 PM
Status:
Color: ■
Layer:
Space:

leave blank

7/15/2022 2:53:26 PM (1)

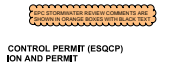

Subject: Stormwater Comments Color
Page Label: 1
Author: dotprete
Date: 7/15/2022 2:53:26 PM
Status:
Color: ■
Layer:
Space:

7/15/2022 2:54:21 PM (1)

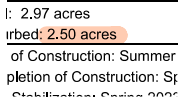

Subject: Engineer
Page Label: 2
Author: dotprete
Date: 7/15/2022 2:54:21 PM
Status:
Color: ■
Layer:
Space:

7/15/2022 2:56:07 PM (1)

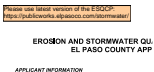

Subject: Engineer
Page Label: 1
Author: dotprete
Date: 7/15/2022 2:56:07 PM
Status:
Color: ■
Layer:
Space:

Please use latest version of the ESQCP:
<https://publicworks.elpasoco.com/stormwater/>

7/15/2022 2:56:22 PM (1)

Colorado Springs, CO 80910

Subject: Engineer
Page Label: 2

doesnt match SWMP

es. **doesnt match SWMP**

Author: dotprete

Start of Construction: Summer 2022

Date: 7/15/2022 2:56:22 PM

Completion of Construction: Spring 2023

Status:

Final Stabilization: Spring 2023

Color: ■

To develop site per plans

Layer:

Discuss purpose of building

Space:

Proposing a 17,255 sf building with 11,415 warehouse, complete with required parking

7/15/2022 2:56:28 PM (1)

Start of Construction: Summer 2022
Completion of Construction: Spring 2023
Final Stabilization: Spring 2023
To develop site per plans
Discuss purpose of building
Proposing a 17,255 sf building with 11,415 warehouse, complete with required parking

Subject: Engineer
Page Label: 2

Discuss purpose of building

Author: dotprete

Date: 7/15/2022 2:56:28 PM

Status:

Color: ■

Layer:

Space:

7/20/2022 4:26:03 PM (1)

Total: 2.97 acres

Subject: Engineer
Page Label: 2

Disturbed: 2.50 acres

Author: dotprete

Start of Construction: Summer 2022

Date: 7/20/2022 4:26:03 PM

Status:

Color: ■

Layer:

Space:

EROSION AND STORMWATER QUALITY CONTROL PERMIT (ESQCP) EL PASO COUNTY APPLICATION AND PERMIT

Add "PCD Project Number: PPR-22-034"

APPLICANT INFORMATION

PERMIT NUMBER

leave blank

Owner Information	
Owner	Trenton B Urban
Name (person of responsibility)	Trent Urban
Company/Agency	Wirenut Home Services
Position of Applicant	President
Address (physical address, not PO Box)	6365 E Platte Ave
City	Colorado Springs
State	CO
Zip Code	80915
Mailing address, if different from above	
Telephone	719-227-0500
FAX number	
Email Address	Turban@thewirenut.com
Cellular Phone number	719-227-0500
Contractor/Operator Information	
Name (person of responsibility)	Dave Hammers
Company	Hammers Construction, INC
Address (physical address, not PO Box)	1411 Woolsey Heights
City	Colorado Springs
State	CO
Zip Code	80915
Mailing address, if different from above	
Telephone	719-570-1599
FAX number	719-570-7008
Email Address	DHammers@hammersconstruction.com
Cellular Phone number	719-499-6015
Erosion Control Supervisor (ECS)*	Dave Hammers
ECS Phone number*	719-570-1599
ECS Cellular Phone number*	719-499-6015

*Required for all applicants. May be provided at later date pending securing a contract when applicable.

PROJECT INFORMATION

Project Information	
Project Name	Wirenut Home Services
Legal Description	Lot 5 Clearway
Address (or nearest major cross streets)	6365 E Platte Ave. Colorado Springs, CO 80915
Acreage (total and disturbed)	Total: 2.97 acres Disturbed: 2.50 acres doesn't match SWMP
Schedule	Start of Construction: Summer 2022 Completion of Construction: Spring 2023 Final Stabilization: Spring 2023
Project Purpose	To develop site per plans Discuss purpose of building
Description of Project	Proposing a 17, 255 sf building with 11,415 sf of office space & 5,840 sf of warehouse, complete with required parking and drive aisles.
Tax Schedule Number	54180-01-005

FOR OFFICE USE ONLY

The following signature from the ECM Administrator signifies the approval of this ESQCP. All work shall be performed in accordance with the permit, the El Paso County Engineering Criteria Manual (ECM) Standards, City of Colorado Springs Drainage Criteria Manual, Volume 2 (DCM2) as adopted by El Paso County Addendum, approved plans, and any attached conditions. The approved plans are an enforceable part of the ESQCP. Construction activity, except for the installation of initial construction BMPs is not permitted until issuance of a Construction permit and Notice to Proceed.

Signature of ECM Administrator: _____

Date _____

1.1 REQUIRED SUBMISSIONS

In addition to this completed and signed application, the following items must be submitted to obtain an ESQCP:

- Permit fees
- Stormwater Management Plan (SWMP) meeting the requirements of DCM2 and ECM either as part of the plan set or as a separate document;
- Cost estimates of construction and maintenance of construction and permanent stormwater control measures (Cost estimates shall be provided on a unit cost basis for all stormwater BMPs);
- Financial surety in an amount agreeable to the ECM Administrator based on the cost estimates of the stormwater quality protection measures provided. The financial surety shall be provided in the form of a Letter of Credit, Surety with a Bonding Company, or other forms acceptable to El Paso County;
- Operation and Maintenance Plan for any proposed permanent stormwater control measures; and
- Signed Private Detention Basin/Stormwater Quality Best Management Practice Maintenance Agreement and Easement, if any permanent stormwater control measures are to be located on site.

1.2 RESPONSIBILITY FOR DAMAGE

The County and its officers and employees, including but not limited to the ECM Administrator, shall not be answerable or accountable in any manner, for injury to or death of any person, including but not limited to a permit holder, persons employed by the permit holder, persons acting in behalf of the permit holder, or for damage to property resulting from any activities undertaken by a permit holder or under the direction of a permit holder. The permit holder shall be responsible for any liability imposed by law and for injuries to or death of any person, including but not limited to the permit holder, persons employed by the permit holder, persons acting in behalf of the permit holder, or damage to property arising out of work or other activity permitted and done by the permit holder under a permit, or arising out of the failure on the permit holder's part to perform the obligations under any permit in respect to maintenance or any other obligations, or resulting from defects or obstructions, or from any cause whatsoever during the progress of the work, or other activity, or at any subsequent time work or other activity is being performed under the obligations provided by and contemplated by the permit.

To the extent allowed by law, the permit holder shall indemnify, save, and hold harmless the County and its officers and employees, including but not limited to the BOCC and ECM Administrator, from all claims, suits or actions of every name, kind and description brought for or on account of injuries to or death of any person, including but not limited to the permit holder, persons employed by the permit holder, persons acting in behalf of the permit holder and the public, or damage to property resulting from the performance of work or other activity under the permit, or arising out of the failure on the permit holder's part to perform his obligations under any permit in respect to maintenance or any other obligations, or resulting from defects or obstructions, or from any cause whatsoever during the progress of the work, or other activity or at any subsequent time work or other activity is being performed under the obligations provided by and contemplated by the permit, except as otherwise provided by state law. The permit holder waives any and all rights to any type of expressed or implied indemnity against the County, its officers or employees.

1.3 APPLICATION CERTIFICATION

We, as the Applicants or the representative of the Applicants, hereby certify that this application is correct and complete as per the requirements presented in this application and the El Paso County Engineering Criteria Manual and Drainage Criteria Manual, Volume 2 and El Paso County Addendum.

We, as the Applicants or the representatives of the Applicants, have read and will comply with all of the requirements of the specified Stormwater Management Plan and any other documents specifying stormwater best management practices to be used on the site including permit conditions that may be required by the ECM Administrator. We understand that the stormwater control measures are to be maintained on the site and revised as necessary to protect stormwater quality as the project progresses. We further understand that a Construction Permit must be obtained and all necessary stormwater quality control measures are to be installed in accordance with the SWMP, the El Paso County Engineering Criteria Manual, Drainage Criteria Manual, Volume 2 and El Paso County Addendum before land disturbance begins and that failure to comply will result in a Stop Work Order and may result in other penalties as allowed by law. We further understand and agree to indemnify, save, and hold harmless the County and its officers and employees, including but not limited to the BOCC and ECM Administrator, from all claims, suits or actions of every name, kind and description as outlined in Section 1.2 Responsibility for Damage.

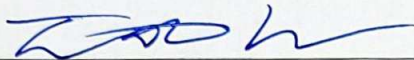

Date: 6/9/2022

Signature of Owner or Representative

Trent Urban

Print Name of Owner or Representative

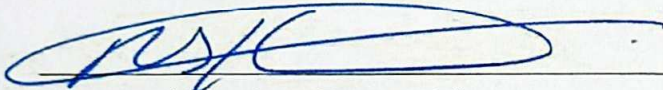

Date: 6/7/2022

Signature of Operator or Representative

Hammers Cont Inc ASE Hammers

Print Name of Operator or Representative

Permit Fee \$ _____

Surcharge \$ _____

Financial Surety \$ _____

Type of Surety _____

Total \$ _____