

LIGHT POLE LOCATION WITHIN ROUND-ABOUT ALONG RURAL MINOR COLLECTOR ROADWAY:
 CRITERIA PER ECM 4.3.5.D.2 AND TABLE 2-5 (POSTED SPEED FOR ROUND-ABOUT = 20 MPH USE DESIGN SPEED = 25 MPH)
 CLEAR ZONE WITHIN ROUND-ABOUT = 7'
 REQUIRED POLE LOCATION = 6.0' MIN. FROM EOA AND WITHIN ROW
 PROPOSED POLE LOCATION = 6.0' FROM EOA

LIGHT POLE OWNERSHIP AND RESPONSIBILITY:
 DEVELOPER RESPONSIBLE FOR COST OF POLE DESIGN AND INSTALL
 MVEA OWNS AND MAINTAINS LIGHT POLES UPON INSTALL
 LOCAL DISTRICT/HOA RESPONSIBLE FOR LIGHT POLE ELECTRICITY COSTS

MAIL KIOSK PULL-OFF 3 (SEE DETAIL BELOW)

FUTURE PARK/OPEN SPACE

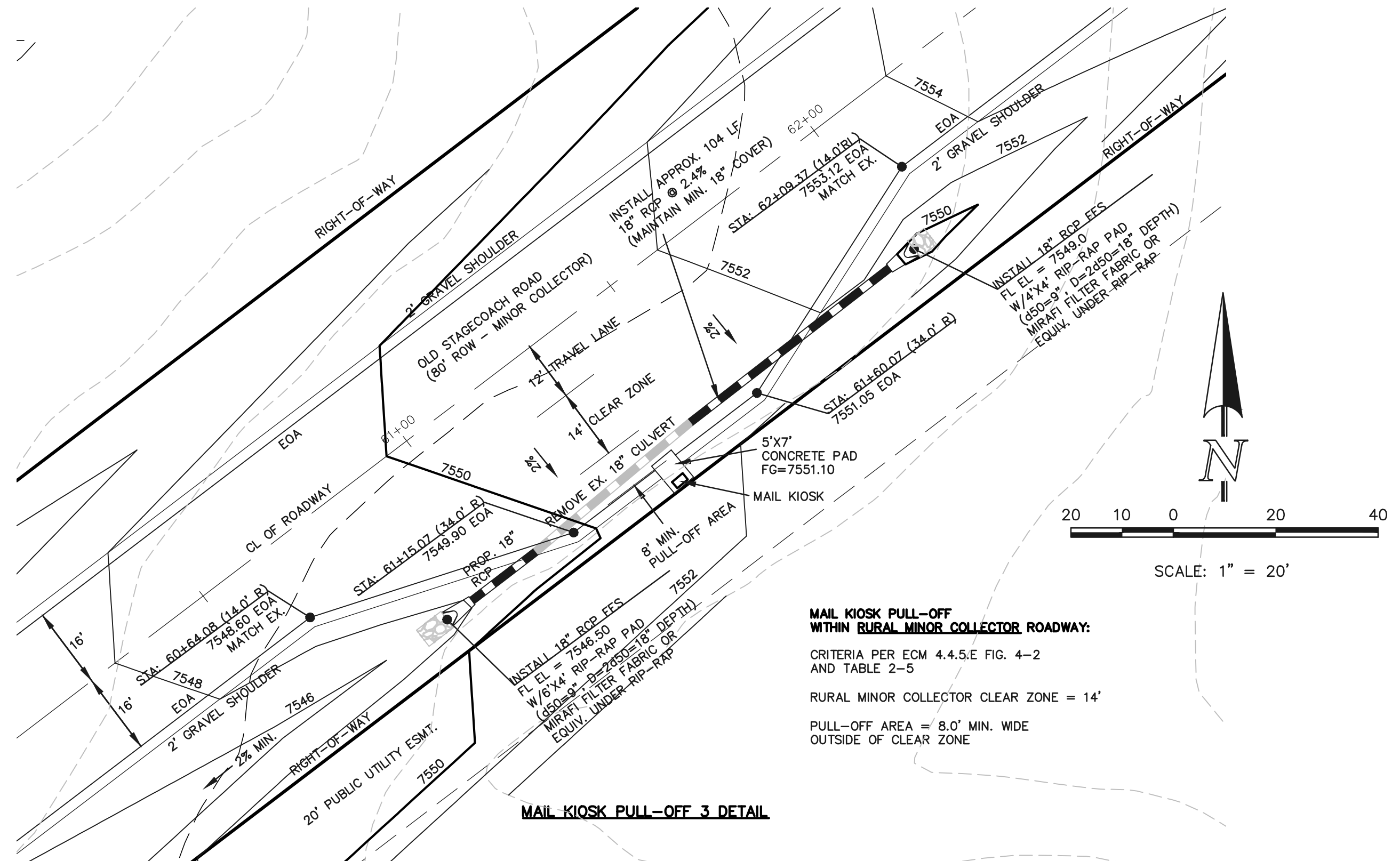

MAIL KIOSK PULL-OFF WITHIN RURAL MINOR COLLECTOR ROADWAY:
 CRITERIA PER ECM 4.4.5.E FIG. 4-2 AND TABLE 2-5
 RURAL MINOR COLLECTOR CLEAR ZONE = 14'
 PULL-OFF AREA = 8.0' MIN. WIDE OUTSIDE OF CLEAR ZONE

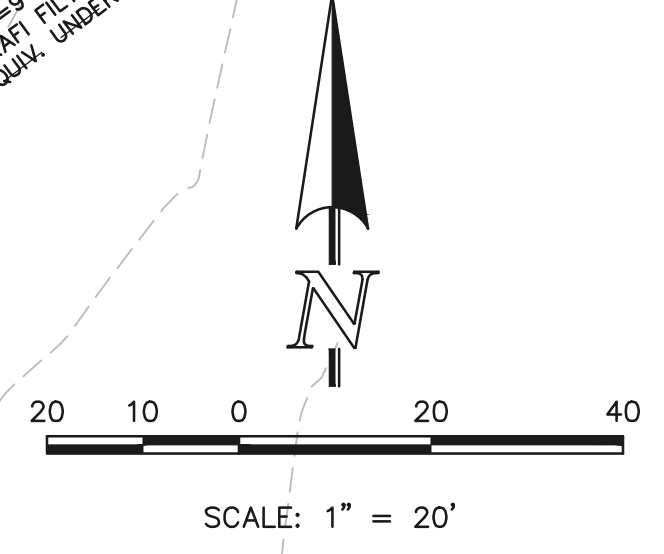

48 HOURS BEFORE YOU DIG,
 CALL UTILITY LOCATORS
811
 UTILITY NOTIFICATION CENTER OF COLORADO
 IT'S THE LAW
 THE LOCATIONS OF EXISTING UNDERGROUND UTILITIES ARE SHOWN IN AN APPROXIMATE WAY ONLY. THE CONTRACTOR SHALL DETERMINE THE EXACT LOCATION OF ALL EXISTING UTILITIES BEFORE COMMENCING WORK. THE CONTRACTOR SHALL BE FULLY RESPONSIBLE FOR ANY AND ALL DAMAGES WHICH MIGHT BE CAUSED BY HIS FAILURE TO EXACTLY LOCATE AND PRESERVE ANY AND ALL UNDERGROUND UTILITIES.

NO.	REVISION	DATE
1	REVISED PER COUNTY COMMENTS	9/16/20

REVIEW:
 PREPARED UNDER MY DIRECT SUPERVISION FOR AND ON BEHALF OF CLASSIC CONSULTING ENGINEERS AND SURVEYORS, LLC
 9/29/2020
 MARC A. WHORTON, COLORADO P.E. #37155 DATE

CLASSIC
 CONSULTING ENGINEERS & SURVEYORS
 619 N. Cascade Avenue, Suite 200
 Colorado Springs, Colorado 80903
 (719)785-0790
 (719)785-0799(fax)

FLYING HORSE NORTH FILING NO. 1
 CONSTRUCTION DRAWINGS
 LIGHT POLE & MAIL KIOSK LOCATION PLAN

DESIGNED BY	MAW	SCALE	DATE	04-14-20
DRAWN BY	MAW	(H) 1" = 200'	SHEET	3 OF 3
CHECKED BY		(V) 1" = N/A	JOB NO.	1096.11

N:\109611\DRAWINGS\CONSTRUCTION\LIGHT_POLES.dwg, 9/29/2020 2:00:14 PM, 1:1