

POSTING REQUIREMENTS

File Number: SP-17-012 + SF-18-001

Post by Date: ~~7/30/18~~ ~~8/13/18~~ 8/21/18

Planner: N. Ruez

Posting Location – See Vicinity Map

Posted by: (Circle One) Mindy Michael Joe Drew **Nina**

Date Posted: 8/21/18

Return to Planner indicated above after posting of site.

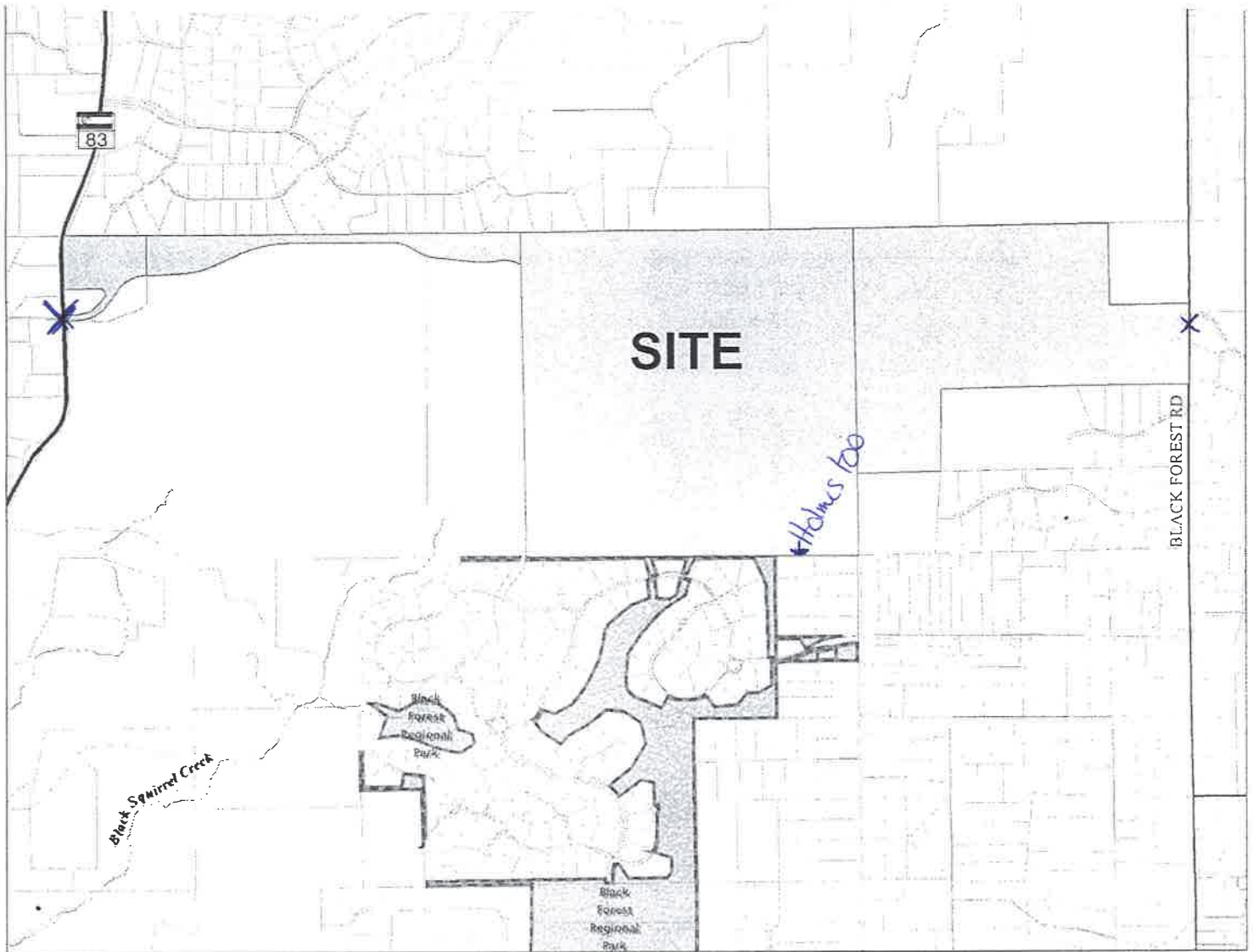

Please report any parcel discrepancies to:
El Paso County Assessor
1675 W Garden of the Gods Rd.
Colorado Springs, CO 80907
(719) 520-6600



COPYRIGHT 2017 by the Board of County Commissioners, El Paso County, Colorado. All rights reserved. No part of this document or data contained hereon may be reproduced, used to prepare derivative products, or distributed without the specific written approval of the Board of County Commissioners, El Paso County, Colorado. This document was prepared from the best data available at the time of printing. El Paso County, Colorado, makes no claim as to the completeness or accuracy of the data contained hereon.



NOTICE
[Illegible text]

[Illegible text]

[Illegible text]

City of...
[Illegible text]





Yellow sign with illegible text.

ACCOMMODATIONS
RESTAURANT