

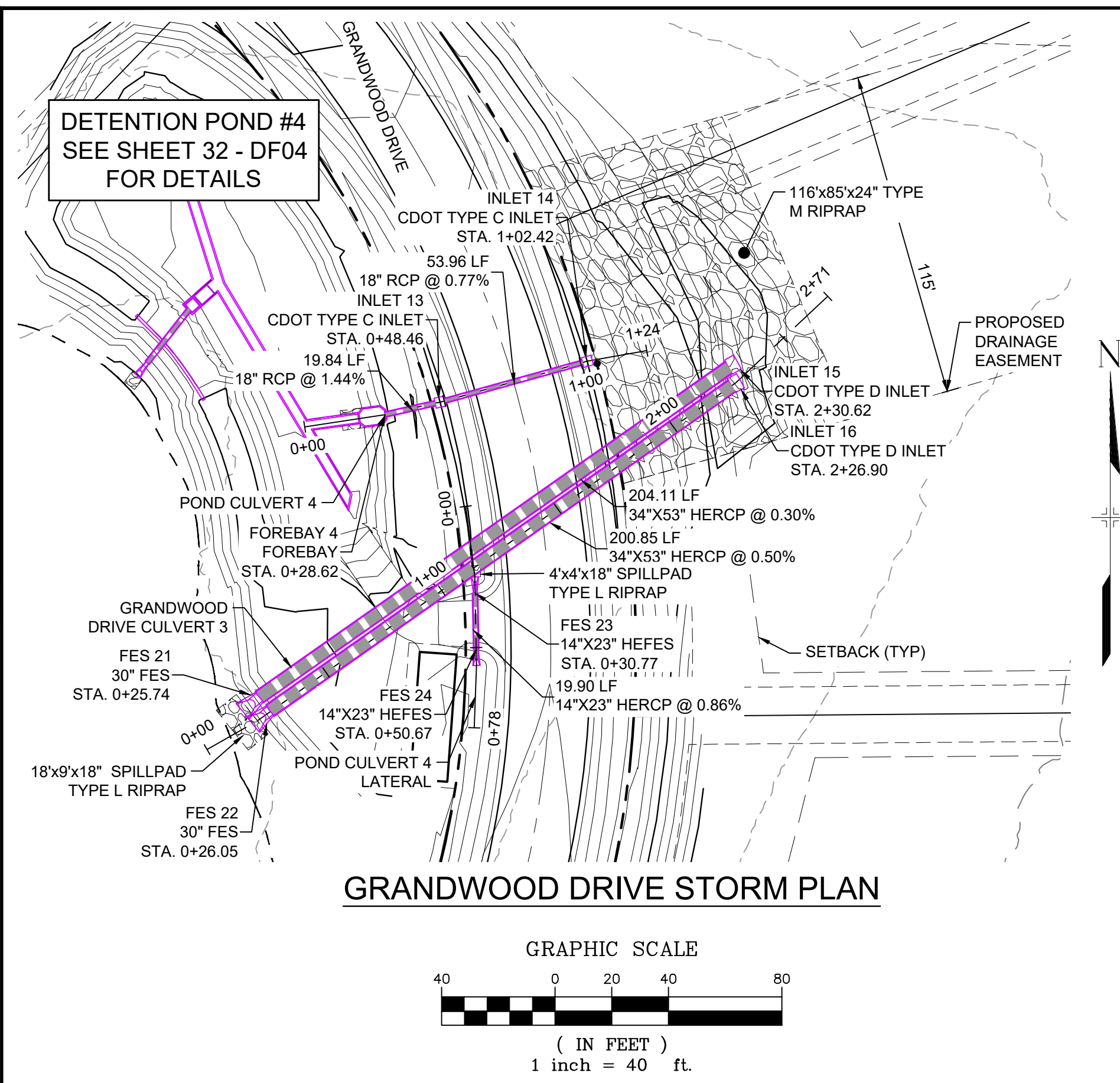

Know what's below. Call before you dig.

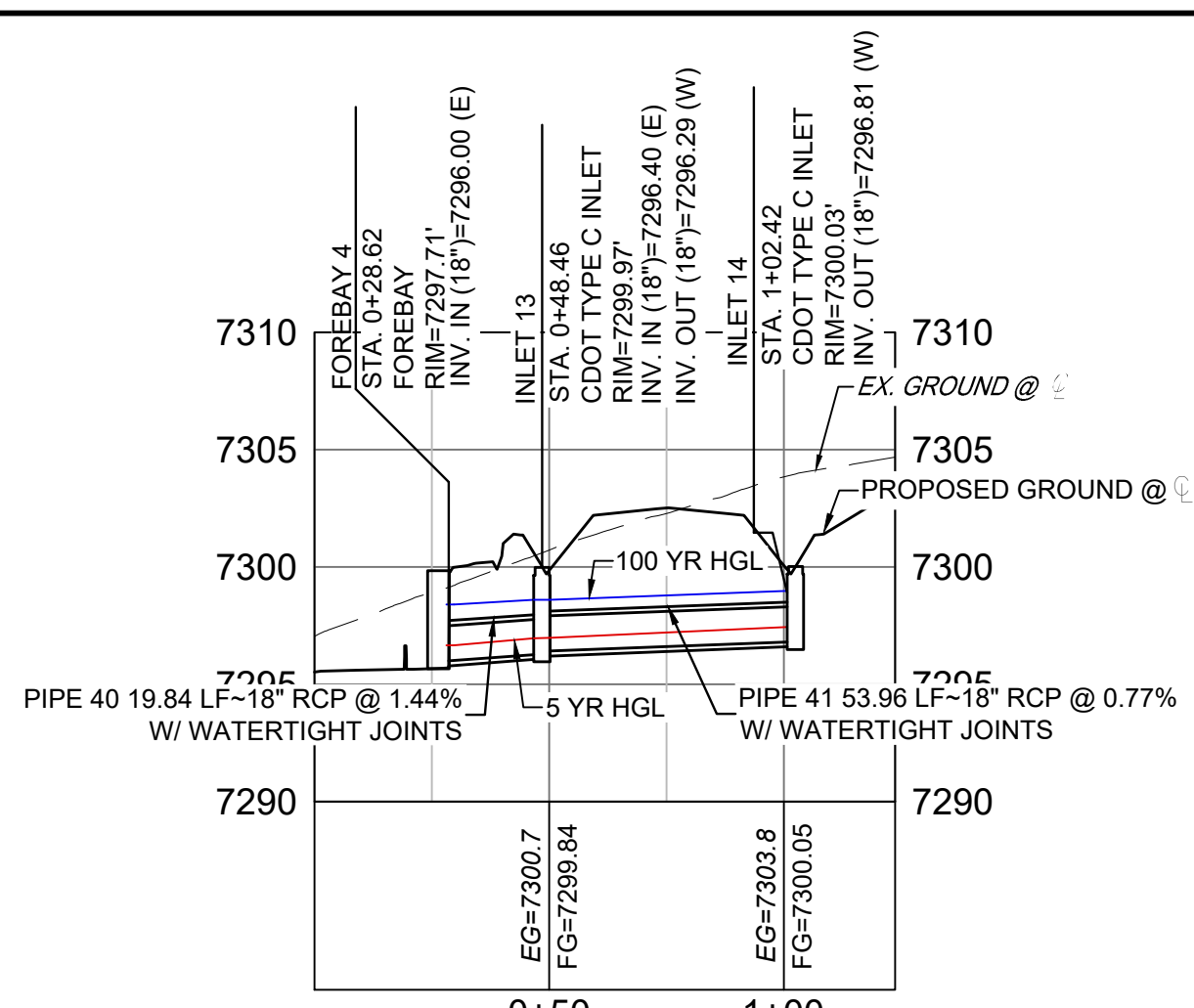

GRANDWOOD DRIVE STORM PLAN

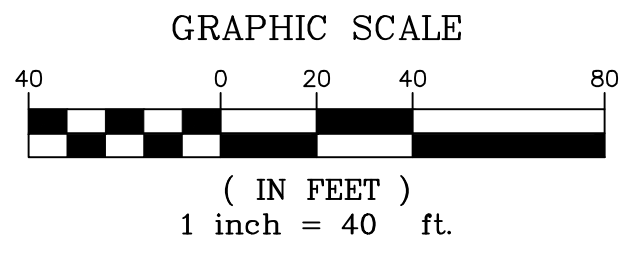

POND STORM CULVERT 4 PROFILE

HORIZ: 1" = 40' VERT: 1" = 8'

PIPE TABLE				
NAME	SIZE	LENGTH	SLOPE	BEARING
PIPE 40	18" RCP	19.84	1.44%	S77°12'09"W
PIPE 41	18" RCP	53.96	0.77%	S74°30'29"W

STRUCTURE TABLE				
NAME	TYPE	DETAILS	N&E	
FOREBAY 4	FOREBAY	RIM = 7297.71 PIPE 40 INV IN = 7296.00	N: 1454896.05 E: 3194585.07	
INLET 13	CDOT TYPE C INLET	RIM = 7299.97 PIPE 41 INV IN = 7296.40 PIPE 40 INV OUT = 7296.29	N: 1454900.44 E: 3194604.42	
INLET 14	CDOT TYPE C INLET	RIM = 7300.03 PIPE 41 INV OUT = 7296.81	N: 1454914.85 E: 3194604.42	

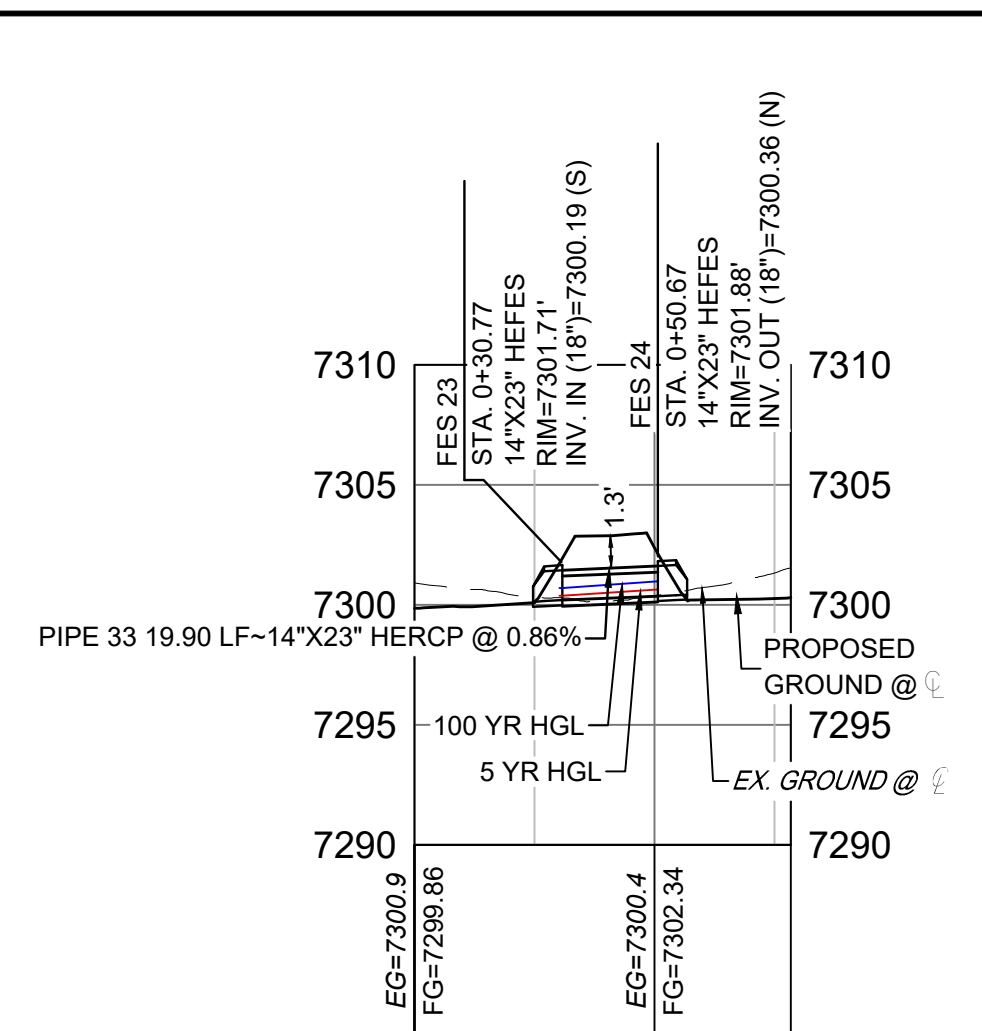

POND STORM CULVERT 4 LATERAL PROFILE

HORIZ: 1" = 40' VERT: 1" = 8'

STRUCTURE TABLE				
NAME	TYPE	DETAILS	N&E	
FES 23	14"X23" HEFES	PIPE 33 RIM = 7301.71 INV IN = 7300.19	N: 1454833.14 E: 3194616.86	
FES 24	14"X23" HEFES	PIPE 33 RIM = 7301.88 INV OUT = 7300.36	N: 1454813.24 E: 3194617.21	

PIPE TABLE				
NAME	SIZE	LENGTH	SLOPE	BEARING
PIPE 33	14"X23" HERCP	19.90	0.86%	N01°00'07"W

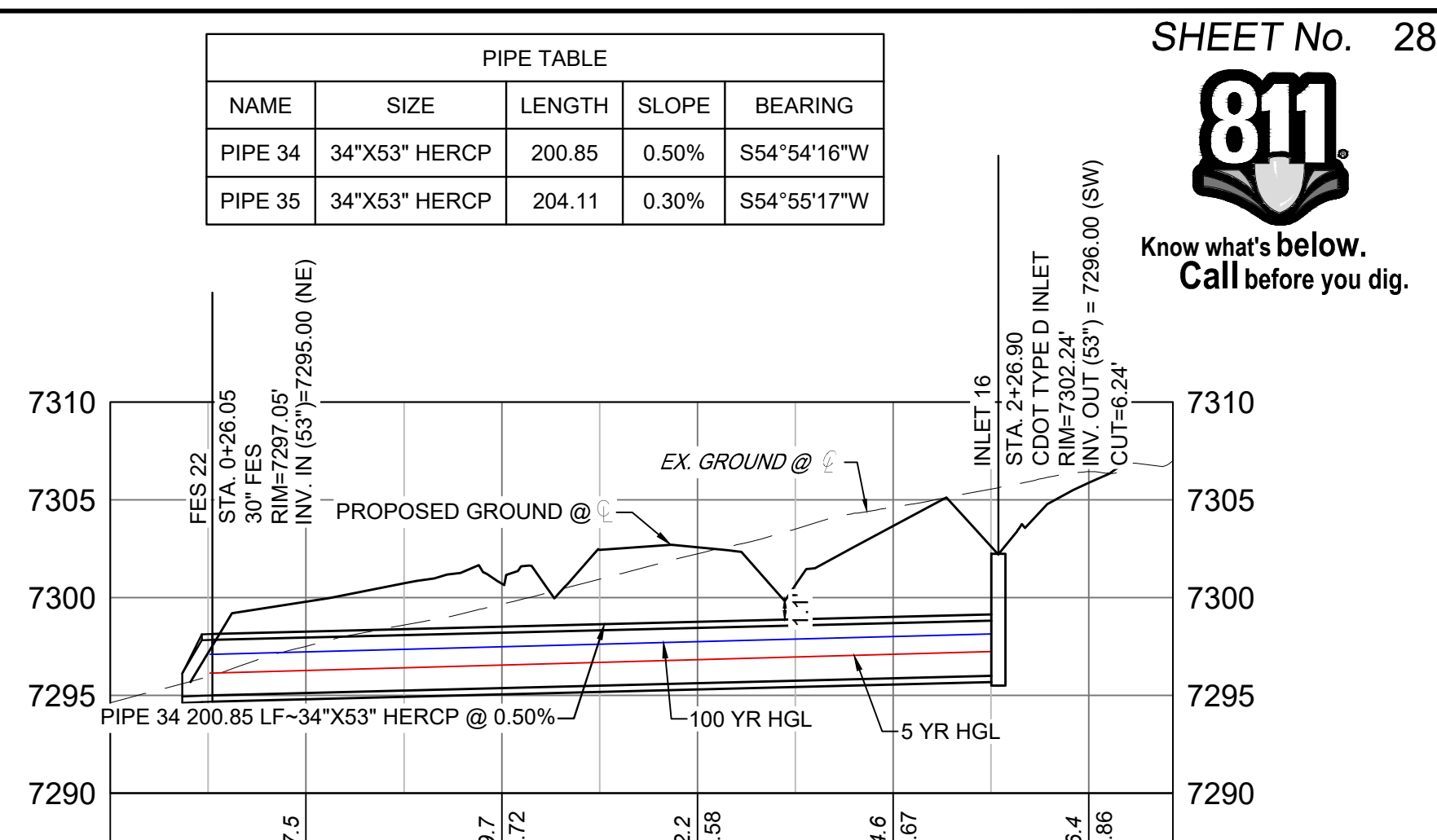

GRANDWOOD DRIVE STORM CULVERT 3 PROFILE

HORIZ: 1" = 40' VERT: 1" = 8'

STRUCTURE TABLE				
NAME	TYPE	DETAILS	N&E	
FES 21	30" FES	PIPE 35 RIM = 7298.93 INV IN = 7295.00	N: 1454796.38 E: 3194540.72	
FES 22	30" FES	PIPE 34 RIM = 7297.05 INV IN = 7295.00	N: 1454913.65 E: 3194544.45	
INLET 15	CDOT TYPE D INLET	PIPE 35 RIM = 7302.24 INV IN = 7295.61	N: 1454913.68 E: 3194707.76	
INLET 16	CDOT TYPE D INLET	PIPE 34 RIM = 7302.24 INV OUT = 7296.00	N: 1454907.12 E: 3194708.79	

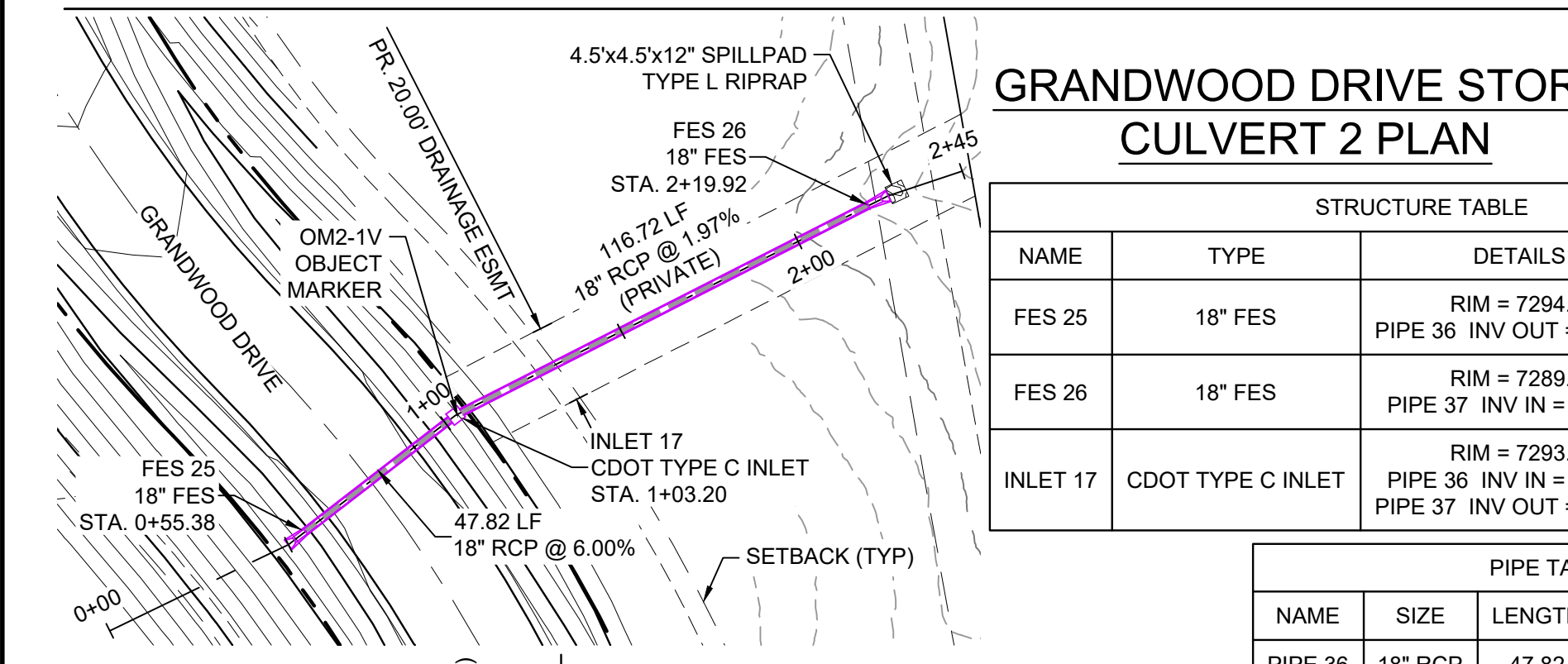

GRANDWOOD DRIVE STORM CULVERT 2 PLAN

STRUCTURE TABLE				
NAME	TYPE	DETAILS	N&E	
FES 25	18" FES	PIPE 36 RIM = 7294.29 INV OUT = 7292.95	N: 1455049.48 E: 3194002.25	
FES 26	18" FES	PIPE 37 RIM = 7289.47 INV IN = 7287.68	N: 1454907.63 E: 3194084.45	
INLET 17	CDOT TYPE C INLET	PIPE 36 RIM = 7293.46 INV IN = 7290.08 PIPE 37 INV OUT = 7289.98	N: 1455011.64 E: 3194031.48	

PIPE TABLE				
NAME	SIZE	LENGTH	SLOPE	BEARING
PIPE 36	18" RCP	47.82	6.00%	S37°41'01"E
PIPE 37	18" RCP	116.72	1.97%	S26°59'17"E

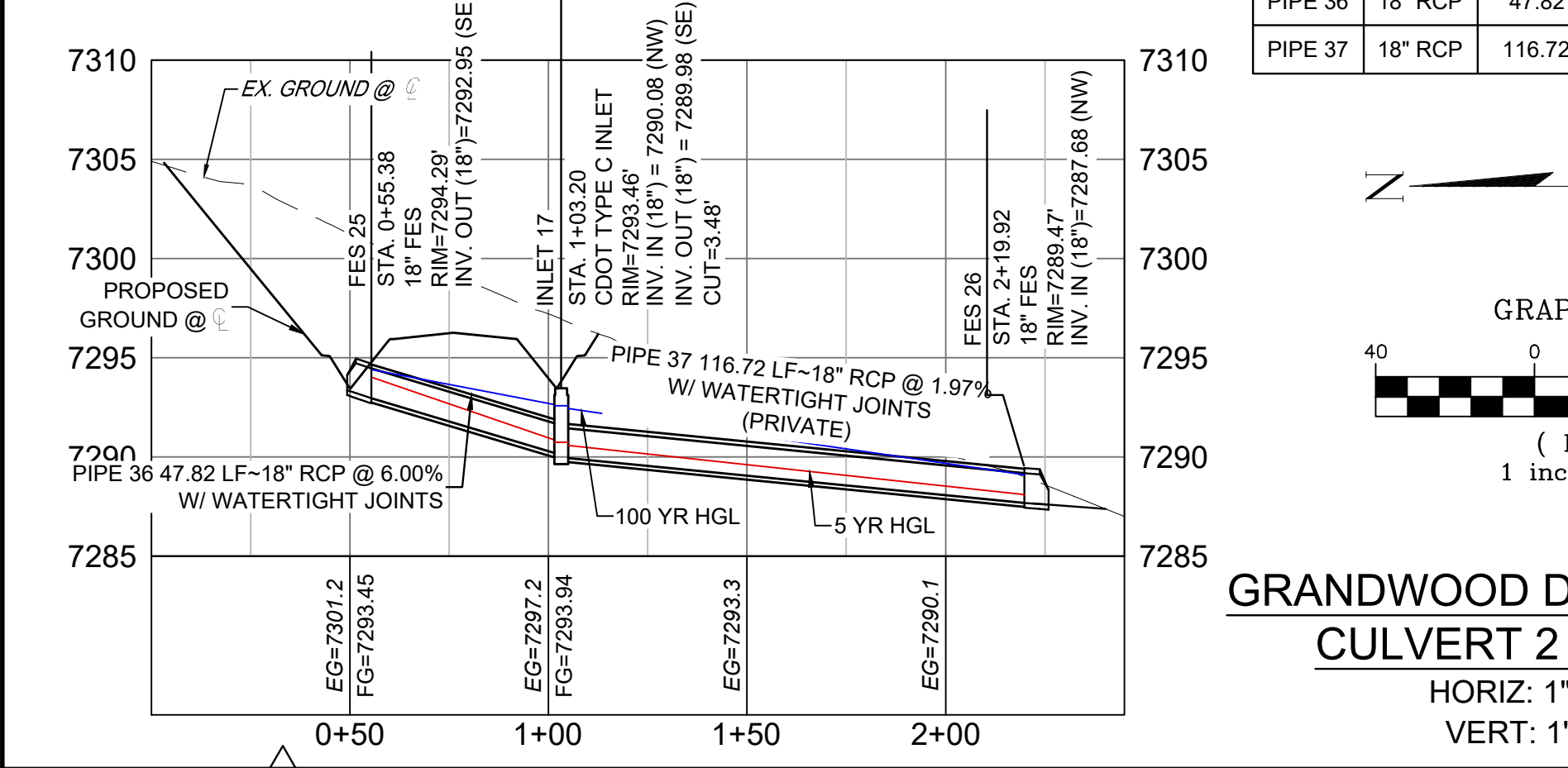

GRANDWOOD DRIVE STORM CULVERT 2 PROFILE

HORIZ: 1" = 40' VERT: 1" = 8'

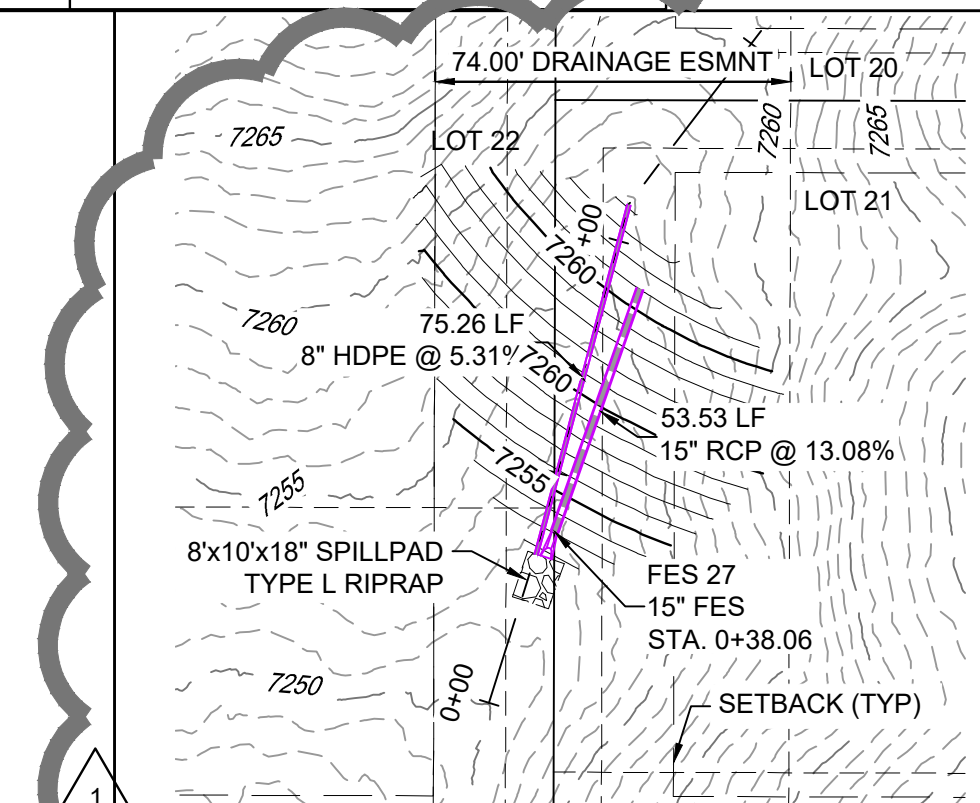

LOT 22 BERM OUTFALL PLAN (PRIVATE)

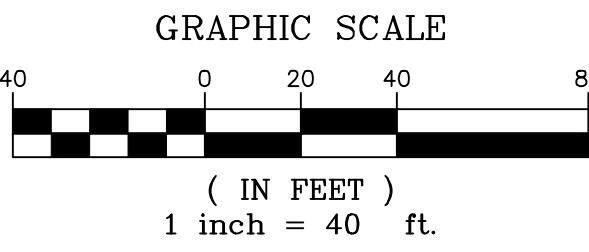

LOT 22 DETENTION OUTFALL PROFILE

HORIZ: 1" = 40' VERT: 1" = 8'

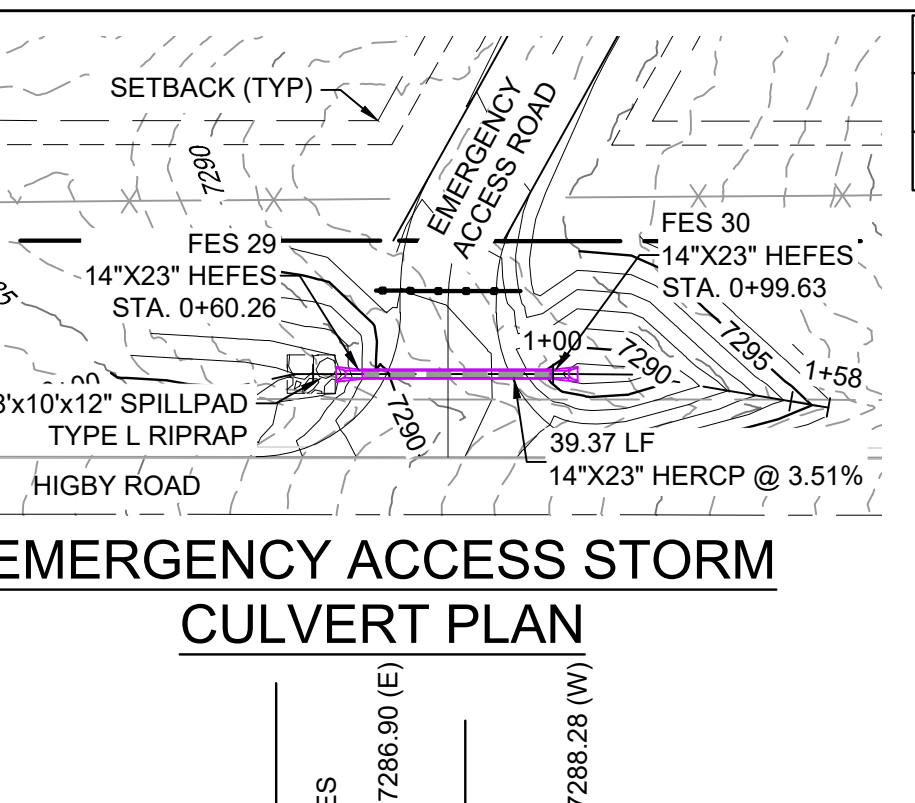
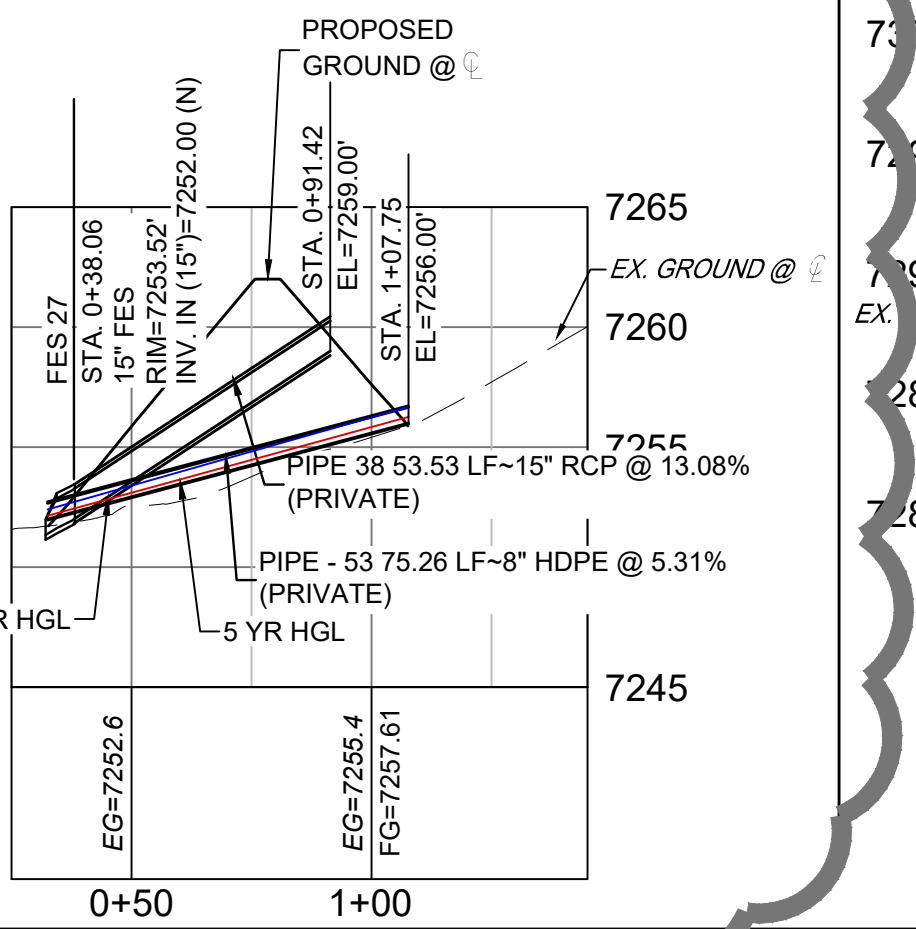
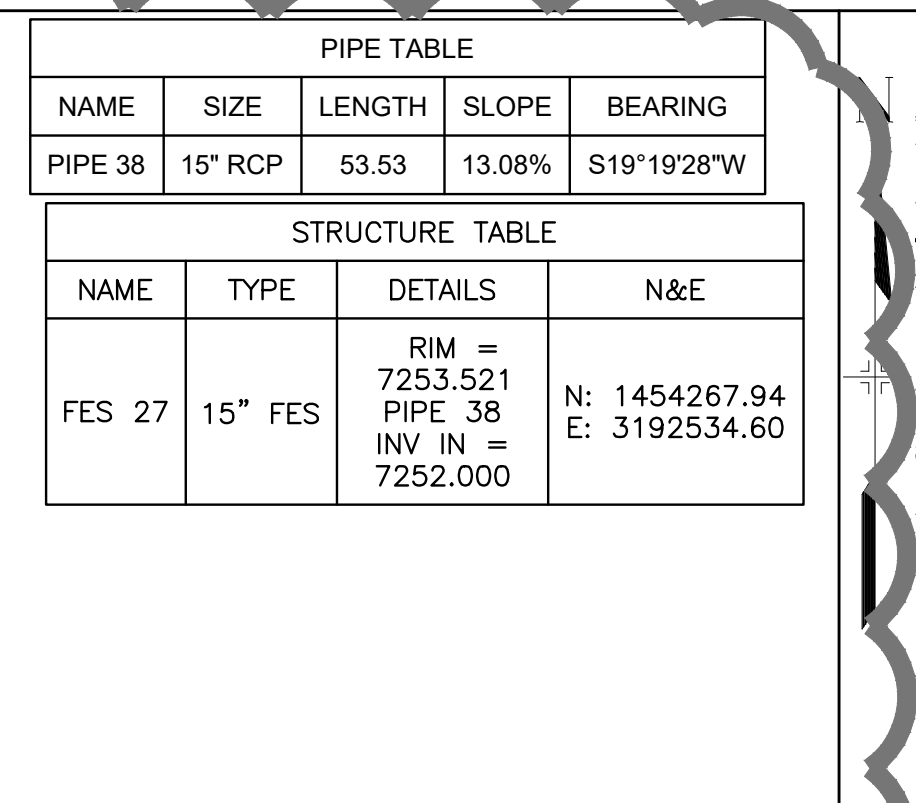

EMERGENCY ACCESS STORM CULVERT PLAN

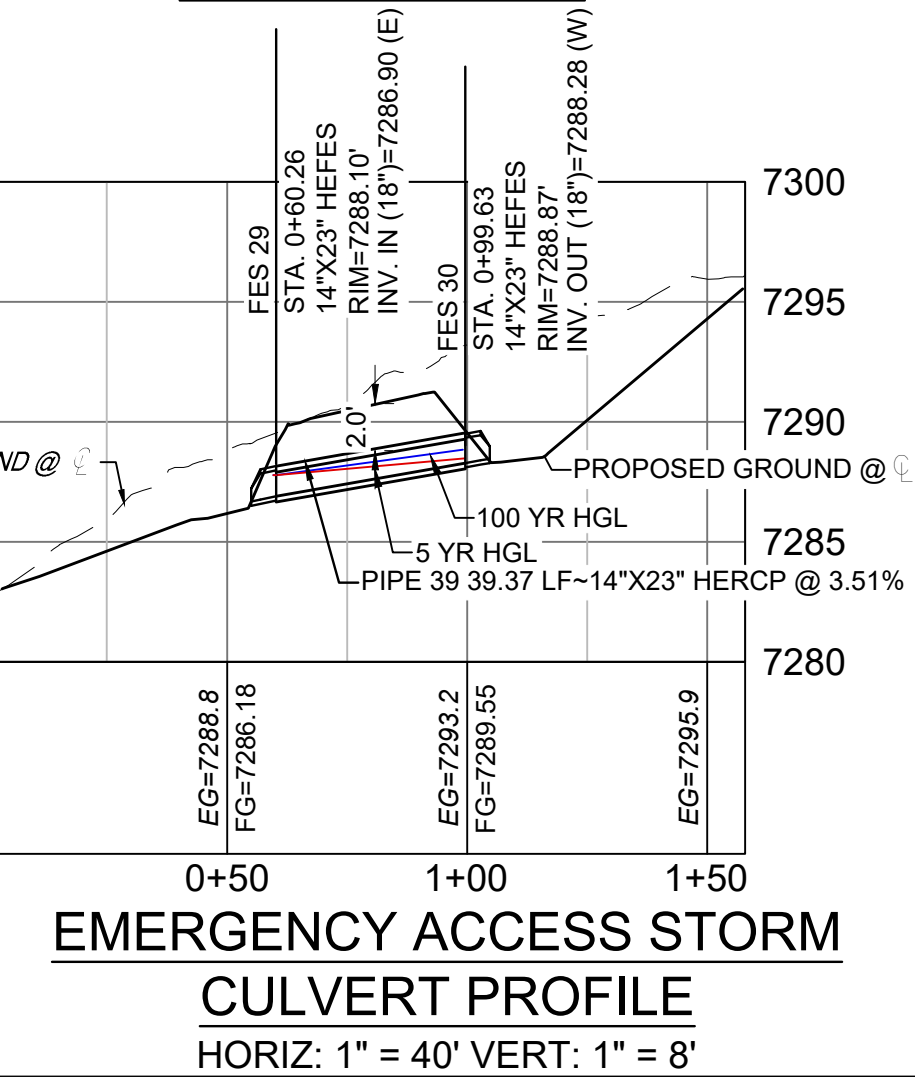

EMERGENCY ACCESS STORM CULVERT PROFILE

HORIZ: 1" = 40' VERT: 1" = 8'

PIPE TABLE				
NAME	SIZE	LENGTH	SLOPE	BEARING
PIPE 39	14"X23" HERCP	39.37	3.51%	N90°00'00"W

STRUCTURE TABLE				
NAME	TYPE	DETAILS	N&E	
FES 29	14"X23" HEFES	RIM = 7288.103 PIPE 39 INV IN = 7286.900	N: 1454156.0 E: 3194332.82	
FES 30	14"X23" HEFES	RIM = 7288.873 PIPE 39 INV OUT = 7288.280	N: 1454156.0 E: 3194372.18	

- NOTES:
1. ALL STATION, OFFSET, AND NORTHING/EASTING VALUES ARE TO THE CENTER OF ALL STRUCTURES UNLESS OTHERWISE NOTED.
 2. PIPE LENGTHS ARE MEASURED FROM CENTER TO CENTER OF ALL STRUCTURES.
 3. ALL PIPE BENDS ANGLES ARE MEASURED FROM THE CENTER OF PIPE.
 4. CONTRACTOR TO FIELD VERIFY HORIZONTAL AND VERTICAL LOCATION OF EXISTING STRUCTURES.
 5. ALL TYPE C AND TYPE D INLETS SHALL BE CONSTRUCTED AND INSTALLED PER CDOT M&S STANDARD DETAILS. ELEVATIONS PROVIDED REFER TO TOP OF GRATE/STRUCTURE ELEVATION.
 6. ALL RCP PIPE SHALL BE CLASS III UNLESS OTHERWISE NOTED.
 7. PIPES OF DIFFERENT SIZES ARE TO BE MATCHED TO THE CROWN OF THE INSIDE WALL OF PIPE.
 8. PER THE EL PASO COUNTY ENGINEERING CRITERIA MANUAL, MANHOLES SHALL BE INSTALLED 1/8" BELOW THE SURFACE OF THE PAVEMENT ON THE LOWEST SIDE OF THE MANHOLE.
 9. SECTIONS OF STORM PIPE WITH PRESSURE HEAD DURING THE 100 YR STORM SHALL USE WATERTIGHT JOINTS WITH A 100 YR SERVICE LIFE PER ECM 3.3.1.B.2.
 10. ALL STORM SEWER IS PRIVATE UNLESS OTHERWISE NOTED. STORM SEWER SHALL BE OWNED AND MAINTAINED BY THE GRANDWOOD RANCH HOMEOWNER ASSOCIATION, INC.

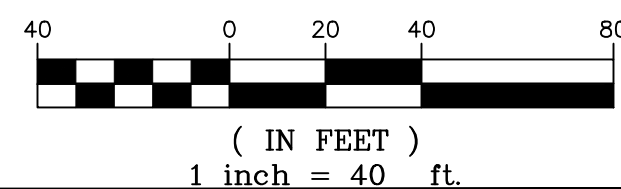

NO.	DATE	DESCRIPTION	BY
1	7/15/21	LOT 22 BERM REVISION	

NO.	DATE	DESCRIPTION	BY

APPROVED
Engineering Department
08/05/2021 1:32:32 PM
EPC Planning & Community Development Department

OWNER:
SYLVAN VISTA, INC.
WILLIAM F. HEREBIC II,
MANAGER
14160 GLENEAGLE DRIVE,
COLORADO SPRINGS, CO 80921

PREPARED BY:

FOR AND ON BEHALF OF
MATRIX DESIGN GROUP, INC.
PROJECT No. 20.1120.003

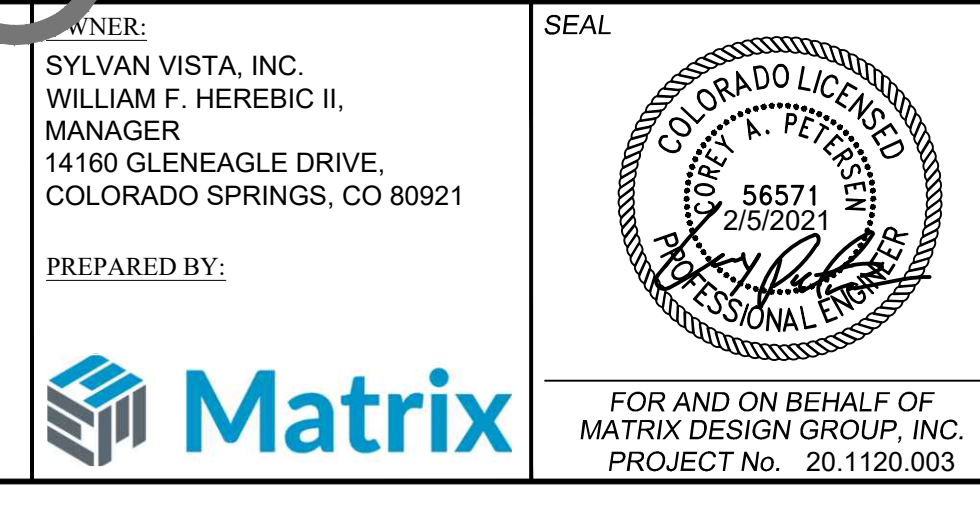

GRANDWOOD RANCH
EL PASO COUNTY - SF 2026
ROAD AND STORM PLANS

STORM PLAN AND PROFILE

DESIGNED BY: CAP
DRAWN BY: CAP
CHECKED BY: NMS

SCALE: 1" = 40'
VERT: 1" = 8'

DATE ISSUED: FEBRUARY, 2021
SHEET: 28 OF 40

DRAWING No. SD06