

# ENG-SF19009-V3-CD-redlines.pdf Markup Summary

1 (3)



**Subject:** EPC ENG Review  
**Page Index:** 1  
**Date:** 5/15/2020 10:27:39 AM  
**Author:** dsdrice  
**Color:** ■  
**Layer:**  
**Space:**  
**Page Label:** [1] Layout1



**Subject:** Text Box  
**Page Index:** 1  
**Date:** 5/15/2020 10:31:49 AM  
**Author:** dsdrice  
**Color:** ■  
**Layer:**  
**Space:**  
**Page Label:** [1] Layout1

Basis of bearings / control points w/ coordinates?



**Subject:** Text Box  
**Page Index:** 1  
**Date:** 5/15/2020 2:17:17 PM  
**Author:** dsdrice  
**Color:** ■  
**Layer:**  
**Space:**  
**Page Label:** [1] Layout1

Provide channel improvements profile.

2 (1)



**Subject:** Text Box  
**Page Index:** 2  
**Date:** 5/14/2020 5:08:58 PM  
**Author:** dsdrice  
**Color:** ■  
**Layer:**  
**Space:**  
**Page Label:** [1] Layout1

Update the notes to the new standard notes.

5 (1)



**Subject:** Callout  
**Page Index:** 5  
**Date:** 5/15/2020 8:09:08 AM  
**Author:** dsdrice  
**Color:** ■  
**Layer:**  
**Space:**  
**Page Label:** [1] Layout1

ECB or TRM? Based on this slope it appears that permanent erosion protection is required.

8 (1)



**Subject:** Callout  
**Page Index:** 8  
**Date:** 5/15/2020 9:04:13 AM  
**Author:** dsdrice  
**Color:** ■  
**Layer:**  
**Space:**  
**Page Label:** [1] Layout1

Is there a creek crossing temp BMP/dewatering detail?

9 (1)



**Subject:** Callout  
**Page Index:** 9  
**Date:** 5/15/2020 9:08:51 AM  
**Author:** dsdrice  
**Color:** ■  
**Layer:**  
**Space:**  
**Page Label:** [1] Layout1

Please label all of the other lines and show the other water line.

10 (1)

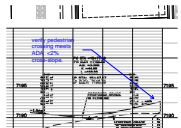

**Subject:** Callout  
**Page Index:** 10  
**Date:** 5/15/2020 9:21:18 AM  
**Author:** dsdrice  
**Color:** ■  
**Layer:**  
**Space:**  
**Page Label:** [1] Layout1

verify pedestrian crossing meets ADA <2% cross-slope.

13 (1)

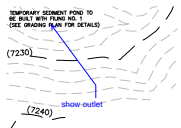

**Subject:** Callout  
**Page Index:** 13  
**Date:** 5/15/2020 9:23:52 AM  
**Author:** dsdrice  
**Color:** ■  
**Layer:**  
**Space:**  
**Page Label:** [1] Layout1

show outlet

14 (1)

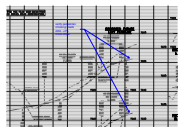

**Subject:** Callout  
**Page Index:** 14  
**Date:** 5/15/2020 9:36:07 AM  
**Author:** dsdrice  
**Color:** ■  
**Layer:**  
**Space:**  
**Page Label:** [1] Layout1

verify pedestrian crossing meets ADA <2% cross-slope.

15 (3)

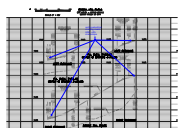

**Subject:** Callout  
**Page Index:** 15  
**Date:** 5/15/2020 9:39:01 AM  
**Author:** dsdrice  
**Color:** ■  
**Layer:**  
**Space:**  
**Page Label:** [1] Layout1

verify pedestrian crossing meets ADA <2% cross-slope.



**Subject:** Callout  
**Page Index:** 15  
**Date:** 5/15/2020 9:39:16 AM  
**Author:** dsdrice  
**Color:** ■  
**Layer:**  
**Space:**  
**Page Label:** [1] Layout1

verify pedestrian crossing meets ADA <2% cross-slope.

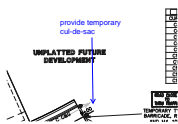

**Subject:** Callout  
**Page Index:** 15  
**Date:** 5/15/2020 9:50:38 AM  
**Author:** dsdrice  
**Color:** ■  
**Layer:**  
**Space:**  
**Page Label:** [1] Layout1

provide temporary cul-de-sac

16 (2)

OR MOVABLE TYPE 3  
 ARE PERMITTED, WHEN  
 LENGTH SHALL BE AT  
 BORROW PIT AND/OR

**Subject:**  
**Page Index:** 16  
**Date:** 5/15/2020 9:40:08 AM  
**Author:** dsdrice  
**Color:** ■  
**Layer:**  
**Space:**  
**Page Label:** [1] Layout1

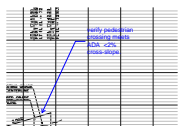

**Subject:** Callout  
**Page Index:** 16  
**Date:** 5/15/2020 9:41:08 AM  
**Author:** dsdrice  
**Color:** ■  
**Layer:**  
**Space:**  
**Page Label:** [1] Layout1

verify pedestrian crossing meets ADA <2% cross-slope.

19 (3)

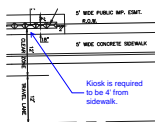

**Subject:** Callout  
**Page Index:** 19  
**Date:** 5/15/2020 9:48:42 AM  
**Author:** dsdrice  
**Color:** ■  
**Layer:**  
**Space:**  
**Page Label:** [1] Layout1

Kiosk is required to be 4' from sidewalk.

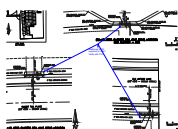

**Subject:** Callout  
**Page Index:** 19  
**Date:** 5/15/2020 9:52:12 AM  
**Author:** dsdrice  
**Color:** ■  
**Layer:**  
**Space:**  
**Page Label:** [1] Layout1

Additional ROW required for slab? Verify with P.O..

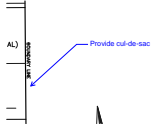

**Subject:** Callout  
**Page Index:** 19  
**Date:** 5/15/2020 9:52:37 AM  
**Author:** dsdrice  
**Color:** ■  
**Layer:**  
**Space:**  
**Page Label:** [1] Layout1

Provide cul-de-sac

25 (1)



**Subject:** Cloud+  
**Page Index:** 25  
**Date:** 5/15/2020 9:59:09 AM  
**Author:** dsdrice  
**Color:** ■  
**Layer:**  
**Space:**  
**Page Label:** [1] Layout1

Should be provided now in case property is sold.

26 (3)

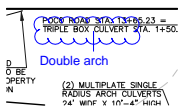

**Subject:** Cloud+  
**Page Index:** 26  
**Date:** 5/15/2020 10:00:06 AM  
**Author:** dsdrice  
**Color:** ■  
**Layer:**  
**Space:**  
**Page Label:** [1] Layout1

Double arch



**Subject:** Callout  
**Page Index:** 26  
**Date:** 5/15/2020 10:04:18 AM  
**Author:** dsdrice  
**Color:** ■  
**Layer:**  
**Space:**  
**Page Label:** [1] Layout1

The invert should be lower to match existing grade here, or additional protection provided on the steeper slope downstream.

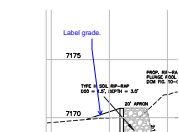

**Subject:** Callout  
**Page Index:** 26  
**Date:** 5/15/2020 10:04:59 AM  
**Author:** dsdrice  
**Color:** ■  
**Layer:**  
**Space:**  
**Page Label:** [1] Layout1

Label grade.



**Subject:**  
**Page Index:** 28  
**Date:** 5/15/2020 10:10:37 AM  
**Author:** dsdrice  
**Color:** ■  
**Layer:**  
**Space:**  
**Page Label:** [1] Layout1



**Subject:** Callout  
**Page Index:** 28  
**Date:** 5/15/2020 10:11:30 AM  
**Author:** dsdrice  
**Color:** ■  
**Layer:**  
**Space:**  
**Page Label:** [1] Layout1

This area should be protected due to slope.



**Subject:** Callout  
**Page Index:** 28  
**Date:** 5/15/2020 10:13:24 AM  
**Author:** dsdrice  
**Color:** ■  
**Layer:**  
**Space:**  
**Page Label:** [1] Layout1

Label

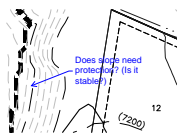

**Subject:** Callout  
**Page Index:** 28  
**Date:** 5/15/2020 2:32:22 PM  
**Author:** dsdrice  
**Color:** ■  
**Layer:**  
**Space:**  
**Page Label:** [1] Layout1

Does slope need protection? (Is it stable?)

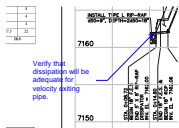

**Subject:** Callout  
**Page Index:** 30  
**Date:** 5/15/2020 10:17:26 AM  
**Author:** dsdrice  
**Color:** ■  
**Layer:**  
**Space:**  
**Page Label:** [1] Layout1

Verify that dissipation will be adequate for velocity exiting pipe.

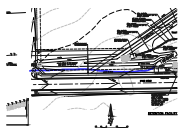

**Subject:**  
**Page Index:** 31  
**Date:** 5/15/2020 10:20:19 AM  
**Author:** dsdrice  
**Color:** ■  
**Layer:**  
**Space:**  
**Page Label:** [1] Layout1

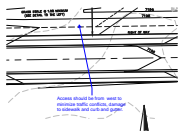

**Subject:** Callout  
**Page Index:** 31  
**Date:** 5/15/2020 10:21:53 AM  
**Author:** dsdrice  
**Color:** ■  
**Layer:**  
**Space:**  
**Page Label:** [1] Layout1

Access should be from west to minimize traffic conflicts, damage to sidewalk and curb and gutter.