

OVERALL LANDSCAPE PLAN

1" = 400'

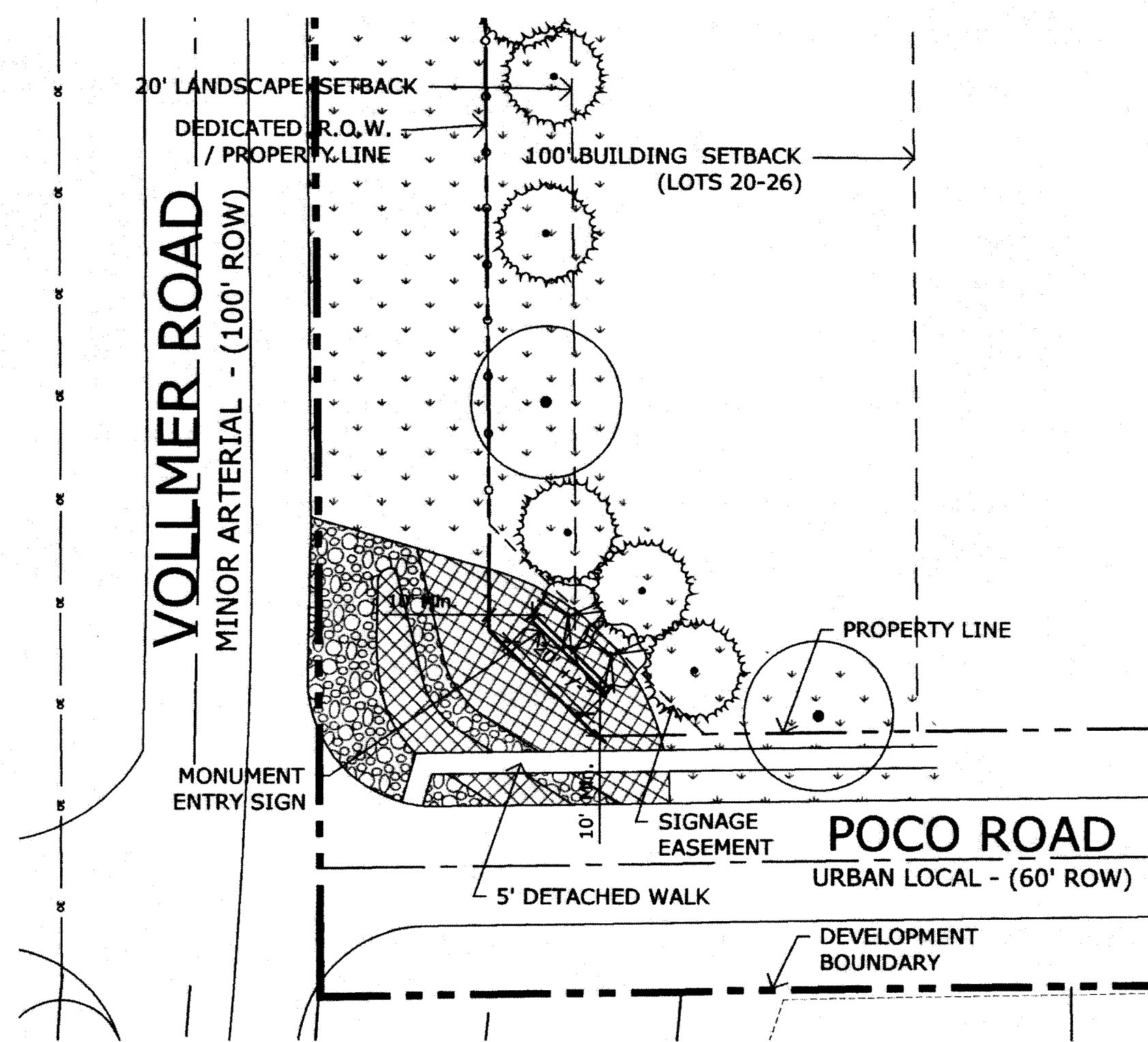

T1 MAIN ENTRY MONUMENT - TYPICAL LANDSCAPE PLAN

Scale: 1" = 30'

LANDSCAPE REQUIREMENTS

Roadway Landscape

Street Name or Zone Boundary	Classification	Width (In Ft.) Req./Prov.	Tree/Feet Required
Vollmer Road	Minor Arterial	20' / 20'	1 / 25'
Arroya Lane	Rural Collector	10' / 25'	1 / 30'

PRELIMINARY TREE SCHEDULE

DECIDUOUS TREES

- Acer grandidentatum 'Highland Park' / Highland Park Bigtooth Maple
- Celtis occidentalis / Common Hackberry
- Gleditsia triacanthos / Honey Locust
- Gymnocladus dioica / Kentucky Coffee Tree
- Populus angustifolia / Narrowleaf Poplar

HEIGHT	WIDTH	SIZE	COND	KEY
40'	25'	2' Cal.	B&B	Xeric
60'	50'	3' Cal.	B&B	Xeric
60'	40'	3' Cal.	B&B	Xeric
60'	50'	3' Cal.	B&B	NonX
50'	30'	2.5" Cal.	B&B	NonX

EVERGREEN TREES

- Abies concolor / White Fir
- Juniperus scopulorum / Rocky Mountain Juniper
- Juniperus virginiana / Eastern Red Cedar
- Picea pungens glauca 'Baby Blue Eyes' / Baby Blue Eyes Colorado Blue Spruce
- Pinus flexilis / Limber Pine
- Pinus ponderosa / Ponderosa Pine
- Pinus strobfomis / Southwestern White Pine

HEIGHT	WIDTH	SIZE	COND	KEY
60'	30'	8" HT	B&B	NonX
30'	15'	6" HT	B&B	Xeric
20'	10'	6" HT	B&B	Xeric
15'	10'	6" HT	B&B	NonX
50'	30'	6" HT	B&B	Xeric
80'	40'	8" HT	B&B	Xeric
50'	30'	8" HT	B&B	NonX

ORNAMENTAL TREE

- Crataegus crus-galli / Cockspur Hawthorn
- Malus x 'Indian Magic' / Indian Magic Crab Apple
- Prunus virginiana 'Shubert' / Canada Red Cherry
- Rhus glabra / Smooth Sumac

HEIGHT	WIDTH	SIZE	COND	KEY
30'	30'	2' Cal.	B&B	Xeric
20'	20'	2' Cal.	B&B	NonX
30'	25'	2' Cal.	B&B	Xeric
15'	10'	2' Cal.	B&B	Xeric

CONCEPT TREE & GROUND COVER LEGEND

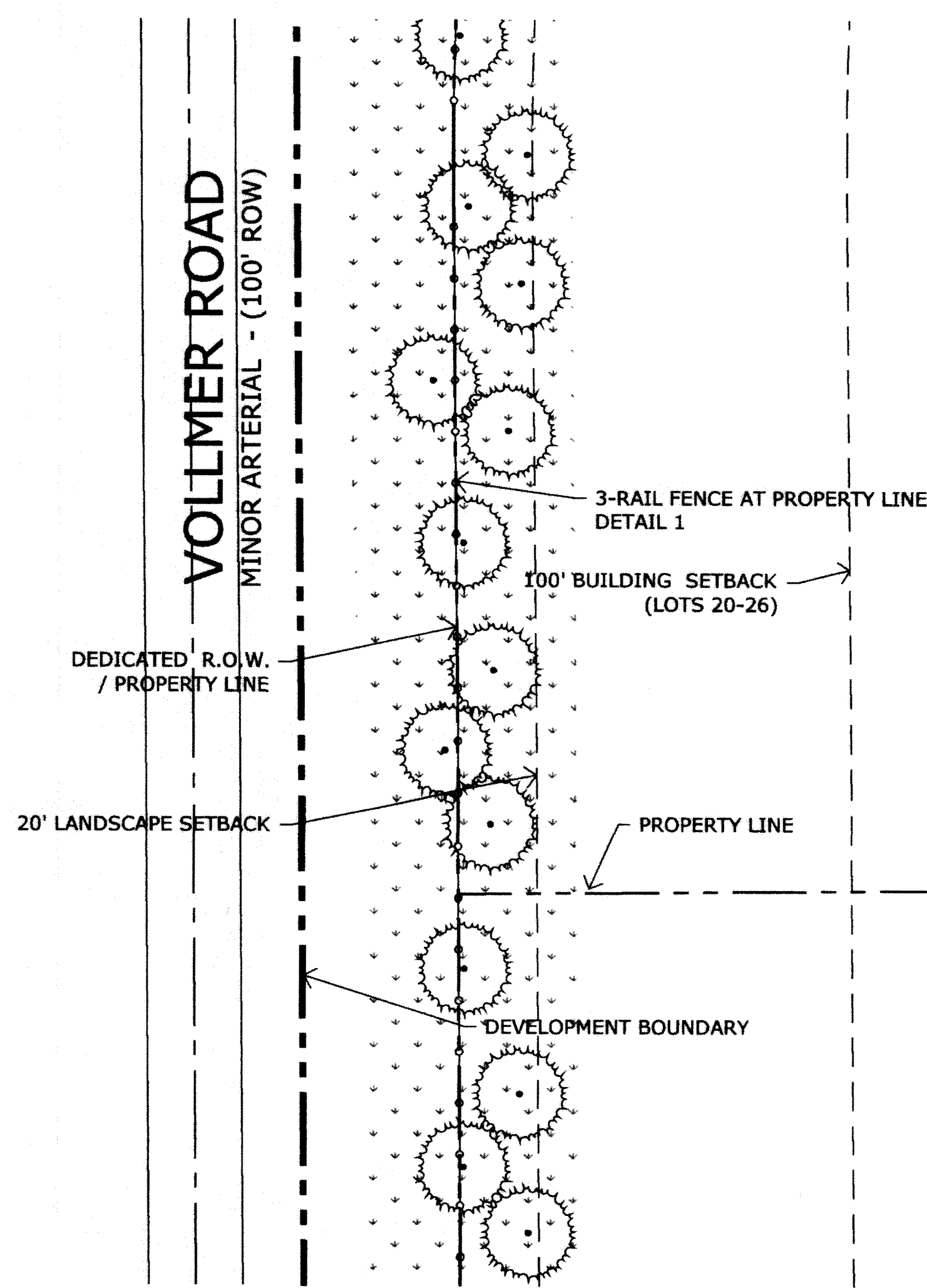
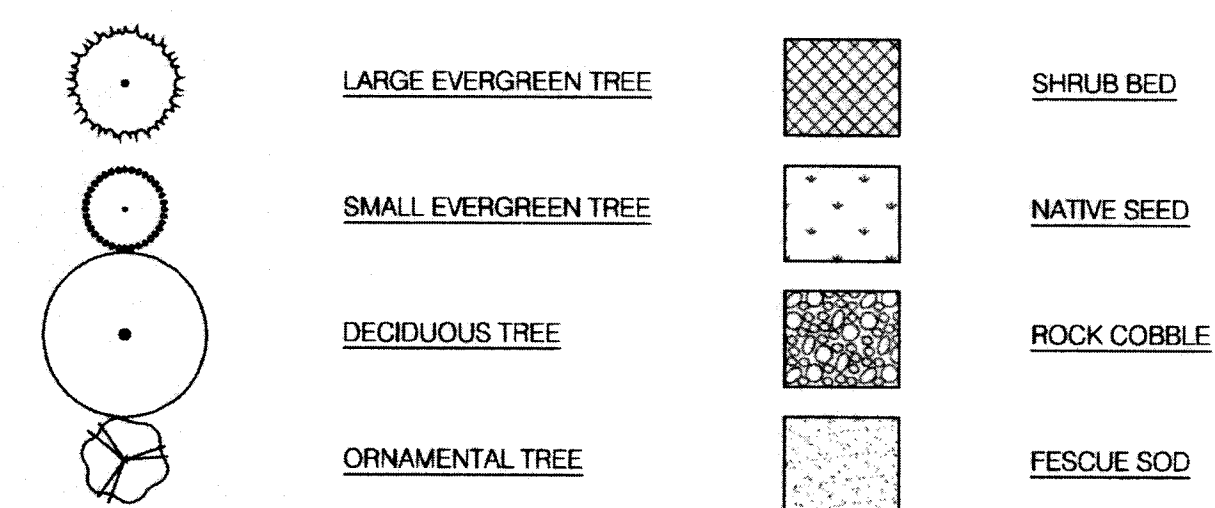

T2 VOLLMER ROAD - TYPICAL LANDSCAPE PLAN

1 TREE / 25', MINIMUM 1/3 EVERGREEN

Scale: 1" = 30'

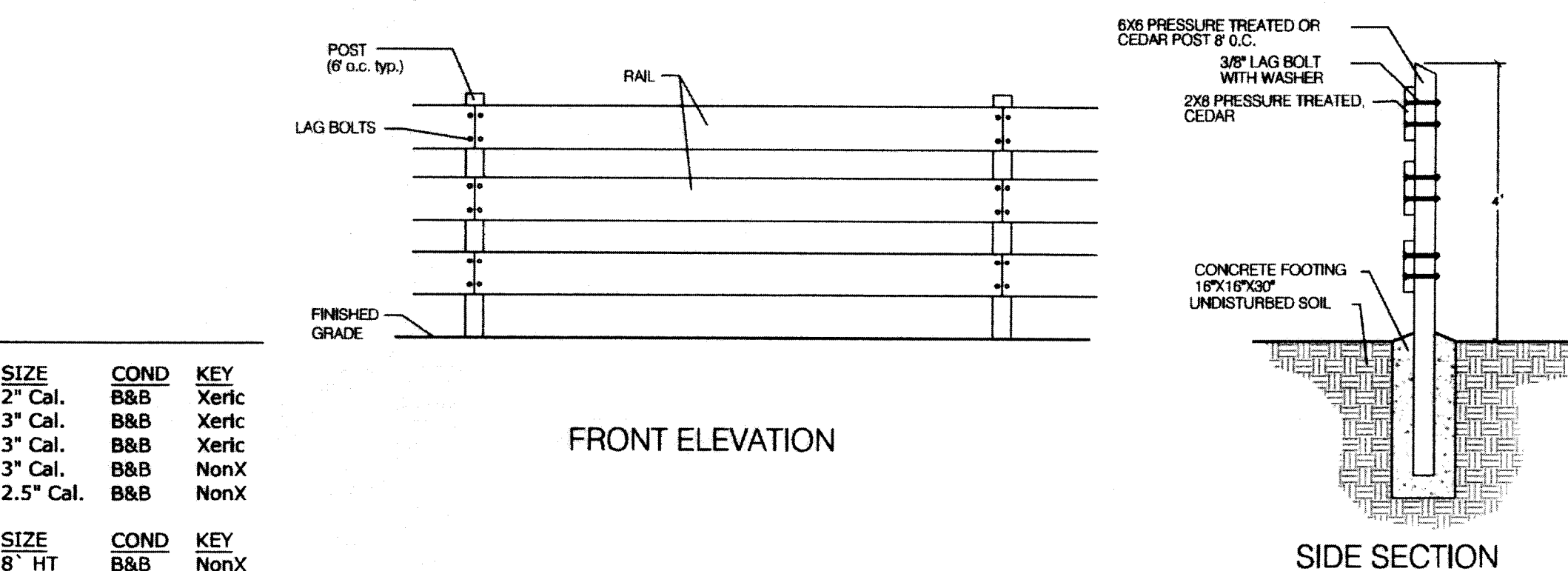

FRONT ELEVATION

SIDE SECTION

D1 3-RAIL WOODEN FENCE

NOT TO SCALE

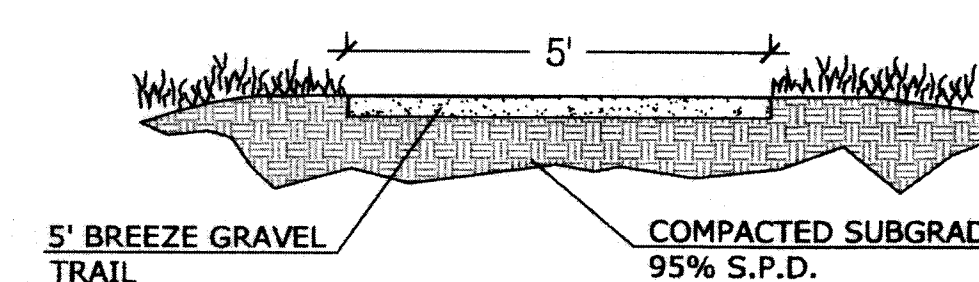

D2 GRAVEL METRO. DISTRICT (LOCAL) TRAIL SECTION

NOT TO SCALE

- NOTES:
- 1. USE 2% CROSS PITCH FOR PITCHED SLOPED AREAS WHERE SPECIFIED.
- 2. CROWN CENTER FOR ALL FLAT SIDE SLOPE AREAS.
- 3. SWALE TO INTERCEPT OVERFLOW FROM SLOPED UPHILL OF TRAIL.
- 4. ALL REGIONAL TRAILS TO BE A MINIMUM OF 8' WIDE BREEZE GRAVEL PATH. WHERE REGIONAL TRAIL ADJACENT TO BREEZE GRAVEL WALK TO BE MINIMUM 10' WIDE CONCRETE WITH A 5' WIDE BREEZE GRAVEL BRIDLE PATH ADJACENT TO WALK.

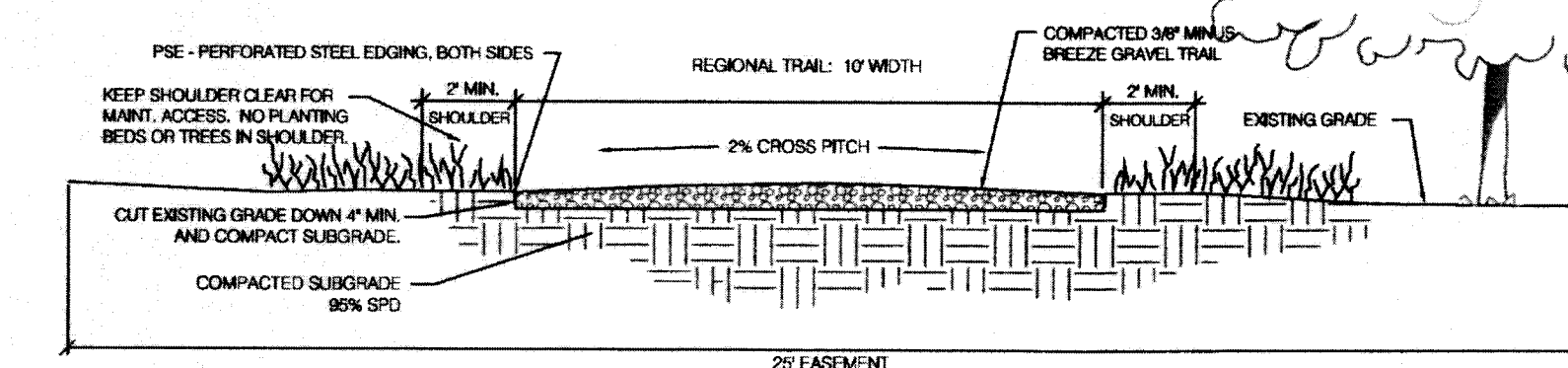

D3 BREEZE GRAVEL REGIONAL MULTI-USE TRAIL SECTION

NOT TO SCALE

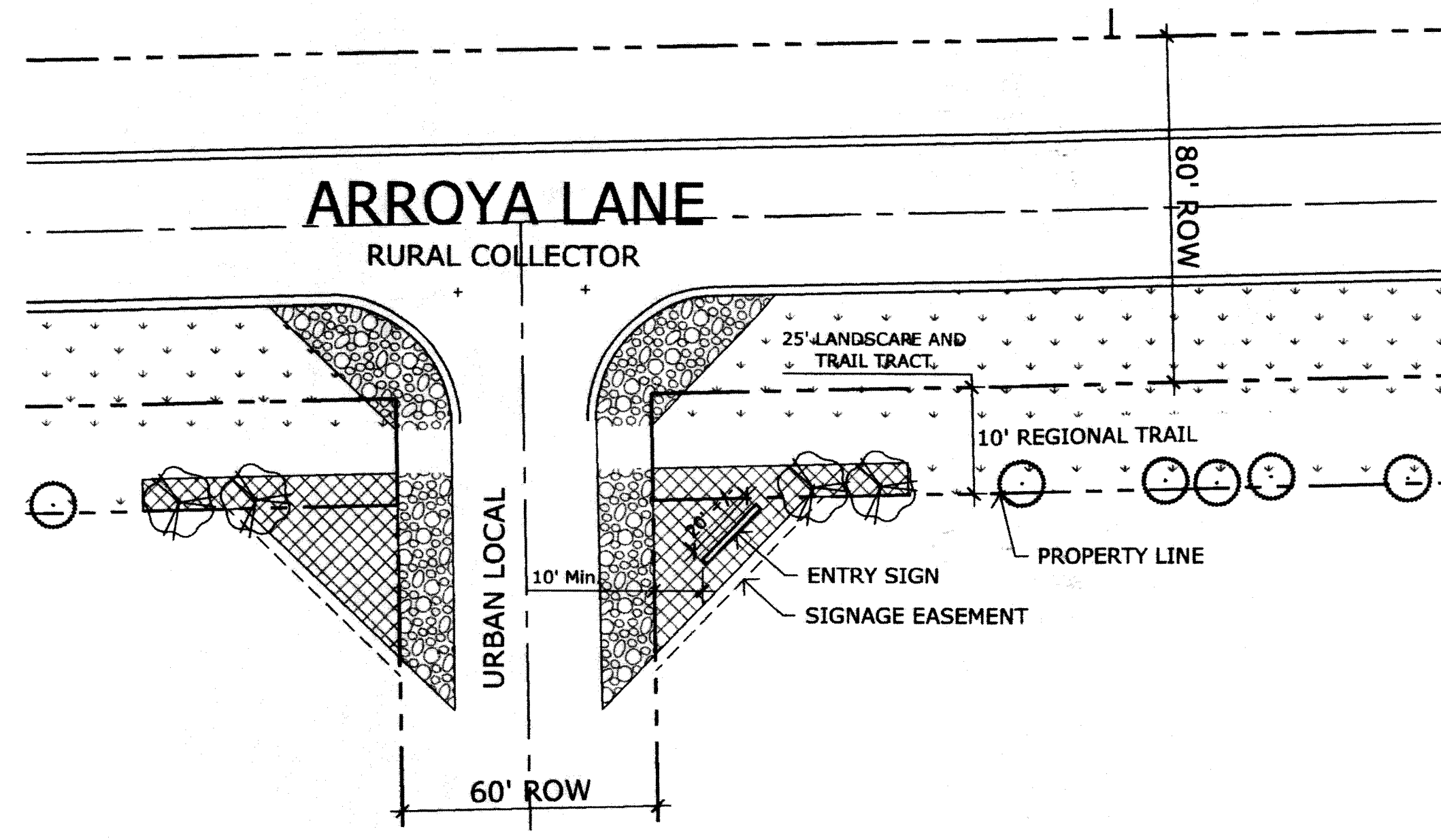

T3 ARROYA LANE - TYPICAL LANDSCAPE PLAN

1 TREE / 30', MINIMUM 1/3 EVERGREEN

Scale: 1" = 30'

21804692
4/11/18

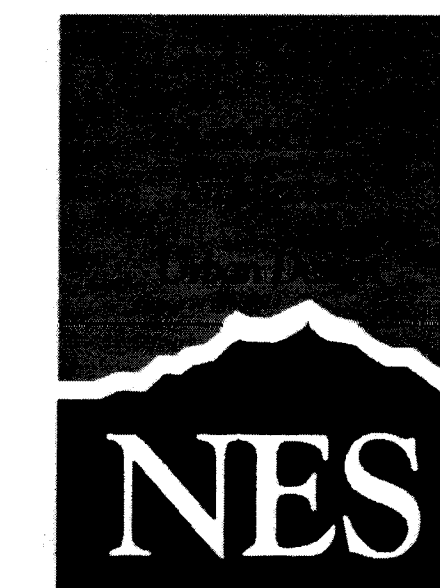

N.E.S. Inc.
619 N. Cascade Avenue, Suite 200
Colorado Springs, CO 80903

Tel. 719.471.0073
Fax 719.471.0267

www.nescolorado.com

© 2012. All Rights Reserved.

Retreat at TimberRidge

PUD Development Plan

VOLLMER RD &
ARROYA LN

EL PASO COUNTY, CO
80908

DATE: 04-12-17
PROJECT MGR: J. MAYNARD
PREPARED BY: K. MARSHALL

DATE:	BY:	DESCRIPTION:
06-21-17	KMM	Per County Review Comments
08-24-17	KMM	Per County Review Comments
01-19-18	KMM	Density and Layout Changes
02-08-18	KMM	Per County Review Comments

LANDSCAPE PLAN & DETAILS

4

OF 4