

KING SOOPERS #147

FALCON MARKETPLACE LOTS 2 & 3, BLOCK 1

A PORTION OF SECTION 1, TOWNSHIP 13 SOUTH, RANGE 65 WEST OF THE 6TH P.M., EL PASO COUNTY, COLORADO

SITE DEVELOPMENT PLAN

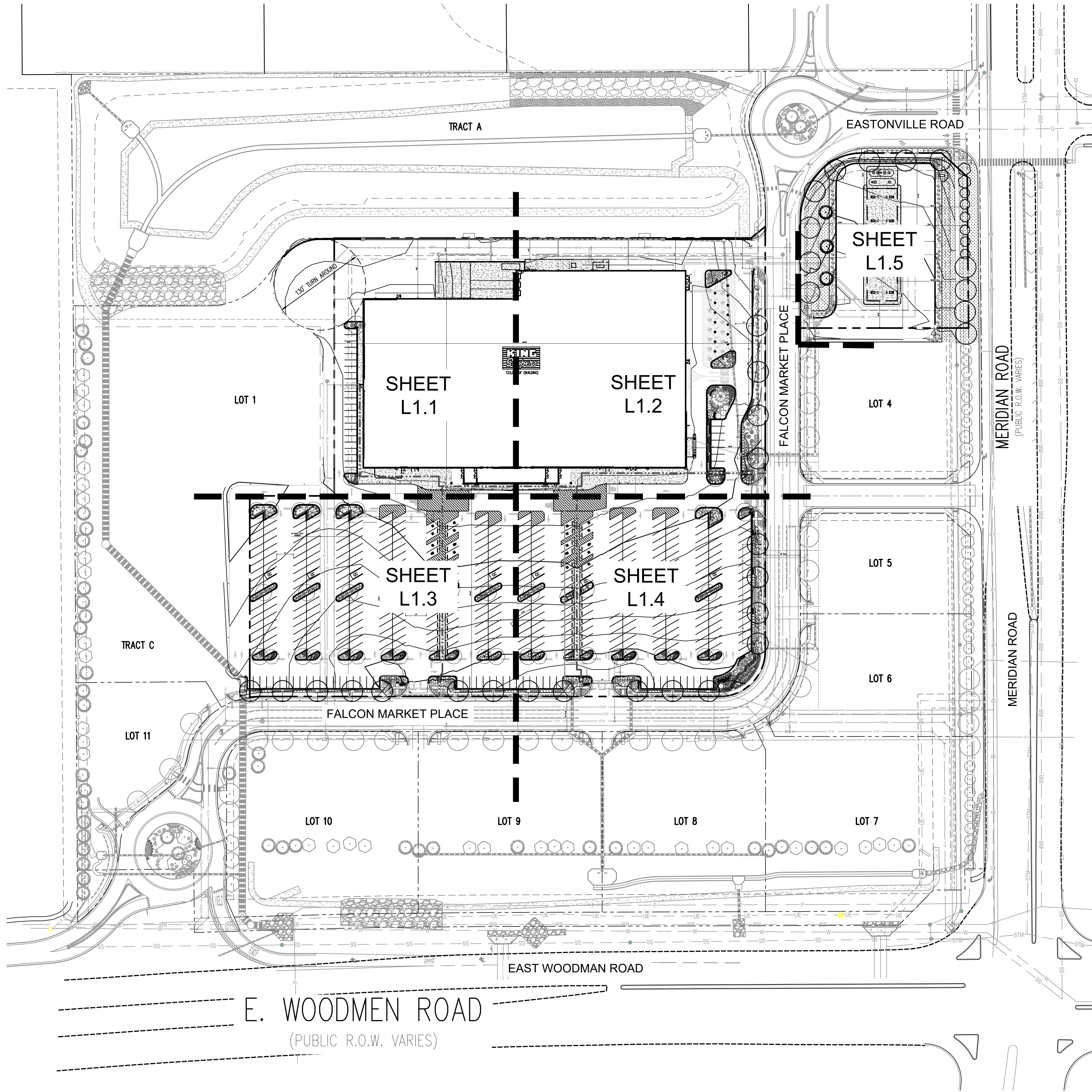

PLANTING NOTES

- GENERAL**
1. ALL LANDSCAPE NOTES SHALL BE COORDINATED WITH ALL APPLICABLE KROGER PROJECT MANUAL SECTIONS UNDER 32 90 00 "PLANTING". THE SPECIFICATIONS SHALL TAKE PRECEDENCE OVER THE GENERAL PLANTING NOTES. ANY DISCREPANCY SHALL BE BROUGHT TO THE ATTENTION OF THE GENERAL CONTRACTOR AND LANDSCAPE ARCHITECT BEFORE PROCEEDING WITH WORK.
 2. ALL WORK SHALL CONFORM TO ALL APPLICABLE STATE AND LOCAL CODES, STANDARDS, AND SPECIFICATIONS.
 3. LANDSCAPE DESIGN IS DIAGRAMMATIC IN NATURE. THE CONTRACTOR SHALL BE RESPONSIBLE FOR HIS OWN TAKEOFFS AND QUANTITY CALCULATIONS. IN THE EVENT OF A DISCREPANCY BETWEEN THE PLAN AND THE LANDSCAPE LEGEND, THE PLANT QUANTITY AS SHOWN ON THE PLAN SHALL TAKE PRECEDENCE AND NOTIFY THE LANDSCAPE ARCHITECT OF THESE DISCREPANCIES. MINOR ADJUSTMENTS TO THE LANDSCAPE MATERIAL AND LOCATIONS MAY BE PROPOSED FOR CITY CONSIDERATION AT THE CONSTRUCTION DOCUMENT STAGE TO RESPOND TO MARKET AND FIELD CONDITIONS. HOWEVER, THERE SHALL BE NO REDUCTION IN THE NUMBER AND SIZE OF MATERIALS.
 4. THE CONTRACTOR SHALL MAKE HIMSELF AWARE OF THE LOCATIONS OF EXISTING AND PROPOSED UTILITIES, AND SHALL BE RESPONSIBLE FOR ANY DAMAGE TO THE UTILITIES AND/OR ANY INJURY TO ANY PERSON.
 5. ALL UTILITY EASEMENTS SHALL REMAIN UNOBSTRUCTED AND FULLY ACCESSIBLE ALONG THEIR ENTIRE LENGTH FOR MAINTENANCE EQUIPMENT.
 6. THE CONTRACTOR SHALL TAKE EXTREME CARE NOT TO DAMAGE ANY EXISTING PLANTS INDICATED AS "TO REMAIN". ANY SUCH PLANTS DAMAGED BY THE CONTRACTOR SHALL BE REPLACED WITH THE SAME SPECIES, SIZE, AND QUANTITY AT THE CONTRACTOR'S OWN EXPENSE, AND AS ACCEPTABLE TO THE OWNER. REFER TO THE TREE PROTECTION NOTES ON THE PLANS (AS APPLICABLE).
 7. LANDSCAPE CONTRACTOR SHALL EXAMINE THE SITE CONDITIONS UNDER WHICH THE WORK IS TO BE PERFORMED AND NOTIFY THE GENERAL CONTRACTOR IN WRITING OF UNSATISFACTORY CONDITIONS. IF SITE CONDITIONS OR PLANT AVAILABILITY REQUIRE CHANGES TO THE PLAN, THEN AN APPROVAL WILL BE OBTAINED FROM THE CITY. DO NOT PROCEED UNTIL CONDITIONS HAVE BEEN CORRECTED.
 8. ALL CONSTRUCTION DEBRIS AND MATERIAL SHALL BE REMOVED AND CLEANED OUT PRIOR TO INSTALLATION OF TOPSOIL, TREES, SHRUBS, AND TURF.
 9. FOR ALL INFORMATION ON SURFACE MATERIAL OF WALKS, DRIVES, AND PARKING LOTS, SEE THE SITE PLAN. SEE PHOTOMETRIC PLAN FOR FREE STANDING LIGHTING INFORMATION.
 10. THE LANDSCAPE CONTRACTOR SHALL NOTIFY THE LANDSCAPE ARCHITECT ONE WEEK PRIOR TO BEGINNING CONSTRUCTION.
 11. WINTER WATERING SHALL BE AT THE EXPENSE OF THE CONTRACTOR UNTIL SUCH TIME AS FINAL ACCEPTANCE IS RECEIVED.
 12. ALL LANDSCAPE CONSTRUCTION PRACTICES, WORKMANSHIP, AND ETHICS SHALL BE IN ACCORDANCE WITH INDUSTRY STANDARDS SET FORTH IN THE CONTRACTORS HANDBOOK PUBLISHED BY THE COLORADO LANDSCAPE CONTRACTORS ASSOCIATION.
 13. LANDSCAPE AND IRRIGATION WORK SHALL BE COMPLETED PRIOR TO THE ISSUANCE OF THE FINAL CERTIFICATE OF OCCUPANCY.
- FINISH GRADING AND SOIL PREPARATION**
14. CONTRACTOR SHALL CONSTRUCT AND MAINTAIN FINISH GRADES AS RECOMMENDED BY THE GEOTECHNICAL REPORT. ALL LANDSCAPE AREAS SHALL HAVE POSITIVE DRAINAGE AWAY FROM STRUCTURES AT THE MINIMUM SLOPE SPECIFIED IN THE REPORT, AND AREAS OF POTENTIAL PONDING SHALL BE REGRADED TO BLEND IN WITH THE SURROUNDING GRADES AND ELIMINATE PONDING POTENTIAL. SHOULD ANY CONFLICTS AND/OR DISCREPANCIES ARISE BETWEEN THE GEOTECHNICAL REPORT, THE GRADING PLANS, THESE NOTES, AND ACTUAL CONDITIONS, THE CONTRACTOR SHALL IMMEDIATELY BRING SUCH ITEMS TO THE ATTENTION OF THE LANDSCAPE ARCHITECT AND OWNER.
 15. AFTER FINISH GRADES HAVE BEEN ESTABLISHED, IT IS RECOMMENDED THAT THE CONTRACTOR SHALL HAVE SOIL SAMPLES TESTED BY AN ESTABLISHED SOIL TESTING LABORATORY FOR THE FOLLOWING: GENERAL SOIL FERTILITY, PH, ORGANIC MATTER CONTENT, SALT (CEC), LIME, SODIUM ADSORPTION RATIO (SAR) AND BORON CONTENT. EACH SAMPLE SUBMITTED SHALL CONTAIN NO LESS THAN ONE QUART OF SOIL. CONTRACTOR SHALL ALSO SUBMIT THE PROJECT'S PLANT LIST TO THE LABORATORY ALONG WITH THE SOIL SAMPLES. THE SOIL REPORT PRODUCED BY THE LABORATORY SHALL CONTAIN RECOMMENDATIONS FOR THE FOLLOWING (AS APPROPRIATE): GENERAL SOIL PREPARATION AND BACKFILL MIXES, PRE-PLANT FERTILIZER APPLICATIONS, AND ANY OTHER SOIL RELATED ISSUES. THE REPORT SHALL ALSO PROVIDE A FERTILIZER PROGRAM FOR THE ESTABLISHMENT PERIOD AND FOR LONG-TERM MAINTENANCE.
 16. THE CONTRACTOR SHALL REQUIRE INSTALLATION OF SOIL AMENDMENTS AND FERTILIZERS PER THE SOILS REPORT FOR THE OWNER'S REPRESENTATIVE CONSIDERATION.
 17. AT A MINIMUM, ALL TOPSOIL SHALL BE AMENDED WITH NITROGEN STABILIZED ORGANIC AMENDMENT COMPOST AT A RATE OF 5.0 CUBIC YARDS AND AMMONIUM PHOSPHATE 16-20-0 AT A RATE OF 10 POUNDS PER THOUSAND SQUARE FEET OF LANDSCAPE AREA. COMPOST SHALL BE MECHANICALLY INTEGRATED INTO THE TOP 6" OF SOIL BY MEANS OF ROTOTILLING AFTER CROSS-RIPPING. GROUND COVER & PERENNIAL BED AREAS SHALL BE AMENDED AT A RATE OF 8 CUBIC FEET PER THOUSAND SQUARE FEET OF NITROGEN STABILIZED ORGANIC AMENDMENT AND 10 LBS. OF 12-12-12 FERTILIZER PER CU. YD., ROTOTILLED TO A DEPTH OF 8". NO
- MANURE OR ANIMAL-BASED PRODUCTS SHALL BE USED FOR ORGANIC AMENDMENTS.**
- PLANTING**
18. ALL DECIDUOUS TREES SHALL HAVE FULL, WELL-SHAPED HEADS. ALL EVERGREENS SHALL BE UNSHEDDED AND FULL TO THE GROUND, UNLESS OTHERWISE SPECIFIED. TREES WITH CENTRAL LEADERS WILL NOT BE ACCEPTED IF LEADER IS DAMAGED OR REMOVED. PRUNE ALL DAMAGED TWIGS AFTER PLANTING.
 19. ALL PLANTS WITHIN A SPECIES SHALL HAVE SIMILAR SIZE, AND SHALL BE OF A FORM TYPICAL FOR THE SPECIES. ANY PLANT DEEMED UNACCEPTABLE BY THE LANDSCAPE ARCHITECT SHALL BE IMMEDIATELY REMOVED FROM THE SITE AND SHALL BE REPLACED WITH AN ACCEPTABLE PLANT OF LIKE TYPE AND SIZE AT THE CONTRACTOR'S OWN EXPENSE. ANY PLANTS APPEARING TO BE UNHEALTHY, EVEN IF DETERMINED TO STILL BE ALIVE, SHALL NOT BE ACCEPTED. THE LANDSCAPE ARCHITECT SHALL BE THE SOLE JUDGE AS TO THE ACCEPTABILITY OF PLANT MATERIAL.
 20. ALL TREES SHALL BE GUYED AND WOOD STAKED AS PER DETAILS. NO "T-STAKES" SHALL BE USED FOR TREES.
 21. ALL PLANT MATERIALS SHALL BE TRUE TO TYPE, SIZE, SPECIES, QUALITY, AND FREE OF INJURY, BROKEN ROOT BALLS, PESTS, AND DISEASES, AS WELL AS CONFORM TO THE MINIMUM REQUIREMENTS DESCRIBED IN THE "AMERICAN STANDARD FOR NURSERY STOCK". FOLLOW GREENCO TREE PLANTING RECOMMENDATIONS FOR MINIMUM QUALITY REQUIREMENTS FOR TREES.
 22. ALL TREE AND SHRUB BED LOCATIONS ARE TO BE STAKED OUT ON SITE FOR APPROVAL BY THE LANDSCAPE ARCHITECT PRIOR TO INSTALLATION.
 23. ALL TREES PLANTED ADJACENT TO PUBLIC AND/OR PEDESTRIAN WALKWAYS SHALL BE TRUNK CLEAR OF ALL BRANCHES BETWEEN GROUND AND A HEIGHT OF EIGHT (8) FEET FOR THAT PORTION OF THE PLAN LOCATED OVER THE SIDEWALK AND/OR ROAD.
 24. IF TURF IS TO BE USED, IT IS RECOMMENDED THROUGH GREEN VALLEY TURF COMPANY, 13159 N US HIGHWAY 85, LITTLETON, CO 80125, (303) 798-6764. RIF TALL FESCUE HAS BEEN APPROVED IN MANY JURISDICTIONS AS A LOW HYDROZONE PLANT MATERIAL. INSTALL AND MAINTAIN IN ACCORDANCE WITH MANUFACTURER'S SPECIFICATIONS.
 25. ALL PLANT MATERIAL SHALL NOT BE PLANTED PRIOR TO INSTALLATION OF TOPSOIL.
 26. ALL PLANT BEDS SHALL BE CONTAINED WITH STEEL EDGER. STEEL EDGER IS NOT REQUIRED ALONG CURBS, WALKS OR BUILDING FOUNDATIONS. ALL EDGING SHALL OVERLAP AT JOINTS A MINIMUM OF 6-INCHES, AND SHALL BE FASTENED WITH A MINIMUM OF 4 PINS PER EACH 10 FOOT SECTION. THE TOP OF ALL EDGING MATERIAL SHALL BE A ROLLED TOP AND 1/2 INCH ABOVE THE FINISHED GRADE OF ADJACENT LAWN OR MULCH AREAS. COLOR: GREEN.
 27. THE DEVELOPER, HIS SUCCESSOR, OR ASSIGNEE SHALL BE RESPONSIBLE FOR ESTABLISHING AND CONTINUING A REGULAR PROGRAM OF MAINTENANCE FOR ALL LANDSCAPED AREAS. SEE LANDSCAPE GUARANTEE AND MAINTENANCE NOTE.
 28. A 3-FOOT CLEAR SPACE SHALL BE MAINTAINED AROUND THE CIRCUMFERENCE OF ALL FIRE HYDRANTS.
 29. LANDSCAPE CONTRACTOR TO SUBMIT SAMPLES OF MISCELLANEOUS LANDSCAPING MATERIALS TO THE LANDSCAPE ARCHITECT AND OWNER'S REPRESENTATIVE FOR APPROVAL PRIOR TO INSTALLATION. I.E.; MULCH, EDGER, LANDSCAPE FABRIC, ETC.
 30. MULCHING
 31. ALL MULCH IS RECOMMENDED THROUGH ROCKY MOUNTAIN MATERIALS AND ASPHALT INC., 1910 RAND AVENUE, COLORADO SPRINGS, CO 80905, (719) 473-3100.
 32. AFTER ALL PLANTING IS COMPLETE, THE CONTRACTOR SHALL INSTALL A MINIMUM 4" THICK LAYER OF MULCH AS SPECIFIED IN THE PLANTING LEGEND. INSTALL A 4" THICK RING OF DOUBLE SHREDED CEDAR BARK MULCH AROUND ALL PLANT MATERIAL IN ROCK MULCH BEDS WHERE LANDSCAPING IS SHOWN ON THE PLANS. WOOD MULCH RING SIZE SHALL BE 1.5X THE CONTAINER SIZE OF THE SHRUBS, PERENNIALS, AND ORNAMENTAL GRASSES. TREE RING SIZE SHALL BE GREEN INDUSTRIES OF COLORADO INDUSTRY STANDARD WIDTH.
 33. ALL MULCH SHALL BE HARVESTED IN A SUSTAINABLE MANNER FROM A LOCAL SOURCE.
 34. INSTALL DEWITT PRO-5 WEED BARRIER FABRIC UNDER ALL ROCK MULCH SHRUB BEDS SPECIFIED ON THE PLANS ONLY. NO LANDSCAPE FABRIC SHALL BE USED IN WOOD MULCH AREAS. NO PLASTIC WEED BARRIERS SHALL BE SPECIFIED.
 35. ABSOLUTELY NO EXPOSED GROUND SHALL BE LEFT SHOWING ANYWHERE ON THE PROJECT AFTER MULCH HAS BEEN INSTALLED.
 36. ALL PLANTING AREAS WITH LESS THAN A 4:1 GRADIENT SHALL RECEIVE A LAYER OF MULCH, TYPE AND DEPTH PER PLANS. SUBMIT 1 CUBIC FOOT SAMPLE OF MULCH (ONE SAMPLE PER TYPE) TO LANDSCAPE ARCHITECT FOR APPROVAL PRIOR TO INSTALLATION. THE MULCH SHALL BE SPREAD EVENLY THROUGHOUT ALL PLANTING AREAS EXCEPT SLOPES 4:1 OR STEEPER, OR AS OTHERWISE DENOTED ON THE PLAN. ABSOLUTELY NO EXPOSED GROUND SHALL REMAIN IN AREAS TO RECEIVE MULCH AFTER MULCH HAS BEEN INSTALLED.
 37. ALL PLANTING AREAS ON SLOPES OVER 4:1 SHALL RECEIVE COCONUT FIBER EROSION CONTROL NETTING FROM ROLLS. NETTING SHALL BE #CT-125, AS MANUFACTURED BY NORTH AMERICAN GREEN (OR EQUAL). INSTALL AND STAKE PER MANUFACTURER'S SPECIFICATIONS. SEE ALSO THE CIVIL ENGINEER'S EROSION CONTROL PLAN.

LANDSCAPE DATA

	LOT 2 AREA	LOT 3 AREA
OVERALL SITE AREA	434,688 SF	57,320 SF
BUILDING AREA	123,000 SF	180 SF
PARKING AND VEHICULAR USE AREAS	300,357 SF	36,666 SF
OVERALL LANDSCAPE AREA	25,002 SF (5.8%)	16,110 SF (28.10%)
INTERNAL LANDSCAPE AREA	8,822 SF	16,110 SF
TOTAL # OF OPEN VEHICULAR PARKING SPACES	892	N/A

CAUTION
UTILITIES EXIST WITHIN CONSTRUCTION LIMITS. CONTRACTOR IS RESPONSIBLE FOR IDENTIFYING THEIR LOCATION PRIOR TO CONSTRUCTION.

IRRIGATION NOTE
IRRIGATION PLANS WILL NEED TO BE SUBMITTED WITHIN 3 MONTHS OF THE DATE OF APPROVAL OF THE SDP (FOR SCENER). THE PLANS MUST BE APPROVED PRIOR TO THE INSTALLATION OF ANY IRRIGATION COMPONENTS.

PARKING LOT ISLAND NOTE
THE SOIL OF ANY PLANTER WITHIN THE PARKING LOT SHALL BE STRUCTURALLY RENOVATED (TILLED) OR REMOVED TO A DEPTH OF THIRTY INCHES (30") AND REPLACED WITH AN ACCEPTABLE GROWING MEDIUM FOR THE SPECIES INDICATED FOR THE INSTALLATION.

SOIL TESTING NOTE
THE LANDSCAPE CONTRACTOR SHALL COORDINATE WITH THE DESIGN LANDSCAPE ARCHITECT REGARDING THE REQUIRED SOIL ANALYSIS REPORT AND IS RESPONSIBLE FOR COMPLETING THE SOIL SAMPLING AND SUBMITTING THE SAMPLES TO A SOILS TESTING LAB FOR TESTING. THIS WOULD INCLUDE A SEPARATE LAB TEST REPORT AND RECOMMENDATIONS (AMENDMENT/FERTILIZER AMOUNTS AND APPLICATION RATES) FOR EACH TYPE OF PROPOSED LANDSCAPING (SHRUB BEDS/SODNATIVE SEED). THE SOILS LAB RESULTS AND RECOMMENDATIONS ARE REQUIRED TO BE REVIEWED AND APPROVED BY THE DESIGN LANDSCAPE ARCHITECT AND THE CITY OF COLORADO SPRINGS PRIOR TO INSTALLING ANY LANDSCAPING (PLANTS/SODNATIVE SEED) ON SITE.

COPYRIGHT
THESE PLANS ARE AN INSTRUMENT OF SERVICE AND ARE THE PROPERTY OF GALLOWAY, AND MAY NOT BE DUPLICATED, DISCLOSED, OR REPRODUCED WITHOUT THE WRITTEN CONSENT OF GALLOWAY. COPYRIGHTS AND INFRINGEMENTS WILL BE ENFORCED AND PROSECUTED.



King Soopers
Supermarket / Petroleum
65 Tejon Street
Denver, CO 80223
Phone (303) 778-3053
Fax (303) 871-9262

KING SOOPERS #147
FALCON MARKETPLACE
LOTS 2 & 3, BLOCK 1
7530 & 7595 FALCON MARKET PL.
FALCON, CO

#	Date	Issue / Description	Init.
1	12/16/19	2ND SDP Sub.	ACJ
2	03/30/20	3RD SDP Sub.	ACJ
3	05/29/20	4TH SDP Sub.	ACJ
4	10/02/20	5TH SDP Sub.	ACJ
5	09/24/21	6TH SDP Sub.	ACJ

Project No: KSS000147
Drawn By: JRR
Checked By: JRR
Date: 8/29/19

SITE LANDSCAPE PLAN

L1.0

KING SOOPERS #147

FALCON MARKETPLACE LOTS 2 & 3, BLOCK 1

A PORTION OF SECTION 1, TOWNSHIP 13 SOUTH, RANGE 65 WEST OF THE 6TH P.M., EL PASO COUNTY, COLORADO

SITE DEVELOPMENT PLAN

SEED NOTES

1. ALL SEED MIXES AVAILABLE THROUGH WESTERN NATIVE SEED COMPANY P.O. BOX 188 COALDALE, CO 81222 (719) 942-3935	HIGH PLAINS / FOOTHILLS GRASS MIX FOR ELEVATIONS BETWEEN 4,500' - 7,000' SEEDING RATE: 2 LBS/1000 SQ.FT.	SEED ESTABLISHMENT NOTES 1. THE LANDSCAPE CONTRACTOR SHALL SEED ALL NATIVE SEED AREAS AS SOON AS POSSIBLE AFTER COMPLETION OF GRADING OPERATIONS. SOIL PREPARATION MEASURES IN AREAS TO BE SEEDED SHALL BE COMPLETED PRIOR TO SEEDING.
2. DRYLAND SEED MIXES ARE AVAILABLE AS FOLLOWS: 100% "FOOTHILLS GRASS MIX"	% SCIENTIFIC NAME 35 BOUTELOUA CURTIPENDULA 15 PASCOPYRUM SMITHII 10 ELYMUS ELYMOIDES 10 ELYMUS TRACHYCAULUS 5 ANDROPOGON GERARDII 5 BOUTELOUA GRACILIS 5 ORYZOPSIS HYMENOIDES 5 SCHIZACHYRIUM SCOPARIUM 5 SPOROBOLUS CRYPTANDRUS 5 STIPA VIRIDULA	2. FOR PROPER ESTABLISHMENT, SEED SHALL BE INSTALLED WHEN AT LEAST THREE MONTHS REMAIN IN THE GROWING SEASON. IF LESS THAN THREE MONTHS REMAIN IN THE GROWING SEASON AT THE TIME OF SEEDING, THE LANDSCAPE CONTRACTOR SHALL IMMEDIATELY NOTIFY THE LANDSCAPE ARCHITECT AND OWNER. THE IRRIGATION SYSTEM FOR SEEDED AREAS SHALL BE FULLY OPERATIONAL AT THE TIME OF SEEDING. 3. THE CONTRACTOR SHALL BE SOLELY RESPONSIBLE FOR ADDITIONAL CORRECTIVE MEASURES, AT HIS OWN COST, TO SATISFY ESTABLISHMENT REQUIREMENTS AND ENSURE TIMELY CLOSOUT. THESE MEASURES MAY INCLUDE, AT THE OWNER'S OPTION, RESEEDING OF SPARSELY GERMINATED AREAS AND/OR INSTALLATION OF SOD IN ALL SEEDED AREAS.
3. ALL SEED APPLICATIONS SHALL BE DRILL SEEDED, WITH HYDROSLURRY APPLIED OVER THE SEED BED AFTER SEEDING. THE SLURRY MIX SHALL CONTAIN THE FOLLOWING: WOOD FIBER MULCH 48 15-15-15 ORGANIC FERTILIZER 4 ORGANIC BINDER 9	LBS./1,000 SF	

TREE PROTECTION NOTES

- USE EL PASO COUNTY TREE PROTECTION NOTE (IF AVAILABLE). TREE PROTECTION NOTES BELOW SHALL BE USED FOR FURTHER INTEGRATION.
- "PROTECTED ZONE" FOR EXISTING TREES: BEFORE BEGINNING ANY DEMOTION OR CONSTRUCTION OPERATIONS, THE CONTRACTOR SHALL INSTALL TEMPORARY FENCING AROUND ALL EXISTING TREES WITHIN THE CONSTRUCTION ZONE THAT ARE TO BE SAVED. THE FENCE SHALL BE INSTALLED NO CLOSER TO THE TREE THAN THE EDGE OF THE TREE'S PROTECTED ZONE, GENERALLY DEFINED AS THE AREA BEGINNING FIVE FEET OUTSIDE OF THE TREE'S DRIPLINE AND EXTENDING TOWARDS THE TREE (OR AS FAR AWAY FROM THE TRUNK AS PRACTICABLE). THE FENCING SHALL BE OF A MATERIAL AND HEIGHT ACCEPTABLE TO THE LANDSCAPE ARCHITECT. ALL CONTRACTORS AND THEIR CREWS SHALL NOT BE ALLOWED INSIDE THIS "PROTECTED ZONE" NOR SHALL THEY BE ALLOWED TO STORE OR DUMP FOREIGN MATERIALS WITHIN THIS AREA. NO WORK OF ANY KIND, INCLUDING TRENCHING, SHALL BE ALLOWED WITHIN THE PROTECTED ZONE EXCEPT AS DESCRIBED BELOW. THE FENCING SHALL REMAIN AROUND EACH TREE TO BE SAVED UNTIL THE COMPLETION OF CONSTRUCTION OPERATIONS.
- TEMPORARY MULCH: TO ALLEVIATE SOIL COMPACTION IN ANTICIPATED AREAS OF HIGH CONSTRUCTION TRAFFIC, AND ONLY WHERE FENCING CANNOT BE SET FIVE FEET OUTSIDE OF THE DRIPLINE, THE CONTRACTOR SHALL INSTALL A LAYER OF MULCH 9"-12" THICK OVER ALL EXPOSED EARTH FROM THE TREE TRUNK TO 2' OUTSIDE OF THE DRIPLINE. THIS LAYER SHALL BE MAINTAINED AT ALL TIMES DURING CONSTRUCTION. WHEN PLANTING OPERATIONS ARE COMPLETED, THE MULCH SHALL BE REDISTRIBUTED THROUGHOUT ALL PLANTING AREAS IN A 3" THICK "PERMANENT" MULCH LAYER.
- NECESSARY WORK: WHEN IT BECOMES NECESSARY TO ENTER THE "PROTECTED ZONE" SUCH AS FOR FINE GRADING, IRRIGATION INSTALLATION AND PLANTING OPERATIONS, THE CONTRACTOR SHALL STRICTLY ADHERE TO THE FOLLOWING RULES:
 - EVERY EFFORT SHALL BE MADE TO PRESERVE THE EXISTING GRADE AROUND PROTECTED TREES IN AS WIDE AN AREA AS POSSIBLE.
 - TRENCHING WITHIN THE PROTECTED ZONE OF EXISTING TREES SHALL BE PERFORMED BY HAND, AND WITH EXTREME CARE NOT TO SEVER ROOTS 1-1/2" IN DIAMETER AND LARGER. WHERE ROOTS 1-1/2" IN DIAMETER AND LARGER ARE ENCOUNTERED, THE CONTRACTOR SHALL TUNNEL UNDER SAID ROOTS. EXPOSED ROOTS THAT HAVE BEEN TUNNELED UNDER SHALL BE WRAPPED IN WET BURLAP AND KEPT MOIST WHILE THE TRENCH IS OPEN.
 - WHERE ROOTS 1-1/2" IN DIAMETER OR LARGER MUST BE CUT DUE TO EXTENSIVE GRADE CHANGES, THOSE ROOTS MUST BE EXPOSED BY HAND DIGGING AND CUT CLEANLY. RAGGED CUTS GENERALLY DO NOT HEAL PROPERLY, AND MAY LEAVE THE TREE OPEN TO PESTS AND PATHOGENS.
 - WHERE TRENCHING NEAR TREES HAS ALREADY OCCURRED FROM PREVIOUS CONSTRUCTION OPERATIONS, THE CONTRACTOR SHALL MAKE EVERY EFFORT TO CONFINE HIS TRENCHING OPERATIONS TO THE PREVIOUSLY-CREATED TRENCHES, WHILE ADHERING TO THE CONDITIONS SET FORTH IN 3B.

- REMOVE ALL DEAD WOOD.
 - PRUNE LIVE WOOD FOR HEALTH OR STRUCTURAL REASONS ONLY, INCLUDING THE NEED TO ELIMINATE DISEASED OR DAMAGED GROWTH, ELIMINATE STRUCTURALLY UNSOUND GROWTH, REDUCE THE POTENTIAL FOR WIND TOPPLING OR WIND DAMAGE, OR TO MAINTAIN GROWTH WITHIN LIMITED SPACE. DO NOT REMOVE MORE THAN 25% OF ANY TREE'S LIVE FOLIAGE IN ANY ONE GROWING SEASON. PRUNE ONLY TO INTERNATIONAL SOCIETY OF ARBORICULTURE/ANSI A300 STANDARDS, AND ONLY UNDER THE DIRECT SUPERVISION OF A CERTIFIED ARBORIST.
 - FINAL CUTS SHALL BE MADE JUST OUTSIDE THE SHOULDER RING AREA. EXTREMELY FLUSHED CUTS WHICH PRODUCE LARGE WOUNDS SHALL NOT BE MADE.
 - ALL TRIMMING CUTS SHALL BE PERFORMED IN SUCH A MANNER AS TO PROMOTE THE NATURAL GROWTH AND SHAPE OF EACH TREE SPECIES.
 - IMPROPER PRUNING METHODS INCLUDING, BUT NOT LIMITED TO, "TOPPING", "TIPPING", "HEADING BACK", "DEHORNING", AND "MANTLING" WILL NOT BE ALLOWED. THE CONTRACTOR SHALL PAY FOR ALL WORK NECESSARY TO CORRECT SUCH PRUNING WHEN PERFORMED BY HIS CREWS OR SUBCONTRACTORS.
 - SHOULD THE CONTRACTOR REQUIRE MORE INFORMATION, THE CONTRACTOR SHALL CONTACT THE ISA AT (217) 355-9411 FOR A COPY OF THE ANSI A300 PRUNING STANDARDS. CONTRACTOR SHALL ADHERE TO THE METHODS AND PRACTICES SET FORTH IN THIS DOCUMENT.
- LANDSCAPE AND IRRIGATION (NATIVE TREES ONLY): ANY FUTURE LANDSCAPE AND IRRIGATION SHOULD ADHERE TO THE FOLLOWING GUIDELINES:
 - NO IRRIGATION OR PLANTING SHOULD OCCUR CLOSER THAN 6'-10" FROM THE TRUNK.
 - WHERE IRRIGATION DOES OCCUR WITHIN THE PROTECTED ZONE, DRIP IRRIGATION SHOULD BE USED WHEREVER POSSIBLE. ADDITIONALLY, ONLY PLANTS WITH LOW WATER NEEDS SHOULD BE PLANTED WITHIN THE PROTECTED ZONE, SPACED FAR APART WHERE CLOSE TO THE TREE. PLANTS MAY BE SPACED CLOSER TOGETHER NEAR THE EDGE OF THE PROTECTED ZONE.

LANDSCAPE GUARANTEE AND MAINTENANCE

- THE LANDSCAPE CONTRACTOR SHALL GUARANTEE ALL TREES, SHRUBS, PERENNIALS, SOD, SEEDED AREAS, AND IRRIGATION SYSTEMS FOR A PERIOD OF ONE YEAR FROM THE DATE OF THE OWNER'S ACCEPTANCE. THE CONTRACTOR SHALL REPLACE, AT HIS OWN EXPENSE, ANY PLANTS WHICH DIE IN THAT TIME, OR REPAIR ANY PORTIONS OF THE IRRIGATION SYSTEM WHICH OPERATE IMPROPERLY.
- THE LANDSCAPE CONTRACTOR SHALL MAINTAIN THE LANDSCAPE IN A NEAT, CLEAN, AND HEALTHY CONDITION FOR A PERIOD OF 90 DAYS. THIS SHALL INCLUDE PROPER PRUNING, MOWING AND AERATION OF LAWNS, WEEDING, REPLACEMENT OF MULCH, REMOVAL OF LITTER, AND THE APPROPRIATE WATERING OF ALL PLANTINGS. IRRIGATION SHALL BE MAINTAINED IN PROPER WORKING ORDER, WITH SCHEDULING ADJUSTMENTS BY SEASON AND TO MAXIMIZE WATER CONSERVATION. IF SITE OPENS DURING WINTER, TO AVOID FREEZE DAMAGE ON PLANTINGS, THE 90 DAYS SHOULD BEGIN AFTER ACCEPTANCE OF THE WORK.
- DURING THE LANDSCAPE MAINTENANCE PERIOD, THE LANDSCAPE CONTRACTOR SHALL MAINTAIN POSITIVE DRAINAGE AWAY FROM STRUCTURES IN ALL LANDSCAPE AREAS AT THE MINIMUM SLOPE SPECIFIED IN THE GEOTECHNICAL REPORT. LANDSCAPE AREAS WHICH SETTLE AND CREATE THE POTENTIAL FOR PONDING SHALL BE REPAIRED TO ELIMINATE PONDING POTENTIAL AND BLEND IN WITH THE SURROUNDING GRADES. SHOULD ANY CONFLICTS AND/OR DISCREPANCIES ARISE BETWEEN THE GEOTECHNICAL REPORT, THE GRADING PLANS, THESE NOTES, AND ACTUAL CONDITIONS, THE CONTRACTOR SHALL IMMEDIATELY BRING SUCH ITEMS TO THE ATTENTION OF THE LANDSCAPE ARCHITECT AND OWNER.

IRRIGATION CONCEPT

- AN AUTOMATIC IRRIGATION SYSTEM SHALL BE INSTALLED AND OPERATIONAL BY THE TIME OF FINAL INSPECTION. THE ENTIRE IRRIGATION SYSTEM SHALL BE INSTALLED BY A QUALIFIED IRRIGATION CONTRACTOR.
- THE IRRIGATION SYSTEM WILL OPERATE ON POTABLE WATER SERVICE AFTER THE WATER METER, BEFORE BUILDING'S DOUBLE CHECK VALVE.
- THE IRRIGATION SYSTEM WILL OPERATE ON POTABLE WATER, AND THE SYSTEM WILL HAVE APPROPRIATE BACKFLOW PREVENTION DEVICES INSTALLED TO PREVENT CONTAMINATION OF THE POTABLE SOURCE.
- ALL NON-TURF/SEED PLANTED AREAS WILL BE DRIP IRRIGATED. TURF SOD/SEED SHALL RECEIVE POP-UP SPRAY IRRIGATION FOR HEAD TO HEAD COVERAGE.
- ALL PLANTS SHARING SIMILAR HYDROZONE CHARACTERISTICS SHALL BE PLACED ON A VALVE DEDICATED TO PROVIDE THE NECESSARY WATER REQUIREMENTS SPECIFIC TO THAT HYDROZONE.
- THE IRRIGATION SYSTEM SHALL BE DESIGNED AND INSTALLED, TO THE MAXIMUM EXTENT POSSIBLE, TO CONSERVE WATER BY USING THE FOLLOWING DEVICES AND SYSTEMS: MATCHED PRECIPITATION RATE TECHNOLOGY ON ROTOR AND SPRAY HEADS (WHEREVER POSSIBLE), RAIN SENSORS, AND SMART MULTI-PROGRAM COMPUTERIZED IRRIGATION CONTROLLERS FEATURING SENSORY INPUT CAPABILITIES.

PLANTING LEGEND

QTY	LEGEND	BOTANIC NAME	COMMON NAME	PLANTING SIZE (MINIMUM)	MATURE SIZE (H X S)	WATER USE (V.L.L.M.H)
-----	--------	--------------	-------------	-------------------------	---------------------	-----------------------

PROPOSED ROW TREES

29	GTSS	GLEDITSIA TRIACANTHOS INERMIS 'SUNBURST'	SUNBURST LOCUST	2.5" CAL B&B	50'X30'	L
2	MASP	MALLUS X 'SPRING SNOW'	SPRING SNOW CRABAPPLE	2" CAL B&B	20'X15'	L
6	QUCR	QUERCUS 'CRIMSCHMIDT'	CRIMSON SPIRE OAK	2" CAL B&B	45'X15'	M

DECIDUOUS TREES

1	ACTA	ACER TARTICUM 'GARANN'	HOT WINGS MAPLE (MULTI-STEM)	2" CAL B&B	25'X20'	L
6	ACTR	ACER TRUNCATUM X A. plat. 'JFS-KW202'	CRIMSON SUNSET MAPLE	2" CAL B&B	35'X25'	L/M
27	GLTR	GLEDITSIA TRIACANTHOS INERMIS 'SHADEMASTER'	SHADEMASTER LOCUST	2.5" CAL B&B	50'X35'	L
1	QUBI	QUERCUS BICOLOR	SWAMP WHITE OAK	2.5" CAL B&B	50'X40'	L
13	TICO	TILIA CORDATA 'GREENSPIRE'	GREENSPIRE LINDEN	2.5" CAL B&B	40'X30'	L

CONIFEROUS TREES

17	JUVI	JUNIPERUS VIRGINIANA 'SKYROCKET'	SKYROCKET JUNIPER	6-8" HT B&B	20'X5'	VL
2	PSME	PSEUDOTSUGA MENZIEI 'GLAUCA'	ROCKY MOUNTAIN DOUGLAS FIR	6-8" HT B&B	55'X25'	L
3	PIPO	PINUS PONDEROSA	PONDEROSA PINE	6-8" HT B&B	40'X25'	L

DECIDUOUS SHRUBS

87	CACL	CARYOPTERIS X CLANDONENSIS	BLUE MIST SPIREA	#5 CONT. 18-24"	3'X2'	VL
301	CHNV	CHRYSOETHAMNUS NAUSEOSUS	RABBITBRUSH	#5 CONT. 18-24"	4'X4'	VL
21	PAMA	ARCTOSTAPHYLOS 'PANCHITO'	PANCHITO MANZANITA	#5 CONT. 18-24"	2'X4'	VL
182	PEAT	PEROVSKIA ATRIPLICIFOLIA	RUSSIAN SAGE	#5 CONT. 18-24"	4'X4'	VL
4	POFR	POTENTILLA FRUTICOSA 'GOLD FINGER'	GOLD FINGER POTENTILLA	#5 CONT. 18-24"	3'X4'	L/M
46	PRBE	PRUNUS BESSEYI 'PAWNEE BUTTES'	PAWNEE BUTTES SAND CHERRY	#5 CONT. 18-24"	1.5'X4'	L
9	RHAR	RHUS AROMATICA 'GROW-LOW'	GRO-LOW FRAGRANT SUMAC	#5 CONT. 18-24"	5'X6'	L/M
95	RHRH	RHUS TRILOBATA	THREE LEAF SUMAC	#5 CONT. 18-24"	4'X4'	VL

EVERGREEN SHRUBS

130	JUHO	JUNIPERUS HORIZONTALIS 'BLUE CHIP'	BLUE CHIP JUNIPER	#5 CONT. 18-24"	1'X5'	VL
155	JUSA	JUNIPERUS SABINA 'BUFFALO'	BUFFALO JUNIPER	#5 CONT. 18-24"	1'X5'	VL
4	PIPU	PICEA PUNGENS 'GLOBOSA'	GLOBE BLUE SPRUCE	#5 CONT. 18-24"	5'X6'	L/M

ORNAMENTAL GRASSES

214	CAAC	CALAMAGROSTIS ACUTIFLORA 'KARL FOERSTER'	FEATHER REED GRASS	#1 CONT.	5'X2'	L
129	HESE	HELICTOTRICHION SEMPERVIRENS	BLUE AVENA GRASS	#1 CONT.	2.5'X2.5'	L
155	PAVI	PANICUM VIRGATUM 'SHENANDOAH'	RED SWITCH GRASS	#1 CONT.	3'X2'	L

PERENNIALS

82	ACMI	ACHILLEA MILLEFOLIUM 'PAPRIKA'	PAPRIKA YARROW	#1 CONT.	3'X2'	VL
286	SAMA	SALVIA SYLVESTRIS X 'MAINACHT'	MAY NIGHT SALVIA	#1 CONT.	2'X1.5'	VL
76	SAPA	SALVIA PACHYPHYLLA	MOJAVE SAGE	#1 CONT.	3'X2'	VL

MISCELLANEOUS

17,919 SF	--	GRASS SEED	XERISCAPE SEED MIX. SEE NOTES	SEED	--	VL
33,114 SF	--	ROCK COBBLE MULCH	25%-75% ARKANSAS RIVER ROCK TO MATCH EXISTING ADJACENT SITE	MULCH	--	--
520 LF	--	STEEL EDGING	14 GAUGE, 4" HIGH BY 1/8" THICK, BLACK COLOR	EDGER	--	--

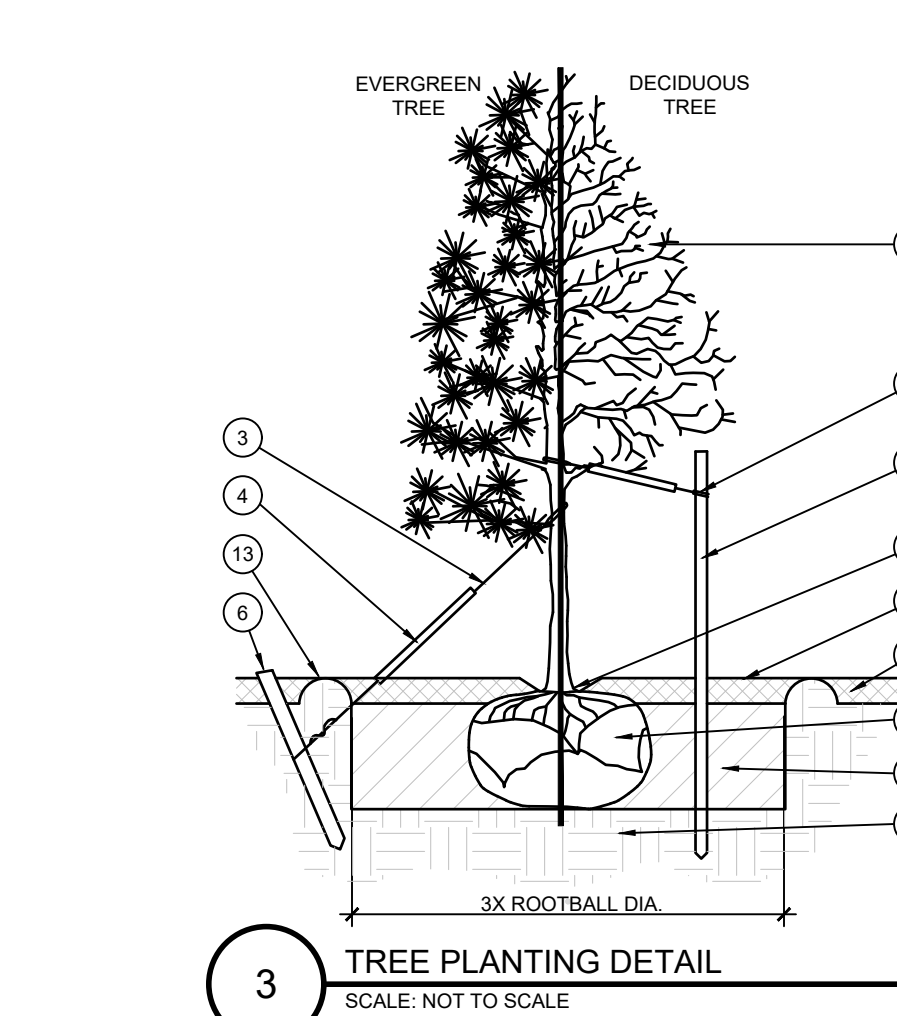
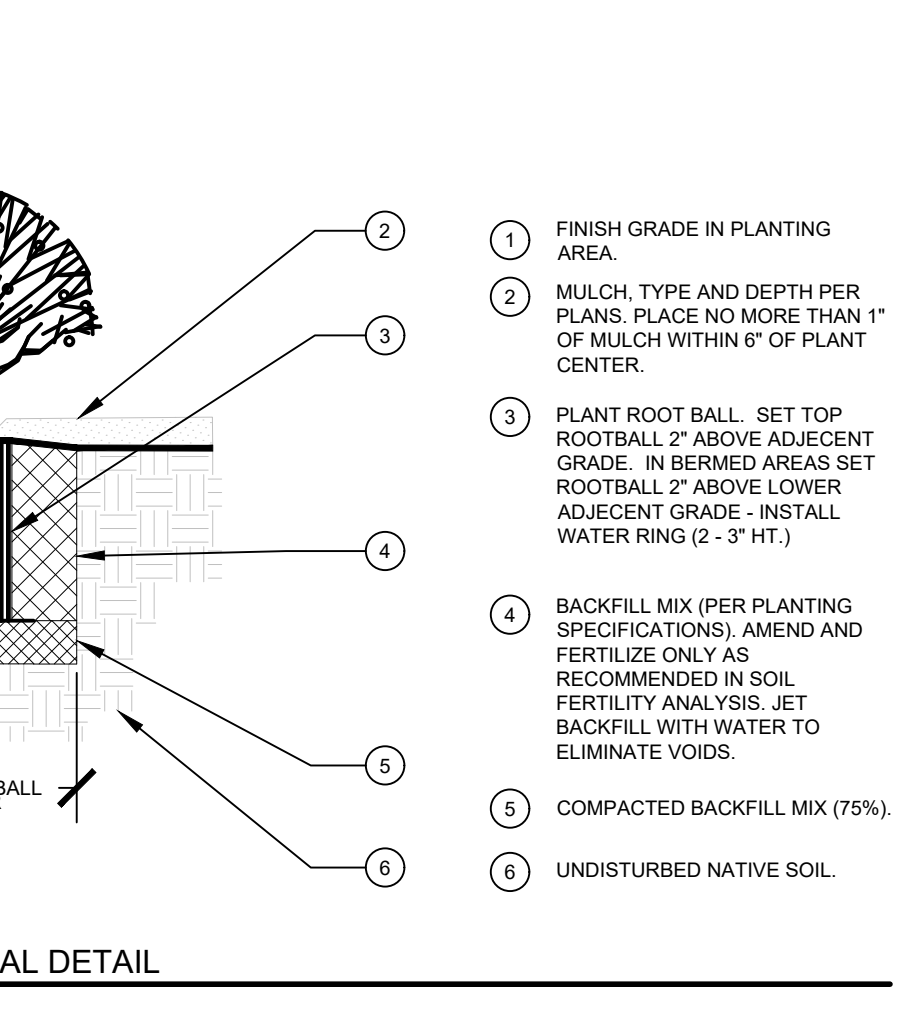
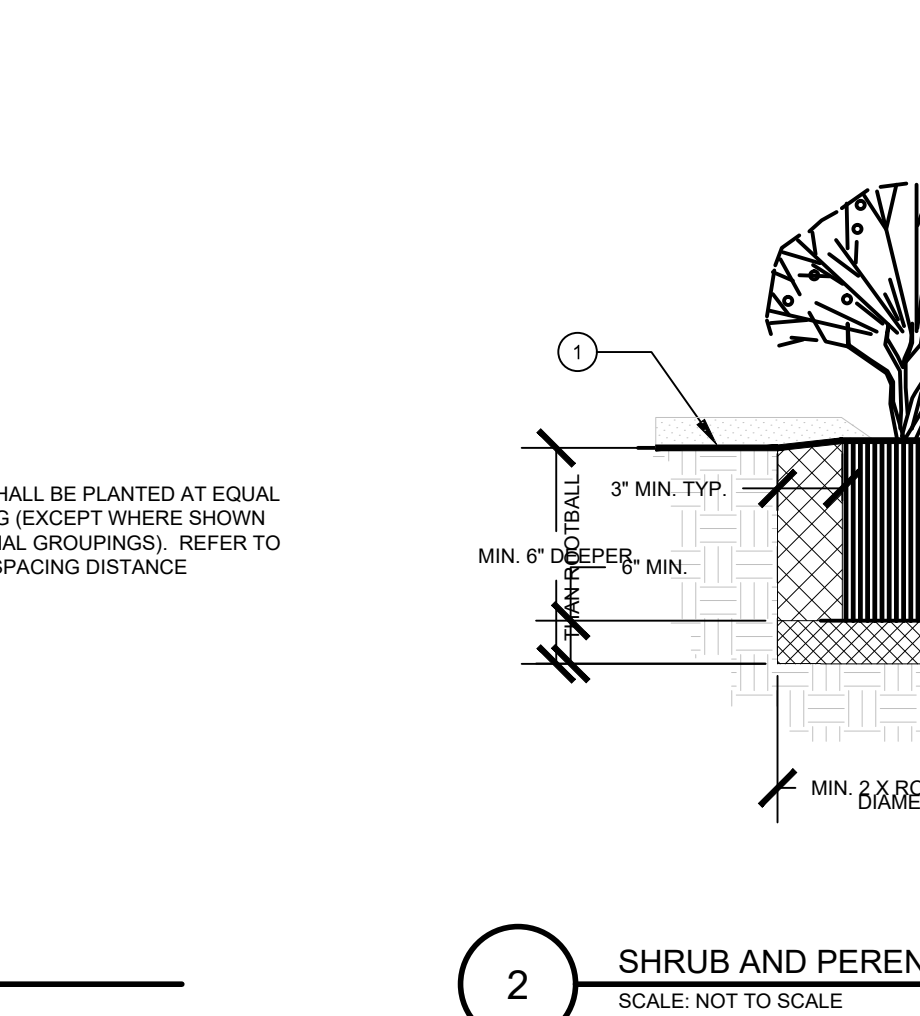
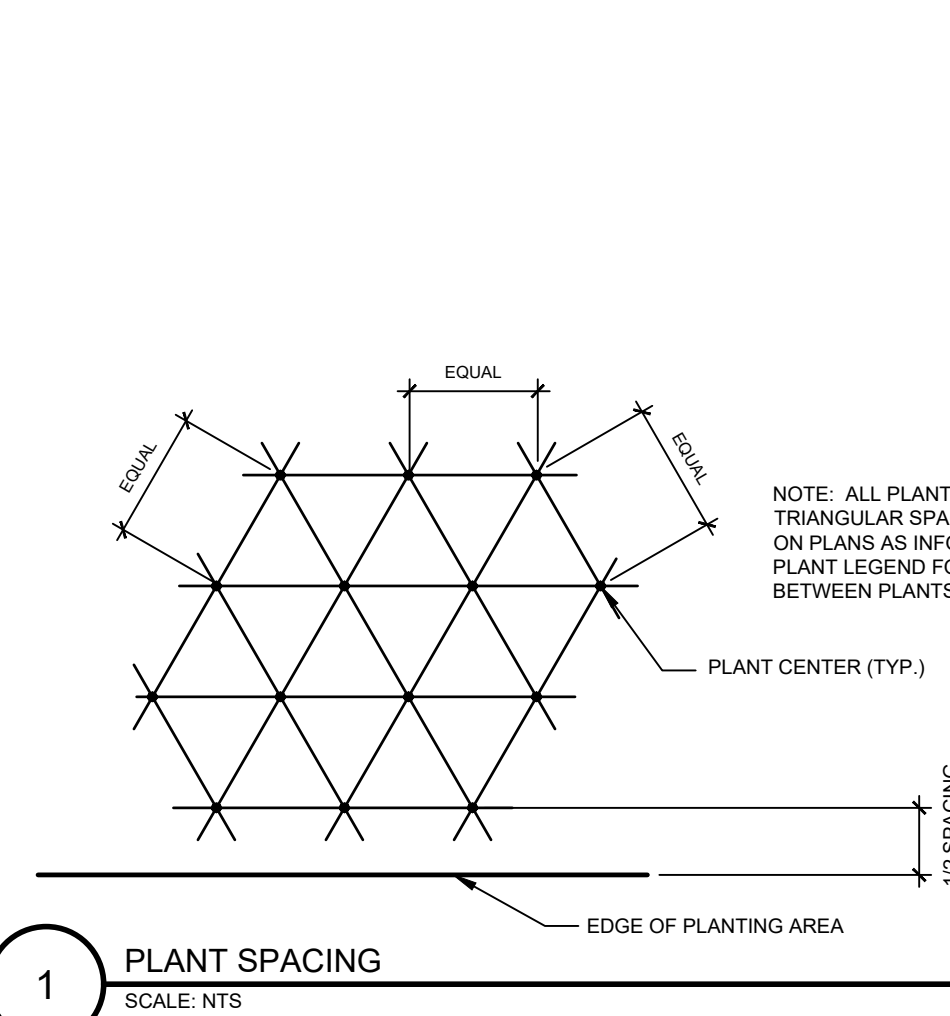

- TREE CANOPY.
- NYLON TREE STRAPS AT ENDS OF WIRES - SECURE TO STAKE OR DEADEN WITH NAILS.
- 12 GAUGE GALVANIZED WIRE, SECURE TO TRUNK JUST ABOVE LOWEST MAJOR BRANCHES.
- 24" X 3/4" P.V.C. MARKERS OVER WIRES.
- PRESSURE-TREATED WOOD STAKE, 2" DIA. EXTEND STAKES 12" MIN. INTO UNDISTURBED SOIL.
- PRESSURE-TREATED WOOD DEADEN, TWO PER TREE (MIN.). BURY OUTSIDE OF PLANTING PIT AND 18" MIN. INTO UNDISTURBED SOIL.
- TRUNK FLARE.
- WOOD MULCH TREE RING 3" DIA. MIN. TYPE AND DEPTH PER PLANS. DO NOT PLACE MULCH WITHIN 3" OF TRUNK.
- FINISH GRADE.
- ROOT BALL-SEE NOTE 3, THIS DETAIL.
- BACKFILL, AMEND AND FERTILIZE ONLY AS RECOMMENDED IN SOIL FERTILITY ANALYSIS.
- UNDISTURBED NATIVE SOIL.
- 4" HIGH EARTHEN WATERING BASIN.

COPYRIGHT
THESE PLANS ARE AN INSTRUMENT OF SERVICE AND ARE THE PROPERTY OF GALLOWAY, AND MAY NOT BE DUPLICATED, DISCLOSED, OR REPRODUCED WITHOUT THE WRITTEN CONSENT OF GALLOWAY. COPYRIGHTS AND INFRINGEMENTS WILL BE ENFORCED AND PROSECUTED.



King Soopers / Petroleum
65 Tejon Street
Denver, CO 80223
Phone (303) 778-3053
Fax (303) 871-9262

KING SOOPERS #147
FALCON MARKETPLACE
LOTS 2 & 3, BLOCK 1
7530 & 7595 FALCON MARKET PL.
FALCON, CO

#	Date	Issue / Description	Init.
1	12/16/19	2ND SDF Sub.	ACJ
2	03/30/20	3RD SDF Sub.	ACJ
3	05/29/20	4TH SDF Sub.	ACJ
4	10/02/20	5TH SDF Sub.	ACJ
5	09/24/21	6TH SDF Sub.	ACJ

Project No: KSS000147
Drawn By: JR
Checked By: JR
Date: 8/29/19

PLANTING DETAILS + NOTES

L1.6