

July 25, 2022

Angela Bellantoni, Ph.D.
Permits and Licenses Specialist
630 Plaza Drive, Suite 150
Highlands Ranch, CO 80129

This project has been referred to the Department of Public Works for comment and regarding a Haul Route Agreement/Haul Route Fee. Please coordinate with Jeff Manchester, Deputy County Engineer (719-520-6851)

Subject: Road Condition Survey for DRMS – Peyton, Colorado

Dear Dr. Bellantoni,

Y2K Engineering, LLC. (Y2K) has been retained to prepare a survey of the road conditions on Curtis Road and Garrett Road along site frontage of the existing Pioneer Sand Company in Peyton, Colorado. Pioneer Sand Company is planning to add an adjoining undeveloped parcel located to the west of the existing sand quarry, which is anticipated to add approximately 30 peak hour trips to the roadway network. **Figure 1** provides the vicinity map.

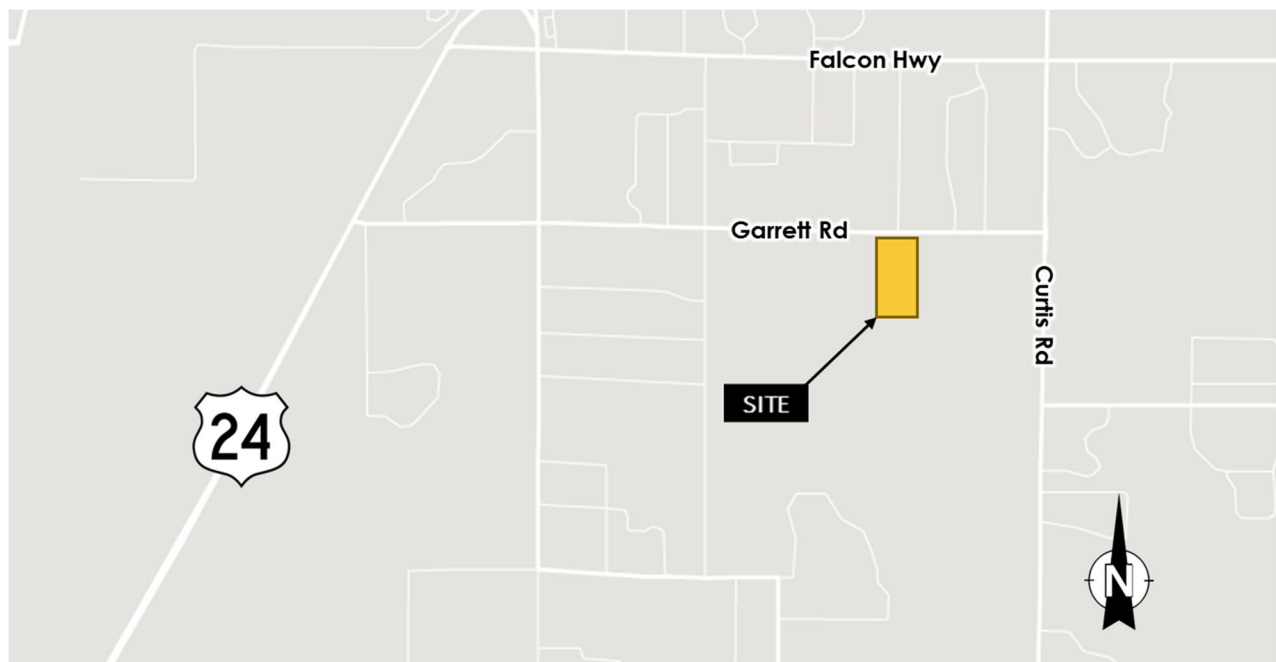

Figure 1: Vicinity Map

STUDY AREA

The study area of the survey of roadway conditions includes the following roadways:

GARRETT ROAD

Garrett road is classified as a minor arterial per the El Paso County 2016 Major Transportation Corridors Plan Update and has an east-west orientation. The roadway features one lane in each direction. Garrett Road has a posted speed limit of 45 mph. Roadway facilities such as curbs, gutter, streetlights, sidewalks, and bike lanes are not present along Garrett Road. Overhead utilities run along the north side of the roadway. Garrett Road connects to U.S. Route 24 (US 24) approximately three miles west of the project site.

CURTIS ROAD

Curtis Road is a north-south roadway classified as a principal arterial by the El Paso County 2016 Major Transportation Corridors Plan Update. Within the vicinity of the project site, Curtis Road provides one lane in each direction. The posted speed limit is 45 mph. Facilities such as curbs, gutter, streetlights, sidewalks, and bike lanes are not provided on the roadway. Overhead utilities are available on both the east and west sides of Curtis Road. Approximately 4.5 miles to the south, Curtis Road connects directly to Colorado State Highway 94 (SH-94).

ROADWAY CONDITION SURVEY

A field review was conducted at the site on Wednesday, June 22nd to observe roadway conditions. During this review, photos of the roadway were taken at approximate 300-foot intervals. At each interval, a photo of the roadway was taken facing each direction (west and east on Garrett Road, north and south on Curtis Road). Photos are provided in **Attachment A. Figure 2** shows the location of photos. Odd number photos are oriented west and north, while even number photos are oriented east and south.



Figure 2: Road Condition Locations

We appreciate the opportunity to prepare this study. Should you have any questions, please feel free to contact me by email at rstephani@y2keng.com or by phone at (720-735-5855).

Sincerely,

Y2K Engineering, LLC.

A handwritten signature in blue ink that reads 'Rae Stephani'.

Rae Stephani, PE, PTOE
Traffic Engineer



ATTACHMENT A
PHOTO LOG



PICTURE 1



PICTURE 2



PICTURE 3



PICTURE 4



PICTURE 5



PICTURE 6



PICTURE 7



PICTURE 8



PICTURE 9



PICTURE 10



PICTURE 11



PICTURE 12



PICTURE 13



PICTURE 14



PICTURE 15



PICTURE 16



PICTURE 17



PICTURE 18



PICTURE 19



PICTURE 20



PICTURE 21



PICTURE 22



PICTURE 23



PICTURE 24



PICTURE 25



PICTURE 26



PICTURE 27



PICTURE 28



PICTURE 29



PICTURE 30



PICTURE 31



PICTURE 32



PICTURE 33



PICTURE 34



PICTURE 35



PICTURE 36



PICTURE 37



PICTURE 38



PICTURE 39



PICTURE 40