

Colorado State Building Codes

2002 NATIONAL ELECTRIC CODE	OCCUPANCY GROUP: "B"
2003 INTERNATIONAL BUILDING CODE	CONSTRUCTION TYPE: V-B
2003 INTERNATIONAL MECHANICAL CODE	
2003 INTERNATIONAL ENERGY CONSERVATION CODE	WIND LOAD:
2003 INTERNATIONAL PLUMBING CODE	50MPH 3 SEC. GUSTS
1998 A117.1 HANDICAP GUIDELINES	SEISMIC DESIGN CATEGORY: S=1.25, S1=0.6, S2E CLASS=0

Design Criteria

SQUARE FOOTAGE:	1974 SF
OCCUPANCY LOAD:	20
FLOOR DEAD LOAD:	25 PSF
FLOOR LIVE LOAD:	50 PSF
ROOF DEAD LOAD:	3 PSF

Roof Snow Load

Ground Snow Load:	50 PSF
Roof Design Load:	50 PSF
Unbalanced Snow Load:	n/a PSF
Snow Exposure:	1.00
Snow Importance Factor:	1.00
Thermal Factor:	1.10

Wind Load

Wind Speed:	90 MPH
Wind Importance Factor:	1.00
Wind Exposure:	"C"
Building Category:	"B"

Seismic Load

Seismic Use Group:	"1"
Seismic Importance Factor:	"1"
Site Class:	"D"
Design Category:	"B"

- Building Notes:**
- All materials are C and B Custom Modular's standards unless otherwise specified.
 - Locate state seals, 3rd party seals and data plate on face of electrical panel.
 - All door adjustments are on site by others.
 - C and B Custom Modular Inc. is not responsible for local codes or permits.
 - Building to be located >10'-0" from existing or assumed property line and >20'-0" from an existing building.
 - Buildings on the same property shall be assumed to have a property line between them.
 - The building exterior and the facilities within the building shall be identified with the international symbol of accessibility. (Signage by others)
 - The dealer/owner shall be responsible for an site barrier free provisions, i.e. Steps, ramps, parking signs etc.
 - Building approach (walkway or ramp) to be 5'-0" wide minimum and a gradient of not more than 1" in 20'.
 - Exit doors to remain operable during business hours from the inside without the use of a key or any special knowledge.
 - Corrosion resistant flooring at top and sides of doors, windows and at roof penetrations shall be provided.
 - If required, adequate accessible restroom facilities at site by others within 500' of new structure.
 - Building shall not be located in areas that exceed those listed on the cover sheet design criteria and state codes.

- Electrical Notes:**
- All receptacles to be grounding type.
 - All wiring to be per the current code in effect.
 - Main panel to be marked "Suitable for use as service equipment" and be equipped with breaker/fuse type over current protection.
 - Proper thermal overload protection to be provided for all motors.
 - Weatherproof protection required for all outdoor lights, receptacles and disconnects.
 - Proper working clearances to be provided and maintained about all electrical equipment.
 - All fluorescent fixtures require thermal protection and proper clearances from insulation also applicable for incandescent fixtures.
 - Combination exhaust fan/light and all recessed incandescent fixtures to be thermally protected.
 - Exit lights "if electric" must be fed from an approved emergency service connected ahead of but not within main service disconnecting means enclosure and installed as per service requirements or be battery backup type units.
 - All exterior metal to be grounded per N.E.C. or applicable code.
 - In cavities used as return air chases, there shall be no exposed romex and wiring should be run in conduit/MC type cables.

FRAME - PERIMETER

MAIN 1-BEAM:	M12X10.8
CROSSMEMBER:	M10X8 1-BEAM @ 48" O.C. (M12X10.8 IN AXLE AREA) WITH RECESSED TAILLIGHTS
NOTE:	DETACHABLE W/ 2 5/16" CLIP AND JACK
HITCH:	4 W/BRAKES, SPRINGS OVERSLUNG (DUAL TANDEM ASSEMBLY)
AXLES:	75 1/2" SPRING CENTERS
NOTE:	14-PLY
TIRES:	MIN 3 MIL BLACK ASPHALT
PAINT:	

FLOOR - LONGITUDINAL

BOTTOM BOARD:	WOVEN PLASTIC INSULATION SUPPORT
NOTE:	FASTENED TO BOTTOM OF JOISTS 24" O.C. MAX.
INSULATION:	R-19 FACED FIBERGLASS
NOTE:	FACING OF INSULATION TO BE INSTALLED TIGHT TO WARMSIDE OF CAVITY.
JOISTS:	2X6 #2 SPF EQUAL OR BETTER @ 16" O.C. (LONGITUDINAL)
JOIST JOIST:	2X6 #2 SPF EQUAL OR BETTER (DOUBLE FULL PERIMETER) OVER THE FLOOR HURRICANE STRAPS
TIE DOWNS:	12
DECKING:	1ST LAYER 3/4" TAG PLYWOOD 16" O.C. MIN. SPAN INDEX. HOLDBACK TOP LAYER OF DECKING 10" EACH SIDE MATELINE
NOTE:	1/8" VINYL COMPOSITION TILE (CLASS A/1 F.S.)
COVERING:	(COLOR = #51899 COOL WHITE)

EXTERIOR WALLS

STUDS:	2X4 STUD GRADE SPF EQUAL OR BETTER @ 16" O.C.
BOTTOM PLATE:	SINGLE 2X4 #3 SPF EQUAL OR BETTER
TOP PLATE(S):	DOUBLE 2X4 #3 SPF EQUAL OR BETTER
WALL HEIGHT:	8'-0"
WALL COVERING:	1/2" VCG (CLASS A/1 F.S.) (COLOR = LOUWA BEIGE)
INSULATION:	R-13 KRAFT FACED FIBERGLASS BATTS
SHEATHING:	HOUSEWRAP UNDER SIDING
SIDING:	7/16" SMART PANEL WOOD SIDING WITH GROOVES EVERY 8" O.C. (COLOR = SW. ANTIQUE WHITE)
TRIM:	1X4 TOP, BOTTOM, MANSARD, CORNERS, DOORS AND WINDOWS (COLOR = SW. LATTIE)
TRIM:	SWIP LOOSE 1X4 MATELINE TRIM (TO MATCH SIDING/MANSARD)
SKIRTING:	17
NOTE:	SWIP LOOSE (4X9 SHEETS) 7/16" SMART PANEL SIDING (4X9 SHEETS) (COLOR = SW. ANTIQUE WHITE)

INTERIOR WALLS

STUDS:	2X4 STUD GRADE SPF EQUAL OR BETTER @ 16" O.C.
BOTTOM PLATE:	SINGLE 2X4 #3 SPF EQUAL OR BETTER
TOP PLATE(S):	DOUBLE 2X4 #3 SPF EQUAL OR BETTER
WALL HEIGHT:	8'-0"
WALL COVERING:	1/2" VCG (CLASS A/1 F.S.)
INSULATION:	R-11 UNFACED FIBERGLASS
CLOSET:	1
TRIM:	DELUXE WOOD PROFILES @ WINDOWS AND DOORS
TRIM:	VINYL BATTENS AT TOP VERTICAL SEAMS AND CORNERS
NOTES:	SWIP LOOSE BATTENS FOR WALL AND CEILING MATELINES
TRIM:	4" VINYL COVE BASE (6" IN RESTROOM)
TRIM:	(COLOR = #P182 TOFFEE)

ROOF

RAFTERS:	FLAT TRUSSES @ 16" O.C. GRADUATED IN HEIGHT
WATE-BEAM:	16" TO 23" LENGTH PER SHEET SS TRUSS#
MANSARD:	1-LAYER OF 1 1/2" X 16" 2 CE LVL PER SHEET SS SMART PANEL W/GROOVES @ 8" O.C. (SEE CROSS SECTION FOR DETAIL) (COLOR = SW LATTIE)
CEILING PANEL:	1/2" PREFINISHED GYPSUM W/VAPOR BARRIER (CLASS A/1 F.S.)
INSULATION:	R-35 UNFACED FIBERGLASS (2-LYRS R19)
SHEATHING:	7/16" OSB 16/0 SPAN INDEX W/BLAZEGUARD 0" (FOR CLASS C/3 F.S.)
ROOFING:	0.45 BLACK EPDM RUBBER ROOF FULLY ADHERED
ROOF VENTING:	3 POWERED SCREENED GABLE VENT TO ACTIVATE @ 60% RELATIVE HUMIDITY (WHITE)
ROOF VENTING:	6 NON-POWERED SCREENED GABLE VENT (WHITE 8X8)
OUTTERS:	K-80 J-RAIL

EXTERIOR DOORS

A:	2
NOTE:	35X80 TELL INS STEEL W/STEEL TELL JAMBS AND 10X10 SAFETY GLAZED LITE. HEAVY DUTY STAY CHAIN, LATCH GUARD, TELL LEVER LOCK SET #LT20015, WEATHER STRIPPING AND H/C THRESHOLD. (COLOR = COLONIAL WHITE) (KEY CODE # AT EP)

INTERIOR DOORS

B:	8
C:	2
D:	1
FOI:	1
NOTE:	36X80 SOLID CORE DOOR W/STEEL JAMBS PASSAGE LEVER SET #LT3575 AND DOOR STOP
NOTE:	36X80 SOLID CORE DOOR W/STEEL JAMBS PRIVACY LEVER SET #LT3576 AND DOOR STOP
NOTE:	26X80 SOLID CORE DOOR W/STEEL JAMBS PASSAGE LEVER SET #LT3575 AND DOOR STOP
NOTE:	36X80 FINISHED OPENING (FINISH W/PINE JAMBS)

WINDOWS

1:	11
NOTE:	WINTTECH Q225 24X53 VERTICAL SLIDER W/WHITE VINYL FRAME DOUBLE GLASS, BUG SCREEN AND WHITE MINIBLINDS

ELECTRICAL

SERVICE:	120/240V SINGLE PHASE, 3 WIRE, 60HZ W/GROUND
LOAD CENTER:	3
ENTRANCE:	16 CIRCUIT WITH MAIN 150AMP BREAKER
RACEWAY:	1 1/2" EMT CONDUIT STUB THRU FLOOR
NOTE:	ANY WIRING IN FLENUMS TO BE FLENUM RATED
MIN #12 AWG NM UP TO 40A, 3-40A IN SE TYPE WIRE (SEE WIRE SIZE TABLE)	
LIGHTS:	28
EXTERIOR LIGHTS:	2
NOTE:	1 3/4" T8-TUBE FLOURESCENT W/DIFFUSER AND ELECTRONIC BALLAST
EM-LIGHTS:	2
REMOTE HDS:	2
NOTE:	1 3/4" FLOURESCENT WP EXTERIOR LIGHT W/PHOTOCELL (300-0W-1300-120PC-3HB) EXTERIOR LTS MAY NEED TO BE SHIPPED LOOSE DUE TO SHIPPING REQUIREMENTS.
EXHAUST FAN:	2
RECEPTILES:	33
NOTE:	100 CFM EXHAUST FAN/ALT COMBO W/13" SWIB
NOTE:	120V 20A IVORY DUPLEX GROUNDING TYPE
NOTE:	120V 20A IVORY DUPLEX GFCI PROTECTED
NOTE:	120V 20A IVORY DUPLEX GFCI PROTECTED, WP FOR HEATTAPE
NOTE:	120V 20A IVORY DUPLEX GFCI PROTECTED, W/IN-USE COVER
NOTE:	120V IVORY TOGGLE TYPE (1 W/RED COVER FOR W/H DISCONNECT)
NOTE:	14 J-BOXES W/ CONDUIT STUBBED THRU FLOOR FOR PHONE/DATA (SYSTEMS TO BE INSTALLED ON SITE BY OTHERS)

PLUMBING

SUPPLY LINES:	TYPE L COPPER (PRESSURE REGULATOR VALVE SUPPLIED BY OTHERS AT SITE)
WASTE LINES:	SCHEDULE 40 P/C
NOTE:	MANIFOLDING BELOW FLOOR AND ACROSS WALLINES TO BE BY OTHERS AT SITE
WATER HEATER:	1
WATER CLOSET:	2
LAVATORY:	2
NOTE:	120V, LOCAL WATER HEATER W/PAN AND SWITCH W/RED COVER FOR DISCONNECT
NOTE:	H/C TYPE, WHITE W/ELONGATED BOWL AND GREEN FRONT SEAT W/1.6GAL FLUSH TANK
NOTE:	INSULATE W/FRAP ON H/C LAVS
NOTE:	HOT WATER TEMPERING VALVE PER ASSE 1016 AND/OR 1070
NOTE:	15X15 STAINLESS STEEL W/ GOOSENECK LEVER HANDLED FAUCET
NOTE:	2" FLOOR DRAIN
SINK:	1
FLOOR DRAIN:	2
WISC:	2
NOTE:	SETS CABBAGES (1) 36, (1) 18 AND (1) 42, 1 1/2 DIAMETER
NOTE:	18X36 BEVELED EDGE MIRROR W/CLIPS
NOTE:	1 P. HOLDER

HVAC

HEATING:	3
COOLING:	3
NOTE:	15KW 240V ELECTRIC RESISTANT HEAT IN WALL HUNG UNIT
NOTE:	3-TON 240V SINGLE PHASE BARD WALL HUNG UNIT (COLOR = BEIGE)
THERMOSTAT:	3
DUCTS:	1
DIFFUSERS:	16
RETURN AIR:	16
NOTE:	HONEYWELL DIGITAL THERMOSTAT, TH31100
NOTE:	FIBERGLASS 16" X 6" IN ROOF FOR S/A
NOTE:	FIBERGLASS 18" X 6" IN ROOF FOR R/A
NOTE:	10X10 WHITE W/ADJUSTABLE DAMPER IN CEILING
NOTE:	10X10 WHITE REGISTERS IN CEILING

SPECIALTIES

COUNTERTOP:	1
NOTE:	25' X 73' HPL COUNTER W/BACK SPLASH (COLOR = ALMOND)
BASE CABINET:	1
NOTE:	5848 MERILAT SPRING VALLEY OAK SINK BASE CABINET
WALL CABINET:	1
NOTE:	824 MERILAT SPRING VALLEY OAK BASE CABINET
NOTE:	W4824 MERILAT SPRING VALLEY OAK WALL CABINET
NOTE:	W2424 MERILAT SPRING VALLEY OAK WALL CABINET
EXTINGUISHER:	1
NOTE:	IF REQUIRED BY OTHERS AT SITE

Satellite Shelters
36 x 60 Office
35'-3" x 56'-0" Actual Size

APPROVED AS IS SIGNATURE _____ DATE _____
APPROVED AS NOTED SIGNATURE _____ DATE _____
REVISE AND RESUBMIT SIGNATURE _____ DATE _____

TRANSPORTATION IS THE RESPONSIBILITY OF THE DEALER AND/OR OWNER. CAB SHALL NOT BE RESPONSIBLE FOR ANY DAMAGE TO BUILDING CAUSED BY SHIPPING COMPANY BECAUSE OF WIDTH AND/OR HEIGHT OF UNIT

See Building Cross Section

Drawing Index

Page	Page Description
C1	Project Cover Sheet
A1	Building Elevations
A2	Production Floor Plan
E1	Production Electrical Plan
S1	Blocking Points
S1	Cross Section - Details
S3-S5	Production Front, Floor and Roof Framing Plans
P1	DWV and Fresh Water Plumbing Schematics

2224 Bloomington Drive
Bristol, Indiana 46507
PH: (574) 848-7300
FX: (574) 848-1950

Drawn:	BB	Date:	2/20/08	Plot Date:	Feb. 20, 2008
Scale:	N/A	Sheet Number:	08-15172-74	DWG File Name:	08-15172-74.dwg
Approval Numbers:					
Sheet Description:	Satellite Shelters 36 x 60 Office (35'-3" x 56'-0")				
Sheet Number:	Building Cover Sheet				

DRAWING LEGEND

SYMBOL	QTY	DESCRIPTION
▶	12	Over the floor hurricane straps/Tie down locations
⊞	3	125/240 electric panel (-30" AFF to bottom of panel)
⊞	2	Lighted 100 CFM exhaust fan combo
⊞	3	Low voltage thermostat (+43" AFF)
⊞	3	Power gable vent
⊞	15	10x10 white SA diffuser with adjustable damper.
⊞	16	10x10 R/A grille through ceiling
⊞	6	Cable vent

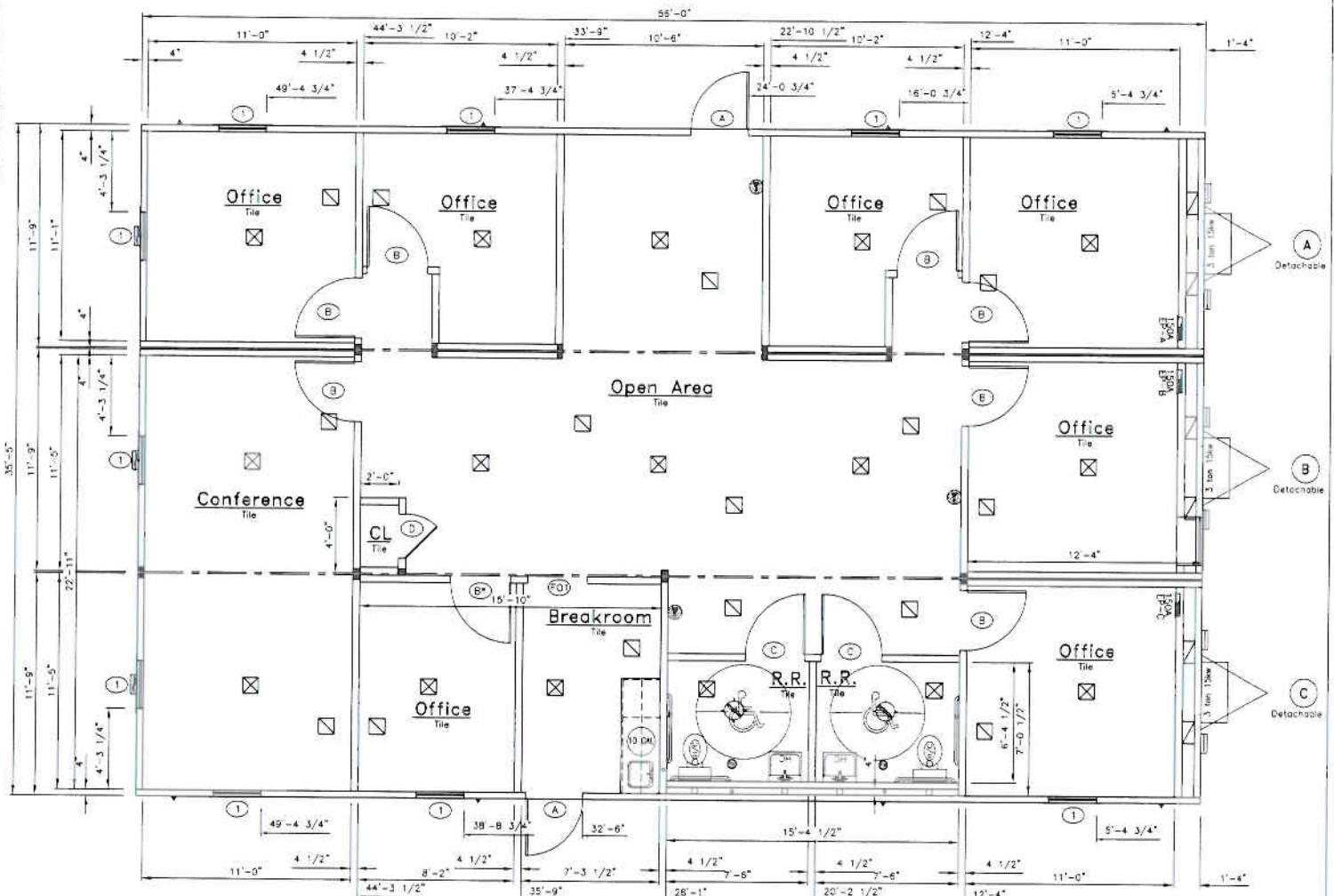

- Mechanical Notes:**
- Exhaust fans and venting equipment to be ducted to exterior and terminate at an approved vent cap.
 - Return air via grilles end/or undercut doors.
 - Materials exposed within plenum shall be noncombustible or shall have a flame spread index of not more than 25 and a smoke-developed index of not more than 50 when tested in accordance with ASTM E-84.
 - Duct exposed to non-conditioned spaces shall be insulated to provide thermal resistance.
 - The lower edge of floor and wall registers shall not be less than 1/2" from the floor in toilet, laundry and/or utility rooms.
 - Metal chimneys shall extend at least 3'-0" above the highest point that they pass through the room and 2'-0" minimum higher than other portions of a building within 10'-0".
 - Ducts shall be class 1/A flame spread.
 - Ventilation to be in conformance w/20CFM per occupant. (Offices)
 - Flexible ducts and connectors shall be installed in accessible areas only and shall not be concealed.
 - Attic to be Naturally ventilated at 1sf per 150sf or mechanically ventilated at >2cfm per SF.

APPROVED AS IS _____
 APPROVED AS NOTED _____
 REVISE AND RESUBMIT _____

TRANSPORTATION IS THE RESPONSIBILITY OF THE DEALER AND OR OWNER. C&B SHALL NOT BE RESPONSIBLE FOR ANY DAMAGE TO BUILDING CAUSED BY SHIPPING COMPANY BECAUSE OF WIDTH AND OR HEIGHT OF UNIT.

See Building Cross Section

DOOR & WINDOW SCHEDULE

SYMBOL	QTY	DESCRIPTION	ROUGH OPENING	Header
(A)	2	16x80 ins/steel door w/steel frame and 10x10 safety glazed lite, latch guard, h.d. stay chain, lever lock set, weathersstripping and 1/2" threshold	36 x 80	(2) 2x4 #2 srf on edge
(B)	1	16x80 solid core door w/steel jambs, passage lever set and door stop	36 x 81	(2) 2x4 #2 srf on edge non-structural
(C)	2	16x80 solid core door w/steel jambs, privacy lever set and door stop	36 x 81	non-structural
(D)	1	28x80 solid core door w/steel jambs, passage lever set and door stop	28 x 81	non-structural
(FO)	1	16x80 finished opening (finish w/pine jambs)	38 x 81	non-structural
(E)	11	30x53 vertical slider w/white vinyl frame double glass blinds and bug screen	30 1/4" x 53 1/4" up 26" A.F.F.	(2) 2x4 #2 srf on edge

- Notes:**
- All structural headers shall be glued, fastened and bear on (1) 2x4 jack stud #2 srf each side of opening.
 - Doors, windows and openings on end walls do not require structural header because roof trusses carry the load.

Satellite
 The First In Space

2224 Bloomingdale Drive
 Bristol, Indiana 46507
 PH: (574) 848-7300
 FX: (574) 848-1950

Date: 3/16 w 11'-0" 08
 Sheet Number: 08-15172-74 823
 Drawing Number: 08-15172-74
 Issue File Name: 08-15172-74.dwg

2224 Bloomingdale Drive
 Bristol, Indiana 46507
 PH: (574) 848-7300
 FX: (574) 848-1950

Satellite Shelters
 36 x 60 Office (35'-3" x 56'-0")
 Production Floor Plan