

2002 NATIONAL ELEM. CODE	OCCUPANCY GROUP:	"B"
2003 INTERNATIONAL BUILDING CODE	CONSTRUCTION TYPE	V-B
2003 INTERNATIONAL MECHANICAL CODE		
2003 INTERNATIONAL ENERGY CONSERVATION CODE	WIND LOAD	
2003 INTERNATIONAL PLUMBING CODE	GOMPH 3 SEC. GUSTS	
1988 A117.1 HANDICAP GUIDELINES	SEISMIC DESIGN CATEGORY:	
	Se=12.5, S1=60, SITE CLASS=0	

Design Criteria		
SQUARE FOOTAGE:	1974 SF	FRAME - PER
OCCUPANCY LOAD:	20	MAIN 1-
FLOOR DEAD LOAD:	25 PSF	CROSSW
FLOOR LIVE LOAD:	50 PSF	NOTE
ROOF DEAD LOAD:	9 PSF	HITCH

<u>Roof Snow Load</u>			NOTE
Ground Snow Load:	50 PSF		TIRES
Roof Design Load:	50 PSF		PAINT
Unbalanced Snow Load:	n/a PSF		
Snow Exposure:	1.00		FLOOR - LOW
Snow Importance Factor:	1.00		BOTTOM
Thermal Factor:	1.10		NOTE

Wind Load		NOTE
Wind Speed:	30 MPH	JOISTS:
Wind Importance Factor:	1.00	RIM JOI
Wind Exposure:	"C"	TIE DOWN
Building Category:	"2"	DECKING

Seismic Load		
Seismic Use Group:	"1"	
Seismic Importance Factor:	"1"	
Site Class:	"D"	EXTERIOR WALL
Design Category:	"B"	STUD.

- All materials are C and B Custom Modular's standards unless otherwise specified.
- Locally site stock 3rd party seats and data plate on local side of electric panel.
- All door adjustments are on site by others.
- C and B Custom Modular's Inc. is not responsible for local codes or permits.
- Building to be located  $\geq 10'-0"$  from existing or assumed property line and  $\geq 20'-0"$  from an existing building.
- Buildings on the same property shall be assumed to have a property line between them.
- The building exterior and the facilities within the building shall be labeled with the international symbol of accessibility (Signage by others).
- The owner shall be responsible for on site signage provisions, i.e. Steps, ramps, parking signs etc.
- Building approach (walkway or ramp) to be  $5'-0"$  wide minimum and a gradient of not more than 1" in 36".
- Exit doors to remain operable during business hours from the inside without the use of a key or any special knowledge.
- Corrosion resistant flashing at top and sides of doors, windows and at roof penetrations shall be provided. If required, adequate accessible restroom facilities at building with wheelchair accessible restrooms.
- Building shall not be located in areas that exceed those listed on the cover sheet design criteria and

- All receptacles to be grounding type
- All wiring to be per the current code in effect.
- Main panel to be marked "Suitable for use as service equipment" and be equipped with breaker/fuse type over current protection
- Proper thermal overload protection to be provided for all motors
- Weatherproof protection required for all outdoor lights, receptacles and disconnects.
- Proper working clearances to be provided and maintained about all electrical equipment.
- All fluorescent fixtures require thermal protection and proper clearance and insulation shall apply for incandescent fixtures.
- Combination exhaust fan/light and all recessed incandescent fixtures to be thermally protected.
- All electrical equipment must be fed from an approved emergency service connected chest of panel within main service disconnect means enclosure and installed as per service requirements or be battery operated units.
- All exterior metal to be grounded per N.E.C. or applicable code.
- In cavities used as return air chases, there shall be no exposed wiring and wiring should be run in conduit type

MAIN I-BEAM:  
CROSSMEMBER:  
NOTE:  
HITCH:  
AXLES:  
NOTE:  
TIRES:  
PAINT:

BOTTOM BOARD:  
 NOTE:  
 INSULATION:  
 NOTE:  
 JOISTS:  
 RIM JOIST:  
 TIE DOWNS:  
 DECKING:  
 NOTE:  
 COVERING:

STUDS:  
BOTTOM PLATE:  
TOP PLATE(S):  
WALL HEIGHT:  
WALL COVERING:

INSULATION:  
SHEATHING:  
SIDING:  
  
TRIM:  
  
TRIM:  
SKIRTING:

STUDS:  
BOTTOM PLATE:  
TOP PLATE(S):  
WALL HEIGHT:  
WALL COVERING:  
INSULATION:  
CLOSET:  
TRIM:  
TRIM:  
NOTES:  
TRIM:

RAFTERS:  
WAKE-BEAM:  
MANSARD:  
CEILING PANEL:  
INSULATION:  
SHEATHING:  
ROOFING:  
ROOF VENTING:  
ROOF VENTING:  
GUTTERS:

▲

B.  
C.  
D.  
E.

W12X10.8  
MIDXB 1-BEAM @ 48" O.C. (M12X10.8 IN AXLE AREA)  
WITH RECESSED TAHLIGHTS  
DETACHABLE W/ 2 5/16" CUP AND JACK  
4 W/ BRAKES, SPRINGS OVERSLUNG (DUAL TANDEM ASSEMBLY)  
75 1/2" SPRING CENTERS  
14-PLY  
MIN 3 MIL BLACK ASPHALT

WOVEN PLASTIC INSULATION SUPPORT  
FASTENED TO BOTTOM OF JOIST'S 24" O.C. MAX.  
R-19 FACED FIBERGLASS  
FACING OF INSULATION TO BE INSTALLED TIGHT TO MARMSIDE OF CAVITY.  
2XB #2 SPF EQUAL OR BETTER @ 16" O.C. (LONGITUDINAL)  
OVER THE FLOOR HURRICANE STRAPS  
1ST LAYER 3/4" T&G PLYWOOD @ 6" O.C. MIN. SPAN (NOX)  
HOLD BACK TOP LAYER OF DECKING 10' EACH SIDE WATERLINE  
1/8" VINYL COMPOSITION TILE (CLASS A/1 F.S.)  
{ COLOR = #51899 COOL WHITE }

2X4 STUD GRADE OR IF EQUAL OR BETTER @ 16" D.C.  
SINGLE 2X4 @ 3 SPF EQUAL OR BETTER  
DOUBLE 2X4 @ 3 SPF EQUAL OR BETTER  
8'-0"  
1/2" VGC (CLASS A/1 F.5.)  
(COLOR = LOAMA BEIGE)  
R-13 KRAFT FACED FIBERGLASS BATTS  
HOUSEMADE UNDER SIDING  
1X16 SMART PANEL W/UNDER SIDING WITH GROOVES EVERY 8" O.C.  
(COLOR = SH. ANTIQUE WHITE)  
1X4 TOP, BOTTOM, MANSARD, CORNERS, DOORS & WINDOWS  
(COLOR = SH. LATTE)  
1X16 LOOSE 1X4 MATELINE TRIM (TO MATCH SIDING/MANSARD)  
SH. (COLOR = SH. LATTE) 7/16" SMART PANEL SIDING (4X9 SHEETS)  
(COLOR = SH. ANTIQUE WHITE)

2X4 STUD GRADE SPF EQUAL OR BETTER @ 16" O.C.  
SINGLE 2X4 @ 3 SPF EQUAL OR BETTER  
DOUBLE 2X4 @ 3 SPF EQUAL OR BETTER  
B - 0"  
1/2" VCG (CLASS A/1 F.S.)  
R-11 UNFACED FIBERGLASS  
  
DELUXE WOOD PROFILES @ WINDOWS AND DOORS  
VINYL BATTENS AT TOP, VERTICAL SEAMS AND CORNERS  
1" x 1" CLOSE BATTENS FOR WALL AND CEILING MATELINES  
4" VINYL COVE BASE @ IN RESTROOM  
(COLOR = #P182 TOFFEE)

FLAT TRUSSES @ 16" O.C. GRADUATED IN HEIGHT  
16" TO 23" LENGTH PER SHEET 55 TRUSS#  
1-LAYER OF 1 1/2" X 16" 2 C/L VCL PER SHEET 55  
SMART PANEL W/ GROOVES @ 8" O.C. (SEE CROSS SECTION FOR DETAIL)  
(COLOR = SW LATE)  
1/2" PRE-INSULATED GYPSUM W/VAPOR BARRIER (CLASS A/1 F.S.)  
2" LAMC 4055 (2-LIBROL)  
7/16" OSB 16/0 SPAN INDEX W/ BLAZEGUARD C\* (FOR CLASS C/3 F.S.)  
45 BLACK EPDM RUBBER ROOF FULLY ADHERED  
POWERED SCREENED GABLE VENT TO ACTIVATE @ 50% RELATIVE HUMIDITY (WHITE)  
NON-POWERED SCREENED GABLE VENT (WHITE 8XB)

36X80 TELL INS STEEL W/STEEL TELL JAMBS AND 10X10 SAFETY GLAZED LITE.  
HEAVY DUTY STAY CHAIN, LATCH GUARD, TELL LEVER LOCK SET #LT2081S,  
WEATHER STRIPPING AND H/C THRESHOLD.  
(COLOR = COLONIAL WHITE ) (KEY CODE 4 AT 50)

36X80 SOLID CORE DOOR W/STEEL JAMBS  
PASSAGE LEVER SET #LT3575 AND DOOR STOP  
36X80 SOLID CORE DOOR W/STEEL JAMBS  
PRIVACY LEVER SET #LT3576 AND DOOR STOP  
26X80 SOLID CORE DOOR W/STEEL JAMBS  
PASSAGE LEVER SET #LT3575 AND DOOR STOP  
36X80 FINISHED OPENING (FINISH W/PINE JAMBS)

1

ELECTRICAL  
SERVICE  
LOAD CENTER:  
ENTRANCE:  
RACEWAY:  
NOTE:  
LIGHTS:  
EXTERIOR LIGHTS:  
NOTE:  
EW-LIGHTS  
REMOTE HOS:  
NOTE:  
EXHAUST FAN  
RECEPTACLES:

SWITCHES  
MISC:

PLUMBING  
SUPPLY LINES  
WASTE LINES:  
NOTE:  
WATER HEATER  
WATER CLOSET  
LAVATORY:  
NOTE:  
NOTE:  
SINK:  
FLOOR DRAIN:  
MISC:

HEATING:  
COOLING:  
NOTE:  
THERMOSTAT  
DUCTS:  
DUCTS:  
DIFFUSERS:  
RETURN AIR

COUNTERTOP:  
BASE CABINET:  
WALL CABINET:  
EXTINGUISHER:

1) WINTech G225 24X53 VERTICAL SLIDER W/WHITE VINYL FRAME  
DOUBLE GLASS, BUG SCREEN AND WHITE MINIBLINDS

120/240V SINGLE PHASE, 3 WIRE, 60HZ W/GROUND  
3 16 CIRCUIT WITH MAIN 150AMP BREAKER  
1 1/2" EMT CONDUIT STUB THRU FLOOR  
MIN #12 AWG NUD TO 40A, > 40A IN SE TYPE WIRE (SEE WIRE SIZE TABLE)  
ANY WIRING IN PLUMBING TO BE PLUMBING  
18 1" FLOURESCENT W/ P/UFUSER AND ELECTRONIC BALLAST  
2 13W FLOURESCENT EXTERIOR W/ P/PTCCELL (300-W-120V-120CP-3WH)  
EXTERIOR LTS MAY NEED TO BE SHIPPED LOOSE DUE TO SHIPPING REQUIREMENTS  
2 COMBO DUAL BULB FLOOR LIGHT & EXIT LIGHT W/BATT BACKUP  
3 SINGLE EXTERIOR REMOTE FOR ABOVE LT  
ATTACHMENT FOR REMOTE HEADS MAY NEED TO BE DONE AT SITE.  
1 80 CFM EXHAUST FAN/LT COMBO W/LT BULB  
3 120V 20A IVORY DUPLEX GROUNDING TYPE  
1 120V 20A IVORY DUPLEX GFCI PROTECTED  
1 120V 20A IVORY DUPLEX GFCI PROTECTED, W/F HEATPAPE  
3 120V 20A IVORY DUPLEX GFCI PROTECTED, W/IN-USE COVER  
2 120V IVORY TOGGLE TYPE (1 W/IN-USE COVER FOR W/PH DISCONNECT)  
1 J-BOXES W/ CONDUIT STUBBED THRU FLOOR FOR PHONE/DATA  
(SYSTEMS TO BE INSTALLED ON SITE BY OTHERS)

TYPE L COPPER (PRESSURE REGULATOR VALVE SUPPLIED BY OTHERS AT SITE)  
SCHEDULE 40 PVC  
MANIFOLDING BELOW FLOOR AND ACROSS WATERLINES TO BE BY OTHERS AT SITE  
1 1/2" 100' WATER HEATER W/PAN AND SWITCH W/RYT COVER FOR DISCONNECT  
2 H/C TYPE, WHITE W/ELONGATED BOWL AND GREEN FRONT SEAT W/1. SOGL FLUSH TANK  
H/C TYPE, 19X1/2 WHITE W/H/C FAUCET  
INSULATE P-TRAP ON H/C LAYS  
HOT WATER TEMPERING VALVE PER ASSE 1016 AND/OR 1070  
1 1/2" STAINLESS STEEL W/ GOOSENECK LEVER HANDLED FAUCET  
2" FLOOR DRAIN  
2 SETS GRABBERS (1) 36, (1) 18 AND (1) 42, 1 1/2" DIAMETER\*  
18X36 BEVELLED EDGE MIRROR W/CLIPS  
2" HOLDER

3 15KW 240V ELECTRIC RESISTANT HEAT IN WALL HUNG UNIT  
3 3-TON 240V SINGLE PHASE BARD WALL HUNG UNIT  
(COLOR = BEIGE)  
3 HONEYWELL DIGITAL THERMOSTAT, TH3110D  
FIBERGLASS 16" X 5" IN ROOF FOR S/A  
FIBERGLASS 16" X 5" IN ROOF FOR R/A  
16 10X10 WHITE W/ADJUSTABLE DAMPER IN CEILING.  
16 10X10 WHITE REGISTERS IN CEILING

1 25" X 73" HPL COUNTER W/BACK SPLASH  
1 (COLOR = ALMOND )  
1 SB48 MERILAT SPRING VALLEY OAK SINK BASE CABINET  
1 B24 MERILAT SPRING VALLEY OAK BASE CABINET  
1 #4B24 MERILAT SPRING VALLEY OAK WALL CABINET  
1 #2424 MERILAT SPRING VALLEY OAK WALL CABINET  
IF REQUIRED BY OTHERS AT SITE

APPROVED AS IS  
APPROVED AS NOTED  
REVISE AND RESUBMIT

TRANSPORTATION IS THE RESPONSIBILITY OF THE DEALER AND OR OWNER. C&B SHALL NOT BE RESPONSIBLE FOR ANY DAMAGE TO BUILDING CAUSED BY SHIPPING COMPANY BECAUSE OF WIDTH AND OR HEIGHT OF UNIT.

See Building Cross Section

## Drawing Index

Page	Page Description
C1	Project Cover Sheet
A1	Building Elevations
A2	Production Floor Plan
E1	Production Electrical Plan
S1	Blocking Points
S2	Cross Section / Details
S3-S5	Production Frame, Floor and Roof Framing Plans
P1	DW and Fresh Water Plumbing Schedules

ID						Date	
Revision							
Issue		Drawn:		Dates		Fair Date	
N/A	B9			2/20/08		Feb. 20, 2008	
Total Number		Drawing Number		DWG File Name			
66-1572-74		823		08-1972-74.dwg			
Approval Number:							
Title:							
Satellite Shelters							
36 x 60 Office (35'-3" x 56'-0")							
Sheet Description:							
Building Cover Sheet							
	Page C						



DRAWING		LEGEND
SYMBOL	QTY	DESCRIPTION
12	Over the floor hurricane straps/Tie down locations	
3	120/240 electric panel (-30" AFF to bottom of panel)	
2	Lighted 100 CFM exhaust fan combo	
3	Low voltage thermostat (-48" AFF)	
3	Power cable vent	
15	10x10 white SA diffuser with adjustable damper	
16	10x10 R/A grille through ceiling	
6	Cable vent	

Mark that this is the floor plan for the office.

- Mechanical Notes:**
- Exhaust fans and venting equipment to be ducted to exterior and terminate at an approved vent cap.
  - Return air via grilles end/or undercut doors.
  - Materials exposed within plenum shall be noncombustible or shall have a flame spread index of not more than 25 and a smoke-developed index of not more than 50 when tested in accordance with ASTM E-84.
  - Duct exposed to non-conditioned spaces shall be insulated to provide thermal resistance.
  - The lower edge of floor and wall registers shall not be less than 1/2" from the floor in toilet, laundry and/or utility rooms.
  - Metal chimneys shall extend at least 3'-0" above the highest point that they pass through the room and 2'-0" minimum higher than other portions of a building within 10'-0".
  - Ducts shall be class 1/A flame spread.
  - Ventilation to be in accordance w/20CFM per occupant (Offices).
  - Flexible ducts and connectors shall be installed in accessible areas only and shall not be concealed.
  - Attic to be naturally ventilated at 1sf per 150sf or mechanically ventilated at >0.2cfm per SF.

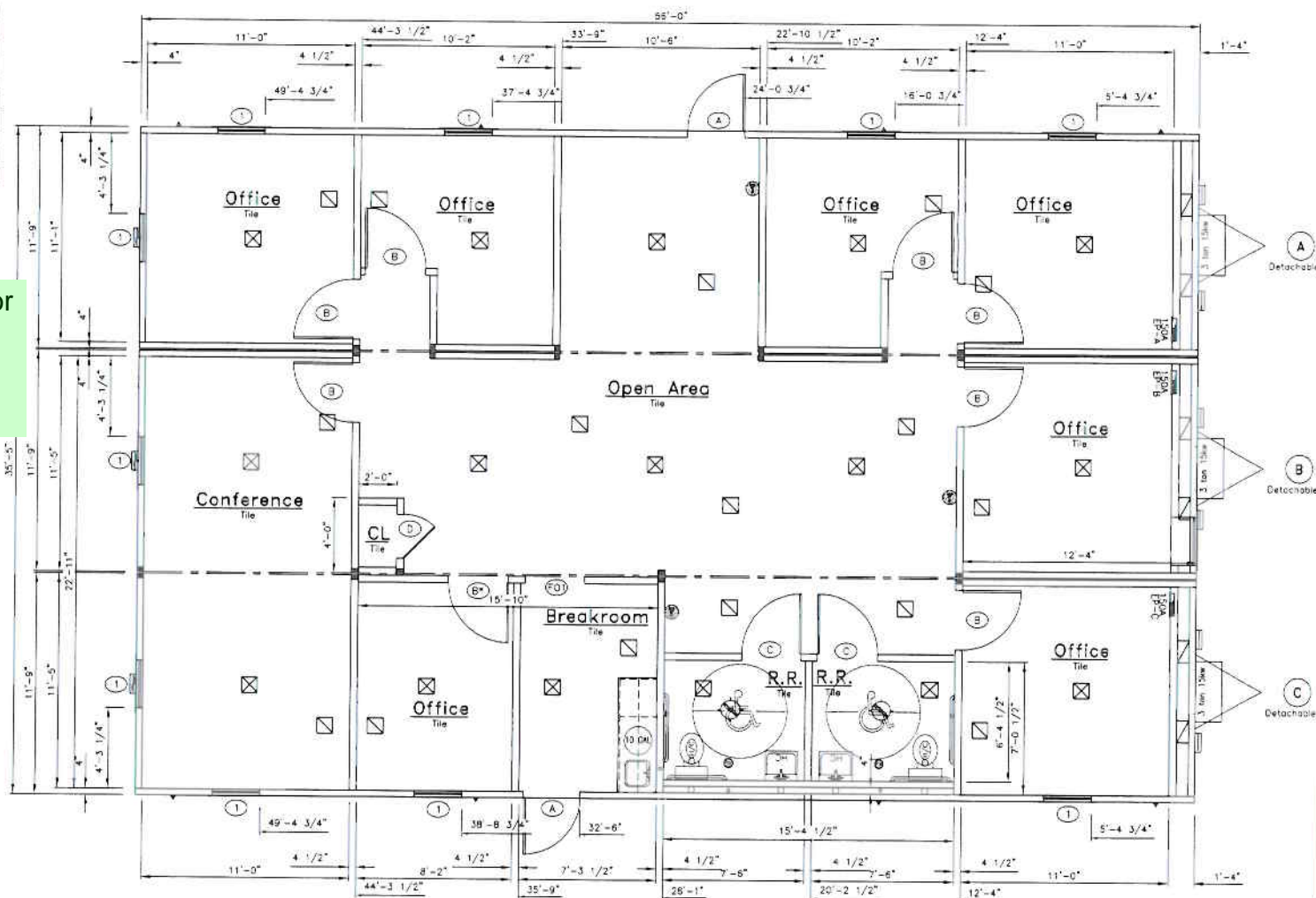

APPROVED AS IS  
APPROVED AS NOTED  
REVISE AND RESUBMIT

TRANSPORTATION IS THE RESPONSIBILITY OF THE DEALER AND OR OWNER. C&B SHALL NOT BE RESPONSIBLE FOR ANY DAMAGE TO BUILDING CAUSED BY SHIPPING COMPANY BECAUSE OF WIDTH AND OR HEIGHT OF UNIT.

See Building Cross Section

### DOOR & WINDOW SCHEDULE

SYMBOL	QTY	DESCRIPTION	ROUGH OPENING	Header
A	2	16x80 ins/steel door w/steel frame and 10x10 safety glazed tile, latch guard, h.d. stay chain, lever lock set, weatherstripping and 1/2" thresholds	36 x 80	(2) 2x4 #2 spt on edge
B	8	36x80 solid core door w/steel jambs, passage lever set and door stop	36 x 81	(2) 2x4 #2 spt on edge non-structural
C	2	36x80 solid core door w/steel jambs, privacy lever set and door stop	36 x 81	non-structural
D	1	28x80 solid core door w/steel jambs, passage lever set and door stop	28 x 81	non-structural
F01	1	36x80 finished opening (finish w/pine jambs)	36 x 81	non-structural
E	11	30x53 vertical slider w/white vinyl frame double glass blinds and bug screen	30 1/4" x 53 1/4" up 26" A.F.F.	(2) 2x4 #2 spt on edge

#### Notes:

- All structural headers shall be glued, fastened and bear on (1) 2x4 jack stud #2 spt each side of opening.
- Doors, windows and openings on end walls do not require structural header because roof trusses carry the load.

**Satellite**  
The First In Space

2224 Bloomingdale Drive  
Bristol, Indiana 46507  
PH: (574) 848-7300  
FX: (574) 848-1950

Scale: 3/16" = 1'-0" BB  
Date: 2/20/08  
Sheet Number: 08-15172-74  
Drawing Number: 823  
User File Name: 08-15172-74.dwg

Approval Numbers:  
Title: Satellite Shelters  
36 x 60 Office (35'-3" x 55'-0")  
Sheet Description: Production Floor Plan  
Page # A2

# Markup Summary

dsdkendall (1)

Mark that this is the floor plan for the office.



**Subject:** Text Box  
**Page Label:** 2  
**Author:** dsdkendall  
**Date:** 9/4/2018 11:05:29 AM  
**Color:** ■

Mark that this is the floor plan for the office.