

SOLACE APARTMENTS FILING NO. 2

A PORTION OF SECTION 7, TOWNSHIP 14 SOUTH, RANGE 65 SEST OF THE P.M.

EL PASO COUNTY, COLORADO

CONSTRUCTION DOCUMENTS

GALLEY RD. & PAONIA ST. - TRAFFIC SIGNAL PLANS

PCD NO: CDR-23-11

SHEET INDEX	
SHEET TITLE	SHEET NO.
COVER SHEET	1
CDOT M&S STANDARD DRAWINGS LIST	2
NOTES	3 - 4
SUMMARY OF QUANTITIES	5
EXISTING CONDITIONS & DEMOLITION PLAN	6
SIGNAGE AND STRIPING PLAN	7
SIGNAL PLAN	8
CONDUIT PLAN	9
GRADING DETAIL	10
DETAILS	11



VICINITY MAP
1" = 500'

CONTACTS

OWNER:
CS POWERS & GALLEY LLC
510 S NEIL ST
CHAMPAIGN, IL 61820
PHONE: (719) 216-2577
CONTACT: DANE OLMSTEAD

SURVEYOR:
JR ENGINEERING, LLC
5475 TECH CENTER DRIVE STE 235
COLORADO SPRINGS, CO 80919
TEL: 719-593-2593
CONTACT: DANIEL CLARK, P.E.

CIVIL ENGINEER:
KIMLEY-HORN AND ASSOCIATES
2 N. NEVADA AVENUE SUITE 300
COLORADO SPRINGS, CO 80903
CONTACT: KEVIN KOFFORD
PHONE: (719) 453-0181

EL PASO COUNTY:
EL PASO COUNTY
PCD DEPARTMENT
2880 INTERNATIONAL CIRCLE, SUITE 110
COLORADO SPRINGS, CO 80910
PHONE: (719) 520-6300

DEVELOPER'S SIGNATURE BLOCK

I, THE OWNER/DEVELOPER HAVE READ AND WILL COMPLY WITH THE REQUIREMENTS SPECIFIED IN THESE DETAILED PLANS AND SPECIFICATIONS.

Dane Olmstead

6/26/2023
DATE

DANE OLMSTEAD

ENGINEER'S SIGNATURE BLOCK

THESE DETAILED PLANS AND SPECIFICATIONS WERE PREPARED UNDER MY DIRECTION AND SUPERVISION. SAID PLANS AND SPECIFICATIONS HAVE BEEN PREPARED ACCORDING TO THE CRITERIA ESTABLISHED BY THE COUNTY FOR DETAILED ROADWAY, DRAINAGE, GRADING AND EROSION CONTROL PLANS AND SPECIFICATIONS AND SAID PLANS AND SPECIFICATIONS ARE IN CONFORMITY WITH THE APPLICABLE MASTER DRAINAGE PLANS AND MASTER TRANSPORTATION PLANS. SAID PLANS AND SPECIFICATIONS MEET THE PURPOSES FOR WHICH THE PARTICULAR ROADWAY AND DRAINAGE FACILITIES ARE DESIGNED AND ARE CORRECT TO THE BEST OF MY KNOWLEDGE AND BELIEF. I ACCEPT RESPONSIBILITY FOR ANY LIABILITY CAUSED BY ANY NEGLIGENT ACTS, ERRORS OR OMISSIONS ON MY PART IN PREPARATION OF THE DETAILED PLANS AND SPECIFICATIONS

Kevin Kofford

6/26/2023
DATE

KEVIN KOFFORD, PE - KIMLEY-HORN AND ASSOCIATES, INC.



EL PASO COUNTY REVIEW STATEMENT

COUNTY PLAN REVIEW IS PROVIDED ONLY FOR GENERAL CONFORMANCE WITH COUNTY DESIGN CRITERIA. THE COUNTY IS NOT RESPONSIBLE FOR THE ACCURACY AND ADEQUACY OF THE DESIGN DIMENSIONS AND/OR ELEVATIONS WHICH SHALL BE CONFIRMED AT THE JOB SITE. THE COUNTY THROUGH THE APPROVAL OF THIS DOCUMENT ASSUMES NO RESPONSIBILITY FOR COMPLETENESS AND/OR ACCURACY OF THIS DOCUMENT.

FILED IN ACCORDANCE WITH THE REQUIREMENTS OF THE EL PASO COUNTY LAND DEVELOPMENT CODE, DRAINAGE CRITERIA MANUAL VOLUMES 1 AND 2, AND ENGINEERING CRITERIA MANUAL, AS AMENDED.

IN ACCORDANCE WITH ECM SECTION 1.12, THESE CONSTRUCTION DOCUMENTS WILL BE VALID FOR CONSTRUCTION FOR A PERIOD OF 2 YEARS FROM THE DATE SIGNED BY THE EL PASO COUNTY ENGINEER. IF CONSTRUCTION HAS NOT STARTED WITHIN THOSE 2 YEARS, THE PLANS WILL NEED TO BE RESUBMITTED FOR APPROVAL, INCLUDING PAYMENT OF REVIEW FEES AT THE PLANNING AND COMMUNITY DEVELOPMENT DIRECTORS DISCRETION.

APPROVED
Engineering Department

06/28/2023 1:17:22 PM

dotnijkamp

EPC Department of Public Works

JOSHUA PALMER, P.E.
COUNTY ENGINEER / ECM ADMINISTRATOR

GENERAL NOTE:

THE PARTIES RESPONSIBLE FOR THIS PLAN HAVE FAMILIARIZED THEMSELVES WITH ALL CURRENT ACCESSIBILITY CRITERIA AND SPECIFICATIONS AND THE PROPOSED PLAN REFLECTS ALL THE SITE ELEMENTS REQUIRED BY THE APPLICABLE ADA DESIGN STANDARDS AND GUIDELINES AS PUBLISHED BY THE UNITED STATES DEPARTMENT OF JUST. APPROVAL OF THIS PLAN BY EL PASO COUNTY DOES NOT ASSURE COMPLIANCE WITH THE ADA OR ANY REGULATIONS OR GUIDELINES ENACTED OR PROMULGATED UNDER OR WITH RESPECT TO SUCH LAWS.

BENCHMARK

FIMS MONUMENT F81, BEING MONUMENTED BY A 3-1/4" ALUMINUM CAP IN RANGE BOX WITH NO TOP, LOCATED 900 FEET EAST OF THE INTERSECTION OF E. PLATTE AVENUE AND VALLEY STREET, APPROXIMATELY 80 FEET NORTH OF THE CENTERLINE OF E PLATTE AVENUE. SAID MONUMENT HAVING A PUBLISHED ELEVATION OF 6275.86 FEET, NAVD88

NO.	REVISION	BY	DATE	APPR

Kimley»Horn
2023 KIMLEY-HORN AND ASSOCIATES, INC.
2 North Nevada Avenue, Suite 900
Colorado Springs, Colorado 80903 (719) 453-0180

DESIGNED BY: KRK
DRAWN BY: RES
CHECKED BY: EJK
DATE: 06/26/2023

SOLACE APARTMENTS FILING NO. 2
CONSTRUCTION DOCUMENTS
GALLEY RD & PAONIA ST - TRAFFIC SIGNAL PLANS
COVER SHEET

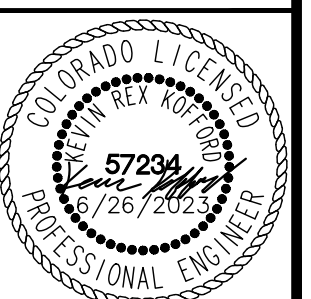

PROJECT NO.
096668009

SHEET

1



PLAN NUMBER	M STANDARD TITLE	PAGE NUMBER
<input type="checkbox"/>	M-100-1 STANDARD SYMBOLS (3 SHEETS)	1-3
<input type="checkbox"/>	M-100-2 ACRONYMS AND ABBREVIATIONS (4 SHEETS)	4-7
<input type="checkbox"/>	M-203-1 APPROACH ROADS	8
<input type="checkbox"/>	M-203-2 DITCH TYPES	9
<input type="checkbox"/>	M-203-11 SUPERELEVATION CROWNED AND DIVIDED HIGHWAYS (3 SHEETS)	10-12
<input type="checkbox"/>	M-203-12 SUPERELEVATION STREETS (2 SHEETS)	13-14
<input type="checkbox"/>	M-206-1 EXCAVATION AND BACKFILL FOR STRUCTURES (2 SHEETS)	15-16
<input type="checkbox"/>	M-206-2 EXCAVATION AND BACKFILL FOR BRIDGES (2 SHEETS)	17-18
<input type="checkbox"/>	M-208-1 TEMPORARY EROSION CONTROL (11 SHEETS)	19-29
<input type="checkbox"/>	M-210-1 MAILBOX SUPPORTS (2 SHEETS)	30-31
<input type="checkbox"/>	M-214-1 NURSERY STOCK DETAILS	32
<input type="checkbox"/>	M-216-1 SOIL RETENTION COVERING (2 SHEETS)	33-34
<input type="checkbox"/>	M-412-1 CONCRETE PAVEMENT JOINTS (9 SHEETS)	35-39 <i>(REVISED ON JANUARY 31, 2022)</i>
<input type="checkbox"/>	M-412-2 CONCRETE PAVEMENT CRACK REPAIR (6 SHEETS)	 <i>(REVISED ON SEPTEMBER 6, 2022)</i>
<input type="checkbox"/>	M-510-1 STRUCTURAL PLATE PIPE H-20 LOADING	40
<input type="checkbox"/>	M-601-1 SINGLE CONCRETE BOX CULVERT (CAST-IN-PLACE) (2 SHEETS)	41-42
<input type="checkbox"/>	M-601-2 DOUBLE CONCRETE BOX CULVERT (CAST-IN-PLACE) (2 SHEETS)	43-44
<input type="checkbox"/>	M-601-3 TRIPLE CONCRETE BOX CULVERT (CAST-IN-PLACE) (2 SHEETS)	45-46
<input type="checkbox"/>	M-601-10 HEADWALL FOR PIPES	47
<input type="checkbox"/>	M-601-11 TYPE "S" SADDLE HEADWALLS FOR PIPE	48
<input type="checkbox"/>	M-601-12 HEADWALLS AND PIPE OUTLET PAVING	49
<input type="checkbox"/>	M-601-20 WINGWALLS FOR PIPE OR BOX CULVERTS (2 SHEETS)	50-51
<input type="checkbox"/>	M-603-1 METAL PIPE (4 SHEETS)	52-55
<input type="checkbox"/>	M-603-2 REINFORCED CONCRETE PIPE	56
<input type="checkbox"/>	M-603-3 PRECAST CONCRETE BOX CULVERT	57 <i>(REVISED ON SEPTEMBER 10, 2020)</i>
<input type="checkbox"/>	M-603-4 CORRUGATED POLYETHYLENE PIPE (AASHTO M294) AND CORRUGATED POLYPROPYLENE PIPE (AASHTO M330) (2 sheets)	58 <i>(REVISED ON MARCH 7, 2022)</i>
<input type="checkbox"/>	M-603-5 POLYVINYL CHLORIDE (PVC) PIPE (AASHTO M304)	59
<input type="checkbox"/>	M-603-6 STEEL REINFORCED POLYETHYLENE RIBBED PIPE (AASHTO MP 20)	60
<input type="checkbox"/>	M-603-10 CONCRETE AND METAL END SECTIONS	61
<input type="checkbox"/>	M-603-12 TRAVERSABLE END SECTIONS AND SAFETY GRATES (3 SHEETS)	62-64
<input type="checkbox"/>	M-604-10 INLET, TYPE C	65
<input type="checkbox"/>	M-604-11 INLET, TYPE D	66
<input type="checkbox"/>	M-604-12 CURB INLET TYPE R (2 SHEETS)	67-68
<input type="checkbox"/>	M-604-13 CONCRETE INLET TYPE 13	69
<input type="checkbox"/>	M-604-20 MANHOLES (3 SHEETS)	70-72
<input type="checkbox"/>	M-604-25 VANE GRATE INLET (5 SHEETS)	73-77 <i>(REVISED ON FEBRUARY 3, 2023)</i>
<input type="checkbox"/>	M-605-1 SUBSURFACE DRAINS	78

PLAN NUMBER	M STANDARD TITLE	PAGE NUMBER
<input type="checkbox"/>	M-606-1 MIDWEST GUARDRAIL SYSTEM TYPE 3 W-BEAM 31 INCHES (19 SHEETS)	79-97 <i>(REVISED ON MARCH 5, 2020)</i>
<input type="checkbox"/>	M-606-13 GUARDRAIL TYPE 7 F-SHAPE BARRIER (4 SHEETS)	98-101
<input type="checkbox"/>	M-606-14 PRECAST TYPE 7 CONCRETE BARRIER (4 SHEETS)	102-104 <i>(REVISED ON FEBRUARY 9, 2023)</i>
<input type="checkbox"/>	M-606-15 GUARDRAIL TYPE 9 SINGLE SLOPE BARRIER (11 SHEETS)	105-115 <i>(REVISED ON FEBRUARY 17, 2023)</i>
<input type="checkbox"/>	M-607-1 WIRE FENCES AND GATES (3 SHEETS)	116-118
<input type="checkbox"/>	M-607-2 CHAIN LINK FENCE (3 SHEETS)	119-121
<input type="checkbox"/>	M-607-3 BARRIER FENCE	122
<input type="checkbox"/>	M-607-4 DEER FENCE, GATES, AND GAME RAMPS (7 SHEETS)	123-127 <i>(REVISED ON JULY 13, 2020)</i>
<input type="checkbox"/>	M-607-10 PICKET SNOW FENCE	128
<input type="checkbox"/>	M-607-15 ROAD CLOSURE GATE (9 SHEETS)	129-137
<input type="checkbox"/>	M-608-1 CURB RAMPS (10 SHEETS)	138-147
<input type="checkbox"/>	M-609-1 CURBS, GUTTERS, AND SIDEWALKS (4 SHEETS)	148-151
<input type="checkbox"/>	M-611-1 CATTLE GUARD (2 SHEETS)	152-153
<input type="checkbox"/>	M-611-2 DEER GUARD (2 SHEETS)	154-155
<input type="checkbox"/>	M-614-1 RUMBLE STRIPS (3 SHEETS)	156-158
<input type="checkbox"/>	M-614-2 SAND BARREL ARRAYS (2 SHEETS)	159-160
<input type="checkbox"/>	M-615-1 EMBANKMENT PROTECTOR TYPE 3	161
<input type="checkbox"/>	M-615-2 EMBANKMENT PROTECTOR TYPE 5	162
<input type="checkbox"/>	M-616-1 INVERTED SIPHON	163
<input type="checkbox"/>	M-620-1 FIELD LABORATORY CLASS 1	164
<input type="checkbox"/>	M-620-2 FIELD LABORATORY CLASS 2 (2 SHEETS)	165-166
<input type="checkbox"/>	M-620-11 FIELD OFFICE CLASS 1	167
<input type="checkbox"/>	M-620-12 FIELD OFFICE CLASS 2	168
<input type="checkbox"/>	M-629-1 SURVEY MONUMENTS (2 SHEETS)	169-170

PLAN NUMBER	S STANDARD TITLE	PAGE NUMBER
<input type="checkbox"/>	S-612-1 DELINEATOR INSTALLATIONS (8 SHEETS)	171-178 <i>(REVISED ON JANUARY 19, 2023)</i>
<input type="checkbox"/>	S-613-1 ROADWAY LIGHTING (6 SHEETS)	179-186 <i>(REVISED ON SEPTEMBER 30, 2020)</i>
<input type="checkbox"/>	S-613-2 ALTERNATIVE ROADWAY LIGHTING (4 SHEETS)	 <i>(NEW, ISSUED ON SEPTEMBER 30, 2020)</i>
<input type="checkbox"/>	S-614-1 GROUND SIGN PLACEMENT (2 SHEETS)	187-188
<input checked="" type="checkbox"/>	S-614-2 CLASS I SIGNS	189
<input type="checkbox"/>	S-614-3 CLASS II SIGNS	190
<input type="checkbox"/>	S-614-4 CLASS III SIGNS (3 SHEETS)	191-193
<input type="checkbox"/>	S-614-5 BREAK-AWAY SIGN SUPPORT DETAILS FOR CLASS III SIGNS (2 SHEETS)	194-195
<input type="checkbox"/>	S-614-6 CONCRETE FOOTINGS AND SIGN ISLANDS FOR CLASS III SIGNS (2 SHEETS)	196-197
<input type="checkbox"/>	S-614-8 TUBULAR STEEL SIGN SUPPORT DETAILS (7 SHEETS)	198-204 <i>(REVISED ON DECEMBER 29, 2020)</i>
<input type="checkbox"/>	S-614-9 PEDESTRIAN PUSH BUTTON POST ASSEMBLY (2 SHEETS)	205-206 <i>(SUPERSEDED ON JANUARY 23, 2020 BY S-614-45)</i>
<input type="checkbox"/>	S-614-10 MARKER ASSEMBLY INSTALLATIONS	207
<input type="checkbox"/>	S-614-11 MILEPOST SIGN DETAIL FOR HIGH SNOW AREAS	208
<input type="checkbox"/>	S-614-12 STRUCTURE NUMBER INSTALLATION (2 SHEETS)	209-210
<input type="checkbox"/>	S-614-14 FLASHING BEACON AND SIGN INSTALLATIONS (4 SHEETS)	211-214
<input type="checkbox"/>	S-614-20 TYPICAL POLE MOUNT SIGN INSTALLATIONS	215
<input type="checkbox"/>	S-614-21 CONCRETE BARRIER SIGN POST INSTALLATIONS (2 SHEETS)	216-217 <i>(REVISED ON SEPTEMBER 21, 2020)</i>
<input type="checkbox"/>	S-614-22 TYPICAL MULTI-SIGN INSTALLATIONS	218
<input type="checkbox"/>	S-614-40 TYPICAL TRAFFIC SIGNAL 30'-75' DOUBLE MAST ARMS 65'-75' SINGLE MAST ARMS (5 SHEETS)	219-223 <i>(REVISED ON JULY 22, 2022)</i>
<input checked="" type="checkbox"/>	S-614-40A ALTERNATIVE TRAFFIC SIGNAL 25'-55' SINGLE MAST ARMS (4 SHEETS)	224-227 <i>(REVISED ON JULY 22, 2022)</i>
<input type="checkbox"/>	S-614-41 TEMPORARY SPAN WIRE SIGNALS (13 SHEETS)	228-240
<input checked="" type="checkbox"/>	S-614-42 CABINET FOUNDATION DETAIL (4 SHEETS)	241-244
<input checked="" type="checkbox"/>	S-614-43 TRAFFIC LOOP AND MISCELLANEOUS SIGNAL DETAILS (8 SHEETS)	245-252
<input checked="" type="checkbox"/>	S-614-44 PEDESTAL POLE SIGNALS (2 SHEETS)	253-254
<input checked="" type="checkbox"/>	S-614-45 PEDESTRIAN PUSH BUTTON POST ASSEMBLY DETAILS (6 SHEETS)	255-266 <i>(REVISED ON DECEMBER 3, 2020)</i>
<input type="checkbox"/>	S-614-50 STATIC SIGN MONOTUBE STRUCTURES (12 SHEETS)	267-280
<input type="checkbox"/>	S-614-60 DYNAMIC SIGN MONOTUBE STRUCTURES (14 SHEETS)	281-289
<input type="checkbox"/>	S-627-1 PAVEMENT MARKINGS (9 SHEETS)	290-299 <i>(REVISED ON JULY 22, 2022)</i>
<input type="checkbox"/>	S-630-1 TRAFFIC CONTROLS FOR HIGHWAY CONSTRUCTION (26 SHEETS)	300-313 <i>(REVISED ON JANUARY 20, 2023)</i>
<input type="checkbox"/>	S-630-2 BARRICADES, DRUMS, CONCRETE BARRIERS (TEMP.) AND VERTICAL PANELS	314
<input type="checkbox"/>	S-630-3 FLASHING BEACON (PORTABLE) DETAILS	315
<input type="checkbox"/>	S-630-4 STEEL SIGN SUPPORT (TEMPORARY) INSTALLATION DETAILS (2 SHEETS)	316-317
<input type="checkbox"/>	S-630-5 PORTABLE RUMBLE STRIPS (TEMPORARY) (2 SHEETS)	318-319
<input type="checkbox"/>	S-630-6 EMERGENCY PULL-OFF AREA (TEMPORARY)	320
<input type="checkbox"/>	S-630-7 ROLLING ROADBLOCKS FOR TRAFFIC CONTROL (3 SHEETS)	321-323

COLORADO
DEPARTMENT OF TRANSPORTATION
M&S STANDARDS PLANS LIST
 July 31, 2019
 Revised on February 17, 2023

ALL OF THE M&S STANDARD PLANS, AS SUPPLEMENTED AND REVISED, APPLY TO THIS PROJECT WHEN USED BY DESIGNATED PAY ITEM OR SUBSIDIARY ITEM.

THE M&S STANDARD PLANS USED TO DESIGN THIS PROJECT ARE INDICATED BY A MARKED BOX AND WILL BE ATTACHED TO THE PLANS. ALL OTHER M&S STANDARD PLANS ARE STILL ELIGIBLE FOR USE IN CONSTRUCTION IF APPROVED BY AN APPROPRIATE CDOT ENGINEER.

Computer File Information		Sheet Revisions	
Creation Date: 07/31/19		Date:	Comments
Designer Initials: JBK	<input type="checkbox"/>		
Last Modification Date: 02/17/23	<input type="checkbox"/>		
Detailer Initials: LTA	<input type="checkbox"/>		
CAD Ver.: MicroStation V8 Scale: Not to Scale Units: English	<input type="checkbox"/>		

Colorado Department of Transportation
 2829 West Howard Place
 CDOT HQ, 3rd Floor
 Denver, CO 80204
 Phone: 303-757-9021 FAX: 303-757-9868
 Construction Engineering Services JBK

STANDARD
PLANS LIST
 Issued by the Project Development Branch: July 31, 2019

STANDARD PLAN NO.
STANDARDS PLANS LIST
Standard Sheet No. 1 of 1
 Project Sheet Number:

NO.
REVISION
BY
DATE

Kimley»Horn

2023 KIMLEY-HORN AND ASSOCIATES, INC.
2 North Nevada Avenue, Suite 900
Colorado Springs, Colorado 80903 (719) 453-0180

DESIGNED BY: KRK
DRAWN BY: RES
CHECKED BY: EUG
DATE: 06/26/2023

SOLACE APARTMENTS FILING NO. 2

CONSTRUCTION DOCUMENTS
GALLEY RD & PAONIA ST - TRAFFIC SIGNAL PLANS
CDOT M&S STANDARD DRAWINGS LIST

PROJECT NO.
096668009

SHEET

2

EL PASO COUNTY TRAFFIC SIGNAL NOTES:

- 1. THE CONTRACTOR SHALL PROVIDE, FOR REVIEW, BY THE ENGINEER, A COMPLETE TRAFFIC SIGNAL MATERIAL SUBMITTAL PACKAGE THAT CONTAINS, ALL OF THE PROPOSED TRAFFIC SIGNAL EQUIPMENT, INCLUDING MATERIAL SPECIFICATIONS AND DESCRIPTIONS THAT WILL BE NECESSARY TO COMPLETE THE TRAFFIC SIGNAL WORK. THE CONTRACTOR SHALL ALLOW FOR A MINIMUM THREE WEEK SUBMITTAL REVIEW PERIOD AND SHALL NOT ORDER ANY SIGNAL EQUIPMENT UNTIL AFTER A REVIEW OF ALL SUBMITTALS HAVE BEEN COMPLETED BY THE ENGINEER AND VERIFIED BY THE CONTRACTOR.
2. FUNCTIONAL AND OPERATIONAL RESPONSIBILITY FOR ALL NEWLY INSTALLED AND EXISTING TRAFFIC SIGNAL EQUIPMENT WILL BECOME THE RESPONSIBILITY OF THE CONTRACTOR UNTIL FINAL ACCEPTANCE OF THE PROJECT. THE CONTRACTOR SHALL CONSIDER THIS WORK INCIDENTAL TO THE OVERALL WORK BEING PERFORMED AND SHALL BE INCLUDED AS PART OF THE PROJECT.
3. SEE COLORADO DEPARTMENT OF TRANSPORTATION SIGNAL DETAILS FOR CONSTRUCTION/ INSTALLATION DETAILS NOT SHOWN ON THESE PLANS.
4. ALL SIGNAL EQUIPMENT REMOVED BY THE CONTRACTOR SHALL BE SALVAGED AND BECOME THE PROPERTY OF EL PASO COUNTY. THE SALVAGED EQUIPMENT SHALL BE DELIVERED AS DIRECTED BY THE ENGINEER. DELIVERY OF THE SIGNAL EQUIPMENT WILL NOT BE PAID FOR SEPARATELY, BUT WILL BE INCLUDED IN THE WORK FOR REMOVAL OF TRAFFIC SIGNAL EQUIPMENT.
5. OVERHEAD STREET NAME SIGN DESIGN AND LAYOUT INFORMATION SHALL BE PER THE STREET NAME SIGN DETAIL CONTAINED IN THE PROJECT PLAN.
6. TRAFFIC SIGNS MOUNTED ON SIGNAL POLES, MAST ARMS, AND PEDESTALS SHALL BE MOUNTED USING BANDING, ALUMINUM CHANNELS, AND BACKING ZEES PER APPLICABLE CDOT STANDARD PLANS, OR SIMILAR RIGID SIGN BRACING MOUNTING ASSEMBLY.
7. ONCE THE PROFESSIONAL ENGINEERING CONSULTANT HAS COMPLETED ALL TRAFFIC SIGNAL CONTROLLER TIMING DEVELOPMENT AND CONTROLLER PROGRAMMING, THE CONTRACTOR WILL COORDINATE THE DELIVERY DATE OF THE PROGRAMMED TRAFFIC SIGNAL CONTROLLER FOR REVIEW OF EPC DEPARTMENT OF PUBLIC WORKS, HIGHWAY DIVISION SIGNAL SHOP AND ALLOW FOR A MINIMUM TWO WEEK REVIEW PERIOD, AFTER WHICH TIME THE CONTRACTOR MAY MAKE ARRANGEMENTS FOR PICKING UP THE SIGNAL CONTROLLER.
8. CONTROLLER CABINET SHALL BE FURNISHED WITH A "BEST" DOOR LOCK KIT LOCK AND CODE IS "BEST": 5L6R LEFT AND RIGHT.
9. CONDUIT IS TO BE REPLACED IN THE EVENT THAT EXISTING CONDUIT IS DAMAGED AND AS DIRECTED BY THE ENGINEER.
10. ELECTRICAL SERVICE DISCONNECT BOXES SHALL BE LOCKABLE AND WEATHER PROOF WITH NEMA TYPE CIRCUIT BREAKER. ENCLOSURES SHALL BE PROVIDED AT THE CONNECTION POINT OF EACH POWER SOURCE OR POINT OF SERVICE AS DIRECTED BY THE ENGINEER.
11. THE CONTRACTOR SHALL FURNISH AND INSTALL ALL WIRING REQUIRED TO COMPLETE THE INSTALLATION AND ESTABLISH THE FUNCTIONALITY OF ALL TRAFFIC SIGNAL EQUIPMENT.
12. ALL INCIDENTAL ITEMS NOT SHOWN IN THE SUMMARY OF APPROXIMATE QUANTITIES OR TABULATION OF SIGNAL EQUIPMENT SHALL BE CONSIDERED TO BE INCLUDED AS PART OF THE TRAFFIC SIGNAL INSTALLATION AND WILL NOT BE MEASURED AND PAID FOR SEPARATELY. ALL QUANTITIES ARE APPROXIMATE. THE CONTRACTOR SHALL BE RESPONSIBLE FOR ALL WORK NECESSARY TO COMPLETE THE CONSTRUCTION SHOWN ON THESE PLANS.
13. THE SIGNAL SHALL NOT BE TURNED ON OR STARTED UNTIL DIRECTED BY THE ENGINEER. PRIOR TO SIGNAL ACTIVATION, THE ENGINEER SHALL CONFIRM THAT THE APPROPRIATE PAVEMENT MARKINGS AND SIGNING ARE IN PLACE AND THAT ALL WORK NECESSARY FOR PROPER SIGNAL OPERATION HAS BEEN COMPLETED.
14. THE SIGNAL CONTROLLER SHALL BE A MCCAIN 2070 FLEX ATC CONTROLLER W/ RACK MOUNT, C1 CONNECTOR, AND OMNI SOFTWARE. THE CONFLICT MONITOR SHALL BE MODEL 2010 ECLIP W/ ETHERNET PORT (EDI) AND DYMEC 3170 EMX MANAGED INDUSTRIAL ETHERNET SWITCH 8X10/100/100 TX PORT. ETHERNET GATEWAY SHALL BE MICROHARD BULLET LTE-NA CELLULAR GATEWAY. CITEL ETHERNET SURGE PROTECTION (RJ45, MJB-POE-A) SHALL BE USED. THE CONTROLLER CABINET SHALL BE A MCCAIN 350I ATC WITH BATTERY BACKUP, AUX RACK AND SHALL CONTAIN ANTI-GRAFFITI SILVER FINISH COATING. CLARY UNINTERRUPTIBLE POWER SUPPLY SP1250 LX, 6 BATTERY, 302C NO SNMP, W/ BATTERY DRAWER SHOULD BE USED. THE CABINET SHALL BE MOUNTED ON A CAST-IN-PLACE CONCRETE FOUNDATION PER APPLICABLE CDOT STANDARDS STANDARD PLAN AND THE CABINET SHALL BE POSITIONED SUCH THAT, WITH THE FRONT DOOR OPEN, BOTH THE CONTROLLER DISPLAY AND THE SIGNAL INSTALLATION BE VISIBLE.
15. LUMINAIRES SHALL CONSIST OF AN ASSEMBLY THAT UTILIZES LEDS AS THE LIGHT SOURCE. IN ADDITION, A COMPLETE LUMINAIRE SHALL CONSIST OF A HOUSING, LED ARRAY, AND ELECTRONIC DRIVER (POWER SUPPLY). ALL LUMINAIRES SHALL BE WIRED 120 VOL TS AC WITH MUL TL-TAP HEADS. THE LED FIXTURE MUST HAVE A COLOR TEMPERATURE OF 4100K (+/- 500K), MUST BE DESIGNED TO OPERATE AT A TEMPERATURE RANGE OF -40°F TO 105°F (-40°C TO 40°C) AND PROVIDE A MINIMUM OF 70,000 HOURS OF OPERATION. LUMINAIRES SHALL BE E-LIGHT-STAR LED STREET LIGHT, OR APPROVED EQUAL. THE CONTRACTOR SHALL PROVIDE A RECOMMENDATION FOR TYPE OF THE STREET LIGHT BASED ON THE CONSTRUCTION PLANS AND MANUFACTURER'S SPECIFICATIONS, TO BE APPROVED BY THE ENGINEER. THE FIXTURE MUST BE CAST ALUMINUM, PROVIDED WITH FUSING, SURGE SUPPRESSION AND MUST BE UL LISTED FOR WET LOCATIONS. THE FIXTURE MUST HAVE AN INTERNAL WEATHER-TIGHT LED DRIVE. NO ACTIVE COOLING FEATURES (FANS, ETC.) WILL BE ALLOWED. THE FINISHED SHALL MATCH THE EXTENSION ARM SHAFTS. THE LUMINAIRES WILL BE INSTALLED ON 15 FOOT EXTENSION ARM SHAFTS AT NOMINAL HEIGHT OF 40 FEET AND SHALL BE WELDED TO THE SIGNAL POLE PER CDOT TYPICAL TRAFFIC SIGNAL INSTALLATION DETAILS STANDARD PLAN S-614-40. LUMINAIRE ARM SHAFT SHALL BE IN ACCORDANCE WITH THE PROJECT PLANS.
16. THE INTERSECTION DETECTION SYSTEM (MICROWAVE VEHICLE DETECTION SYSTEM) CONTRACT ITEM INCLUDES DEVICE INSTALLATION (I.E., DETECTOR UNIT, HARDWARE, WIRING, PROCESSOR MODULE, ETC.), AND VERIFICATION OF SUCCESSFUL IN-FIELD DETECTION ZONE OPERATION BASED ON SEVERAL VEHICLE ACTUATIONS IN ALL DETECTION ZONES.

- 17. THE CONTRACTOR SHALL COORDINATE THE SCHEDULES OF THE CONTRACTED PROFESSIONAL ENGINEERING CONSULTANT AND THE EPC DEPARTMENT OF PUBLIC WORKS, HIGHWAY DIVISION TRAFFIC SIGNAL STAFF FOR SCHEDULING THE ON-SITE FIELD IMPLEMENTATION OF ALL TRAFFIC SIGNAL TIMING AND OPERATIONAL PROGRAMMING, VEHICLE DETECTION ZONE PLACEMENT, AND DETECTION EQUIPMENT POSITIONING. THIS WORK SHALL BE SCHEDULED NEAR THE END OF THE PROJECT, PRIOR TO PROJECT ACCEPTANCE, AND ONLY AFTER ALL FINAL PAVEMENT MARKINGS, SIGNING, AND TRAFFIC SIGNAL WORK HAS BEEN COMPLETED.
18. THE MICROWAVE RADAR DETECTION SYSTEM SHALL UTILIZE MS SEDCO INTERSECTOR-SBE MICROWAVE VEHICLE PRESENCE SENSOR 2.0, WITH INTERFACE BOARD (4 OUTPUTS, SINGLE CABINET SLOT).
19. PEDESTRIAN SIGNAL HEAD INSTALLATION SHALL INCLUDE ALUMINUM AND POWDER COATED GLOSS BLACK SIGNAL HEAD WITH APPROVED LED COUNTDOWN DISPLAY, ALUMINUM OPEN VISOR WITH THE OUTSIDE POWDER COATED GLOSS BLACK, PUSHBUTTON, AND INSTRUCTIONAL R10-3E COUNTDOWN PEDESTRIAN ACTUATION SIGN. PUSHBUTTONS SHALL BE POLARA NAVIGATOR INS23TN1-B-ES BLACK INS-UNIVERSAL NAVIGATOR W/ 9"x15" R10-3E SIGN, NO BRAILLE, CUSTOM VOICE, AND 2-WIRE PUSH BUTTONS, OR APPROVED EQUIVALENT (GEN 4 AUDIBLE). CUSTOM MESSAGING SHALL NOT INTERFERE WITH TRADITIONAL NON-VISUAL FORMATS SPECIFIED IN 4E OF THE MUTCD AND SHALL ONLY PROVIDE ADDITIONAL INFORMATION AS DIRECTED BY THE ENGINEER.
20. ALL TRAFFIC SIGNAL POLES, MAST ARMS, PEDESTALS, AND LUMINAIRE ARMS SHALL HAVE A GLOSS BLACK COAT FINISH OVER HOT DIP GALVANIZED BASE COAT, INSTALLED IN ACCORDANCE WITH THE PAINT MANUFACTURER'S INSTRUCTIONS.
21. ALL SIGNAL POLE AND CONTROLLER LOCATIONS SHOWN ARE APPROXIMATE ONLY. MAST ARMS SHALL BE OF SUFFICIENT LENGTH AND DESIGN TO ALLOW PROPER PLACEMENT OF SIGNAL HEADS AND OVERHEAD SIGNING PER THE PLANS. ACTUAL LOCATIONS SHALL BE STAKED IN THE FIELD AND FIELD VERIFIED BY THE ENGINEER PRIOR TO DRILLING, EXCAVATION, AND ORDERING THE SIGNAL EQUIPMENT AND MAST ARMS. THE LOCATION OF EACH SIGNAL POLE FOUNDATION SHALL BE POTHOLED PRIOR TO DRILLING TO CONFIRM WHETHER OR NOT ANY UTILITY CONFLICTS EXIST.
22. LATERAL OFFSETS FROM THE NEAR EDGE OF TRAFFIC SIGNAL POLES, PEDESTALS, AND CABINETS TO THE FACE OF CURB OR EDGE OF PAVED SHOULDER SHOULD BE AT LEAST SIX FEET, HOWEVER, A MINIMUM LATERAL OFFSET OF AT LEAST FOUR FEET MAY BE PROVIDED FOR CURB OFFSETS. IF NO PAVED SHOULDER EXISTS, A MINIMUM LATERAL OFFSET OF AT LEAST EIGHT FEET SHOULD BE PROVIDED FROM THE EDGE OF PAVEMENT FOR AN AUXILIARY LANE AND A MINIMUM LATERAL OFFSET OF AT LEAST TWELVE FEET SHOULD BE PROVIDED FROM THE EDGE OF PAVEMENT FOR A THROUGH LANE.
23. SHOULD THE CONTRACTOR ENCOUNTER WATER IN THE CAISSON, ANY DE-WATERING METHODS AND NECESSARY PERMITS SHALL BE INCLUDED IN THE COST OF THE CAISSON AND WILL BE CONSIDERED INCIDENTAL TO THE WORK.
24. ALL TRAFFIC SIGNAL COMPONENT PULL BOXES SHALL BE PRE CAST HIGH DENSITY POLYMER CONCRETE (HDPC) MATERIAL WITH THE FOLLOWING SIZES: 36 INCH X 48 INCH X 24 INCH (CDOT TYPE 5) FOR THE PULL BOX ADJACENT TO THE CONTROLLER CABINET FOUNDATION AND 24 INCH X 36 INCH X 24 INCH (CDOT TYPE 4) FOR THE REMAINING PULL BOXES.
25. TRAFFIC PULL BOX LOCATIONS SHOWN IN THE PROJECT PLANS ARE APPROXIMATE. ACTUAL LOCATIONS SHALL BE VERIFIED IN THE FIELD BY THE ENGINEER. PULL BOXES SHALL BE FLUSH WITH THE FINISHED GROUND SURFACE AND SHALL NOT BE PLACED IN AREAS THAT ARE SUSCEPTIBLE TO WATER RUNOFF OR STANDING WATER. CONDUIT RUNS BETWEEN PULL BOXES SHALL NOT EXCEED APPROXIMATELY 200 FEET AND PULL BOXES SHALL NOT BE LOCATED IN HANDICAP RAMPS, PEDESTRIAN LANDING AREAS, SIDEWALKS, PRIMARY SIDEWALK PATHS, OR ROADWAY PAVEMENT AREAS.
26. THE CONDUIT NUMBER AND SIZES FOR TYPICAL CONDUIT RUNS INCLUDE THE FOLLOWING FOR A PREEMINENT MAST ARM SIGNAL INSTALLATION.
A. BETWEEN THE SIGNAL POLE FOUNDATION AND ADJACENT SIGNAL POLE PULL BOX: TWO (2) 2 INCH AND ONE (1) 3 INCH.
B. BETWEEN SIGNAL PULL BOXES: TWO (2) 2 INCH AND THREE (3) 3 INCH.
C. BETWEEN THE CONTROLLER CABINET FOUNDATION AND ADJACENT PULL BOX: THREE (3) 2 INCH AND FOUR (4) 3 INCH.
D. BETWEEN THE SECONDARY SERVICE PEDESTAL METER FOUNDATION AND THE CONTROLLER CABINET FOUNDATION ONE (1) 2 INCH FOR THE ELECTRICAL SERVICE FEED.
27. ALL CONDUIT AND FITTINGS SHALL BE SCHEDULE 80 PVC AND ALL CONDUIT SHALL HAVE A PULL ROPE LEFT IN THEM WHEN CONSTRUCTION IS COMPLETED. ALL CONDUIT ENTERING THE CABINET FOUNDATION AND PULL BOXES SHALL HAVE BELL END STYLE COUPLINGS ON ALL CONDUIT ENDS.
28. ALL CONDUIT THAT IS DIRECTIONALLY BORED SHALL BE A MINIMUM OF THREE FEET BELOW THE EXISTING PAVEMENT. THIS WORK SHALL AVOID DISTURBING OR DAMAGING EXISTING FACILITIES AND THE CONTRACTOR SHALL BE RESPONSIBLE FOR THE PROMPT RECONSTRUCTION, ALTERATION, REPAIR OR MAINTENANCE OF HIGHWAY PROPERTY, AS NECESSARY, TO REPAIR DAMAGE CAUSED BY THE ACCOMMODATION OF THE UTILITY, AND TO RESTORE THE HIGHWAY TO PRE-EXISTING OR BETTER CONDITIONS.
29. ALL SIGNAL CABLE SHALL BE CONTINUOUS FROM CONNECTIONS MADE IN THE HANDHOLE COMPARTMENT OF THE SIGNAL POLE BASE TO THE TERMINAL COMPARTMENT OF THE CONTROLLER CABINET AND SHALL CONTAIN NO SPLICES. EACH SIGNAL HEAD SHALL CONTAIN SEPARATE AND CONTINUOUS SIGNAL CABLE FROM THE SIGNAL HEAD TO THE ABOVE GROUND HANDHOLE AT THE BASE OF THE SIGNAL POLE AND SHALL CONTAIN NO SPLICES.
30. A SEPARATE AND CONTINUOUS 21 CONDUCTOR CABLE SHALL RUN FROM THE CONTROLLER CABINET TO THE HANDHOLE AT EACH SIGNAL POLE AND SHALL CONTAIN NO SPLICES.

- 31. ALL SIGNS MOUNTED ON SIGNAL POLES, MAST ARMS, AND PEDESTALS SHALL BE MOUNTED USING BANDING ALUMINUM CHANNELS, AND BACKING ZEES PER CDOT TYPICAL POLE MOUNT SIGN INSTALLATION STANDARD PLAN S-614-20, OR SIMILAR RIGID SIGN BRACING MOUNTING ASSEMBLY, AS DIRECTED BY THE ENGINEER. MAST ARM SIGNS THAT REQUIRE Z-BRACKETS SHALL BE MOUNTED ON ASTRO-STYLE BRACKETS AND RISERS. THE COST OF ALL HARDWARE FITTINGS, TOOLS, AND EQUIPMENT NECESSARY FOR A COMPLETE INSTALLING OF MAST ARM SIGNS WILL NOT BE MEASURED AND PAID FOR SEPARATELY BUT SHALL BE INCLUDED IN THE COST OF THE WORK.
32. ALL CONDUCTORS AND CABINET WIRING SHALL BE COLOR CODED AND PERMANENTLY TAGGED PER ENGINEER DIRECTION AND IN ACCORDANCE WITH THE SIGNAL PHASE NUMBERING AND DETECTION ZONE PHASE NUMBERING INFORMATION CONTAINED IN THE PROJECT PLANS.
33. ALL VEHICLE SIGNAL HEADS SHALL HAVE APPROVED 12 INCH LED INDICATIONS AND SHALL BE ALUMINUM WITH POWDER COATED GLOSS BLACK FINISH AND SHALL CONTAIN 12 INCH ALUMINUM TUNNEL VISORS WITH THE OUTSIDE POWDER COATED GLOSS BLACK. ALL VEHICLE SIGNAL HEADS SHALL HAVE ALUMINUM LOUVERED BACK PLATES WITH POWDER COATED GLOSS BLACK FINISH AND YELLOW RETRO REFLECTIVE BORDER. MAST ARM SIGN HEADS SHALL USE ASTRO- TYPE MOUNTING ASSEMBLIES AND SHALL BE INSTALLED APPROXIMATELY LEVEL WITH ONE ANOTHER AT A 17 TO 19 FOOT VERTICAL CLEARANCE ABOVE THE HIGH POINT OF THE PAVEMENT EDGE.
34. FINAL VEHICLE DIRECTION ZONE PLACEMENT AND DIMENSIONS, IN ACCORDANCE WITH THE PROJECT, PLAN AND FINAL SIGNAL PROGRAMMING SHALL BE COMPLETED IN THE FIELD AND THE CONTRACTOR SHALL CONTACT THE ENGINEER FOR COORDINATING AND SCHEDULING THIS WORK.
35. ALL VEHICLE AND PEDESTRIAN SIGNAL HEADS THAT HAVE NOT BEEN PLACED IN SERVICE SHALL BE COVERED WITH PREFABRICATED WEATHER RESISTANT NYLON FROM FITTING SIGNAL FACE COVER MATERIAL. THE SIGNAL FACE SHALL REMAIN COMPLETELY COVERED UNTIL THE SIGNAL HEAD IS PLACED IN SERVICE AND IS FULLY FUNCTIONAL AND OPERATIONAL.
36. ALL DETECTION EQUIPMENT, DETECTION ZONES, AND SIGNAL TIMING OPERATION SHALL BE CONFIRMED IN THE FIELD BY THE PROFESSIONAL ENGINEERING CONSULTANT TO BE ACHIEVING SATISFACTORY TRAFFIC SIGNAL OPERATION.
37. COMMUNICATION SYSTEM WILL BE A DYMEC ETHERNET SWITCH KY-3170EMX AND CELLULAR MODEM MICROHARD BULLET LTE, WITH CITEL SURGE SUPPRESSION ON ALL THESE COMPONENTS.
38. THE CONTRACTED PROFESSIONAL ENGINEERING TRAFFIC SIGNAL TIMING, CONTROLLER PROGRAMMING AND OPERATION AND OVERALL TRAFFIC SIGNAL OPERATIONAL CONSULTANT SERVICES THAT ARE TO BE RETAINED BY THE OWNER/DEVELOPER/DISTRICT SHALL INCLUDE, BUT NOT BE LIMITED TO:
A. DEVELOPING ALL TRAFFIC SIGNAL TIMING AND ALL OPERATIONAL PARAMETERS FOR ACHIEVING ISOLATED, FULL-ACTUATED VEHICLE AND PEDESTRIAN INTERSECTION OPERATION AND, WHEN DOCUMENT TO BE NECESSARY, COORDINATED SIGNAL SYSTEM TIMING PLAN OPERATION DURING VARIOUS TIMES OF THE DAY.
B. PROGRAMMING ALL SIGNAL TIMING PARAMETERS INTO THE TRAFFIC SIGNAL CONTROLLER.
C. FIELD IMPLEMENTING AND FINE-TUNING PARAMETERS INTO THE TRAFFIC SIGNAL CONTROLLER.
D. FIELD IMPLEMENTING AND FINE-TUNING/ADJUSTING ALL TRAFFIC SIGNAL TIMING PARAMETERS, INCLUDING FOLLOW-UP FIELD REVIEWS AS MAY BE NECESSARY.

ALL OF THE AFOREMENTIONED CONTRACTED PROFESSIONAL ENGINEERING TRAFFIC SIGNAL OPERATIONAL CONSULTANT SERVICED DELIVERABLES SHALL BE CONSISTENT WITH NATIONAL PUBLICATIONS, INCLUDING BUT NOT LIMITED TO: MANUAL ON UNIFORM TRAFFIC CONTROL DEVICES (MUTCD) LATEST EDITION/REVISION, FHWA-HOP-08-024 "TRAFFIC SIGNAL TIMING MANUAL" (JUNE 2008), FHWA-HRT-04-091 "SIGNALIZED INTERSECTIONS: INFORMATION GUIDE" (AUGUST 2004), FHWA-HOP-06-006 "TRAFFIC CONTROL SYSTEMS HANDBOOK" (OCTOBER 2005), FHWA-DTFH61-01-C-00183 "SIGNAL TIMING PROCESS FINAL REPORT" (DECEMBER 2003), NCHRP REPORT 731 "GUIDELINES FOR TIMING YELLOW AND ALL-RED INTERVALS AT SIGNALIZED INTERSECTIONS" (2012), NCHRP REPORT 812 "SIGNAL TIMING MANUAL SECOND EDITION" 2015).

- NOTE:
- 1. THE TRAFFIC SIGNAL CONTROLLER CONTRACT ITEM IS TO BE INCLUSIVE OF ETHERNET SWITCH, CELLULAR GATEWAY, AND SURGE PROTECTION
 - 2. THE TRAFFIC SIGNAL CONTROLLER CABINET CONTRACT ITEM IS TO BE INCLUSIVE OF FOUNDATION PAD AND CLARY UNINTERRUPTIBLE POWER SUPPLY
 - 3. POWER SOURCE WIRE IS TO BE CAT5E OUTDOOR CABLE (CMXT 350 MHz, SOLID, 24 AWG, FOIL WATERPROOF TAPE 1000F/ROLL)

K:\COS_LA\196140002 - Cimarron Hills\Phase 2\CADD\PlanSheets\SIG\196140002 - SIG_NOTES.dwg Schmeibach, Ryan 6/26/2023 2:35 PM

NO.	REVISION	BY	DATE



DESIGNED BY: KRK
DRAWN BY: RES
CHECKED BY: EJG
DATE: 06/26/2023

SOLACE APARTMENTS FILING NO. 2
CONSTRUCTION DOCUMENTS
GALLEY RD & PAONIA ST - TRAFFIC SIGNAL PLANS
NOTES

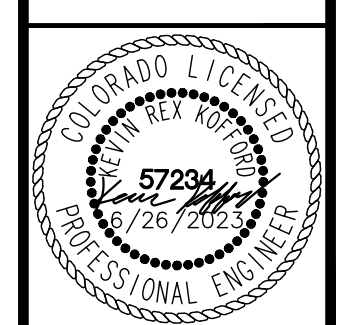

PROJECT NO.
09668009
SHEET
3

STANDARD NOTES FOR EL PASO COUNTY CONSTRUCTION PLANS

- 1. ALL DRAINAGE AND ROADWAY CONSTRUCTION SHALL MEET THE STANDARDS AND SPECIFICATIONS OF THE CITY OF COLORADO SPRINGS/EL PASO COUNTY DRAINAGE CRITERIA MANUAL, VOLUMES 1 AND 2, AND THE EL PASO COUNTY ENGINEERING CRITERIA MANUAL.
- 2. CONTRACTOR SHALL BE RESPONSIBLE FOR THE NOTIFICATION AND FIELD NOTIFICATION OF ALL EXISTING UTILITIES, WHETHER SHOWN ON THE PLANS OR NOT, BEFORE BEGINNING CONSTRUCTION. LOCATION OF EXISTING UTILITIES SHALL BE VERIFIED BY THE CONTRACTOR PRIOR TO CONSTRUCTION. CALL 811 TO CONTACT THE UTILITY NOTIFICATION CENTER OF COLORADO (UNCC).
- 3. CONTRACTOR SHALL KEEP A COPY OF THESE APPROVED PLANS, THE GRADING AND EROSION CONTROL PLAN, THE STORMWATER MANAGEMENT PLAN (SWMP), THE SOILS AND GEOTECHNICAL REPORT, AND THE APPROPRIATE DESIGN AND CONSTRUCTION STANDARDS AND SPECIFICATIONS AT THE JOB SITE AT ALL TIMES, INCLUDING THE FOLLOWING:
 - a. EL PASO COUNTY ENGINEERING CRITERIA MANUAL (ECM)
 - b. CITY OF COLORADO SPRINGS/EL PASO COUNTY DRAINAGE CRITERIA MANUAL, VOLUMES 1 AND 2
 - c. COLORADO DEPARTMENT OF TRANSPORTATION (CDOT) STANDARD SPECIFICATIONS FOR ROAD AND BRIDGE CONSTRUCTION
 - d. CDOT M & S STANDARDS
- 4. NOTWITHSTANDING ANYTHING DEPICTED IN THESE PLANS IN WORDS OR GRAPHIC REPRESENTATION, ALL DESIGN AND CONSTRUCTION RELATED TO ROADS, STORM DRAINAGE AND EROSION CONTROL SHALL CONFORM TO THE STANDARDS AND REQUIREMENTS OF THE MOST RECENT VERSION OF THE RELEVANT ADOPTED EL PASO COUNTY STANDARDS, INCLUDING THE LAND DEVELOPMENT CODE, THE ENGINEERING CRITERIA MANUAL, THE DRAINAGE CRITERIA MANUAL, AND THE DRAINAGE CRITERIA MANUAL VOLUME 2. ANY DEVIATIONS FROM REGULATIONS AND STANDARDS MUST BE REQUESTED, AND APPROVED, IN WRITING. ANY MODIFICATIONS NECESSARY TO MEET CRITERIA AFTER-THE-FACT WILL BE ENTIRELY THE DEVELOPER'S RESPONSIBILITY TO RECTIFY.
- 5. IT IS THE DESIGN ENGINEER'S RESPONSIBILITY TO ACCURATELY SHOW EXISTING CONDITIONS, BOTH ONSITE AND OFFSITE, ON THE CONSTRUCTION PLANS. ANY MODIFICATIONS NECESSARY DUE TO CONFLICTS, OMISSIONS, OR CHANGED CONDITIONS WILL BE ENTIRELY THE DEVELOPER'S RESPONSIBILITY TO RECTIFY.
- 6. CONTRACTOR SHALL SCHEDULE A PRE-CONSTRUCTION MEETING WITH EL PASO COUNTY PLANNING AND COMMUNITY DEVELOPMENT (PCD) – INSPECTIONS, PRIOR TO STARTING CONSTRUCTION.
- 7. IT IS THE CONTRACTOR'S RESPONSIBILITY TO UNDERSTAND THE REQUIREMENTS OF ALL JURISDICTIONAL AGENCIES AND TO OBTAIN ALL REQUIRED PERMITS, INCLUDING BUT NOT LIMITED TO EL PASO COUNTY EROSION AND STORMWATER QUALITY CONTROL PERMIT (ESQCP), REGIONAL BUILDING FLOODPLAIN DEVELOPMENT PERMIT, U.S. ARMY CORPS OF ENGINEERS-ISSUED 401 AND/OR 404 PERMITS, AND COUNTY AND STATE FUGITIVE DUST PERMITS.
- 8. CONTRACTOR SHALL NOT DEViate FROM THE PLANS WITHOUT FIRST OBTAINING WRITTEN APPROVAL FROM THE DESIGN ENGINEER AND PCD. CONTRACTOR SHALL NOTIFY THE DESIGN ENGINEER IMMEDIATELY UPON DISCOVERY OF ANY ERRORS OR INCONSISTENCIES.
- 9. ALL STORM DRAIN PIPE SHALL BE CLASS III RCP UNLESS OTHERWISE NOTED AND APPROVED BY PCD.
- 10. CONTRACTOR SHALL COORDINATE GEOTECHNICAL TESTING PER ECM STANDARDS. PAVEMENT DESIGN SHALL BE APPROVED BY EL PASO COUNTY PCD PRIOR TO REPLACEMENT OF CURB AND GUTTER AND PAVEMENT.
- 11. ALL CONSTRUCTION TRAFFIC MUST ENTER/EXIT THE SITE AT APPROVED CONSTRUCTION ACCESS POINTS.
- 12. SIGHT VISIBILITY TRIANGLES AS IDENTIFIED IN THE PLANS SHALL BE PROVIDED AT ALL INTERSECTIONS. OBSTRUCTIONS GREATER THAN 18 INCHES ABOVE FLOWLINE ARE NOT ALLOWED WITHIN SIGHT TRIANGLES.
- 13. SIGNING AND STRIPING SHALL COMPLY WITH EL PASO COUNTY DOT AND MUTCD CRITERIA. [IF APPLICABLE, ADDITIONAL SIGNING AND STRIPING NOTES WILL BE PROVIDED.]
- 14. CONTRACTOR SHALL OBTAIN ANY PERMITS REQUIRED BY EL PASO COUNTY DOT, INCLUDING WORK WITHIN THE RIGHT-OF-WAY AND SPECIAL TRANSPORT PERMITS.
- 15. THE LIMITS OF CONSTRUCTION SHALL REMAIN WITHIN THE PROPERTY LINE UNLESS OTHERWISE NOTED. THE OWNER/DEVELOPER SHALL OBTAIN WRITTEN PERMISSION AND EASEMENTS, WHERE REQUIRED, FROM ADJOINING PROPERTY OWNER(S) PRIOR TO ANY OFF-SITE DISTURBANCE, GRADING, OR CONSTRUCTION.

EL PASO COUNTY STANDARD SIGNAGE AND STRIPING NOTES:

- 1. ALL SIGNS AND PAVEMENT MARKING SHALL BE IN COMPLIANCE WITH THE CURRENT MANUAL ON UNIFORM TRAFFIC CONTROL DEVICES (MUTCD).
- 2. REMOVAL OF EXISTING PAVEMENT MARKINGS SHALL BE ACCOMPLISHED BY A METHOD THAT DOES NOT MATERIALLY DAMAGE THE PAVEMENT. THE PAVEMENT MARKINGS SHALL BE REMOVED TO THE EXTENT THAT THEY WILL NOT BE VISIBLE UNDER DAY OR NIGHT CONDITIONS. AT NO TIME WILL IT BE ACCEPTABLE TO PAINT OVER EXISTING PAVEMENT MARKINGS.
- 3. ANY DEVIATION FROM THE SIGNAGE AND STRIPING PLAN SHALL BE APPROVED BY EL PASO COUNTY PLANNING AND COMMUNITY DEVELOPMENT.
- 4. ALL SIGNS SHOWN ON THE SIGNING AND STRIPING PLAN SHALL BE NEW SIGNS. EXISTING SIGNS MAY REMAIN OR BE REUSED IF THEY MEET CURRENT EL PASO COUNTY AND MUTCD STANDARDS.
- 5. STREET NAME AND REGULATORY STOP SIGNS SHALL BE ON THE SAME POST AT INTERSECTIONS.
- 6. ALL REMOVED SIGNS SHALL BE DISPOSED OF IN A PROPER MANNER BY THE CONTRACTOR.
- 7. ALL STREET NAME SIGNS SHALL HAVE "D" SERIES LETTERS, WITH LOCAL ROADWAY SIGNS BEING 4" UPPER-LOWER CASE ON 8" BLANK AND NON-LOCAL ROADWAY SIGNS BEING 6" LETTERING, UPPER-LOWER CASE LETTERING ON 12" BLANK WITH A WHITE BORDER THAT IS NOT RECESSED. MULTI-LANE ROADWAYS WITH SPEED LIMITS OF 35 MPH OR HIGHER SHALL HAVE 6" UPPER-LOWER CASE LETTERING ON 12" BLANK WITH A WHITE BORDER THAT IS NOT RECESSED. THE WIDTH OF THE NON-RECESSED WHITE BORDERS SHALL MATCH PAGE 255 OF THE 2012 MUTCD "STANDARD HIGHWAY SIGNS". SIGNAL POLE MOUNTED AND OVERHEAD STREET NAME SIGNS SHALL BE PER MUTCD SIZE STANDARDS.
- 8. ALL TRAFFIC SIGNS SHALL HAVE A MINIMUM HIGH INTENSITY PRISMATIC GRADE SHEETING.
- 9. ALL LOCAL RESIDENTIAL STREET SIGNS SHALL BE MOUNTED ON A 1.75" X 1.75" SQUARE TUBE SIGN POST AND STUB POST BASE. FOR OTHER APPLICATIONS REFER TO THE CDOT STANDARD S-614-8 REGARDING USE OF THE P2 TUBULAR STEEL POST SLIPBASE DESIGN.
- 10. ALL SIGNS SHALL BE SINGLE SHEET ALUMINUM WITH 0.100" THICKNESS.
- 11. ALL LIMIT LINES/STOP LINES, CROSSWALK LINES, PAVEMENT LEGENDS, AND ARROWS SHALL BE A MINIMUM 125 MIL THICKNESS PREFORMED THERMOPLASTIC PAVEMENT MARKINGS WITH TAPERED LEADING EDGES PER CDOT STANDARD S-627-1.
- 12. WORD AND SYMBOL MARKINGS SHALL BE THE NARROW TYPE STOP BARS SHALL BE 24" IN WIDTH, CROSSWALK LINES SHALL BE 2' WIDE AND 9' LONG.
- 13. ALL LONGITUDINAL LINES SHALL BE A MINIMUM 15 MIL THICKNESS EPOXY PAINT. ALL NON-LOCAL RESIDENTIAL ROADWAYS SHALL INCLUDE BOTH RIGHT AND LEFT EDGE LINE STRIPING AND ANY ADDITIONAL STRIPING AS REQUIRED BY CDOT S-627-1.
- 14. THE CONTRACTOR SHALL NOTIFY EL PASO COUNTY PLANNING AND COMMUNITY DEVELOPMENT (719) 520-6819 PRIOR TO AND UPON COMPLETION OF THE SIGNING AND STRIPING.
- 15. THE CONTRACTOR SHALL OBTAIN A WORK IN THE RIGHT OF WAY PERMIT FROM THE EL PASO COUNTY DEPARTMENT OF PUBLIC WORKS (DPW) PRIOR TO ANY SIGNAGE OR STRIPING WORK WITHIN AN EXISTING EL PASO COUNTY ROADWAY.

GENERAL NOTES:

- 1. THE CONTRACT DOCUMENTS SHALL NOT CREATE, NOR SHALL BE CONSTRUED TO CREATE, ANY CONTRACTUAL RELATIONSHIP BETWEEN THE ENGINEER AND THE CONTRACTOR AND/OR ANY SUBCONTRACTOR.
- 2. THE ENGINEER SHALL NOT BE RESPONSIBLE FOR CONSTRUCTION MEANS, METHODS, TECHNIQUES, SEQUENCES OR PROCEDURES OR FOR SAFETY PRECAUTIONS OR PROGRAMS UTILIZED IN CONNECTION WITH THE WORK, AND WILL NOT BE RESPONSIBLE FOR THE CONTRACTOR'S FAILURE TO CARRY OUT THE WORK IN ACCORDANCE WITH THE CONTRACT DOCUMENTS.
- 3. THE CONTRACTOR SHALL FURNISH ALL NECESSARY MATERIALS, EQUIPMENT, MACHINERY, TOOLS, MEANS OF TRANSPORTATION AND LABOR NECESSARY TO COMPLETE THE WORK IN FULL AND COMPLETE IN ACCORDANCE WITH THE SHOWN, DESCRIBED AND REASONABLY INTENDED REQUIREMENTS OF THE CONTRACT DOCUMENTS AND JURISDICTIONAL AGENCY REQUIREMENTS.
- 4. THE CONTRACTOR SHALL BE RESPONSIBLE TO OBTAIN ALL REQUIRED CONSTRUCTION PERMITS, CERTIFICATIONS, BONDS, ETC. REQUIRED FOR CONSTRUCTION PRIOR TO COMMENCING CONSTRUCTION.
- 5. CONTRACTOR TO LOCATE ALL EXISTING PROPERTY MONUMENTS PRIOR TO CONSTRUCTION, ANY MONUMENTS DISTURBED DURING THE CONSTRUCTION OF THIS PROJECT SHALL BE REPLACED BY REGISTERED LAND SURVEYOR AT THE CONTRACTOR'S EXPENSE.
- 6. CONTRACTOR SHALL VERIFY BENCHMARKS AND DATUMS PRIOR TO COMMENCING CONSTRUCTION OR STAKING OF IMPROVEMENTS. ANY DISCREPANCIES SHALL BE IMMEDIATELY BROUGHT TO THE ATTENTION OF THE OWNER AND ENGINEER PRIOR TO COMMENCING WITH CONSTRUCTION.
- 7. THE CONTRACTOR TO ARRANGE FOR ALL COPIES OF COMPACTION, CONCRETE AND OTHER REQUIRED TEST RESULTS TO BE SENT TO THE OWNER AND DESIGN ENGINEER OF RECORD DIRECTLY FROM THE TESTING AGENCY.
- 8. ALL NECESSARY INSPECTIONS AND/OR CERTIFICATIONS REQUIRED BY CODES, JURISDICTIONAL AGENCIES AND/OR UTILITY SERVICE COMPANIES IS REQUIRED OF THE CONTRACTOR AND SHALL BE PERFORMED PRIOR TO ANNOUNCED BUILDING POSSESSION AND THE FINAL CONNECTION OF SERVICES.
- 9. PREPARATION OF TRAFFIC CONTROL PLAN(S) IS THE CONTRACTOR'S RESPONSIBILITY.

K:\COS_LA\196140002 - Cimarron Hills\Phase 2\CADD\PlanSheets\SIG\196140002 - SIG_NOTES.dwg Schmelbach, Ryan 6/26/2023 2:35 PM

NO.	REVISION	DATE	APPR



DESIGNED BY: KRK
 DRAWN BY: RES
 CHECKED BY: EUG
 DATE: 06/26/2023

SOLACE APARTMENTS FILING NO. 2
 CONSTRUCTION DOCUMENTS
 GALLEY RD & PAONIA ST - TRAFFIC SIGNAL PLANS
 NOTES

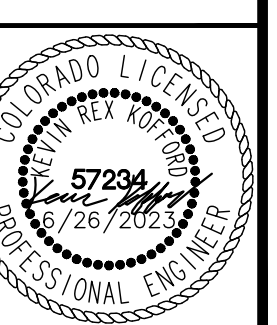

PROJECT NO.
096668009

SHEET
4

K:\COS_LA\196140002 - Cimarron Hills\Phase 2\CADD\PlanSheets\SIG\196140002 - SIG_NOTES.dwg Schmelbach, Ryan 6/26/2023 2:35 PM

CDOT CONTRACT ITEM NO.	CONTRACT ITEM	UNIT											PROJECT TOTALS		NOTES	
			PLAN	AS CONST.	PLAN	AS CONST.	PLAN	AS CONST.	PLAN	AS CONST.	PLAN	AS CONST.	PLAN	AS CONST.		
202-00250	REMOVAL OF PAVEMENT MARKING	SF	12											12		
203-01597	POTHOLING	EA	6											6		
503-00018	DRILLED CAISSON (18-INCH)	LF	15											15		
503-00036	DRILLED CAISSON (36-INCH)	LF	74											74		
613-00200	2 INCH ELECTRICAL CONDUIT	LF	107											107		
613-00206	2 INCH ELECTRICAL CONDUIT (BORED)	LF	442											442		
613-00300	3 INCH ELECTRICAL CONDUIT	LF	31											31		
613-00306	3 INCH ELECTRICAL CONDUIT (BORED)	LF	663											663		
613-07004	CDOT TYPE 4 PULL BOX	EA	3											3		
613-07005	CDOT TYPE 5 PULL BOX	EA	1											1		
613-10000	WIRING	LS	1											1		
613-13000	LUMINAIRE (LED)	EA	3											3		
613-50109	METER POWER PEDESTAL	SF	1											1		12" WIDE CP3A SIZE 12" WIDE SLIMLINE PEDESTAL
614-00011	SIGN PANEL (CLASS I)	SF	68											68		
614-00037	SIGN PANEL (SPECIAL)	EA	4											4		OVERHEAD STREET NAME SIGN (2'X8.5')
614-70150	PEDESTRIAN SIGNAL FACE (16) (COUNTDOWN)	EA	6											6		
614-70336	TRAFFIC SIGNAL FACE (12-12-12)	EA	10											10		W/ BACKPLATES & 1.5" REFLECTIVE TAPE
614-70448	TRAFFIC SIGNAL FACE (12-12-12-12 ARROW)	EA	8											8		W/ BACKPLATES & 1.5" REFLECTIVE TAPE
614-72836	CONFLICT MONITOR	EA	1											1		MODEL 2010 ECLIP W/ ETHERNET PORT (EDI)
*614-72855	TRAFFIC SIGNAL CONTROLLER CABINET	EA	1											1		MCCAIN 350i A TC
614-72860	PEDESTRIAN PUSH BUTTON	EA	6											6		WITH INSTRUCTION SIGN
614-72895	MICROWAVE VEHICLE DETECTION SYSTEM	EA	4											4		SEBCO INTERSECTOR-SBE W/ INTERFACE BOARD
614-81130	TRAFFIC SIGNAL-LIGHT POLE STEEL (1-30 FOOT MAST ARM)	EA	1											1		PELCO TRAFFIC SIGNAL POLE
614-81135	TRAFFIC SIGNAL-LIGHT POLE STEEL (1-35 FOOT MAST ARM)	EA	1											1		PELCO TRAFFIC SIGNAL POLE
614-81140	TRAFFIC SIGNAL-LIGHT POLE STEEL (1-40 FOOT MAST ARM)	EA	1											1		PELCO TRAFFIC SIGNAL POLE
614-81150	TRAFFIC SIGNAL-LIGHT POLE STEEL (1-50 FOOT MAST ARM)	EA	1											1		PELCO TRAFFIC SIGNAL POLE
614-84100	TRAFFIC SIGNAL PEDESTAL POLE ALUMINUM	EA	3											3		5' PED POLE x2 ; 10' PED POLE x1
614-86238	TRAFFIC SIGNAL CONTROLLER	EA	1											1		FLEX, RACK MOUNT, C1 CONN., W/ OMNI SOFTWARE
623-04002	POWER SOURCE WIRE	LF	93											93		CAT5E OUTDOOR CABLE, CMXT 350MHz
625-00000	CONSTRUCTION SURVEYING	LS	1											1		
626-00000	MOBILIZATION	LS	1											1		
627-00002	THERMOPLASTIC PAVEMENT MARKING	SF	310											310		
630-00016	TRAFFIC CONTROL (SPECIAL) LS	LS	1											1		

NO.	REVISION	BY	DATE	APPR

Kimley»Horn
 2023 KIMLEY-HORN AND ASSOCIATES, INC.
 2 North Nevada Avenue, Suite 900
 Colorado Springs, Colorado 80903 (719) 453-0180

DESIGNED BY: KRK
 DRAWN BY: RES
 CHECKED BY: EJJ
 DATE: 06/26/2023

SOLACE APARTMENTS FILING NO. 2
 CONSTRUCTION DOCUMENTS
 GALLEY RD & PAONIA ST - TRAFFIC SIGNAL PLANS
 SUMMARY OF QUANTITIES

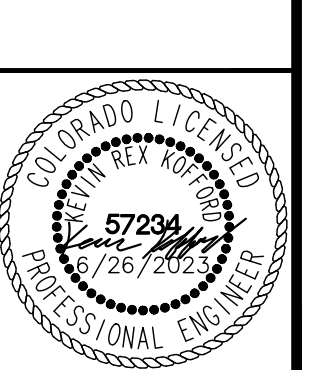

PROJECT NO.
09668009

SHEET
5

K:\COS_LA\196140002 - Cimarron Hills\Phase 2\CADD\PlanSheets\SIG\196140002 - SIG_EX-DEMO.dwg Schmelbach, Ryan 6/26/2023 2:35 PM

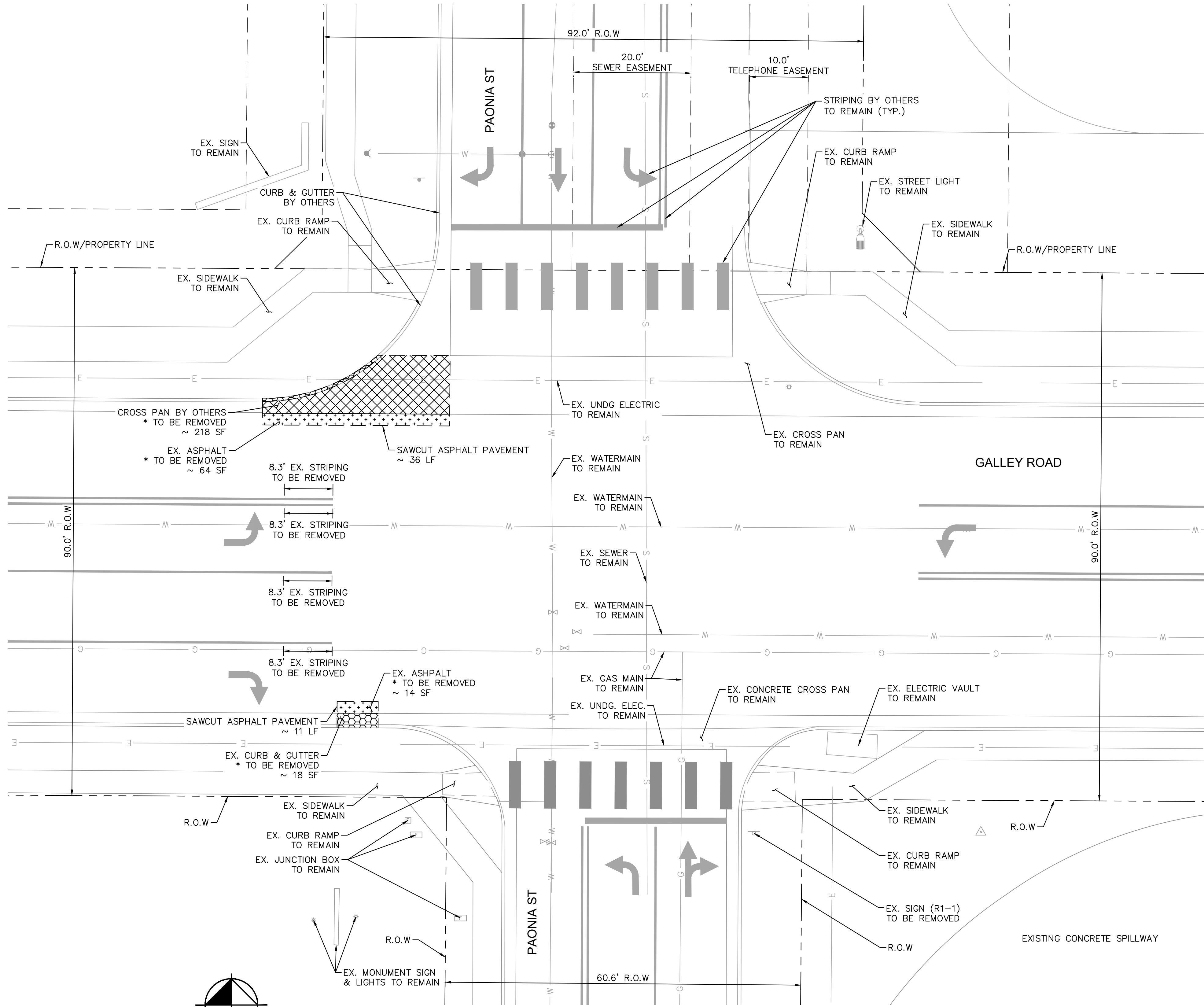

UTILITY LEGEND

- G — EXISTING UNDERGROUND NATURAL GAS
- E — EXISTING UNDERGROUND ELECTRIC
- S — EXISTING SANITARY SEWER
- W — EXISTING WATER MAIN

REMOVAL LEGEND

- REMOVE EX. CONCRETE CROSS PAN
- REMOVE EXISTING CURB & GUTTER
- REMOVE EXISTING ASPHALT
- SAWCUT

*** REMOVAL NOTES**

1. REMOVAL QUANTITIES MAY VARY IN THE FIELD.
2. CONTRACTOR TO REMOVE CONCRETE CROSS PAN AND CURB & GUTTER AT THE APPROPRIATE JOINT FOR PROPER INSTALLATION OF PROPOSED INFRASTRUCTURE.
3. CONTRACTOR TO REMOVE CONCRETE CROSS PAN AND CURB & GUTTER AT THE APPROPRIATE JOINT TO MINIMIZE REMOVAL/DISTURBANCE OF EXISTING INFRASTRUCTURE.

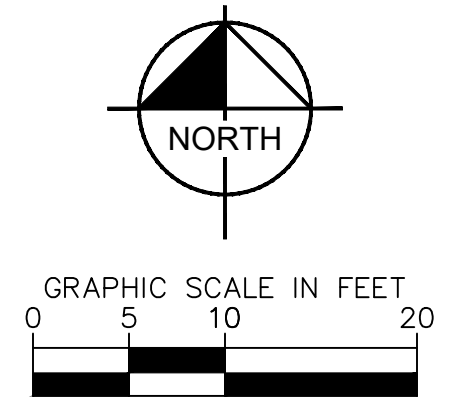

NO.	REVISION	BY	DATE	APPR

Kimley»Horn
 2023 KIMLEY-HORN AND ASSOCIATES, INC.
 2 North Nevada Avenue, Suite 900
 Colorado Springs, Colorado 80903 (719) 453-0180

DESIGNED BY: KRK
 DRAWN BY: RES
 CHECKED BY: EJJ
 DATE: 06/26/2023

SOLACE APARTMENTS FILING NO. 2
 CONSTRUCTION DOCUMENTS
GALLEY RD & PAONIA ST - TRAFFIC SIGNAL PLANS
 EXISTING CONDITIONS & DEMOLITION PLAN



PROJECT NO. 096668009
 SHEET 6

K:\COS_LA\196140002 - Cimarron Hills\Phase 2\CADD\PlanSheets\SIG\196140002 - SIG_SS.dwg Schmelbach, Ryan 6/26/2023 2:36 PM

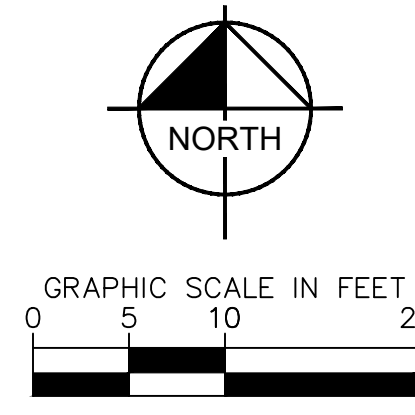
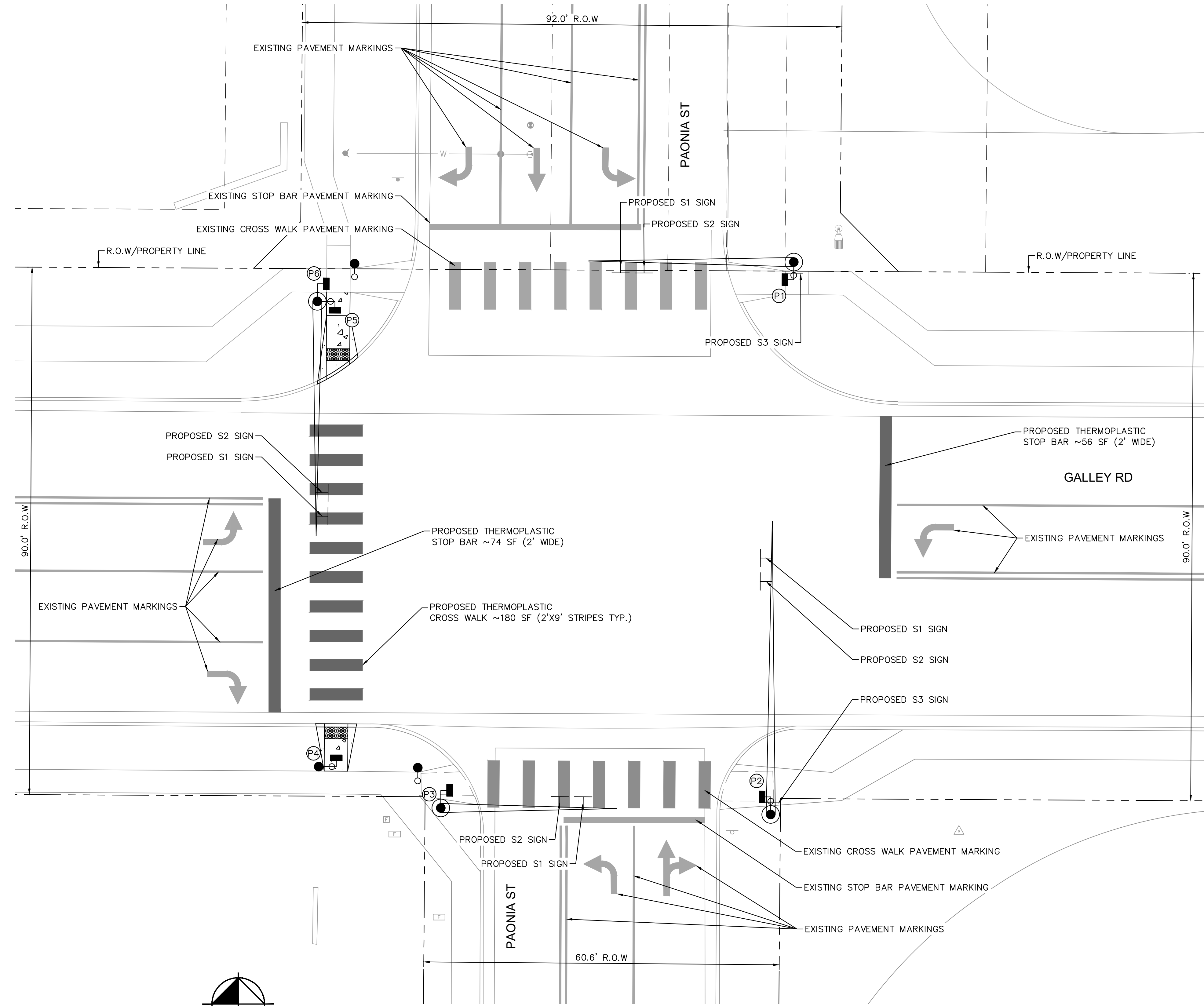

PAVEMENT MARKING LEGEND



SIGNAGE LEGEND

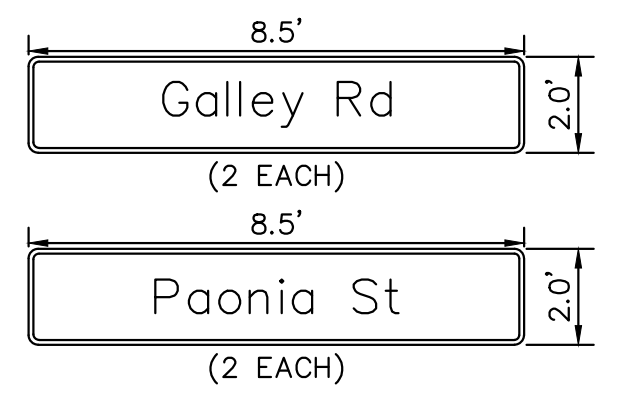
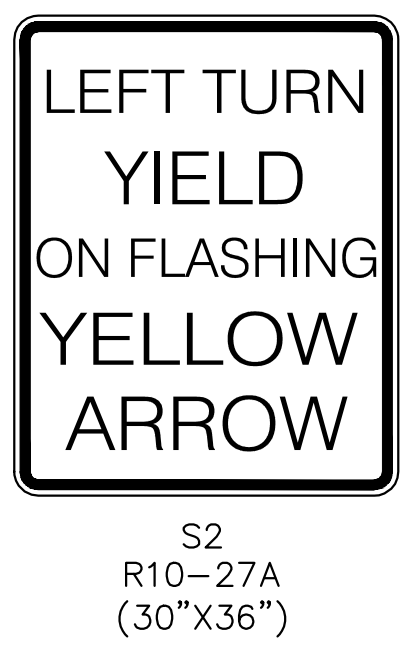

(STREET NAME SPECS PER EL PASO COUNTY)
 NOTE:
 1. STREET NAME SIGNS TO BE PER EL PASO COUNTY STANDARD DETAIL. SEE SHEET 11.

PEDESTRIAN SIGNAL FACE



NO.	REVISION	BY	DATE	APPR

Kimley»Horn
 2023 KIMLEY-HORN AND ASSOCIATES, INC.
 2 North Nevada Avenue, Suite 900
 Colorado Springs, Colorado 80903 (719) 453-0180

DESIGNED BY: KRK
 DRAWN BY: RES
 CHECKED BY: EJJ
 DATE: 06/26/2023

SOLACE APARTMENTS FILING NO. 2
CONSTRUCTION DOCUMENTS
GALLEY RD & PAONIA ST - TRAFFIC SIGNAL PLANS
 SIGNAGE AND STRIPING PLAN



PROJECT NO.
096668009
 SHEET
7

K:\COS_LA\196140002 - Cimarron Hills\Phase 2\CADD\PlanSheets\SIG\196140002 - SIG_SIGNAL.dwg Schmelbach, Ryan 6/26/2023 2:36 PM

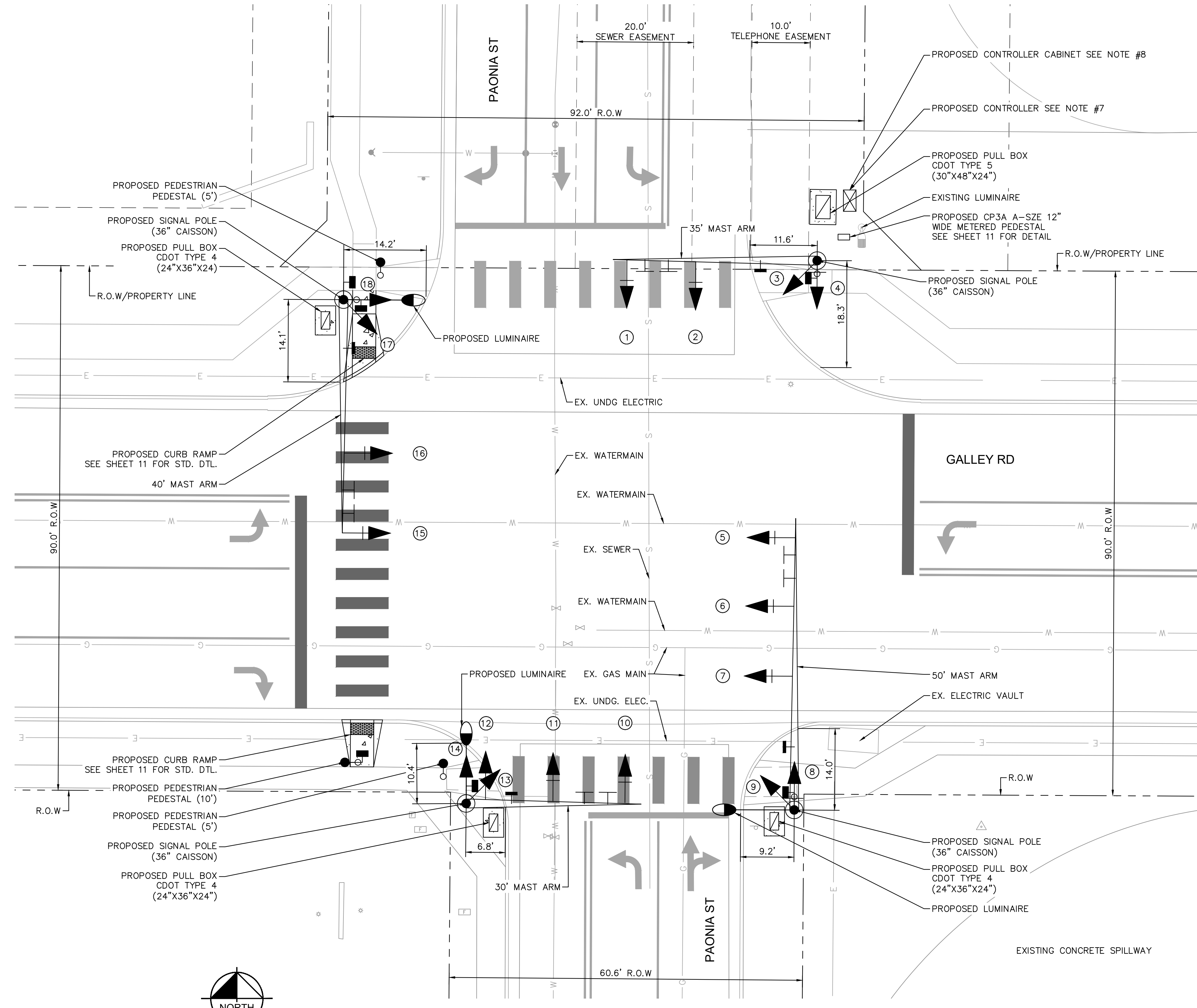

NOTES:

1. MAST ARMS, CAISSON DIAMETER, AND CAISSON DEPTHS WERE DETERMINED PER CDOT STANDARD DETAIL S-614-40A
2. PEDESTRIAN PUSH BUTTON ASSEMBLIES ARE TO BE CONSTRUCTED PER CDOT STANDARD S-614-09
3. ALL PEDESTALS AND PUSH BUTTONS SHALL BE LOCATED IN THE CLEAR SPACE PER S-614-45
4. PULL BOXES SHALL BE PLACED PER CDOT STANDARD DETAIL S-614-43
5. TOP OF CAISSON SHALL BE FLUSH WITH SIDEWALK IF DIRECTLY ADJACENT TO SIDEWALK OR A MINIMUM OF 2" ABOVE THE LANDSCAPING
6. SEE SHEET 10 FOR PUSH BUTTON PROXIMITY DETAIL
7. PROPOSED CONTROLLER TO BE A MCCAIN 2070 FLEX ATC CONTROLLER W/ RACK MOUNT, C1 CONNECTOR, AND OMNI SOFTWARE
8. PROPOSED CONTROLLER CABINET SHALL BE A MCCAIN 350i ATC W/ BATTERY BACKUP AND AUXILIARY RACK.

TRAFFIC SIGNAL LEGEND

- ☒ CONTROLLER
- ☑ PULL BOX (CDOT TYPE 4 & TYPE 5)
- ➔ SIGNAL HEAD (LED)
- POWER METER PEDESTAL
- ⌋ PEDESTRIAN HEAD WITH COUNTDOWN
- PEDESTRIAN PUSH BUTTON
- ⌋ MICROWAVE VEHICLE PRESENCE SENSOR
- ⌋ OVERHEAD MOUNTED SIGN
- ⦿ MAST ARM & SIGNAL POLE
- PEDESTAL/PUSHBUTTON POLE
- LUMINAIRE (LED)
- CONDUIT

UTILITY LEGEND

- G — EXISTING UNDERGROUND NATURAL GAS
- E — EXISTING UNDERGROUND ELECTRIC
- S — EXISTING SANITARY SEWER
- W — EXISTING WATER MAIN

TRAFFIC SIGNAL FACE LEGEND

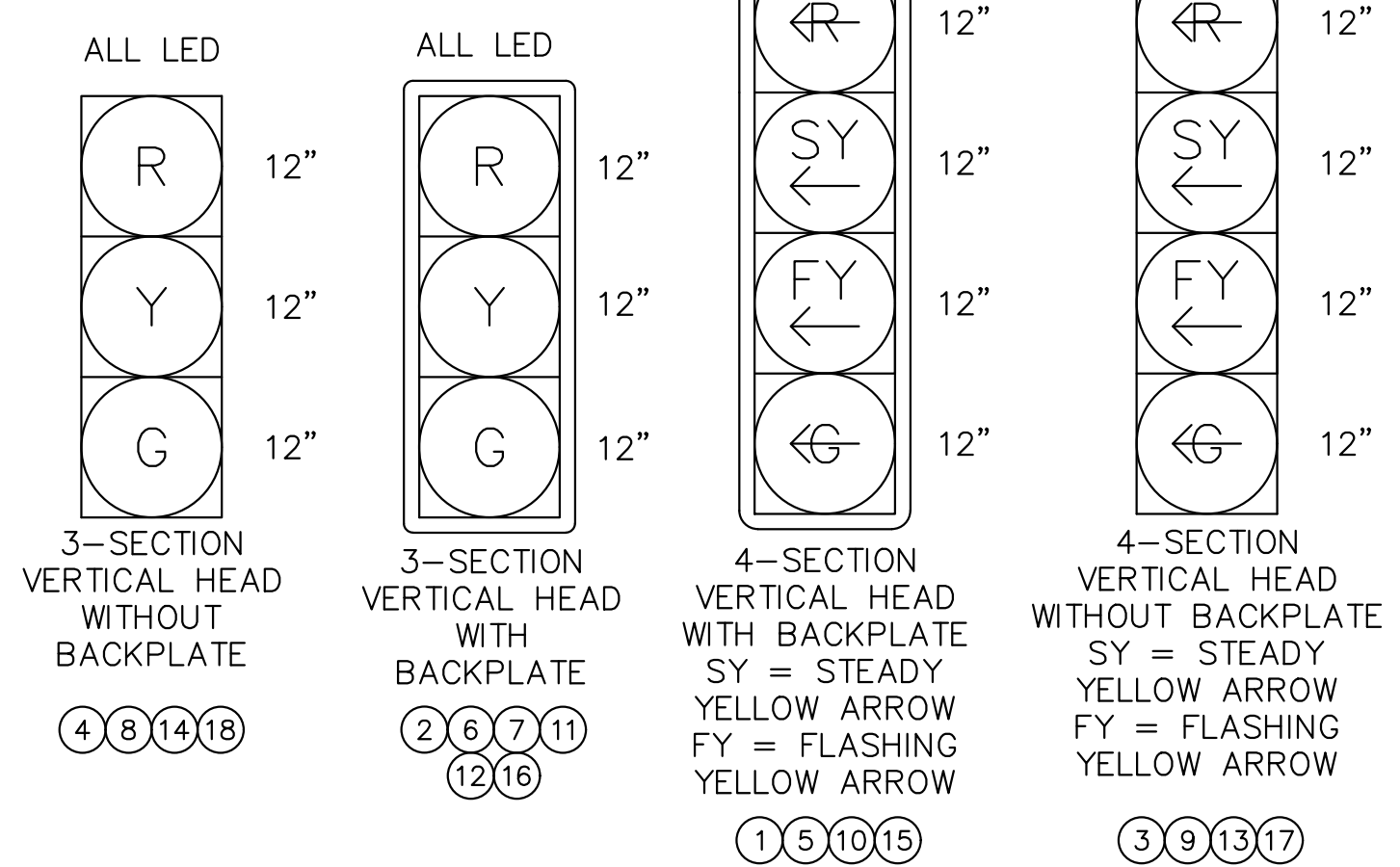

PHASING DIAGRAM

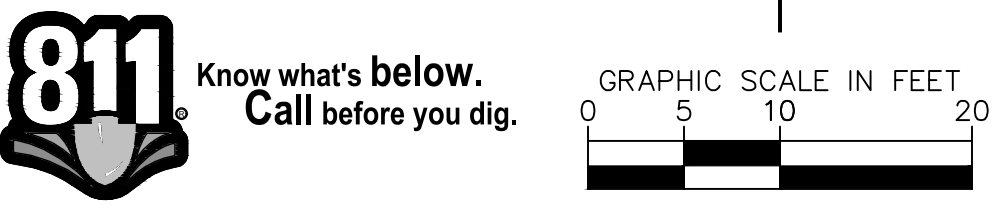
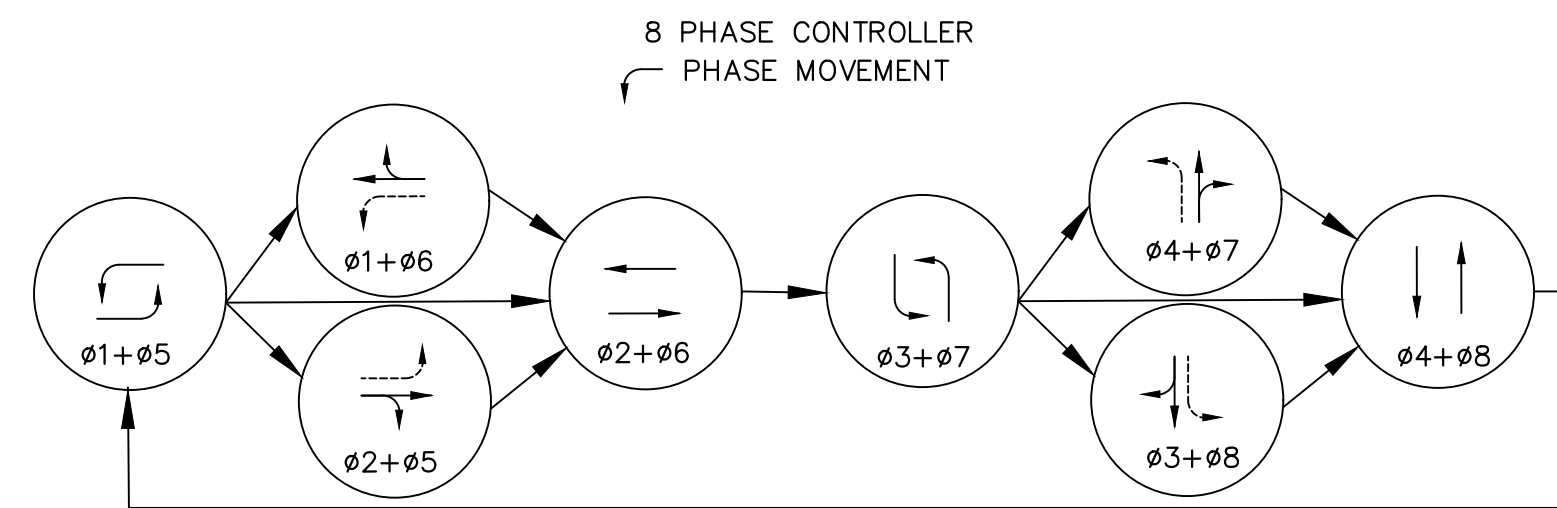

811 Know what's below.
Call before you dig.

NO.	REVISION	BY	DATE	APPR

Kimley»Horn
2023 KIMLEY-HORN AND ASSOCIATES, INC.
2 North Nevada Avenue, Suite 900
Colorado Springs, Colorado 80903 (719) 453-0180

DESIGNED BY: KRK
DRAWN BY: RES
CHECKED BY: EJJ
DATE: 06/26/2023

SOLACE APARTMENTS FILING NO. 2
CONSTRUCTION DOCUMENTS
GALLEY RD & PAONIA ST - TRAFFIC SIGNAL PLANS
SIGNAL PLAN

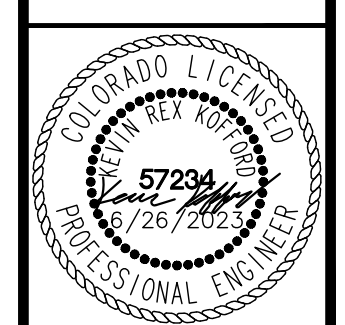

PROJECT NO.
096668009
SHEET
8

EPC 6/28/23

K:\COS_LA\196140002 - Cimarron Hills\Phase 2\CADD\PlanSheets\SIG\196140002 - SIG_CONDUIT.dwg Schnelboch, Ryan 6/26/2023 2:36 PM

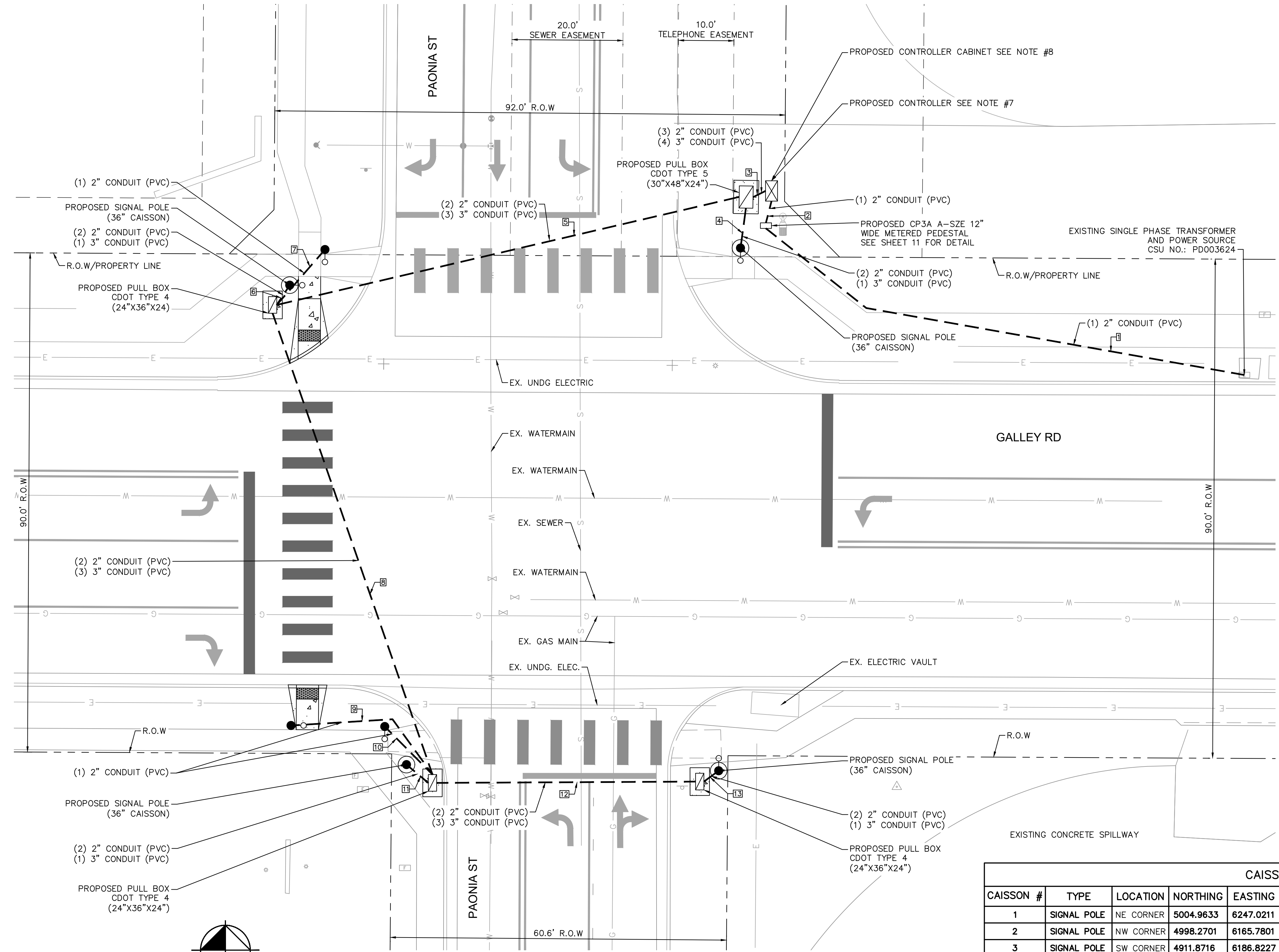

TRAFFIC SIGNAL LEGEND

- ☒ CONTROLLER
- ☐ PULL BOX (24"x36"x18")
- ➔ SIGNAL HEAD (LED)
- POWER METER PEDESTAL
- ⌋ PEDESTRIAN HEAD
- ⌋ PEDESTRIAN PUSH BUTTON WITH COUNTDOWN
- ⌋ MICROWAVE VEHICLE PRESENCE SENSOR
- ⌋ OVERHEAD MOUNTED SIGN
- ⦿ MAST ARM & SIGNAL POLE
- PEDESTAL/PUSHBUTTON POLE
- ⦿ LUMINAIRE (LED)
- CONDUIT

UTILITY LEGEND

- G EXISTING UNDERGROUND NATURAL GAS
- E EXISTING UNDERGROUND ELECTRIC
- S EXISTING SANITARY SEWER
- W EXISTING WATER MAIN

NOTES

1. MAST ARMS, CAISSON DIAMETER, AND CAISSON DEPTHS WERE DETERMINED PER CDOT STANDARD DETAIL S-614-40A
2. PEDESTRIAN PUSH BUTTON ASSEMBLIES ARE TO BE CONSTRUCTED PER CDOT STANDARD S-614-09
3. ALL PEDESTALS AND PUSH BUTTONS SHALL BE LOCATED IN THE CLEAR SPACE PER S-614-45
4. PULL BOXES SHALL BE PLACED PER CDOT STANDARD DETAIL S-614-43
5. TOP OF CAISSON SHALL BE FLUSH WITH SIDEWALK IF DIRECTLY ADJACENT TO SIDEWALK OR A MINIMUM OF 2" ABOVE THE LANDSCAPING
6. PROPOSED CONTROLLER TO BE A MCCAIN 2070 FLEX ATC CONTROLLER W/ RACK MOUNT, C1 CONNECTOR, AND OMNI SOFTWARE
7. PROPOSED CONTROLLER CABINET SHALL BE A MCCAIN 3501 ATC W/ BATTERY BACKUP AND AUXILIARY RACK.

CONDUIT SCHEDULE			
LINE	LENGTH (FT)	CONDUIT	NOTES
1	93	(1) 2" CONDUIT	TRANSFORMER TO POWER METER
2	4	(1) 2" CONDUIT	POWER METER TO CONTROLLER
3	3	(3) 2" CONDUIT (4) 3" CONDUIT	CONTROLLER TO HR PULL BOX
4	7	(2) 2" CONDUIT (1) 3" CONDUIT	HR PULL BOX TO SIGNAL POLE
5	86	(2) 2" CONDUIT (3) 3" CONDUIT	DIRECTIONAL BORING
6	4	(2) 2" CONDUIT (1) 3" CONDUIT	PULL BOX TO SIGNAL POLE
7	13	(1) 2" CONDUIT	PULL BOX TO PEDESTAL
8	88	(2) 2" CONDUIT (3) 3" CONDUIT	DIRECTIONAL BORING
9	31	(1) 2" CONDUIT	PULL BOX TO PEDESTAL
10	12	(1) 2" CONDUIT	PULL BOX TO PEDESTAL
11	5	(2) 2" CONDUIT (1) 3" CONDUIT	PULL BOX TO SIGNAL POLE
12	47	(2) 2" CONDUIT (3) 3" CONDUIT	DIRECTIONAL BORING
13	3	(2) 2" CONDUIT (1) 3" CONDUIT	PULL BOX TO SIGNAL POLE

CONDUIT SUMMARY

2 INCH CONDUIT (TRENCHED) = 107 LF	2 INCH CONDUIT = 642 LF
2 INCH CONDUIT (BORED) = 442 LF	2 INCH CONDUIT (POWER FEED) = 93 LF
3 INCH CONDUIT (TRENCHED) = 31 LF	3 INCH CONDUIT (BORED) = 663 LF

CAISSON SCHEDULE								
CAISSON #	TYPE	LOCATION	NORTHING	EASTING	CAISSON SIZE	CAISSON DEPTH	MAST ARM LENGTH	SURFACE ELEV.
1	SIGNAL POLE	NE CORNER	5004.9633	6247.0211	36"	18'-6"	35'	6248.14
2	SIGNAL POLE	NW CORNER	4998.2701	6165.7801	36"	18'-6"	40'	6248.43
3	SIGNAL POLE	SW CORNER	4911.8716	6186.8227	36"	18'-6"	30'	6248.01
4	SIGNAL POLE	SE CORNER	4910.7597	6243.0813	36"	18'-6"	50'	6248.00
5	5' PED POLE	NW CORNER	5004.6917	6172.1353	18"	4'-8"	N/A	6248.43
6	10' PED POLE	SW CORNER	4918.9204	6166.0133	18"	4'-8"	N/A	6248.03
7	5' PED POLE	SW CORNER	4918.7351	6182.9055	18"	4'-8"	N/A	6248.01

* ELEVATIONS ARE PROVIDED FOR REFERENCE. CONTRACTOR TO VERIFY ELEVATIONS PRIOR TO CONSTRUCTION. EPC 6/28/23

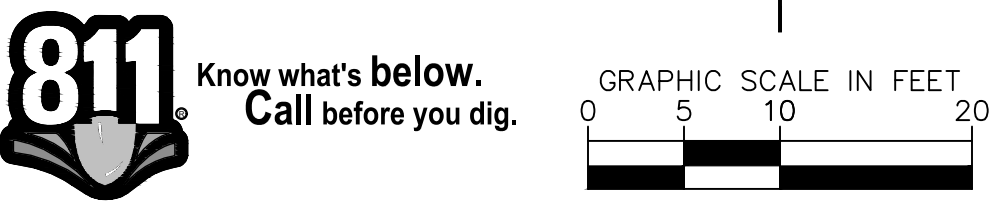

NO.	REVISION	BY	DATE	APPR

Kimley»Horn
 2023 KIMLEY-HORN AND ASSOCIATES, INC.
 2 North Nevada Avenue, Suite 900
 Colorado Springs, Colorado 80903 (719) 453-0180

DESIGNED BY: KRK
 DRAWN BY: RES
 CHECKED BY: EUG
 DATE: 06/26/2023

SOLACE APARTMENTS FILING NO. 2
 CONSTRUCTION DOCUMENTS
 GALLEY RD & PAONIA ST - TRAFFIC SIGNAL PLANS
 CONDUIT PLAN



PROJECT NO.
096668009
 SHEET
 9

K:\COS_LA\196140002 - Cimarron Hills\Phase 2\CADD\PlanSheets\SIG\196140002 - SIG_GRADING.dwg Schmelbach, Ryan 6/26/2023 2:36 PM



Know what's below.
Call before you dig.

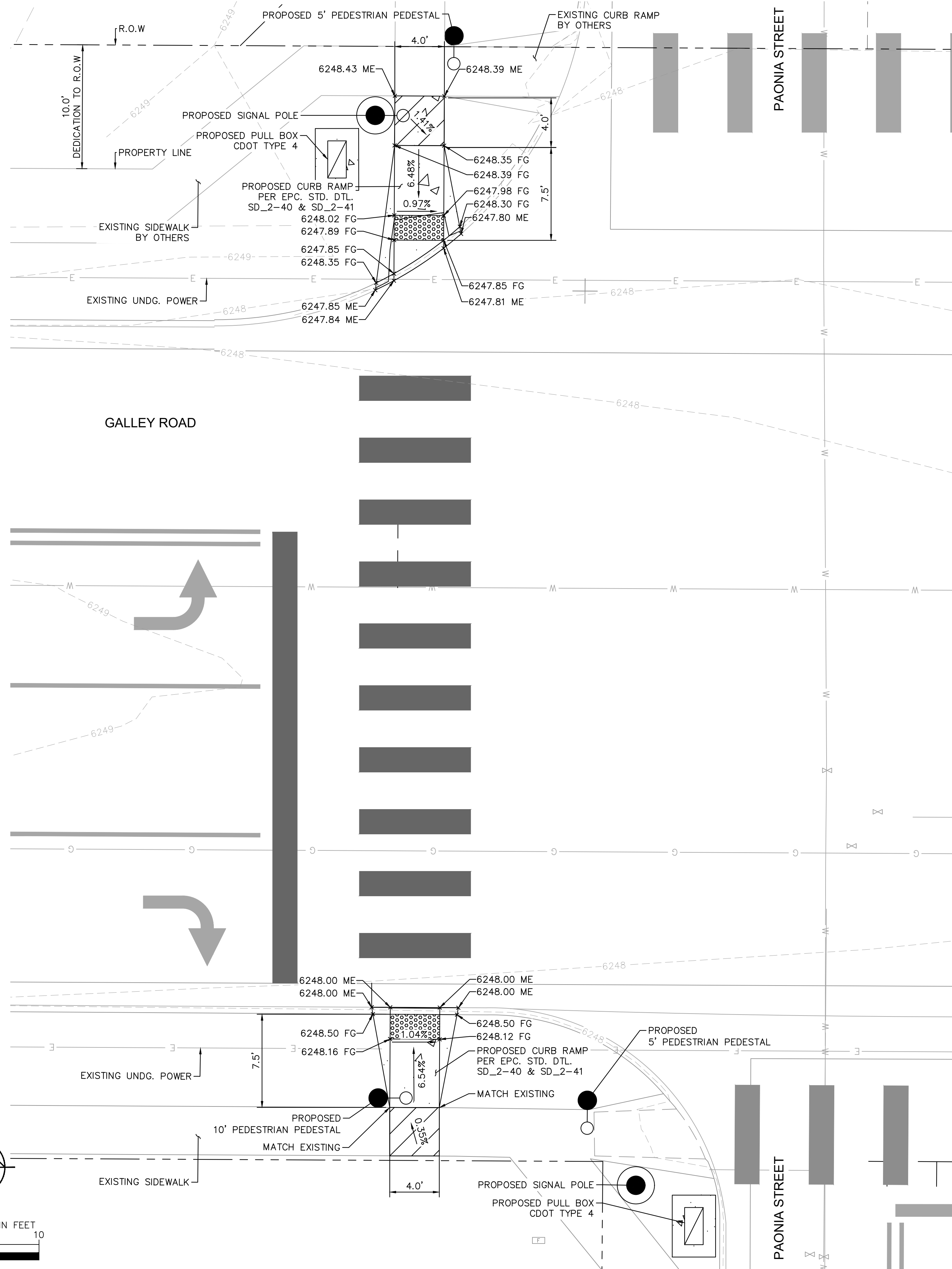
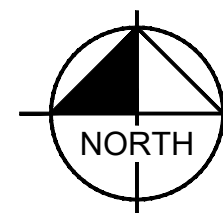
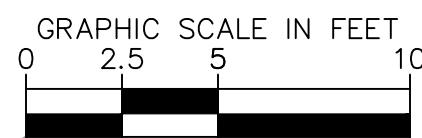

LEGEND

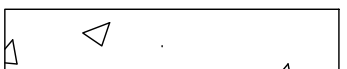
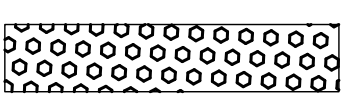
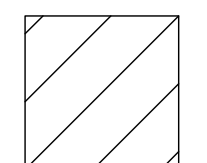
-  EXISTING CONCRETE SIDEWALK
-  PROPOSED CONCRETE CURB RAMP PER SD_2-40 & SD_2-41
-  PROPOSED DETECTABLE WARNING SURFACE (DWS)
-  4' X 4' MIN TURNING SPACE
2% MAX. SLOPE (IN ANY DIRECTION)

GENERAL NOTES

1. CONTROL JOINT SPACING SHALL BE 4' TYPICAL AND NO GREATER THAN 10 FT.
2. EXPANSION JOINT SPACING SHALL BE 20' TYPICAL.
3. ALL ACCESSIBLE AREAS SHALL COMPLY WITH ALL ADA REQUIREMENTS INCLUDING A LONGITUDINAL SLOPE OF 5.0% MAXIMUM AND A CROSS SLOPE OF 2% MAXIMUM.
4. CONTRACTOR TO CONFIRM EXISTING ELEVATIONS IN THE FIELD.
5. CONTRACTOR IS RESPONSIBLE FOR APPLYING FOR AND OBTAINING THE STATE STORMWATER DISCHARGE PERMIT AT LEAST TEN (10) BUSINESS DAYS PRIOR TO THE START OF CONSTRUCTION ACTIVITIES.
6. CONTRACTOR TO VERIFY ALL ELEVATIONS IN THE FIELD.
7. CONTRACTOR TO MATCH ELEVATIONS AT EXISTING SIDEWALK TIE-IN LOCATIONS.

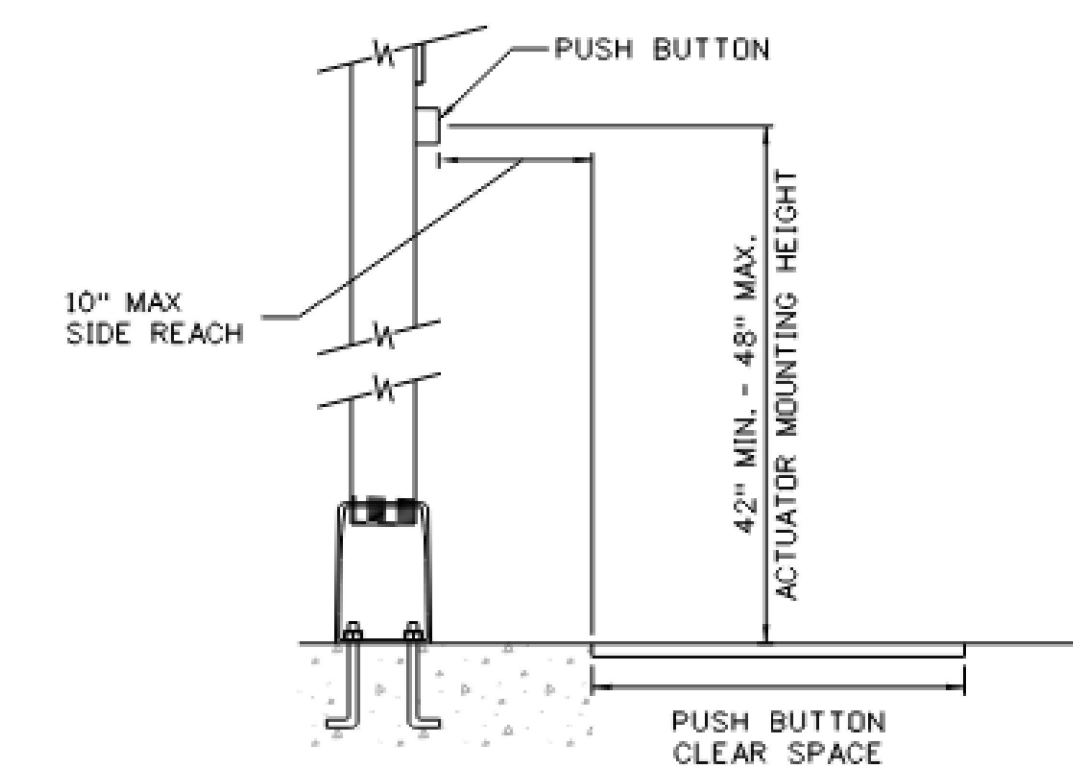
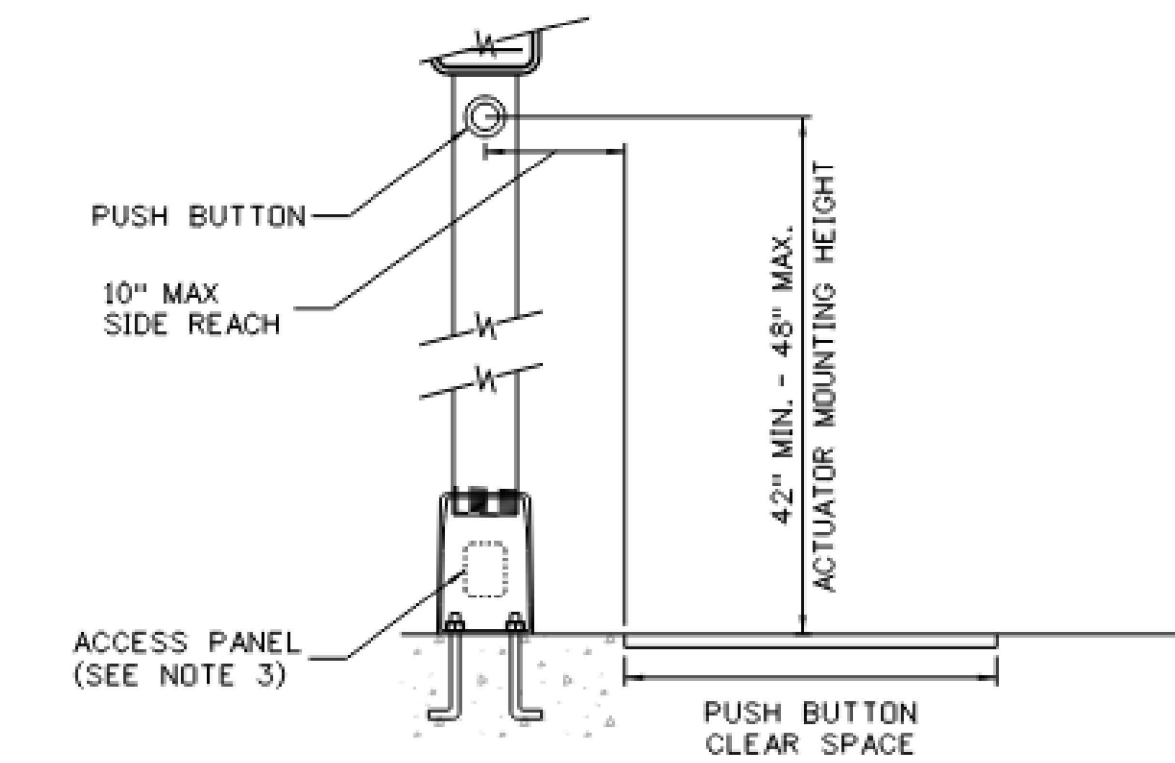

PUSH BUTTON LOCATION DETAIL
PER CDOT STANDARD DETAIL S-614-45

NO.	REVISION	BY	DATE	APPR

Kimley»Horn
 2023 KIMLEY-HORN AND ASSOCIATES, INC.
 2 North Nevada Avenue, Suite 900
 Colorado Springs, Colorado 80903 (719) 453-0180

DESIGNED BY: KRK
 DRAWN BY: RES
 CHECKED BY: EJC
 DATE: 06/26/2023

SOLACE APARTMENTS FILING NO. 2
 CONSTRUCTION DOCUMENTS
 GALLEY RD & PAONIA ST - TRAFFIC SIGNAL PLANS
 GRADING DETAIL

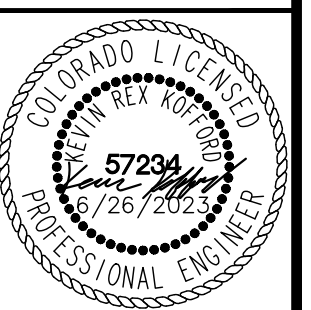

PROJECT NO.
09668009

SHEET
10

Catalog Number: 120/240 VAC, 1-phase, 3-wire, 100 Amps Maximum. (see Main circuit breaker rating)
CP3A51C16AAPCSXCCOD1 Rainproof - Type 3R, Aluminum Enclosure, painted GRAY
 Enclosed Industrial Control - Suitable ONLY for Use as Service Equipment
 Dead Front - 1189639

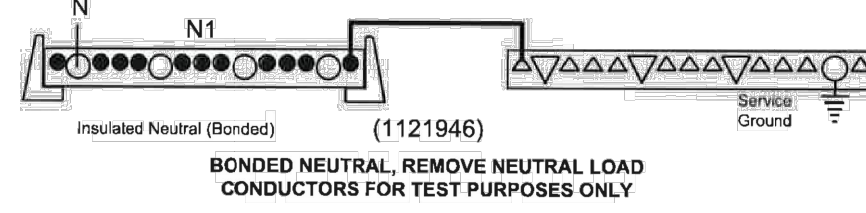
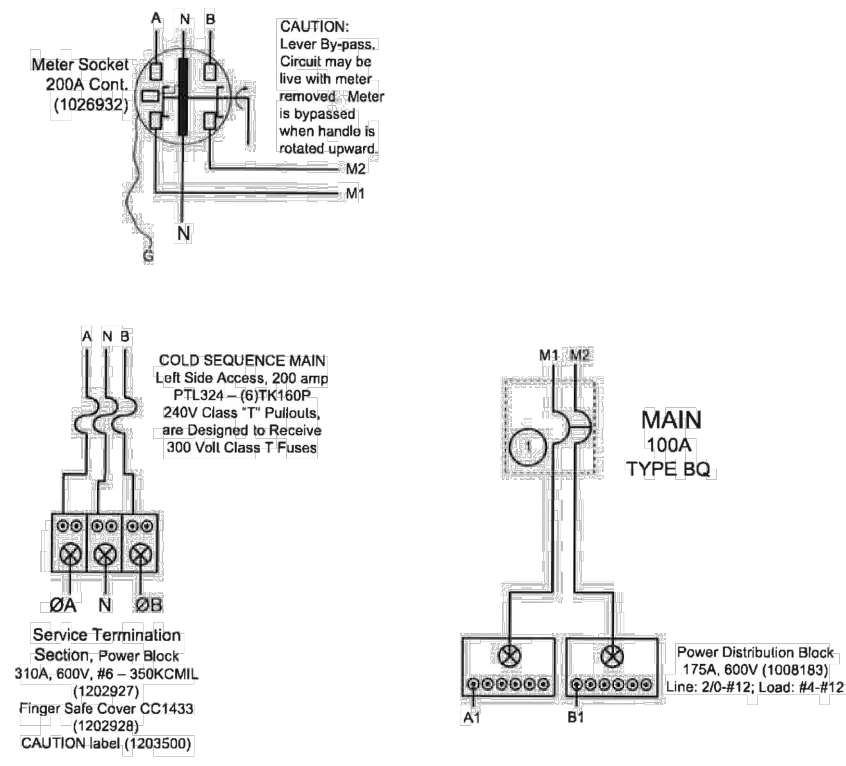

Sheet 2 of 2

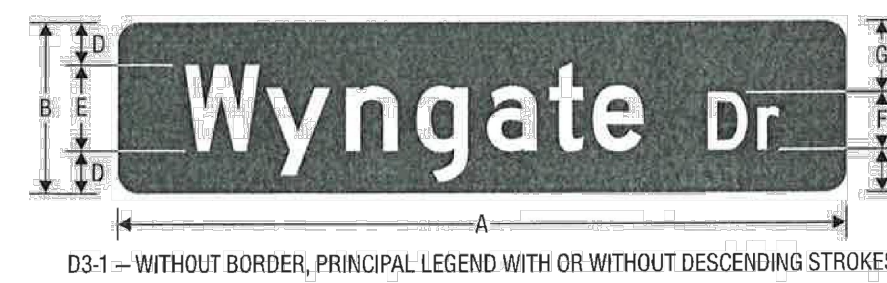
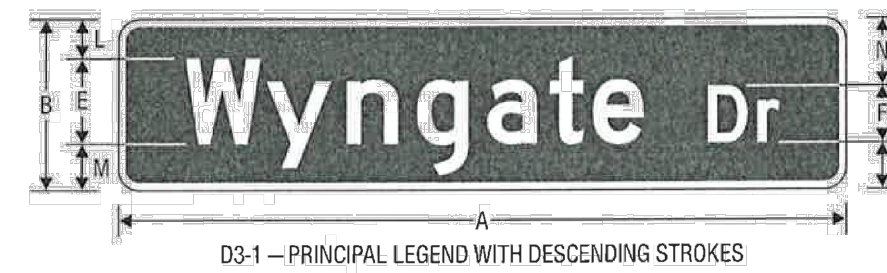
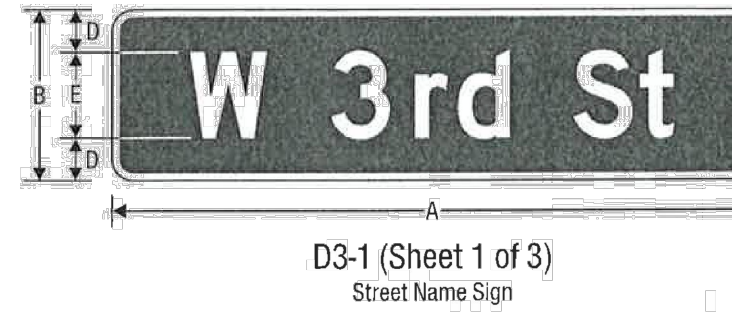
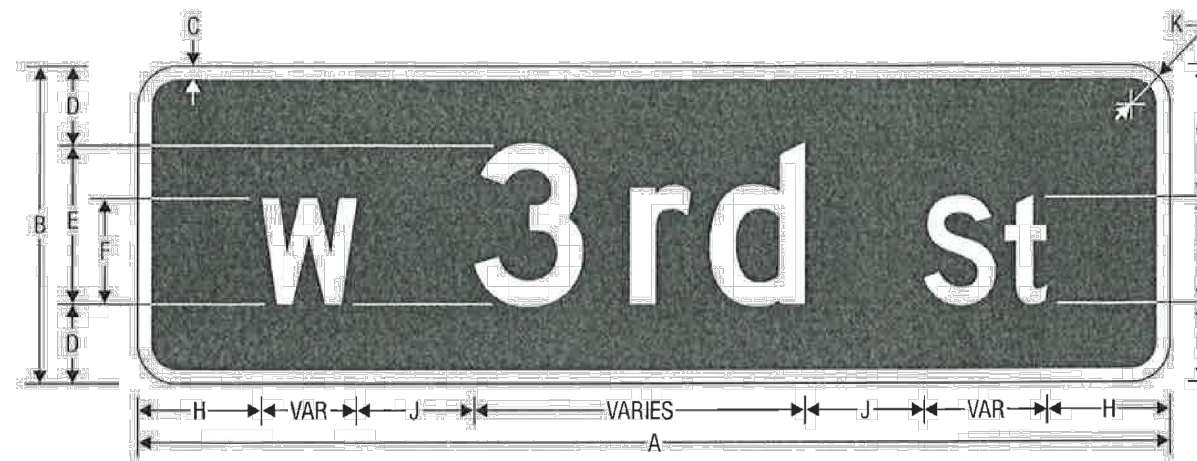

	A	B	C	D	E	F	G	H	J	K	L	M	N	O
VAR	8	0.375	2	4 D	3 D	3	3 (MIN)	3	1	1.75	2.25	2.75	1.5 D	
VAR	12	0.5	3	6 D	4 D	5	4.5 (MIN)	4.5	1.5	2.75	3.25	4.75	3 D	
VAR	18	0.75	5	8 D	5.33 D	7.67	5.33 (MIN)	6	1.875	5	5	7.67		
VAR	24	1	6	12 D	8 D	10	9 (MIN)	9	2.25	5.5	6.5	9.5		

COLORS: LEGEND, BORDER - WHITE (RETROREFLECTIVE)
 BACKGROUND - GREEN (RETROREFLECTIVE)
 BACKGROUND (ALTERNATE) - BLUE OR BROWN (RETROREFLECTIVE)

X-XX

Sheet 1 of 3
 Issued 10/14/201

3/27/23, 7:42 AM

AppF-27.png (2149*2853)

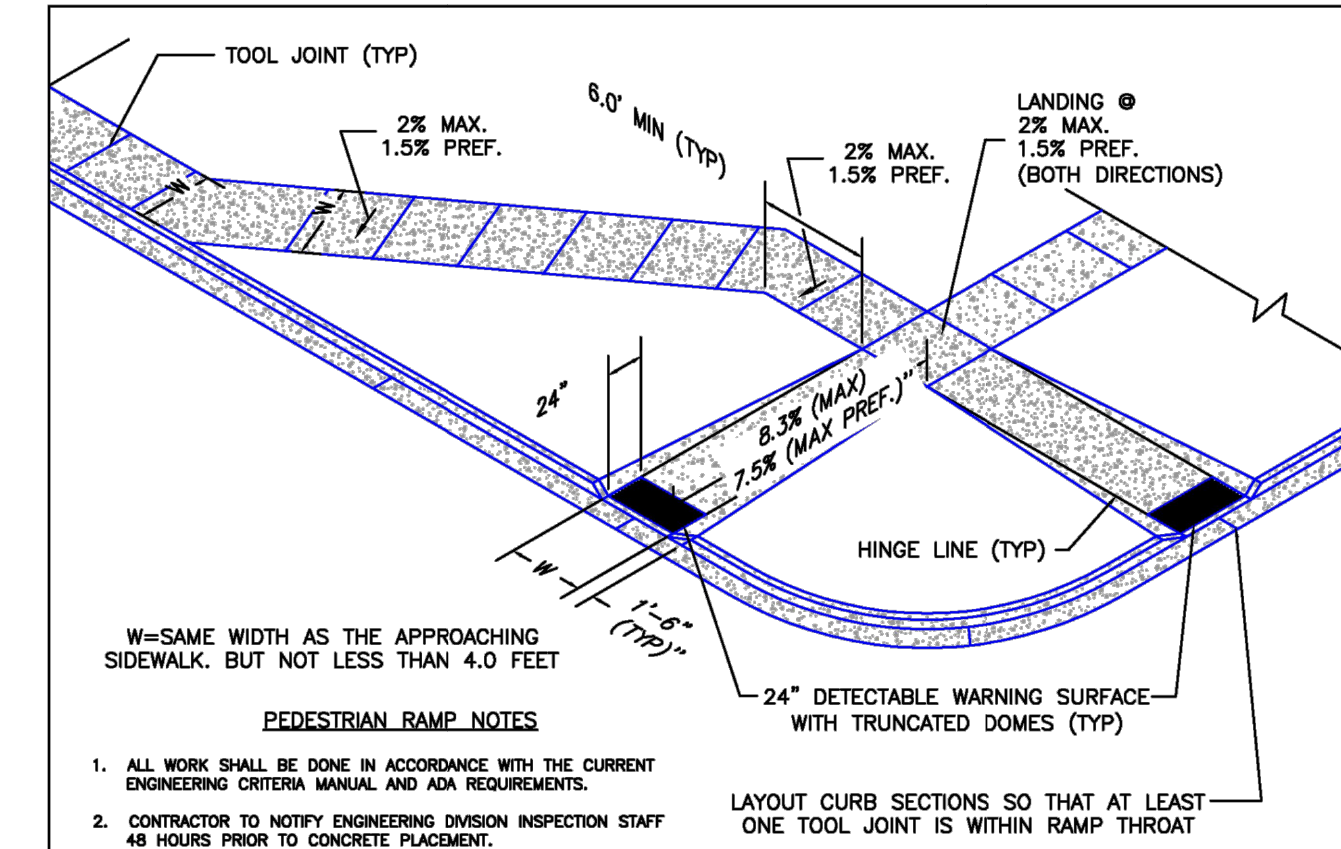

- PEDESTRIAN RAMP NOTES**
- ALL WORK SHALL BE DONE IN ACCORDANCE WITH THE CURRENT ENGINEERING CRITERIA MANUAL AND ADA REQUIREMENTS.
 - CONTRACTOR TO NOTIFY ENGINEERING DIVISION INSPECTION STAFF 48 HOURS PRIOR TO CONCRETE PLACEMENT.
 - PEDESTRIAN CURB RAMP CONSTRUCTION SHALL BE A MINIMUM 4,500 PSI CONCRETE, MINIMUM 4" THICK, NON-COLORED, NON-SCORED, COARSE BROOM FINISH.
 - PEDESTRIAN CURB RAMP LOCATION AND LENGTH MAY REQUIRE MODIFICATION TO MAINTAIN THE 8.3% MAXIMUM RUNNING RAMP SLOPE DUE TO STREET INTERSECTION GRADINGS AND/OR ALIGNMENTS. SEE SCM SECTION 6.3.6 FOR PEDESTRIAN PUSHBUTTON LOCATION REQUIREMENTS.
 - DETECTABLE WARNING SURFACE SHALL START A MINIMUM OF 6" BUT NOT MORE THAN 8" FROM THE FLOWLINE OF THE CURB AT ANY POINT.
 - DETECTABLE WARNING SURFACE SHALL BE PREFABRICATED, CAST IRON (PRIMA NATURAL FINISH) AND IN ACCORDANCE WITH SCM CHAPTER 8 AND SD-2-42. THERMOPLASTIC TRUNCATED DOMES AND PAVERS WILL NOT BE ACCEPTED.
 - THE DETECTABLE WARNING SURFACE SHALL BE 24" IN LENGTH AND THE FULL WIDTH OF THE RAMP.
 - PEDESTRIAN CURB RAMP WIDTH REQUIRED IS SAME AS APPROACHING SIDEWALK, 4' MINIMUM.
 - ALL PEDESTRIAN CURB RAMP SHALL BE PERPENDICULAR TO TRAFFIC WITH THE EXCEPTION OF MID-BLOCK OR TERMINAL RAMP WHICH MAY BE PARALLEL SUBJECT TO APPROVAL.
 - DRAINAGE STRUCTURES, TRAFFIC SIGNAL/SIGNAL, UTILITIES/JUNCTION BOXES, OR OTHER OBSTRUCTIONS WITHIN PROPOSED PEDESTRIAN CURB RAMP AREAS AND LANDINGS ARE PROHIBITED.
 - THE COUNTER SLOPE OF THE GUTTER OR ROAD AT THE FOOT OF A RAMP SHALL NOT EXCEED 5%.
- GENERAL NOTES**
- WHERE THE 1"-8" FLARED SIDING OF A PERPENDICULAR CURB RAMP IS (ARE) CONTIGUOUS WITH A PEDESTRIAN OR HARD SURFACE AREA (PEDESTRIAN CIRCULATION PATH), THE MAXIMUM FLARE SLOPE SHALL NOT EXCEED 10:1.
 - PEDESTRIAN WALKWAY (PEDESTRIAN ACCESS ROUTE) AND/OR LOCATION OF EXISTING OR FUTURE PEDESTRIAN RAMP ON OPPOSITE CORNERS SHALL BE REVIEWED BEFORE CONSTRUCTING NEW RAMPS.
 - AT MARKED PEDESTRIAN CROSSINGS, THE BOTTOM OF THE RAMPS, EXCLUSIVE OF THE FLARE SIDING, SHALL BE TOTALLY CONTAINED WITHIN THE MARKINGS.

6/23/20
 DATE APPROVED: Jennifer E. Irvine
 DEPARTMENT OF PUBLIC WORKS

Pedestrian Curb Ramp Detail
 Standard Drawing
 REVISION DATE: 6/23/20
 FILE NAME: SD_2-41

https://mclibrary.blob.core.usgovcloudapi.net/codecontent/15646/367064/AppF-27.png

1/1

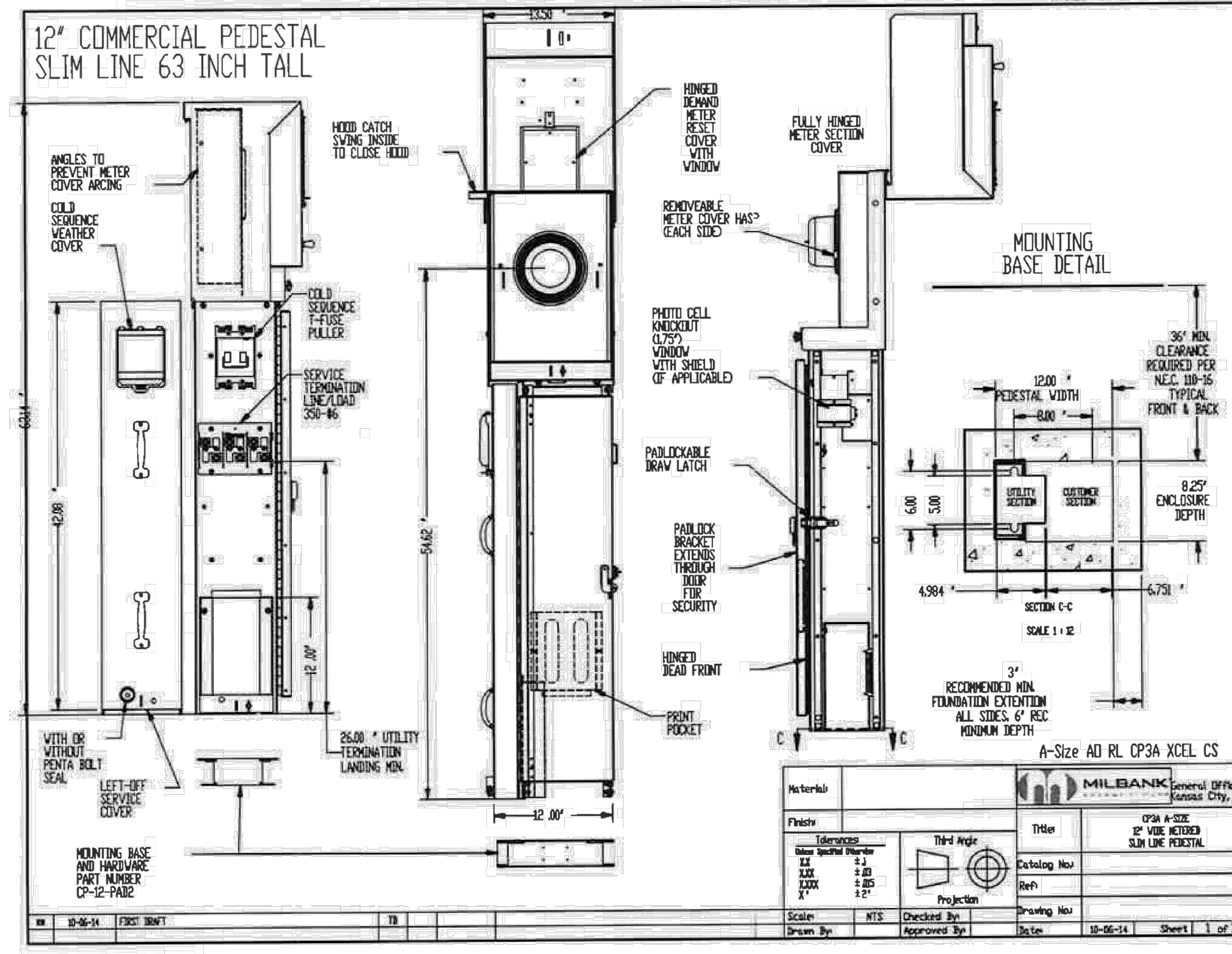

Material	Quantity	Notes
304 A-316 1/2" V-BE RIBBED SLIM LINE PEDESTAL	1	

3/27/23, 7:41 AM

AppF-26.png (3061*2280)

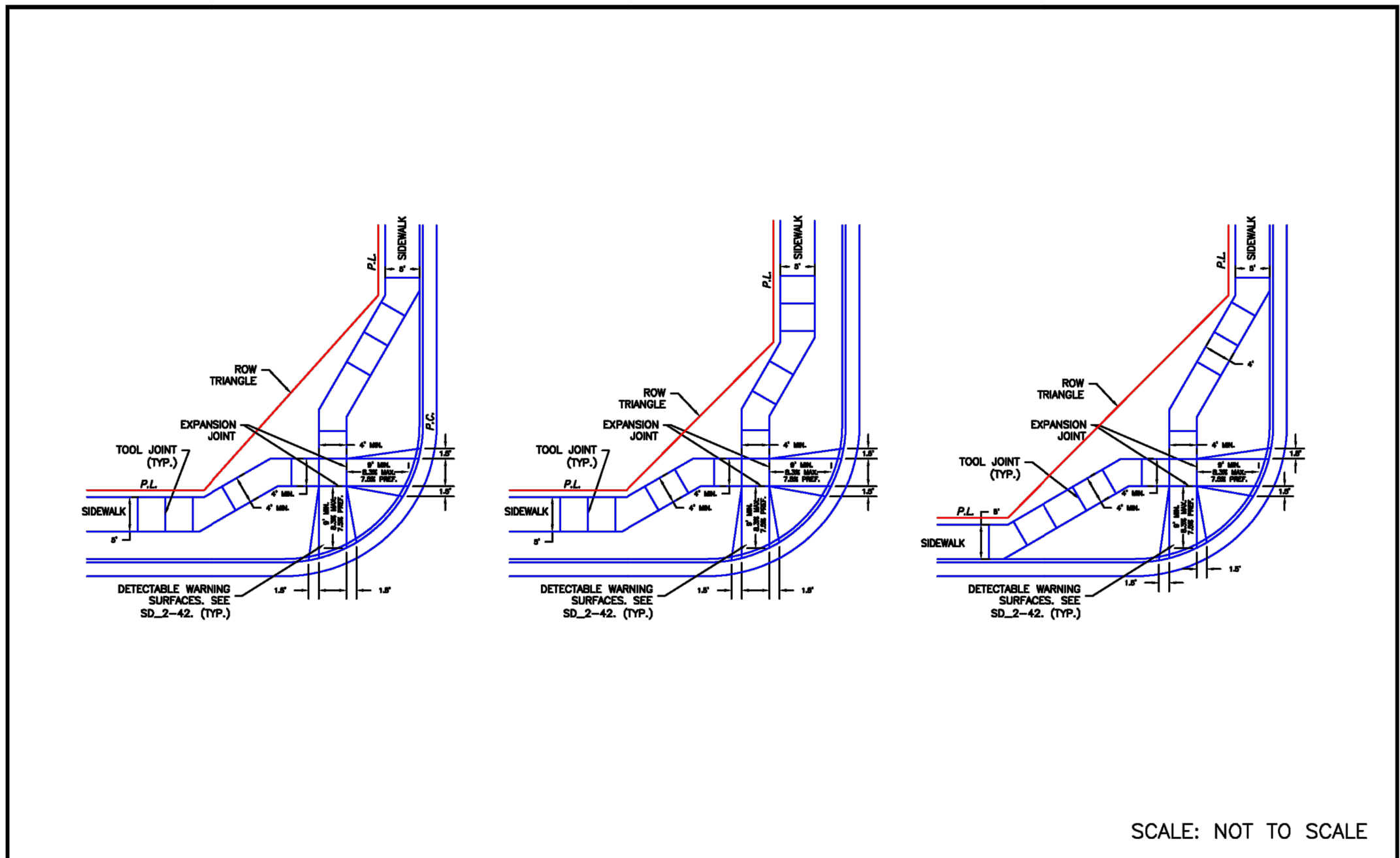

6/23/20
 DATE APPROVED: Jennifer E. Irvine
 DEPARTMENT OF PUBLIC WORKS

Pedestrian Curb Ramp Detail
 Standard Drawing
 REVISION DATE: 6/23/20
 FILE NAME: SD_2-40

https://mclibrary.blob.core.usgovcloudapi.net/codecontent/15646/367064/AppF-26.png

1/1

EPC 6/28/23

NO.	REVISION	BY	DATE	APPR

Kimley»Horn
 2023 KIMLEY-HORN AND ASSOCIATES, INC.
 2 North Nevada Avenue, Suite 900
 Colorado Springs, Colorado 80903 (719) 453-0180

DESIGNED BY: KRK
 DRAWN BY: RES
 CHECKED BY: E.JG
 DATE: 06/26/2023

SOLACE APARTMENTS FILING NO. 2
 CONSTRUCTION DOCUMENTS
 GALLEY RD & PAONIA ST - TRAFFIC SIGNAL PLANS
 DETAILS

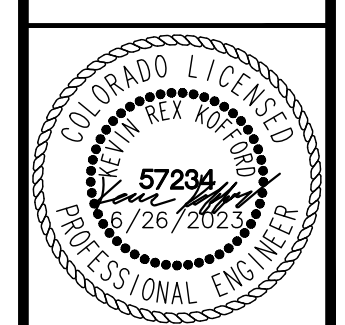

PROJECT NO. 09668009
 SHEET

11

K:\COS_LA\196140002 - Cimarron Hills\Phase 2\CADD\PlanSheets\SIG\196140002 - SIG_DETALL.dwg Schmelbach, Ryan 6/26/2023 2:36 PM