

131 Metcalf Lane, 80132

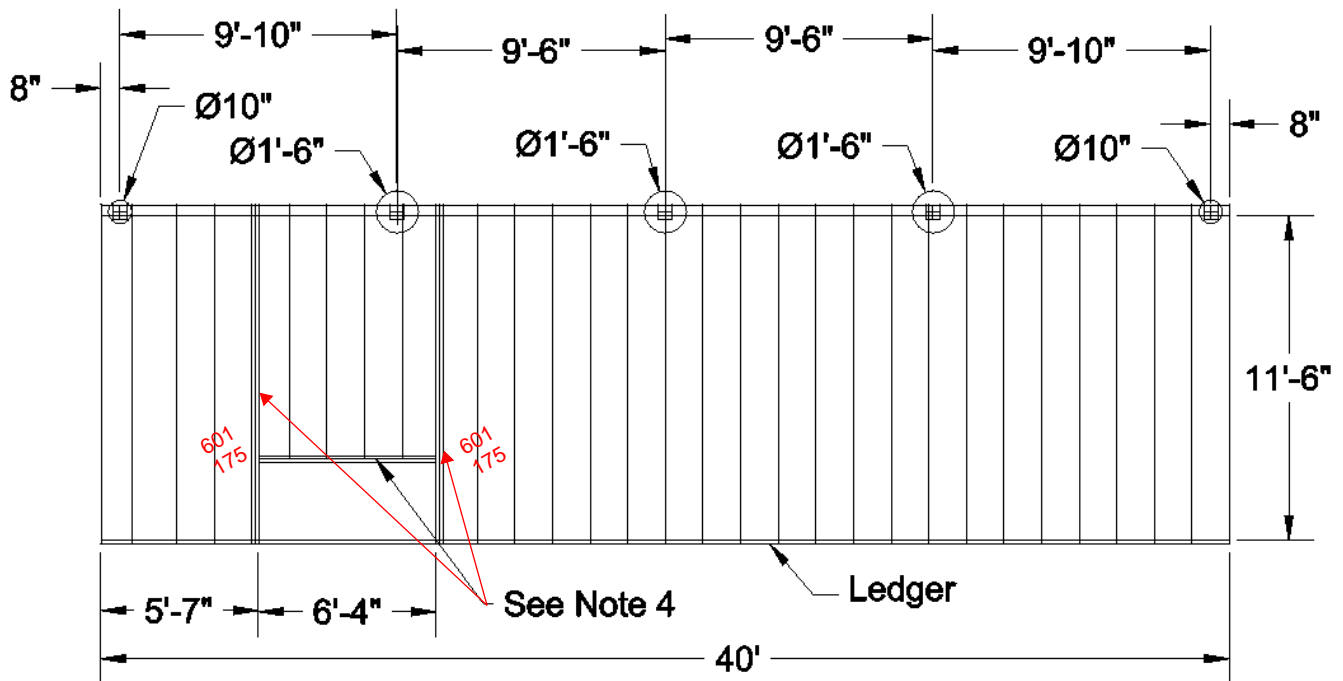

Notes

1. All joists 2x8, hem fir #2 or better pressure treated. 16" OC
2. Decking – Composite 1" x 6" Parallel to house
3. Outer beam – Flush mount (3) 2x10
4. Three internal beams – (3) 2x8" hem fir #2 or better pressure treated, flush mount. Use LUS28-3 on triple beams – 6 places
5. For ledger at Simpson LUS210-3 , use (4) 3/8" lag screws within 3" of the bracket on either side, with the bracket no closer than 6" from the end of the ledger
6. Joist hangers LUS26 at ledger and beams
7. Joist hangers at Corners – L70
8. Posts – Pressure treated 6x6
9. Concrete Piers – 30" deep, diameter as indicated
10. Post to beam connectors two L30
11. 2 x 8 Ledger, hem fir #2 or better pressure treated with (2) 3/8" lag screws 16" OC "
12. Railings – Trex Aluminum
13. No Hot tub. No electric. No cover