

**NOTES:**  
 THERE WILL BE NO ASPHALT,  
 CONCRETE BATCH PLANTS AND  
 MASONRY MIX STATIONS ON THIS SITE.

**NOTES:**  
 THE SITE HAS BEEN PREVIOUSLY  
 DISTURBED WITH MASS GRADING  
 OPERATIONS AND VEGETATION IS  
 SPARSE AND OF NATURAL GRASSLAND  
 CONSISTENCY (NO TREES OR SHRUBS).

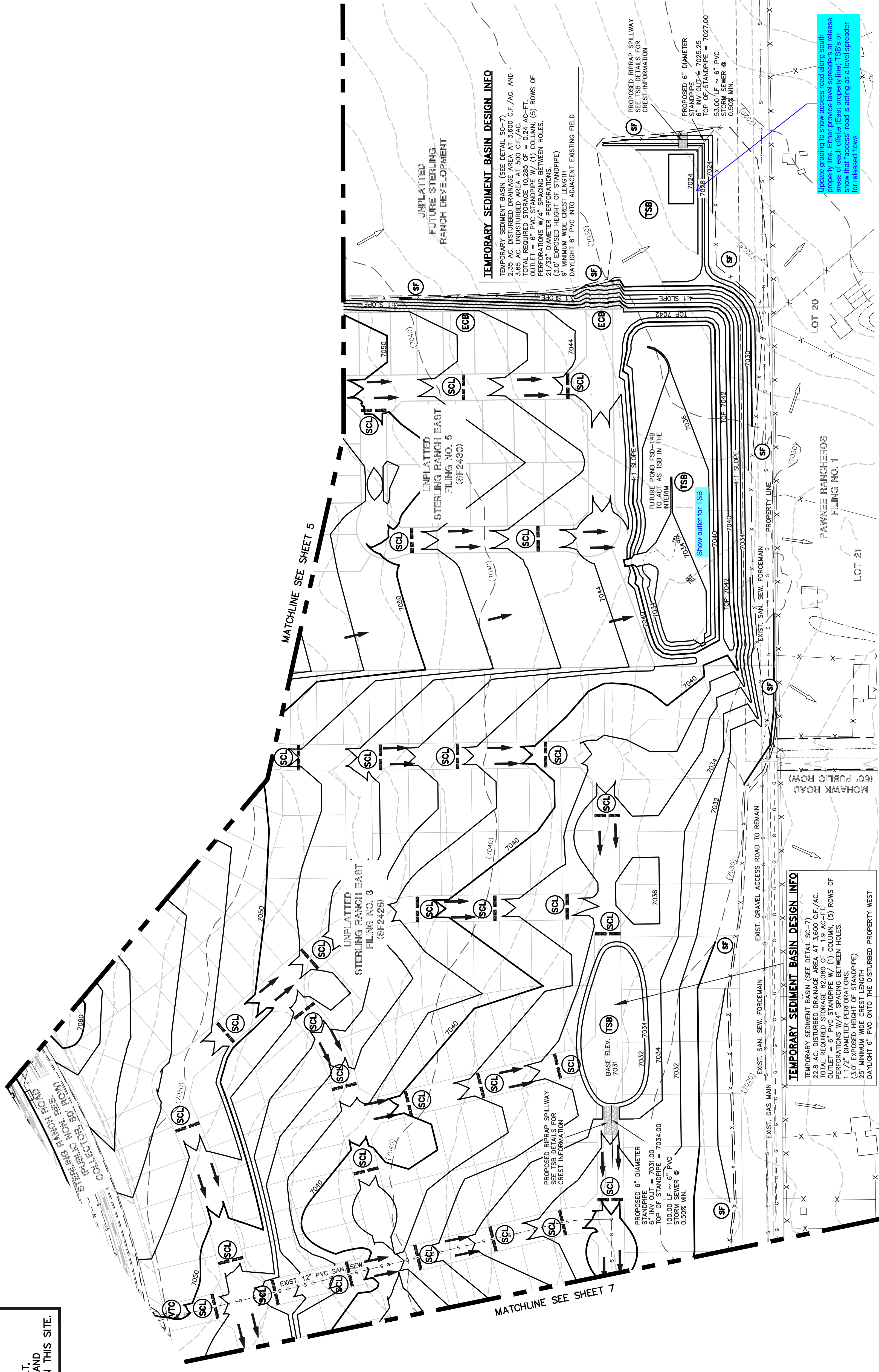

**TEMPORARY SEDIMENT BASIN DESIGN INFO**  
 TEMPORARY SEDIMENT BASIN (SEE DETAIL SC-7)  
 TOTAL REQUIRED STORAGE 10,285 CF = 0.24 AC-FT.  
 TOTAL REQUIRED STORAGE 10,285 CF = 0.24 AC-FT.  
 OUTLET = 6" PVC STANDPIPE W/ (1) COLUMN, (5) ROWS OF  
 PERFORATIONS W/ 1/4" SPACING BETWEEN HOLES.  
 (3.0' EXPOSED HEIGHT OF STANDPIPE)  
 9' MINIMUM WIDE CREST LENGTH  
 DAYLIGHT 6" PVC INTO ADJACENT EXISTING FIELD

**TEMPORARY SEDIMENT BASIN DESIGN INFO**  
 TEMPORARY SEDIMENT BASIN (SEE DETAIL SC-7)  
 TOTAL REQUIRED STORAGE 82,080 CF = 1.9 AC-FT.  
 OUTLET = 6" PVC STANDPIPE W/ (1) COLUMN, (5) ROWS OF  
 PERFORATIONS W/ 1/4" SPACING BETWEEN HOLES.  
 (3.0' EXPOSED HEIGHT OF STANDPIPE)  
 25' MINIMUM WIDE CREST LENGTH  
 DAYLIGHT 6" PVC ONTO THE DISTURBED PROPERTY WEST

Update grading to show access road along south  
 property line. Either provide level spreaders at release  
 areas of each offset (East property line) TSB's or  
 show that "access" road is acting as a level spreader  
 or reduced flows

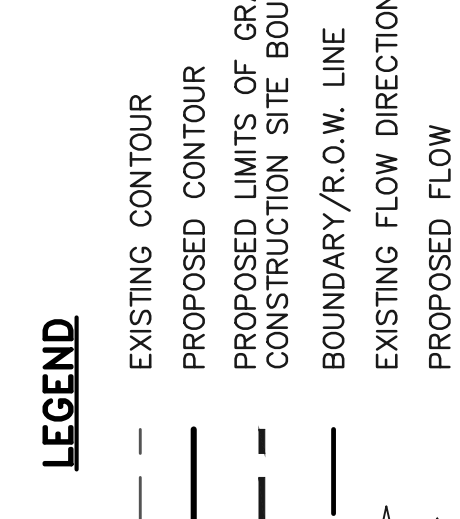
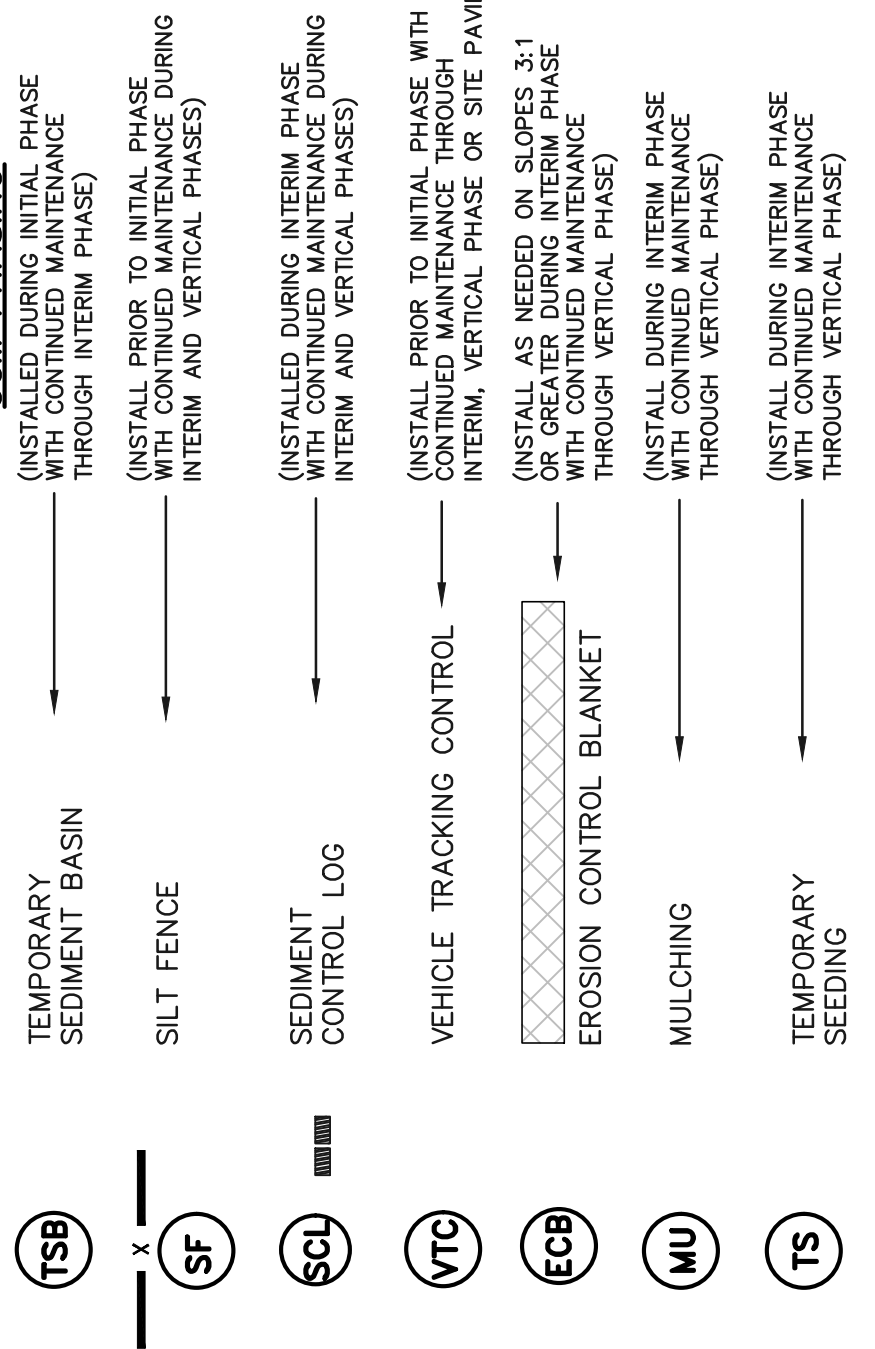

**NOTE:**  
 THIS OFF-SITE GRADING WITHIN STERLING RANCH EAST FILING NO. 3 AND NO. 5 IS SHOWN AS A PART OF THIS GEC PLAN AS REQUIRED TO PROVIDE MATERIAL BORROW/STOCKPILE AREAS AND UTILITY CORRIDORS FOR THE VILLAGES DEVELOPMENT.  
 FINAL GEC PLANS FOR EACH OF THESE AREAS WILL BE REQUIRED PRIOR TO FORMAL DEVELOPMENT OF THESE FINAL PLATS.

**CLASSIC CONSULTING**

VILLAGES AT STERLING RANCH

EARLY GRADING AND EROSION CONTROL PLAN  
 OFF-SITE DISTURBANCE AREA

PCD FILE # PUD SP226

DESIGNED BY MAW SCALE DATE 1/9/25  
 DRAWN BY MAW (H) 1" = 100' SHEET 6 OF 9  
 CHECKED BY (V) 1" = N/A JOB NO. 1183.26

REVIEW: PREPARED UNDER MY DIRECT SUPERVISION FOR AND ON BEHALF OF CLASSIC CONSULTING AND REGISTERED SURVEYORS, LLC DATE 2/21/2025  
 MARC A. WHORTON (303) 684-3883 (719) 755-0758 (cell) #37155

NO. REVISION DATE

48 HOURS BEFORE YOU DIG,  
**811**  
 CALL UTILITY LOCATORS

UTILITY NOTIFICATION CENTER OF COLORADO  
 IT'S THE LAW

THE LOCATIONS OF EXISTING UNDERGROUND UTILITIES ARE SHOWN FOR INFORMATION ONLY. THE CONTRACTOR SHALL DETERMINE THE EXACT LOCATION OF ALL EXISTING UTILITIES BEFORE COMMENCING WORK. THE CONTRACTOR SHALL BE RESPONSIBLE FOR ANY DAMAGE TO UTILITIES WHICH MIGHT BE CAUSED BY THE FAILURE TO EXACTLY LOCATE AND PRESERVE ANY AND ALL UNDERGROUND UTILITIES.