

Please include:

- Owner / applicant contact information
- Property address
- Graphic scale and north arrow
- location of lighting devices

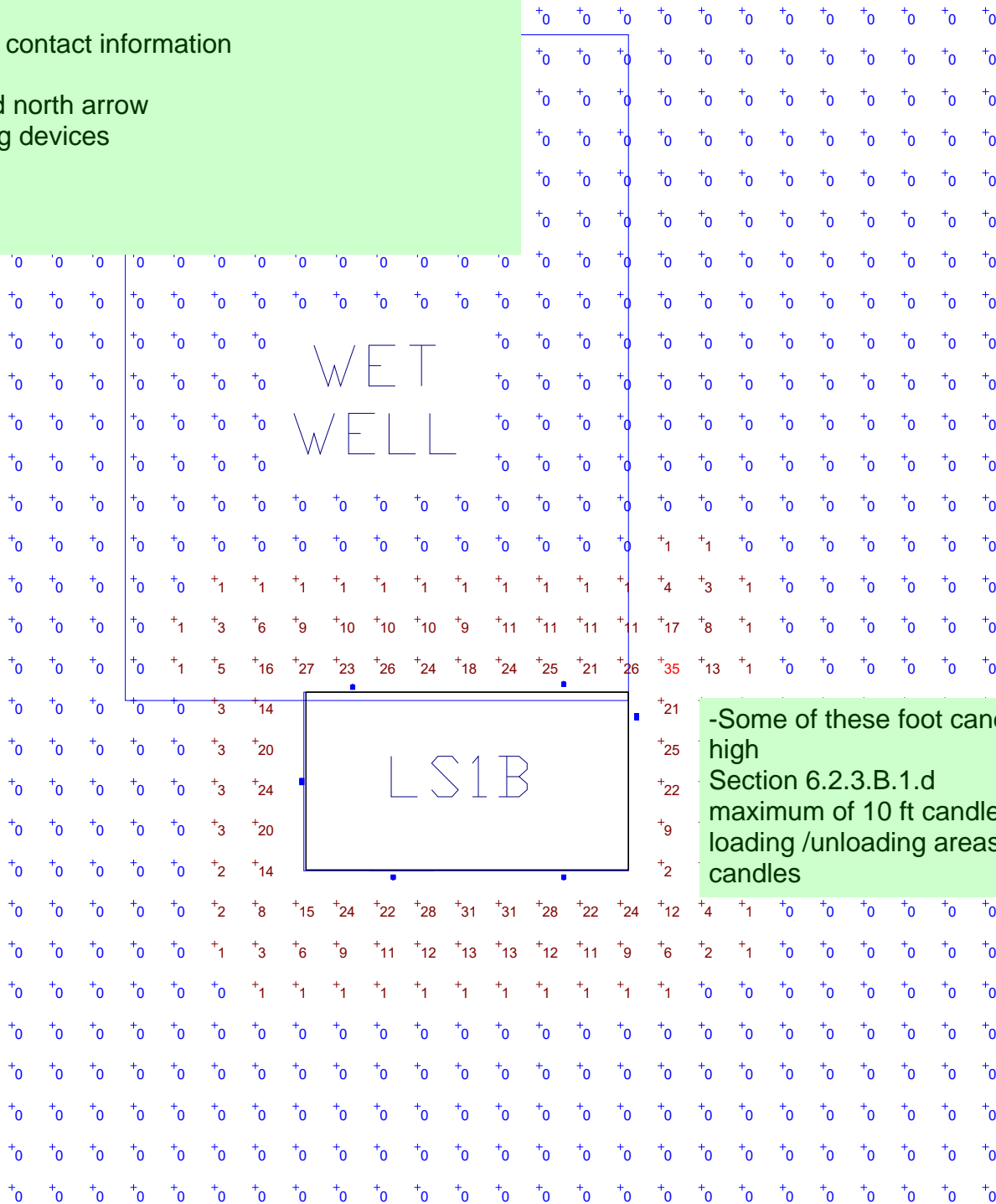

-Some of these foot candles are too high
Section 6.2.3.B.1.d
maximum of 10 ft candles expect in
loading /unloading areas = 20 ft
candles

Plan View



**Cherokee Photometric Study
LS1B Site**

Designer
Amber Ruter
Date
12/14/2022
Scale
Not to Scale
Drawing No.

Summary
Photometric Study

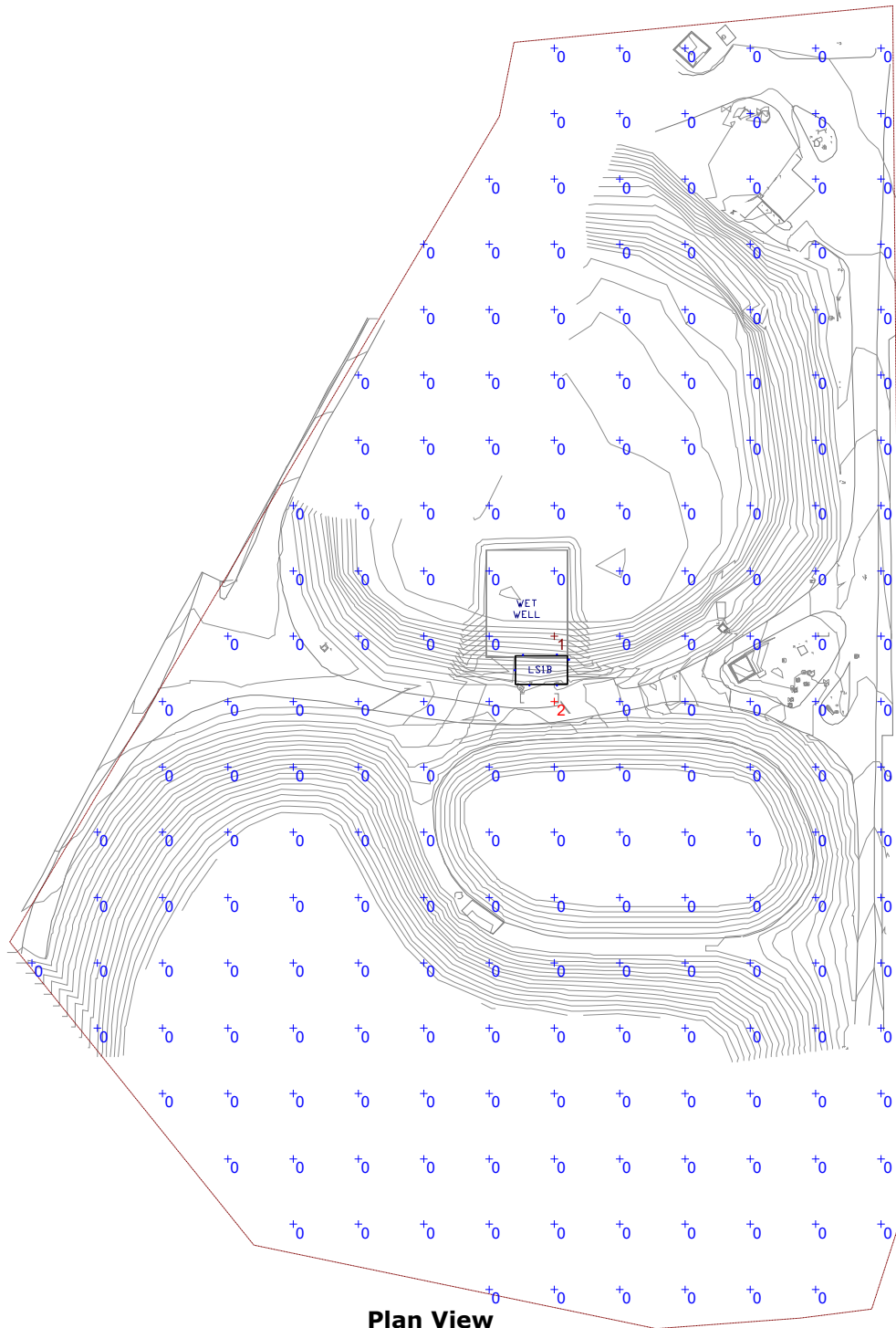

Plan View



**Cherokee Photometric Study
Full Site**

Designer
Amber Ruter
Date
12/14/2022
Scale
Not to Scale
Drawing No.

Summary
Photometric Study

OUTDOOR PHOTOMETRIC REPORT

CATALOG: BNS2-36L-400-5K7-1-CGL

Manufacturer: KIM LIGHTING
Test Lab: CURRENT
Catalog: BNS2-36L-400-5K7-1-CGL
Description: BNS2 DATA SHOWN IS ABSOLUTE. Healthcare, Medical, Hospitality, Hotel, Industrial, Institutional, Library, Parking, Parks, Pathway, Pedestrian, Sidewalk, Walkway, Prison, Recreation, Sports, Residential, Retail, Roadway, Street, Utility, Accent, Decorative, Direct, Downlight, Damp Location, Retrofit
Lamp: C-70-CRI
Lamp Output: Total luminaire Lumens: 5493.9, **absolute photometry ***
Input Wattage: 47.67
Luminous Opening: Circular (Dia: 11.76")
Max Cd: 5,200.2 at Horizontal: 70°, Vertical: 45°

No
Photo
Available

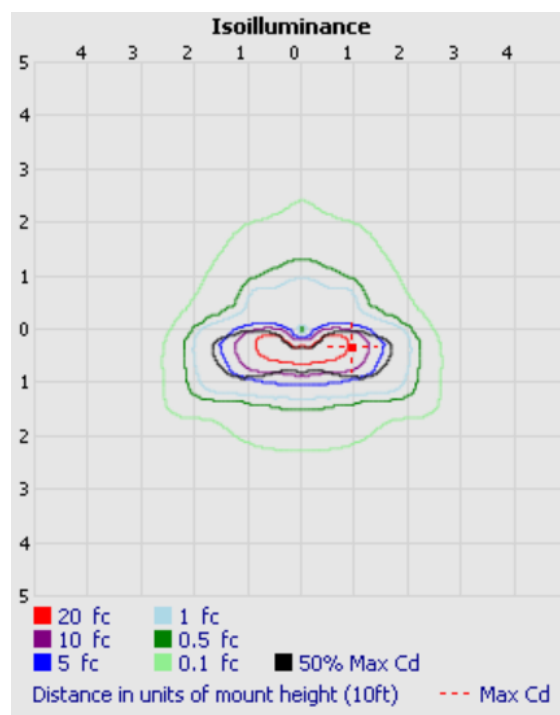
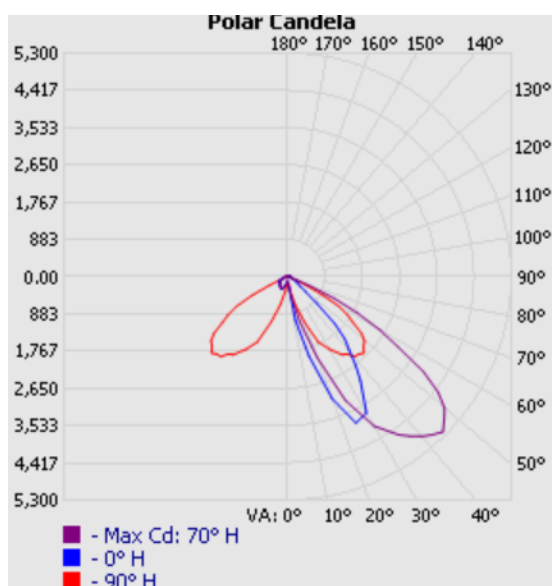

*Test based on absolute photometry where lamp lumens=lumens total.
*Cutoff Classification and efficiency cannot be properly calculated for absolute photometry.

Visual Photometric Tool 1.2.46 copyright 2022, Acuity Brands Lighting.

This Photometric report has been generated using methods recommended by the IESNA. Calculations are based on Photometric data provided by the manufacturer, and the accuracy of this Photometric report is dependent on the accuracy of the data provided. End-user environment and application (including, but not limited to, voltage variation and dirt accumulation) can cause actual Photometric performance to differ from the performance calculated using the data provided by the manufacturer. This report is provided without warranty as to accuracy, completeness, reliability or otherwise. In no event will Acuity Brands Lighting be responsible for any loss resulting from any use of this report.

Zonal Lumen Summary

Zone	Lumens	% Luminaire
0-30	1,141.7	20.8%
0-40	2,464.2	44.9%
0-60	4,904.1	89.3%
60-90	465.0	8.5%
70-100	111.2	2%
90-120	91.0	1.7%
0-90	5,369.1	97.7%
90-180	124.8	2.3%
0-180	5,493.9	100%

Lumens Per Zone

Zone	Lumens	% Total	Zone	Lumens	% Total
0-10	23.7	0.4%	90-100	20.6	0.4%
10-20	267.0	4.9%	100-110	30.7	0.6%
20-30	851.0	15.5%	110-120	39.7	0.7%
30-40	1,322.5	24.1%	120-130	26.8	0.5%
40-50	1,449.2	26.4%	130-140	5.9	0.1%
50-60	990.8	18.0%	140-150	1.0	0%
60-70	374.4	6.8%	150-160	0.000	0%
70-80	73.0	1.3%	160-170	0.000	0%
80-90	17.6	0.3%	170-180	0.000	0%

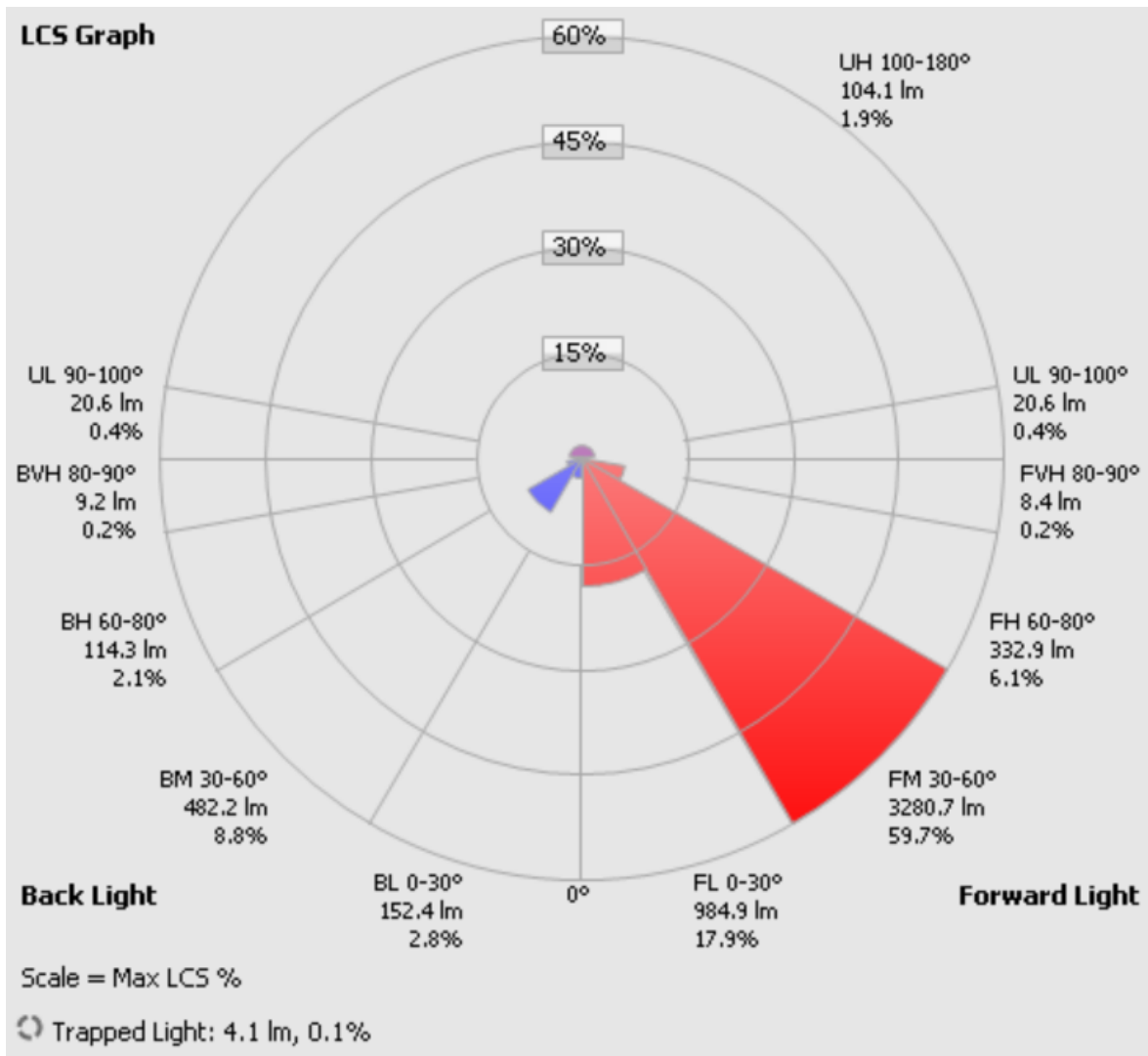

Candela Table - Type C

	0	10	20	30	40	50	60	70	80	90	100	110	120	130	140	150	160	170	180	
0	0	0	0	0	0	0	0	0	0	0	0	0	0	0	0	0	0	0	0	0
5	214	190	178	163	133	131	140	139	133	127	112	103	93	83	82	83	83	83	83	83
10	1048	944	792	697	692	613	556	495	455	360	284	211	184	161	158	153	149	151	151	151
15	1944	1908	1660	1639	1621	1495	1304	1106	942	689	447	309	257	238	222	215	213	222	213	213
20	3080	3000	2654	2578	2684	2619	2276	2035	1687	1140	629	407	316	288	279	265	265	285	276	276
25	3829	3759	3468	3408	3527	3523	3338	3239	2638	1705	859	458	339	320	311	301	311	337	330	330
30	3726	3683	3672	3811	3936	4161	4166	4090	3365	1987	925	458	349	325	312	308	320	341	335	335
35	3004	3053	3180	3530	3986	4387	4598	4571	3956	2258	890	405	346	333	303	286	295	312	304	304
40	2263	2371	2512	2832	3685	4386	4845	4941	4412	2473	898	406	375	366	306	270	278	290	281	281
45	1582	1770	1962	2270	3087	4188	5145	5200	4625	2556	809	435	442	396	315	250	255	269	264	264
50	550	618	1018	1509	2283	3599	4802	4854	4341	2373	593	318	362	368	259	224	224	238	237	237
55	307	319	363	511	1145	2333	3747	3923	3751	1885	419	213	220	229	207	195	198	217	235	235
60	226	232	247	260	397	1150	2053	2509	2550	1401	331	162	155	165	171	168	180	193	234	234
65	167	169	185	194	191	450	1284	1223	997	468	155	120	116	122	138	153	146	156	206	206
70	110	111	119	124	112	148	406	251	180	120	97	83	80	85	92	122	111	117	167	167
75	56	54	56	62	54	59	70	65	65	64	59	51	47	47	49	71	68	76	128	128
80	21	22	21	19	20	21	24	28	30	29	28	25	23	21	21	24	26	40	75	75
85	13	13	12	11	10	9	11	13	15	15	15	15	15	13	12	10	9	8	7	7
90	17	17	15	14	12	12	13	15	17	17	17	17	17	15	14	12	11	10	10	10
95	23	22	21	19	17	17	18	20	22	22	21	21	20	19	17	16	14	13	13	13
100	29	29	27	25	23	22	23	25	27	28	27	26	24	23	21	19	18	17	16	16
105	37	36	34	31	29	28	29	30	32	33	32	30	29	27	25	23	21	21	21	21
110	44	43	41	38	36	34	35	36	38	39	38	36	34	32	29	28	26	26	27	27
115	53	51	48	46	42	40	41	42	44	46	44	41	39	37	35	33	32	33	34	34
120	62	60	58	56	50	43	36	40	46	49	46	38	30	31	40	38	38	39	40	40
125	59	57	56	52	46	37	22	20	27	28	25	17	13	20	26	24	22	21	22	22
130	24	23	21	20	17	17	13	6	8	9	8	6	9	12	12	11	10	10	10	10
135	2	2	2	2	2	3	4	5	6	6	6	7	8	9	9	9	8	8	8	8
140	1	1	2	2	3	3	4	6	7	7	7	8	8	9	10	10	9	9	9	9
145	0	0	0	0	0	0	0	0	0	0	0	0	0	0	0	0	0	0	0	0
150	0	0	0	0	0	0	0	0	0	0	0	0	0	0	0	0	0	0	0	0
155	0	0	0	0	0	0	0	0	0	0	0	0	0	0	0	0	0	0	0	0
160	0	0	0	0	0	0	0	0	0	0	0	0	0	0	0	0	0	0	0	0
165	0	0	0	0	0	0	0	0	0	0	0	0	0	0	0	0	0	0	0	0
170	0	0	0	0	0	0	0	0	0	0	0	0	0	0	0	0	0	0	0	0
175	0	0	0	0	0	0	0	0	0	0	0	0	0	0	0	0	0	0	0	0
180	0	0	0	0	0	0	0	0	0	0	0	0	0	0	0	0	0	0	0	0

LNC

COMPACT LED LITEPAK

FEATURES

- Compact LNC LED is designed for perimeter illumination and available in 3 lumen packages for safety, security and identity
- 3000K, 4000K, **5000K** and Amber color temperatures
- Up to 4:1 spacing to mounting height ratio means fewer fixtures to install
- Acrylic diffuser included! Use for applications near entrances or locations where reduced brightness is desired. (Maximum spacing with diffuser 30ft)
- Die-cast aluminum housing with decorative Laredo styling
- Full cut-off neighbor friendly
- Listed to UL1598 for use in wet locations

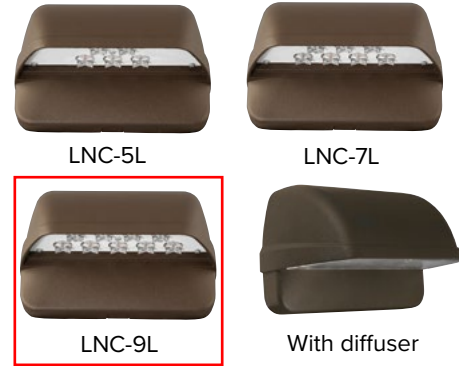

SPECIFICATIONS

CONSTRUCTION

- Decorative die-cast aluminum housing and door
- Rugged design protects internal components and provides excellent thermal management for long life
- Powder paint finishes provide lasting appearance in outdoor environments
- Full cut-off distribution; Ambient diffuser included, use for applications near entrances or locations where reduced brightness is desired

OPTICS

- Drivers are 120-277V, 50/60Hz Type II, III and Type IV lenses provide wide lateral spread
- 3000K - 80 CRI, 4000K - 70 CRI, and 5000K - 70 CRI, CCT nominal
- Drivers have greater than .90 power factor and less than 20% Total Harmonic Distortion

INSTALLATION

- Quick mount adapter provides quick installation, designed for recessed box 4" square junction box

ELECTRICAL

- 60,000 hours minimum LED life at L96 rating per IESNA TM-21-11
- Minimum operating temperature is -40°C/-40°F
- 0-10V dimming 120-277V only
- LNC5L – 5 LEDs, Types II, III or IV available, see page 2 for electrical details
- LNC7L – 7 LEDs, Type II, III or IV available, see page 2 for electrical details
- LNC9L – 9 LEDs, Types II, III or IV available, see page 2 for electrical details

CONTROLS

- Photocontrol option is available to provide dusk-to-dawn control for additional energy savings

CERTIFICATIONS

- Listed and labeled to UL 1598 for wet locations, 25°C ambient environments

WARRANTY

- 5 year warranty

KEY DATA	
Lumen Range	800–2100
Wattage Range	13–22
Efficacy Range (LPW)	64–95
Fixture Projected Life (Hours)	L96>60K
Weights lbs. (kg)	9.6 (24.5)

ORDERING GUIDE

Example: LNC-5L-U-3K-2-BLT-PCU

CATALOG # _____

ORDERING INFORMATION

Series	# LEDs	Voltage	CCT/CRI	IES Distribution	Finish	Mounting
LNC LNC Zero Uplight	5L 5 LEDs 7L 7 LEDs 9L 9 LEDs	U 120-277V 1 120V 2 208V 3 240V 4 277V	3K 3000K nominal, 70 CRI 4K 4000K nominal, 70 CRI 5K 5000K nominal, 70 CRI AM Amber (590 μm available for "Turtle Friendly"/ observatory applications, 350mA (consult factory) ¹)	2 Type II 3 Type III 4 Type IV	BLT Black Matte Textured BLS Black Gloss Smooth DBT Dark Bronze Matte Textured DBS Dark Bronze Gloss Smooth GTT Graphite Matte Textured LGS Light Grey Gloss Smooth PSS Platinum Silver Smooth WHT White Matte Textured WHS White Gloss Smooth VGT Verde Green Textured Color Option CC Custom Color	PCU Universal Button Photocell

Notes:
1 Amber LEDs only available on 7L and 9L configurations, 350mA

REPLACEMENT PARTS AND ACCESSORIES

Catalog Number	Description
<input type="checkbox"/> 93039574	Frosted comfort shield, improved uniformity with only 5% reduction

PERFORMANCE DATA

# Of LEDs	Nominal Wattage	System Watts	Dist. Type	5K (5000K NOMINAL 70 CRI)		4K (4000K NOMINAL 70 CRI)		3K (3000K NOMINAL 80 CRI)		AM (<580 nm wave-length)		
				Lumens	LPW*	Lumens	LPW	Lumens	LPW	Lumens	System Watts	LPW*
5	STD. (700mA) AM (350mA)	13W	2	1,150	88.5	1,052	81	883	68	-	-	-
			3	1,132	87	1,077	83	833	64	-	-	-
			4	1,146	88	1,053	81	849	65	-	-	-
7		17W	2	1,515	89	1,369	80.5	1,272	75	-	-	-
			3	1,500	88	1,539	90.5	1,392	82	268	6.6	59
			4	1,557	91.5	1,535	90	1,425	84	-	-	-
9	22W	2	2,069	94	2,033	92	1,588	72	-	-	-	
		3	2,024	92	1,989	90	1,623	74	-	-	-	
		4	2,095	95	2,059	93.5	1,680	76	382	8.3	46	

* Lumen values are from photometric tests performed in accordance with IESNA LM-79-08. Data is considered to be representative of the configurations shown. Actual performance may differ as a result of end-user environment and application. Please consult IES files for BUG ratings.

PROJECTED LUMEN MAINTENANCE

Ambient Temperature	OPERATING HOURS					
	0	25,000	50,000	TM-21-11* L96 60,000	100,000	L70 (Hours)
25°C / 77°F	1.00	0.97	0.97	0.96	0.95	>791,000
40°C / 104°F	0.99	0.96	0.96	0.96	0.94	>635,000

* Projected per IESNA TM-21-11* Data references the extrapolated performance projections for the LNC-12LU-5K base model in a 40°C ambient, based on 10,000 hours of LED testing per IESNA LM-80-08

LNC
COMPACT LED LITEPAK

ELECTRICAL DATA

# OF LEDS	Drive Current (mA)	Input Voltage (V)	Oper. Current (Amps)	System Power (W)
9	STD. (700mA)	120	0.11	13
		277	0.05	
12	STD. (700mA)	120	0.14	17
		277	0.07	
12	STD. (700mA)	120	0.17	22
		277	0.09	

LUMINAIRE AMBIENT TEMPERATURE FACTOR (LATF)

Ambient Temperature		Lumen Multiplier
0° C	32° F	1.02
10° C	50° F	1.01
20° C	68° F	1.00
25° C	77° F	1.00
30° C	86° F	1.00
40° C	104° F	0.99
50° C	122° F	0.98

Use these factors to determine relative lumen output for average ambient temperatures from 0-50°C (32-122°F).

PHOTOMETRY

LNC9LU – Type II

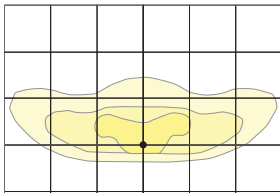

LNC9LU – Type III

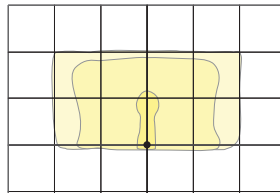

LNC9LU – Type IV

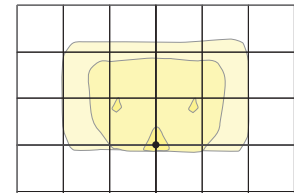

DIMENSIONS

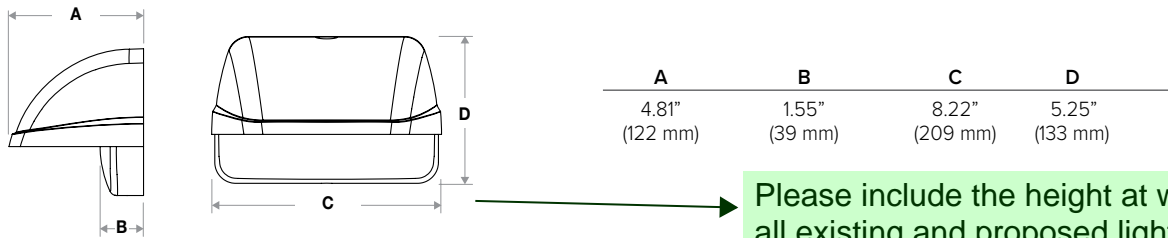

Please include the height at which all existing and proposed lighting will be at on the property

ADDITIONAL INFORMATION

SHIPPING INFORMATION

Catalog Number	G.W(kg)/ CTN	Carton Dimensions			Carton Qty. per Master Pack
		Length Inch (cm)	Width Inch (cm)	Height Inch (cm)	
LNC-5LU	9.6 (4.36)	14.5 (37)	9.6 (24.5)	6.8 (17.5)	2
LNC-7LU	9.6 (4.36)	14.5 (37)	9.6 (24.5)	6.8 (17.5)	2
LNC-9LU	9.6 (4.36)	14.5 (37)	9.6 (24.5)	6.8 (17.5)	2

USE OF TRADEMARKS AND TRADE NAMES

All product and company names, logos and product identifies are trademarks™ or registered trademarks® of Current or their respective owners. Use of them does not necessarily imply any affiliation with or endorsement by such respective owners.