

PREPARED BY:

DREXEL, BARRELL & CO.
Engineers • Surveyors
3 SOUTH 7TH STREET
COLORADO SPGS, COLORADO 80905
CONTACT: TIM D. McCONNELL, P.E.
(719)260-0887
BOULDER • COLORADO SPRINGS

CLIENT:

HUMMEL INVESTMENTS, LLC
8117 PRESTON ROAD, SUITE 120
DALLAS, TEXAS 75225
(214) 416-9820

CONSTRUCTION DRAWINGS FOR

**FALCON
MARKETPLACE**
FALCON, COLORADO

ISSUE	DATE
90% SUBMITTAL	5-6-19
DESIGNED BY:	TDM
DRAWN BY:	KGW
CHECKED BY:	TDM
FILE NAME:	

PREPARED UNDER MY DIRECT
SUPERVISION FOR AND ON BEHALF
OF DREXEL, BARRELL & CO.

DRAWING SCALE:
HORIZONTAL: VARIES
VERTICAL: 1"=5'

**SOUTH
ROUNDAABOUT
PROFILES**

PROJECT NO. 20988-00CSCV
DRAWING NO.

C4.10

SHEET: 15 OF 39

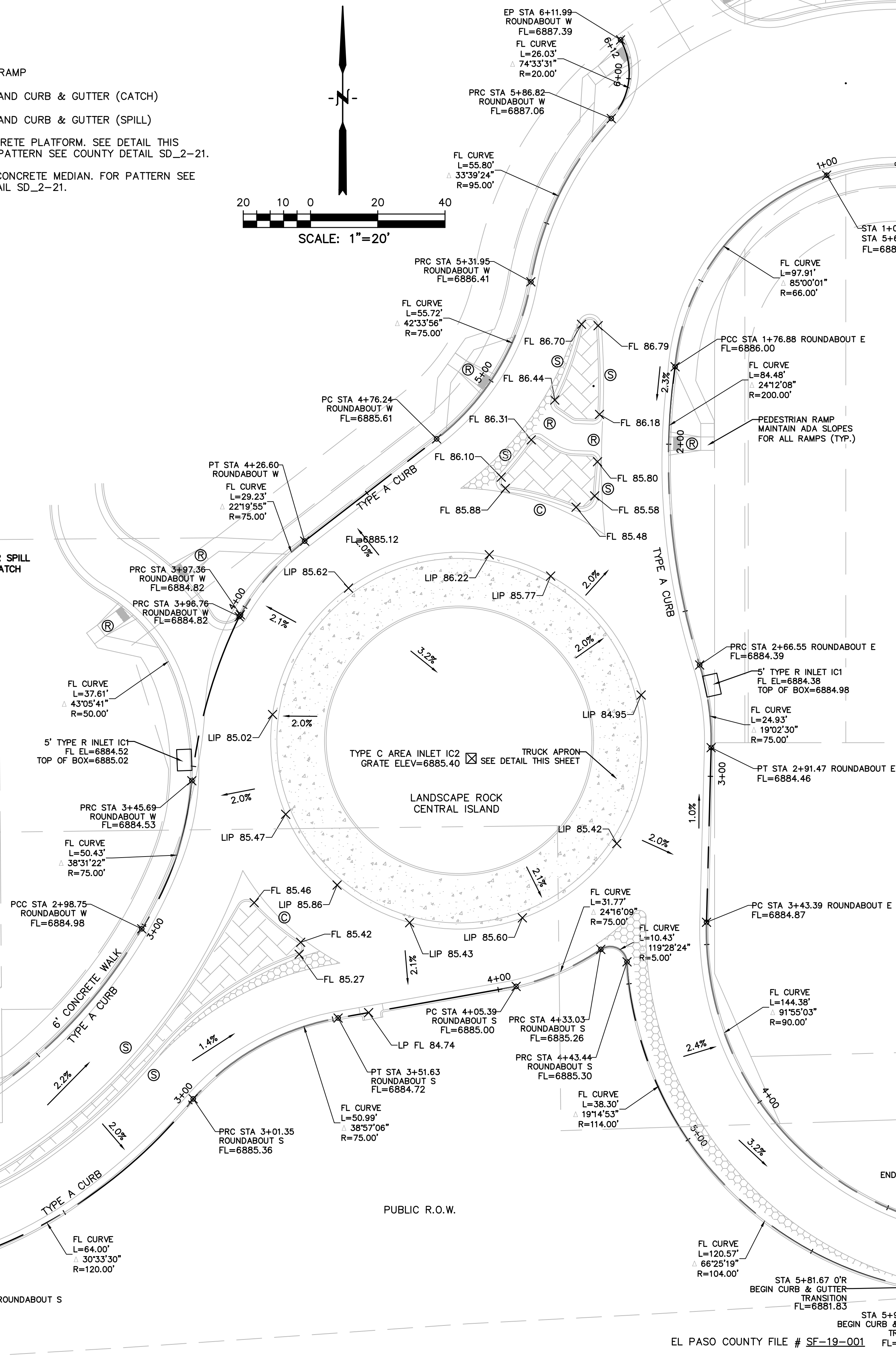
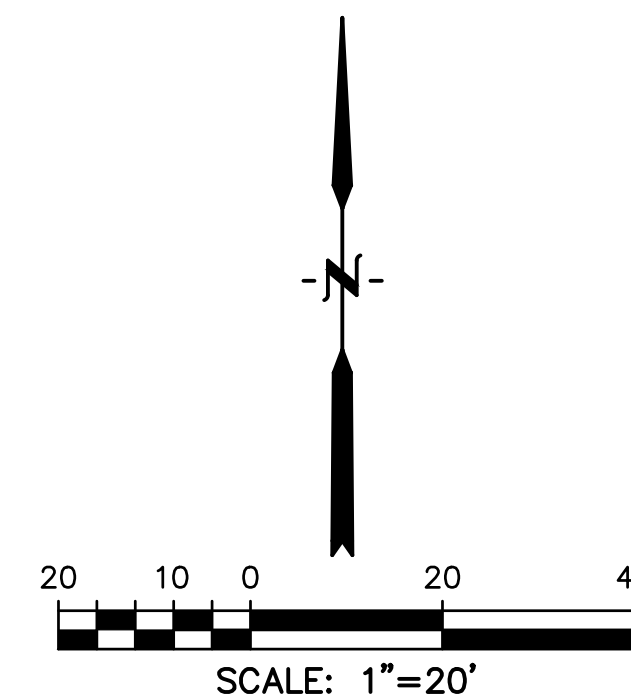
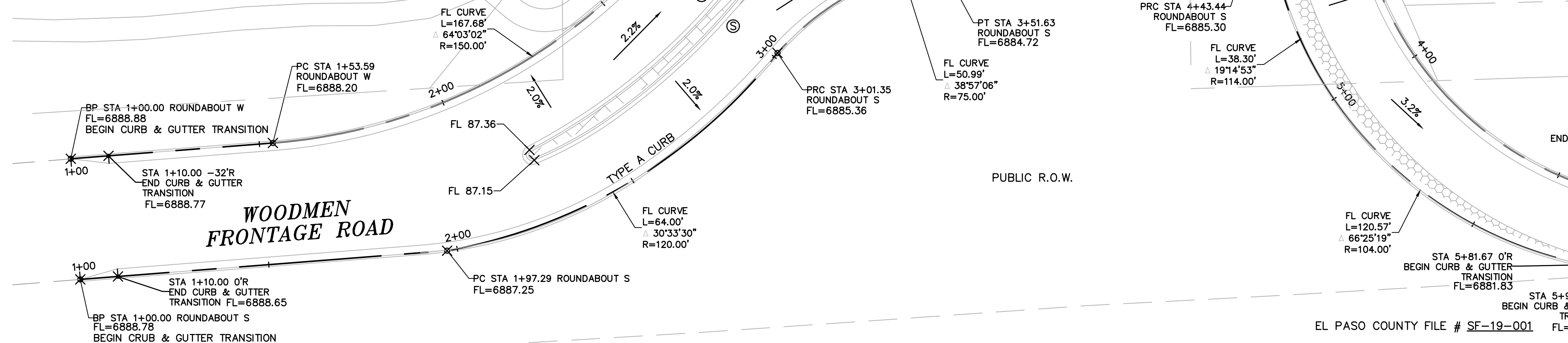
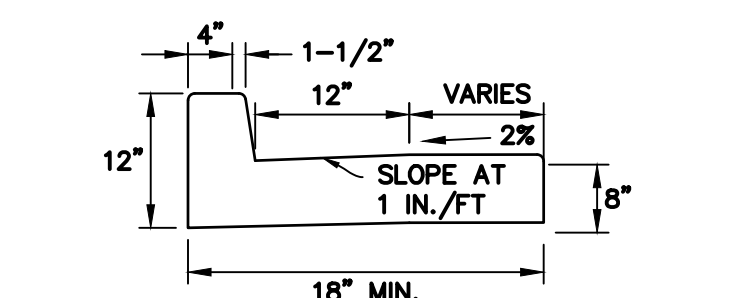
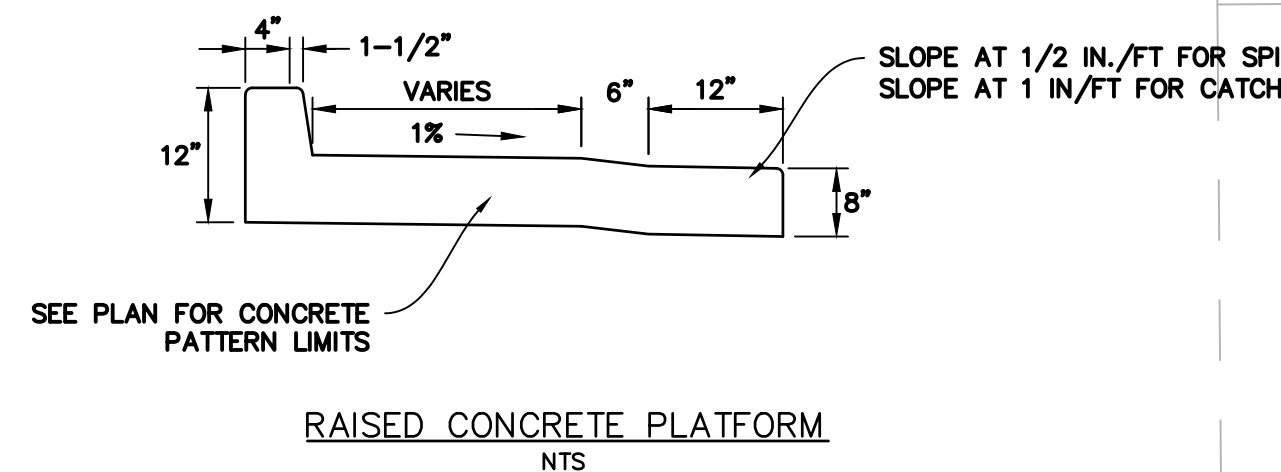
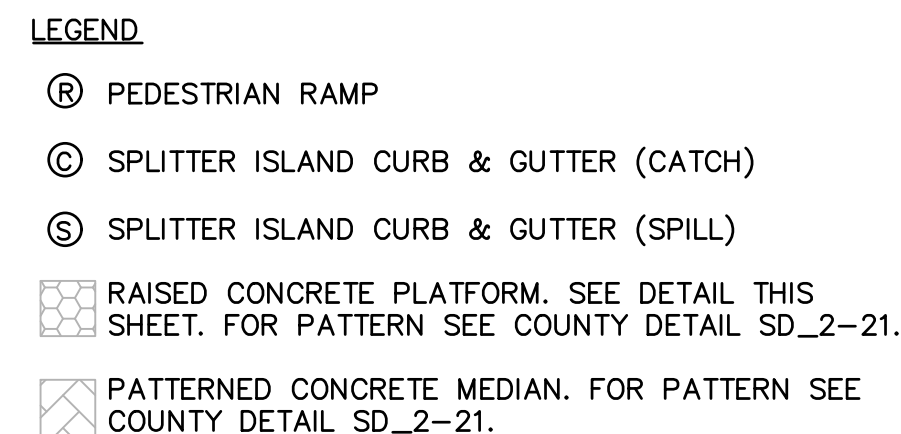

CLIENT:

(214) 416-9820

CONSTRUCTION DRAWINGS FOR
**FALCON
MARKETPLACE**
FALCON, COLORADO

ISSUE	DATE
90% SUBMITTAL	5-6-19
DESIGNED BY:	TDM
DRAWN BY:	KGV
CHECKED BY:	TDM
FILE NAME:	

DRAWING SCALE:
HORIZONTAL: VARIES
VERTICAL: 1"=5'

SOUTH ROUNDBOUT PROFILES

PROJECT NO. 20988-00CSCV
DRAWING NO.

C4.11

EL PASO COUNTY FILE # SF-19-001 TRA
FL=6 SHEET: 16 OF 39

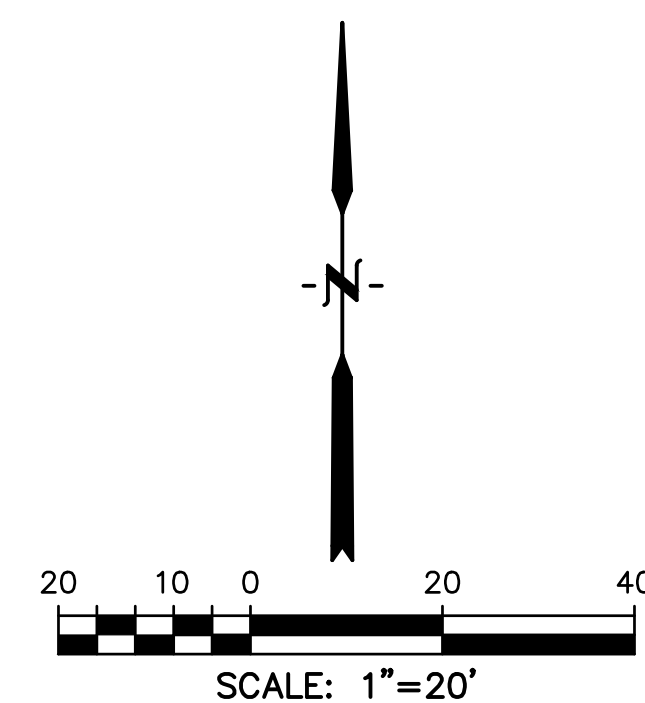



LEGEND

(R) PEDESTRIAN RAMP

(C) SPLITTER ISLAND CURB & GUTTER (CATCH)

(S) SPLITTER ISLAND CURB & GUTTER (SPILL)

 RAISED CONCRETE PLATFORM. SEE DETAIL THIS SHEET. FOR PATTERN SEE COUNTY DETAIL SD_2-21.

 PATTERNED CONCRETE MEDIAN. FOR PATTERN SEE COUNTY DETAIL SD_2-21.

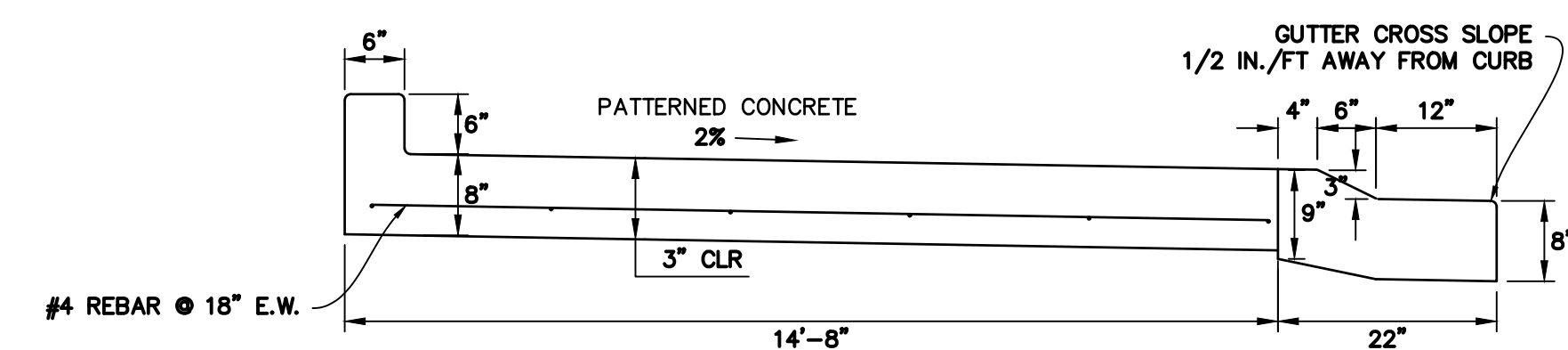

TYPICAL TRUCK APRON DETAIL
NTS

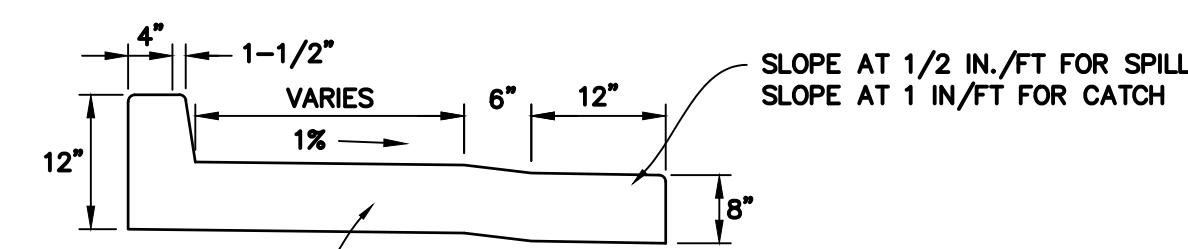

SEE PLAN FOR CONCRETE
PATTERN LIMITS

RAISED CONCRETE PLATFORM
NTS

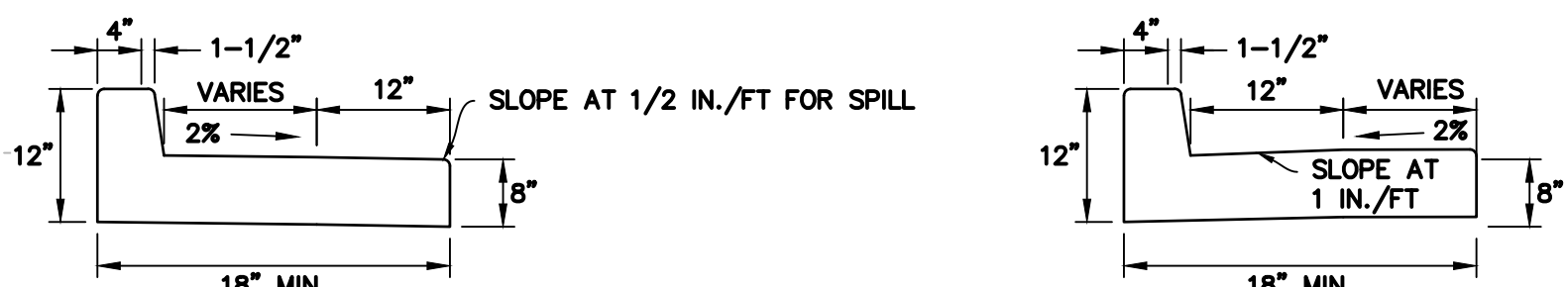

SPLITTER ISLAND CURB/GUTTER (SPILL)
NTS

SPLITTER ISLAND CURB/GUTTER (CATCH)
NTS

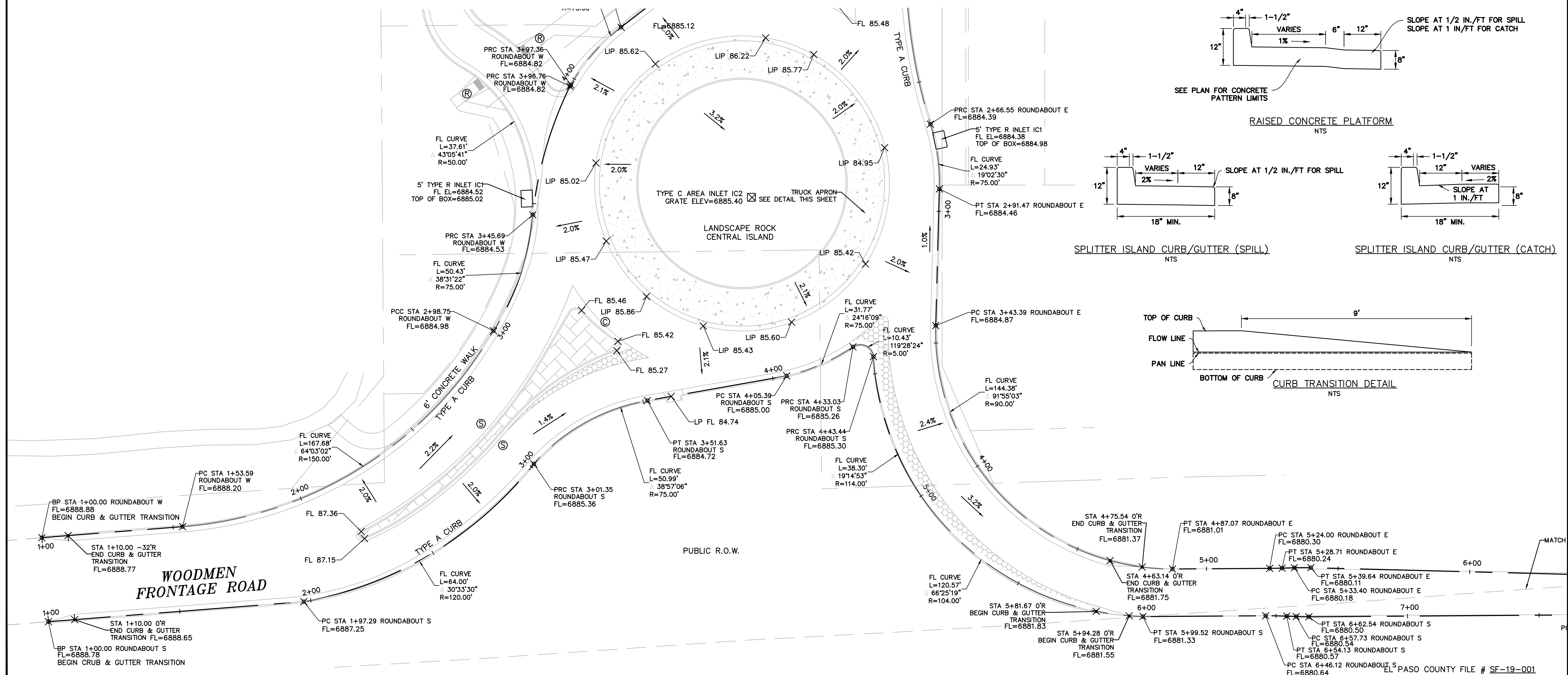
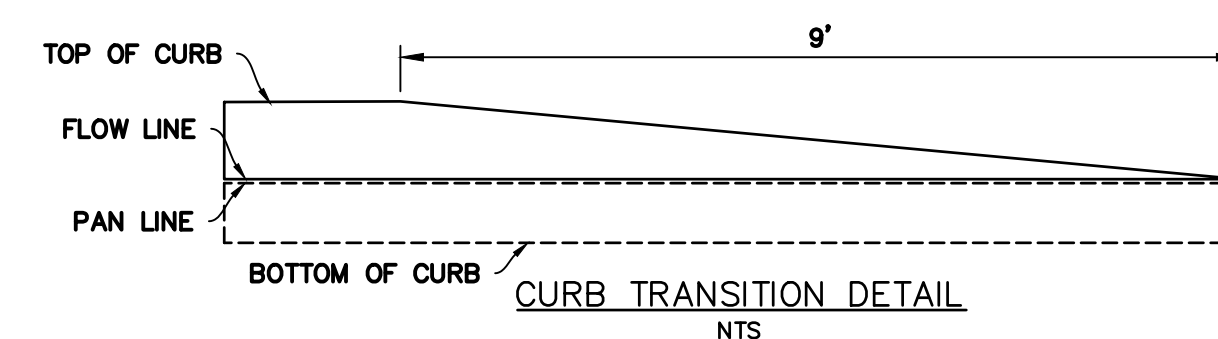

PREPARED BY:

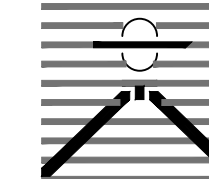

DREXEL, BARRELL & CO.
Engineers • Surveyors
3 SOUTH 7TH STREET
COLORADO SPGS, COLORADO 80905
CONTACT: TIM D. McCONNELL, P.E.
(719)260-0887
BOULDER • COLORADO SPRINGS

CLIENT:

HUMMEL INVESTMENTS, LLC

8117 PRESTON ROAD, SUITE 120
DALLAS, TEXAS 75225

(214) 416-9820

CONSTRUCTION DRAWINGS FOR
**FALCON
MARKETPLACE**
FALCON, COLORADO

ISSUE	DATE
90% SUBMITTAL	5-6-19
DESIGNED BY:	TDM
DRAWN BY:	KGV
CHECKED BY:	TDM
FILE NAME:	

PREPARED UNDER MY DIRECT
SUPERVISION FOR AND ON BEHALF
OF DREXEL, BARNETT & CO.

DRAWING SCALE:
HORIZONTAL: VARIE
VERTICAL: 1"=5'

SOUTH ROUNDBOUT PROFILES

PROJECT NO. 20988-00CSCV
DRAWING NO.

C4.12

SHEET: 17 OF 39

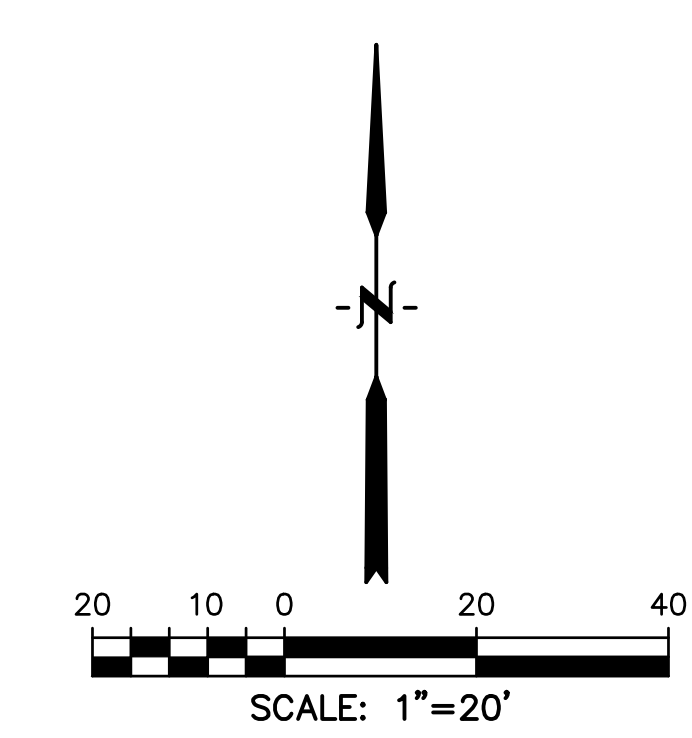
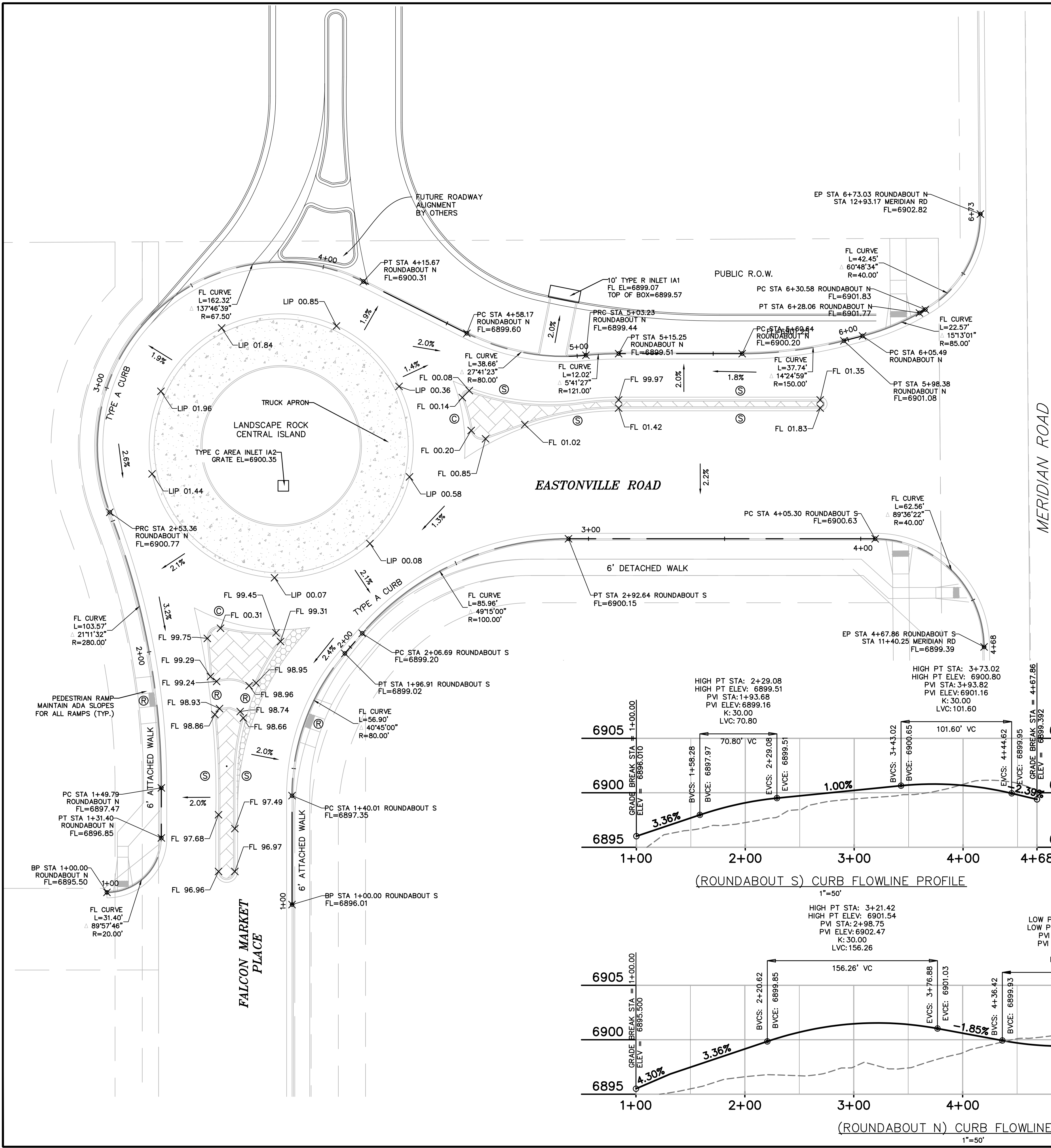

- LEGEND
- Ⓡ PEDESTRIAN RAMP
 - Ⓢ SPLITTER ISLAND CURB & GUTTER (CATCH)
 - Ⓣ SPLITTER ISLAND CURB & GUTTER (SPILL)
 - Ⓤ RAISED CONCRETE PLATFORM. SEE DETAIL THIS SHEET. FOR PATTERN SEE COUNTY DETAIL SD_2-21.
 - Ⓦ PATTERNED CONCRETE MEDIAN. FOR PATTERN SEE COUNTY DETAIL SD_2-21.

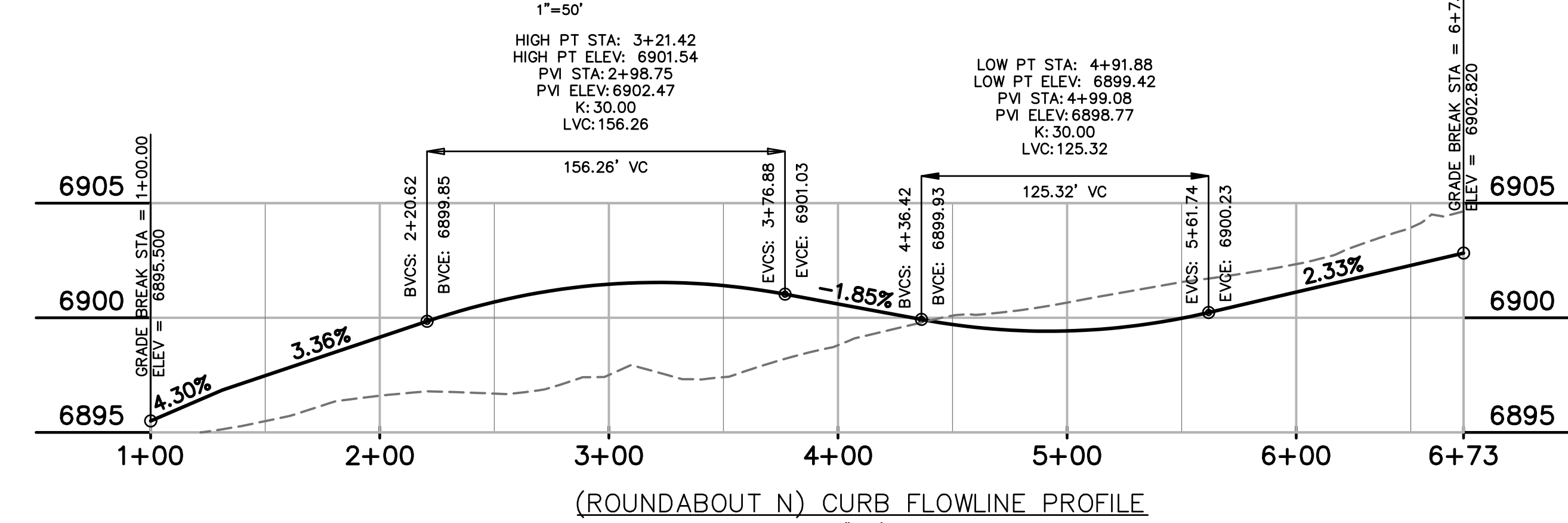
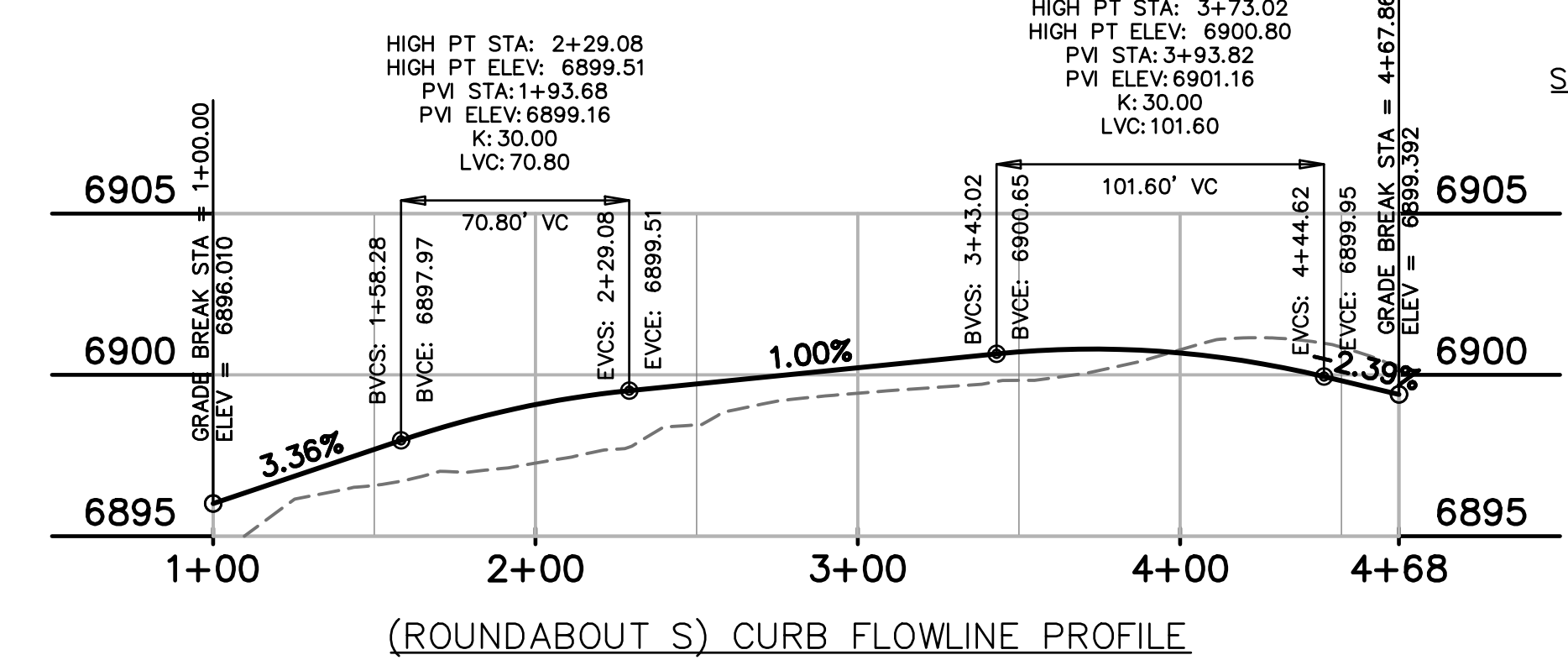
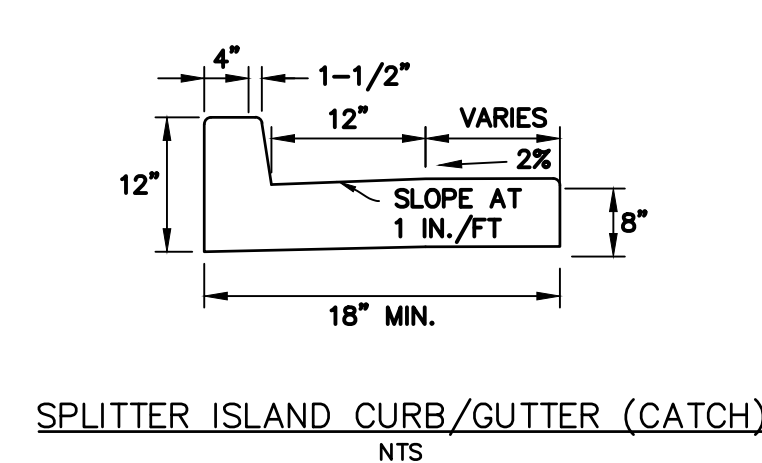
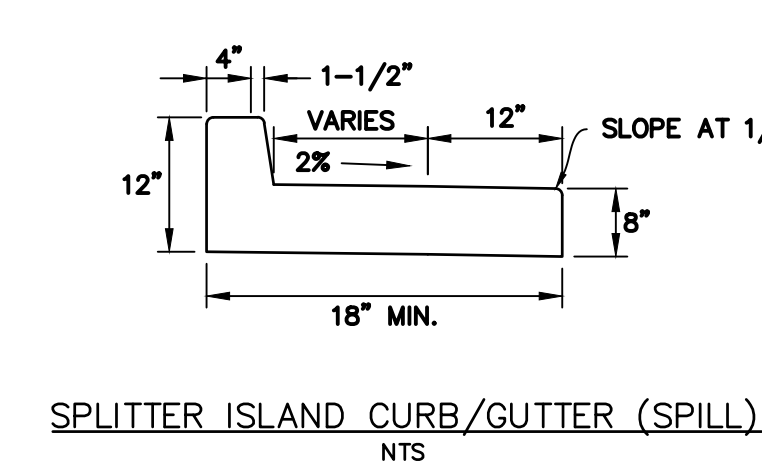
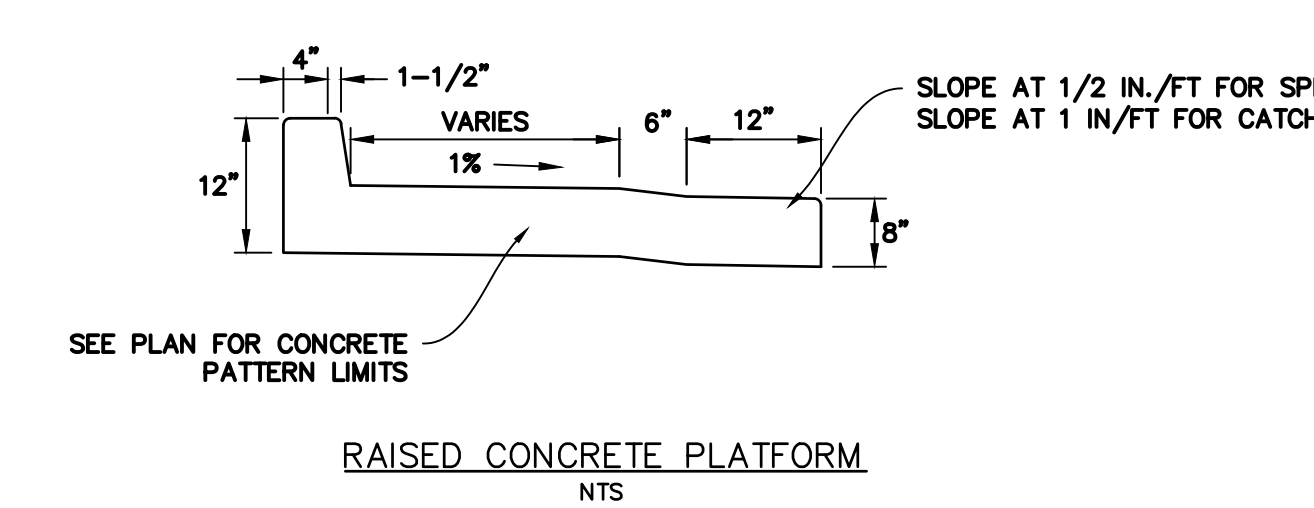
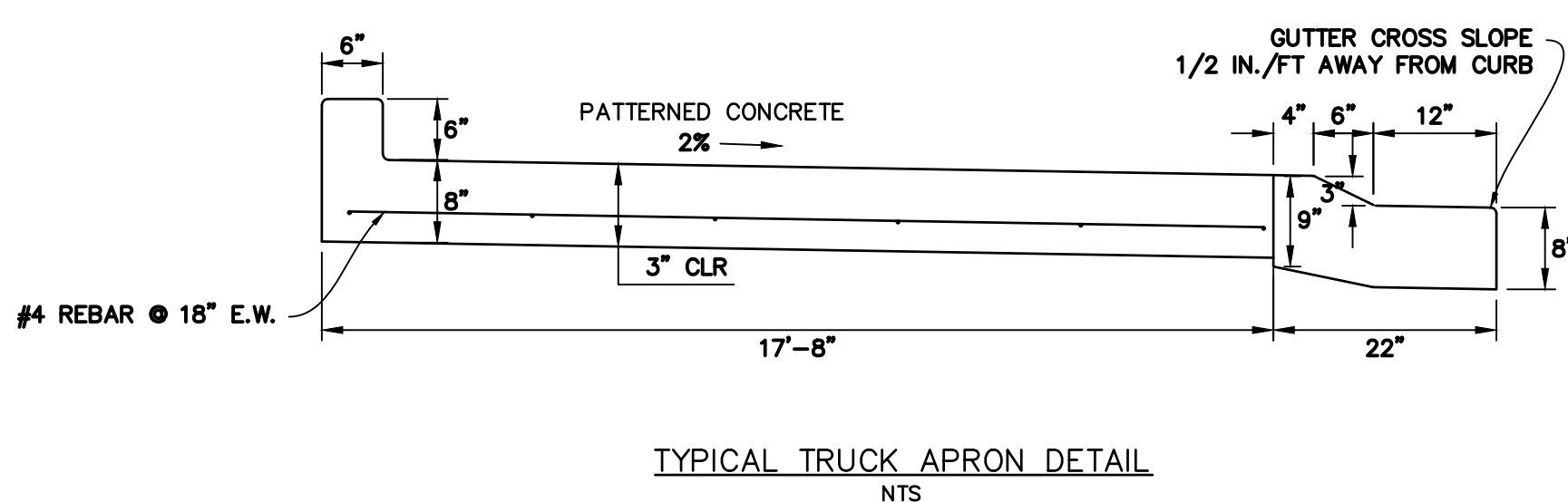

PREPARED BY:

DREXEL, BARRELL & CO.
Engineers • Surveyors
3 SOUTH 7TH STREET
COLORADO SPGS, COLORADO 80905
CONTACT: TIM D. McCONNELL, P.E.
(719)260-0887
BOULDER • COLORADO SPRINGS

CLIENT:

HUMMEL INVESTMENTS, LLC
8117 PRESTON ROAD, SUITE 120
DALLAS, TEXAS 75225
(214) 416-9820

CONSTRUCTION DRAWINGS FOR

FALCON
MARKETPLACE
FALCON, COLORADO

ISSUE	DATE
90% SUBMITTAL	5-6-19
DESIGNED BY:	TDM
DRAWN BY:	KGW
CHECKED BY:	TDM
FILE NAME:	

PREPARED UNDER MY DIRECT SUPERVISION FOR AND ON BEHALF OF DREXEL, BARRELL & CO.

DRAWING SCALE:
HORIZONTAL: VARIES
VERTICAL: 1"=5'

NORTH
ROUNDABOUT
PROFILES

PROJECT NO. 20988-00CSCV
DRAWING NO.

C4.13

SHEET: 18 OF 39

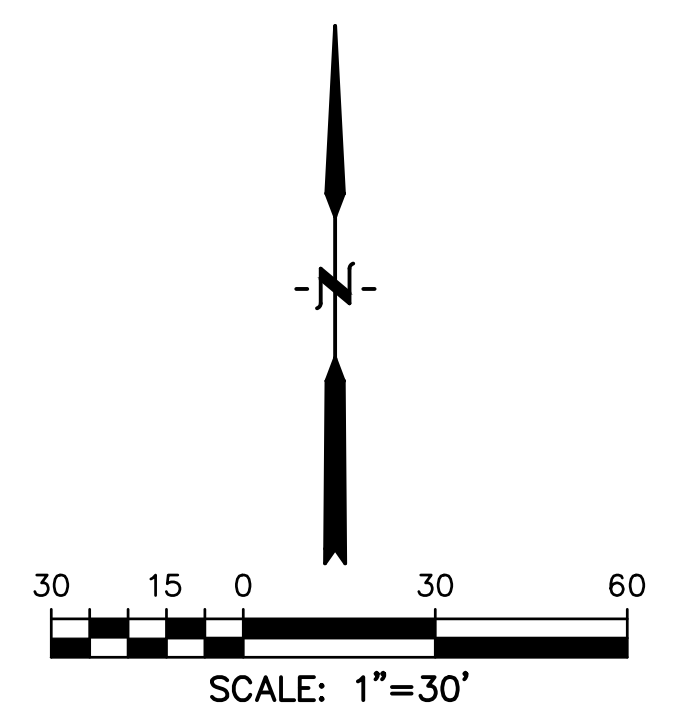
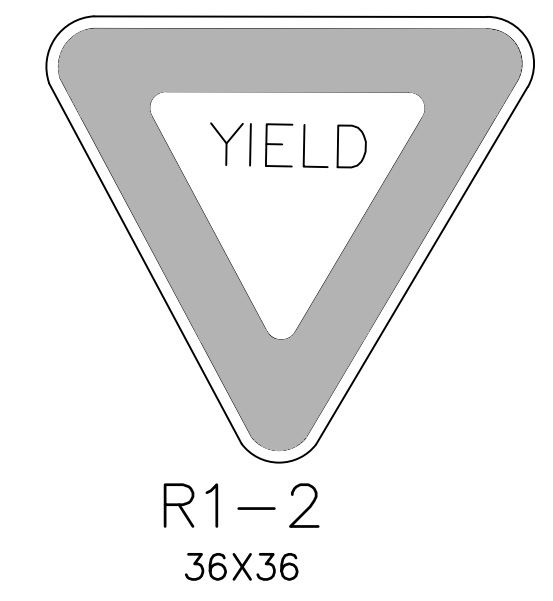
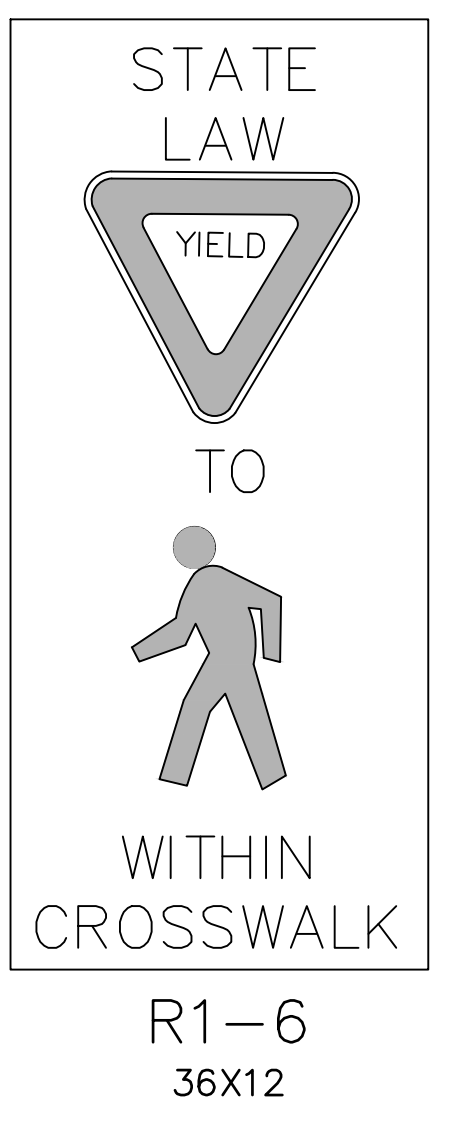
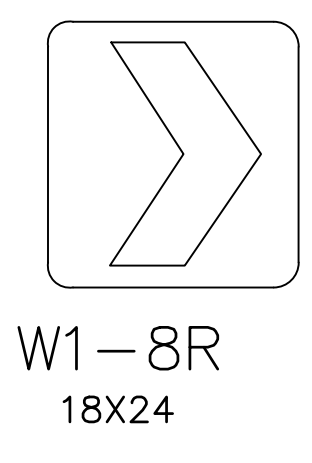
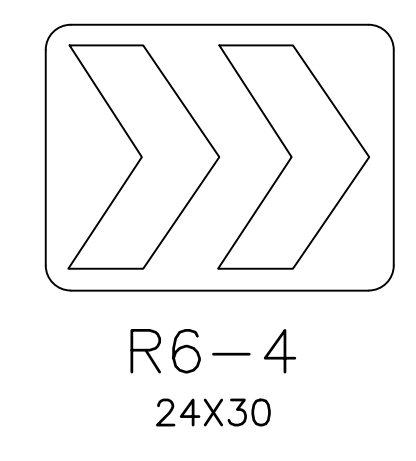
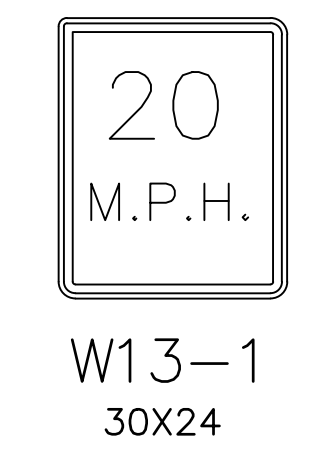
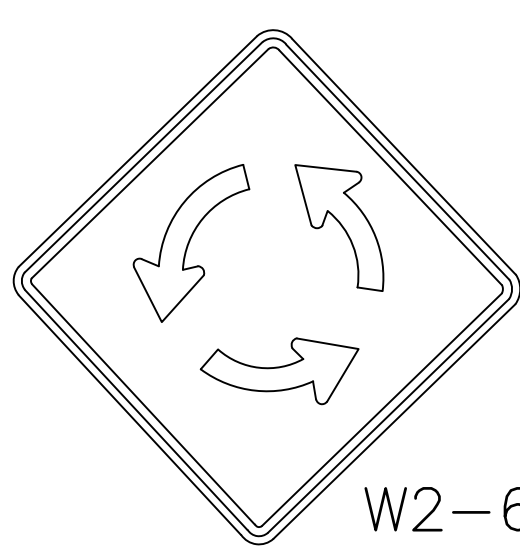
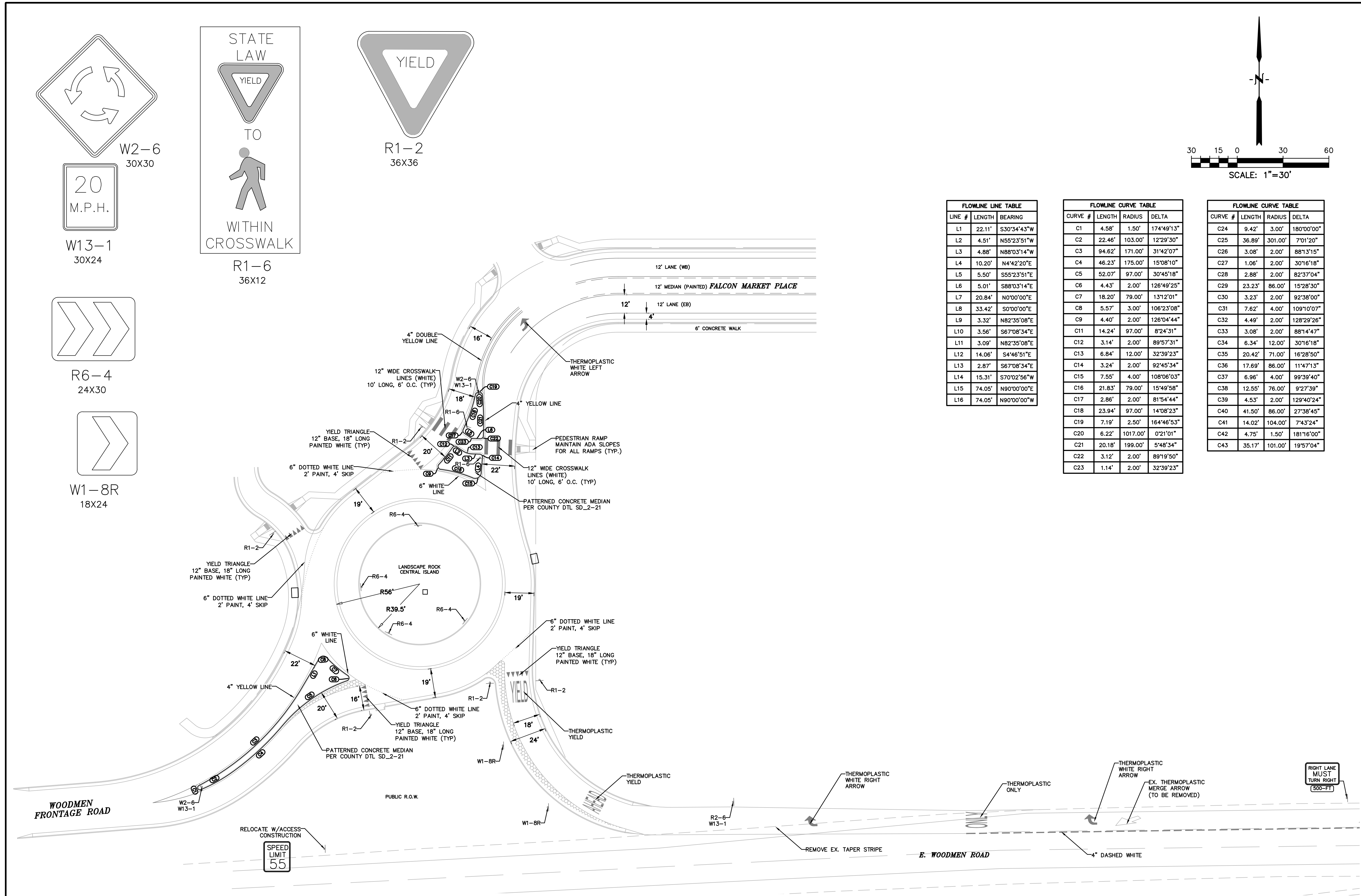

FLOWLINE LINE TABLE		
LINE #	LENGTH	BEARING
L1	22.11'	S30°34'43"W
L2	4.51'	N55°23'51"W
L3	4.88'	N88°03'14"W
L4	10.20'	N4°42'20"E
L5	5.50'	S55°23'51"E
L6	5.01'	S88°03'14"E
L7	20.84'	N0°00'00"E
L8	33.42'	S0°00'00"E
L9	3.32'	N82°35'08"E
L10	3.56'	S67°08'34"E
L11	3.09'	N82°35'08"E
L12	14.06'	S4°46'51"E
L13	2.87'	S67°08'34"E
L14	15.31'	S70°02'56"W
L15	74.05'	N90°00'00"E
L16	74.05'	N90°00'00"W

FLOWLINE CURVE TABLE			
CURVE #	LENGTH	RADIUS	DELTA
C1	4.58'	1.50'	174°49'13"
C2	22.46'	103.00'	12°29'30"
C3	94.62'	171.00'	31°42'07"
C4	46.23'	175.00'	15°08'10"
C5	52.07'	97.00'	30°45'18"
C6	4.43'	2.00'	126°49'25"
C7	18.20'	79.00'	13°12'01"
C8	5.57'	3.00'	106°23'08"
C9	4.40'	2.00'	126°04'44"
C11	14.24'	97.00'	8°24'31"
C12	3.14'	2.00'	89°57'31"
C13	6.84'	12.00'	32°39'23"
C14	3.24'	2.00'	92°45'34"
C15	7.55'	4.00'	108°06'03"
C16	21.83'	79.00'	15°49'58"
C17	2.86'	2.00'	81°54'44"
C18	23.94'	97.00'	14°08'23"
C19	7.19'	2.50'	164°46'53"
C20	6.22'	1017.00'	0°21'01"
C21	20.18'	199.00'	5°48'34"
C22	3.12'	2.00'	89°19'50"
C23	1.14'	2.00'	32°39'23"

FLOWLINE CURVE TABLE			
CURVE #	LENGTH	RADIUS	DELTA
C24	9.42'	3.00'	180°00'00"
C25	36.89'	301.00'	7°01'20"
C26	3.08'	2.00'	88°13'15"
C27	1.06'	2.00'	30°16'18"
C28	2.88'	2.00'	82°37'04"
C29	23.23'	86.00'	15°28'30"
C30	3.23'	2.00'	92°38'00"
C31	7.62'	4.00'	109°10'07"
C32	4.49'	2.00'	128°29'26"
C33	3.08'	2.00'	88°14'47"
C34	6.34'	12.00'	30°16'18"
C35	20.42'	71.00'	16°28'50"
C36	17.69'	86.00'	11°47'13"
C37	6.96'	4.00'	99°39'40"
C38	12.55'	76.00'	9°27'39"
C39	4.53'	2.00'	129°40'24"
C40	41.50'	86.00'	27°38'45"
C41	14.02'	104.00'	7°43'24"
C42	4.75'	1.50'	181°16'00"
C43	35.17'	101.00'	19°57'04"

PREPARED BY:

DREXEL, BARRELL & CO.
Engineers • Surveyors
3 SOUTH 7TH STREET
COLORADO SPGS, COLORADO 80905
CONTACT: TIM D. McCONNELL, P.E.
(719)260-0887
BOULDER • COLORADO SPRINGS

CLIENT:

HUMMEL INVESTMENTS, LLC
8117 PRESTON ROAD, SUITE 120
DALLAS, TEXAS 75225
(214) 416-9820

CONSTRUCTION DRAWINGS FOR

FALCON
MARKETPLACE
FALCON, COLORADO

ISSUE	DATE
90% SUBMITTAL	5-6-19
DESIGNED BY:	TDM
DRAWN BY:	KGV
CHECKED BY:	TDM
FILE NAME:	

PREPARED UNDER MY DIRECT SUPERVISION FOR AND ON BEHALF OF DREXEL, BARRELL & CO.

DRAWING SCALE:
HORIZONTAL: 1"=30'
VERTICAL: N/A

SOUTH
ROUNABOUT
SIGNAGE

PROJECT NO. 20988-00CSCV
DRAWING NO.

C4.14

SHEET: 19 OF 39

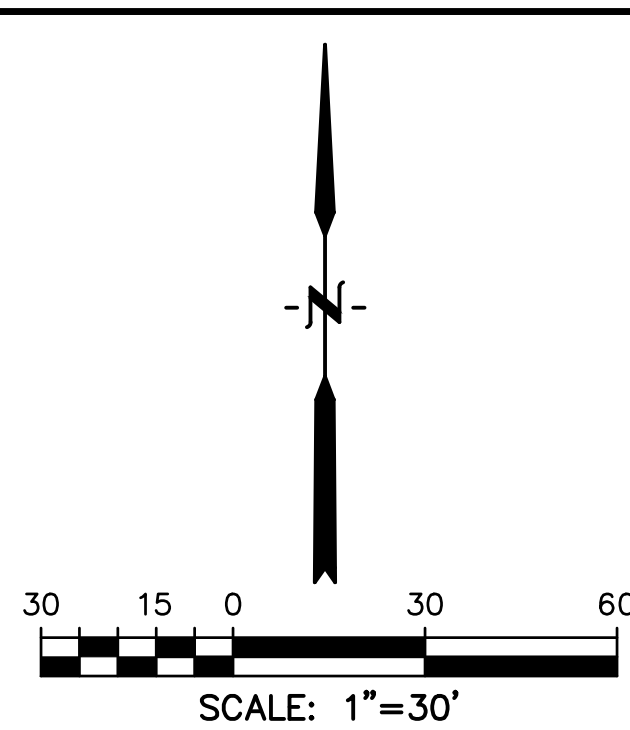
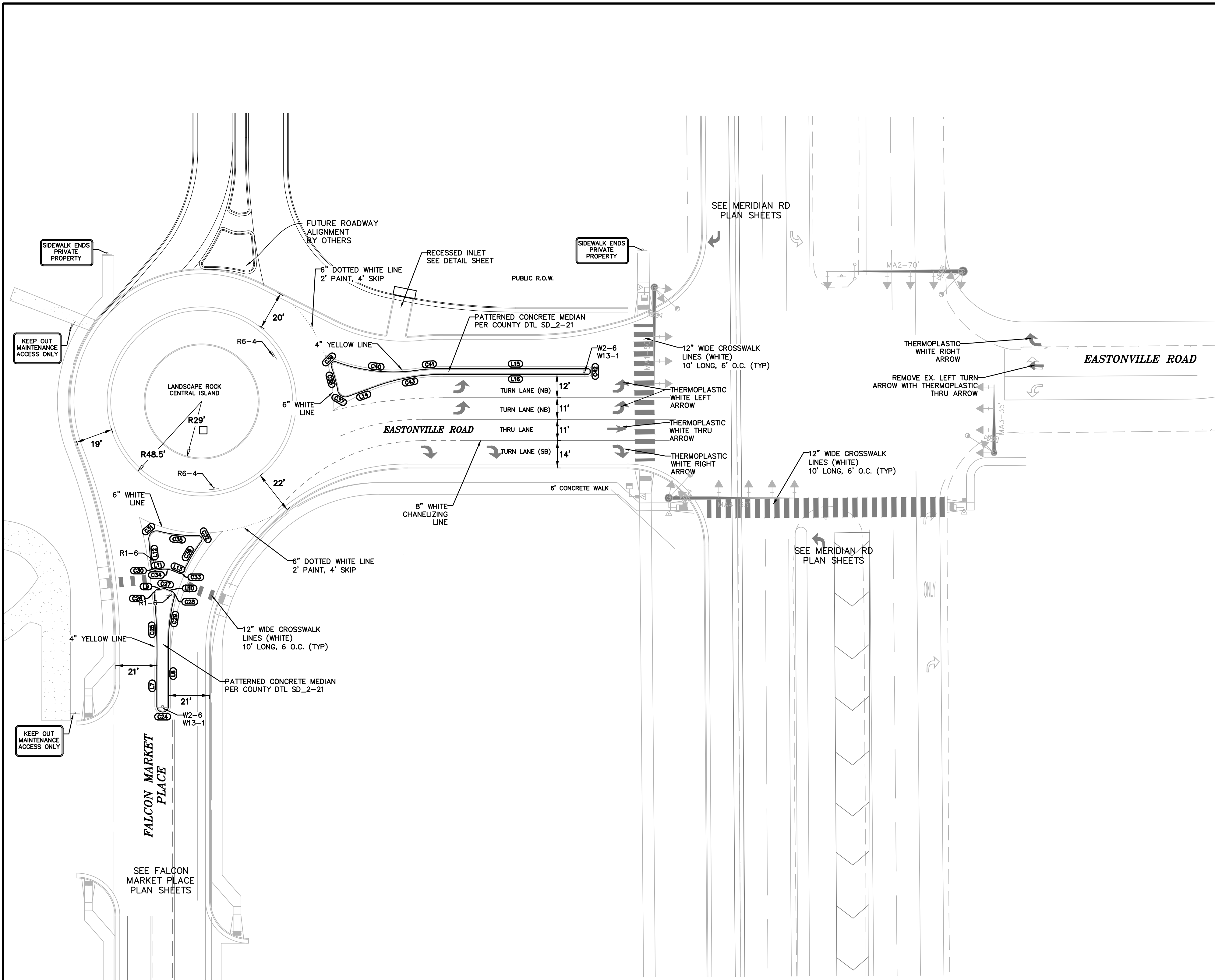

FLOWLINE LINE TABLE		
LINE #	LENGTH	BEARING
L1	22.11'	S30°34'43"W
L2	4.51'	N55°23'51"W
L3	4.88'	N88°03'14"W
L4	10.20'	N4°42'20"E
L5	5.50'	S55°23'51"E
L6	5.01'	S88°03'14"E
L7	20.84'	N0°00'00"E
L8	33.42'	S0°00'00"E
L9	3.32'	N82°35'08"E
L10	3.56'	S67°08'34"E
L11	3.09'	N82°35'08"E
L12	14.06'	S4°46'51"E
L13	2.87'	S67°08'34"E
L14	15.31'	S70°02'56"W
L15	74.05'	N90°00'00"E
L16	74.05'	N90°00'00"W

FLOWLINE CURVE TABLE			
CURVE #	LENGTH	RADIUS	DELTA
C1	4.58'	1.50'	174°49'13"
C2	22.46'	103.00'	12°29'30"
C3	94.62'	171.00'	31°42'07"
C4	46.23'	175.00'	15°08'10"
C5	52.07'	97.00'	30°45'18"
C6	4.43'	2.00'	126°49'25"
C7	18.20'	79.00'	13°12'01"
C8	5.57'	3.00'	106°23'08"
C9	4.40'	2.00'	126°04'44"
C11	14.24'	97.00'	8°24'31"
C12	3.14'	2.00'	89°57'31"
C13	6.84'	12.00'	32°39'23"
C14	3.24'	2.00'	92°45'34"
C15	7.55'	4.00'	108°06'03"
C16	21.83'	79.00'	15°49'58"
C17	2.86'	2.00'	81°54'44"
C18	23.94'	97.00'	14°08'23"
C19	7.19'	2.50'	164°46'53"
C20	6.22'	1017.00'	0°21'01"
C21	20.18'	199.00'	5°48'34"
C22	3.12'	2.00'	89°19'50"
C23	1.14'	2.00'	32°39'23"

FLOWLINE CURVE TABLE			
CURVE #	LENGTH	RADIUS	DELTA
C24	9.42'	3.00'	180°00'00"
C25	36.89'	301.00'	7°01'20"
C26	3.08'	2.00'	88°13'15"
C27	1.06'	2.00'	30°16'18"
C28	2.88'	2.00'	82°37'04"
C29	23.23'	86.00'	15°28'30"
C30	3.23'	2.00'	92°38'00"
C31	7.62'	4.00'	109°10'07"
C32	4.49'	2.00'	128°29'26"
C33	3.08'	2.00'	88°14'47"
C34	6.34'	12.00'	30°16'18"
C35	20.42'	71.00'	16°28'50"
C36	17.69'	86.00'	11°47'13"
C37	6.96'	4.00'	99°39'40"
C38	12.55'	76.00'	9°27'39"
C39	4.53'	2.00'	129°40'24"
C40	41.50'	86.00'	27°38'45"
C41	14.02'	104.00'	7°43'24"
C42	4.75'	1.50'	181°16'00"
C43	35.17'	101.00'	19°57'04"

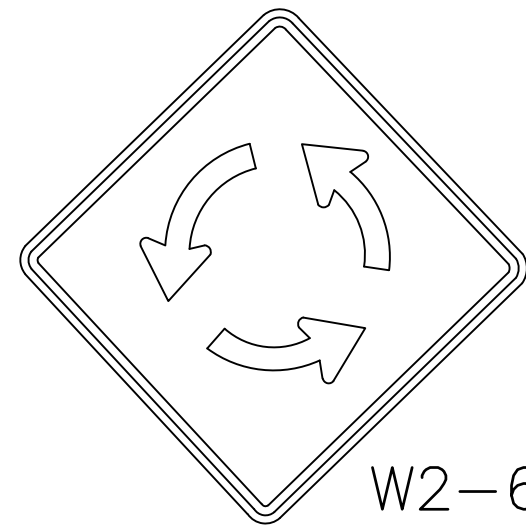

W2-6
30X30

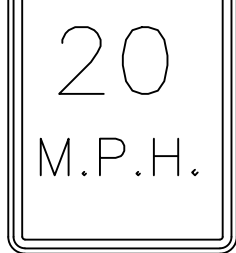

W13-1
30X24

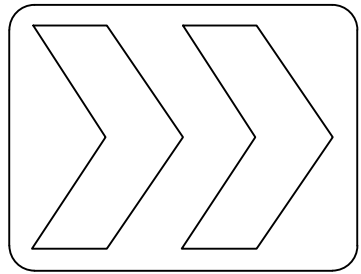

R6-4
24X30

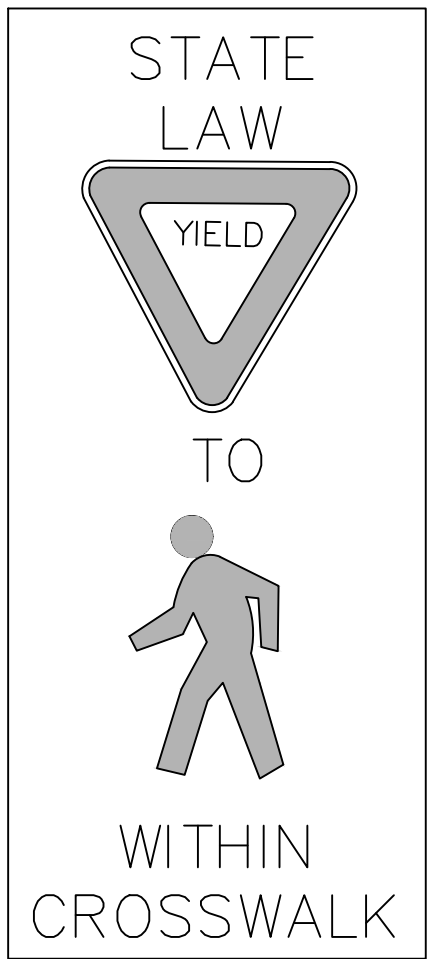

R1-6
36X12

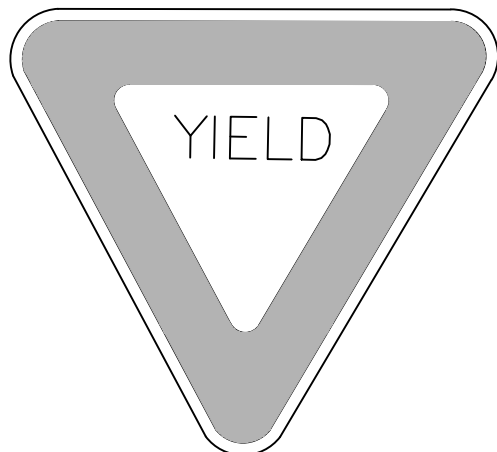

R1-2
36X36

PREPARED BY:

DREXEL, BARRELL & CO.
Engineers • Surveyors
3 SOUTH 7TH STREET
COLORADO SPGS, COLORADO 80905
CONTACT: TIM D. McCONNELL, P.E.
(719)260-0887
BOULDER • COLORADO SPRINGS

CLIENT:

HUMMEL INVESTMENTS, LLC

8117 PRESTON ROAD, SUITE 120
DALLAS, TEXAS 75225
(214) 416-9820

CONSTRUCTION DRAWINGS FOR
**FALCON
MARKETPLACE**
FALCON, COLORADO

ISSUE	DATE
90% SUBMITTAL	5-6-19
DESIGNED BY:	TDM
DRAWN BY:	KGV
CHECKED BY:	TDM
FILE NAME:	

PREPARED UNDER MY DIRECT
SUPERVISION FOR AND ON BEHALF
OF DREXEL, BARRELL & CO.

DRAWING SCALE:
HORIZONTAL: 1"=30'
VERTICAL: N/A

**NORTH
ROUNDABOUT
SIGNAGE**

PROJECT NO. 20988-00CSCV
DRAWING NO.

C4.15

SHEET: 20 OF 39

EL PASO COUNTY FILE # SF-19-001