

**NOTES:**  
 1. PROPOSED GRADING (BY OTHERS) IS SHOWN FOR REFERENCE ONLY. SEE FOREST LAKES FILING NO. 5, 6 & 7 PRE-DEVELOPMENT GRADING AND EROSION CONTROL PLAN (BY CLASSIC CONSULTING). THIS SHEET INCLUDED FOR EROSION CONTROL ITEMS SPECIFIC TO TANK SITE WHICH ARE EXCLUDED FROM THE AFOREMENTIONED PLANS.  
 2. FOR FUTURE DETAILED DEVELOPMENT DATA, SEE MAJOR AMENDMENT TO PUD DEVELOPMENT PLAN AND PRELIM. PLAN FOR FILINGS 5, 6 & 7 (BY N.E.S. INC.).

J:\JDS-Hydro\Project Files\294 FLRD #2 LLC\294.01 Phase II Regional Water & Sewer Facilities\Drawings\CAD\Working\Tank\29401\_Tank\_Site.dwg  
 2019/11/21 1:07 PM By: ACH

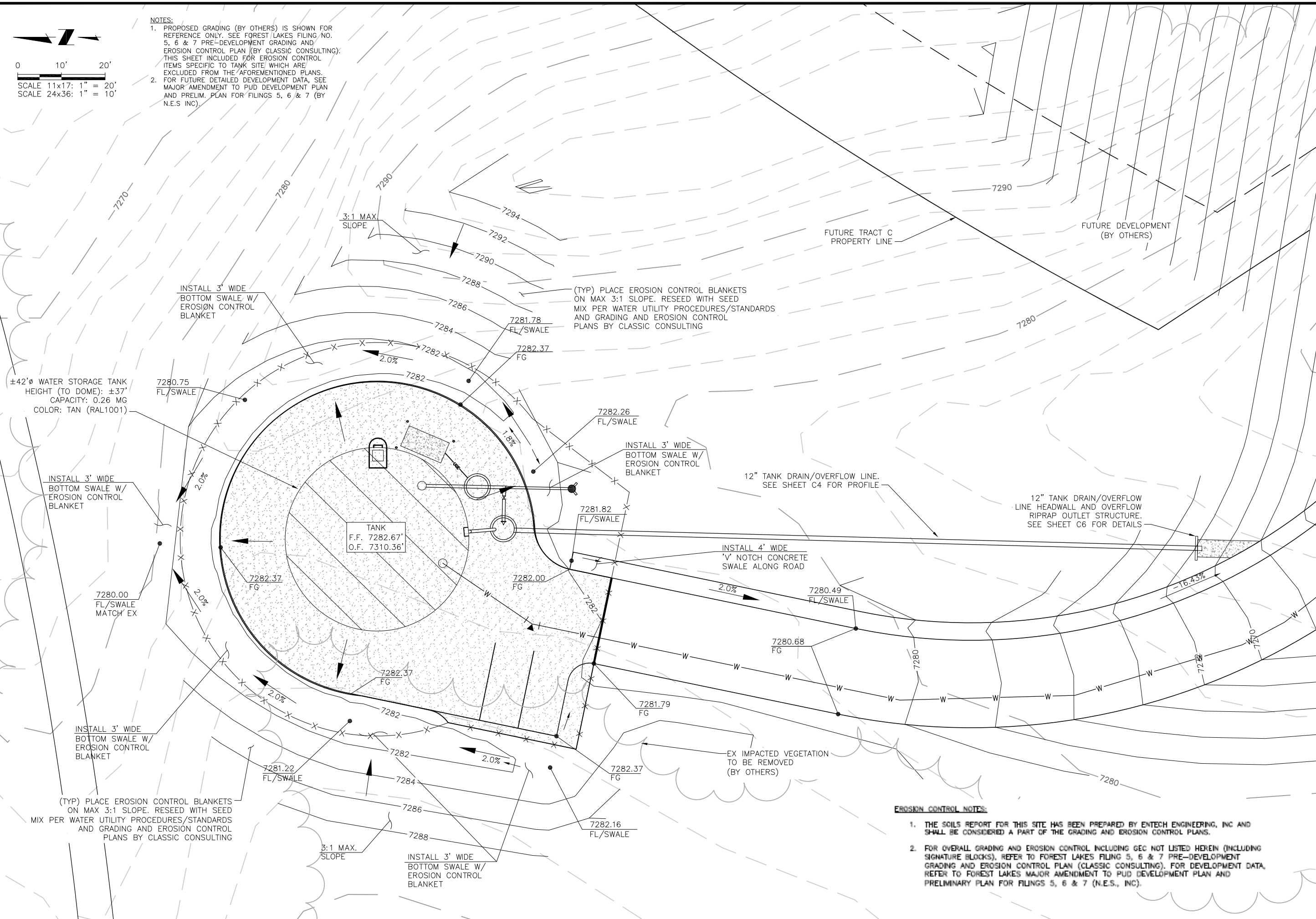

**JDS-HYDRO CONSULTANTS, INC.**  
 5540 TECH CENTER DRIVE, SUITE 100  
 COLORADO SPRINGS, COLORADO 80919  
 (719) 227-0072

**FLRD #2, LLC.**  
 PHASE II REGIONAL WATER IMPROVEMENTS  
 0.26 MG POTABLE WATER TANK  
 GRADING AND EROSION CONTROL PLAN

| NO. | DESCRIPTION | BY | APP. | DATE |
|-----|-------------|----|------|------|
| 1   |             |    |      |      |
| 2   |             |    |      |      |
| 3   |             |    |      |      |
| 4   |             |    |      |      |
| 5   |             |    |      |      |
| 6   |             |    |      |      |
| 7   |             |    |      |      |

**FOR PLAN REVIEW**

Project No.: 294.01  
 Date: 11/18/19  
 Design: GJD  
 Drawn: SNW/GGM  
 Check: JPM

**C3**  
 SHEET 6 OF 11

**EROSION CONTROL NOTES:**

- THE SOILS REPORT FOR THIS SITE HAS BEEN PREPARED BY ENTECH ENGINEERING, INC AND SHALL BE CONSIDERED A PART OF THE GRADING AND EROSION CONTROL PLANS.
- FOR OVERALL GRADING AND EROSION CONTROL INCLUDING GEC NOT LISTED HEREIN (INCLUDING SIGNATURE BLOCKS), REFER TO FOREST LAKES FILING 5, 6 & 7 PRE-DEVELOPMENT GRADING AND EROSION CONTROL PLAN (CLASSIC CONSULTING). FOR DEVELOPMENT DATA, REFER TO FOREST LAKES MAJOR AMENDMENT TO PUD DEVELOPMENT PLAN AND PRELIMINARY PLAN FOR FILINGS 5, 6 & 7 (N.E.S., INC).