

Eldorado Springs at Cheyenne Mountain Filing No. 1

ADMINISTRATIVE SITE DEVELOPMENT PLAN

SIGN PLAN

APRIL, 2019

recent changes to the LDC allows for a Mater Sign Plan that can be requested at time of a SDP, please review changes on the Planning website and notify planner if you wish to pursue this avenue or continue with a traditional sign permit application.

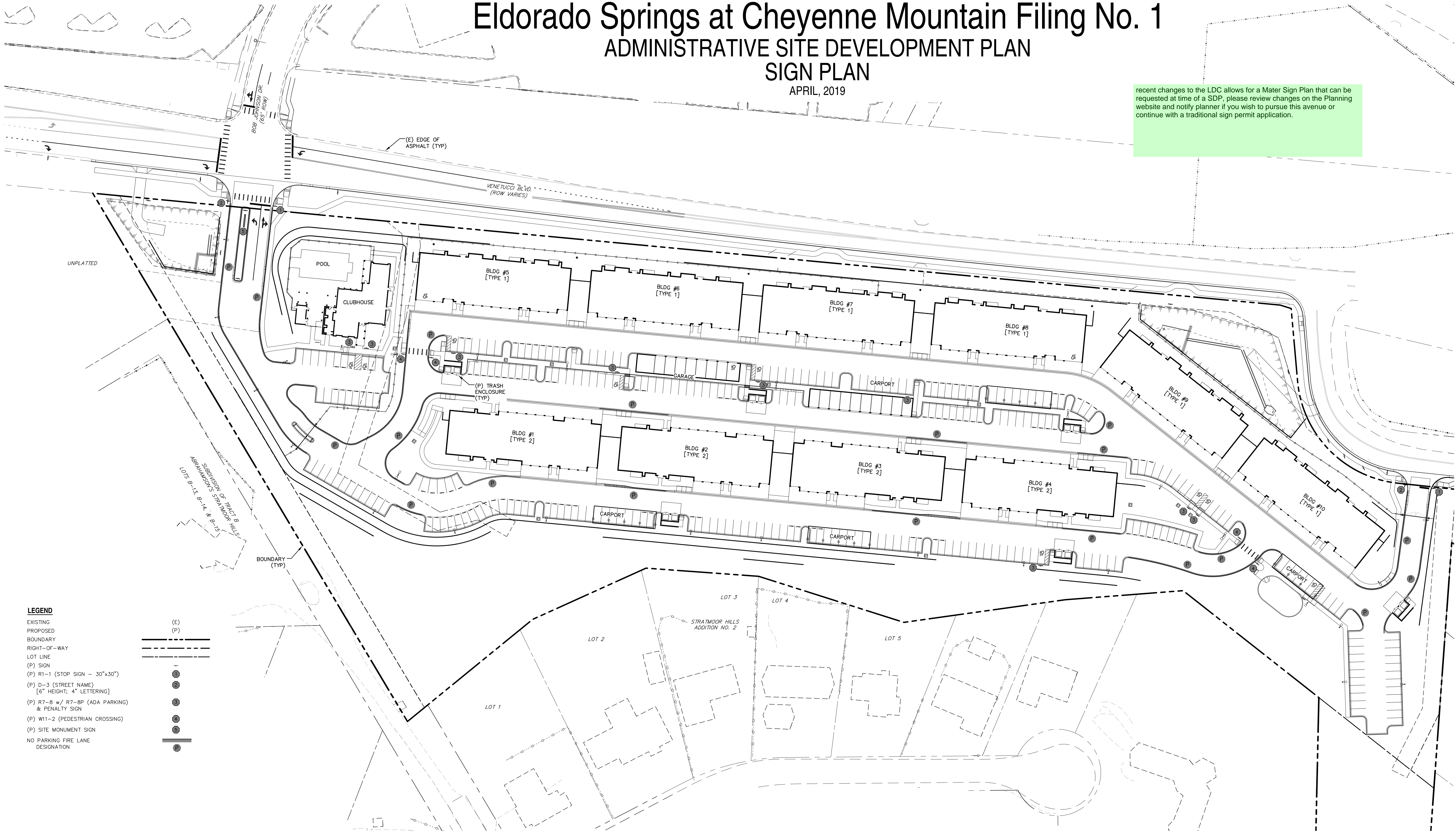

- LEGEND**
- EXISTING
 - PROPOSED
 - BOUNDARY
 - RIGHT-OF-WAY
 - LOT LINE
 - (P) SIGN
 - (P) R1-1 (STOP SIGN - 30"x30")
 - (P) D-3 (STREET NAME) [6" HEIGHT; 4" LETTERING]
 - (P) R7-8 w/ R7-BP (ADA PARKING) & PENALTY SIGN
 - (P) W11-2 (PEDESTRIAN CROSSING)
 - (P) SITE MONUMENT SIGN
 - NO PARKING FIRE LANE DESIGNATION

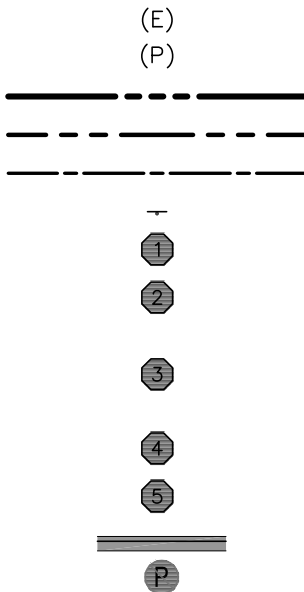

ALTITUDE
LAND CONSULTANTS
PLANNING LANDSCAPE
2727 N. CASCADE AVE., SUITE #160
COLORADO SPRINGS, CO 80907
WWW.ALTITUDELANDCO.COM

WAY ARCHITECTS, P.C.
318 North Tejon
Colorado Springs, Colorado 80903
(719)473-8400 FAX (719)473-0400
www.waygroup.com

WESTWORKS
ENGINEERING
1023 W. COLORADO COLORADO SPRINGS, CO 80904 (719) 685-1670

Eldorado Springs
ADMINISTRATIVE SITE DEVELOPMENT PLAN
SOUTH VENETUCCI BOULEVARD
EL PASO COUNTY, STATE OF COLORADO

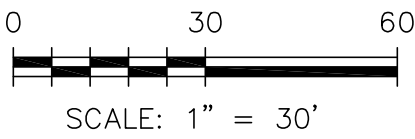
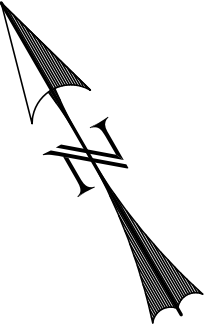

DATE: 06.27.2019
DRAWN BY: CDK
CHECKED BY: CDK

NOT FOR CONSTRUCTION
COPYRIGHT 2019
THIS DOCUMENT IS AN INSTRUMENT OF SERVICE, AND AS SUCH REMAINS THE PROPERTY OF THE CONSULTANT. PERMISSION FOR USE OF THIS DOCUMENT IS LIMITED AND CAN BE EXTENDED ONLY BY WRITTEN AGREEMENT WITH ALTITUDE LAND CONSULTANTS.

REV.	DESCRIPTION	DATE

SHEET SDP13
WESTWORKS PROJECT # 91807

COUNTY FILE NO. PPR-11-001 - ADMINISTRATIVE SITE DEVELOPMENT PLAN