

INDEPENDENCE PLACE AT CHEYENNE MOUNTAIN Fil. No. 1

ADMINISTRATIVE SITE DEVELOPMENT PLAN

VENETUCCI BLVD. OCTOBER, 2019
 MINOR ARTERIAL
 ROW VARIES

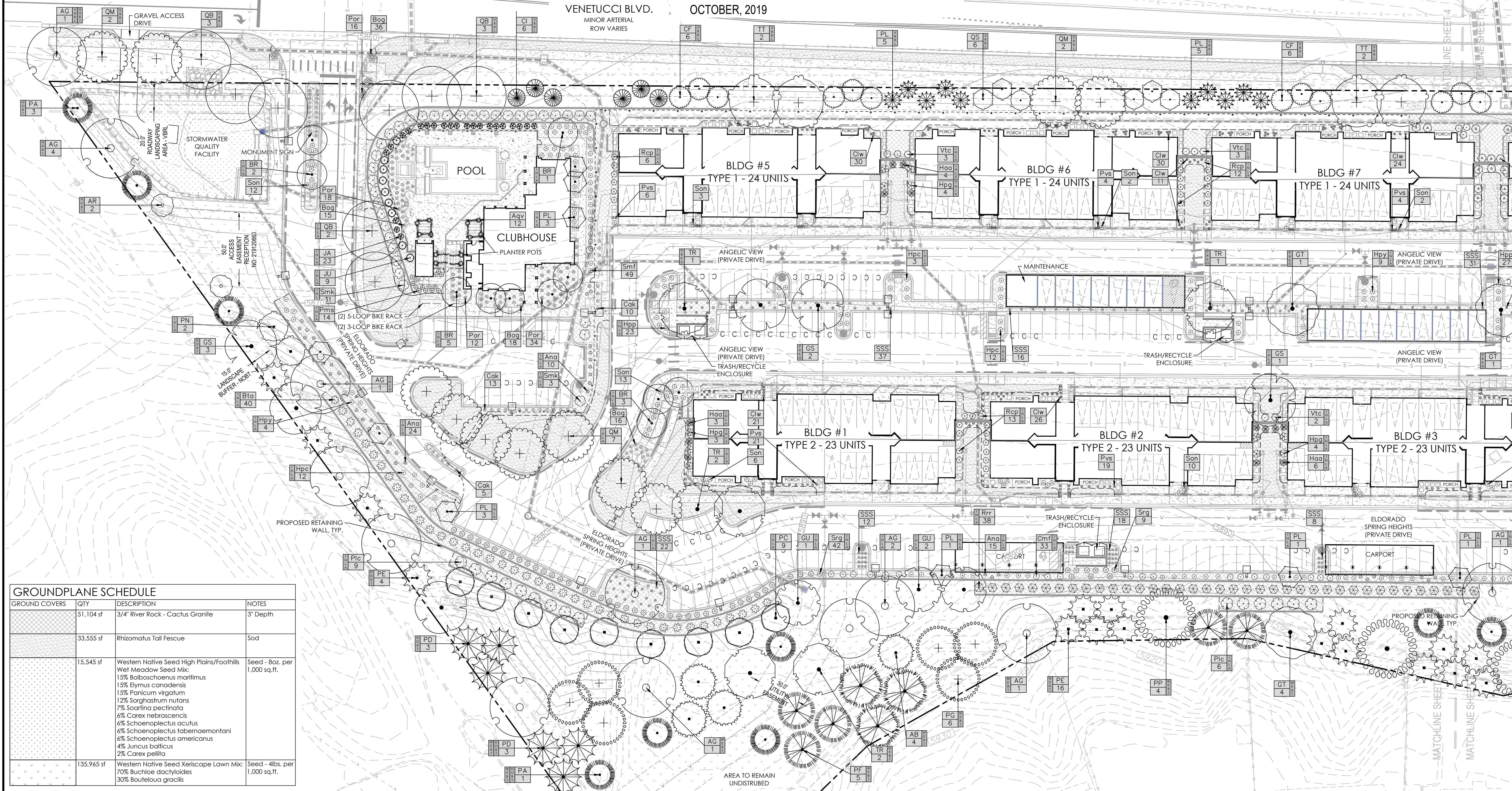

GROUNDPLANE SCHEDULE			
GROUND COVERS	QTY	DESCRIPTION	NOTES
[Pattern]	51,104 sf	3/4" River Rock - Cactus Granite	3" Depth
[Pattern]	33,555 sf	Rhizomatous Tall Fescue	Sod
[Pattern]	15,545 sf	Western Native Seed High Plains/Foothills Wet Meadow Seed Mix: 15% Bolboschoenus maritimus 15% Elymus canadensis 15% Panicum virgatum 12% Sorghastrum nutans 7% Soraria pectinata 6% Carex nebrascensis 6% Schoenoplectus acutus 6% Schoenoplectus tabernaemontani 6% Schoenoplectus americanus 4% Juncus balticus 2% Carex pellita	Seed - 8oz. per 1,000 sq.ft.
[Pattern]	135,965 sf	Western Native Seed Xeriscape Lawn Mix: 70% Buchloe dactyloides 30% Bouteloua gracilis	Seed - 4lbs. per 1,000 sq.ft.

ELDORADO SPRINGS
 ADMINISTRATIVE SITE DEVELOPMENT PLAN
 SOUTH VENETUCCI BOULEVARD
 EL PASO COUNTY, STATE OF COLORADO

LANDSCAPE PLAN
SDP4
 SHEET 4 OF 16
 ALC PROJECT #19-020



NOT FOR CONSTRUCTION
 COPYRIGHT 2020
 THIS DOCUMENT IS AN INSTRUMENT OF SERVICE, AND AS SUCH REMAINS THE PROPERTY OF THE CONSULTANT. PERMISSION FOR USE OF THIS DOCUMENT IS LIMITED AND CAN BE EXTENDED ONLY BY WRITTEN AGREEMENT WITH ALTITUDE LAND CONSULTANTS.

LEGEND:
 - - - - - 6" STEEL ROLLED-TOP EDGING
 - - - - - 6" IRON FENCE

ORIGINAL SUBMITTAL DATE: 10.31.2019
 DRAWN BY: RLB
 CHECKED BY: JWO

REVISIONS:
 NO. DATE BY
 #1 02.21.2020 AKT
 #2 04.30.2020 AKT
 #3 08.18.2020 AKT

INDEPENDENCE PLACE AT CHEYENNE MOUNTAIN Fil. No. 1

ADMINISTRATIVE SITE DEVELOPMENT PLAN

OCTOBER, 2019

PARKING LOT LANDSCAPE REQUIREMENTS - LAND DEVELOPMENT CODE SECTION 6.2.2 - C			
# OF UNCOVERED SPACES	SHADE TREES REQ. / PROV. (1 TREE PER 15 SPACES)	SYMBOL ON PLAN	
264	18	18	PRKG

INTERNAL LANDSCAPING - LAND DEVELOPMENT CODE SECTION 6.2.2 - E									
SITE AREA	MINIMUM REQ. INTERNAL LANDSCAPE AREA	INTERNAL LANDSCAPE AREA REQ. / PROV.	TREES REQ. / PROV. (1 TREE PER 500 SQ. FT.)	SHRUBS SUBSTITUTES REQ. / PROV. (1 TREE = 10 SHRUBS)	SYMBOL ON PLAN	GROUNDPLANE VEGETATION REQ. / PROV.			
571,445	15%	85,717	236,187	171	117	540	545	INLA	50% / 50%

ROADWAY LANDSCAPING - LAND DEVELOPMENT CODE SECTION 6.2.2 - B										
STREET NAME	CLASSIFICATION	DEPTH OF ROADWAY LANDSCAPING AREA REQ. / PROV.	LINEAR FOOTAGE	REQ. TREE SPACING	TREES REQ. / PROV.	EVERGREEN TREES REQ. / PROVIDED (1/3)	SYMBOL ON PLAN			
VENETUCCI BLVD	MINOR ARTERIAL	20	20	1281	25	51	51	17	18	VBRL
WESTMARK AVE	NON-ARTERIAL	10	10	265	30	9	9	3	3	WARL

REQUIRED BUFFER AND SCREEN AREAS - LAND DEVELOPMENT CODE SECTION 6.2.2 - D										
PROPERTY LINE	BUFFER DEPTH REQ. / PROV.	LINEAR FOOTAGE	TREES REQ. / PROV. (1 TREE PER 25 LINEAR FT.)	EVERGREEN TREES REQ. / PROV. (1/3 REQ. TREE TOTAL)	6' TALL OPAQUE FENCE LENGTH REQ. / PROV. (BUFFER IF DISTANCE)	SYMBOL ON PLAN				
NORTH	15'	15'	535	21	24	7	14	535	0'	NOBT
WEST	15'	15'	1350	54	83	18	69	1350	0'	WEBT
SOUTH	15'	15'	235	9	19	3	15	235	0'	SOBT

*SEE ALTERNATIVE COMPLIANCE REQUEST: IN LIEU OF 6' OPAQUE FENCE, REQUIRED BUFFER LANDSCAPING INCREASED.

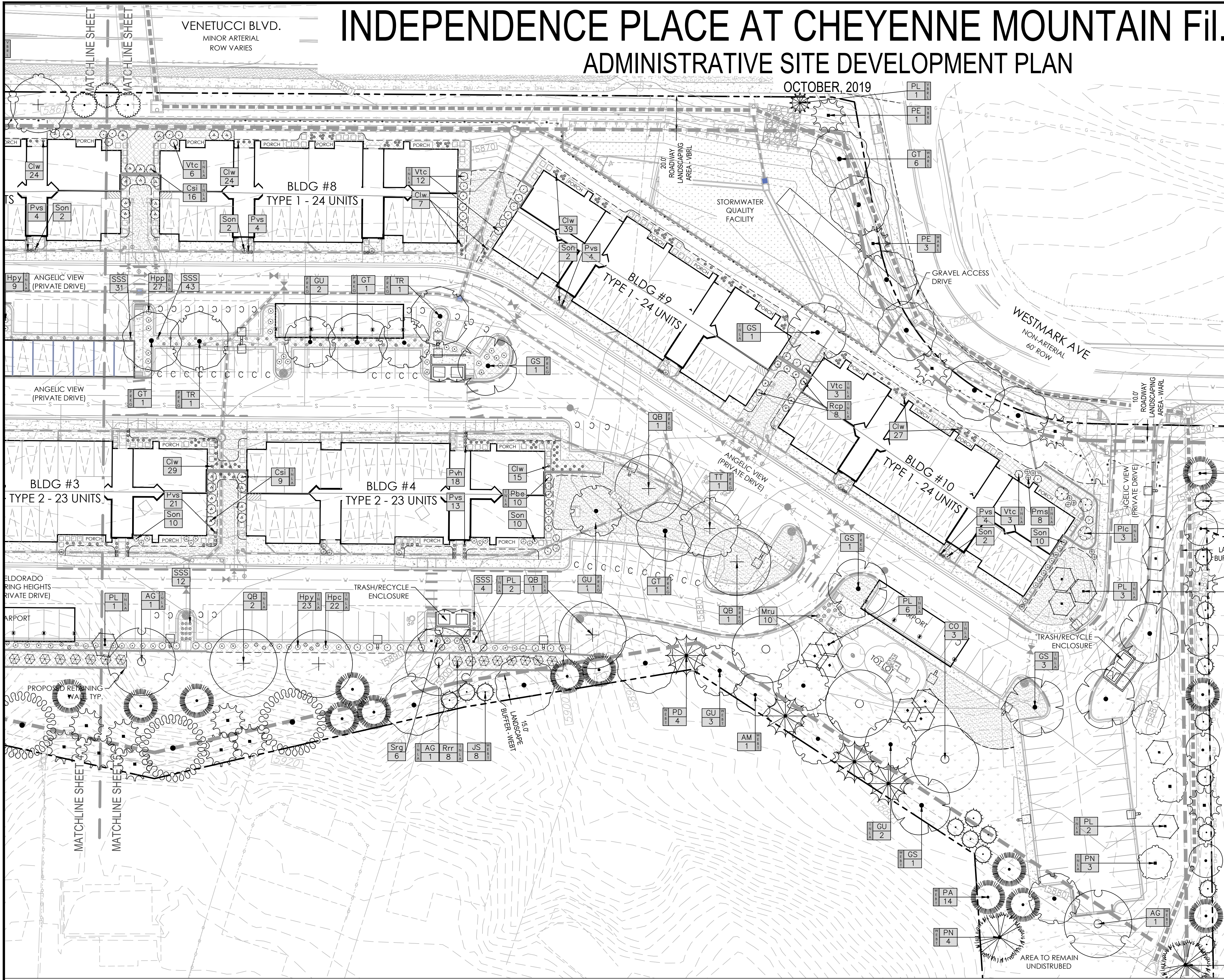

GROUNDPLANE SCHEDULE			
GROUND COVERS	QTY	DESCRIPTION	NOTES
[Pattern]	51,104 sf	3/4" River Rock - Cactus Granite	3" Depth
[Pattern]	33,555 sf	Rhizomatous Tall Fescue	Sod
[Pattern]	15,545 sf	Western Native Seed High Plains/Foothills Wet Meadow Seed Mix: 15% Bolboschoenus maritimus 15% Elymus canadensis 15% Panicum virgatum 12% Sorghastrum nutans 7% Sorghastrum nutans 6% Carex nebrascensis 6% Schoenoplectus acutus 6% Schoenoplectus tabernaemontani 6% Schoenoplectus americanus 4% Juncus balticus 2% Carex pectinata	Seed - 8oz. per 1,000 sq.ft.
[Pattern]	135,965 sf	Western Native Seed Xeriscape Lawn Mix: 70% Buchloe dactyloides 30% Bouteloua gracilis	Seed - 4lbs. per 1,000 sq.ft.

ALTITUDE
LAND CONSULTANTS
CIVIL/SURVEY/PLANNING/LANDSCAPE
2727 N. CASCADE AVE., SUITE #160
COLORADO SPRINGS, CO 80907
WWW.ALTITUDELANDCO.COM

WAY ARCHITECTS, P.C.
318 North Tejon
Colorado Springs, Colorado 80903
(719)473-8400 FAX (719)473-0400
www.waygroup.com

WESTWORKS
ENGINEERING
1023 W. COLORADO COLORADO SPRINGS, CO 80904 (719) 686-1670

ELDORADO SPRINGS
ADMINISTRATIVE SITE DEVELOPMENT PLAN
SOUTH VENETUCCI BOULEVARD
EL PASO COUNTY, STATE OF COLORADO

LANDSCAPE PLAN
SDP5
SHEET 5 OF 16
ALC PROJECT #19-020

NOT FOR CONSTRUCTION
COPYRIGHT 2020
THIS DOCUMENT IS AN INSTRUMENT OF SERVICE, AND AS SUCH REMAINS THE PROPERTY OF THE CONSULTANT. PERMISSION FOR USE OF THIS DOCUMENT IS LIMITED AND CAN BE EXTENDED ONLY BY WRITTEN AGREEMENT WITH ALTITUDE LAND CONSULTANTS.

ORIGINAL SUBMITTAL DATE: 10.31.2019
DRAWN BY: RLB
CHECKED BY: JWO

REVISIONS:
NO. DATE BY
#1 02.21.2020 AKT
#2 04.30.2020 AKT
#3 08.18.2020 AKT

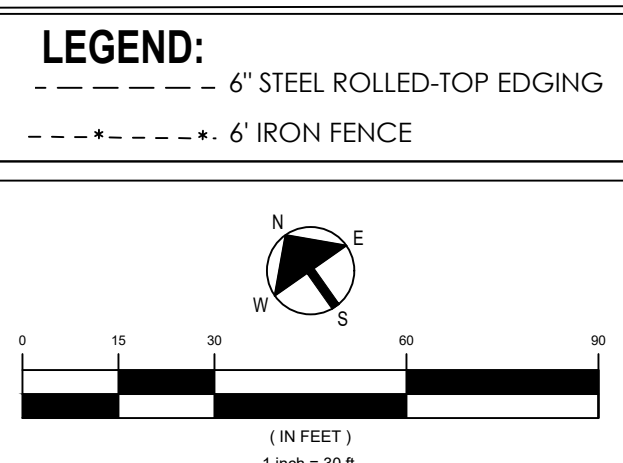

INDEPENDENCE PLACE AT CHEYENNE MOUNTAIN Fil. No. 1

ADMINISTRATIVE SITE DEVELOPMENT PLAN

OCTOBER, 2019

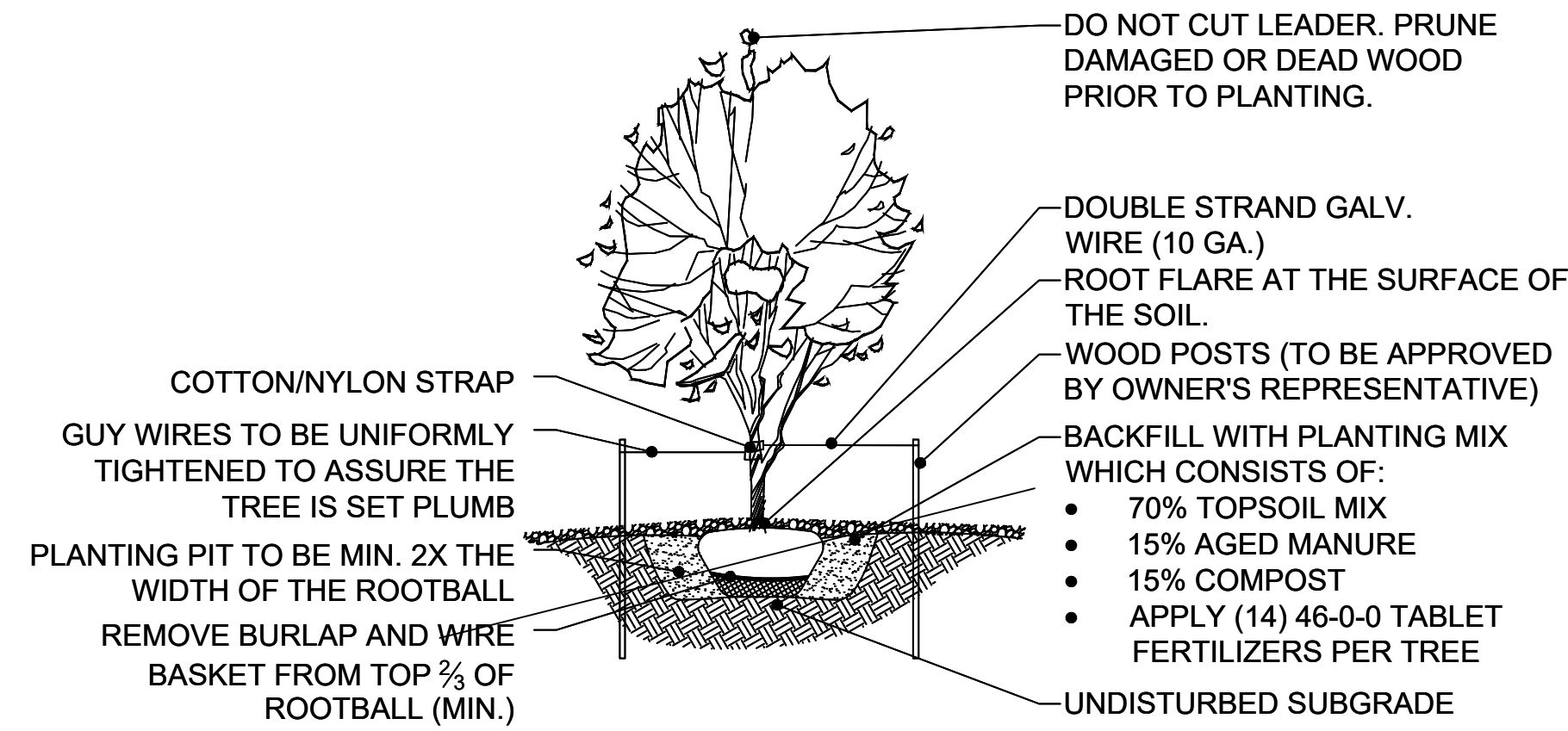

A1 Deciduous Tree Planting Detail:

NOT TO SCALE

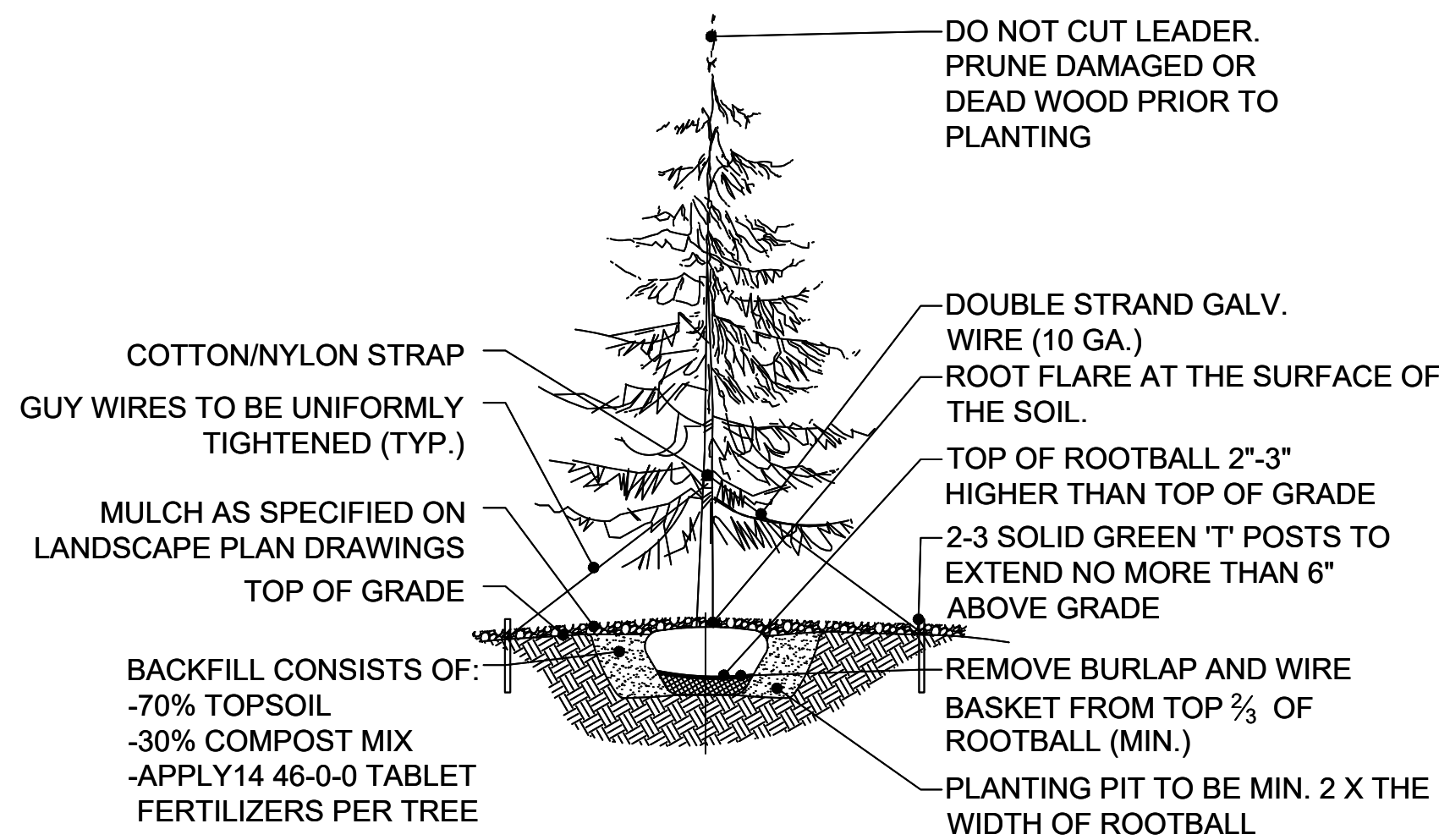

A2 Evergreen Tree Planting Detail:

NOT TO SCALE

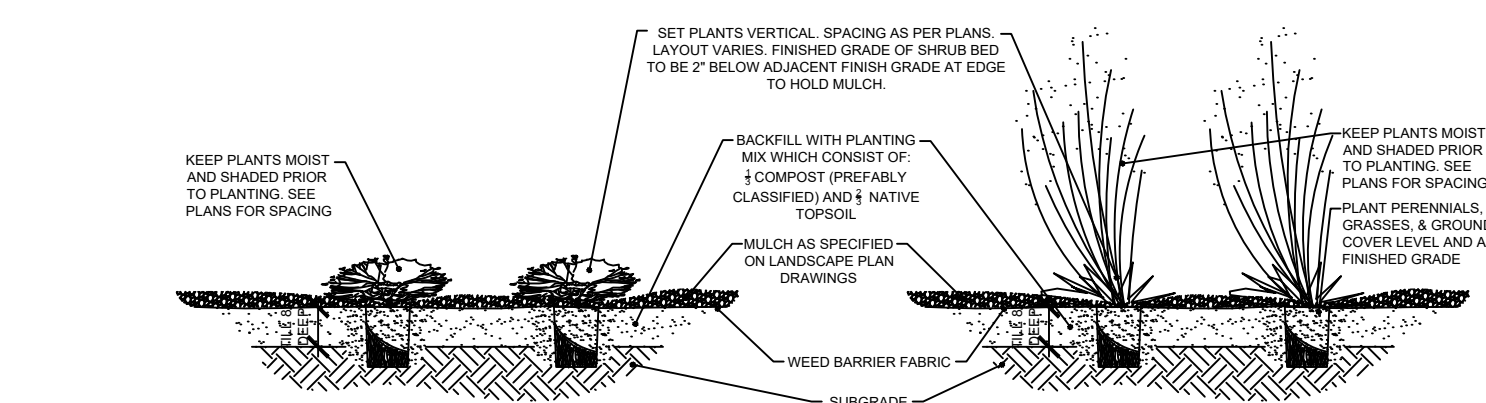

A3 Shrubs & Grasses Planting Details:

NOT TO SCALE

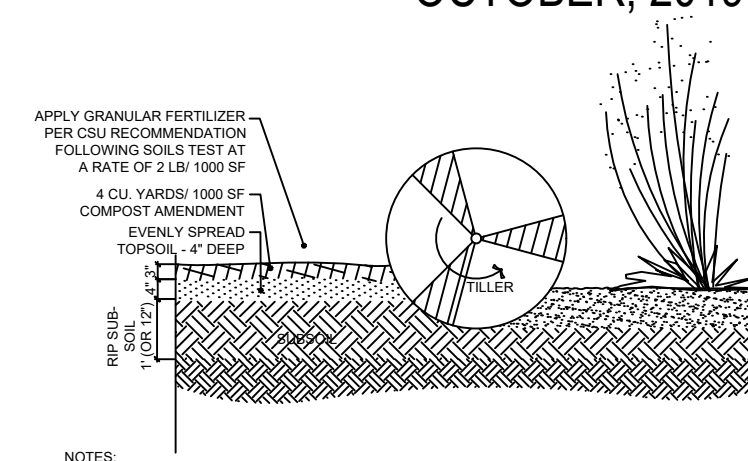

B1 Soil Prep-Plantings:

NOT TO SCALE

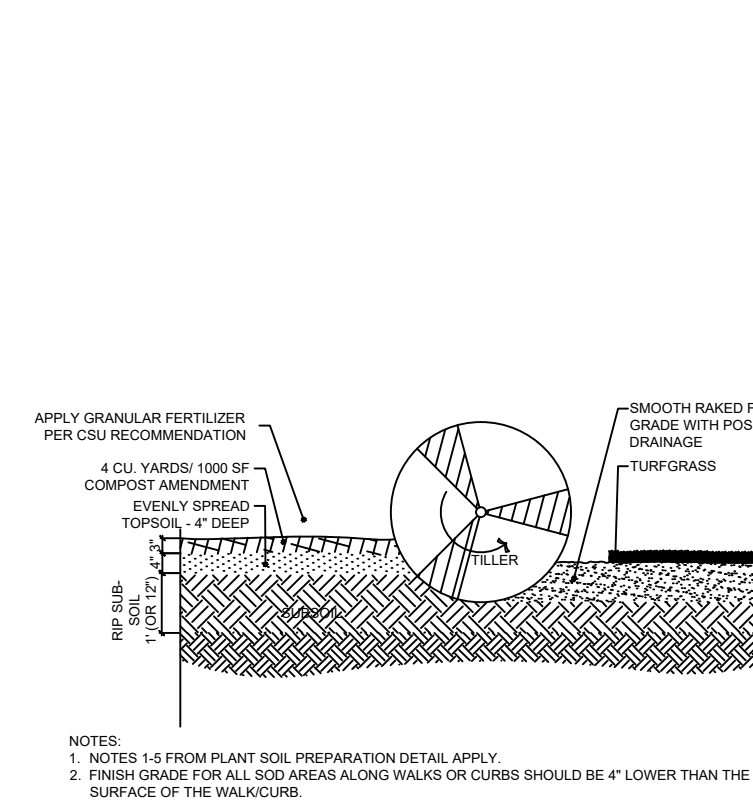

B2 Soil Prep-Sod:

NOT TO SCALE

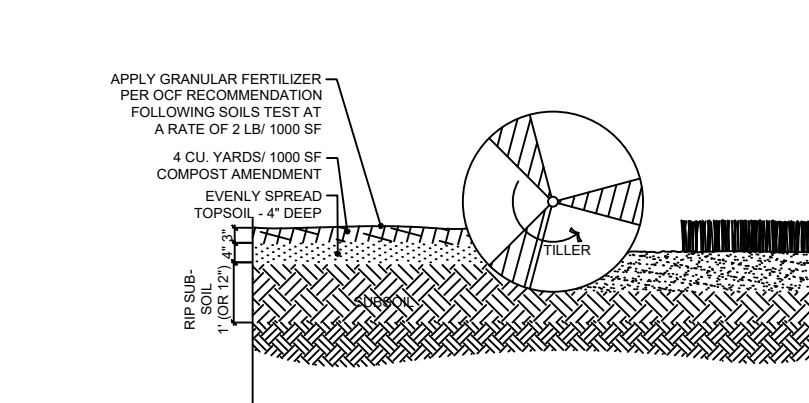

B3 Soil Prep-Seed:

NOT TO SCALE

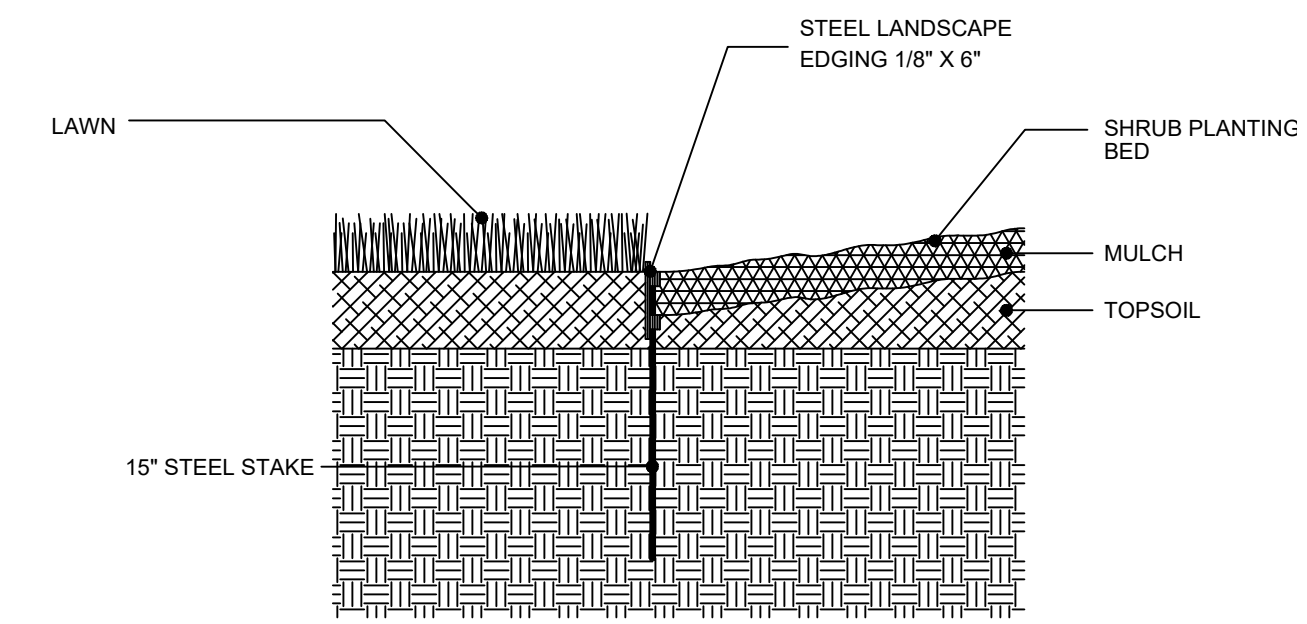

C1 Steel Rolled-Top Edging Detail:

NOT TO SCALE

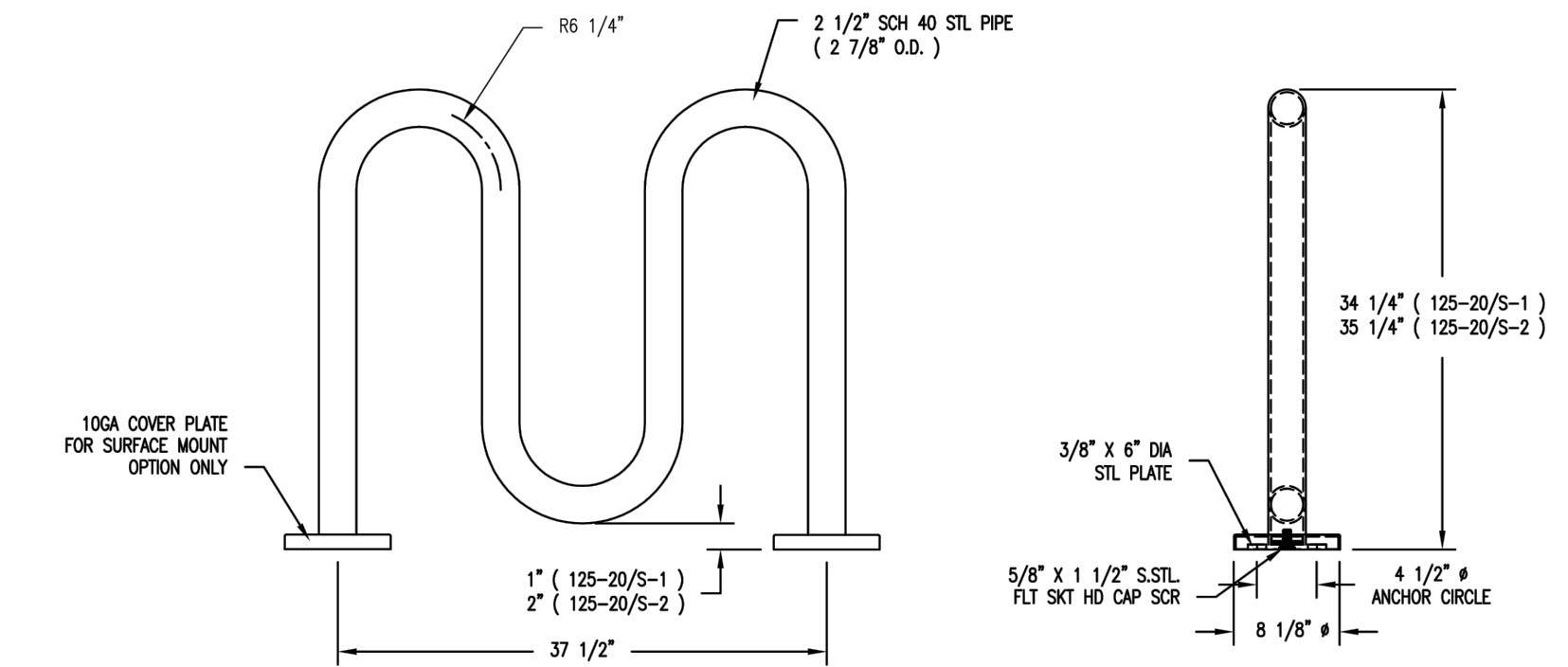

C2 3-Loop Bike Rack Detail:

NOT TO SCALE

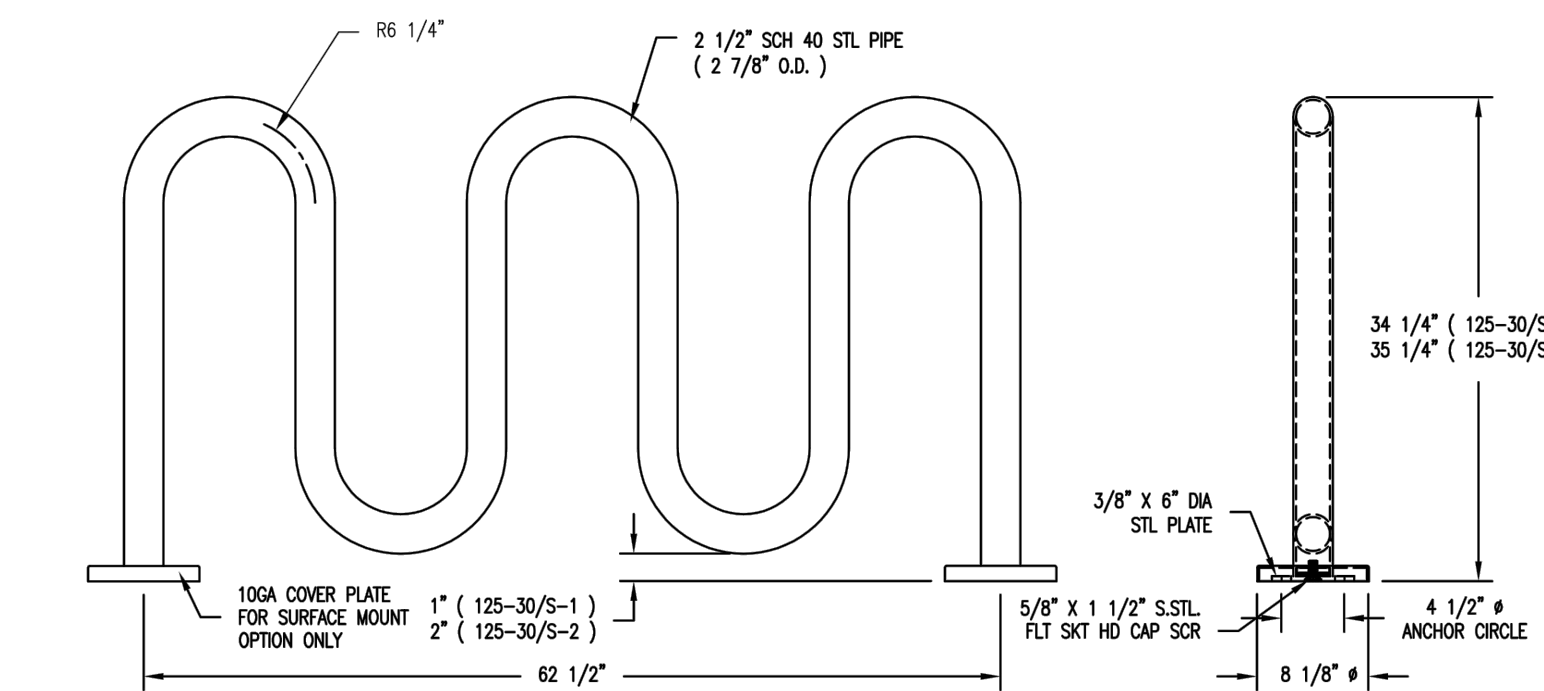

C3 5-Loop Bike Rack Detail:

NOT TO SCALE



0.1 0 0.04 0.1 Miles

NAD_1983_StatePlane_Colorado_Central_FIPS_0502_Feet
© Latitude Geographics Group Ltd.

Copyright © 2020 City of Colorado Springs on behalf of the Colorado Springs Utilities. All rights reserved. This work, and/or the data contained hereon, may not be modified, republished, used to prepare derivative works or commercially exploited in any manner without the prior express written consent of the City of Colorado Springs. This work was prepared utilizing the best data available at the time of creation. Neither the City of Colorado Springs, the Colorado Springs Utilities, nor any of their employees makes any warranty, express or implied, or assumes any legal liability or responsibility for accuracy, completeness, or usefulness of any data contained hereon. The City of Colorado Springs, Colorado Springs Utilities, and their employees explicitly disclaim any responsibility for the data contained hereon.