

# RESIDENTIAL



2017 PPRBC

Address: 6535 LINDAL DR, COLORADO SPRINGS

Parcel: 5406107007

Plan Track #: 156676 

Received: 12-Jan-2022 (AUSTINK)

## Description:

**DECK - NEW**

Contractor: HOMEOWNER

Type of Unit:

## Required PPRBD Departments (2)

**Floodplain**

(N/A) RBD GIS

**Construction**

Released for Permit  
01/21/2022 4:45:22 PM



**CGieck**  
**CONSTRUCTION**

## Required Outside Departments (1)

**County Zoning**

**APPROVED**  
**Plan Review**

02/02/2022 12:18:39 PM  
dsdkrebs



EPC Planning & Community  
Development Department

Release of this plan does not preclude compliance with all applicable codes, ordinances and other pertinent regulations. This plan set must be present on the job site for every inspection.

# Site Plan

## New Deck Distance to Property Line

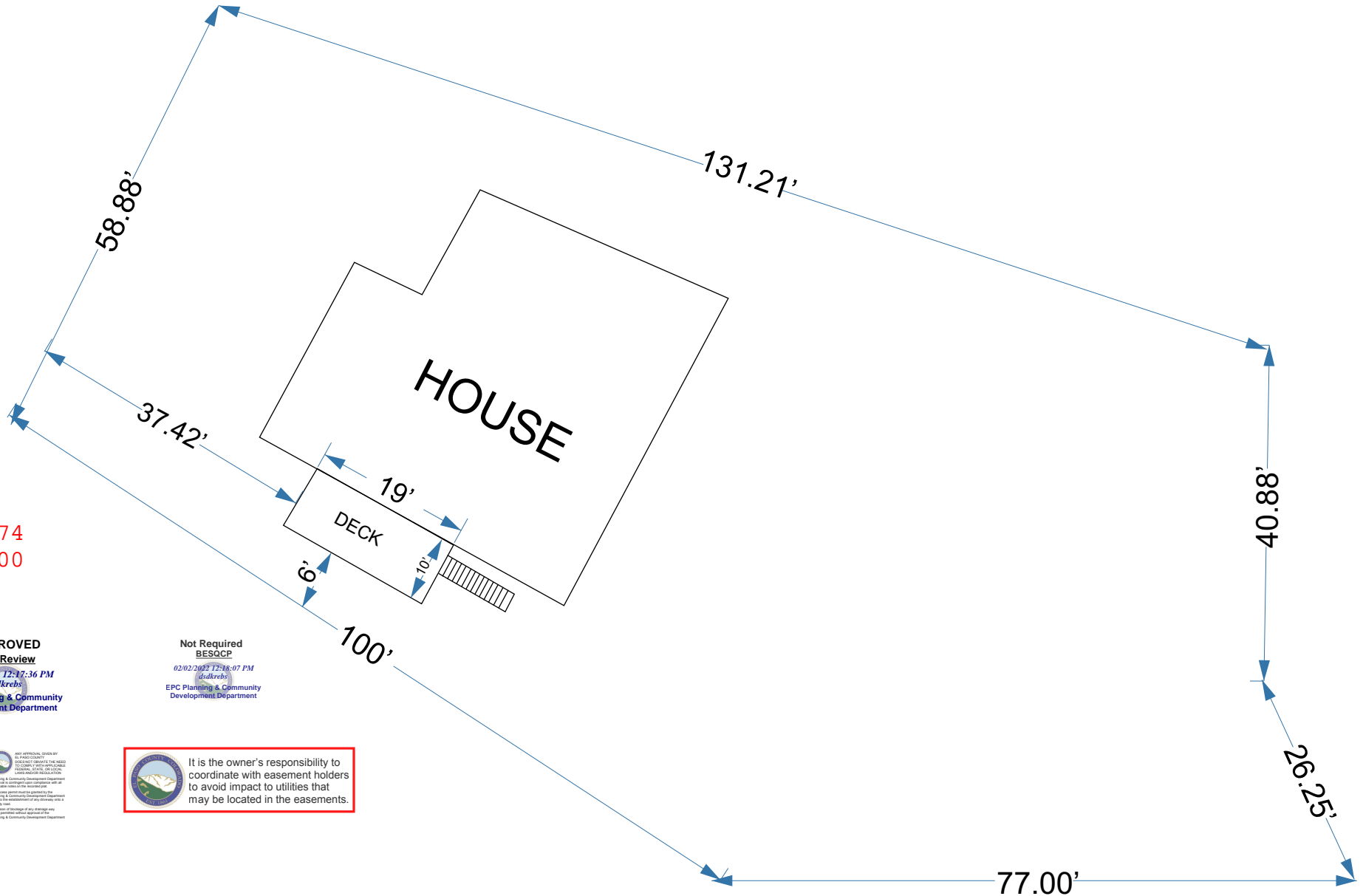

ADD2274  
RS-6000  
6720

**APPROVED**  
**Plan Review**  
02/02/2022 12:17:36 PM  
dsdkrebs  
EPC Planning & Community  
Development Department

Not Required  
BESQCP  
02/02/2022 12:18:07 PM  
dsdkrebs  
EPC Planning & Community  
Development Department

ANY APPROVALS GRANTED BY  
SOLANO COUNTY ARE THE RESULT OF  
THE COUNTY'S BEST EFFORTS TO  
PROVIDE SERVICES TO THE COMMUNITY.  
THE COUNTY DOES NOT WARRANT THE  
ACCURACY OF ANY INFORMATION  
CONTAINED HEREIN. THE COUNTY  
PLANNING & COMMUNITY DEVELOPMENT  
DEPARTMENT IS NOT RESPONSIBLE FOR  
ANY DAMAGES, INCLUDING BUT NOT  
LIMITED TO, CONSEQUENTIAL DAMAGES,  
OR ANY OTHER DAMAGES, ARISING FROM  
THE USE OF THIS INFORMATION.

 It is the owner's responsibility to coordinate with easement holders to avoid impact to utilities that may be located in the easements.