

# LEWIS PALMER TRAIL

LEWIS PALMER SCHOOL DISTRICT 38

TOWN OF MONUMENT, EL PASO COUNTY, COLORADO

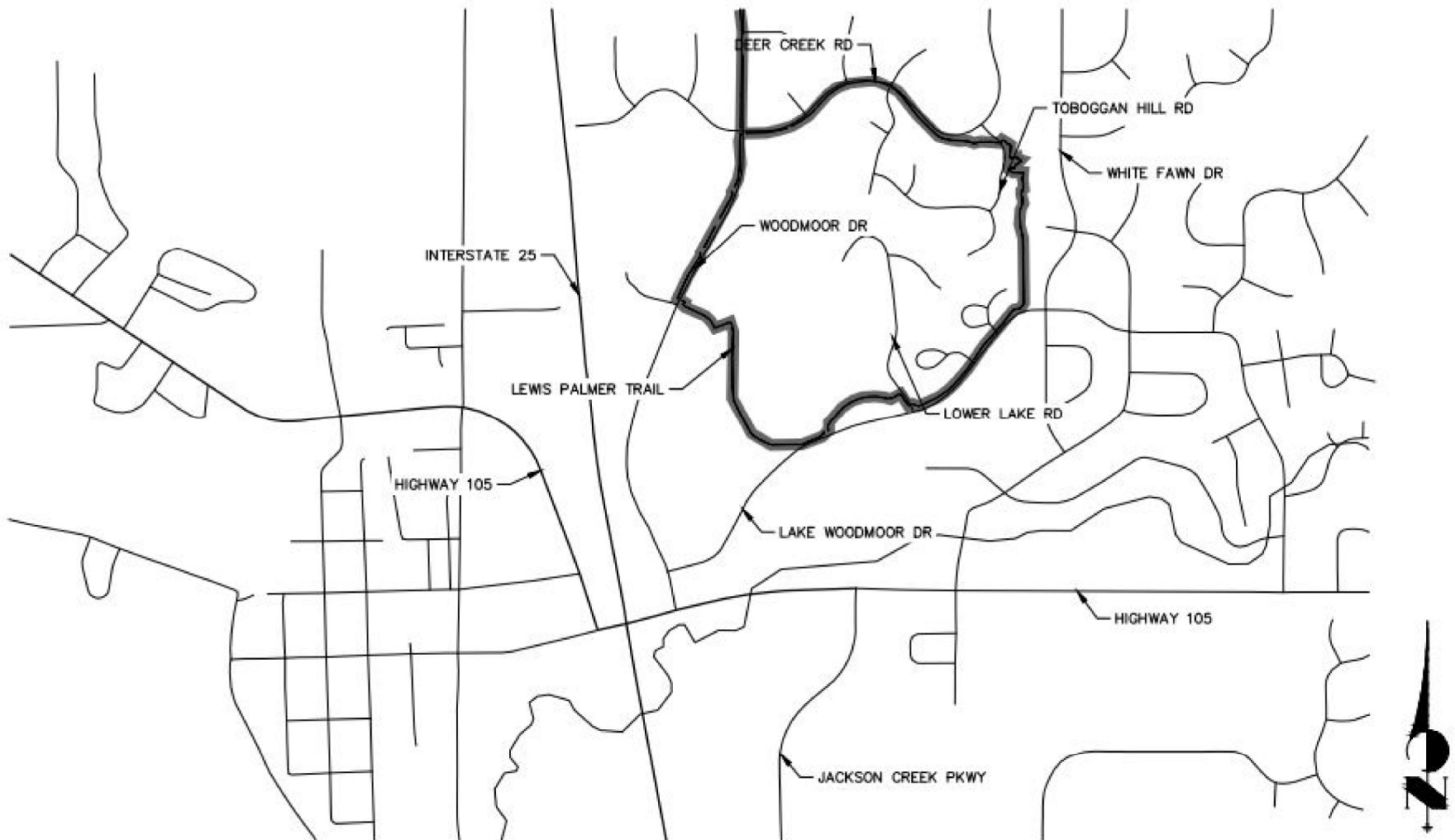

VICINITY MAP

SCALE: 1"=1000'

# LOCATION APPROVAL MAP CHECKLIST

PROJECT NAME: Lewis Palmer Trail System  
SUBMITTAL DATE: 05 /23 /2022  
SUBMITTED BY: Glenn Ellis - JR Engineering  
SUBMITTAL REVIEWED BY: \_\_\_\_\_

## **Location Approval Map**

A map shall be drawn to a scale suitable to describe the information required and shall include:

1. Boundary description of the subject property, which shall illustrate the legal description.  NA
2. Existing land uses and zoning on the property and within five hundred (500) feet of the boundary.  NA
3. Adjoining property ownership.
4. Existing private roads.
5. Existing structures.
6. Existing easements.
7. Name and addresses of the petitioner, owners of all interests (including mineral interests), in the property, and preparer.