

# THE SOD GUY - SALES LOT

SITE DEVELOPMENT PLANS  
LOT 1, APPALOOSA HIGHWAY 24 SUBDIVISION

Proposed access is equivalent to frontage, both fronts of the road are required to meet 50 foot front yard setback due to access.

THE PARTIES RESPONSIBLE FOR THIS PLAN HAVE FAMILIARIZED THEMSELVES WITH ALL CURRENT ACCESSIBILITY CRITERIA AND SPECIFICATIONS AND THE PROPOSED PLAN REFLECTS ALL SITE ELEMENTS REQUIRED BY THE APPLICABLE ADA DESIGN STANDARDS AND GUIDELINES AS PUBLISHED BY THE UNITED STATES DEPARTMENT OF JUSTICE. APPROVAL OF THIS PLAN BY EL PASO COUNTY DOES NOT ASSURE COMPLIANCE WITH THE ADA OR ANY REGULATIONS OR GUIDELINES ENACTED OR PROMULGATED UNDER OR WITH RESPECT TO SUCH LAWS.

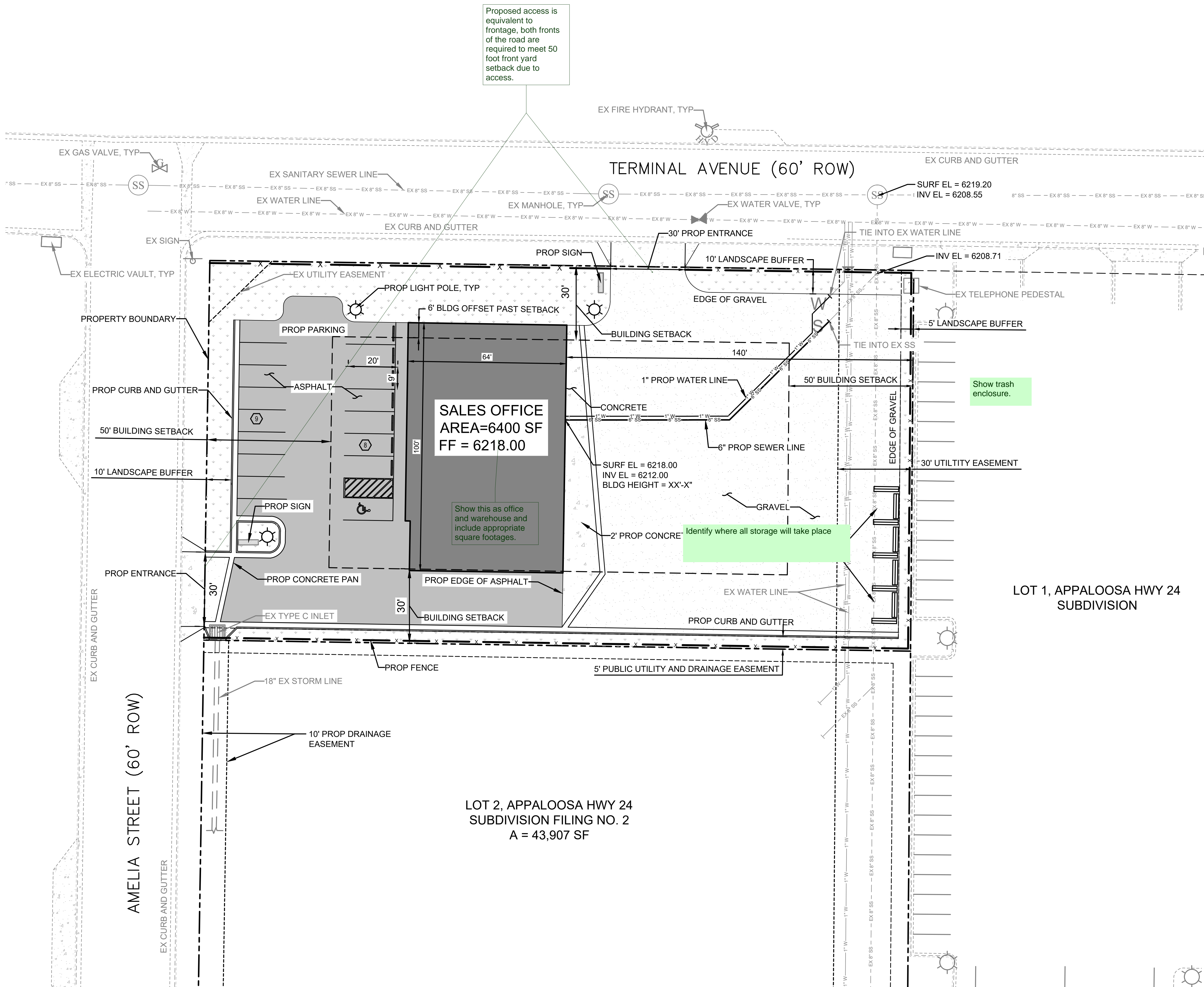

**LEGEND:**

- PROPOSED GRAVEL
- PROPOSED ASPHALT
- PROPOSED FENCE
- PROPOSED LANDSCAPING

EL PASO COUNTY CODE	REQUIRED	PROVIDED
PARKING SPACES	XX	17
LANDSCAPING	XX	XX

NO.	REVISIONS	BY	DATE

**FORSGREN Associates, Inc.**  
50 Inverness Drive East, Suite 112, Englewood, CO 80112  
PH: 720.214.5884 FAX: 720.000.0000

PROJECT NO.	04-18-2XXX
DRAWN	C. BURBA
DESIGNED	C. BURBA
APPROVED	C. BURBA
QA/QC	J. MOORE

**OWNER**  
THE SOD GUY  
COLORADO SPRINGS, CO

**THE SOD GUY - SALES LOT**  
**SITE PLAN**

SHEET NO:  
**C-01**  
DATE:  
01/11/19  
PAGE NO:  
1 OF 1

# Site Plan\_v1-redline.pdf Markup Summary

dskendall (4)

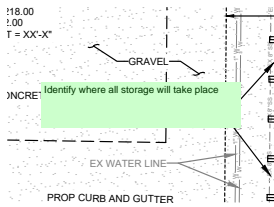

**Subject:** Text Box  
**Page Label:** [1] C-01  
**Lock:** Unlocked  
**Author:** dskendall  
**Date:** 6/13/2019 4:12:45 PM  
**Status:**  
**Color:** ■  
**Layer:**  
**Space:**

Identify where all storage will take place

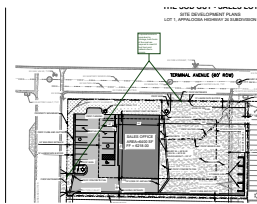

**Subject:** Callout  
**Page Label:** [1] C-01  
**Lock:** Unlocked  
**Author:** dskendall  
**Date:** 6/13/2019 4:13:56 PM  
**Status:**  
**Color:** ■  
**Layer:**  
**Space:**

Proposed access is equivalent to frontage, both fronts of the road are required to meet 50 foot front yard setback due to access.

Show trash enclosure.

**Subject:** Text Box  
**Page Label:** [1] C-01  
**Lock:** Unlocked  
**Author:** dskendall  
**Date:** 6/13/2019 4:14:26 PM  
**Status:**  
**Color:** ■  
**Layer:**  
**Space:**

Show trash enclosure.

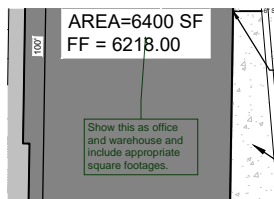

**Subject:** Callout  
**Page Label:** [1] C-01  
**Lock:** Unlocked  
**Author:** dskendall  
**Date:** 6/13/2019 4:19:59 PM  
**Status:**  
**Color:** ■  
**Layer:**  
**Space:**

Show this as office and warehouse and include appropriate square footages.