



January 10, 2023

Mr. Brett Lewis
Thompson Thrift Construction
901 Wabash Ave, Suite 300
Terre Haute, IN 47807
Upland Flats by Watermark

Please refer to ECM Chapter 5.10.6B for required statements and information on certification letters. Please include this statement "the site and adjacent properties (as affected by work performed under the County permit) are stable with respect to settlement and subsidence, sloughing of cut and fill slopes, revegetation or other ground cover, and that the improvements (public improvements, common development improvements, site grading and paving) meet or exceed the minimum design requirements."

Please also include a statement that the facilities provide the required storage volume and will meet the required release rates, as documented by an attached UDFCD design form submitted with the original application, the stage areas, elevations and outlet dimensions.

POND AS-BUILT CERTIFICATION LETTER

To whom it may concern,

The drainage facilities for the on-site extended detention basin, also referred to as the South Pond, was installed in general conformance with the construction documents for Upland Flats by Watermark (Tract DD, Hannah Ridge at Feathergrass Filing No. 1). This pond design was approved by El Paso County on November 9, 2021. This certification is based on an as-built survey performed by Compass Surveying & Mapping, LLC. On September 15, 2022. The results are as follows:

South Pond	Design	As-Built
Pond Volume	2.137	2.129
Pond Volume (No Freeboard)	1.482	1.465
100-Year Detention Volume	1.451	1.451

Additionally, the construction of the pond outlet structure was completed in compliance with the plans.

If you have any questions, please reach out to eric.gunderson@kimley-horn.com.

Thank you!

Eric Gunderson, PE
Engineer of Record
Kimley-Horn and Associates, Inc.



Eric Gunderson, Colorado PE 49487

DETENTION BASIN STAGE-STORAGE TABLE BUILDER

MHFD-Detention, Version 4.03 (May 2020)

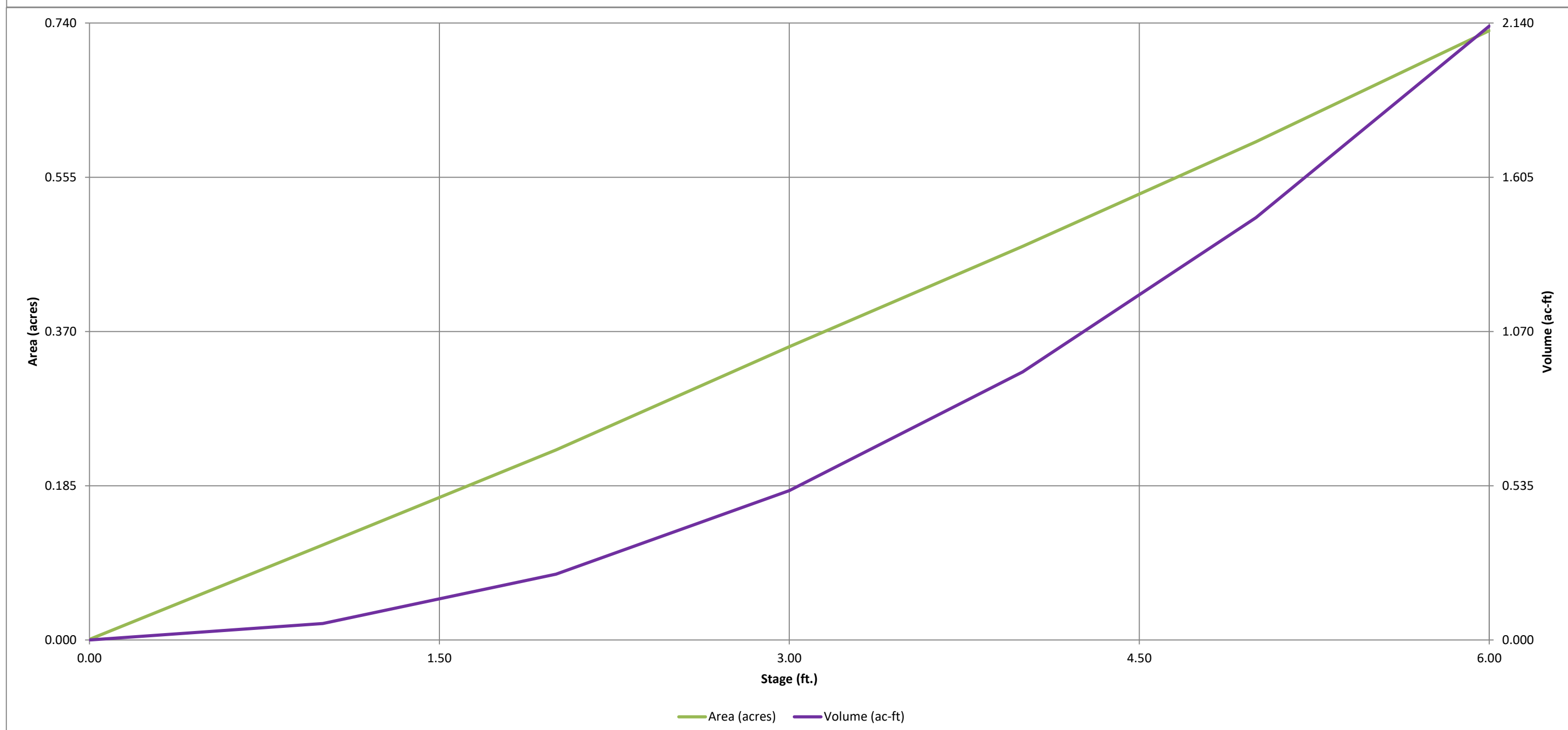
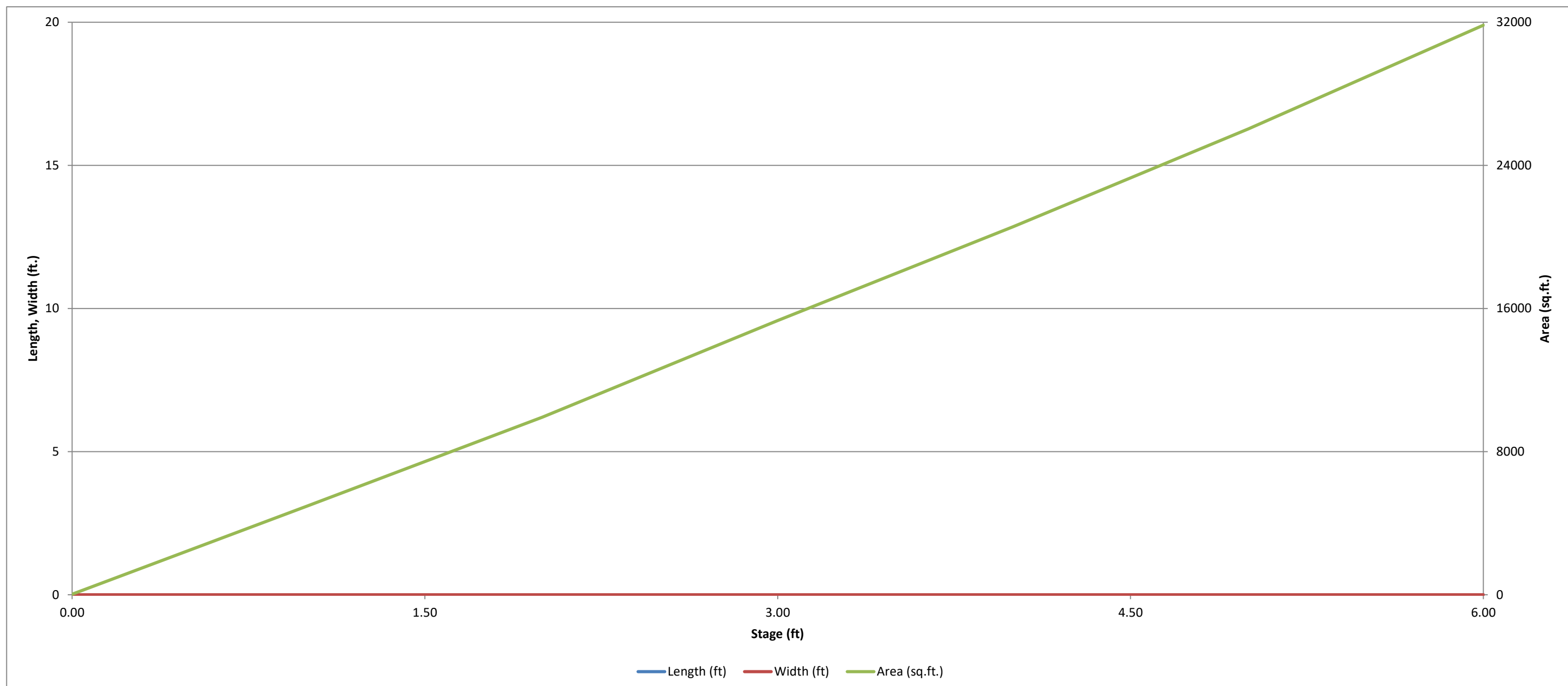

DETENTION BASIN STAGE-STORAGE TABLE BUILDER

MHFD-Detention, Version 4.03 (May 2020)

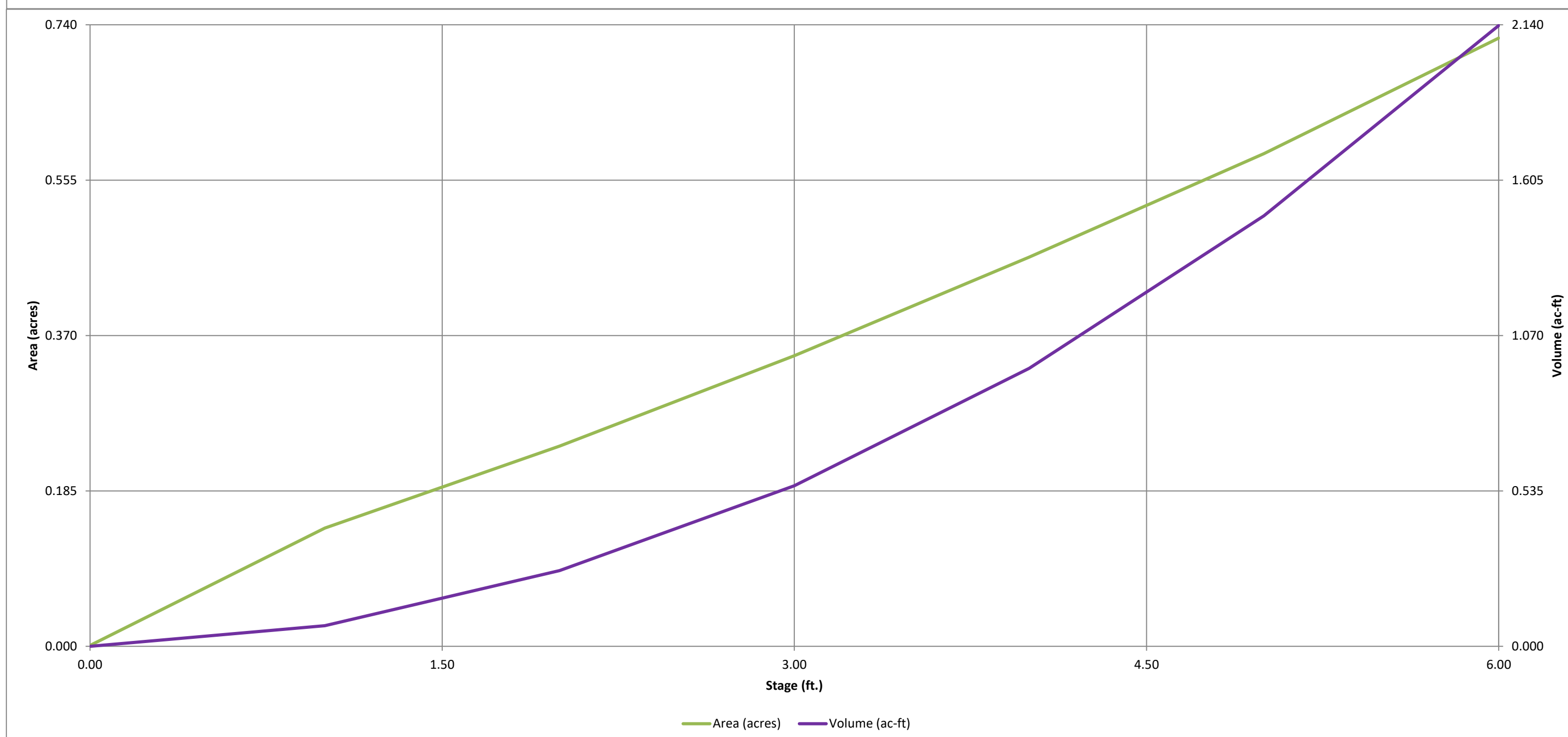
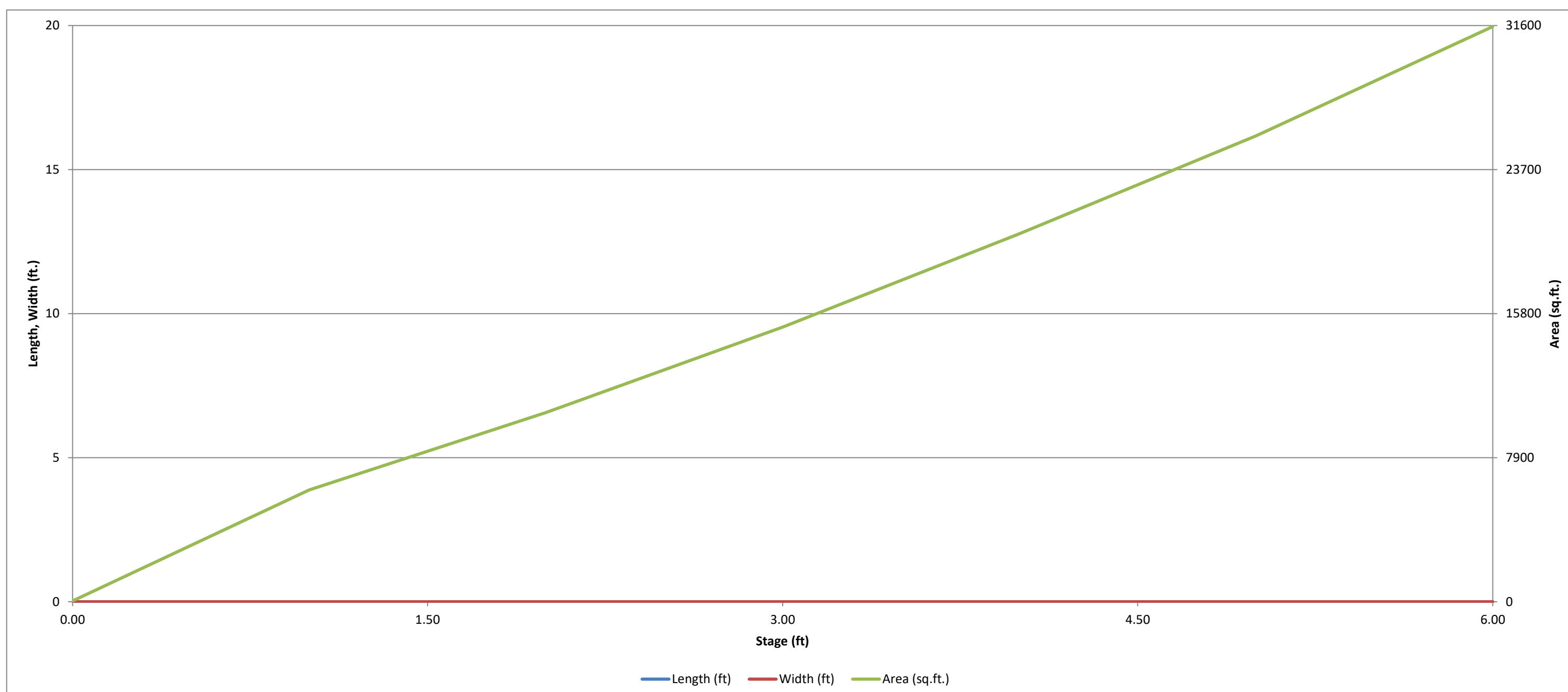

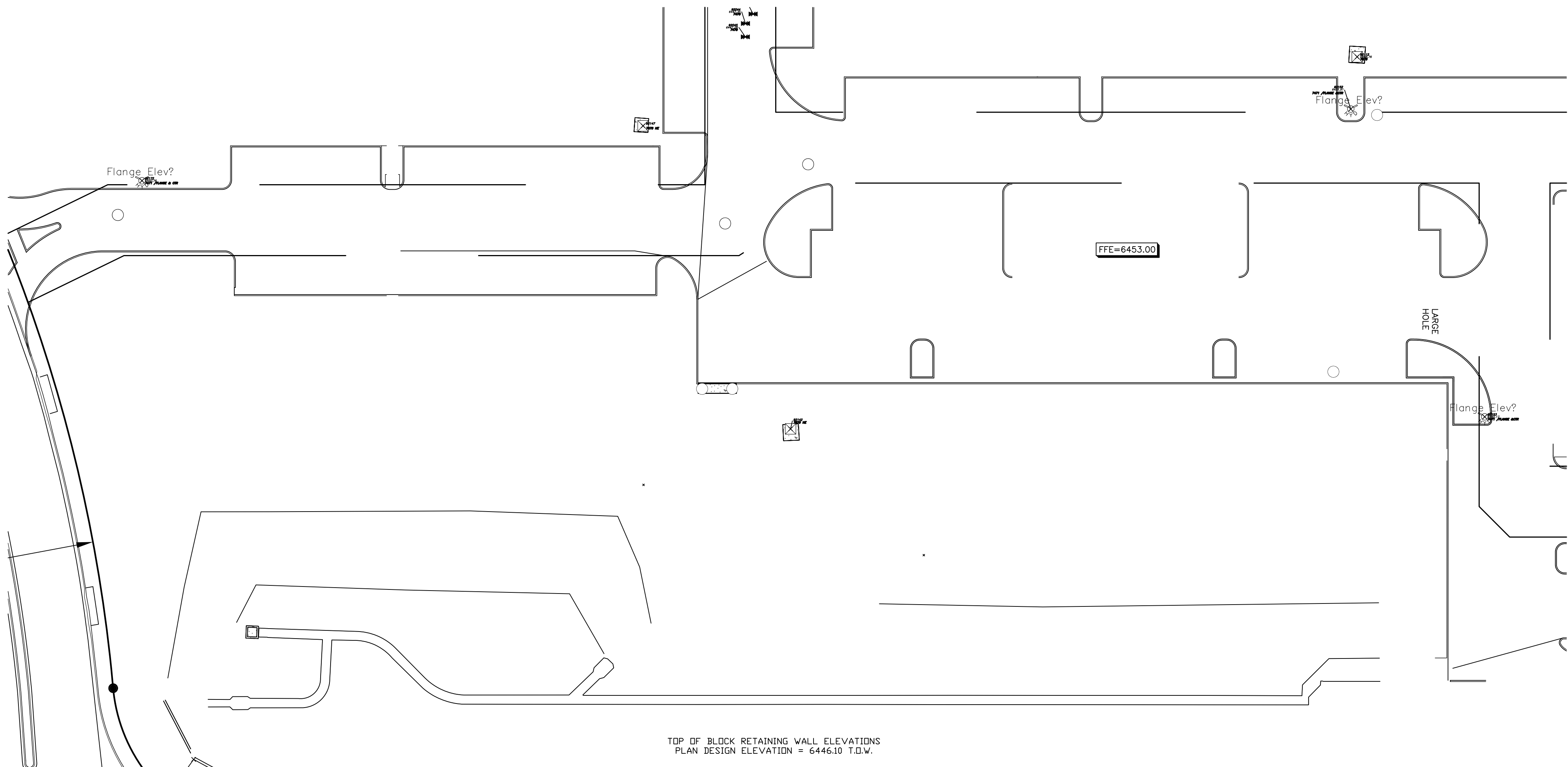

TOP OF BLOCK RETAINING WALL ELEVATIONS
 PLAN DESIGN ELEVATION = 6446.10 T.D.W.

- 93006
6444.07
3134 OH-1
- 93007
6445.93
3134 OH-1
- 93008
6446.04
3134 OH-1
- 93009
6446.04
3134 OH-1
- 93010
6446.04
3134 OH-1
- 93011
6446.05
3134 OH-1
- 93012
6446.05
3134 OH-1
- 93013
6446.02
3134 OH-1
- 93014
6446.02
3134 OH-1
- 93015
6446.04
3134 OH-1
- 93016
6446.01
3134 OH-1

CONSTITUTION AVENUE

(120' PUBLIC ROW)
 PLAT BOOK V-3 PAGE 169

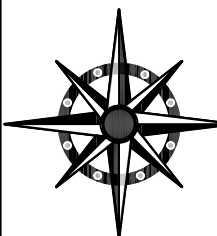

COMPASS SURVEYING & MAPPING, LLC
 3249 WEST CAREFREE CIRCLE
 COLORADO SPRINGS, CO 80917
 719-354-4120
 WWW.CSAMLLC.COM

AS-CONSTRUCTED
 August 04, 2022

UPLAND FLATS BY WATERMARK
 CITY OF COLORADO SPRINGS,
 EL PASO COUNTY, COLORADO

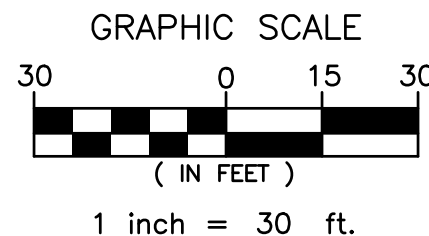

PROJECT NO.	21264
DATE:	SEPTEMBER 7, 2022
DRAWN BY:	TB
CHECKED BY:	DRH
SHEET:	1 OF 3

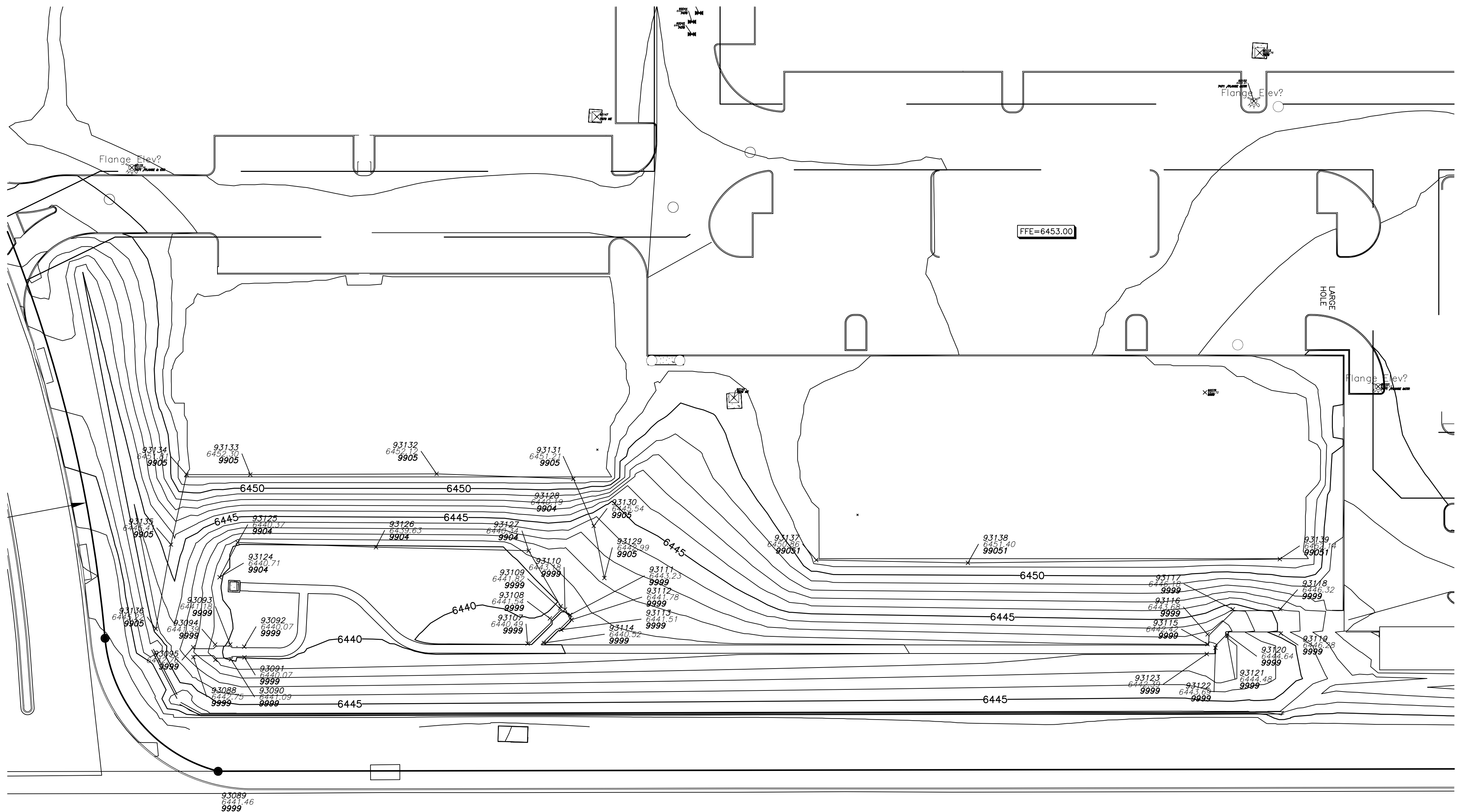

CONSTITUTION AVENUE

(120' PUBLIC ROW)
PLAT BOOK V-3 PAGE 169

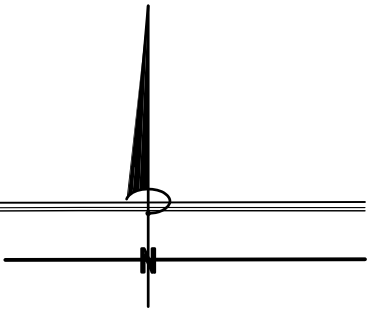



COMPASS SURVEYING & MAPPING, LLC
 3249 WEST CAREFREE CIRCLE
 COLORADO SPRINGS, CO 80917
 719-354-4120
 WWW.CSAMLLC.COM

AS-CONSTRUCTED
August 04, 2022

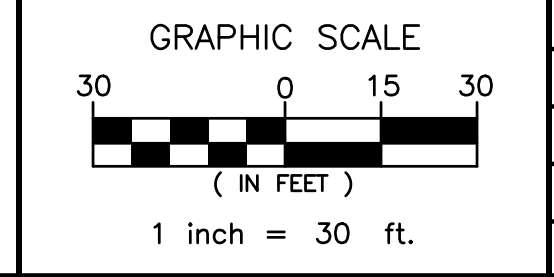
UPLAND FLATS BY WATERMARK
 CITY OF COLORADO SPRINGS,
 EL PASO COUNTY, COLORADO

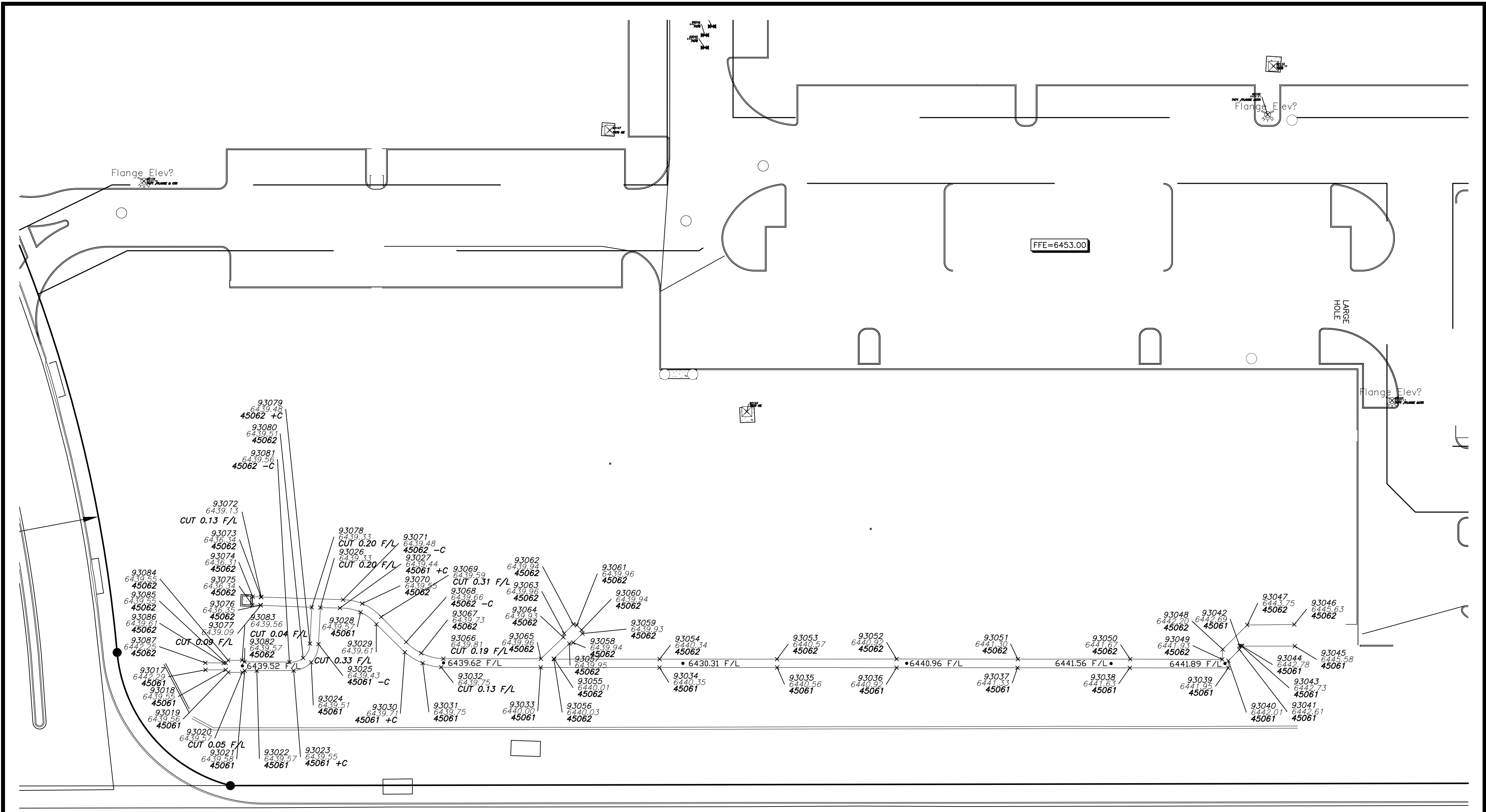

PROJECT NO.	21264
DATE:	SEPTEMBER 7, 2022
DRAWN BY:	TB
CHECKED BY:	DRH
SHEET:	2 OF 3



CONSTITUTION AVENUE

(120' PUBLIC ROW)
PLAT BOOK V-3 PAGE 169



COMPASS SURVEYING & MAPPING, LLC
3249 WEST CAREFREE CIRCLE
COLORADO SPRINGS, CO 80917
719-354-4120
WWW.CSAMLLC.COM

AS-CONSTRUCTED
August 04, 2022

UPLAND FLATS BY WATERMARK
CITY OF COLORADO SPRINGS,
EL PASO COUNTY, COLORADO

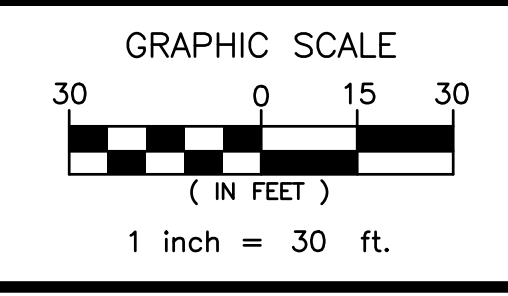

PROJECT NO.	21264
DATE:	SEPTEMBER 7, 2022
DRAWN BY:	TB
CHECKED BY:	DRH
SHEET:	3 OF 3

