

Form No. GWS-11 8/2007

STATE OF COLORADO OFFICE OF THE STATE ENGINEER 818 Centennial Bldg., 1313 Sherman St., Denver CO 80203 Phone - Info: (303) 866-3587 Main: (303) 866-3581 Fax: (303) 866-3589 http://www.water.state.co.us

For Office Use Only

CHANGE IN OWNERSHIP/ADDRESS CORRECTION OF THE WELL LOCATION

RECEIVED

OCT 20 2010

WATER RESOURCES STATE ENGINEER COLO

Review instructions on the reverse side prior to completing the form.

Name, address and phone of the person claiming ownership of the well:

NAME(S): Richard G. Haberman Mailing Address: 4015 E. Blaney Rd City, St. Zip: Peyton, CO 80831 Phone () -

0451577

This form is filed by the named individual/entity claiming that they are the owner of the well permitted as referenced above. This filing is made pursuant to C.R.S. 37-90-143.

WELL LOCATION: Well Permit Number: 221785 Receipt Number: County El Paso Well Name or # (optional) 221785 4015 E. Blaney Rd Peyton CO 80831 (Address) (City) (State) (Zip) 1/4 of the 1/4, Sec. Twp. N. or S., Range E. or W., P.M. Distance from Section Lines: Ft. From N. or S., Ft. From E. or W. Line. Subdivision Name Corral Ranches Fil 07 Lot Block Filing/Unit

The above listed owner(s) say(s) that he, she (they) own the well described herein. The existing record is being amended for the following reasons:

Change in name of owner Change in mailing address Correction of location for exempt wells permitted prior to May 8, 1972 and non-exempt wells permitted before May 17, 1965.

Please see the reverse side for further information regarding correction of the well location.

I (we) claim and say that I (we) (are) the owner(s) of the well described above, know the contents of the statements made herein, and state that they are true to my (our) knowledge.

Signature(s) of the new owner Please print the Signer's Name & Title Date 10-15-10

It is the responsibility of the new owner of this well to complete and sign the form. Signatures of agents are acceptable if an original letter of agency signed by the owner is attached to the form upon its receipt.

For Office Use Only

ACCEPTED AS A CHANGE OF OWNERSHIP AND/OR MAILING ADDRESS

State Engineer

By

Date 09/07/2011

221785

0451573

Public Record Property Information

Database Updated: 05/25/2010 Today: Wednesday, September 07, 2011 Time: 3:48:38 PM

Personal Information

Schedule No: 4300000469

Owner Name: HABERMAN ROBERT G

Location: 4015 E BLANEY RD

Mailing Address: 4015 E BLANEY RD
PEYTON CO 80831-7737**Previous Parcel****Replaced Parcel****Legal Description**

PT OF NW4 SEC 29-13-64 DES AS FOLS: COM AT NW COR OF
SD SEC 29, TH S 00<08'56" W ALG W LN OF SD SEC 29 A
DIST OF 1276.56 FT FOR POB, S 89<48'14" E 1262.52 FT,
S 03<22'54" W 1277.11 FT, N 89<48'14" W 1190.50 FT TO
A PT ON W LN OF SEC 29, TH N 00<08'56" E 1275.14 FT TO
POB, EX WLY 30 FT IN RD

Market Information (2011 Values)

Levy Year: 2010 Mill Levy: 63.859 Exempt Status: Not Exempt

Table	Use Code	2011 Market Value	2011 Assessed Value	Exempt
Land	SINGLE FAMILY RES.	\$120,000	\$9,550	
Land	WELL AND SEPTIC	\$5,000	\$400	
Imp	FRAME GOOD QUALITY	\$207,745	\$16,540	
	Total Value	\$332,745	\$26,490	

Tax Entity and Levy Information

(District: SCF)

Taxing Entity	Contact Name	Contact Phone
EL PASO COUNTY	COUNTY OFFICE BUILDING	(719) 520-6498
EPC ROAD & BRIDGE (UNSHARED)		(719) 520-6498
FALCON SCHOOL NO 49	BRETT RIDGWAY	(719) 495-1130
PIKES PEAK LIBRARY	MIKE VARNET	(719) 531-6333
UPPER BLK SQUIRREL CRK GROUND WATER	TRACY DORAN	(719) 347-0704
EL PASO COUNTY CONSERVATION	MADELINE NEWELL	(719) 473-7104
FALCON FIRE DISTRICT	TRENT HARWIG	(719) 495-4050

Sale Information

Seq #	Sale Date	Sale Price	Sale Type
-------	-----------	------------	-----------

WELL PERMIT NUMBER 221785
DIV. 8 WD 10 DES. BASIN 04 MD 12

APPLICANT

KARA KLIEWER
270 PECK CT
SECURITY, CO 80911-

(719) 392-5706

APPROVED WELL LOCATION

EL PASO COUNTY
SW 1/4 NW 1/4 Section 29
Township 13 S Range 64 W Sixth P.M.

DISTANCES FROM SECTION LINES

1776 Ft. from North Section Line
682 Ft. from West Section Line

PERMIT TO CONSTRUCT A WELL

CONDITIONS OF APPROVAL

- 1) This well shall be used in such a way as to cause no material injury to existing water rights. The issuance of this permit does not assure the applicant that no injury will occur to another vested water right or preclude another owner of a vested water right from seeking relief in a civil court action.
- 2) The construction of this well shall be in compliance with the Water Well Construction Rules 2 CCR 402-2, unless approval of a variance has been granted by the State Board of Examiners of Water Well Construction and Pump Installation Contractors in accordance with Rule 18.
- 3) Approved pursuant to CRS 37-90-105 as one well used for domestic purposes and in one commercial business described as a kennel. The commercial business must meet the qualifications as defined in CRS 37-90-105(1)(c)(II). Use of this well in a commercial business having another small capacity commercial well is prohibited unless a new permit to use this well is granted.
- 4) The maximum pumping rate of this well shall not exceed 15 GPM.
- 5) The annual withdrawal of ground water from this well shall not exceed 1 acre-foot.
- 6) Production is limited to the Denver aquifer which is located 130 feet below land surface and extends to depth of 680 feet. Plain casing must be installed and grouted to prevent the withdrawal of ground water from other aquifers and the movement of ground water between aquifers.
- 7) A totalizing flow meter must be installed on this well and maintained in good working order. Permanent records of all diversions must be maintained by the well owner (collected at least annually) and submitted to the Upper Black Squirrel Ground Water Management District and the Division of Water Resources upon request.
- 8) This well must be constructed within 300 feet of the location specified on this permit.
- 9) This permit has been approved with a change to the permit application form from that applied for by the applicant. You are hereby notified that you have the right to appeal the issuance of this permit, by filing a written request with this office within sixty (60) days of the date of issuance, pursuant to the State Administrative Procedures Act. (See Section 24-4-104 through 106, C.R.S.)

NOTE: Noncompliance with the procedures outlined in the attached information sheet (form GWS-5) may void your well permit.

NOTE: The ability of this well to withdraw its authorized amount of water from this non-renewable aquifer may be less than the 100 years upon which the amount of water in the aquifer is allocated, due to anticipated water level declines.

APPROVED
EBT

Neil D. Simpson
State Engineer

William H. Franzel
By

Receipt No. 0451573

DATE ISSUED **NOV 09 1999**

EXPIRATION DATE **NOV 09 2001**

FORM NO.
GWS-32
10/84

PUMP INSTALLATION AND TEST REPORT
STATE OF COLORADO, OFFICE OF THE STATE ENGINEER

For Office Use only

RECEIVED

MAY 30 2000

WATER RESOURCES
STATE ENGINEER
COLO.

1. WELL PERMIT NUMBER 221785
2. OWNER NAME(S) KARA KLIEWER
Mailing Address 270 PECK CT.
City, St. Zip SECURITY CO 80911
Phone (719) 392-5766

3. WELL LOCATION AS DRILLED: SW 1/4 NW 1/4, Sec. 29 Twp. 13 S, Range 64 W
DISTANCES FROM SEC. LINES:
1776 ft. from North Sec. line. and 682 ft. from West Sec. line.
(north or south) (east or west)
SUBDIVISION: LOT _____ BLOCK _____ FILING(UNIT) _____
STREET ADDRESS AT WELL LOCATION: 4215 E. BLANEY Rd.

4. PUMP DATA: Type SUBMERSIBLE Installation Completed 5/6/00
Pump Manufacturer Goulds Pump Model No. 1DLS15412
Design GPM 10 at RPM 3450, HP 1.5, Volts 230, Full Load Amps 11.6
Pump Intake Depth 280 Feet, Drop/Column Pipe Size 1" inches, Kind PVC
ADDITIONAL INFORMATION FOR PUMPS GREATER THAN 50 GPM:
TURBINE DRIVER TYPE: Electric Engine Other _____
Design Head _____ feet, Number of Stages _____, Shaft size _____ inches.

5. OTHER EQUIPMENT:
Airline Installed Yes No, Orifice Depth ft. _____ Monitor Tube Installed Yes No, Depth ft. _____
Flow Meter Mfg. MASTER Meter Serial No. 2627907
Meter Readout Gallons, Thousand Gallons, Acre feet, Beginning Reading D

6. TEST DATA: Check box if Test data is submitted on Supplemental Form.
Date 5-6-00
Total Well Depth 315 Time _____
Static Level 145 Rate (GPM) 11
Date Measured 1-5-00 Pumping Lvl. 280

7. DISINFECTION: Type HTH Amt. Used 60Z.

8. Water Quality analysis available. Yes No

9. Remarks _____

10. I have read the statements made herein and know the contents thereof, and that they are true to my knowledge.
[Pursuant to Section 24-4-104 (13)(a) C.R.S., the making of false statements herein constitutes perjury in the second degree and is punishable as a class 1 misdemeanor.]

CONTRACTOR KUNAU Drilling & Exc Phone (719) 683-3720 Lic. No. 1148
Mailing Address 23945 LUCKINLANE CATHAN CO 80808

Name/Title (Please type or print) TIM KUNAU-OWNER Signature Tim Kunau Date 5-16-00

WELL CONSTRUCTION AND TEST REPORT
 STATE OF COLORADO, OFFICE OF THE STATE ENGINEER
 1313 Sherman St., Rm 618, Denver, CO 80203

For Office Use only

RECEIVED

MAR 27 2000

WATER RESOURCES
 STATE ENGINEER
 COLO.

1. WELL PERMIT NUMBER 221785

2. OWNER NAME(S) Kara Kliewer
 Mailing Address 270 Rock Ct
 City, St. Zip Security, Co 80911
 Phone (719) 392-5706

3. WELL LOCATION AS DRILLED: SW 1/4 NW 1/4, Sec. 29 Twp. 13 S, Range 64W 6th PM
 DISTANCES FROM SEC. LINES:
1776 ft. from North Sec. line. and 682 ft. from West Sec. line. OR
(north or south) (east or west)
 SUBDIVISION: _____ LOT _____ BLOCK _____ FILING(UNIT) _____
 STREET ADDRESS AT WELL LOCATION: 4215 E Blaney Rd

4. GROUND SURFACE ELEVATION _____ ft. DRILLING METHOD Air Rotary
 DATE COMPLETED 1-5-00 TOTAL DEPTH 315 ft. DEPTH COMPLETED 315 ft.

5. GEOLOGIC LOG:

Depth	Description of Material (Type, Size, Color, Water Location)
0-50	Sand Clay
50-75	Sand/cl
75-160	Clay Shale
160-215	Sand/cl
215-230	Clay
230-242	Gravel Sand/cl
242-315	Sand Clay Shale

REMARKS:

6. HOLE DIAM. (in.)

From (ft)	To (ft)
0	20
20	90
90	315

7. PLAIN CASING

OD (in)	Kind	Wall Size	From (ft)	To (ft)
6.3	Steel	188	1	20
4.2	PVC	200psi	15	135

PERF. CASING: Screen Slot Size: 5 holes
 4.2 PVC 200psi 135-315

8. FILTER PACK:
 Material Gravel
 Size 4"
 Interval 19-95

9. PACKER PLACEMENT:
 Type Rubber
 Depth 135'

10. GROUTING RECORD:

Material	Amount	Density	Interval	Placement
cement	2 sacks	129gal	6-20	pourad
cement	4 sacks	24gal	95-135	trimmie

11. DISINFECTION: Type HTH Amt. Used 6 oz

12. WELL TEST DATA: Check box if Test Data is submitted on Form No. GWS 39 Supplemental Well Test.
 TESTING METHOD Diaped
 Static Level 145 ft. Date/Time measured _____, Production Rate 15 gpm.
 Pumping level 270 ft. Date/Time measured _____, Test length (hrs.) 4
 Remarks _____

13. I have read the statements made herein and know the contents thereof, and that they are true to my knowledge. [Pursuant to Section 24-4-104 (13)(e) C.R.S., the making of false statements herein constitutes perjury in the second degree and is punishable as a class 1 misdemeanor.]

CONTRACTOR Kunau Drilling LLC Phone (719) 683-3920 Lic. No. 1148
 Mailing Address 23945 LUCKY 2ND CALHAN CO 80808

Name/Title (Please type or print) Tim Kunau/Owner Signature Tim Kunau Date 2-23-00

RECEIVED

OCT 19 1999

WATER RESOURCES
STATE ENGINEER
COLO.

RECEIVED

SEP 29 1999

WATER RESOURCES
STATE ENGINEER

Item 5 (Tract on which well will be located).

Legal Description of Tract

THAT PART OF THE NORTHWEST ¼ OF SECTION 29, TOWNSHIP 13 SOUTH, RANGE 64 WEST OF THE 6TH P.M., COUNTY OF EL PASO, STATE OF COLORADO BEING MORE PARTICULARLY DESCRIBED AS FOLLOWS:

COMMENCING AT THE NORTHWEST CORNER OF SAID SECTION 29, THENCE S00°08'56"W ALONG THE WEST LINE OF SAID SECTION 29, A DISTANCE OF 1276.56 FEET TO THE TRUE POINT OF BEGINNING; THENCE S89°48'14"E AND PARALLEL TO THE NORTH LINE OF SAID SECTION 29, A DISTANCE OF 1262.52 FEET; THENCE S03°22'54"W A DISTANCE OF 1277.11 FEET; THENCE N89°48'14"W AND PARALLEL TO SAID NORTH LINE OF SECTION 29 A DISTANCE OF 1190.50 FEET TO A POINT ON THE WEST LINE OF SAID SECTION 29; THENCE N00°08'56"E ALONG SAID WESTERLY LINE OF SAID SECTION 29 A DISTANCE OF 1275.14 FEET TO THE TRUE POINT OF THE BEGINNING, EXCEPT THE WESTERLY 30 FEET IN ROAD.

ALL BEARINGS ARE RELATIVE TO THE EAST LINE OF THE SOUTHWEST ¼ OF SAID SECTION 29 BEING N03°22'08"E PER THE SUBDIVISION PLAT OF CORRAL RANCHES SUBDIVISION FILING NO. 7 AS RECORDED IN BOOK U-3 AT PAGE 21 OF THE EL PASO COUNTY RECORDS.

Item 6 (Use of Well)

The well will serve two purposes:

- 1) Well will be source of water for a commercial boarding kennel for dogs/cats on the same property. Kennel will be approximately 3,800 – 5000 sq feet. Water will be needed for cleaning, grooming, and drinking.
- 2) Well will also be source of water for residential home (one single family home) on same property. Water will be for in-home use and small lawn/garden.

Item 8 (Land on which ground water will be used)

The land areas on which the ground water will be used include the kennel and single family home with lawn/garden area. Total land area will be approximately 1 acre (of the 35.9 acres described in legal description above).

OCT 19 1999

WATER RESOURCES
STATE ENGINEER
COLO.

Detailed Breakdown of Water Usage

Kennel Usage

Drinking Water*	1.5 gal X 50 animals X 365 days/year =	27,375 gal
Cleaning*	20 gal X 50 runs X 365 days/year =	365,000 gal
Laundry		= 10,000 gal
Grooming**	20 gal X 2,000 animals/year =	40,000 gal

Single Family Dwelling

Domestic Use		= 14,500 gal
Irrigation	For 3,000 sq.ft: 3 X 2,100 gal/year =	6,300 gal

Total = 463,175gal
= 1.42 acre feet

* Figures based on a 50 run kennel

** Kennel will only groom boarded dogs. I estimate approximately 2,000 dogs will be groomed per year.

SUPPLEMENTAL INFORMATION FOR SMALL CAPACITY
COMMERCIAL WELL PERMIT APPLICATIONS
INSIDE DESIGNATED GROUND WATER BASINS
Division of Water Resources
818 Centennial Building
1313 Sherman St., Denver, CO 80203

RECEIVED
OCT 19 1999

WATER RESOURCES
STATE ENGINEER
COLO.

APPLICANT:

RECEIPT NO.:

Your application is being evaluated pursuant to the provisions of CRS 37-90-105, which allows for one well used in one commercial business. **If a permit is granted, the use of this proposed well in a commercial business having another small capacity commercial well will be prohibited.** The supplemental information requested in this form is necessary in order to determine whether your application qualifies within the provisions of this statute.

INSTRUCTIONS: Please type or print using black ink. Answer the following questions in the spaces provided. If additional space is needed, identify the question number on a separate sheet, then attach it to this form. This form must be signed and dated below.

1. Will you own and operate this proposed well and the business that this well is to serve? If not, please explain who will own and operate this well and the business to be served.

Yes.

2. Do you currently have a valid permit for any other small capacity commercial well inside the Designated Basins? If so, please provide the permit number(s) of any valid permits you have.

No.

I (we) have read the statements made herein, know the contents thereof, and state that they are true to my (our) knowledge. [Pursuant to Section 24-4-104 (13)(a) C.R.S., the making of false statements herein constitutes perjury in the second degree and is punishable as a Class 1 misdemeanor.]

Name/Title (print or type): Kara L. Kliever

Signature: Kara L. Kliever Date: 10-16-99

RECEIVED
OCT 19 1999

WATER RESOURCES
STATE ENGINEER
COLO.

Plot of Parcel - 35.9 AC

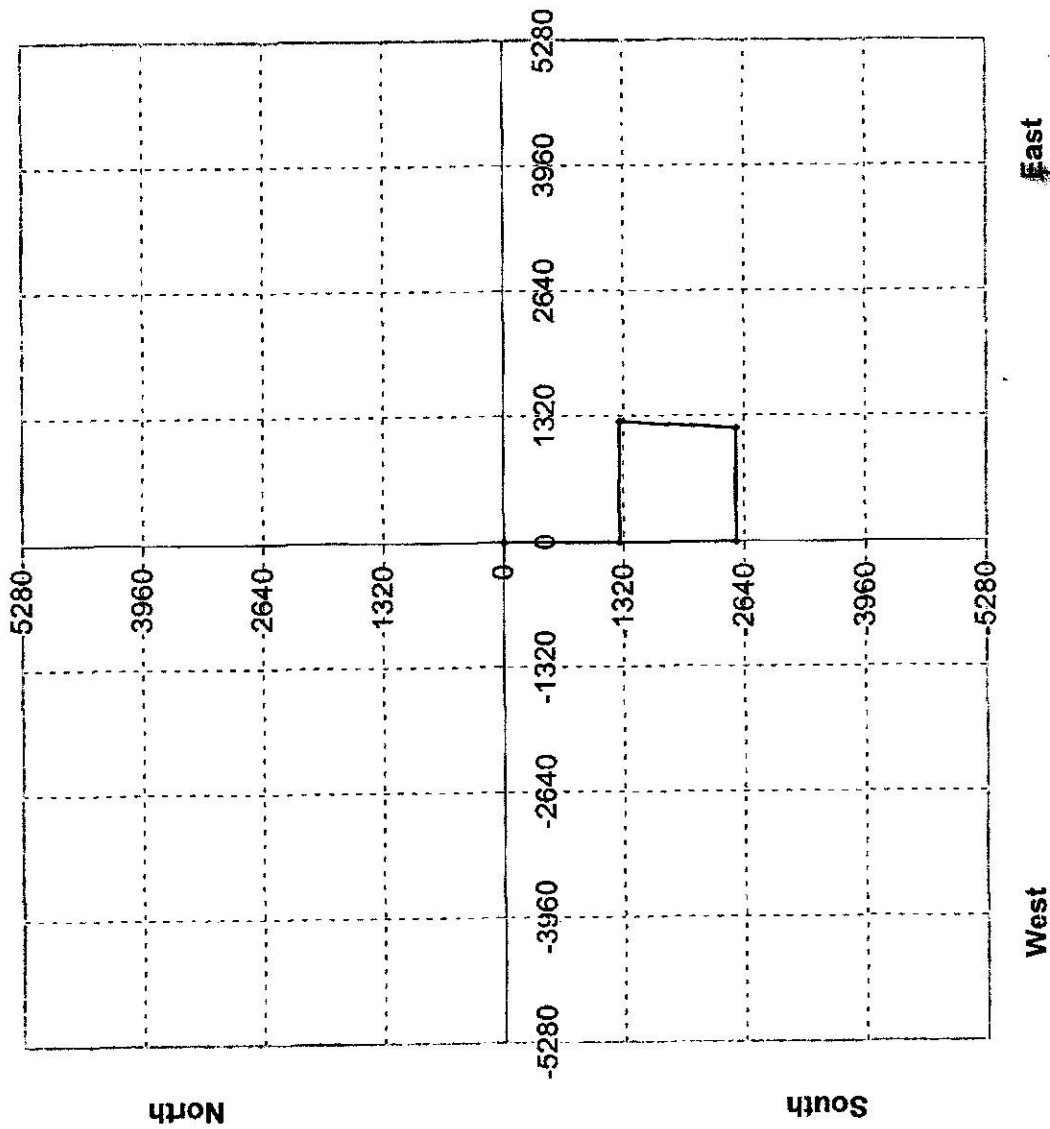

STATE OF COLORADO

OFFICE OF THE STATE ENGINEER
Division of Water Resources
Department of Natural Resources

1313 Sherman Street, Room 818
Denver, Colorado 80203
Phone: (303) 866-3581
FAX: (303) 866-3589

<http://water.state.co.us/default.htm>

RECEIVED

OCT 19 1999

WALTER S. SUNDLES
STATE ENGINEER
COLO.



Bill Owens
Governor

Greg E. Walcher
Executive Director

Hal D. Simpson, P.E.
State Engineer

10/07/99

Kara Kliewer
270 Peck Crt.
Security, CO 80911

Re: Commercial Well Permit Application, Receipt no. 451573

Dear Ms. Kliewer

I am returning your application for additional information. The Supplemental Information For Small Capacity Commercial Well Permit Applications Inside Designated Ground Water Basins form is required as part of a commercial well application, as is a detailed breakdown of intended water uses. Unfortunately, our office has little background information on water consumption within a dog and cat kennel. Therefore, in this case, a rudimentary breakdown should suffice. The breakdown is necessary, because the breakdown helps determine the annual withdrawal (see application, section 7). All commercial wells are required to have meters. The information we have indicates that the greatest consumption comes from animal watering and pen and run cleaning. Make your calculation with a full kennel in mind. Our records have these principle consumption rates: The average dog consumes 1.5 gallons of water a day. A cement-floored run takes two to five minutes to wash down with an average hose producing five gallons a minute (10-25 gals per run per wash). These are rough averages, please include, within reason, the estimations and uses that best suit the set-up of your kennel. Uses such as domestic and irrigation should be included (average single family dwelling uses 14,500 gals. /year, irrigation equals 2,100 gals per 1,000 sq. ft. per year). For the conversion to acre-feet, use 325,850 gallons per acre-foot. Please attach the requested documents and return the application to this office for evaluation. If you have any questions please call me at (303) 866-3581.

Sincerely,

Eric Thorman
Water Resource Specialist
Designated Basins

Ebt/kliewerK.ltr

RECEIVED

OCT 19 1999

Enclosed is the <sup>WATER RESOURCES
STATE ENGINEER</sup> additional
information as you
requested.

Thanks for the information
on water consumption for
kennels and domestic use.

LOCATION: SW1/4 OF NW1/4 OF SEC. 29, T.13S., R.64W. (1776 NSL, 682 WSL)

LOCATION IS WITHIN THE UPPER BLACK SQUIRREL DESIGNATED GROUND WATER BASIN
 Ground Elevation: 6700 Number of Acres: 35.9

AQUIFER	ELEVATION		NET SAND	DEPTH TO		ANNUAL APPROP A-F	STATUS
	BOT.	TOP		BOT.	TOP		
UPPER DAWSON	----	----	----	----	----	----	----
LOWER DAWSON	----	----	----	----	----	----	----
DENVER	6019	6568	169.6	681	132	10.35	NNT
UPPER ARAPAHOE	5527	6003	211.6	1173	697	12.92	NNT
LOWER ARAPAHOE	----	----	----	----	----	----	----
LARAMIE-FOX HILLS	4864	5140	215.0	1836	1560	11.58	NT

note: E indicates location is at aquifer boundary and values may be more approximate.

Permit Application Change Form

To be used when issuing well permits based upon information other than as received. Please file with final Permit

Receipt No. 451573

Name of Applicant Kara Kliewer

Summary of change(s):

Section 7: Annual withdrawal reduced to 1.0 Af
per @WMD rules

Date 10/29/99

Signed E. Thomas

Print Name Eric Thomas