

Key  
Wall Light

**NOTE:** The full building plan sets, to include MEP, are not yet completed. The applicant is waiting until after the initial review of the so that it can be determined there are no changes that need to be made to the building layout. All lights are wall-mounted lights are integrated into the building. The photometric plan will be submitted with review 2.

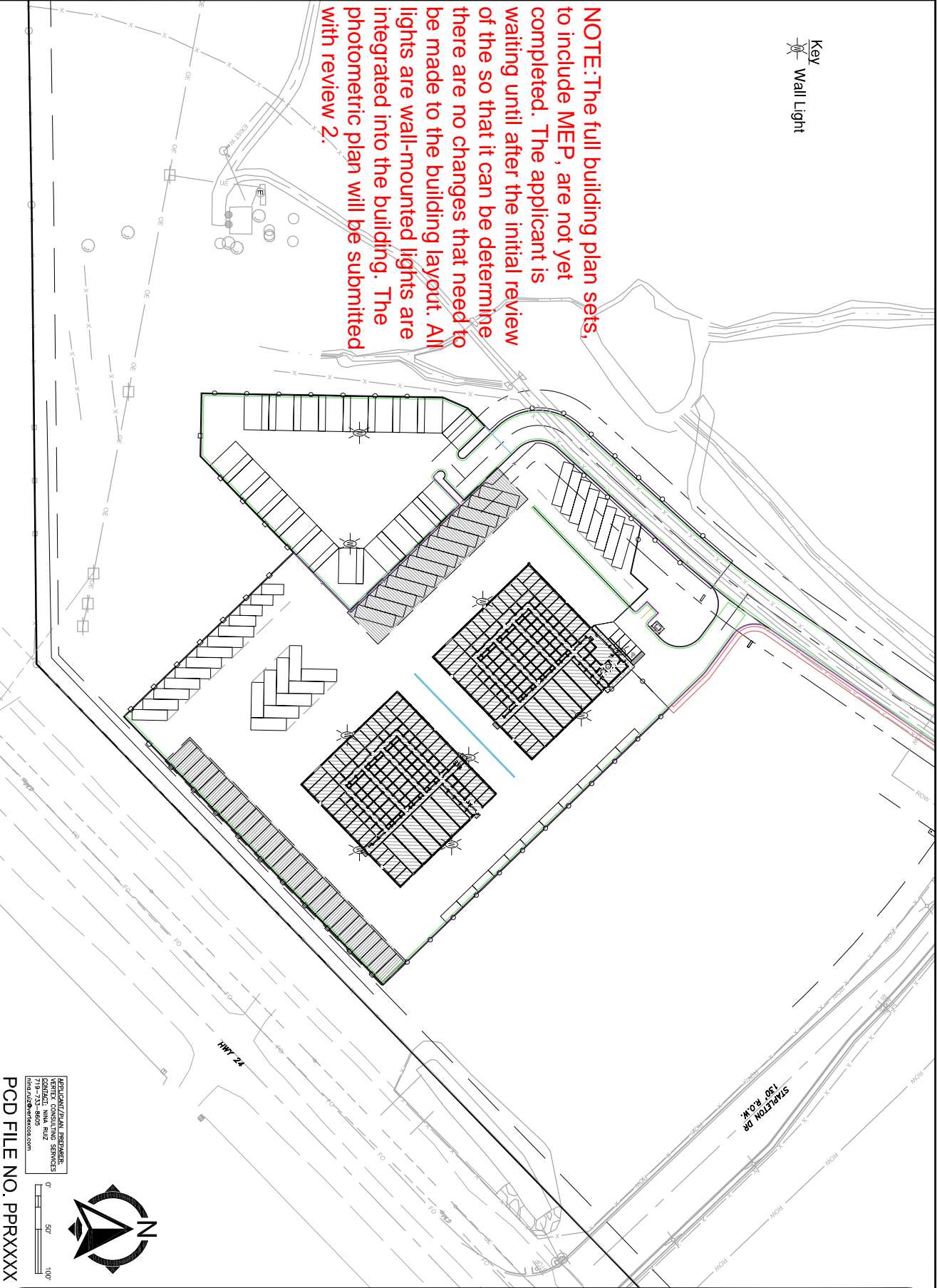

APRIL/DAVID/RYAN BREIDENBACH  
 VERTX CONSULTING SERVICES  
 444 E. Highway 24  
 Colorado Springs, Colorado 80905  
 719-573-8605  
 info@vertxconsulting.com

PROJECT NO. SHEET  
 DATE 11/16/23  
 P1  
 PREPARED BY  
 APPROVED  
 CMB

PCD FILE NO. PPRXXXX



GENERAL NOTES

FOR REVIEW

NO.	REVISION/ISSUE	DATE

THE ONEIL GROUP CO.  
 4WAY COMMERCIAL  
 LIGHTING PLAN

VERTX Consulting Services  
 444 E. Highway 24  
 Colorado Springs, Colorado 80905  
 719-573-8605

# LARGE SLIM PROFILE WALL PACK



## OUTDOOR

- ### FEATURES
- Bronze die-cast aluminum housing with hinged front frame
  - Custom and factory select colors available (Contact factory for pricing)
  - 1/2" coin plug with o-rings for condensation protocol
  - Tempered glass lens
  - Type III (WPL-P-50W), Type II (WPL-P-80W)
  - 100% recyclable housing
  - 4000K and 5000K CCT
  - 120-277V Universal Voltage
  - 5 Year Warranty
  - ETL Listed for Wet Location
  - DesignLights Consortium® Qualified Luminaire



### SUITABLE APPLICATIONS

- Parking Lots
- Buildings
- General Area Lighting
- Wet Wash
- Walkways



### LED SYSTEMS INFORMATION

Calculated L <sub>90</sub> (TM-21)	50W	80W	50W	80W
Delivered Lumens	>100K	>100K	>100K	>100K
Total Input Watts	51 W	77 W	53 W	78 W
Luminaire Efficacy Rating (LER)	98 lm/W	106 lm/W	94 lm/W	102 lm/W
Correlated Color Temperature (CCT)	4000K	4000K	5000K	5000K
Color Rendering Index (CRI)	>80	>80	>70	>70
Maximum Ambient Temperature	105 F	115 F	105 F	115 F
Universal Driver	120-277 V	120-277 V	120-277 V	120-277 V

LED System data shown based on WPL-P-50WLED-UNIV-400K, WPL-P-80WLED-UNIV-400K, WPL-P-50WLED-UNIV-5000K & WPL-P-80WLED-UNIV-5000K  
LED System Performance Curves based on 100% inspection for high failure at 25 C ambient.

### PHOTOMETRIC REPORTS

#### WPL-P-50WLED-UNIV-40

**SUMMARY DATA**

HEIGHTS TESTED: 80ft  
 EFFICIENCY (delivered light): 98.6 lm/W  
 EFFICIENCY (input power): 98.6 lm/W  
 BEAM ANGLE (at 100 ft): 17.9°  
 BEAM CLASSIFICATION: Type III, Very Sharp  
 CUTOFF CLASSIFICATION: Cutoff  
 LUMENS: 4183  
 INPUT WATTS: 48.6

**CANDELA PLOT**

Photometric values based upon data performed in compliance with IES LM-79  
 Candela (Cd) at 100 ft: 231

#### WPL-P-80WLED-UNIV-40

**SUMMARY DATA**

HEIGHTS TESTED: 80ft  
 EFFICIENCY (delivered light): 98.7 lm/W  
 EFFICIENCY (input power): 98.7 lm/W  
 BEAM ANGLE (at 100 ft): 17.9°  
 BEAM CLASSIFICATION: Type III, Very Sharp  
 CUTOFF CLASSIFICATION: Cutoff  
 LUMENS: 6918.7  
 INPUT WATTS: 70.4

**CANDELA PLOT**

Photometric values based upon data performed in compliance with IES LM-79  
 Candela (Cd) at 100 ft: 388

### GENERAL NOTES

FOR REVIEW	
NO.	REVISION/ISSUE

THE ONEIL GROUP CO.  
4-WAY COMMERCIAL  
LIGHTING PLAN



PROJECT NO.	DATE	REVISION	APPROVED
	11/10/23		

P2

APPROVAL/SIGNATURE  
 VERTEX CONSULTING SERVICES  
 401 E. UNIVERSITY BLVD.  
 COLORADO SPRINGS, CO 80903  
 719-333-8605  
 info@vertexconsulting.com

PCD FILE NO. PPRXXXX

