

# CREEKSIDE AT LORSON RANCH FILING No. 1 Fire Protection Report

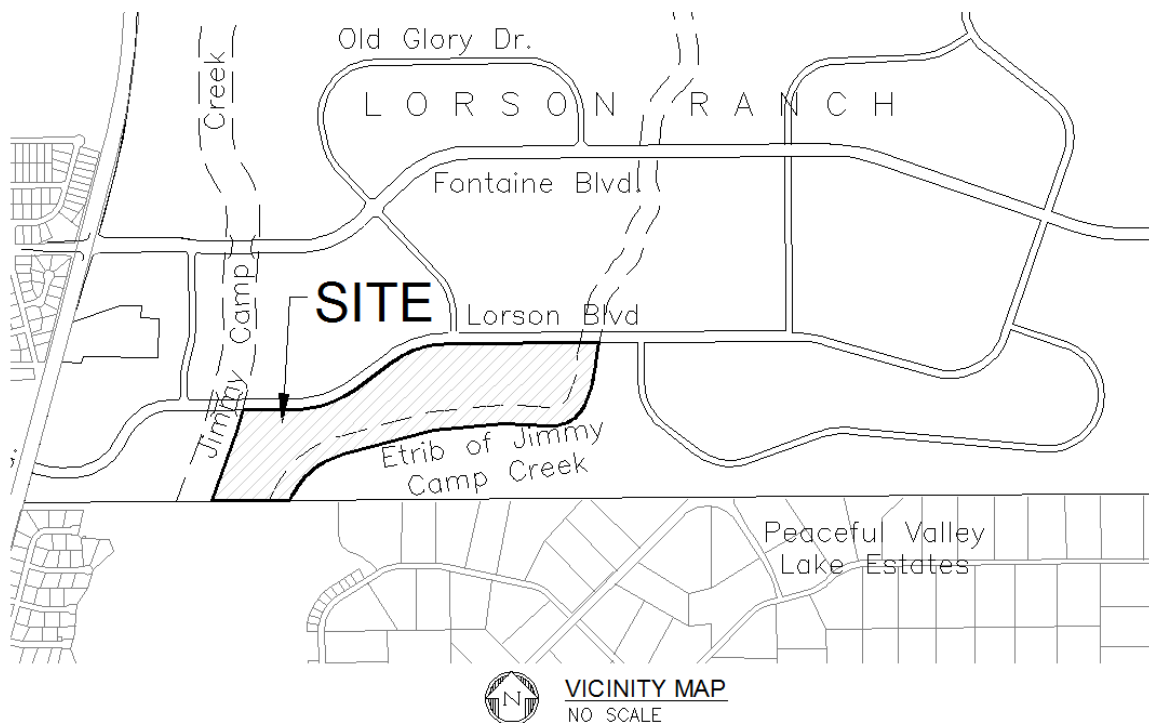

## Site Location, Size, Zoning:

The site is 83.088 acres and proposes 235 single family lots located within the central portion of Lorson Ranch in southeastern El Paso County. The project lies east of the Jimmy Camp Creek and south of Lorson Boulevard. This filing will be a continuation of the Lorson Ranch Development as a PUD Development Plan/ Preliminary Plan (PUDSP 18-005) was approved and recorded on February 21, 2019, Reception No. 219020279. There are no existing structures on the site. There are several underground facilities currently owned and maintained by Widefield Water and Sanitation District including sanitary sewer and watermain. In addition, the existing FMIC (Fountain Mutual Irrigation Company) easement crosses the property on the west side which shall remain in place. The design of the Creekside development project takes this into account and will cause little to no impact on these underground facilities.

**Fire Protection Report:**

The Creekside at Lorson Ranch Filing No. 1 development lies within the protection of the Security Fire Department. Founded in 1956, the early Security Fire Department years were a volunteer department only. With the growth of the Fountain/ Security/ Widefield area, the department has also grown to currently staff 21 career Firefighters with an additional 25 Volunteers. The Security Fire Department is currently averaging 3,500 calls a year. The fire department is assisted by the El Paso County Sheriff's office who aids in dispatching and through Action Care Ambulance which is contracted by Security Fire Department.

Security Fire Department operations include 5 Fire Engines, 1 Ladder Truck, 3 Ambulances, 1 Utility Truck, 1 Brush Truck, and 1 Chief's Vehicle. The department staffs 3 Engines and 2 Engineers, with an added volunteer at each station at night. The Engineers are trained to be capable with all the engines as well as other station apparatus and equipment. Each station provides a secondary vehicle depending on the type of fire reported. During a wildland fire call for example, District 2 would respond with the brush truck while District 1 and District 3 would respond with their Engines. If there is a structure fire, District 1 would respond with the Ladder truck and District 2 and 3 would respond with their engines and so on.

The Security Fire Department currently has three stations:

- **Station 1:**
  - Located at 400 Security Blvd. and is just over 6 miles to the Lorson Ranch East project site.
  - Houses the Chief and all offices.
  - Station 1 contains the Chief's Vehicle, Utility 151, Ladder 131, Engine 114, and Medic 181
- **Station 2:**
  - Located at 7420 Metropolitan St. and is 5 miles from the Lorson Ranch East project site. This is the closest station.
  - Station 2 is the smallest out of the three.
  - Station 2 has the Brush-143, Engine-111 and Engine-110.
- **Station 3:**
  - Located at 5110 Bradley Rd. and is 9.5 miles from the project site. This station is the furthest from the project.
  - Station 3 is the newest station out of the three and has the only drive thru bay.
  - Station 3 has Engine 113, Engine-115 and Medic-183

The Creekside at Lorson Ranch project is considered a low risk area for wildfire as the site is primarily native grassland or improved development areas. There are no existing stands of trees on the proposed site.

A new fire station is not being requested by the fire department nor being proposed by the developer within Lorson Ranch as the Security Fire Department has selected a site off of Mesa Ridge Parkway to the south for a new fire station to be built at a future time.