



EL PASO COUNTY

COMMISSIONERS:
STAN VANDERWERF (CHAIR)
CAMI BREMER (VICE-CHAIR)

COLORADO

HOLLY WILLIAMS
CARRIE GEITNER
LONGINOS GONZALEZ, JR.

COMMUNITY SERVICES DEPARTMENT

PARK OPERATIONS ~ JUSTICE SERVICES
ENVIRONMENTAL SERVICES ~ VETERANS SERVICES ~ RECREATION/CULTURAL SERVICES

March 3, 2021

Kari Parsons
Project Manager
El Paso County Development Services Department
2880 International Circle
Colorado Springs, CO 80910

Subject: Sterling Ranch Filing No. 2 Final Plat, Review #3 (SF-20-015)

Hello Kari,

The Park Operations Division of the Community Services Department has reviewed the Sterling Ranch Filing No. 2 Final Plat, Review #3, and has the following additional comments of behalf of El Paso County Parks:

This development application was first presented and reviewed in July 2018, under the File Number of SF-18-020. Because Final Plat application was resubmitted in June 2020 with a new File Number of SF-20-015, regional and urban park fees were recalculated to reflect the updated 2020 park fee schedule. The updated Subdivision Review Form is attached and lists the regional and urban park fees as **\$22,883** and **\$14,455**, respectively. Because the original Filing No. 2 Final Plat application was endorsed by the Park Advisory Board with no concessions, the current application, with no additional changes to dwelling unit numbers or total acreage, does not require renewed endorsement.

At this time, El Paso County Parks recommends that the applicant address the 25' trail easement located along the north side of Marksheffel Road, as recommended to and endorsed by the Park Advisory Board in February 2018. The trail easement is not shown on the submitted Final Plat, nor is it included in the Final Plat General Notes section. The additional 5' crusher fine trail is not depicted in the submitted Landscape Plans. These recommendations are highlighted below.

The original Sterling Ranch Filing No. 2 Final Plat development application, as well as the following comments and recommendations, was presented to and endorsed by the Park Advisory Board on February 14, 2018:

"This is a request by N.E.S., Inc. on behalf of SR Land, LLC, for approval of the Sterling Ranch Filing No. 2 Final Plat, which includes 49 single-family residential lots on 49.64 acres. The property is currently zoned RS-5000, and is located along Vollmer Road, near the intersection of Vollmer Road and Glider Port Road.

The 2013 El Paso County Parks Master Plan shows a branch of the Sand Creek Regional Trail impacted by this project. This branch, located along a proposed extension of Marksheffel Boulevard, will connect the primary alignment of the Sand Creek Regional Trail, located immediately east and adjacent the property along Sand Creek, to City of Colorado Springs trails located to the west of the project site. Furthermore, the proposed Vollmer Road Bicycle Route is located immediately west of the project location. A dedicated public right-of-way already exists along the aforementioned bicycle route, so no easement requests are necessary at that location; however, the applicant is



advised that multi-model transportation options will be developed within the rights-of-way in the future. The property is not located within any candidate open space land.

While the current application shows 6.86 acres of open space, dedicated to landscaping and utilities, the original Sterling Ranch Preliminary Plan, endorsed by the Park Advisory Board in April 2015, included 35 acres of open space, constituting 19.5% of the total project acreage. The El Paso County Planning Commission and Board of County Commissioner summaries for the approval of the Sterling Ranch Preliminary Plan also added requirements for the dedication to El Paso County of a 25-foot wide regional trail corridor along Sand Creek for the construction, maintenance, and public access of the Sand Creek Primary Regional Trail. This trail easement, Instrument #218054786, was dedicated to El Paso County in May 2018.

Staff recommends that the developer install a 5-foot wide gravel trail adjacent to the sidewalk on the proposed extension of Marksheffel Road on the street side to accommodate equestrians who may be accessing the Sand Creek Regional Trail from locations to the west, as well as dedicate to El Paso County a 25-foot wide trail easement for public access and maintenance of the trail. Staff also recommends fees in lieu of land dedication for regional and urban park purposes, the latter of which is required due to the fact that the original Preliminary Plan met the urban density requirements.

Recommended Motion:

Recommend to the Planning Commission and the Board of County Commissioners that approval of Sterling Ranch Filing No. 2 Final Plat includes the following conditions: (1) recommend the developer install a 5-foot wide gravel trail adjacent the sidewalk along Marksheffel Road; (2) show on the Final Plat and dedicate to El Paso County a 25-foot trail easement along the north side of Marksheffel Road that allows for public access, as well as maintenance by El Paso County of the western branch of the Sand Creek Primary Regional Trail; (3) require fees in lieu of land dedication for regional park purposes in the amount of **\$22,883 (updated 07/16/2020)** and urban park fees in the amount of **\$14,455 (updated 07/16/2020)**.”

Please feel free to contact me should you have any questions or concerns.

Sincerely,



Ross A. Williams
Park Planner
Park Operations Division
Community Services Department
rosswilliams@elpasoco.com

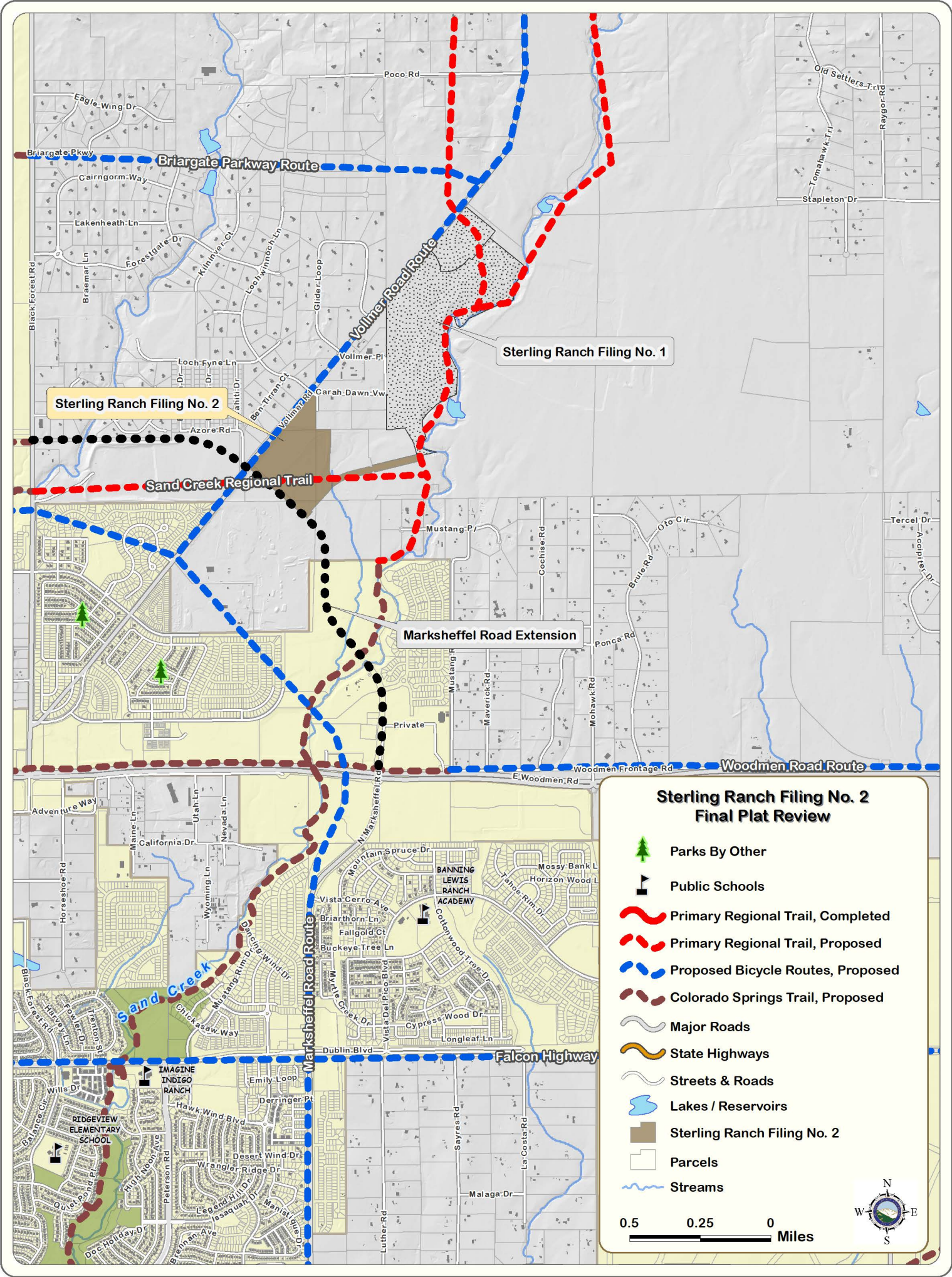

Sterling Ranch Filing No. 2

Sterling Ranch Filing No. 1

Marksheffel Road Extension

**Sterling Ranch Filing No. 2
Final Plat Review**

-  Parks By Other
-  Public Schools
-  Primary Regional Trail, Completed
-  Primary Regional Trail, Proposed
-  Proposed Bicycle Routes, Proposed
-  Colorado Springs Trail, Proposed
-  Major Roads
-  State Highways
-  Streets & Roads
-  Lakes / Reservoirs
-  Sterling Ranch Filing No. 2
-  Parcels
-  Streams

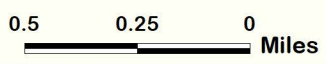

**Development
Application
Permit
Review**



COMMUNITY SERVICES DEPARTMENT

Park Operations - Community Outreach - Environmental Services
Veterans Services - Recreation / Cultural Services

July 16, 2020

Subdivision requirements referenced in Section 8.5.2 of the El Paso County Land Development Code. Fees are based on average land values within designated areas. See El Paso County Board of County Commissioners (BoCC) Resolution for fees established on an annual basis. The Park Advisory Board meets the second Wednesday of each month, 1:30 p.m., BoCC Auditorium, second floor of Centennial Hall, 200 South Cascade Avenue, Colorado Springs.

Name:	Sterling Ranch Filing No. 2 Final Plat	Application Type:	Final Plat
PCD Reference #:	SF-20-015	Total Acreage:	49.64
Applicant / Owner:	Owner's Representative:	Total # of Dwelling Units:	49
SR Land, LLC	NES, Inc.	Dwelling Units Per 2.5 Acres:	2.47
20 Boulder Crescent	Erin Ganaway	Regional Park Area:	2
Suite 102	619 North Cascade Avenue, Suite 200	Urban Park Area:	2
Colorado Springs, CO 80903	Colorado Springs, CO 80903	Existing Zoning Code:	PUD
		Proposed Zoning Code:	PUD

REGIONAL AND URBAN PARK DEDICATION AND FEE REQUIREMENTS

<p>Regional Park land dedication shall be 7.76 acres of park land per 1,000 projected residents, while Urban Park land dedication shall be 4 acres of park land per 1,000 projected residents. The number of projected residents shall be based on 2.5 residents per dwelling unit.</p>	<p>The EPC Land Development Code defines urban density as land development of higher density and intensity which is characteristically provided with services of an urban nature. This category of development includes residential uses with densities of more than one dwelling unit per 2.5 acres.</p>
LAND REQUIREMENTS	Urban Density (>= 1 Dwelling Unit Per 2.5 Acres): YES
<p>Regional Park Area: 2</p> <p>0.0194 Acres x 49 Dwelling Units = 0.951</p> <p>Total Regional Park Acres: 0.951</p>	<p>Urban Park Area: 2</p> <p>Neighborhood: 0.00375 Acres x 49 Dwelling Units = 0.18</p> <p>Community: 0.00625 Acres x 49 Dwelling Units = 0.31</p> <p>Total Urban Park Acres: 0.49</p>
FEE REQUIREMENTS	
<p>Regional Park Area: 2</p> <p>\$467 / Dwelling Unit x 49 Dwelling Units = \$22,883</p> <p>Total Regional Park Fees: \$22,883</p>	<p>Urban Park Area: 2</p> <p>Neighborhood: \$116 / Dwelling Unit x 49 Dwelling Units = \$5,684</p> <p>Community: \$179 / Dwelling Unit x 49 Dwelling Units = \$8,771</p> <p>Total Urban Park Fees: \$14,455</p>

ADDITIONAL RECOMMENDATIONS

Staff Recommendation: Recommend to the Planning Commission and the Board of County Commissioners that approval of Sterling Ranch Filing No. 2 Final Plat includes the following conditions: (1) recommend the developer install a 5-foot wide gravel trail adjacent the sidewalk along Marksheffel Road; (2) show on the Final Plat and dedicate to El Paso County a 25-foot trail easement along the north side of Marksheffel Road that allows for public access, as well as maintenance by El Paso County of the western branch of the Sand Creek Primary Regional Trail; (3) require fees in lieu of land dedication for regional park purposes in the amount of \$22,883 (updated 07/16/2020) and urban park fees in the amount of \$14,455 (updated 07/16/2020)."

Park Advisory Board Recommendation: **Originally Endorsed 08/08/2018**