







Please add the following:

- Owner name, contact telephone number, and email for responsible party
- Applicant name (if not owner), contact telephone number, and email for responsible party
- Plan preparer name, telephone number, and email
- Property address
- Property tax schedule number
- Legal description
- Lot/parcel size
- Lot area coverage calculation
- Existing/proposed land use and zoning
- Total gross building square footage
- Open space, landscaping, and impermeable surface percentage
- Density and total number of dwelling units (residential)
- Parking computations (required, provided, etc.)

-  Parking Lot Area Light
-  Loading Zone
-  Flow of Traffic
-  Parking Space (9'x 20')
-  Parking Space (9' x 22')
-  Aisle Measurement
-  Handicap Parking

This section of spots will be 9 feet wide by 20 feet deep and all spots will be a 45 degree (diagonal) angle. In this section there will be 10 spots with all the same measurement with also a 2.5 foot sidewalk in front of each spot.

Parking lot area lights will shine to illuminate up to the second row of the middle section of parking. Which will cover more than the 37 parking spaces needed for the daycare.

Main Entrance to the building that is covered by an awning. This entrance allows for the loading zone to have an unobstructed view. (Table 6-2 in General Development Standards.)

Loading Zone of 60 ft by 20 ft for a total of 1200 square feet to accommodate the licensing of 45 children per the required 10' x 20 per 8 children. There will also be a 2.5 foot sidewalk running the length of the loading zone.

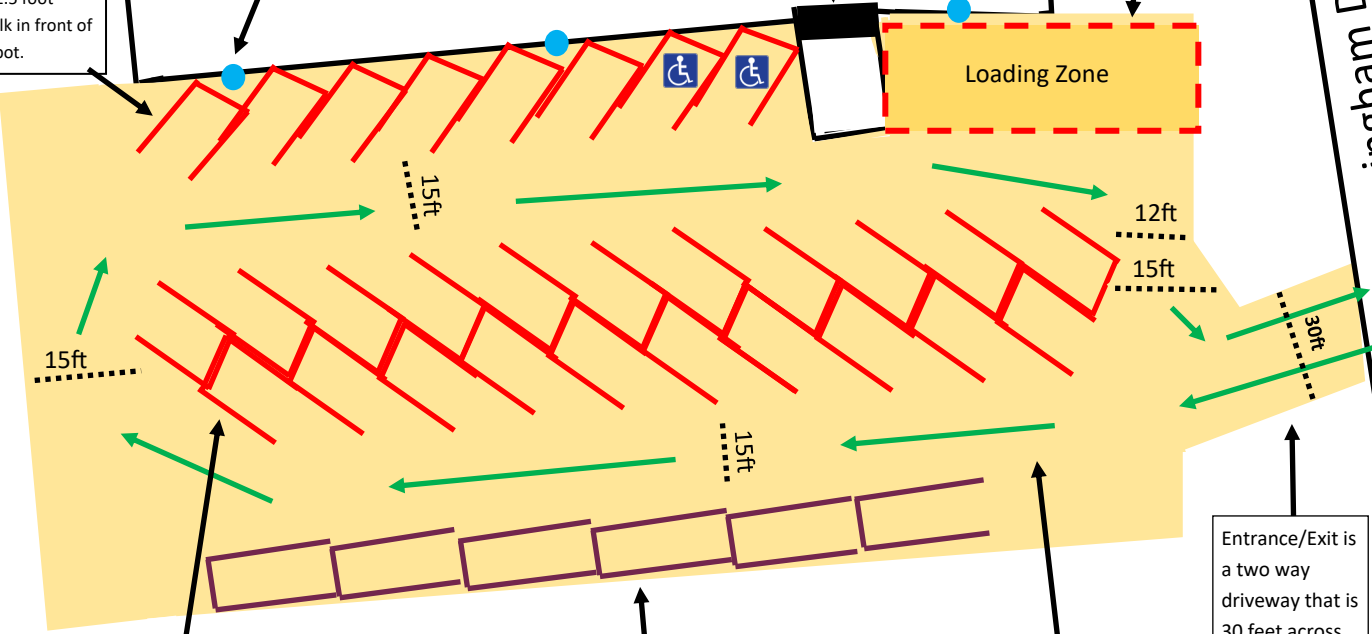

45 degree (diagonal) will be used for the main parking. All diagonal spaces are 9 feet wide by 20 feet deep. In this section, there will be seventeen spots on each side, for a total of thirty-four spots for the center row. (Table 6-4 in General Development Standards)

Parallel Parking will be provided for Church parking in the event that a member needs to stop by during the day. This will leave enough room for thorough parking for the childcare during the service times. There will be six 9' wide by 22 feet deep spots in accordance to Table 6-4 in General Development Standards.

The traffic will be one way to ensure the max amount of parking can be allotted. Entering and exiting through the same space. The one-way aisles will be 15 feet across.

Entrance/Exit is a two way driveway that is 30 feet across. Allowing for 15 feet across for each lane.



Cunningham Drive