

Condition of approval:
 -Building permit must be pulled for fencing over 7 feet in height.

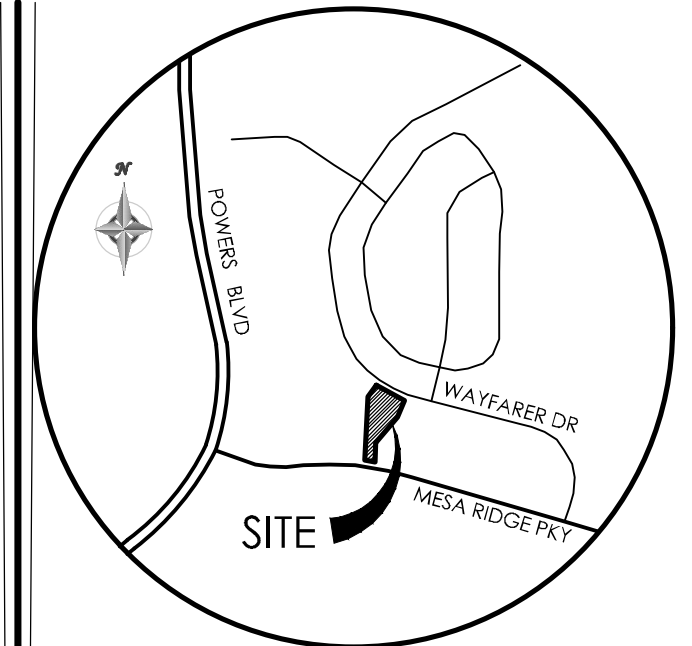

VICINITY MAP
 NOT TO SCALE

BENCHMARK
 THE EXISTING TOPOGRAPHY SHOWN ON THIS PLAN WAS PREPARED BY MVE INC. USING DATA PROVIDED BY POLARIS SURVEYING INC. ELEVATIONS SHOWN ARE RELATIVE TO THE COLORADO SPRINGS UTILITIES CONTROL NETWORK (FIMS DATUM/NAVD29).

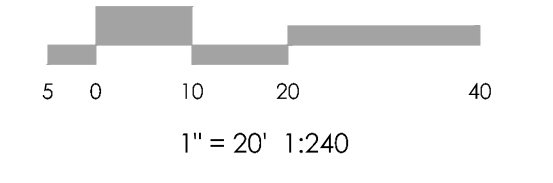
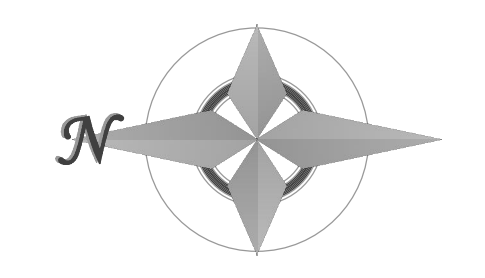
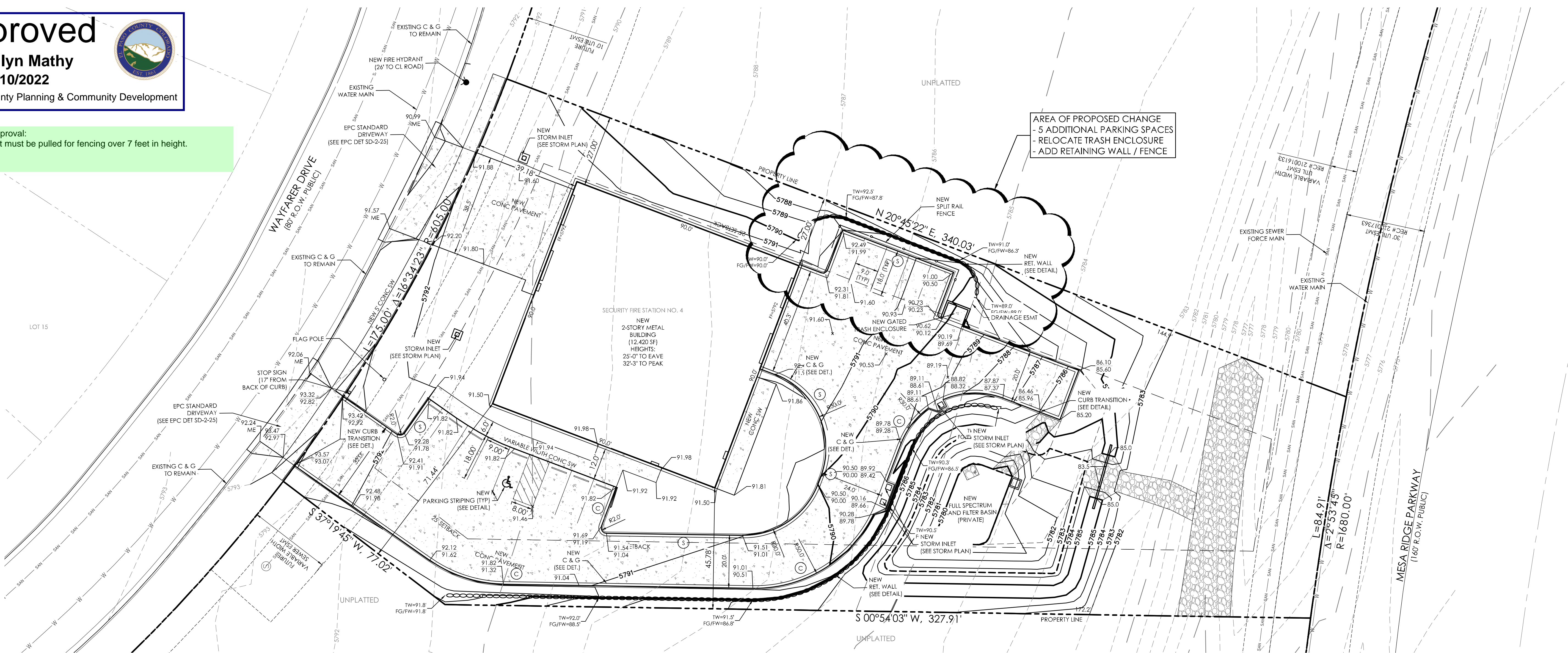

LIGHTING NOTE: LIGHTING TO REMAIN AS APPROVED ON THE SITE DEVELOPMENT PLAN (PCD FILE NO. PPR-20-029) CONSISTING OF WALL PACK LIGHTING ATTACHED TO THE BUILDING AND NO LIGHT POLES.

This Commercial Over the Counter (COM) Submittal is presented to allow the addition of 5 parking spaces southeast of the fire station building. The site is under construction at this date (9/29/2022) and the additional parking spaces will be completed along with all the other site improvements. The Development Plan was approved 5/17/2021 and the Grading and Erosion Control Plan was approved 5/12/2021 under PCD File No. PPR-20-029. No changes to the detention pond or other aspects of the site are required.

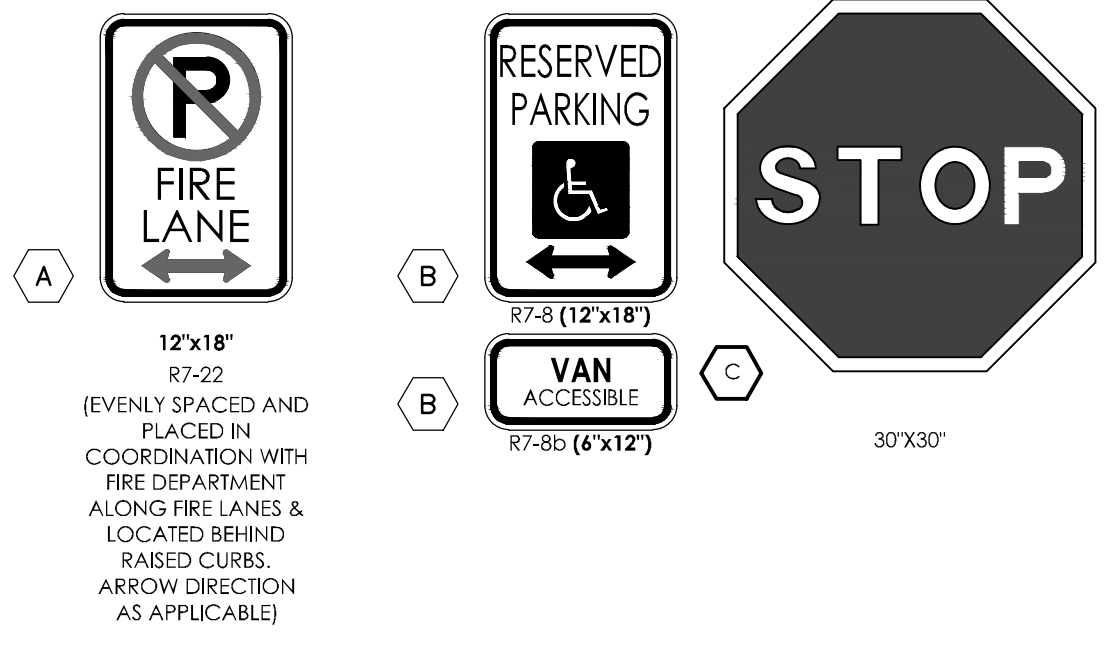

SITE SIGNAGE LEGEND
 SCALE: 1" = 1'-0"

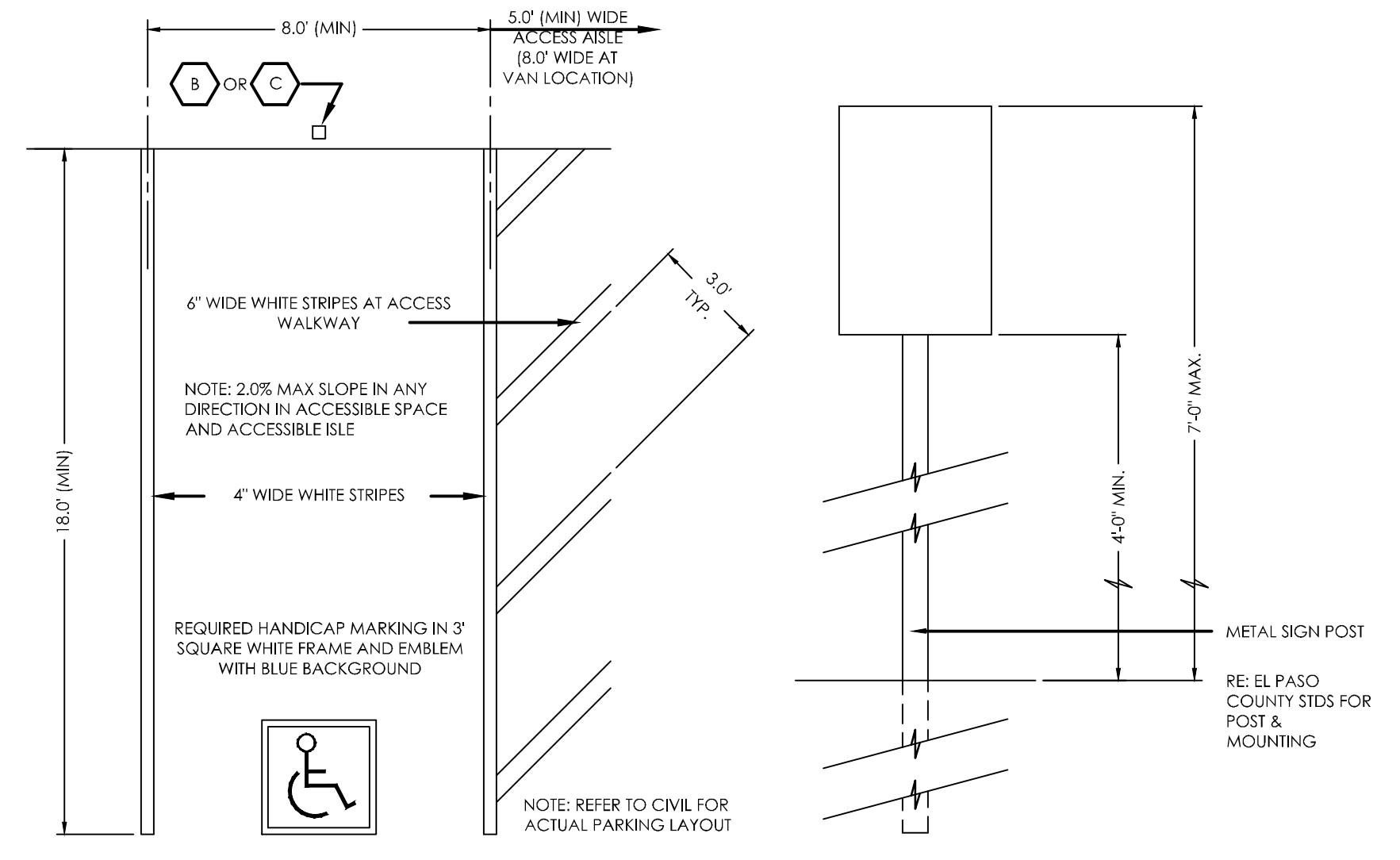

TYPICAL HANDICAP PARKING SPACE
 SCALE 1" = 4'-0"

TYPICAL SIGN POST
 NTS

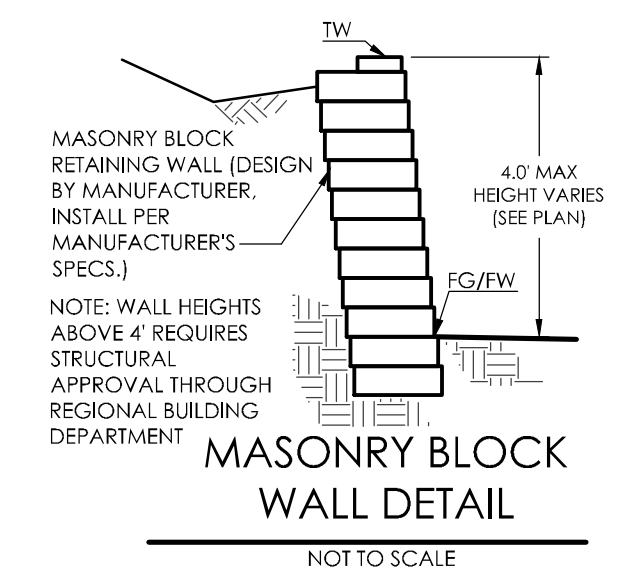

MASONRY BLOCK WALL DETAIL
 NOT TO SCALE

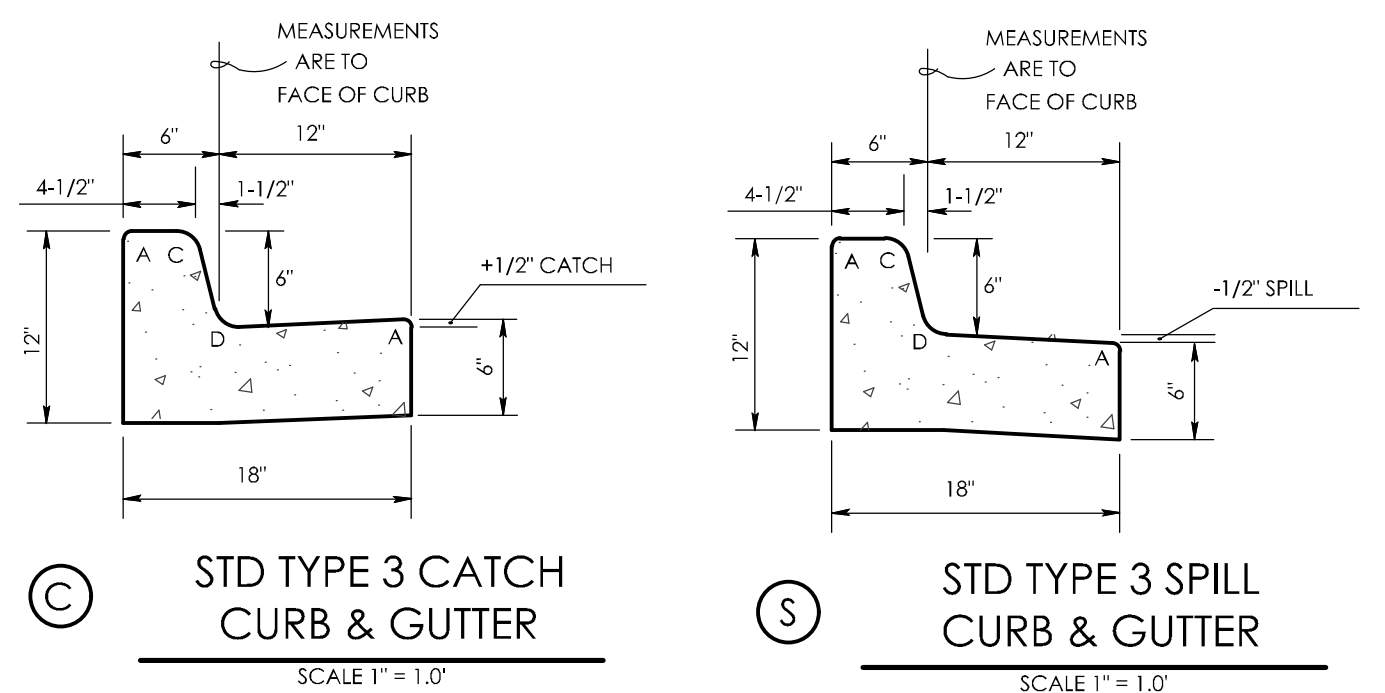

STD TYPE 3 CATCH CURB & GUTTER
 SCALE 1" = 1'-0"

STD TYPE 3 SPILL CURB & GUTTER
 SCALE 1" = 1'-0"

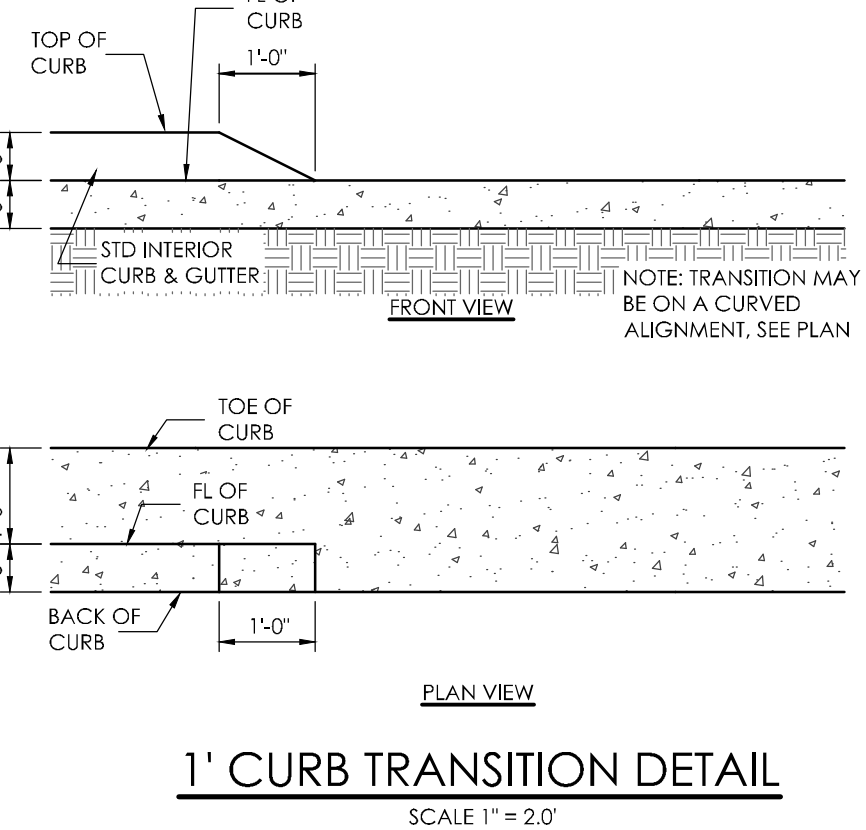

1' CURB TRANSITION DETAIL
 SCALE 1" = 2'-0"

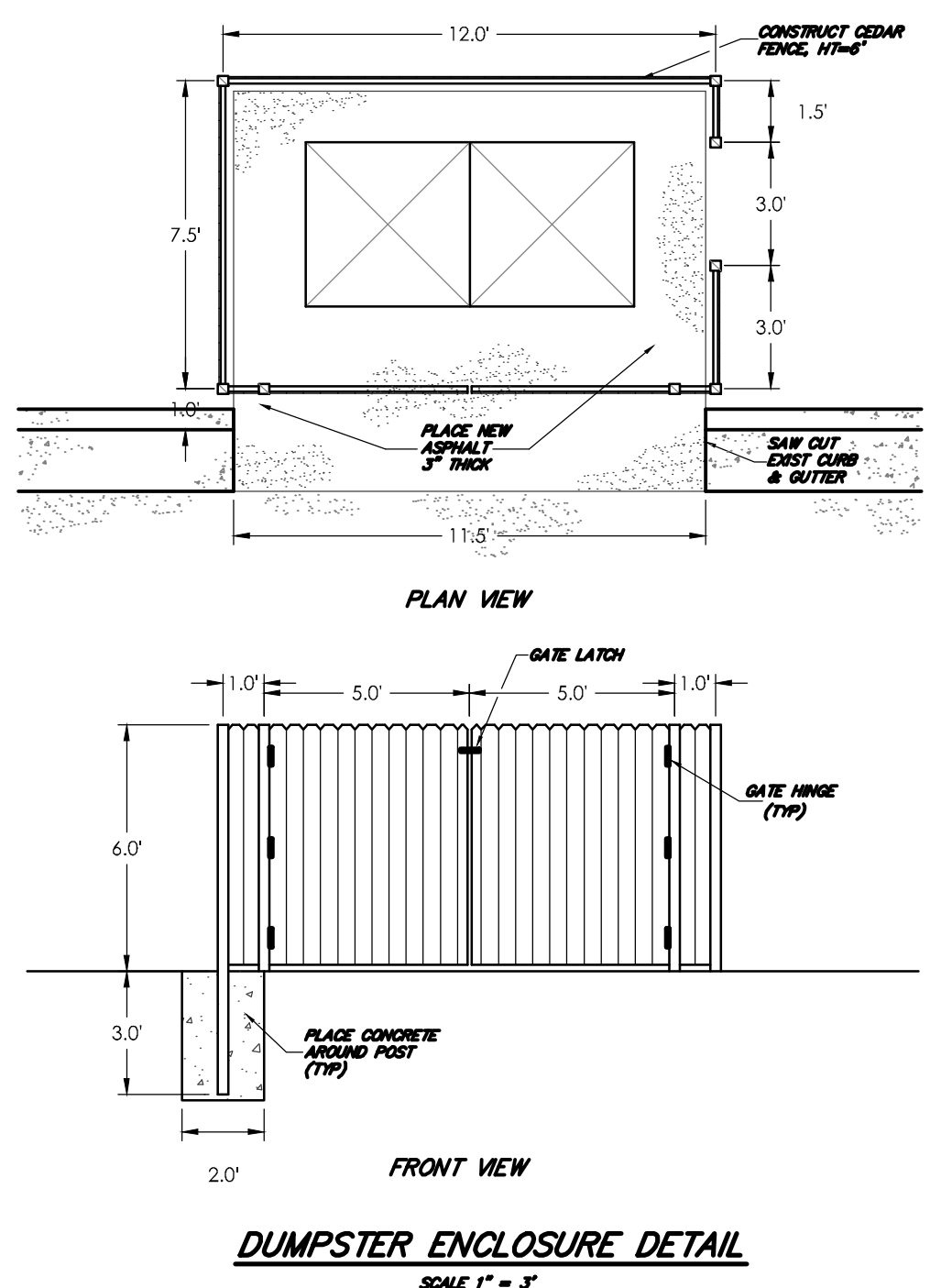

DUMPSTER ENCLOSURE DETAIL
 SCALE 1" = 3'-0"

REVISIONS
 1 ADDITIONAL PARKING AREA 9/21/2022

DESIGNED BY _____
 DRAWN BY _____
 CHECKED BY _____
 AS-BUILTS BY _____
 CHECKED BY _____

SECURITY FIRE STATION NO. 4
 SITE DEVELOPMENT PLAN
 SITE PLAN
 DP-2 MVE PROJECT 61134
 MVE DRAWING DEV-SP
 SEPTEMBER 29, 2022
 SHEET 2 OF 2



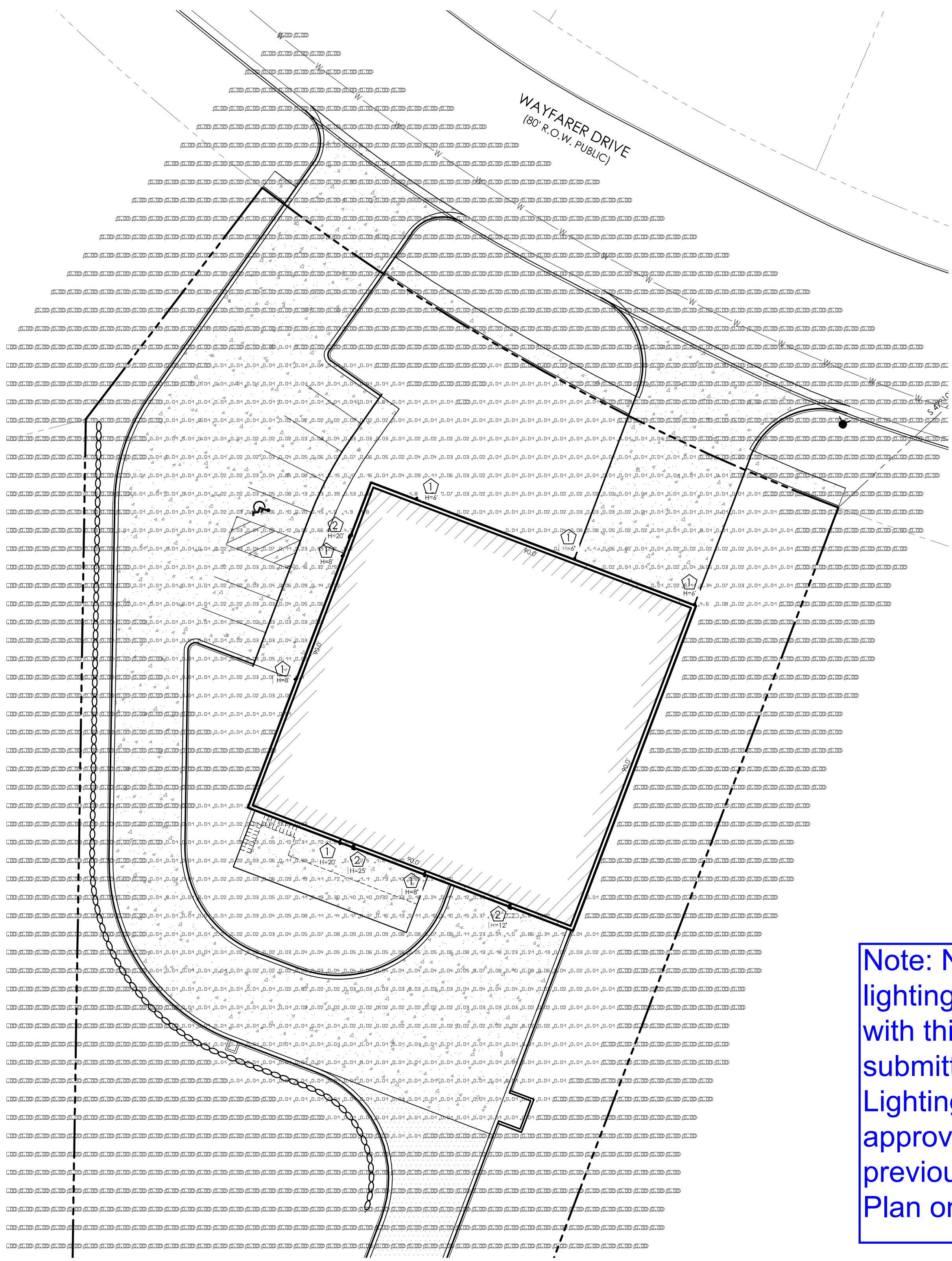

Note: No changes to lighting are requested with this COM submittal. This Lighting Plan was approved with the previous Development Plan on 5/17/2021

Luminaire list (Site 1)								
Index	Manufacturer	Article name	Item number	Fitting	Luminous flux	Light loss factor	Connected load	Quantity
1	BEGA	LED 3,8W	33590	1x LED 3,8W	293 lm	0.80	6 W	7
2	WEEF	QLS410 [M] IP66:LED-3/13W/3K	620-2017	3x 3 LED 13W (3000K)	1496 lm	0.80	16 W	3

Wall luminaire - two-sided light distribution

BEGA

Application
Wall luminaire with light emission on two sides. Downward directed light distribution is ideal for general illumination of pathways and corridors. Upward directed light is ideal for highlighting various architectural features.

Materials
Luminaire housing constructed of die-cast marine grade, copper free (±0.3% copper content) A380.0 aluminum alloy
Clear safety glass
Reflectors made of pure anodized aluminum
Silicone applied robotically to casting, plasma treated for increased adhesion
High temperature silicone gasket
Mechanically captive stainless steel fasteners
NRTL listed to North American Standards, suitable for wet locations
Protection class IP64
Weight: 1.5 lbs

Electrical
Operating voltage 120-277VAC
Minimum start temperature -30° C
Maximum ambient temperature 40° C
LED module wattage 3.8W
System wattage 7.3W
Controllability 0-10V dimmable
Color rendering index Ra > 80
Luminaire lumens 300 lumens (4000K)
LED service life (L70) 60,000 hours

LED color temperature
 4000K - Product number + **K4 (EXPRESS)**
 3500K - Product number + **K35**
 3000K - Product number + **K3 (EXPRESS)**
 2700K - Product number + **K27**
 Amber - Product number + **AMS**

Wildlife friendly amber LED - Optional
Luminaire is optionally available with a narrow bandwidth, amber LED source (585-600nm) approved by the FWG. This light output is suggested for use within close proximity to sea turtle nesting and hatching habitats. Electrical and control information may vary from standard luminaire.

LED module wattage 4.2W (Amber)
System wattage 7.6W (Amber)
Luminaire lumens 89 lumens (Amber)

BEGA can supply you with suitable LED replacement modules for up to 20 years after the purchase of LED luminaires - see website for details

Type:
BEGA Product:
Project:
Modified:

- Available Options**
- FSC** Fusing
 - FRO** Frosted lens
 - FFRO** Factory fixed reduced output
 - UPO** Uplight only
- See individual accessory spec sheet for details.



Finish
All BEGA standard finishes are matte, textured polyester powder coat with minimum 3 mil thickness.

Available colors Black (BLK) White (WHT) RAL:
 Bronze (BRZ) Silver (SLV) CUS:

Wall luminaire - two-sided light distribution

LED	β	A	B	C
33590	3.8W	22°	3	5 1/4 8 1/4

β = Beam angle

BEGA 1000 BEGA Way, Carpinteria, CA 93013 (805) 684-0533 info@bega-us.com
Due to the dynamic nature of lighting products and the associated technologies, luminaire data on this sheet is subject to change at the discretion of BEGA North America. For the most current technical data, please refer to bega-us.com © copyright BEGA 2019 Updated 08/01/19

QLS410 LED 620-2017



Description
IP66, Class I, IK07. Surface mounted LED wall luminaire. Marine-grade, die-cast aluminum alloy, SCE superior corrosion protection including PCS hardware. Silicone rubber gasket. Safety glass lens. Integral EC electronic converter. CAD-optimised optics for superior illumination and glare control. OLC® One LED Concept. Factory installed LED circuit board. 0-10V on request. Suitable for installation over 4" recessed junction box. ADA (American Disabilities Act) Compliant.

Beam Type	symmetric, medium beam [M]
Light Source	LED-3/13W / 1400 mA - 3000 K
CRI	80
Gear Type	electronic gear
Nominal Luminous Flux (lm)	
LED Lumens	498.7 lm
LEDs	3
Total Lumens	1496 lm
Tj	85 °C
Delivered Lumens Flux (lm)	
LED Lumens	336.1 lm
Total Lumens	1008.4 lm
Ta	25 °C
Rated Input Power	16 W

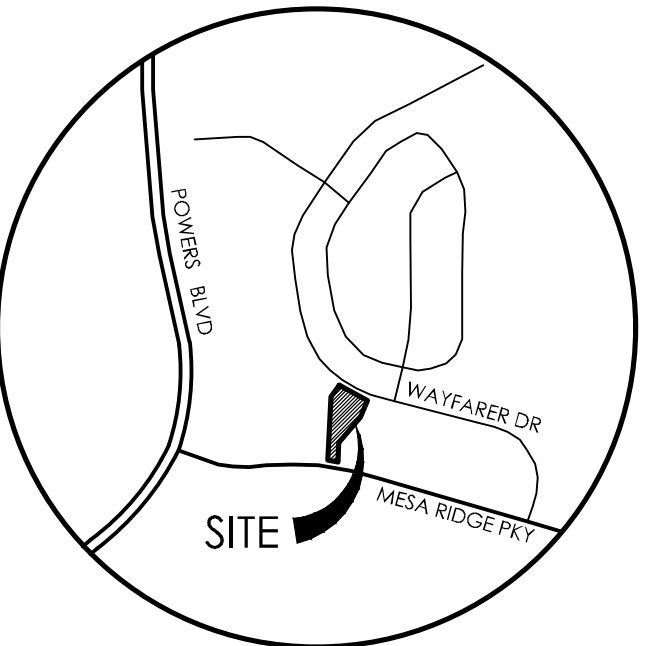

VICINITY MAP
NOT TO SCALE

BENCHMARK

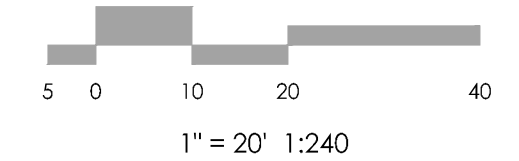
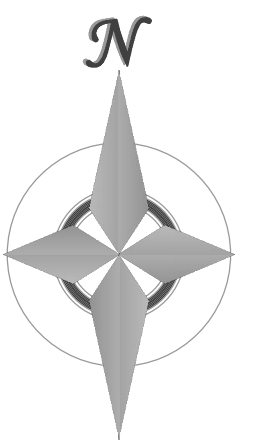

1" = 20' 1:240

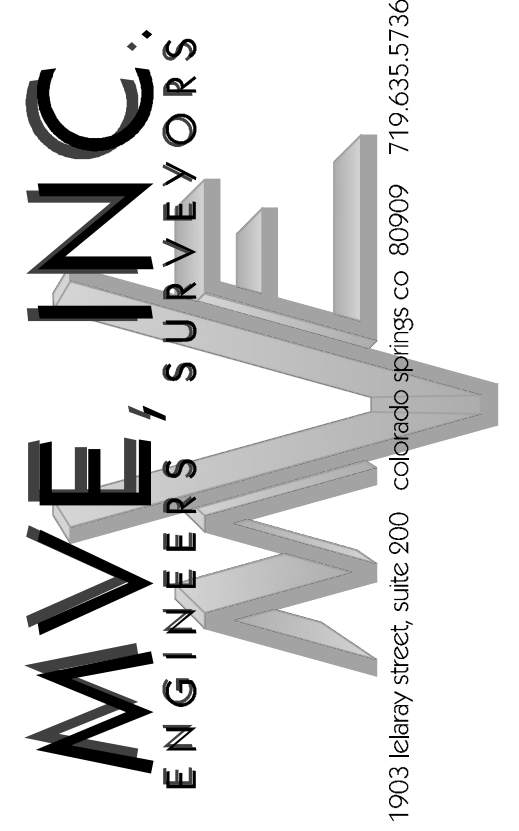

REVISIONS

DESIGNED BY _____
DRAWN BY _____
CHECKED BY _____
AS-BUILTS BY _____
CHECKED BY _____

SECURITY FIRE STATION NO. 4

SITE DEVELOPMENT PLAN LIGHTING PLAN

E-1 MVE PROJECT 61134
MVE DRAWING DEV-LP

SEPTEMBER 10, 2020 SHEET 1 OF 1

EPC PROJ NO.