

SFD20858
PLAT 14053
PUD



AVERAGE FINISH GRADE = (AFG)
AFG = $\frac{(82.8 \times 5)}{(5)} = 82.8$
BUILDING HEIGHT = 18.8 + (TS - AFG) =
BUILDING HEIGHT = 18.8 + (83.5 - 82.8) = 19.5

APPROVED
Plan Review

07/10/2020 7:23:58 AM
dsdrangel

EPC Planning & Community
Development Department



ANY APPROVAL GIVEN BY
EL PASO COUNTY
DOES NOT OVIATE THE NEED
TO COMPLY WITH APPLICABLE
FEDERAL, STATE, OR LOCAL
LAWS AND/OR REGULATION

Planning & Community Development Department
approval is contingent upon compliance with all
applicable notes on the recorded plat.

An access permit must be granted by the
Planning & Community Development Department
prior to the establishment of any driveway onto a
County road.

Division of blockage of any drainage way
is not permitted without approval of the
Planning & Community Development Department

APPROVED
BESQCP

07/10/2020 7:24:13 AM
dsdrangel

EPC Planning & Community
Development Department

LOT 42

LOT 44



It is the owner's responsibility to
coordinate with easement holders
to avoid impact to utilities that
may be located in the easements.

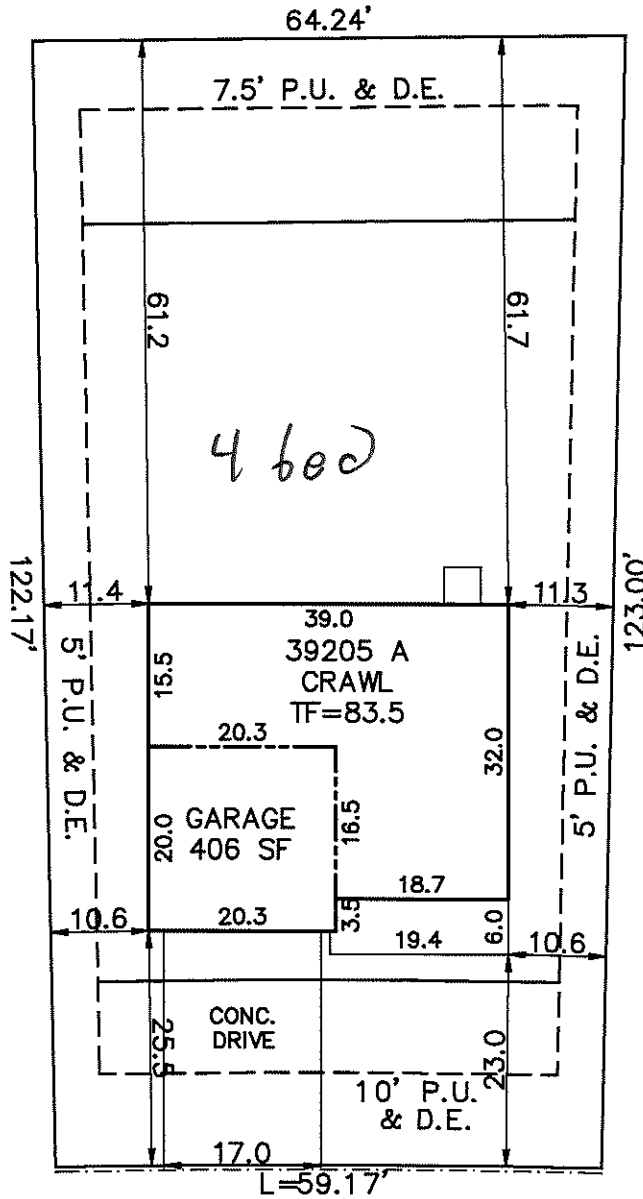

STONE MEADOWS WAY
(60' R.O.W.)

SITE DATA

LOT SQ. FT.= 7550
HOUSE SQ. FT.= 1433
COVERAGE = 19.0%
BLDG. HEIGHT = 19.5

SCALE: ...1"=20'

DRAWN BY: TAP

SCHEDULE No. 422921601X 5

WARNING!

1. LOCATE UNDERGROUND UTILITIES PRIOR TO EXCAVATION.
2. THIS PLOT PLAN SHOWS IMPROVEMENTS AT GRADE ONLY. SEE FOUNDATION PLANS FOR STRUCTURAL INFORMATION

PLOT PLAN

LEGAL DESCRIPTION

LOT 43
STONEBRIDGE FILING NO. 3 AT MERIDIAN RANCH
EL PASO COUNTY, COLORADO

ADDRESS

13248 STONEY MEADOWS WAY

Century Communities
9475 BRIAR VILLAGE POINT, STE 125
COLORADO SPRINGS, COLORADO 8020

TITLE CO. FILE NO.

DATE

06-30-20

DRAWING NAME

PROJECT NO.

S3-043



Woodmen Road Metropolitan District

c/o Walker Schooler District Managers
614 N. Tejon Street
Colorado Springs, CO 80903

Receipt

DATE	RECEIPT NO.
7/6/2020	4057

SOLD TO

Century Communities Colorado, LLC
8390 E. Crescent Parkway Ste 650
Greenwood Village, CO 80111

CHECK NO.	PAYMENT METHOD
361431	Check

DESCRIPTION	FILING	QTY	RATE	AMOUNT
Lot 41 - 13228 Stoney Meadows Way	Stonebridge 3 @ MR	1	550.00	550.00
Lot 42 - 13238 Stoney Meadows Way	Stonebridge 3 @ MR	1	550.00	550.00
Lot 43 - 13248 Stoney Meadows Way	Stonebridge 3 @ MR		550.00	550.00
Lot 84 - 10164 Bluffstone court	Stonebridge 3 @ MR		550.00	550.00
Lot 85 - 10144 Bluffstone Court	Stonebridge 3 @ MR		550.00	550.00

AUTHORIZED SIGNATURE:

Kalilah Anderson

Total

\$2,750.00

Phone #

(719) 447-1777

SITE



2017 PPRBC

Address: 13248 STONEY MEADOWS WAY, PEYTON

Parcel: 4229216015

Plan Track #: 130868

Received: 09-Jul-2020 (BECKYA)

Map #: 552G

Description:

RESIDENCE

Type of Unit:

Garage	401	
Lower Level 2	831	
Main Level	918	
Upper Level 1	1089	
	3239	Total Square Feet

Required PPRBD Departments (2)

Enumeration

APPROVED

BECKYA

7/9/2020 9:12:01 AM

Floodplain

(N/A) RBD GIS

Required Outside Departments (1)

County Zoning

APPROVED

Plan Review

07/10/2020 7:24:35 AM

dsdrangel

EPC Planning & Community
Development Department

Release of this plan does not preclude compliance with all applicable codes, ordinances and other pertinent regulations. This plan set must be present on the job site for every inspection.