



VERIZON SITE NUMBER: 5000265313
VERIZON SITE NAME: MARKSHEFFLE
VERIZON PROJECT: 16576147
SITE TYPE: MONOPOLE
TOWER HEIGHT: 100'-0"

BUSINESS UNIT #: 823518
SITE ADDRESS: 3585 SAGUARO CIR
COLORADO SPRINGS, CO 80925
COUNTY: EL PASO
JURISDICTION: PIKES PEAK REGIONAL BUILDING DEPARTMENT



SITE INFORMATION

CROWN CASTLE USA INC.
SITE NAME: CS_CUCHARES_RANCH
BU NUMBER: 823518
TOWER OWNER: CROWN CASTLE
CARRIER/APPLICANT: VERIZON WIRELESS
SITE ADDRESS: 3585 SAGUARO CIR
COUNTY: EL PASO
LATITUDE: 38° 46' 48.55" / 38.7802°
LONGITUDE: -104° 39' 20.17" / -104.6556°
AREA OF CONSTRUCTION: EXISTING
CURRENT ZONING: RS-6000 (CAD-O)
MAP/PARCEL #: 55031-19-017
Legal Description
OCCUPANCY CLASSIFICATION: U
TYPE OF CONSTRUCTION: IIB
A.D.A. COMPLIANCE: FACILITY IS UNMANNED AND NOT FOR HUMAN HABITATION
Lot size
PROPERTY OWNER: MD7 CAPITAL ONE LLC
JURISDICTION: PIKES PEAK REGIONAL BUILDING DEPARTMENT
ELECTRIC PROVIDER: MOUNTAIN VIEW ELECTRIC

DRAWING INDEX

Table with 2 columns: SHEET #, SHEET DESCRIPTION. Rows include T-1 TITLE SHEET, T-2 GENERAL NOTES, C-1 SITE PLAN, C-2 TOWER ELEVATIONS, C-3 ANTENNA PLANS, C-4 FINAL EQUIPMENT SCHEDULE, C-5.1 EQUIPMENT DETAILS & SPECIFICATIONS, C-5.2 EQUIPMENT DETAILS & SPECIFICATIONS, C-6 COLOR CODE MATRIX, G-1 GROUNDING DETAILS, ATTACHED MOUNT MODIFICATION (BY OTHERS)

APPROVALS

Table with 3 columns: APPROVAL, SIGNATURE, DATE. Rows include VERIZON SIGNATURE BLOCK, CROWN CASTLE USA INC. SIGNATURE BLOCK, and various roles like SITE ACQUISITION, PLANNER, CONSTRUCTION, PROJECT MANAGER, UTILITY MANAGER, LANDLORD.

LOCATION MAP

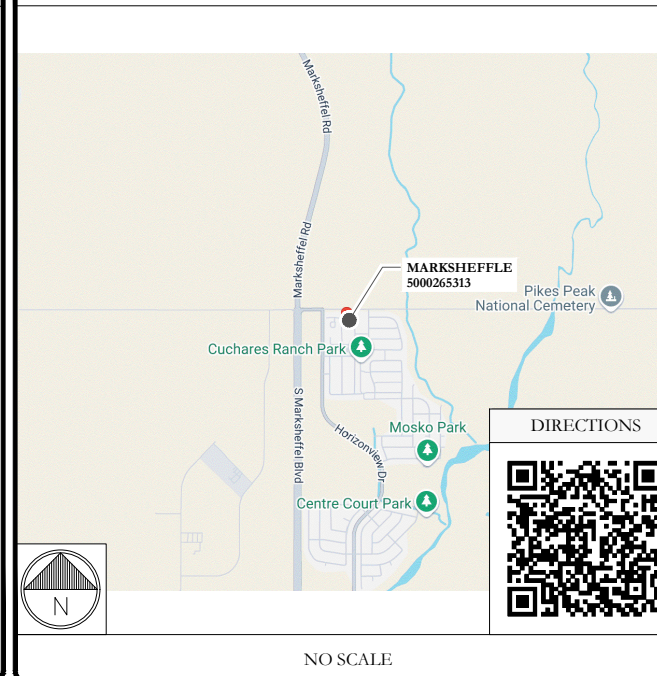

VERIZON SITE NUMBER: 5000265313

BU #: 823518

CROWN CASTLE SITE NAME CS_CUCHARES_RANCH

3585 SAGUARO CIR
COLORADO SPRINGS, CO 80925

EXISTING 100'-0" MONOPOLE

ISSUED FOR:

Table with 5 columns: REV, DATE, DRWN, DESCRIPTION, DES./QA. Rows show revision history for construction drawings.

ALL DRAWINGS CONTAINED HEREIN ARE FORMATTED FOR 11X17. CONTRACTOR SHALL VERIFY ALL PLANS AND EXISTING DIMENSIONS AND CONDITIONS ON THE JOB SITE AND SHALL IMMEDIATELY NOTIFY THE ENGINEER IN WRITING OF ANY DISCREPANCIES BEFORE PROCEEDING WITH THE WORK OR BE RESPONSIBLE FOR SAME.

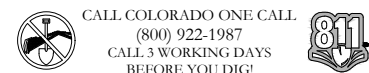

CONTRACTOR PMI REQUIREMENTS

Table with 2 columns: PMI ACCESSED AT, SMART TOOL VENDOR PROJECT NUMBER, V2W LOCATION CODE (PSLC). Includes URL https://pmi.vzwsmart.com and phone number 10235882.

MOUNT MODIFICATION REQUIRED

Y

V2W APPROVED SMART KIT VENDORS

REFER TO MOUNT MODIFICATION DRAWINGS PAGE FOR V2W SMART KIT APPROVED VENDORS

PROJECT DESCRIPTION

THE PURPOSE OF THIS PROJECT IS TO ENHANCE BROADBAND CONNECTIVITY AND CAPACITY TO THE EXISTING ELIGIBLE WIRELESS FACILITY.

- TOWER SCOPE OF WORK:
• REMOVE (3) AMPHENOL - BXA-185063/8CF ANTENNAS
• REMOVE (3) AMPHENOL - CWX063X03FYX0 ANTENNAS
• REMOVE (6) AMPHENOL - LPA-80063/4CF ANTENNAS
• REMOVE (18) 7/8" COAX CABLES
• INSTALL (6) COMMSCOPE - NHH-65B-R2B ANTENNAS
• INSTALL (3) ERICSSON - AIR6419 ANTENNAS
• INSTALL (3) ERICSSON - 4890 RADIOS
• INSTALL (3) COMMSCOPE - BSAMNT-SBS-1-2 SIDE BY SIDE ANTENNA BRACKET MOUNTS
• INSTALL (3) BACK TO BACK RADIO MOUNTS
• INSTALL (1) 12 OVP
• INSTALL (2) 6X12 HYBRID CABLES
• INSTALL MOUNT MODIFICATIONS PER MOUNT ANALYSIS BY COLLIERS ENGINEERING & DESIGN DATED 07/10/24

- GROUND SCOPE OF WORK:
• REMOVE (1) ERICSSON - 6630 BBU
• REMOVE (3) UHFA RRUS
• REMOVE (3) UHIC ALCA TEL RRUS
• REMOVE (2) 4812 CABINETS
• REMOVE (1) FILTER/DUPLEXER CDMA RACK
• RELOCATE (3) ERICSSON - 4449 RADIOS TO TOWER
• INSTALL (1) 12 OVP
• INSTALL (1) ERICSSON - 6651 BBU

APPLICABLE CODES & REFERENCE DOCUMENTS

ALL WORK SHALL BE PERFORMED AND MATERIALS INSTALLED IN ACCORDANCE WITH THE CURRENT EDITIONS OF THE FOLLOWING CODES AS ADOPTED BY THE LOCAL GOVERNING AUTHORITIES. NOTHING IN THESE PLANS IS TO BE CONSTRUED TO PERMIT WORK NOT CONFORMING TO THESE CODES:

Table with 2 columns: CODE TYPE, CODE. Rows include BUILDING (2021 IBC), MECHANICAL (2021 IMC), ELECTRICAL (2023 NEC).

REFERENCE DOCUMENTS:

Table with 2 columns: ANALYSIS TYPE, DATED. Rows include STRUCTURAL ANALYSIS (MORRISON HERSHFIELD, 09/19/24), MOUNT ANALYSIS (COLLIERS ENGINEERING & DESIGN, 07/10/24), RFDS REVISION (0, 06/24/24), ORDER ID (679430), REVISION (0).

INSTALLER NOTE:

AN ACTIVE BIRDS NEST HAS BEEN OBSERVED AT THIS SITE. BEFORE GAINING ACCESS TO THIS SITE PLEASE CHECK WITH THE CROWN CASTLE USA INC. REGULATORY DEPARTMENT.

INSTALLER NOTE:

NO PROPOSED LOADING TO BE ADDED UNTIL MOUNT MODIFICATIONS ARE INSTALLED PER MOUNT ANALYSIS BY COLLIERS ENGINEERING & DESIGN DATED 07/10/24.

PROJECT TEAM

A&E FIRM: CROWN CASTLE USA, INC.
CONTACTS: EVE ZWEIG - PROJECT MANAGER
MOISES MENDEZ - AES
JANE COLLIER - VERIZON REAL ESTATE SPECIALIST
HAMAD MUNEEB - VERIZON RF ENGINEER
CHESTER WEBER - VERIZON CONST. ENGINEER

DocuSigned by:

Eric Iglesias

CS-2024051111BF40E...



12/5/2024 | 3:22:07 PM CS

Plan preparer phone number and email for responsible party

CROWN CASTLE USA INC.

IT IS A VIOLATION OF LAW FOR ANY PERSON, UNLESS THEY ARE ACTING UNDER THE DIRECTION OF A LICENSED PROFESSIONAL ENGINEER, TO ALTER THIS DOCUMENT.

SHEET NUMBER:

T-1

REVISION:

1

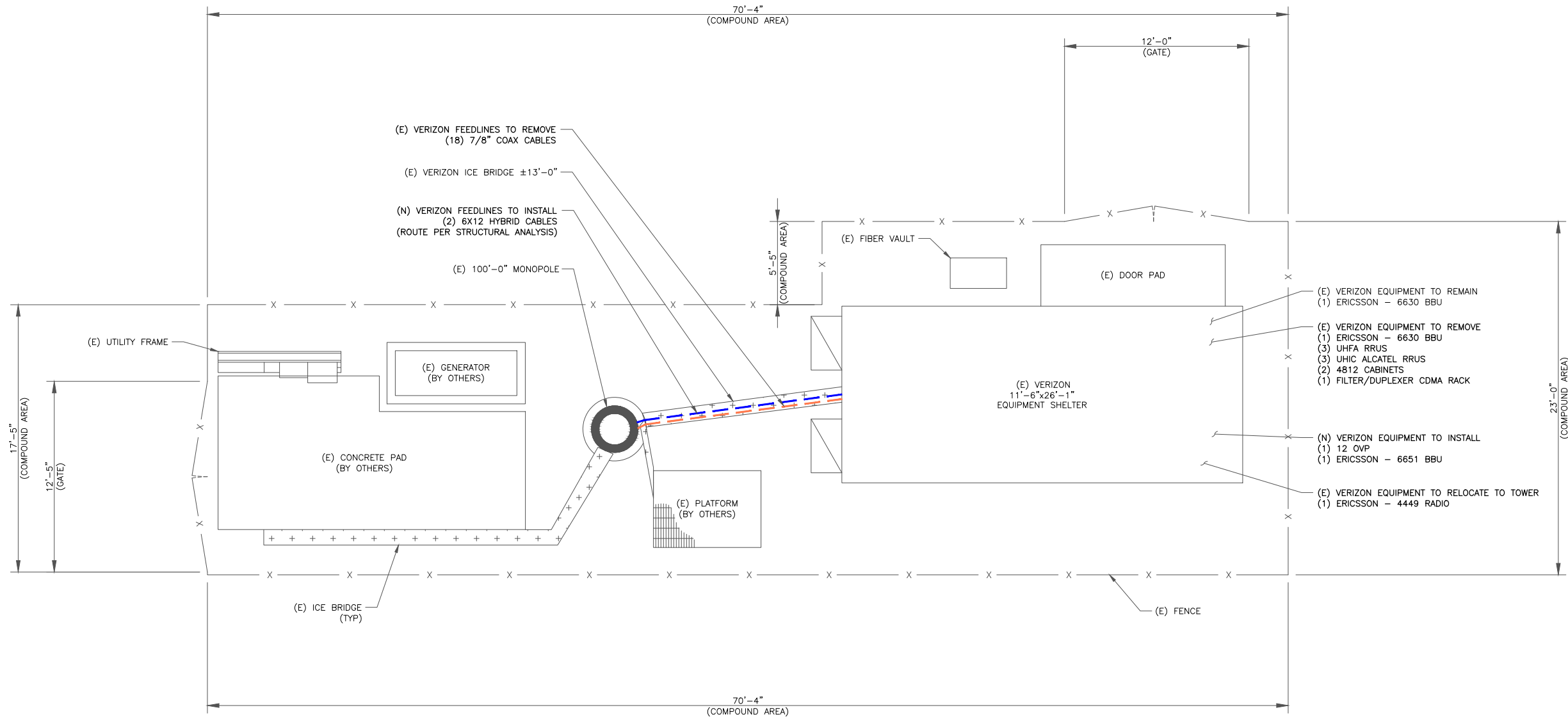

VERIZON SITE NUMBER:
5000265313

BU #: 823518

CROWN CASTLE SITE NAME
CS_CUCHARES_RANCH

3585 SAGUARO CIR
COLORADO SPRINGS, CO
80925

EXISTING 100'-0"
MONOPOLE

ISSUED FOR:

REV	DATE	DRWN	DESCRIPTION	DES./QA
0	10/22/24	CDM	CONSTRUCTION	EVI
1	12/5/24	AJC	CONSTRUCTION	EVI

DocuSigned by:

Eric Iglesias

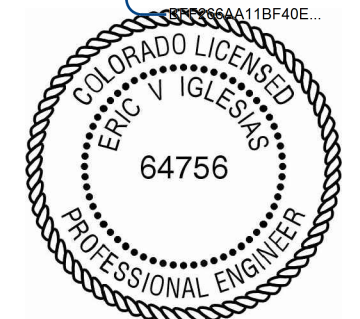

12/5/2024 | 3:22:07 PM CST

CROWN CASTLE USA INC.
IT IS A VIOLATION OF LAW FOR ANY PERSON,
UNLESS THEY ARE ACTING UNDER THE DIRECTION
OF A LICENSED PROFESSIONAL ENGINEER,
TO ALTER THIS DOCUMENT.

SHEET NUMBER:

C-1

REVISION:

1

1 SITE PLAN
SCALE: 1/4"=1'-0" (FULL SIZE)
1/8"=1'-0" (11x17)

