

EL PASO  **COUNTY**
COLORADO

COMMISSIONERS:
MARK WALLER (CHAIR)
LONGINOS GONZALEZ, JR. (VICE-CHAIR)

HOLLY WILLIAMS
STAN VANDERWERF
CAMI BREMER

PLANNING AND COMMUNITY DEVELOPMENT DEPARTMENT
CRAIG DOSSEY, EXECUTIVE DIRECTOR

December 13, 2020

RE: Claremont Business Park 2 Filing No. 1

File: SF-20-014

Parcel ID Nos.: 5405412001, 5405412004, 5405412002, 5405412003,
5408101057

To Whom It May Concern:

This letter is to inform property owners adjacent to Claremont Business Park 2 Filing No. 1 subdivision that the applicants, Hammers Construction, Case LG, Nancy Starr, and Lena Case, have requested approval of an administrative final plat application to develop 10 commercial lots, rights-of-way, and open space and utility tracts within a 13.73 acre development area within the CS (Commercial Service) zoning district. The Planning and Community Development Director may make a formal decision regarding the request on 12/29/2020. Any comments or questions may be forwarded to me prior to that decision. At the discretion of the Planning and Community Development Director, the application may be elevated to the Board of County Commissioners for consideration. All administrative decisions, such as this one, may be appealed to the Board of County Commissioners within 30 days of the date of the decision.

You may view the application documents online at www.epcdevplanreview.com. Please feel free to contact me with any questions, comments, or concerns you may have prior to the decision.

Respectfully,



Lindsay Darden
El Paso County Planning and Community Development
719-520-6302
Lindsaydarden@elpasoco.com

2880 INTERNATIONAL CIRCLE, SUITE 110
PHONE: (719) 520-6300



COLORADO SPRINGS, CO 80910-3127
FAX: (719) 520-6695

WWW.ELPASOCO.COM

12/14/2020

MEADOWBROOK PKWY

Market Value \$51,960

No Facts Available

5405412003



CASE
LENA
GAIL

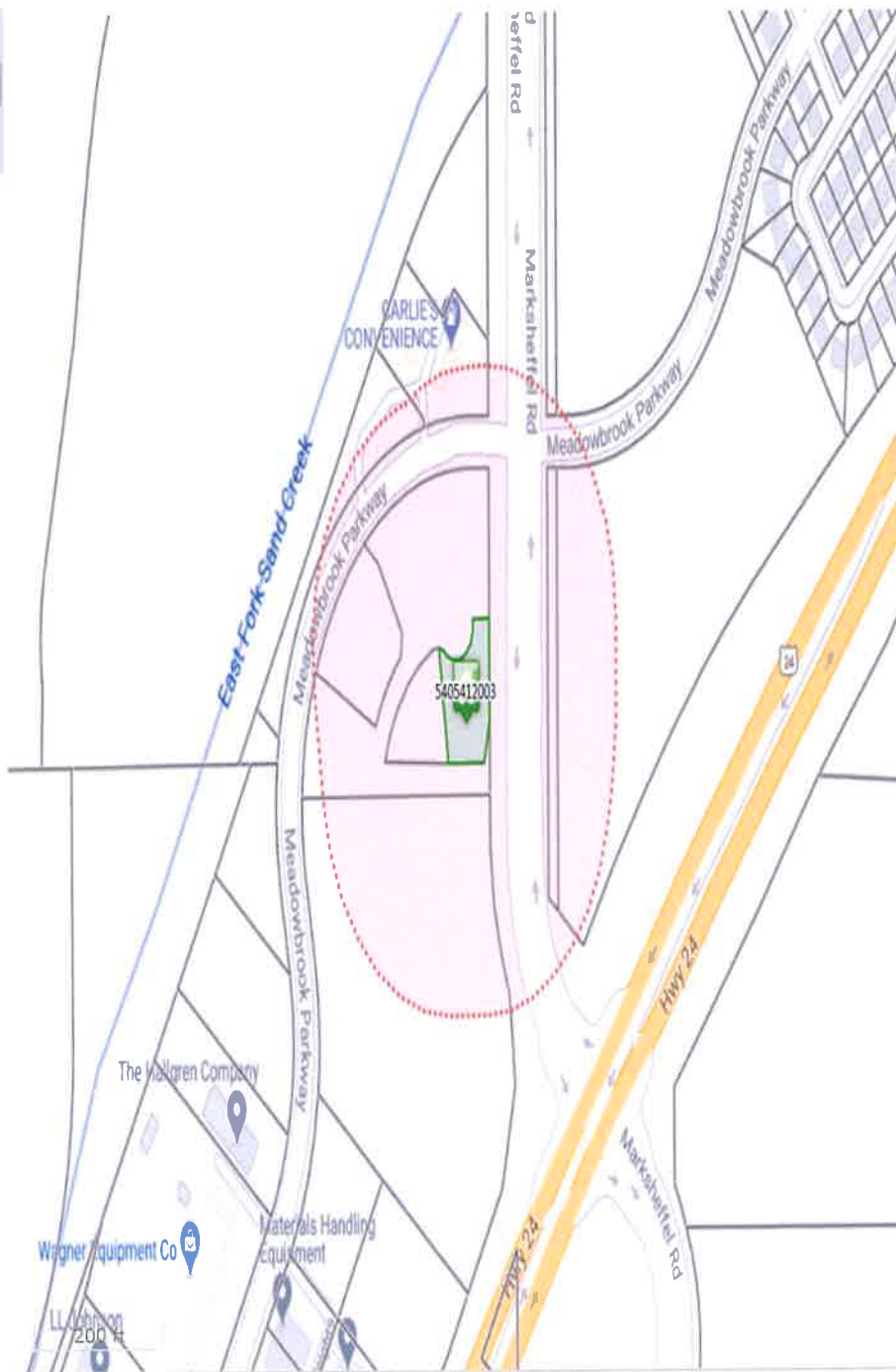

Disclaimer

We have made a good-faith effort to provide you with the most recent and most accurate information available. However, if you need to use this information in any legal or official venue, you will need to obtain official copies from the Assessor's Office. Do be aware that this data is subject to change on a daily basis. If you believe that any of this information is incorrect, please call us at (719) 520-6600.

MEADOWBROOK PKWY

Market Value \$48,040

No Photo Available

5405412002



CASE
LENA
GAIL

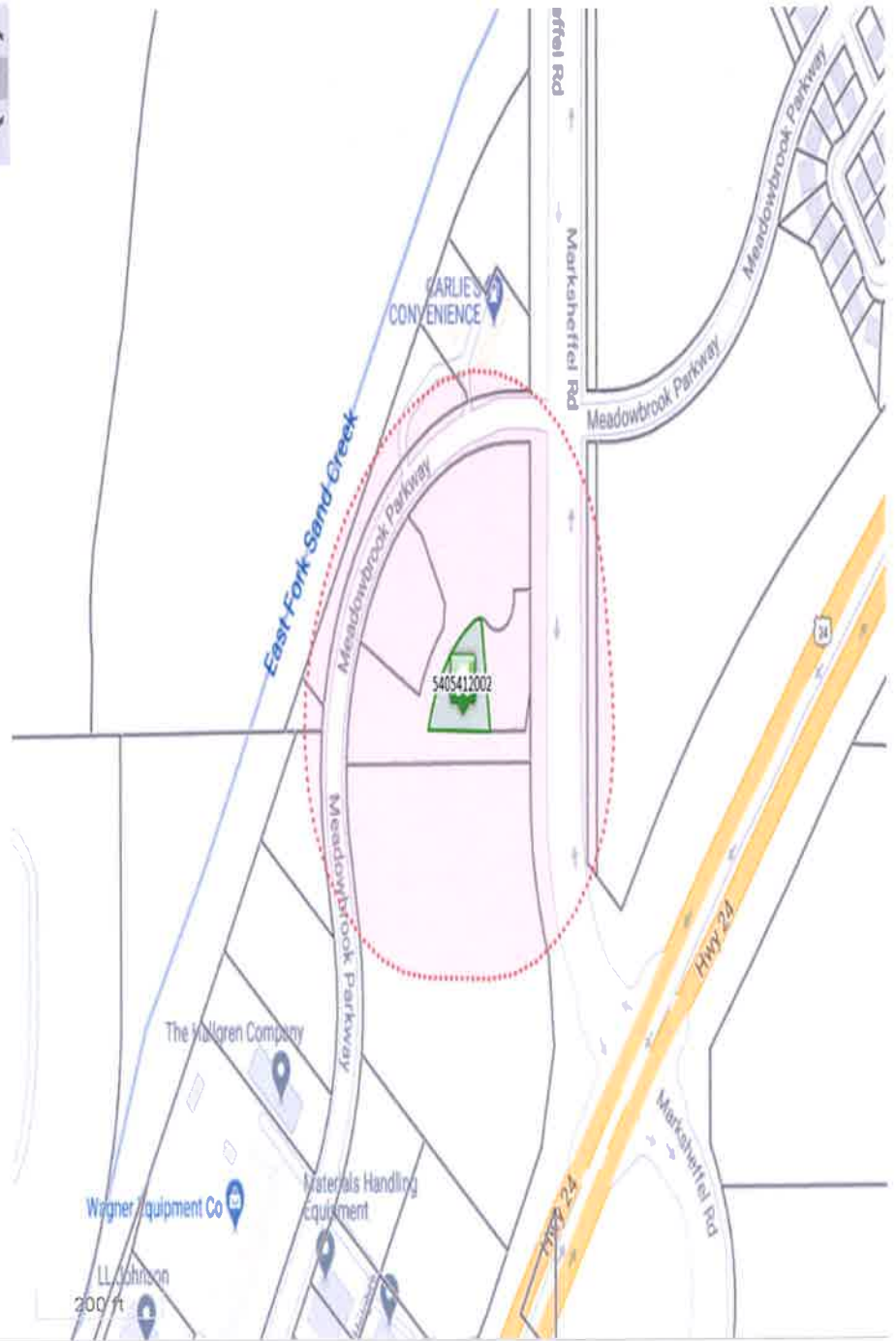

Disclaimer

We have made a good-faith effort to provide you with the most recent and most accurate information available. However, if you need to use this information in any legal or official venue, you will need to obtain official copies from the Assessor's Office. Do be aware that this data is subject to change on a daily basis. If you believe that any of this information is incorrect, please call us at (719) 520-6600.

MEADOWBROOK PKWY

Market Value \$249,272

No Photo Available

5405412004

CASE

L G

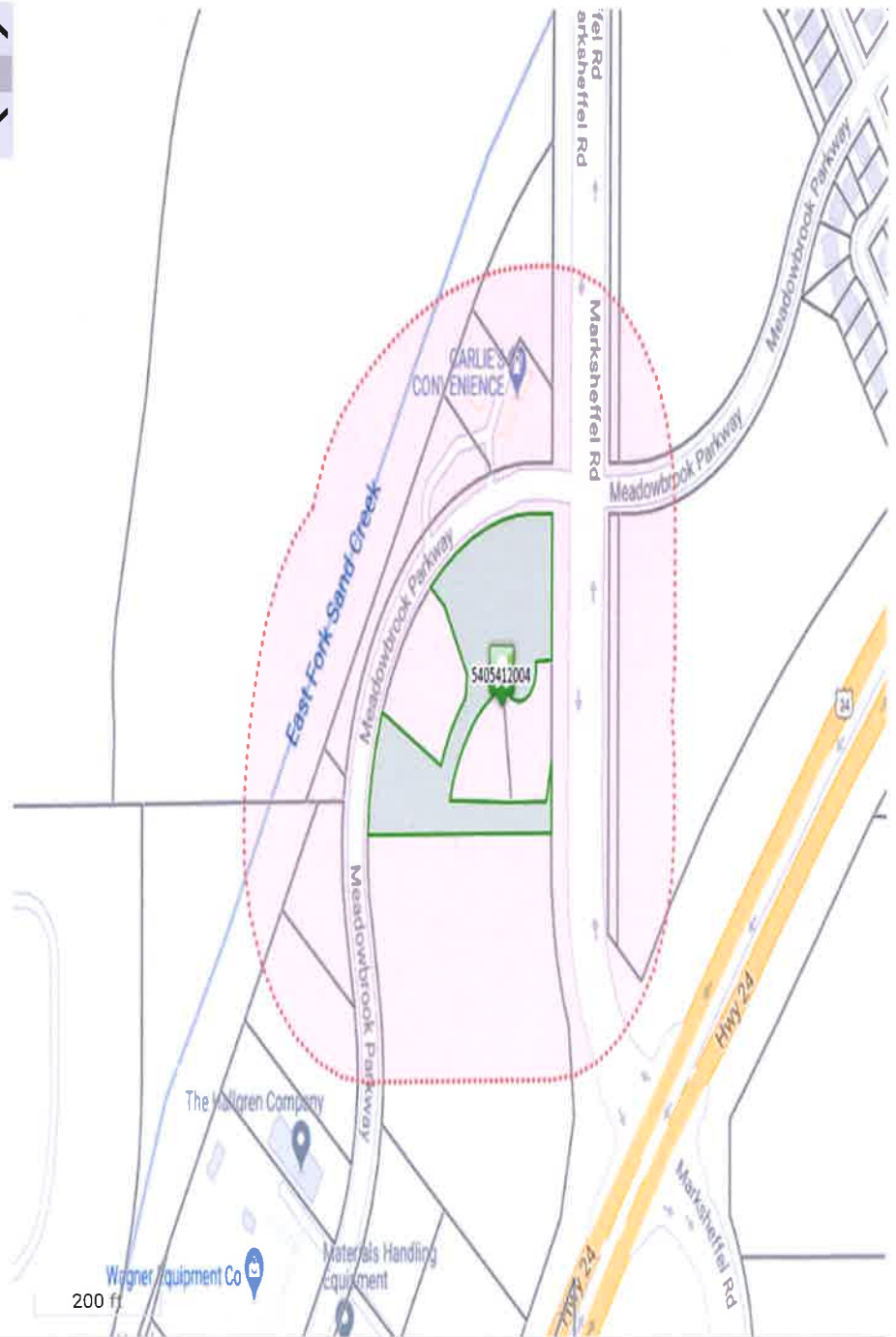

Disclaimer

We have made a good-faith effort to provide you with the most recent and most accurate information available. However, if you need to use this information in any legal or official venue, you will need to obtain official copies from the Assessor's Office. Do be aware that this data is subject to change on a daily basis. If you believe that any of this information is incorrect, please call us at (719) 520-6600.

MEADOWBROOK PKWY

Market Value **\$89,842**

No Photo Available

5405412001



STARR
NANCY
BARBER,
STARR
JON

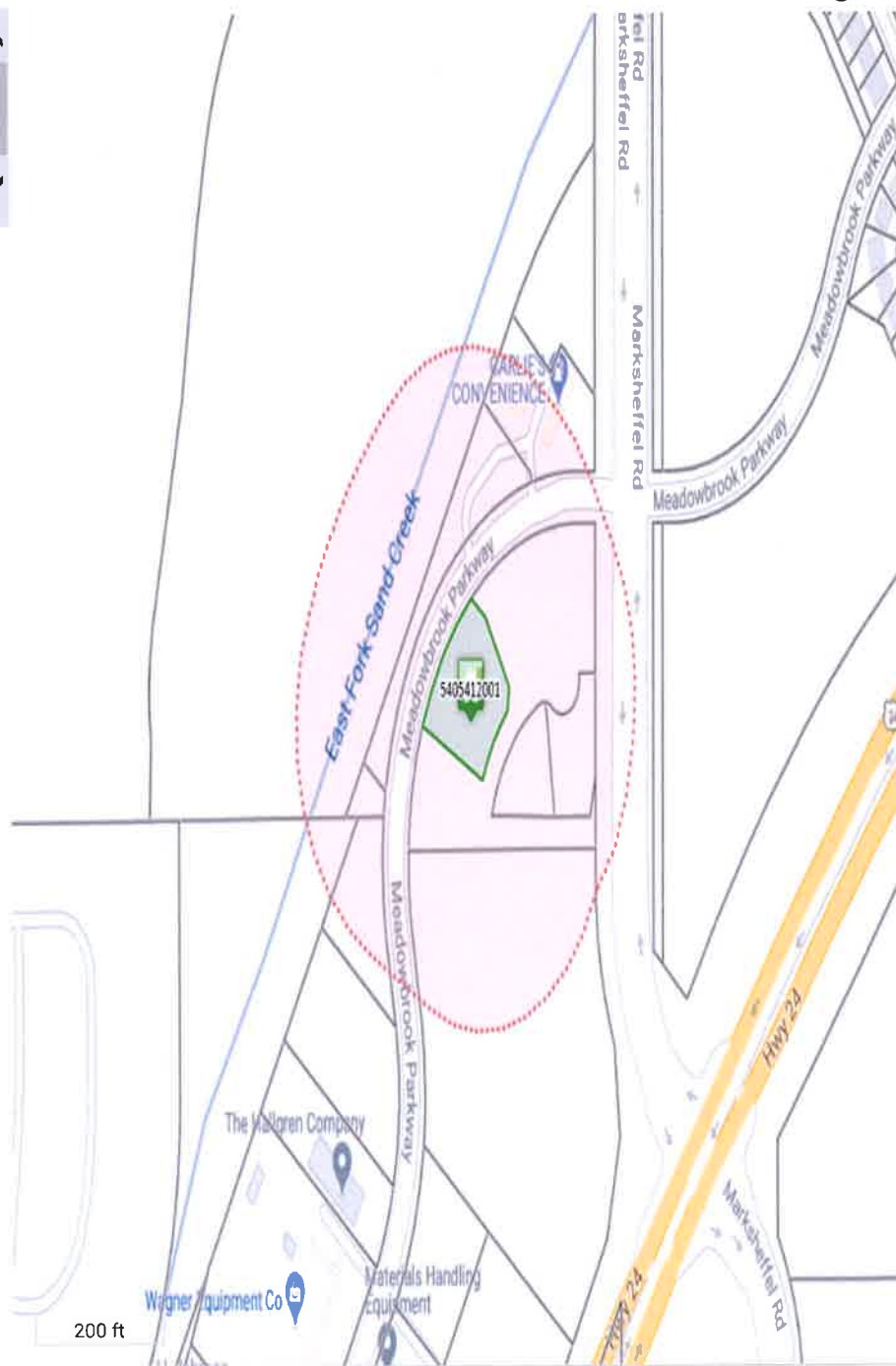

Disclaimer

We have made a good-faith effort to provide you with the most recent and most accurate information available. However, if you need to use this information in any legal or official venue, you will need to obtain official copies from the Assessor's Office. Do be aware that this data is subject to change on a daily basis. If you believe that any of this information is incorrect, please call us at (719) 520-6600.

El Paso County - Colorado

111 MEADOWBROOK PKWY

Market Value \$635,000

Full Photo Available



5408101057
HAMMERS
CONSTRUCTION
INC



Disclaimer

We have made a good-faith effort to provide you with the most recent and most accurate information available. However, if you need to use this information in any legal or official venue, you will need to obtain official copies from the Assessor's Office. Do be aware that this data is subject to change on a daily basis. If you believe that any of this information is incorrect, please call us at (719) 520-6600.

VENTIMIGLIA DOROTHY B TRUST
PO BOX 618
LARKSPUR CO 80118-0618

CENTRAL MARKSHEFFEL
METROPOLITAN
455 E PIKES PEAK AVE STE 100
COLORADO SPRINGS CO 80903-3672

RK FAMILY INVESTMENTS LLC
4560 W 33RD AVE
DENVER CO 80212-1802

MALLERY LLC
7575 PINERY CIR
COLORADO SPRINGS CO 80908-2838

CASE INTERNATIONAL COMPANY
102 E PIKES PEAK AVE STE 200
COLORADO SPRINGS CO 80903-1818

STARR NANCY BARBER
5001 S CLINTON ST
ENGLEWOOD CO 80111-1333

CASE LENA GAIL
102 E PIKES PEAK AVE STE 200
COLORADO SPRINGS CO 80903

CASE LENA GAIL
102 E PIKES PEAK AVE STE 200
COLORADO SPRINGS CO 80903

CASE L G
2432 PARKVIEW LN
COLORADO SPRINGS CO 80906-1163

STATE OF COLORADO
4201 E ARKANSAS AVE
DENVER CO 80222-3406

1495 COLORADO SPRINGS
5360 SOUTH RILEY LANE
SALT LAKE CITY UT 84107

~~HAMMERS CONSTRUCTION INC
1411 WOOLSEY HTS
COLORADO SPRINGS CO 80915-5400~~

HAMMERS CONSTRUCTION INC
1411 WOOLSEY HTS
COLORADO SPRINGS CO 80915-5400

HALLGREN PROPERTIES INC
5909 63RD ST
LUBBOCK TX 79424-2711

8250 REALTY LLC
PO BOX 31871
WEST PALM BEACH FL 33420-1871

CARMA AINA LLC
5840 CANTRELL CT
PARKER CO 80134-5801

(18)

VENTIMIGLIA DOROTHY B TRUST
PO BOX 618
LARKSPUR CO 80118-0618

CENTRAL MARKSHEFFEL
METROPOLITAN
455 E PIKES PEAK AVE STE 100
COLORADO SPRINGS CO 80903-3672

RK FAMILY INVESTMENTS LLC
4560 W 33RD AVE
DENVER CO 80212-1802

MALLERY LLC
7575 PINERY CIR
COLORADO SPRINGS CO 80908-2838

MALLERY LLC
7575 PINERY CIR
COLORADO SPRINGS CO 80908-2838

CASE INTERNATIONAL COMPANY
102 E PIKES PEAK AVE STE 200
COLORADO SPRINGS CO 80903-1818

STARR NANCY BARBER
5001 S CLINTON ST
ENGLEWOOD CO 80111-1333

CASE LENA GAIL
102 E PIKES PEAK AVE STE 200
COLORADO SPRINGS CO 80903

CASE LENA GAIL
102 E PIKES PEAK AVE STE 200
COLORADO SPRINGS CO 80903

CASE L G
2432 PARKVIEW LN
COLORADO SPRINGS CO 80906-1163

HAMMERS CONSTRUCTION INC
1411 WOOLSEY HTS
COLORADO SPRINGS CO 80915-5400

CARMA AINA LLC
5840 CANTRELL CT
PARKER CO 80134-5801

RODO INVESTMENTS LLC
20 BOULDER CRESCENT STE 200
COLORADO SPRINGS CO 80903-3300

CENTRAL MARKSHEFFEL
METROPOLITAN
455 E PIKES PEAK AVE STE 100
COLORADO SPRINGS CO 80903-3672

VENTIMIGLIA DOROTHY B TRUST
PO BOX 618
LARKSPUR CO 80118-0618

CENTRAL MARKSHEFFEL
METROPOLITAN
455 E PIKES PEAK AVE STE 100
COLORADO SPRINGS CO 80903-3672

MALLERY LLC
7575 PINERY CIR
COLORADO SPRINGS CO 80908-2838

MALLERY LLC
7575 PINERY CIR
COLORADO SPRINGS CO 80908-2838

STARR NANCY BARBER
5001 S CLINTON ST
ENGLEWOOD CO 80111-1333

CASE LENA GAIL
102 E PIKES PEAK AVE STE 200
COLORADO SPRINGS CO 80903

CASE LENA GAIL
102 E PIKES PEAK AVE STE 200
COLORADO SPRINGS CO 80903

CASE L G
2432 PARKVIEW LN
COLORADO SPRINGS CO 80906-1163

HAMMERS CONSTRUCTION INC
1411 WOOLSEY HTS
COLORADO SPRINGS CO 80915-5400

~~RODO INVESTMENTS LLC
20 BOULDER CRESCENT STE 200
COLORADO SPRINGS CO 80903-3300~~

~~CENTRAL MARKSHEFFEL
METROPOLITAN
455 E PIKES PEAK AVE STE 100
COLORADO SPRINGS CO 80903-3672~~

~~VENTIMIGLIA DOROTHY B TRUST
PO BOX 618
LARKSPUR CO 80118-0618~~

~~CENTRAL MARKSHEFFEL
METROPOLITAN
455 E PIKES PEAK AVE STE 100
COLORADO SPRINGS CO 80903-3672~~

~~RK FAMILY INVESTMENTS LLC
4560 W 33RD AVE
DENVER CO 80212-1802~~

~~LAND FIRST INC
1378 PROMONTORY BLUFF VW
COLORADO SPRINGS CO 80921-3945~~

~~MALLERY LLC
7575 PINERY CIR
COLORADO SPRINGS CO 80908-2838~~

~~MALLERY LLC
7575 PINERY CIR
COLORADO SPRINGS CO 80908-2838~~

~~CASE INTERNATIONAL COMPANY
102 E PIKES PEAK AVE STE 200
COLORADO SPRINGS CO 80903-1818~~

~~STARR NANCY BARBER
5001 S CLINTON ST
ENGLEWOOD CO 80111-1333~~

~~CASE LENA GAIL
102 E PIKES PEAK AVE STE 200
COLORADO SPRINGS CO 80903~~

~~CASE LENA GAIL
102 E PIKES PEAK AVE STE 200
COLORADO SPRINGS CO 80903~~

~~CASE L G
2432 PARKVIEW LN
COLORADO SPRINGS CO 80906-1163~~

~~HAMMERS CONSTRUCTION INC
1411 WOOLSEY HTS
COLORADO SPRINGS CO 80915-5400~~

~~8250 REALTY LLC
PO BOX 31871
WEST PALM BEACH FL 33420-1871~~

~~CARMA AINA LLC
5840 CANTRELL CT
PARKER CO 80134-5801~~

~~RODO INVESTMENTS LLC
20 BOULDER CRESCENT STE 200
COLORADO SPRINGS CO 80903-3300~~

~~CENTRAL MARKSHEFFEL
METROPOLITAN
455 E PIKES PEAK AVE STE 100
COLORADO SPRINGS CO 80903-3672~~

~~VENTIMIGLIA DOROTHY B TRUST
PO BOX 618
LARKSPUR CO 80118-0618~~

~~CENTRAL MARKSHEFFEL
METROPOLITAN
455 E PIKES PEAK AVE STE 100
COLORADO SPRINGS CO 80903-3672~~

~~MALLERY LLC
7575 PINERY CIR
COLORADO SPRINGS CO 80908-2838~~

~~MALLERY LLC
7575 PINERY CIR
COLORADO SPRINGS CO 80908-2838~~

~~STARR NANCY BARBER
5001 S CLINTON ST
ENGLEWOOD CO 80111-1333~~

~~CASE LENA GAIL
102 E PIKES PEAK AVE STE 200
COLORADO SPRINGS CO 80903~~

~~CASE LENA GAIL
102 E PIKES PEAK AVE STE 200
COLORADO SPRINGS CO 80903~~

~~CASE L G
2432 PARKVIEW LN
COLORADO SPRINGS CO 80906-1163~~

~~HAMMERS CONSTRUCTION INC
1411 WOOLSEY HTS
COLORADO SPRINGS CO 80915-5400~~