

**EL PASO**  **COUNTY**  
**COLORADO**

COMMISSIONERS:  
MARK WALLER (CHAIR)  
LONGINOS GONZALEZ, JR. (VICE-CHAIR)

HOLLY WILLIAMS  
STAN VANDERWERF  
CAMI BREMER

PLANNING AND COMMUNITY DEVELOPMENT DEPARTMENT  
CRAIG DOSSEY, EXECUTIVE DIRECTOR

December 13, 2020

RE: Claremont Business Park 2 Filing No. 1

File: SF-20-014

Parcel ID Nos.: 5405412001, 5405412004, 5405412002, 5405412003,  
5408101057

To Whom It May Concern:

This letter is to inform property owners adjacent to Claremont Business Park 2 Filing No. 1 subdivision that the applicants, Hammers Construction, Case LG, Nancy Starr, and Lena Case, have requested approval of an administrative final plat application to develop 10 commercial lots, rights-of-way, and open space and utility tracts within a 13.73 acre development area within the CS (Commercial Service) zoning district. The Planning and Community Development Director may make a formal decision regarding the request on 12/29/2020. Any comments or questions may be forwarded to me prior to that decision. At the discretion of the Planning and Community Development Director, the application may be elevated to the Board of County Commissioners for consideration. All administrative decisions, such as this one, may be appealed to the Board of County Commissioners within 30 days of the date of the decision.

You may view the application documents online at [www.epcdevplanreview.com](http://www.epcdevplanreview.com). Please feel free to contact me with any questions, comments, or concerns you may have prior to the decision.

Respectfully,



Lindsay Darden  
El Paso County Planning and Community Development  
719-520-6302  
Lindsaydarden@elpasoco.com

2880 INTERNATIONAL CIRCLE, SUITE 110  
PHONE: (719) 520-6300



COLORADO SPRINGS, CO 80910-3127  
FAX: (719) 520-6695

[www.ELPASOCO.COM](http://www.ELPASOCO.COM)

MEADOWBROOK PKWY

Market Value \$51,960

No Photo Available

5405412003

CASE

LENA

GAIL

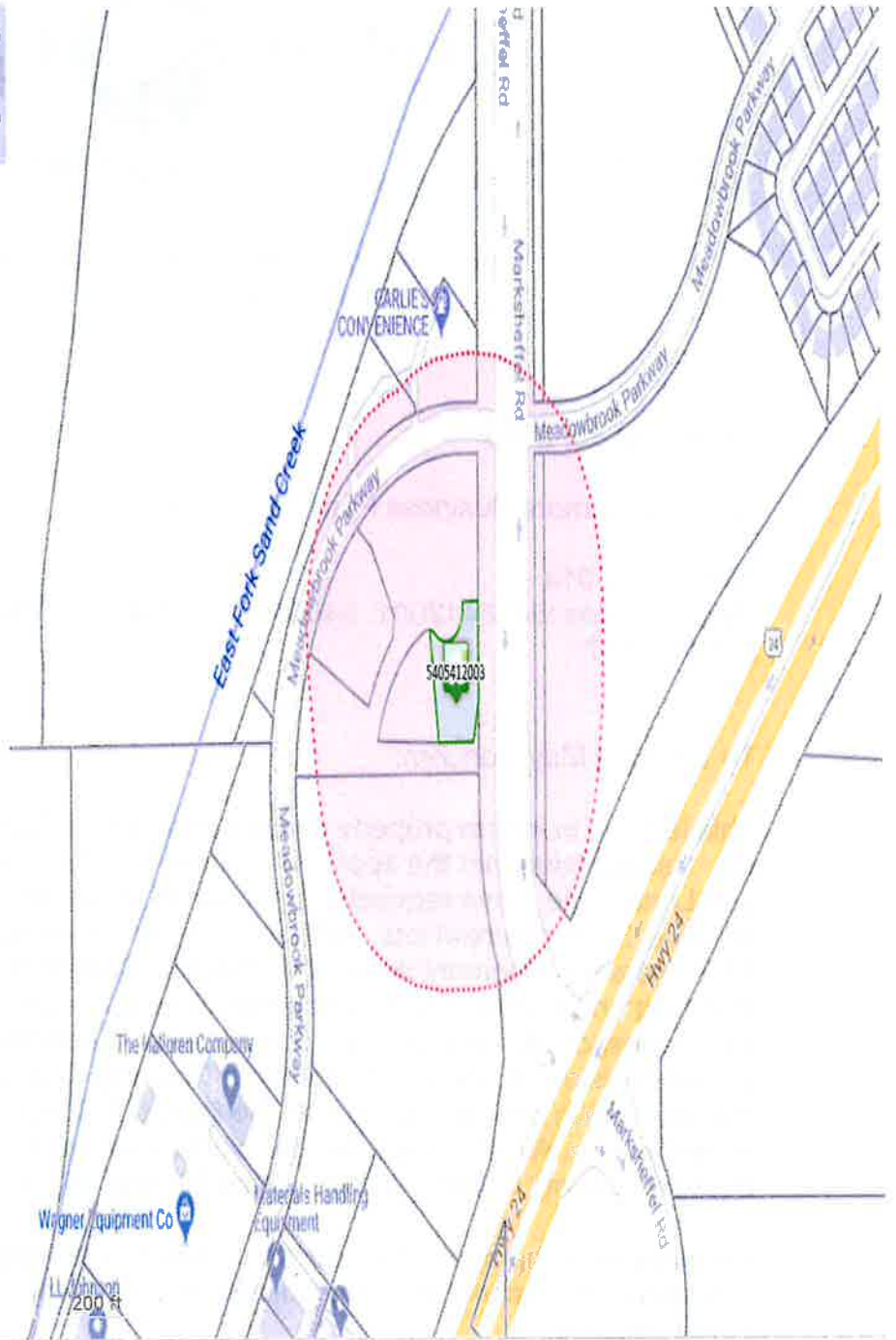

Disclaimer

We have made a good-faith effort to provide you with the most recent and most accurate information available. However, if you need to use this information in any legal or official venue, you will need to obtain official copies from the Assessor's Office. Do be aware that this data is subject to change on a daily basis. If you believe that any of this information is incorrect, please call us at (719) 520-6600.

El Paso County - Colorado

MEADOWBROOK PKWY

Market Value \$48,040



5405412002  
CASE  
LENA  
GAIL

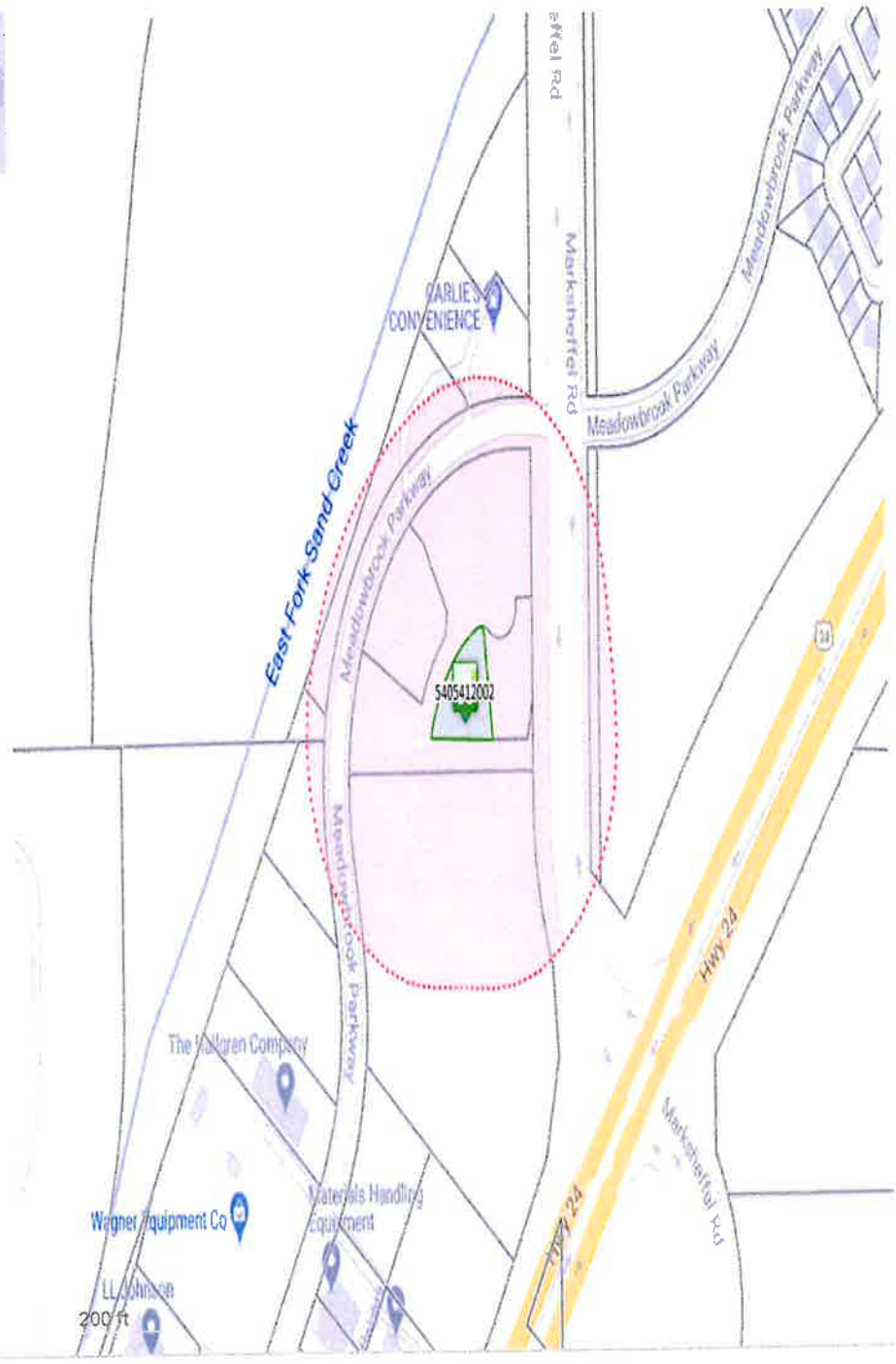

Disclaimer

We have made a good-faith effort to provide you with the most recent and most accurate information available. However, if you need to use this information in any legal or official venue, you will need to obtain official copies from the Assessor's Office. Do be aware that this data is subject to change on a daily basis. If you believe that any of this information is incorrect, please call us at (719) 520-6600.

MEADOWBROOK PKWY

Market Value \$249,272

No Photo Available

5405412004

CASE

L G

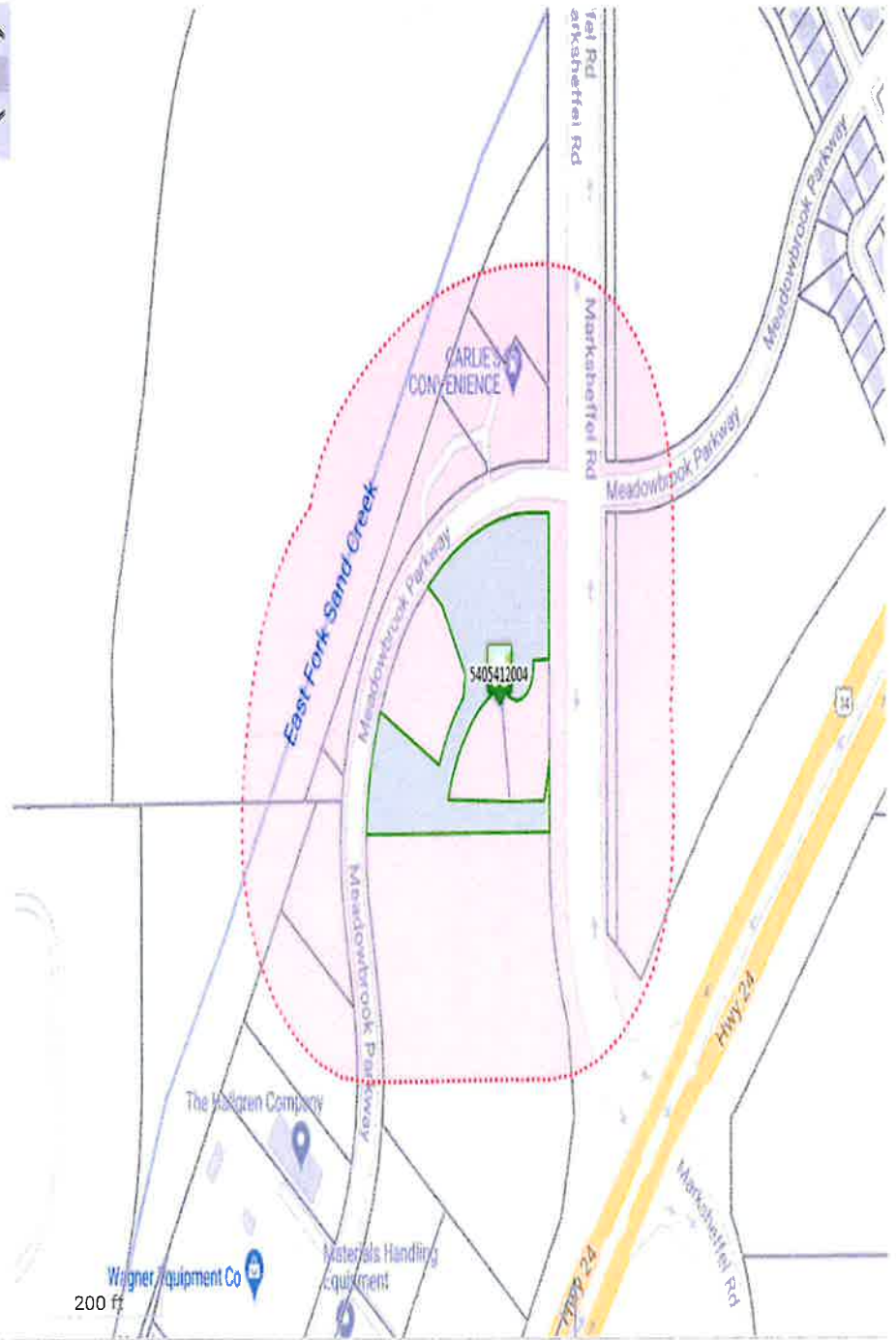

Disclaimer

We have made a good-faith effort to provide you with the most recent and most accurate information available. However, if you need to use this information in any legal or official venue, you will need to obtain official copies from the Assessor's Office. Do be aware that this data is subject to change on a daily basis. If you believe that any of this information is incorrect, please call us at (719) 520-6600.

El Paso County - Colorado

MEADOWBROOK PKWY

Market Value **\$89,842**

No Photo Available



5405412001

STARR  
NANCY  
BARBER,  
STARR  
JON

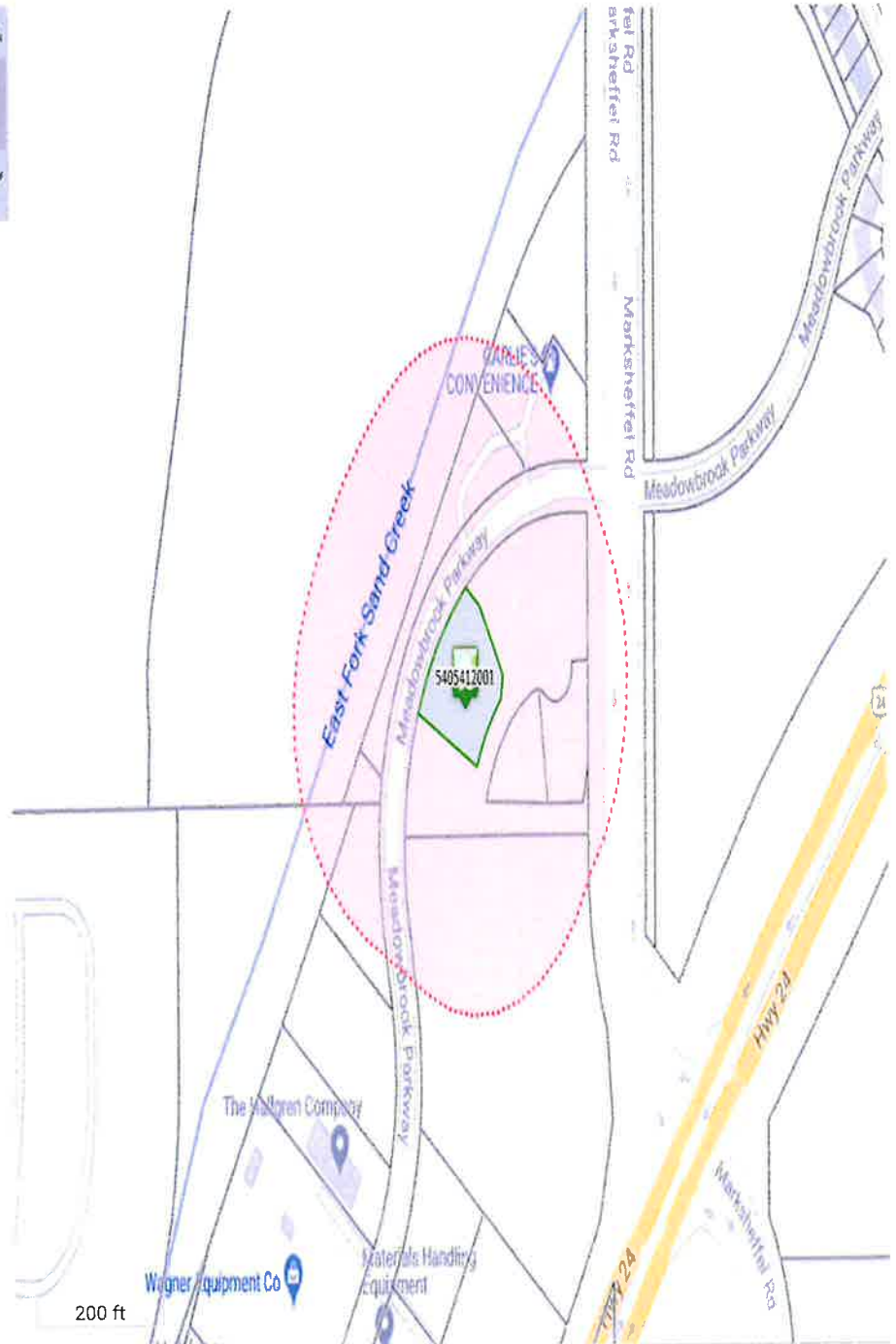

Disclaimer

We have made a good-faith effort to provide you with the most recent and most accurate information available. However, if you need to use this information in any legal or official venue, you will need to obtain official copies from the Assessor's Office. Do be aware that this data is subject to change on a daily basis. If you believe that any of this information is incorrect, please call us at (719) 520-6600.

1111 MEADOWBROOK PKWY

Market Value \$635,000

No Photo Available



5408101057  
HAMMERS  
CONSTRUCTION  
INC

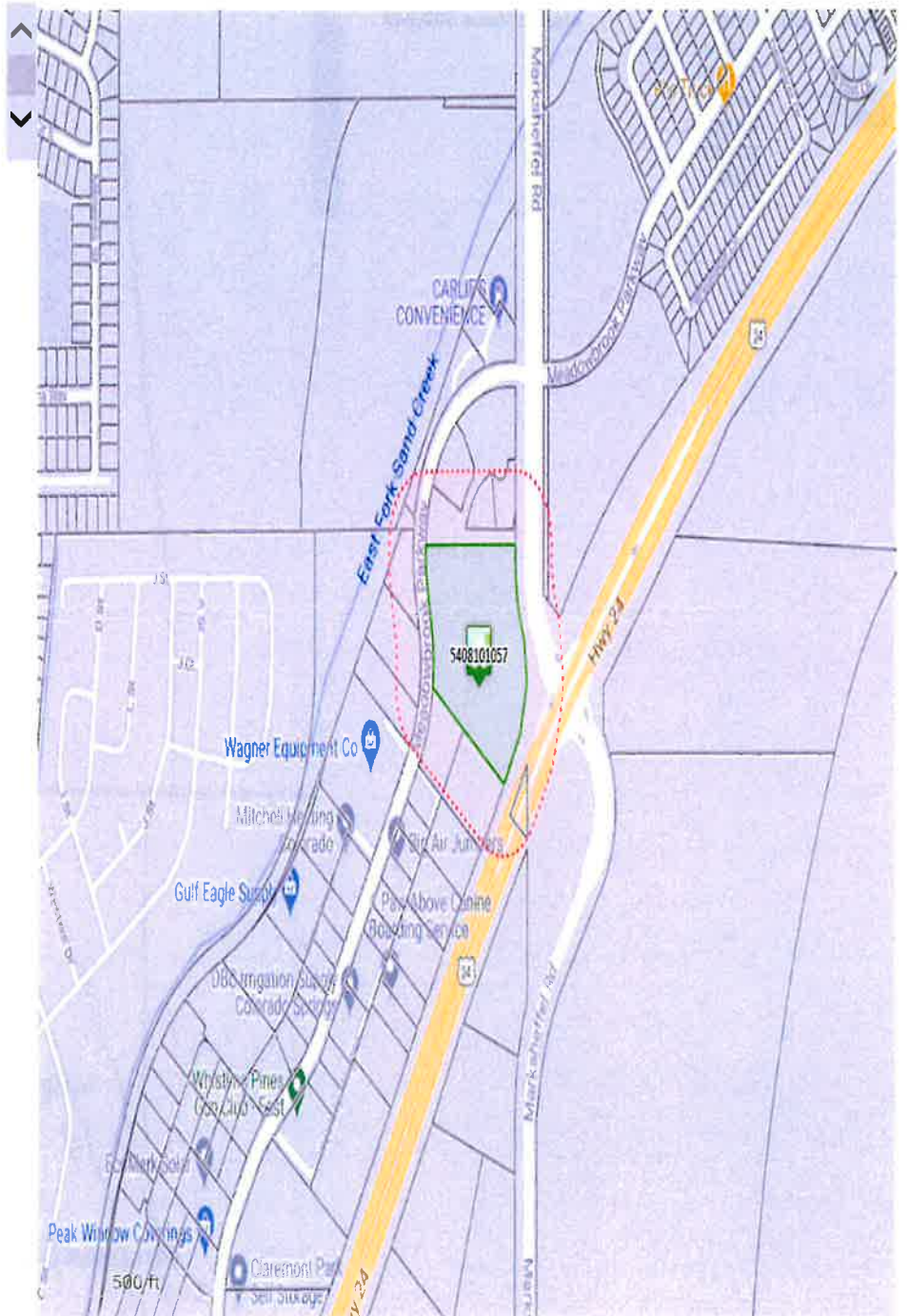

Disclaimer

We have made a good-faith effort to provide you with the most recent and most accurate information available. However, if you need to use this information in any legal or official venue, you will need to obtain official copies from the Assessor's Office. Do be aware that this data is subject to change on a daily basis. If you believe that any of this information is incorrect, please call us at (719) 520-6600.

EL PASO COUNTY

PLANNING AND COMMUNITY DEVELOPMENT DEPARTMENT  
2880 INTERNATIONAL CIRCLE, SUITE 110  
COLORADO SPRINGS, CO 80910

DENVER CO 802

17 DEC 2020 PM 9:11



PITNEY BOWES  
\$ 000.500  
02 1P  
0001977679 DEC 14 2020  
MAILED FROM ZIP CODE 80910

STATE OF COLORADO  
4201 E ARKANSAS AVE  
DENVER CO 80222-3406

*UTF*

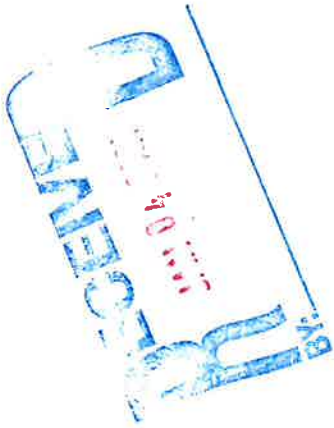

NIXIE 898 FE 1 0017/30/20

RETURN TO SENDER  
NOT DELIVERABLE AS ADDRESSED  
UNABLE TO FORWARD

SC: 80910314835 \*1720-00226-17-31

UTF  
802223406

