

FILE - ADD24348  
ZONING - RR-0.5  
PLAT - 2862  
APPROVED 712 SQ FT DECK

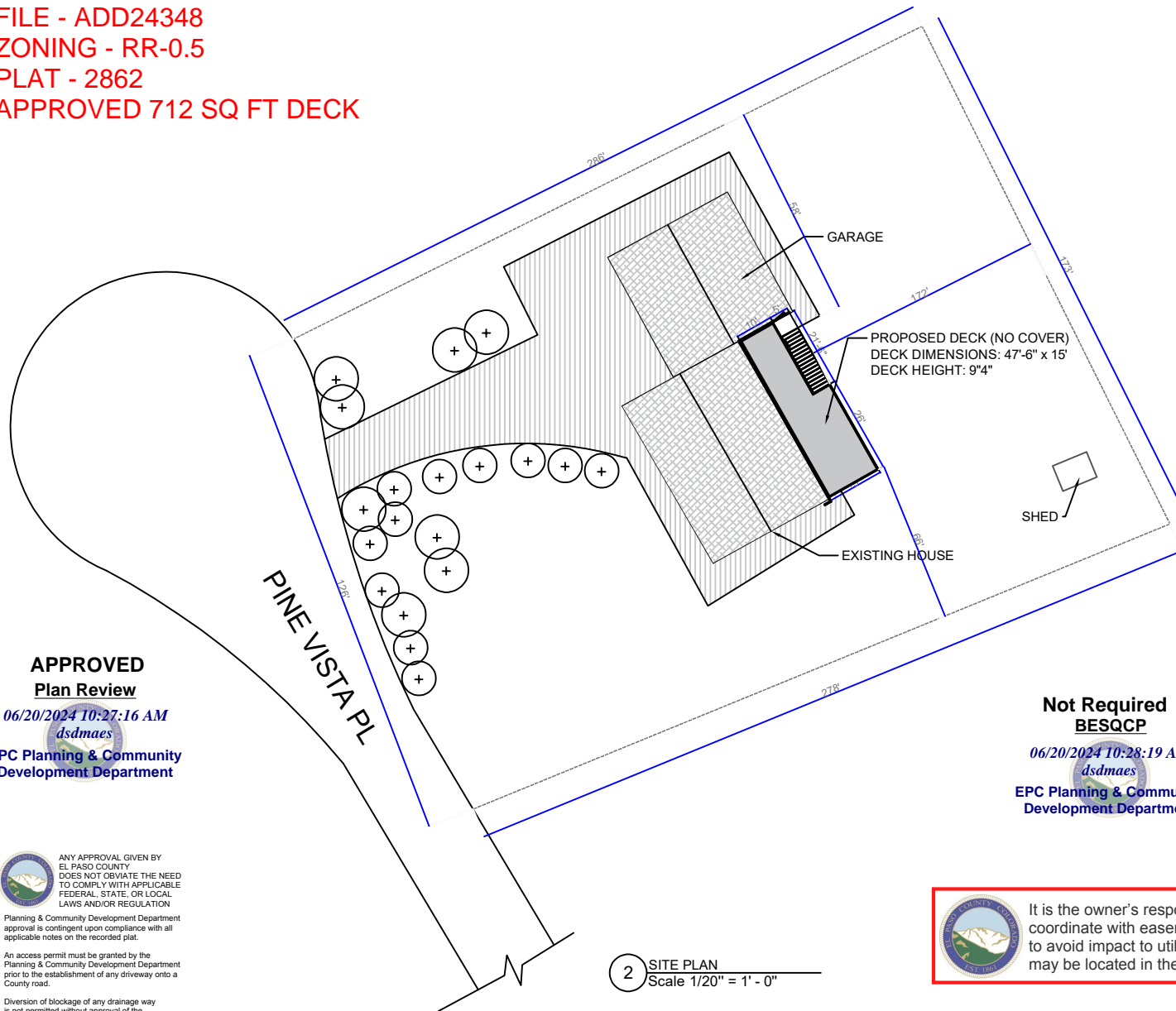

Revision	Date

ADDRESS: 18215 Pine Vista Place  
Colorado Springs, CO 80908

**APPROVED**  
**Plan Review**  
06/20/2024 10:27:16 AM  
*dsdmaes*  
EPC Planning & Community  
Development Department

**Not Required**  
**BESQCP**  
06/20/2024 10:28:19 AM  
*dsdmaes*  
EPC Planning & Community  
Development Department

SITE PLAN  
Scale 1/20" = 1' - 0"

ANY APPROVAL GIVEN BY  
EL PASO COUNTY  
DOES NOT OVIATE THE NEED  
TO COMPLY WITH APPLICABLE  
FEDERAL, STATE, OR LOCAL  
LAWS AND/OR REGULATION

Planning & Community Development Department  
approval is contingent upon compliance with all  
applicable notes on the recorded plat.

An access permit must be granted by the  
Planning & Community Development Department  
prior to the establishment of any driveway onto a  
County road.

Division of blockage of any drainage way  
is not permitted without approval of the  
Planning & Community Development Department

2 SITE PLAN  
Scale 1/20" = 1' - 0"

It is the owner's responsibility to  
coordinate with easement holders  
to avoid impact to utilities that  
may be located in the easements.

C000

# RESIDENTIAL



2023 PPRBC  
IECC: N/A

Parcel: 6114001010

Address: 18215 PINE VISTA PL, COLORADO SPRINGS

Plan Track #: 190930 

Received: 17-Jun-2024 (SIERRAC)

## Description:

**DECK - NEW**

Contractor: HOMEOWNER

Type of Unit:

## Required PPRBD Departments (2)

<p><b>Floodplain</b></p> <p>(N/A) RBD GIS</p>	<p><b>Construction</b></p>
---	----------------------------

## Required Outside Departments (1)

<p><b>County Zoning</b></p> <p><b>APPROVED</b> <b>Plan Review</b></p> <p>06/20/2024 10:29:11 AM <i>dsdmaes</i></p> <p>EPC Planning &amp; Community Development Department</p>
---

Release of this plan does not preclude compliance with all applicable codes, ordinances and other pertinent regulations. This plan set must be present on the job site for every inspection.