

Problem	Location	Date	Time	Time of Day
Traffic Accident	Peaceful Valley Rd / S Marksheffel Rd	Mon Jul 12, 2021	12:07:38 AM	Night
Traffic Accident	Lorson Blvd / S Marksheffel Rd	Mon Aug 16, 2021	9:36:43 AM	Day
Traffic Accident	Mesa Ridge Pkwy / S Marksheffel Rd	Fri Aug 20, 2021	1:19:01 PM	Day
Traffic Accident	Mesa Ridge Pkwy / S Marksheffel Rd	Thu Sep 02, 2021	8:11:03 PM	Night
Traffic Accident	Lorson Blvd / S Marksheffel Rd	Fri Sep 17, 2021	5:00:39 PM	Dusk
Traffic Accident	Mesa Ridge Pkwy / S Marksheffel Rd	Wed Oct 06, 2021	7:35:53 AM	Day
Ebound Closed for RIRO Island	Peaceful Valley Rd / S Marksheffel Rd	Mon Oct 11, 2021	6:00:00 AM	
Traffic Accident	Mesa Ridge Pkwy / S Marksheffel Rd	Thu Oct 28, 2021	4:15:23 PM	Day
Traffic Accident	Lorson Blvd / S Marksheffel Rd	Mon Nov 01, 2021	4:20:30 AM	Day
Traffic Accident	Peaceful Valley Rd / S Marksheffel Rd	Fri Nov 12, 2021	7:32:06 PM	Night
Traffic Accident	Poa Annua St / S Marksheffel Rd	Wed Dec 08, 2021	5:51:51 PM	Night
Traffic Accident	Lorson Blvd / S Marksheffel Rd	Wed Dec 08, 2021	6:28:46 PM	Night
Traffic Accident	Lorson Blvd / S Marksheffel Rd	Fri Dec 10, 2021	10:31:57 AM	Day
Traffic Accident	Peaceful Valley Rd / S Marksheffel Rd	Wed Dec 15, 2021	8:32:20 AM	Day
Traffic Accident	Peaceful Valley Rd / S Marksheffel Rd	Wed Jan 05, 2022	6:49:26 AM	Dawn
Traffic Accident	Lorson Blvd / S Marksheffel Rd	Sun Jan 09, 2022	9:07:10 PM	Night
Traffic Accident	Mesa Ridge Pkwy / S Marksheffel Rd	Tue Jan 18, 2022	4:58:50 PM	Dusk
Traffic Accident	Peaceful Valley Rd / S Marksheffel Rd	Thu Jan 27, 2022	12:15:16 PM	Day
Traffic Accident	Peaceful Valley Rd / S Marksheffel Rd	Thu Jan 27, 2022	1:19:37 PM	Day
Traffic Accident	Lorson Blvd / S Marksheffel Rd	Fri Jan 28, 2022	3:45:17 PM	Day
Traffic Accident	Peaceful Valley Rd / S Marksheffel Rd	Mon Feb 07, 2022	5:53:04 PM	Dusk
Traffic Accident	Lorson Blvd / S Marksheffel Rd	Fri Feb 11, 2022	10:04:45 PM	Night

02 Reported with Injuries
 08 Reported with No Injuries
 11 Reported with Unknown Injuries
21 Total Accidents

01 Poa Annua St / S Marksheffel Rd
 05 Mesa Ridge Pkwy / S Marksheffel Rd
 07 Peaceful Valley Rd / S Marksheffel Rd
 08 Lorson Blvd / S Marksheffel Rd

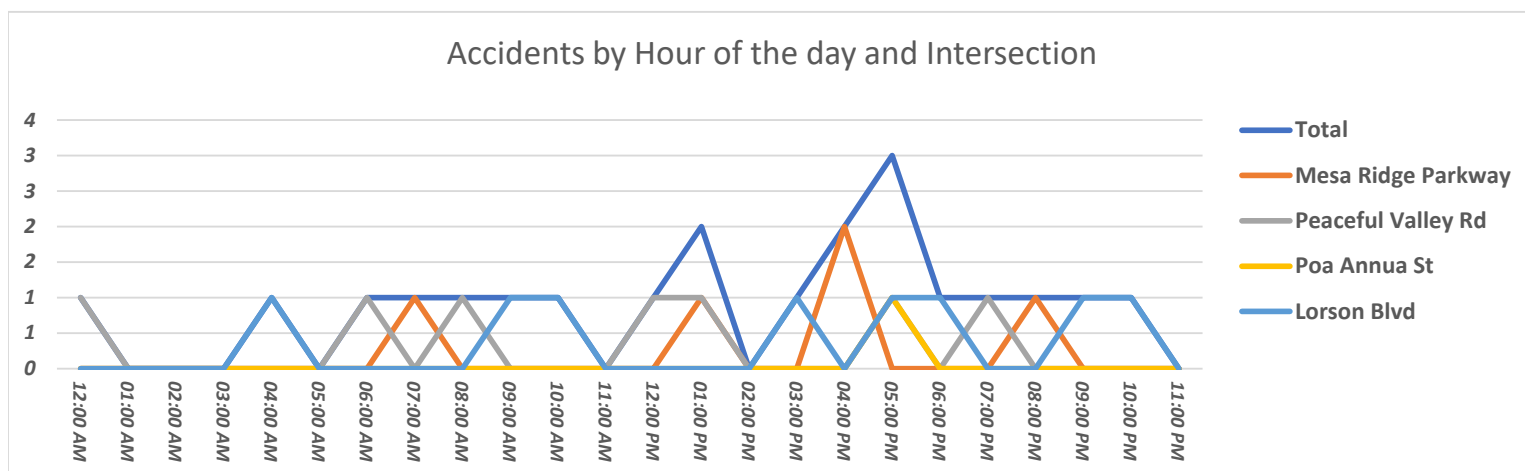

Filing #	Lots	Status	Running Total
07	148	Existing	148
08	101	Existing	249
09	106	Existing	355
10	40	Proposed	395
11	103	Proposed	498
12	79	Proposed	577
	577	Total	

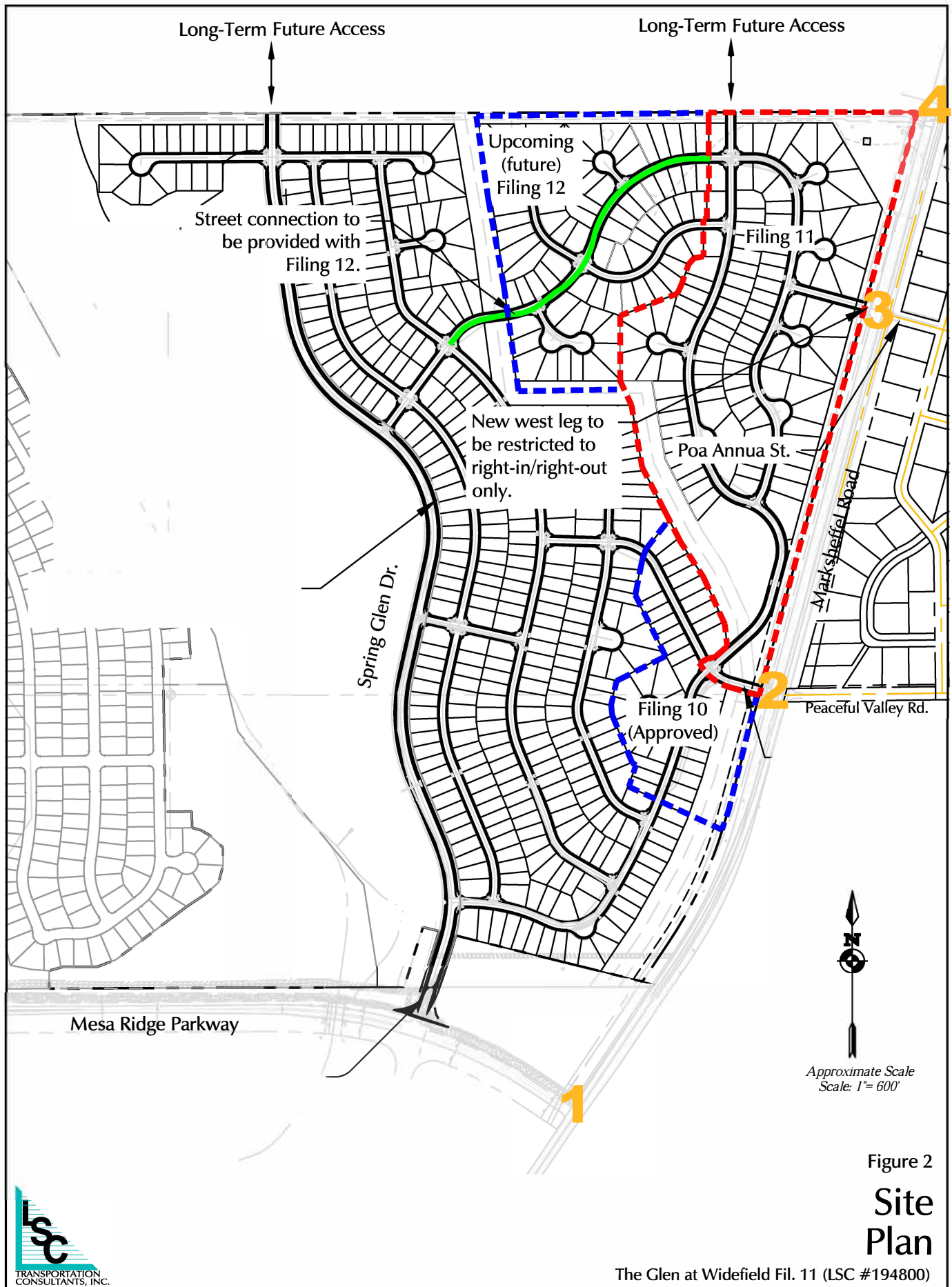

Intersection	w/ Marksheffel Rd	NorthBound	Time (secs)	SouthBound	Time (secs)	Distance (Ft)
1	Mesa Ridge Pwy	0.00	--	0.40	00:26	2112.00
2	Peaceful Valley Rd	0.40	00:26	0.34	00:22	1795.20
3	Poa Annoa	0.34	00:22	0.20	00:13	1056.00
4	Lorson Blvd	0.20	00:13	0.00	--	

Using 55 MPH | 55 mph = 80.666667 ft/s 01:02 0.94 01:02

Using 50 MPH | 50 mph = 73.333333 ft/s 01:08 +00:06

Using 45 MPH | 45 mph = 66 ft/s 01:15 +00:07

time = distance ÷ speed

AccidentDate	AccidentTime	NumberInjured	FIP	ReferencePointName	ReferencePointAtName	SuspectedAlcohol	AccidentNarrative
9/17/17	0:55	1	Injury	Mesa Ridge Parkway	Marksheffel Road	Yes	Vehicle #1 was eastbound on Mesa Ridge Parkway approaching a "T" style intersection with S. Marksheffel Road. Vehicle #1 disregarded a stop sign and continued straight across the intersection and off the end of the "T" intersection. Vehicle #1 traveled off road for about 24.3' and the front of the vehicle collided with a dirt embankment. After impact, vehicle #1 continued east for about 11.7' and the front of the vehicle collided with a barbed wire fence. Vehicle #1 traveled another 11.9' and came to rest in a field, on its wheels, facing east.

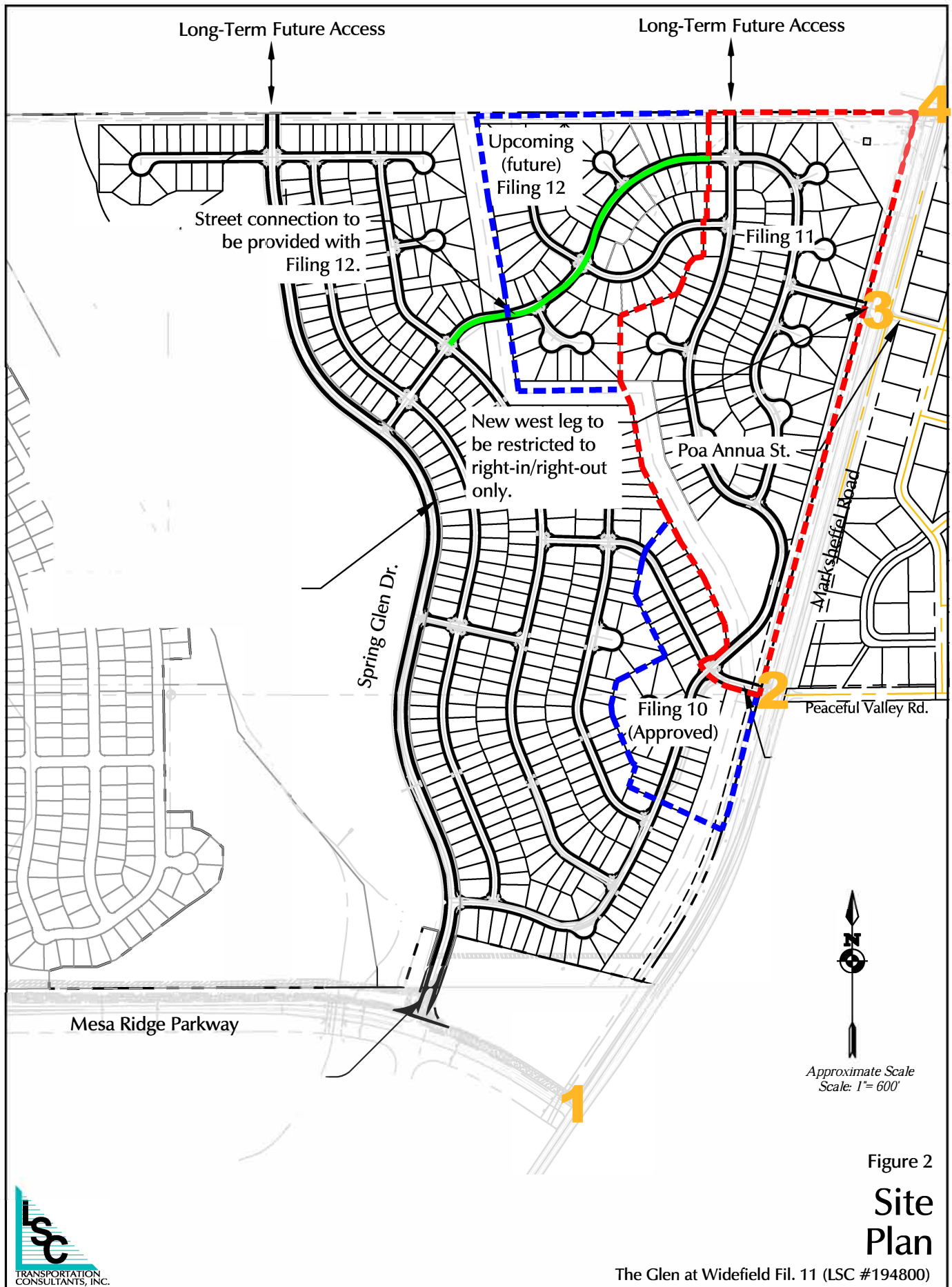

Intersection	w/ Marksheffel Rd	NorthBound	Time (secs)	SouthBound	Time (secs)	Distance (Ft)
1	Mesa Ridge Pwy	0.00	--	0.40	00:26	2112.00
2	Peaceful Valley Rd	0.40	00:26	0.34	00:22	1795.20
3	Poa Annoa	0.34	00:22	0.20	00:13	1056.00
4	Lorson Blvd	0.20	00:13	0.00	--	

Using 55 MPH | 55 mph = 80.666667 ft/s 01:02 0.94 01:02

Using 50 MPH | 50 mph = 73.333333 ft/s 01:08 +00:06

Using 45 MPH | 45 mph = 66 ft/s 01:15 +00:07

time = distance ÷ speed

AccidentDate	AccidentTime	NumberInjured	FIP	ReferencePointName	ReferencePointAtName	SuspectedAlcohol	AccidentNarrative
9/17/17	0:55	1	Injury	Mesa Ridge Parkway	Marksheffel Road	Yes	Vehicle #1 was eastbound on Mesa Ridge Parkway approaching a "T" style intersection with S. Marksheffel Road. Vehicle #1 disregarded a stop sign and continued straight across the intersection and off the end of the "T" intersection. Vehicle #1 traveled off road for about 24.3' and the front of the vehicle collided with a dirt embankment. After impact, vehicle #1 continued east for about 11.7' and the front of the vehicle collided with a barbed wire fence. Vehicle #1 traveled another 11.9' and came to rest in a field, on its wheels, facing east.