

THIS DOCUMENT AND ITS CONTENTS ARE THE WORK PRODUCT AND PROPERTY OF 51EC, INC., WHICH RETAINS ALL COMMON LAW, STATUTORY AND OTHER RESERVED RIGHTS, INCLUDING THE COPYRIGHT.

**NEW BUILD
INTELFAB
ELLIOTT COLORADO**

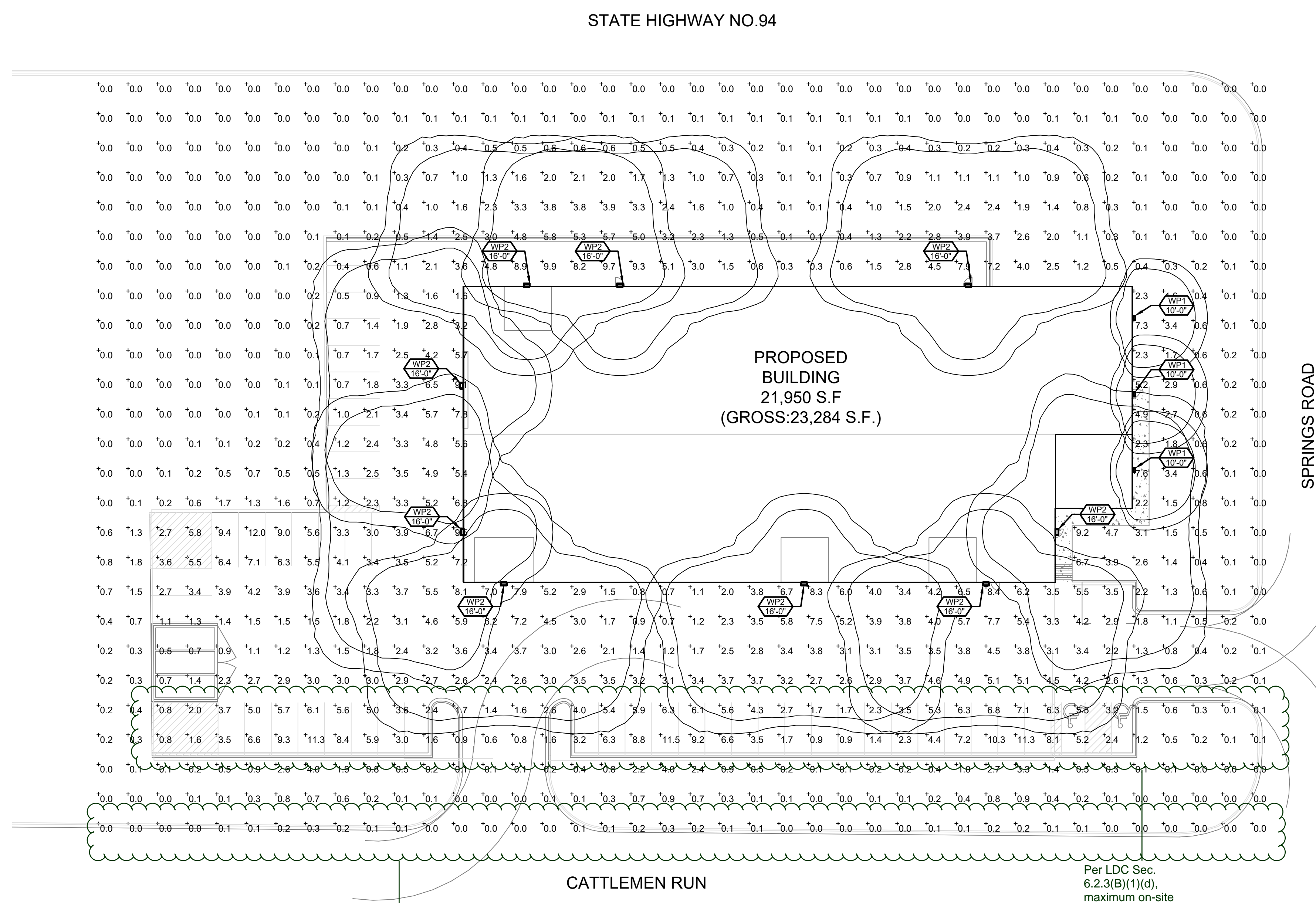

Per LDC Sec. 6.2.3(B)(1)(e), lighting shall not exceed 0.1 foot candles at property boundaries where adjacent to public right of way.

Per LDC Sec. 6.2.3(B)(1)(d), maximum on-site lighting shall not exceed 10 foot candles, except in loading areas, where 20 foot candles is allowed.

SITE PHOTOMETRIC PLAN
SCALE: 1" = 40'-0"

Statistics						
Description	Symbol	Avg	Max	Min	Max/Min	Avg/Min
Calc Zone #1	+	1.7 fc	12.0 fc	0.0 fc	N/A	N/A

Schedule											
Symbol	Label	QTY	Manufacturer	Catalog Number	Description	Lamp	Number Lamps	Filename	Lumens per Lamp	LLF	Wattage
WP1	WP1	3	Lithonia Lighting	WDGE2 LED P2 40K 80CRI VF	WDGE2 LED WITH P2 - PERFORMANCE PACKAGE, 4000K, 80CRI, VISUAL COMFORT FORWARD OPTIC		1	WDGE2_LED_P2_40K_80CRI_VF.ies	2023	0.92	14.53
WP2	WP2	9	Lithonia Lighting	WDGE3 LED P4 70CRI R4 40K	WDGE3 LED WITH P4 - PERFORMANCE PACKAGE, 4000K, 70CRI, TYPE 4 OPTIC		1	WDGE3_LED_P4_70CRI_R4_40K.ies	12537	0.92	87.8914

REV	DESCRIPTION	DRAWN	CHECK	APPR	DATE

ISSUANCE:
ISSUED FOR REVIEW

CLIENT:
HAMMERS CONSTRUCTION
1411 WOOLSEY HEIGHTS
COLORADO SPRINGS, CO 80915

ARCHITECT:
HAMMERS CONSTRUCTION
1411 WOOLSEY HEIGHTS
COLORADO SPRINGS, CO 80915

PROJECT NO:
5151-20-02

TITLE:
PHOTOMETRICS

SHEET NO:
9 OF 11

