

MONUMENT
ACADEMY
HIGH SCHOOL

FOR CONSTRUCTION

PARCEL
#61100-01-011
THOMAS, ANNETTE
5.3 AC.

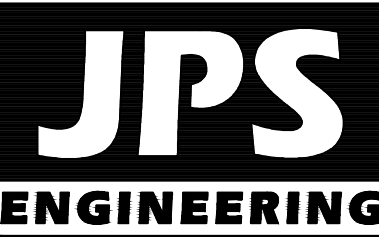
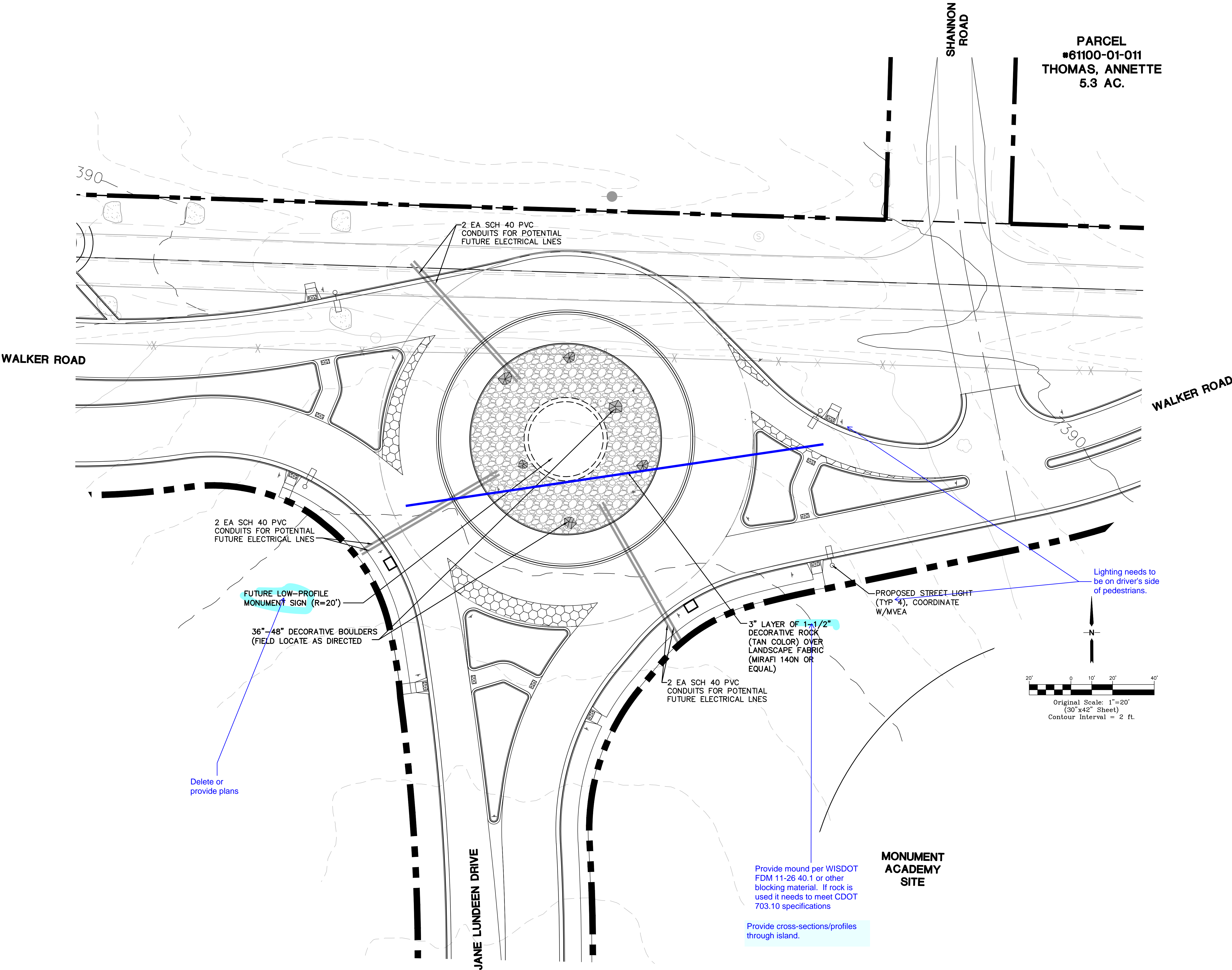

19 E. Willamette Ave.
Colorado Springs, CO
80903
PH: 719-477-9429
FAX: 719-471-0766
www.jpsengr.com

OWNERSHIP OF INSTRUMENTS OF SERVICE:
ALL REPORTS, PLANS, SPECIFICATIONS, COMPUTER FILES, FIELD
DATA, NOTES AND OTHER DOCUMENTS AND INSTRUMENTS
PREPARED BY DESIGN PROFESSIONAL AS INSTRUMENTS OF
SERVICE SHALL REMAIN THE PROPERTY OF THE DESIGN
PROFESSIONAL. THE DESIGN PROFESSIONAL SHALL RETAIN ALL
COMMON LAW STATUTORY AND OTHER RESERVED RIGHTS
INCLUDING THE COPYRIGHT THEREON.

CRP ARCHITECTS AIA
100 E. St. Vrain, Suite 300
Colorado Springs, Colorado 80903

WALKER ROAD & JANE
LUNDEEN DRIVE
ROUNDBOUT
PH. 1 LANDSCAPE &
LIGHTING PLAN
SCALE : 1"=20'

NORTH
DATE: 6/26/19
DRAWN BY: BJJ
CHECKED BY: JPS
REVISED: 8/04/20

NO.	REVISION	BY	DATE
1	COUNTY SUBMITTAL	JPS	8/04/20

PCD PROJECT NO. CDR-20-001

RD1.2

LEGEND

PROPERTY LINE
EASEMENT
6520 PROPOSED CONTOUR
6520 EXISTING CONTOUR
99.0 PROPOSED SPOT
ELEVATION (FLOWLINE)
99.0 EXIST. SPOT ELEVATION

For lighting see:
<https://wisconsin.gov/dtsdManuals/traffic-ops/manuals-and-standards/teops/11-04.pdf>

Provide mound per WISDOT
FDM 11-26 40.1 or other
blocking material. If rock is
used it needs to meet CDOT
703.10 specifications

Provide cross-sections/profiles
through island.

Delete or
provide plans