

1576 ELEVATION
 AVERAGE FINISH GRADE = (AFG)
 $AFG = \frac{59.9 + 59.7 + 59.8(2) + 59.2(2)}{6} = 59.5$
 BUILDING HEIGHT = 20.4 + (TF - AFG) =
 BUILDING HEIGHT = 20.4 + (60.4 - 59.5) = 21.3

Released for Permit

04/14/2026 10:46:19 AM



Becky A
 ENUMERATION



SFD26339
 PLAT 15140
 PUD

APPROVED
 Plan Review

04/15/2026 2:02:55 PM

dsdhills

EPC Planning & Community
 Development Department

APPROVED
 BESQCP

04/15/2026 2:03:01 PM

dsdhills

EPC Planning & Community
 Development Department



It is the owner's responsibility to coordinate with easement holders to avoid impact to utilities that may be located in the easements.



ANY APPROVAL GIVEN BY EL PASO COUNTY DOES NOT OBLIVATE THE NEED TO COMPLY WITH APPLICABLE FEDERAL, STATE, OR LOCAL LAWS AND/OR REGULATION

Planning & Community Development Department approval is contingent upon compliance with all applicable notes on the recorded plat.

An access permit must be granted by the Planning & Community Development Department prior to the establishment of any driveway onto a County road.

Diversion of blockage of any drainage way is not permitted without approval of the Planning & Community Development Department

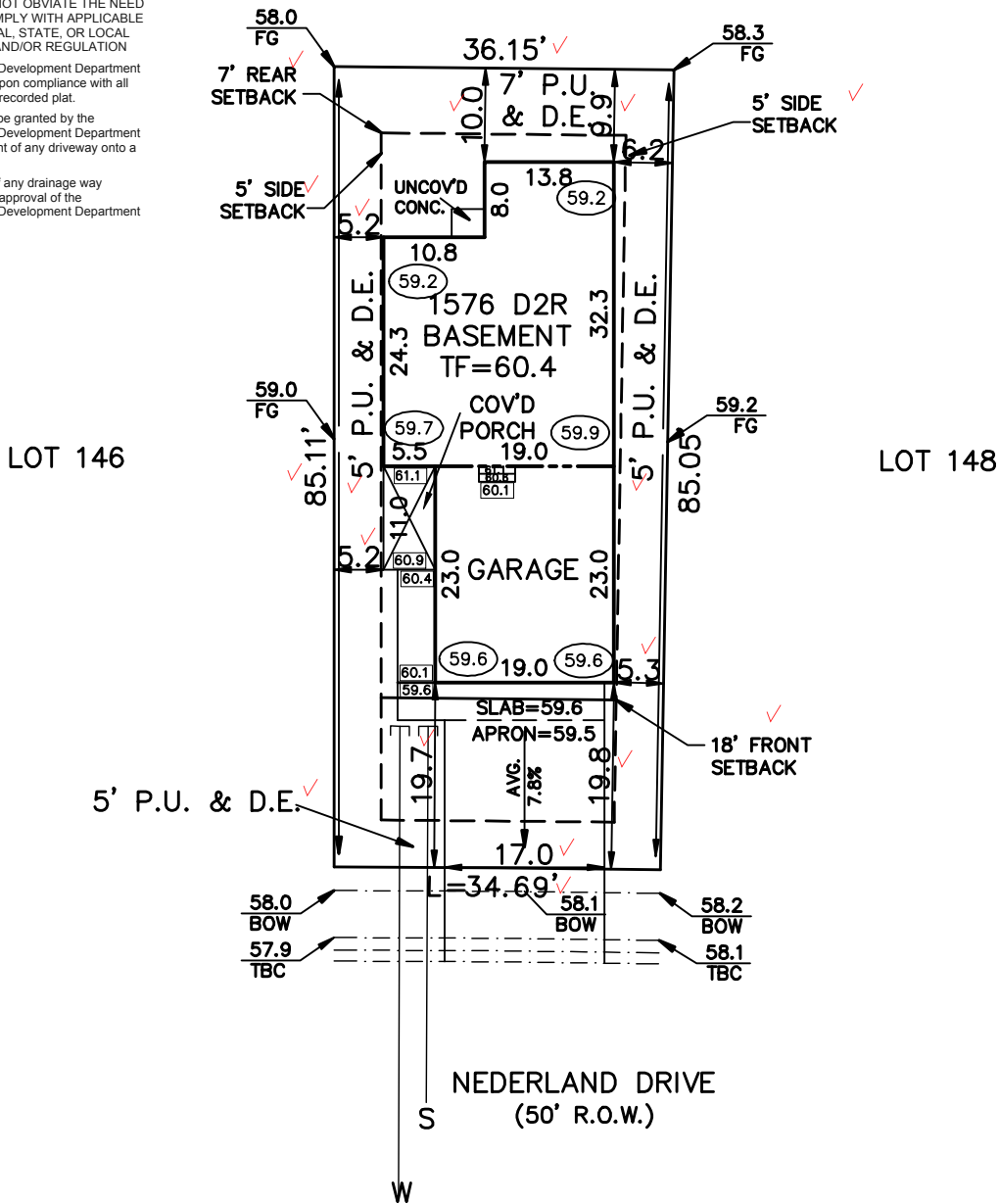

SCHEDULE No. 4220407026 ✓

WARNING! 1. LOCATE UNDERGROUND UTILITIES PRIOR TO EXCAVATION. 2. THIS PLOT PLAN SHOWS IMPROVEMENTS AT GRADE ONLY. SEE FOUNDATION PLANS FOR STRUCTURAL INFORMATION.	SITE DATA LOT SQ. FT. = 3025 ✓ HOUSE SQ. FT. = 1290 ✓ COVERAGE = 42.6% ✓ BLDG. HEIGHT = 21.3	PLOT PLAN	
	LEGAL DESCRIPTION LOT 147 ✓ The Sanctuary Filing No. 1 at Meridian Ranch ✓ EL PASO COUNTY, COLORADO		
ASPEN LAND CONSULTANTS, LLC 11670 SILVER CHARM WAY COLORADO SPRINGS, COLORADO 80921		ADDRESS 13545 NEDERLAND DRIVE ✓	
		SCALE: ...1"=20' DRAWN BY: TAP	TITLE CO. FILE NO. DATE 04-06-26
		DRAWING NAME S1MR-147	PROJECT NO.

SITE



2023 PPRBC
2021 IECC Amended

Address: 13545 NEDERLAND DR, PEYTON

Parcel: 4220407026

Plan Track #: 212121 

Received: 14-Apr-2026 (BECKYA)

Description:

RESIDENCE

Type of Unit:

Garage	437	
Lower Level 2	632	
Main Level	706	
Upper Level 1	870	
	2645	Total Square Feet

Required PPRBD Departments (3)

Enumeration

APPROVED

BECKYA

4/14/2026 10:46:32 AM

Floodplain

(N/A) RBD GIS

Construction

Required Outside Departments (1)

County Zoning

APPROVED

Plan Review

04/15/2026 2:06:39 PM



**EPC Planning & Community
Development Department**

Release of this plan does not preclude compliance with all applicable codes, ordinances and other pertinent regulations. This plan set must be present on the job site for every inspection.