

Site Development Plan_V2 REDLINES.pdf Markup Summary

edebr (1)

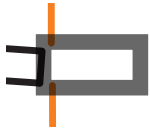

Subject: Rectangle
Page Label: 1
Author: edebr
Date: 5/27/2022 1:29:46 PM
Status:
Color: ■
Layer:
Space:

Steve Prideaux (12)

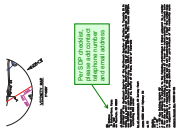

Subject: Callout
Page Label: 1
Author: Steve Prideaux
Date: 6/10/2022 6:09:23 AM
Status:
Color: ■
Layer:
Space:

Per SDP checklist, please add contact telephone number and email address

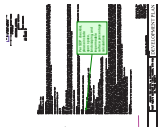

Subject: Callout
Page Label: 1
Author: Steve Prideaux
Date: 6/21/2022 1:16:31 PM
Status:
Color: ■
Layer:
Space:

Per SDP checklist, please include open space, landscaping, and impermeable surface percentage calculations

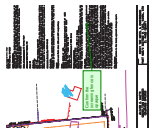

Subject: Callout
Page Label: 1
Author: Steve Prideaux
Date: 6/21/2022 1:18:36 PM
Status:
Color: ■
Layer:
Space:

Confirm the screening fence is opaque

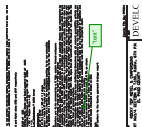

Subject: Callout
Page Label: 1
Author: Steve Prideaux
Date: 6/21/2022 1:19:35 PM
Status:
Color: ■
Layer:
Space:

"tent"

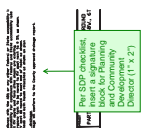

Subject: Callout
Page Label: 1
Author: Steve Prideaux
Date: 6/21/2022 1:36:56 PM
Status:
Color: ■
Layer:
Space:

Per SDP checklist, insert a signature block for Planning and Community Development Director (1" x 2")



Subject: Group
Page Label: 1
Author: Steve Prideaux
Date: 6/21/2022 2:13:01 PM
Status:
Color: ■
Layer:
Space:

Per SDP checklist, cite both "existing" and "proposed" zoning and land use- even if remaining the same



Subject: Callout
Page Label: 1
Author: Steve Prideaux
Date: 6/22/2022 10:10:00 AM
Status:
Color: ■
Layer:
Space:

Per SDP checklist, a graphical depiction of the screening mechanism is required on the site development plan.

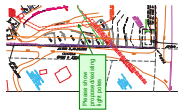

Subject: Callout
Page Label: 1
Author: Steve Prideaux
Date: 6/22/2022 10:10:16 AM
Status:
Color: ■
Layer:
Space:

Please show proposed/existing light poles

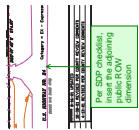

Subject: Callout
Page Label: 1
Author: Steve Prideaux
Date: 6/22/2022 5:36:59 AM
Status:
Color: ■
Layer:
Space:

Per SDP checklist, insert the adjoining public ROW dimension



Subject: Group
Page Label: 1
Author: Steve Prideaux
Date: 6/22/2022 5:43:28 AM
Status:
Color: ■
Layer:
Space:

Per SDP checklist, please show ADA pathways



Subject: Callout
Page Label: 1
Author: Steve Prideaux
Date: 6/22/2022 9:48:39 AM
Status:
Color: ■
Layer:
Space:

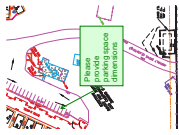

Subject: Callout
Page Label: 1
Author: Steve Prideaux
Date: 6/22/2022 9:48:50 AM
Status:
Color: ■
Layer:
Space:

Please provide parking space dimensions

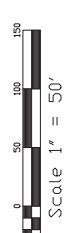

- EXISTING WATER HOOK-UP
 - EXISTING ELECTRIC HOOK-UP
 - TRASH DUMPSTER
 - EXISTING PRIVATE PAD AT EAST CORNER
 - PROPOSED PRIVACY FENCE (6' DPANEL)
- CONTOUR LEGEND:
- 1' ORIGINAL CONTOURS
 - 1' FINISH CONTOURS
 - 2' FINISH CONTOURS
 - 5' FINISH CONTOURS

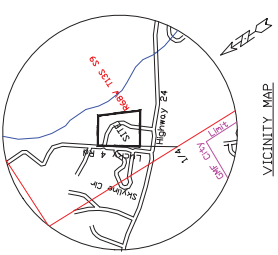

Per SDP checklist, please add contact telephone number and email address

Per SDP checklist, cite both "existing" and "proposed" zoning and land use- even if remaining the same

Per SDP checklist, please show ADA pathways

Please provide parking space dimensions

Per SDP checklist, please show ADA pathways

Per SDP checklist, provide setback distances to property line from each existing and proposed structure

Per SDP checklist, a graphical depiction of the screening mechanism is required on the site development plan.

Please show proposed/existing light poles

Per SDP checklist, please include open space, landscaping, and impermeable surface percentage calculations

"tent"

Per SDP checklist, insert a signature block for Planning and Community Development Director (1" x 2")

Prepared by the office of:
 Oliver E. Watts, Consulting Engineer, Inc.
 614 Elkton Drive
 Colorado Springs, CO 80907
 Phone: (719) 595-8079
 Celebrating 42 years in Business

County File No. PRR244

DEVELOPMENT PLAN

ROUND
 8W., 6TH P.M.

PROJECT PART

OLIVER E. WATTS
 CONSULTING ENGINEER
 COLORADO SPRINGS

REVISION	DATE	DESCRIPTION
REV 1	08/15/24	PER COUNTY REVIEW COMMENTS
REV 2	08/22/24	PER COUNTY REVIEW COMMENTS
REV 3	09/05/24	PER COUNTY REVIEW COMMENTS
REV 4	09/12/24	PER COUNTY REVIEW COMMENTS

APPROVED BY:
 DATE: 8-16-24
 PROJECT NO.: 24
 SHEET NO.: 01 OF 02
 DRAWN BY: J.E.W.
 CHECKED BY: J.E.W.
 SCALE: AS SHOWN

U.S. HIGHWAY NO. 24
 Category = EX - Expressway/No. Bypass
 (FROM 810 PAGE 473)

Δ=0102°10'
 R=1692.10'
 CH=1657'08.52" W
 CB=88.34'

Per SDP checklist, insert the adjoining public ROW dimension

