

EL PASO



COUNTY

COMMISSIONERS:
DARRYL GLENN (PRESIDENT)
MARK WALLER (PRESIDENT PRO TEMPORE)

STAN VANDERWERF
LONGINOS GONZALEZ
PEGGY LITTLETON

PLANNING AND COMMUNITY DEVELOPMENT DEPARTMENT
CRAIG DOSSEY, EXECUTIVE DIRECTOR

August 3, 2018

RE: Special Use Request for Chuckie's Place d/b/a/ Reigning Hope Therapy Services of Colorado

File: AL1815, Reigning Hope Commercial Stables
Parcel ID: 52060-00-040

To Whom It May Concern:

This letter is to inform property owners adjacent to 14445 Holms Road that they have requested a special use to allow for a Commercial Stable within the RR-5 (Residential Rural) zoning district. The Planning and Community Development Director may make a formal decision regarding the request on August 20, 2018 at 4:30 P.M. Any comments or questions may be forwarded to me prior to that decision. At the discretion of the Planning and Community Development Director, the approval process may be elevated to the Board of County Commissioners for consideration. Administrative approval by the Planning and Community Development Director is subject to the appeal provisions of the Land Development Code.

You may view the application documents online at www.epcdevplanreview.com. Please feel free to contact me with any questions, comments, or concerns you may have prior to the decision.

Respectfully,

Len Kendall, Planner I
El Paso County Planning and Community Development
719-520-6447
lenkendall@elpasoco.com

*copied, mailed
8/6/2018 JK*

2880 INTERNATIONAL CIRCLE, SUITE 110
PHONE: (719) 520-6300



COLORADO SPRINGS, CO 80910-3127
FAX: (719) 520-6695

www.ELPASOCO.COM

----- El Paso County Parcel Information -----

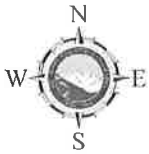
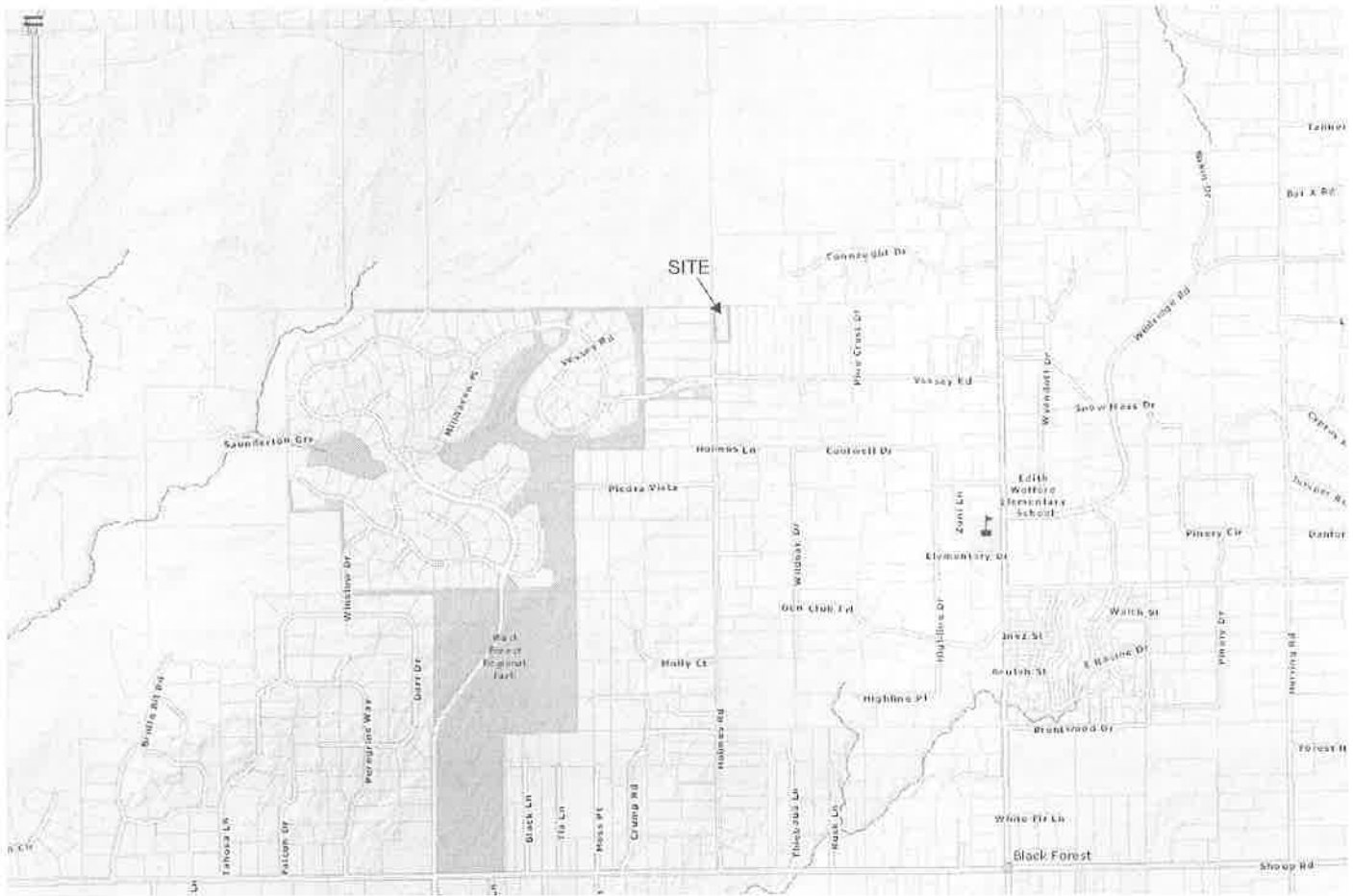

COPYRIGHT 2018 by the Board of County Commissioners, El Paso County, Colorado. All rights reserved. No part of this document or data contained hereon may be reproduced; used to prepare derivative products; or distributed without the specific written approval of the Board of County Commissioners, El Paso County, Colorado. This document was prepared from the best data available at the time of printing. El Paso County, Colorado, makes no claim as to the completeness or accuracy of the data contained hereon.

Parcel: 5206000040

Name: HOFFMAN CRAIG
HOFFMAN SUSANNE

City: Colorado Springs

State: CO

Zip: 80908-3344

Filename: AL-18-015

Zone Map Number: 55192

Date: December 28, 2017

Please report any parcel discrepancies to:
El Paso County Assessor
1675 W. Garden of the Gods Rd.
Colorado Springs, CO 80907
(719) 520-6600

6201000002
ERNST CHARLES H
14410 HOLMES RD
COLORADO SPRINGS, CO 80908

5206000040
HOFFMAN CRAIG
14090 HOLMES RD
COLORADO SPRINGS, CO 80908

5206000039
HOFFPAUIR DAN W JR
14495 HOLMES RD
COLORADO SPRINGS, CO 80908

5100000437
JONES INGRID L
5940 VESSEY RD
COLORADO SPRINGS, CO 80908

5206000041
MCGOWAN PATRICK J JR
14355 HOLMES RD
COLORADO SPRINGS, CO 80908

6100000075
PRI #2 LLC
6385 CORPORATE DR
COLORADO SPRINGS, CO 80919

6201003001
THOMAS JOHN K
PO BOX 88193
COLORADO SPRINGS, CO 80908

6201003006
THOMAS JOHN K
PO BOX 88193
COLORADO SPRINGS, CO 80908

6201000003
VEREECKE JEREMY
14350 HOLMES RD
COLORADO SPRINGS, CO 80908