



Chavez Tiffany & Ayers
Engineering Corporation

611 North Nevada Avenue
Colorado Springs, Colorado 80903
P (719) 636-0021



MESA RIDGE SUBDIVISION
PHOTOMETRIC PLAN
COLORADO SPRINGS, COLORADO

Luminaire Schedule						
Symbol	Qty	Label	ILF	Description	Tag	Height
+	8	B	0.855	FM2-24LU-3K-XX	HUBBELL	3'-6"
+	22	A3	0.855	VPS-36L-65-3K7-4W	BEACON	16'-0"
+	1	A4	0.855	VPS-36L-65-3K7-4W	BEACON	16'-0"
○	108	D	0.855	1000L DOWNLIGHT	OSTWIN	10'-0"
○	14	G	0.855	P5607-31	PROGRESS	5'-0"

Calculation Summary						
Label	CalcType	Units	Avg	Max	Min	Avg/Min
Light Footcandle	FC	fc	0.00	0.0	0.0	N.A.
Property Line	Illuminance	fc	0.52	11.1	0.0	N.A.

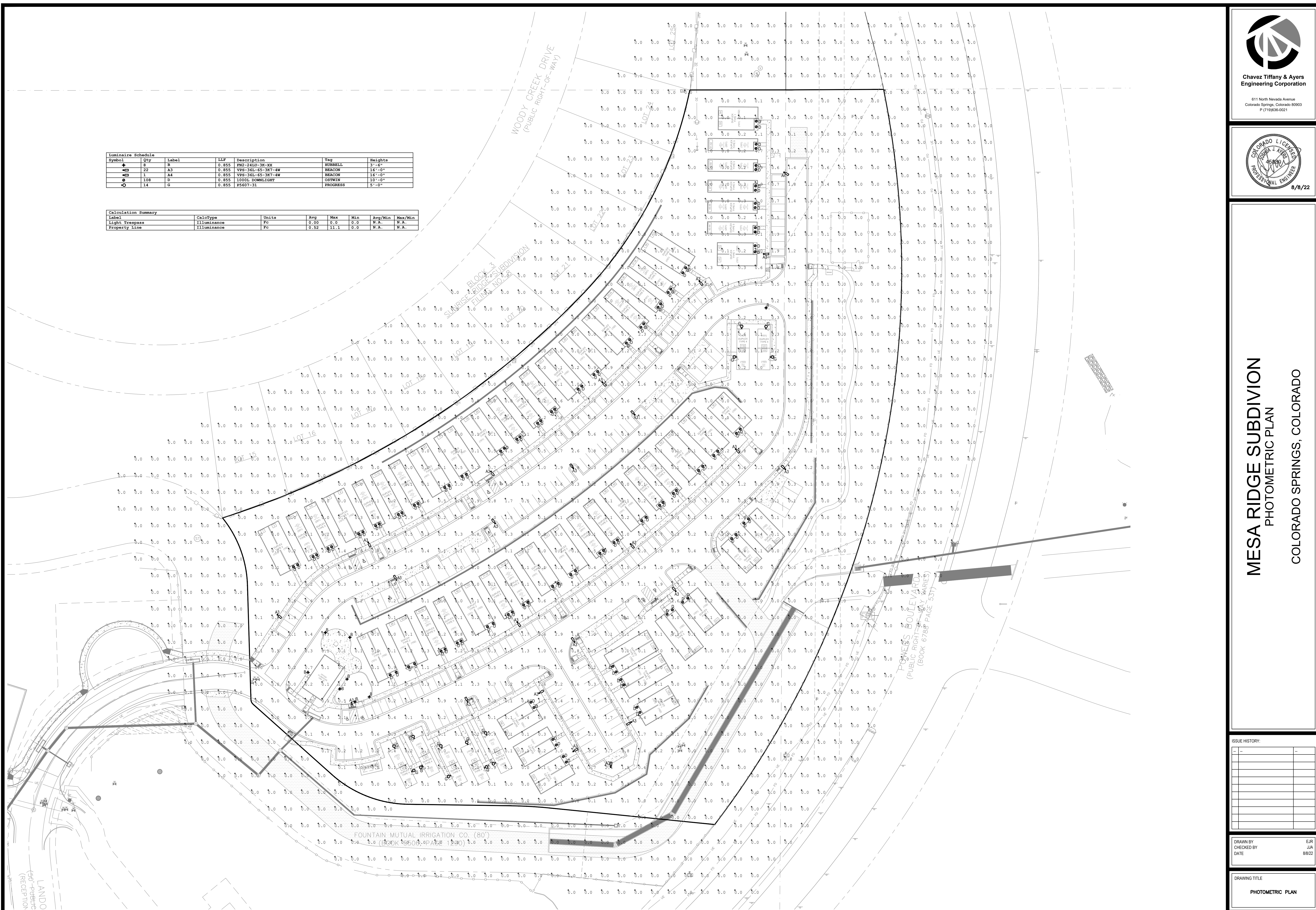

1 PHOTOMETRIC PLAN
DPE-1 SCALE: 1"=40'-0"

ISSUE HISTORY:	

DRAWN BY: EJR
CHECKED BY: JJA
DATE: 8/8/22

DRAWING TITLE:
PHOTOMETRIC PLAN

DRAWING NO.:
DPE-1

BEACON
SMALL VIPER LUMINAIRE

VIPER S
SMALL VIPER LUMINAIRE

FEATURES

- Small size companion to Viper Large
- Wide choice of different LED wattage configurations
- Nine optical solutions
- Designed to replace H&J lighting up to 40W MH or HPS
- Suitable for wet locations



CONTROL TECHNOLOGY
NX DISTRIBUTED INTELLIGENCE **wISCAPE** energen[®] SiteSure

SPECIFICATIONS

CONSTRUCTION

- Manufactured with cast aluminum
- Coated with a polyester finish that meets ASTM B17 corrosion test requirements and ASTM D322 cracking and loss of adhesion test requirements
- IP5 polyester powder-coat electrostatically applied and thermocured. IP5 finish consists of a fine scribe pretreatment regimen with a polymer primer sealer and top coated with a thermoset super TOC polyester powder coat finish
- The finish meets the AAMA 2604 performance specifications which includes passing a 3,000-hour salt spray test for corrosion resistance and meets cracking and loss of adhesion per ASTM D522 and meets surface impacts up to 160 inch-pounds
- External hardware is corrosion resistant

OPTICS

- Cartridge is held together with internal brass standoffs soldered to the board so that it can be field replaced as a one-piece optical system
- One-piece silicone gasket ensures a weatherproof seal around each individual optic
- One-piece optical cartridge system consisting of an LED engine, optics, gasket and stainless steel bezel

INSTALLATION

- Mounting options for horizontal arm, vertical trim or freestanding arm mounting available. Mounting hardware included

Submittal Review / Shop Drawing

APPROVED
 APPROVED WITH CHANGES NOTES
 REVISIONS AND REVISIONS
 REVISIONS

DATE: 9/4/2020 LOCATION:
TYPE: A PROJECT: Pikeview
CATALOG #: VPS-36L-65-3K-SR-UNV-A-VGT

LED ENGINE
SMD LED array
SMD LED array
SMD LED array
SMD LED array

STRIKE

RELATED PRODUCTS
Viper Large

KEY DATA

Lumen Range	5400 - 16,216
Wattage Range	55 - 36
Efficacy Range (LPW)	100 - 104
Reported Life (Hours)	170,000,000
Input Current Range (Amps)	0.1 - 1.1

Page 16 of 30
HUBBELL
LIGHTING

BEACON
SMALL VIPER LUMINAIRE

VIPER S
SMALL VIPER LUMINAIRE

ORDERING GUIDE

CATALOG #: VPS-36L-65-3K-SR-UNV-A-VGT

Example: VPS-24L-55-4K7-4W-UNV-A-DL-TL-GEN-04-BC

Series	LED Engine	CCT/CRI	Distribution	Mounting	Voltage
VPS-36L-65-3K	SMD LED array	3000K 3K (C0)	FR	Type 1/Post Row	UNV 55-277V
VPS-36L-65-3K	SMD LED array	4000K 4K (C1)	FR	Type 2	247 30V
VPS-36L-65-3K	SMD LED array	5000K 5K (C2)	FR	Type 3	480 480V
VPS-36L-65-3K	SMD LED array	5000K 5K (C2)	FR	Type 4	
VPS-36L-65-3K	SMD LED array	5000K 5K (C2)	FR	Type 5	
VPS-36L-65-3K	SMD LED array	5000K 5K (C2)	FR	Type 6	

Accessories and Services (Ordered Separately)

SCD-BEOTE Remote Control for SCD, F, option. Order at least one per project to program and control the occupancy sensor.

SWS-ISP 3 Sixtyday weather-based on/off control for use with timer supplied PC/Windows based only. Includes Sixtyday license software and LED light bridge module.

SWS-ITAP 3 Windows tablet and Sixtyday interface software. Includes tablet with pre-installed software, Sixtyday license and USB radio bridge module.

SWS-IR 3 Sixtyday 7-pin on feature module On/Off/Dim. Daylight Sensor with iSCAPE Radio. 100-480VAC.

SWS-IR 3 Sixtyday 7-pin on feature module On/Off/Dim. Daylight Sensor with iSCAPE Radio. 100-480VAC.

SWS-IR 3 Sixtyday 7-pin on feature module On/Off/Dim. Daylight Sensor with iSCAPE Radio. 100-480VAC.

SWS-IR 3 Sixtyday 7-pin on feature module On/Off/Dim. Daylight Sensor with iSCAPE Radio. 100-480VAC.

Page 29 of 30
HUBBELL
LIGHTING

BEACON

SSS-B SERIES
POLES
SQUARE STRAIGHT STEEL

DATE: 9/4/2020 LOCATION:
TYPE: A PROJECT: Pikeview
CATALOG #: VPS-36L-65-3K-SR-UNV-A-VGT

Example: SSS-B-16-40-A-1-B3-VGT

APPLICATIONS

- Lighting installations for side and top mounting of luminaires with effective projected area (EPA) not exceeding maximum allowable loading of the specified pole in its installed geographic location

CONSTRUCTION

- SHFT: One-piece straight steel with square cross section. Flat sides and minimum 0.238" radius on all corners. Minimum wall of 46.000 psi (ASTM-A500, Grade B). Longitudinal weld seam to appear flush with flat side wall. Steel base plate with axial bolt circle slots welded flush to pole shaft having minimum yield of 36,000 psi (ASTM A36)
- BASE COVER: Two-piece square aluminum base cover (included standard)
- POLE CAP: Pole shaft supplied with removable cover when applicable. Trim and post-top configurations also available
- HAND HOLE: Rectangular 3x5 steel hand hole frame (2.38" x 4.38" opening); Mounting provisions for grounding lug located behind gasketed cover
- ANCHOR BOLTS: Four galvanized anchor bolts provided per pole with minimum yield of 55,000 psi (ASTM A307, Grade B). Galvanized hardware with two washers and two nuts per bolt
- Anchor bolt part numbers: 3/4 x 30 x 3 --- TAB-30-M8S
1 x 36 x 4 --- TAB-36-M20

FINISH

- Durable thermoset polyester powder coat paint finish with nominal 3.0 mil thickness
- Powder paint prime applied over "white metal" steel substrate cleaned via mechanical shot
- Decorative finish coat available in seven standard colors. Custom colors available. RAL number provided.
- Internal protective coating available

WAREHOUSE STOCKED POLES:

- SSSH245-40A-4-HV-DB-RC, SSSH245-40A-4-HV-DB-RC and SSSH245-40A-4-HV-DB-RC
- The HV designation in the above catalog numbers is a combination drill pattern of the Hubbell Outdoor S2 pattern and the designation S3/S4 Viper pattern (rectangular arm mounting)

POLE CAP **TRIM** **BASE COVER** **BASE DETAIL**

ORDERING INFORMATION

ORDERING EXAMPLE: SSS-B-16-40-A-1-B3-VGT

Reference page 2 for available configurations

SERIES	HEIGHT	SHAFT	THICKNESS	MOUNTING	FINISH	OPTIONS
SSS-B	Square Straight Steel Pole	Reference page 2 Ordering table	Reference page 2 Ordering table	Reference page 2 Ordering table	BLS Black Matte Textured BLS Black Gloss Smooth DBS Dark Bronze Matte Textured DBS Dark Bronze Gloss Smooth GTT Graphite Matte Textured LGS Light Gray Gloss Smooth PSS Platinum Silver Smooth WHT White Matte Textured WHT White Gloss Smooth WHT White Green Textured	RSC Internal Coating (Hubbell Seal) GF 20 Amp GFCI (Breaker) and Cover EHF Extra Handhole COP 3" Coating MPR Mid-pole Luminaire Mount VM2 2nd mode vibration damper LAB Lase Anchor Bolt UL Listed Certified

ACCESSORIES - Order Separately

Color Options

Color	Description
W1	1st mode vibration damper
VM2XSS	2nd mode vibration damper
B1	Color: 7806 Yell
B3	2 bolt (3-1/2" spacing), Vert "A" arm
B2	2 bolt (3-1/2" spacing), Viper "AD" arm

Page 29 of 30
HUBBELL
LIGHTING

HUBBELL
Outdoor Lighting

FRESNO Series
BOLLARDS

FEATURES

- Two size options available
- Sealed one-piece, clear acrylic lens
- Specular, anodized aluminum optical systems
- 30w and 40w energy-efficient LED systems
- Extruded aluminum square or round housing, with tamper-resistant hardware
- Flat top, or optional dome top for round FN2



RELATED PRODUCTS
Bristle Park Pavilion Family

SPECIFICATIONS

HOUSING

- Extruded aluminum 6061 alloy square or round housing, with tamper-resistant hardware; flat top, for round FN2
- Single screw access for service and maintenance
- Sealed one-piece, clear acrylic lens; Specular, anodized aluminum optical systems
- Concealed, cast aluminum 360 alloy anchor base; four 1/2" x 10" anchor bolts
- Durable Leticores[®] TIGC thermoset polyester powder coat paint finish ensures long life and maintenance-free service

OPTICS

- Available in 5000K, 4000K, 3000K CCT and Macroluminaires
- Long Life >60,000 hours L90 rated at 25°C
- Optional continuous dimming to 10%
- Rotatable LED assembly adjustment for ideal placement and aiming of asymmetric light pattern

ELECTRICAL

- Universal voltage (120-277, 50/60Hz) drivers with $\pm 10\%$ tolerance, starting temperature rated at 20°F

CERTIFICATIONS

- UL1598 for use in wet locations
- 5-year limited warranty
- See HLI Standard Warranty for additional information

WARRANTY

- 5-year limited warranty
- See HLI Standard Warranty for additional information

DATE: 9/4/2020 LOCATION:
TYPE: B PROJECT: Pikeview
CATALOG #: FN1-24LU-3K-DB

Submittal Review / Shop Drawing

APPROVED
 APPROVED WITH CHANGES NOTES
 REVISIONS AND REVISIONS
 REVISIONS

DATE: 9/4/2020 LOCATION:
TYPE: B PROJECT: Pikeview
CATALOG #: FN1-24LU-3K-DB

LED ENGINE
SMD LED array
SMD LED array

PERFORMANCE DATA

Description	Drive Current	Distribution	5K (5000K NOMINAL 70 CRI)	4K (4000K NOMINAL 70 CRI)	3K (3000K NOMINAL 80 CRI)							
FN1	12	Type III	761	28	0	2	0	635	24	0	2	0
		Type V	1580	39	1	2	0	1443	35	1	2	0
		Type III	1095	41	0	2	0	941	35	0	2	0
FN2	12	Type V	1580	39	1	2	0	1443	35	1	2	0
		Type III	1095	41	0	2	0	941	35	0	2	0
		Type V	1580	39	1	2	0	1443	35	1	2	0

Page 16 of 30
HUBBELL
LIGHTING

HUBBELL
Outdoor Lighting

FRESNO Series
BOLLARDS

ORDERING GUIDE

CATALOG #: FN1-24LU-3K-DB

Example: FN1-24LU-3K-BT-CD

ORDERING INFORMATION

Series	LED Engine	CCT/CRI	Distribution	Mounting	Voltage
FN1	SMD LED array	3000K 3K (C0)	DB	FR	UNV 55-277V
FN1	SMD LED array	4000K 4K (C1)	DB	FR	247 30V
FN1	SMD LED array	5000K 5K (C2)	DB	FR	480 480V
FN2	SMD LED array	5000K 5K (C2)	DB	FR	
FN2	SMD LED array	5000K 5K (C2)	DB	FR	
FN2	SMD LED array	5000K 5K (C2)	DB	FR	

Accessories and Services (Ordered Separately)

SCD-BEOTE Remote Control for SCD, F, option. Order at least one per project to program and control the occupancy sensor.

SWS-ISP 3 Sixtyday weather-based on/off control for use with timer supplied PC/Windows based only. Includes Sixtyday license software and LED light bridge module.

SWS-ITAP 3 Windows tablet and Sixtyday interface software. Includes tablet with pre-installed software, Sixtyday license and USB radio bridge module.

SWS-IR 3 Sixtyday 7-pin on feature module On/Off/Dim. Daylight Sensor with iSCAPE Radio. 100-480VAC.

SWS-IR 3 Sixtyday 7-pin on feature module On/Off/Dim. Daylight Sensor with iSCAPE Radio. 100-480VAC.

SWS-IR 3 Sixtyday 7-pin on feature module On/Off/Dim. Daylight Sensor with iSCAPE Radio. 100-480VAC.

SWS-IR 3 Sixtyday 7-pin on feature module On/Off/Dim. Daylight Sensor with iSCAPE Radio. 100-480VAC.

Page 29 of 30
HUBBELL
LIGHTING

HUBBELL
Outdoor Lighting

FRESNO Series
BOLLARDS

ORDERING GUIDE

CATALOG #: FN1-24LU-3K-DB

Example: FN1-24LU-3K-BT-CD

ORDERING INFORMATION

Series	LED Engine	CCT/CRI	Distribution	Mounting	Voltage
FN1	SMD LED array	3000K 3K (C0)	DB	FR	UNV 55-277V
FN1	SMD LED array	4000K 4K (C1)	DB	FR	247 30V
FN1	SMD LED array	5000K 5K (C2)	DB	FR	480 480V
FN2	SMD LED array	5000K 5K (C2)	DB	FR	
FN2	SMD LED array	5000K 5K (C2)	DB	FR	
FN2	SMD LED array	5000K 5K (C2)	DB	FR	

Accessories and Services (Ordered Separately)

SCD-BEOTE Remote Control for SCD, F, option. Order at least one per project to program and control the occupancy sensor.

SWS-ISP 3 Sixtyday weather-based on/off control for use with timer supplied PC/Windows based only. Includes Sixtyday license software and LED light bridge module.

SWS-ITAP 3 Windows tablet and Sixtyday interface software. Includes tablet with pre-installed software, Sixtyday license and USB radio bridge module.

SWS-IR 3 Sixtyday 7-pin on feature module On/Off/Dim. Daylight Sensor with iSCAPE Radio. 100-480VAC.

SWS-IR 3 Sixtyday 7-pin on feature module On/Off/Dim. Daylight Sensor with iSCAPE Radio. 100-480VAC.

SWS-IR 3 Sixtyday 7-pin on feature module On/Off/Dim. Daylight Sensor with iSCAPE Radio. 100-480VAC.

SWS-IR 3 Sixtyday 7-pin on feature module On/Off/Dim. Daylight Sensor with iSCAPE Radio. 100-480VAC.

Page 29 of 30
HUBBELL
LIGHTING

7/27/22, 4:18 PM

Progress Lighting P5607-31 Signature 1 Light | Build.com

Item # bc1357932
Progress Lighting Signature 1 Light Outdoor Wall Sconce with Flat Glass Shade - 8" Tall
Model P5607-31
★★★★☆ (4) | [Write a Review](#)
TYPE G



CUTTING EDGE LED TECHNOLOGY

- E26 ADAPTOR and TP24 CONNECTOR - simple click and turn installation
- Snap spring clips compatible 5/8 inch recessed housing can
- HIGH QUALITY LED CHIPS
- TRADITIONAL BAFFLE TRIM DESIGN - provides glare free

5 YEAR WARRANTY

WET LOCATION

Intertek

\$36.02
Free Shipping on orders over \$49.00!
Delivered to 80524 by Saturday, July 30th - Shipping to 80524

https://www.build.com/progress-lighting-p5607/683814?uid=357932&searchid=8LyGd2cDeN

Page 16 of 30
HUBBELL
LIGHTING

Chavez Tiffany & Ayers
Engineering Corporation

611 North Nevada Avenue
Colorado Springs, Colorado 80903
P (719)636-0021

COLORADO LICENSED PROFESSIONAL ENGINEER
8/8/22

MESA RIDGE SUBDIVISION
PHOTOMETRIC PLAN
COLORADO SPRINGS, COLORADO

ISSUE HISTORY:

DRAWN BY EJR
CHECKED BY JJA
DATE 8/8/22

DRAWING TITLE
LIGHT FIXTURE SPECIFICATIONS

DRAWING NO.
DPE-2