

NORTH

VEGETATED AREAS DISTURBED DURING EXCAVATION AND FOUNDATION CONSTRUCTION TO BE SEEDED WITH NATIVE GRASS "FIRE MIX" OR OTHER USES APPROVED NATIVE SEED MIX. THE GRASS SEED MIX USED SHALL MAINTAIN THE CHARACTER OF THE SURROUNDING AREA. (THIS AREA IS NOT VISIBLE FROM PUBLIC ROADS OR ANY ADJACENT PROPERTY.)

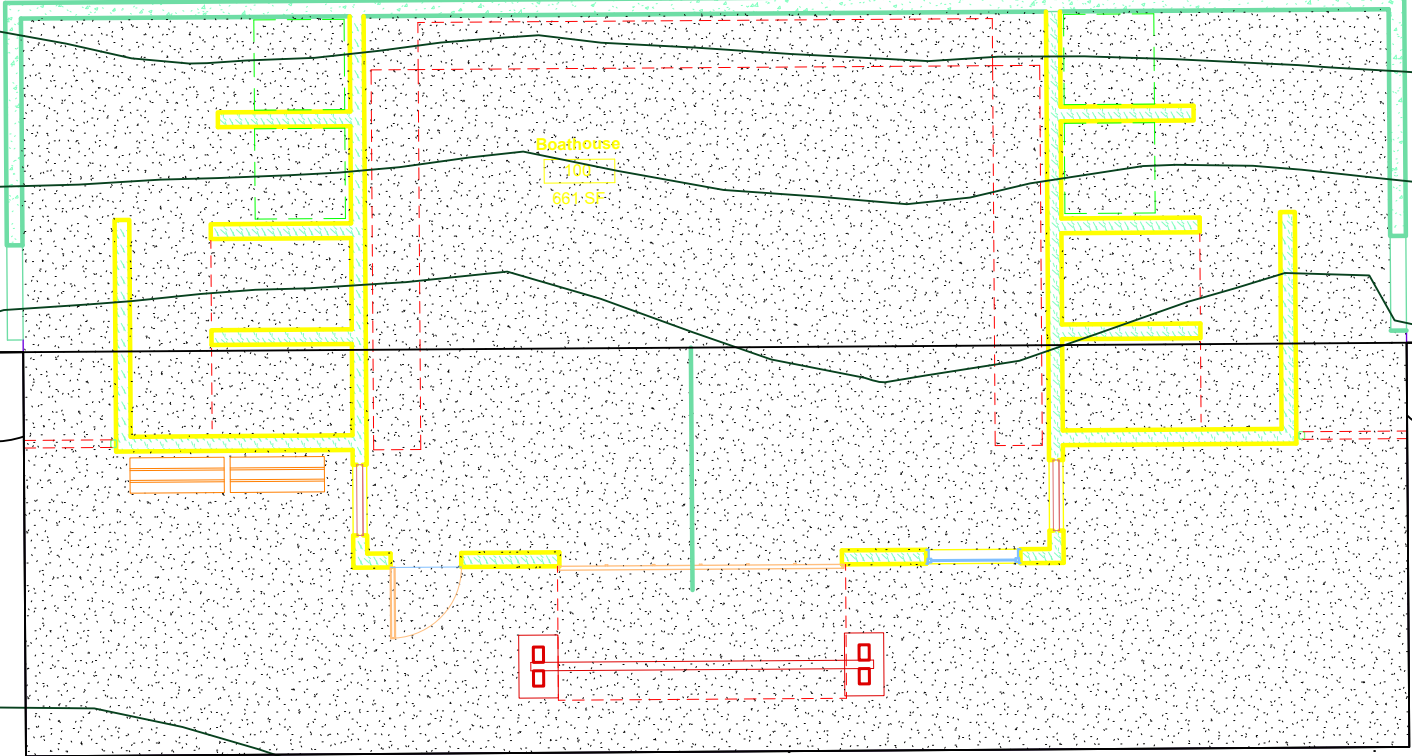

EXISTING
BOATHOUSE
(TO BE
REMOVED)

GRASS IN THIS
AREA SHALL
REMAIN
UNDISTURBED.

REMOVE GRASS IN THIS AREA,
REPLACE WITH 4-6" DEEP PLAY SAND.

EXISTING BEACH AREA COMPRISED
OF 4-6" DEEP PLAY SAND.

LAKE WATER

SCALE: 1"=8' (APPROX.)